

IMPORTANT NOTES: Read First

(A) Use liquid thread lock (such as Loctite®) with all threaded hardware. **Important:** Liquid thread lock (prior to curing) helps to eliminate the common problem of "thread seizure" in stainless steel hardware by serving as a lubricant during assembly.

(B) Do not pour concrete until the equipment is completely assembled, leveled and plumbed. Concrete must be allowed to cure completely before using the equipment (at least 72 hours).

(C) Refer to Installation Manual for NF-5102 NFuse 2-Rung Access Ladder installation instructions.

(D) The maximum height of rungs (at grasping point) from the top of the protective surfacing for ages 5-12 is 84" [2130mm] above protective surfacing.

(E) An appropriate energy absorbing safety surface is required under and around all playground equipment. Loose fill protective surfacing is shown only as an example for the purpose of this assembly instruction. Other surfacing material may vary in thickness and/or compression depths. See free publication - The Handbook for Public Playground Safety, Publication #325 at www.cpsc.gov for the surfacing appropriate for the fall height of the equipment or consult your surfacing supply representative.

FIGURE 1
NFuse Ring Traverse

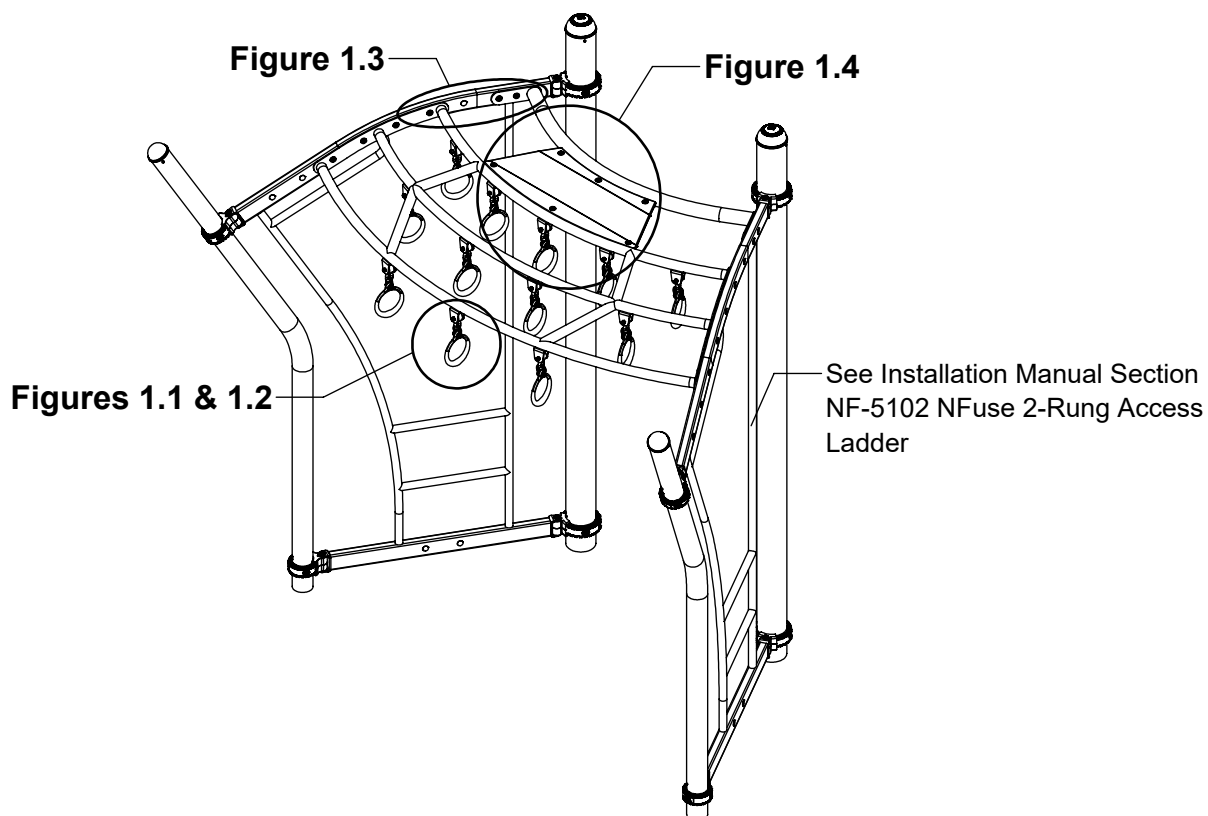

NOTE: NFuse Non-Deck Mount Bay shown. Other configurations will vary slightly, but does not affect assembly.

Step 1

Attach Rings to Swivels as shown in Figure 1.1.
(See Note A)

NOTE: 12 Places

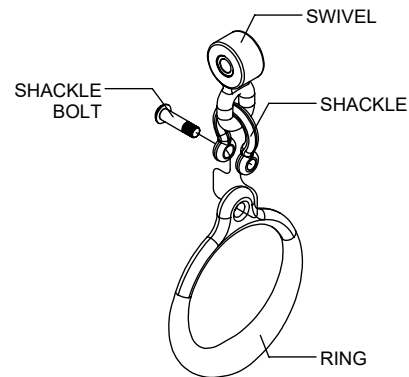

Figure 1.1

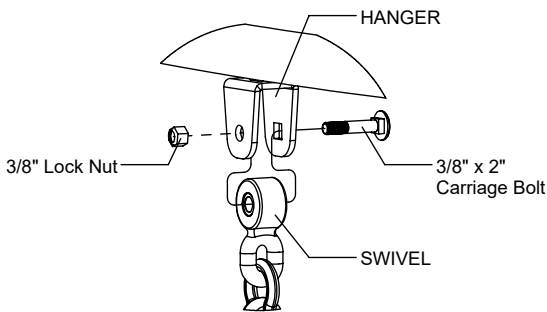

Figure 1.2

Step 2

Attach Swivels to Hangers as shown in Figure 1.2. (See Note A)

NOTE: 12 Places

Step 3

Attach Top Inside Weldment and Ring Traverse to Frame as shown in Figure 1.3. (See Notes A & D)

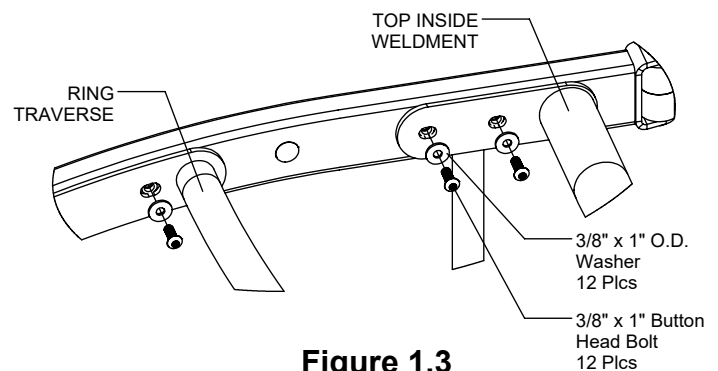

Figure 1.3

Step 4

Attach Rubber Pad to Top Inside Weldment and Ring Traverse as shown in Figure 1.4.
(See Note A)

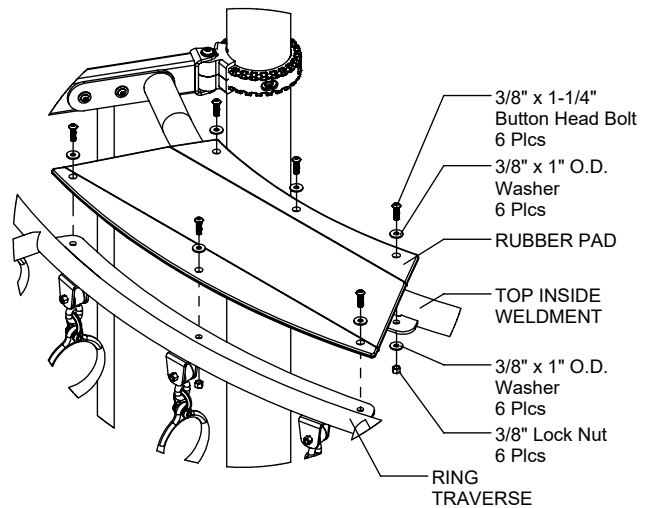

Figure 1.4

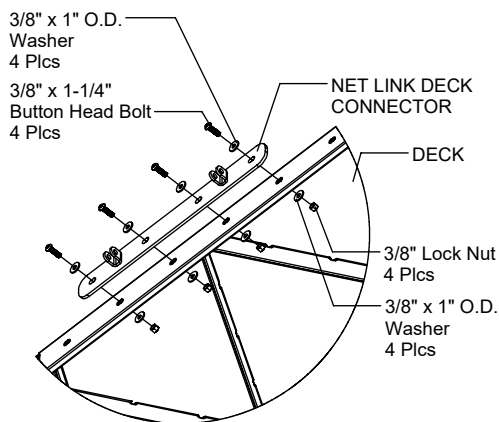

FIGURE 2

Step 5

For Deck Mount Version Only

Attach Net Link Deck Connector to Deck as shown in Figure 2. (See Note A)

Step 6

For Deck Mount Version Only

Attach Deck Link Nets to Net Link Deck Connector as shown in Figure 3. (See Note A)

Step 7

Fully tighten all fasteners according to the "TIGHTENING TORQUE FOR HARDWARE" section of the Installation Manual.

Step 8

Place required protective surfacing under and around NFuse Ring Traverse. (See Note E)

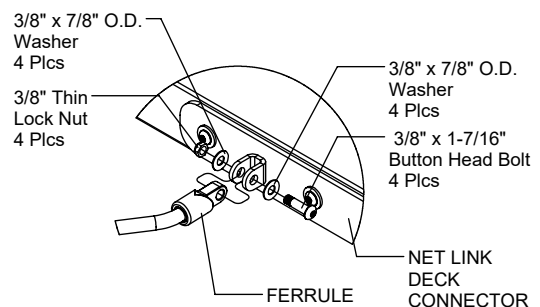

FIGURE 3

NFUSE RING TRAVERSE INSTALLATION INSTRUCTIONS

5205
Page 4 of 4

Parts List

NON-DECK MOUNT		
Part #	DESCRIPTION	QTY
FS-5205	NFuse Ring Traverse - Weldment	1
FS-5205-TI	NFuse Ring Traverse - Top Inside Weldment	1
HM-0009	NFuse Ring Traverse - Rubber Pad	1
411001	Ring	12
451161-SS	Swing Shackle - Stainless Steel	12
471002	Swing Hanger w/ Nut & Bolt	12
9103052-TR	Bolt Button Head 3/8" x 1"	12
9103062-TR	Bolt Button Head 3/8" x 1-1/4"	6
9333002	Washer Flat 3/8" x 1" O.D. x .100" thick	24
9413002	Nut Lock 3/8"	6

DECK MOUNT		
Part #	DESCRIPTION	QTY
FS-1528	Angled Net Link Deck Connector	1
FS-5205	NFuse Ring Traverse - Weldment	1
FS-5205-DL	NFuse Ring Traverse - Top Inside Weldment - Deck Link	1
HM-0001-DN	NFuse Deck Link Net	2
HM-0009	NFuse Ring Traverse - Rubber Pad	1
411001	Ring	12
451161-SS	Swing Shackle - Stainless Steel	12
471002	Swing Hanger w/ Nut & Bolt	12
9103052-TR	Bolt Button Head 3/8" x 1"	12
9103062-TR	Bolt Button Head 3/8" x 1-1/4"	10
9103200-TR	Bolt Button Head 3/8" x 1-7/16"	4
9333002	Washer Flat 3/8" x 1" O.D. x .100" thick	32
9333042	Washer Flat 3/8" x 7/8" O.D.	8
9413002	Nut Lock 3/8"	10
9423002	Nut Lock Thin 3/8"	4

Specifications

NFUSE RING TRAVERSE - WELDMENT:

Shall be fabricated using 1.660" O.D. 11 gauge steel tubing with welded 1/4" plates and 3/16" thick steel hangers and will have a multi-stage baked-on powder coat finish.

NFUSE RING TRAVERSE - TOP INSIDE WELDMENT:

Shall be fabricated using 2.375" O.D. 10 gauge steel tubing with welded 1/4" plates and 3/16" thick steel clevises (for deck mount version) and will have a multi-stage baked-on powder coat finish.

NFUSE RING TRAVERSE - RUBBER PAD:

Shall be constructed of UV-stabilized flexible rubber compound with slash proof, reinforced metal inserts.

ANGLED NET LINK DECK CONNECTOR:

Shall be fabricated using 1/4" thick steel with welded 3/16" thick steel clevises and will have a multi-stage baked-on powder coat finish.

NFUSE DECK LINK NET:

Shall be made from 16mm steel-reinforced rope with high-strength copolymer plastic intersection connectors and machined aluminum ferrules.

HARDWARE:

Shall be stainless steel, zinc/nickel plated or galvanized as required to resist rust and corrosion.

Maintenance

Periodically tighten all screws, bolts and nuts. A periodic inspection of all parts is necessary. If a part is broken or worn, replace immediately. For general maintenance please refer to our Playground Maintenance Manual.



www.playcraftsystems.com
For Customer Service Call
800.333.8519 (U.S.A.) or 541.955.9199 (International)

Rev A
9/27/2021