

TALEGA PARK TOP VIEW

ADA ACCESSIBILITY GUIDELINE - ADAAG CONFORMANCE

| ELEVATED | ACCESSIBLE | RAMP ACCESSIBLE | GROUND | TYPES |
|----------|------------|-----------------|--------|-------|
| -1 | 0/0 | 0 | 8/0 | 0/0 |

R5

FOR KIDS
AGES
5-12

GENERAL NOTES:

This conceptual plan is based on information provided prior to construction. Detailed site information, including the following, should be obtained, evaluated, and utilized in the final project design. Exact site dimensions, topography, existing utilities, soil conditions and drainage solutions.

WARNING: Accessible safety surfacing material is required beneath and around this equipment that has a critical height value (Fall Height) appropriate for the highest accessible part of this equipment. Refer to the CPSC'S Handbook For Public Playground Safety, Section 4: Surfacing.

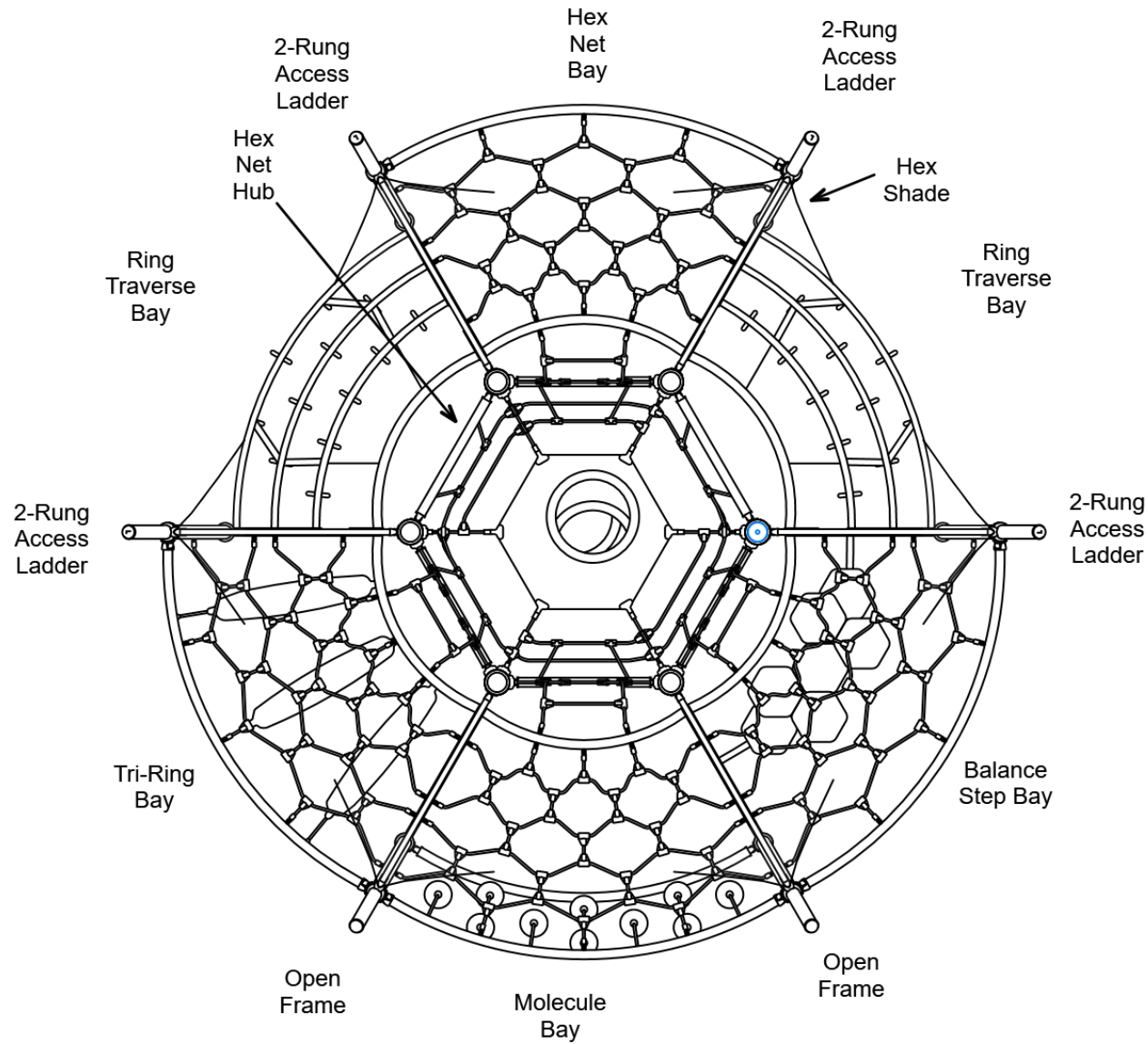

STRUCTURE#: NF5B3CFFA
PROJECT#: PAC22B754EA
DATE: 9/26/2022

MIN. USE ZONE: 32' x 31'

PLAYCRAFT REP:
Pacific Play Systems, Inc.

TALEGA PARK
TOP VIEW

ADA ACCESSIBILITY GUIDELINE - ADAAG CONFORMANCE

| ELEVATED | ACCESSIBLE | RAMP ACCESSIBLE | GROUND | TYPES |
|----------|------------|-----------------|--------|-------|
| 0 | 0/0 | 0 | 1/0 | 1/0 |

FOR KIDS
AGES
5-12

PC 2476
SPIN MAX
TOWER

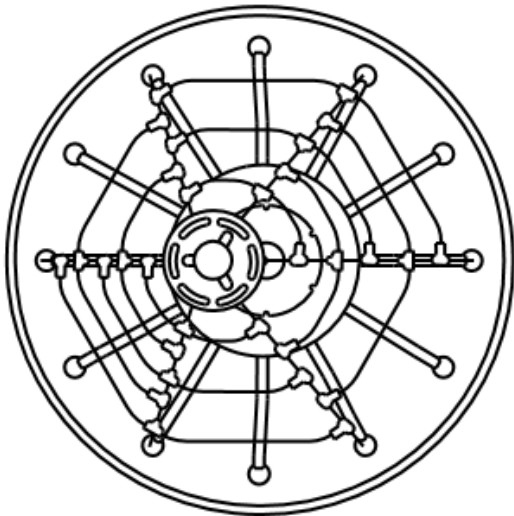

GENERAL NOTES:

This conceptual plan is based on information provided prior to construction. Detailed site information, including the following, should be obtained, evaluated, and utilized in the final project design. Exact site dimensions, topography, existing utilities, soil conditions and drainage solutions.

WARNING: Accessible safety surfacing material is required beneath and around this equipment that has a critical height value (Fall Height) appropriate for the highest accessible part of this equipment. Refer to the CPSC'S Handbook For Public Playground Safety, Section 4: Surfacing.

STRUCTURE#: FREPC2476
PROJECT#: PAC22B754EA
DATE: 9/26/2022

MIN. USE ZONE: 19' x 19'

PLAYCRAFT REP:
Pacific Play Systems, Inc.

**TALEGA PARK
SITE PLAN**

ADA ACCESSIBILITY GUIDELINE - ADAAG CONFORMANCE

| ELEVATED | ACCESSIBLE | RAMP ACCESSIBLE | GROUND | TYPES |
|----------|------------|-----------------|--------|-------|
| 0 | 0/0 | 0 | 14/0 | 2/0 |

R5

FOR KIDS
AGES
5-12

GENERAL NOTES:

This Preliminary Site Plan is based on measurements that were provided in the initial planning phase. All dimensions must be verified prior to the submission of a purchase order. Playcraft Systems will not be held responsible for any discrepancies between actual dimensions and dimensions submitted in the planning phase.

The Minimum Use Zone for a play structure is based on the product design at the time of proposal. Components and structure designs may be subject to change which may affect dimensions. Therefore, before preparing the site, we strongly recommend obtaining final drawings from the factory (available after the order is placed and included in the Assembly Manual).

WARNING: Accessible safety surfacing material is required beneath and around this equipment that has a critical height value (Fall Height) appropriate for the highest accessible part of this equipment. Refer to the CPSC'S Handbook For Public Playground Safety, Section 4: Surfacing.

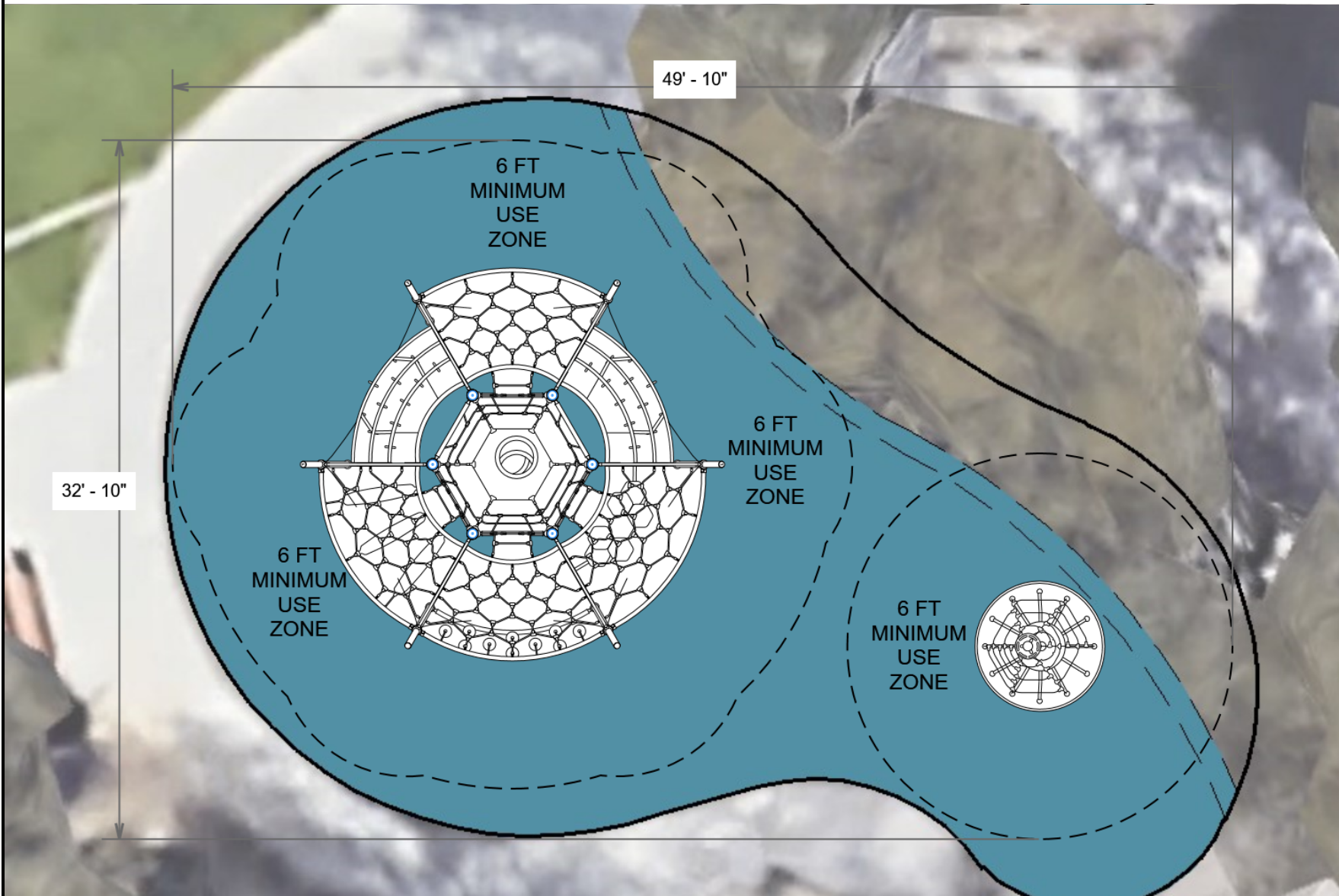

PROJECT#: PAC22B754EA
DATE: 9/26/2022

MIN. USE ZONE: 50' x 33'

PLAYCRAFT REP:
Pacific Play Systems, Inc.

TALEGA PARK
SW VIEW

R5

FOR KIDS
AGES
5-12

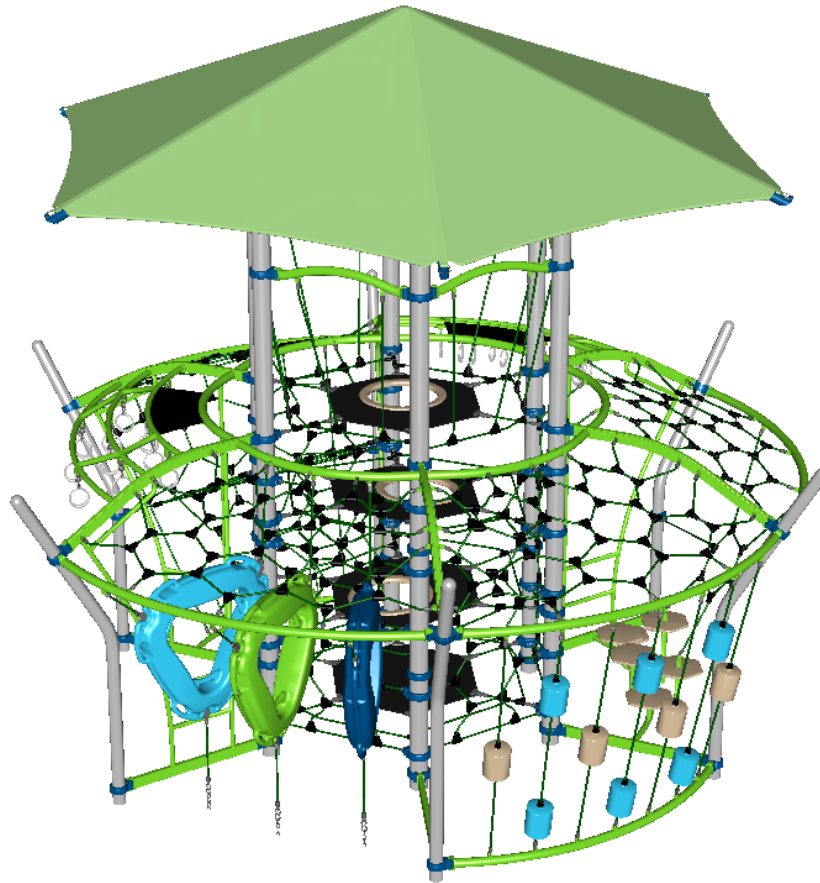

STRUCTURE#: NF5B3CFFA
PROJECT#: PAC22B754EA
DATE: 9/26/2022

TALEGA PARK
NE VIEW

R5

FOR KIDS
AGES
5-12

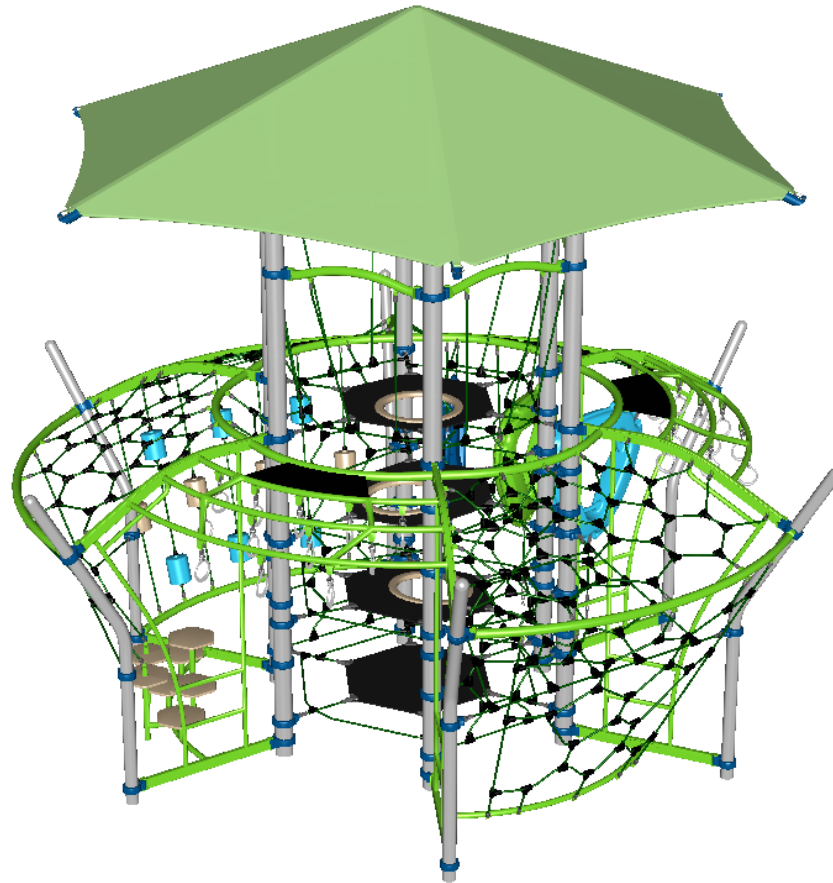

STRUCTURE#: NF5B3CFFA
PROJECT#: PAC22B754EA
DATE: 9/26/2022

TALEGA PARK
SW VIEW

FOR KIDS
AGES
5-12

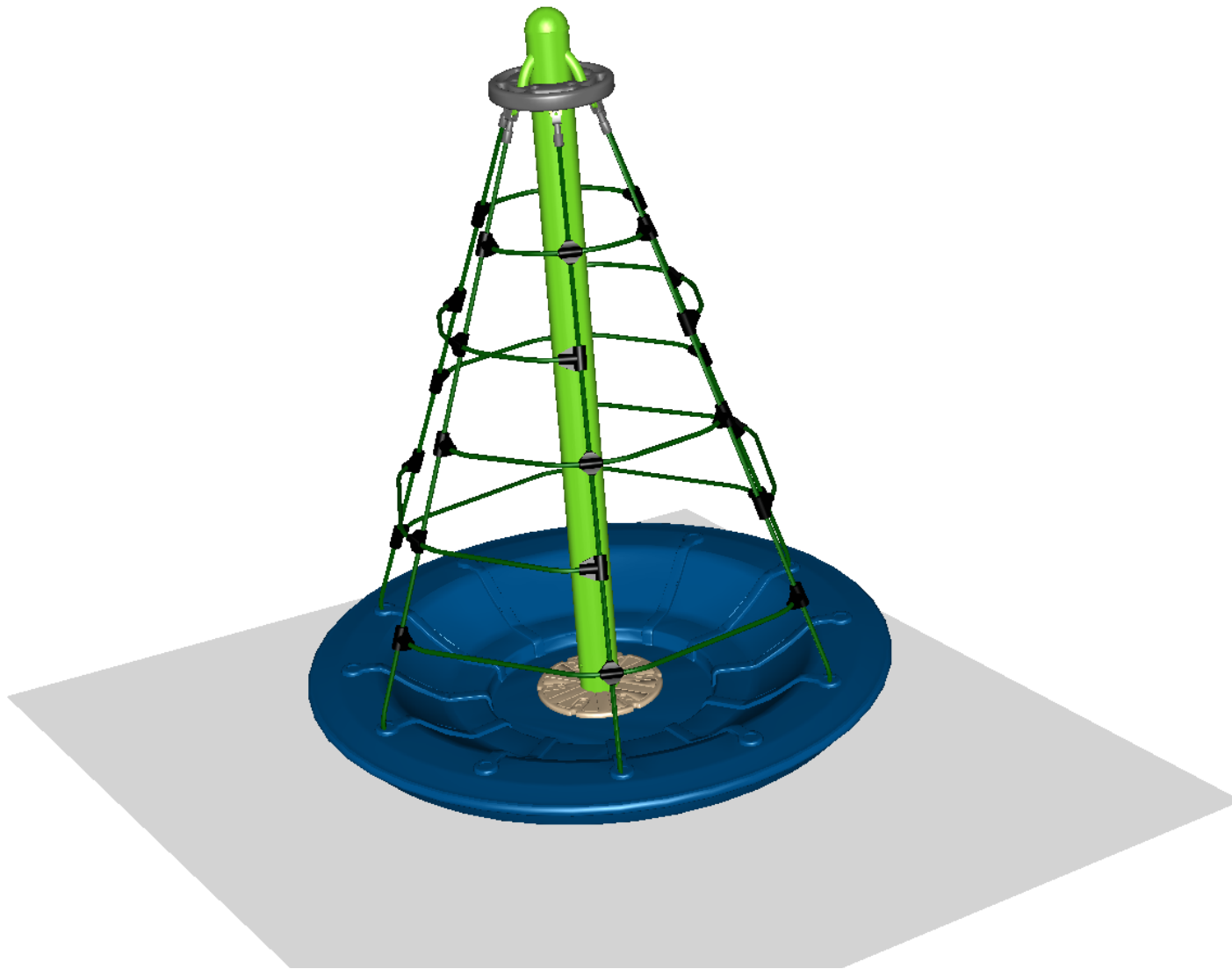

STRUCTURE#: FREPC2476
PROJECT#: PAC22B754EA
DATE: 9/26/2022



Bill of Materials

TALEGA PARK

Project# PAC22B754EA

9/26/2022

| Item | Description | Quantity |
|----------------|-------------------------|----------|
| NF5B3CFFA | | |
| HS-1004-R | Collars | 59 |
| HS-1004-R35 | Collars R35 | 16 |
| S-1017-R5-17ft | Post, 17ft R5 | 6 |
| S-18026-18-R5 | Shade Canopy, Hex 18ft | 1 |
| S-1925-R5 | Hub, Hex Net | 1 |
| S-5101 | Open Frame | 2 |
| S-5102 | 2-Rung Access Ladder | 4 |
| S-5201 | Hex Net Bay | 1 |
| S-5202 | Balance Step Bay | 1 |
| S-5203 | Tri-Ring Bay | 1 |
| S-5204 | Molecule Bay | 1 |
| S-5205 | Ring Traverse Bay | 2 |
| FREPC2476 | | |
| A2-2476 | PC 2476 Spin Max, Tower | 1 |