

IMPORTANT NOTES: Read First

(A) Use liquid thread lock (such as Loctite®) with all threaded hardware. **Important:** Liquid thread lock (prior to curing) helps to eliminate the common problem of "thread seizure" in stainless steel hardware by serving as a lubricant during assembly.

(B) Do not pour concrete until the equipment is completely assembled, leveled and plumbed. Concrete must be allowed to cure completely before using the equipment (at least 72 hours).

(C) **Important:** Full bucket seat swings should be suspended from structures that are separate from those used for other swings, or at least suspended from a separated bay of the same structure. According to the Handbook for Public Playground Safety, Publication #325 at www.cpsc.gov.

(D) Refer to CPSC for appropriate swing spacing.

(E) Chain length should be adjusted (trimmed) so that the underside of the belt swing is no less than 12" (Bucket Seat 24") from Finish Grade. See Recommended Swing Seat Heights.

(F) **Important:** Do not modify hanging position of ADA swings. (e.g. shortening chain, etc.)

(G) All bolt threads protruding beyond the nut must be cut and de-burred until end is smooth to the touch. Sharp edges and/or points of any kind must be eliminated. A maximum of two threads may be exposed beyond the end of the nut.

(H) An appropriate energy absorbing safety surface is required under and around all playground equipment. Loose fill protective surfacing is shown only as an example for the purpose of this assembly instruction. Other surfacing material may vary in thickness and/or compression depths. See free publication - The Handbook for Public Playground Safety, Publication #325 at www.cpsc.gov for the surfacing appropriate for the fall height of the equipment or consult your surfacing supply representative.

TREE TOP UPGRADE

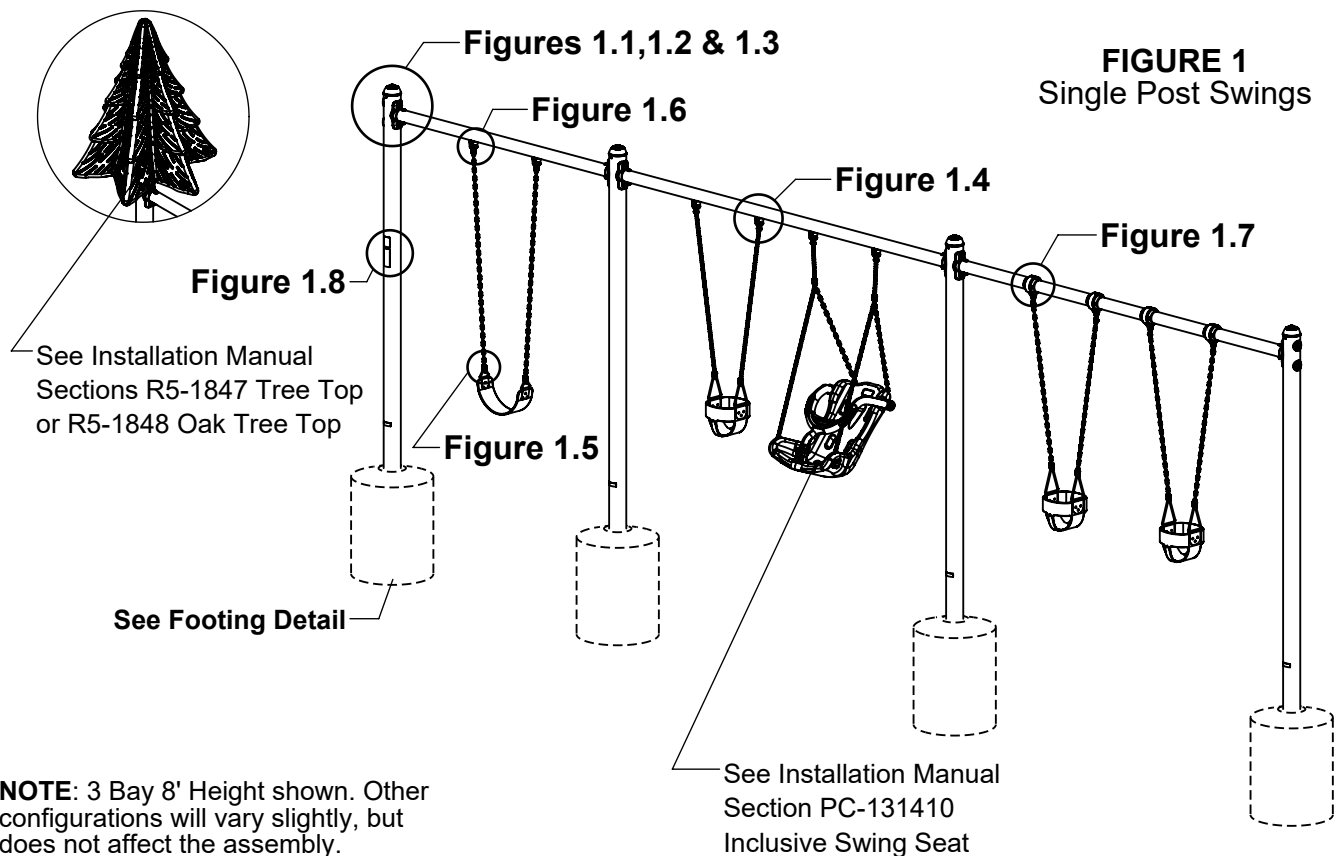

Step 1

Refer to Footing Layout and mark footing hole locations. Dig Ø 24" footing holes. Refer to Footing Detail for depth and details.

IMPORTANT: For areas with soft soil conditions, larger footings may be required.

* Footing depth must be adjusted to compensate for the depth/thickness requirements of selected safety surfacing. See Section 06.1 of the Installation Manual.

NOTE: Footing depths and chain lengths must be adjusted to compensate for lower height installs.

Footing Detail

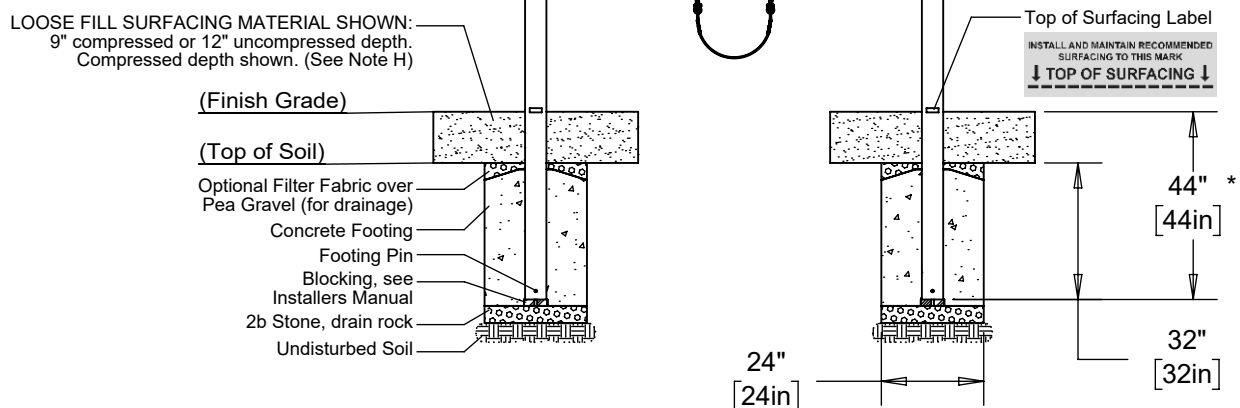

Recommended Swing Seat Heights (See Notes D, E & F)

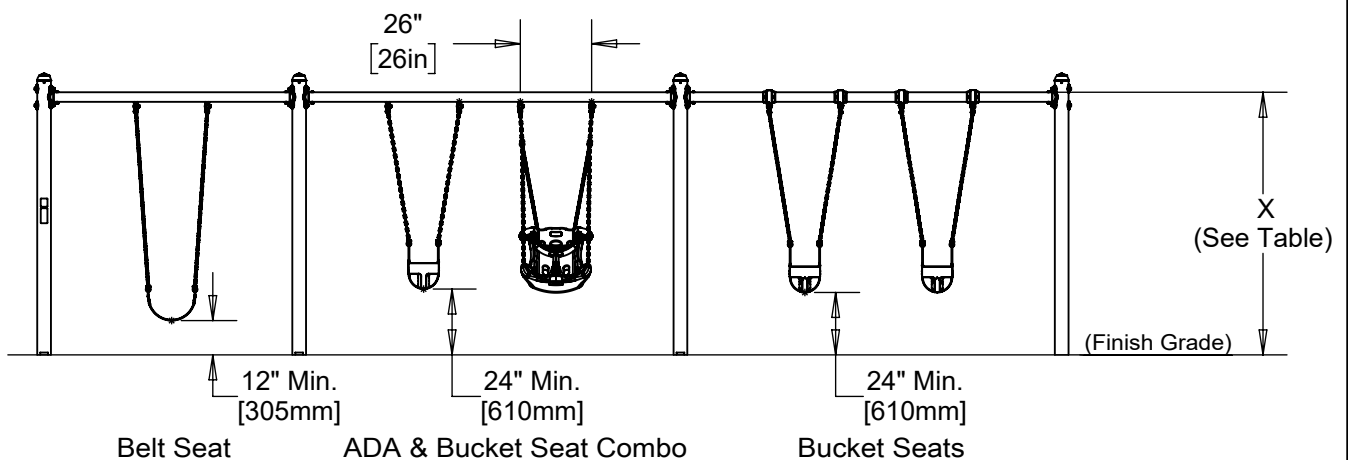

Swing Beam Height Finish Grade to Top of Beam			
Description	Part No.	X (in.)	X (mm)
8' Single Post Swing	PC-2181	96	2429
10' Single Post Swing	PC-2181-10	120	3048
Swing w/ Tree Top	PC-2182	96	2429

**Top View - Footing Layout
Single Seat Swing Bay**

NOTE: Footing distance is the same for additional bays.

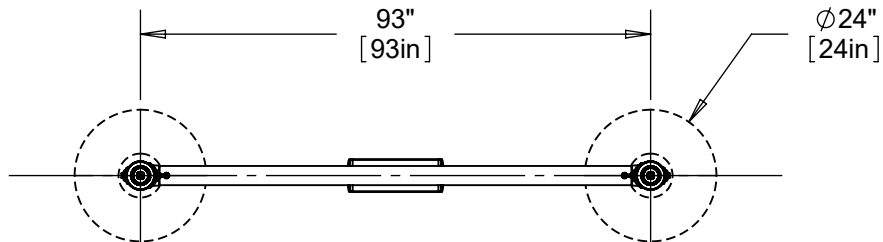

**Top View - Footing Layout
Two Seat Swing Bay**

NOTE: Footing distance is the same for additional bays.

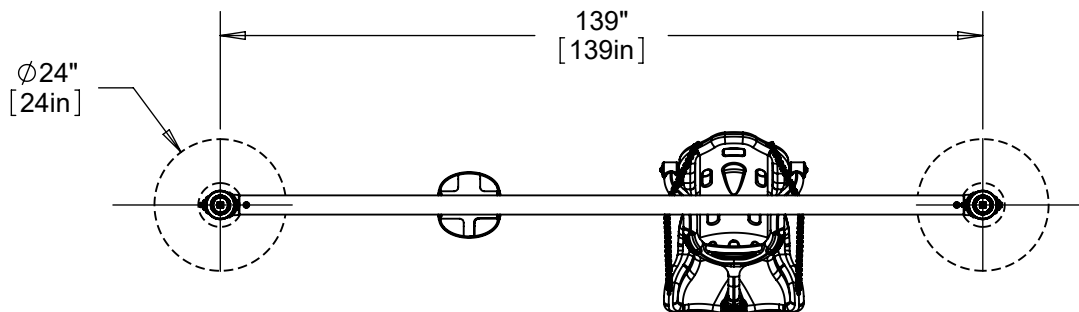

Use Zone

NOTE: Configuration shown is for illustration of use zones. Your configuration may vary slightly. Refer to CPSC for corresponding single-axis swing use zones.

IMPORTANT: Front to Rear Use Zones cannot overlap while End Use Zones may overlap other swing End Use Zones.

NOTE: Use zones are in conformance with the CPSC but not the CSA. If installing in Canada please refer to CSA Z614.

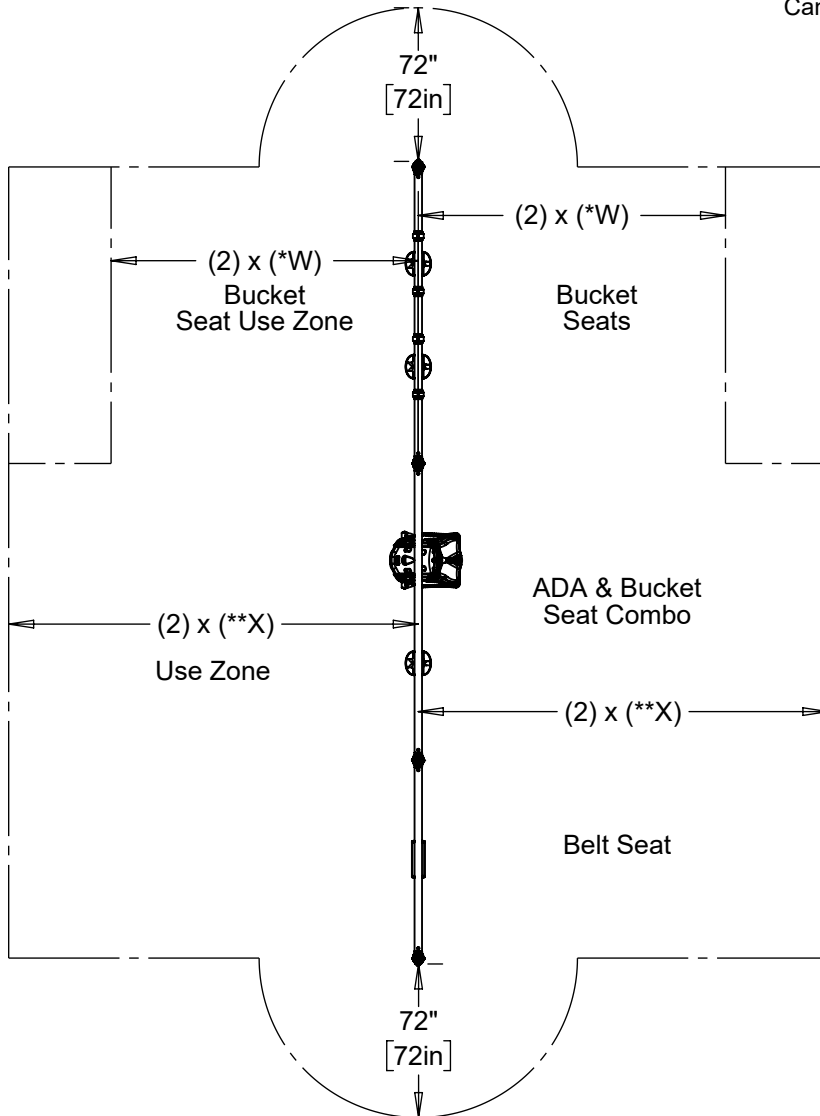

* W = the vertical distance from the swing pivot point to the top of the sitting surface.

** X = the vertical distance from the protective surfacing to the swing pivot point.

Step 2 (Factory Assembled)

For Standard Single Post Swing Only

Attach Post Caps to Posts as shown in Figure 1.1.

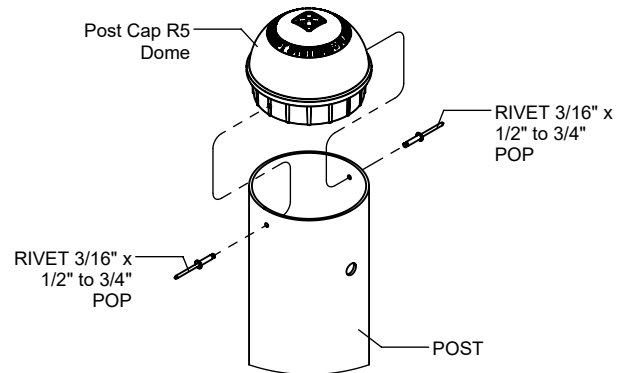

Figure 1.1

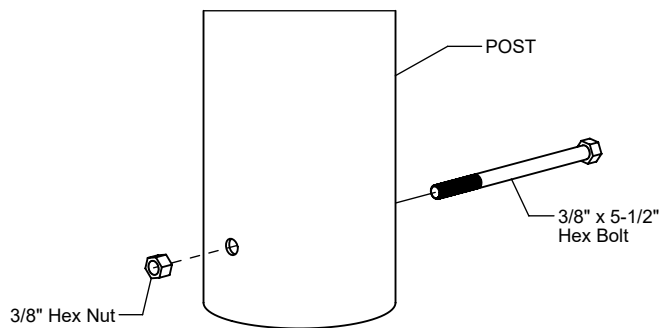

FIGURE 2

Step 3

Install footing pins into Posts as shown in Figure 2.
(See Note A)

Step 4

Attach Arch Swing Beam to Swing Castings as shown in Figure 1.2. (See Note A)

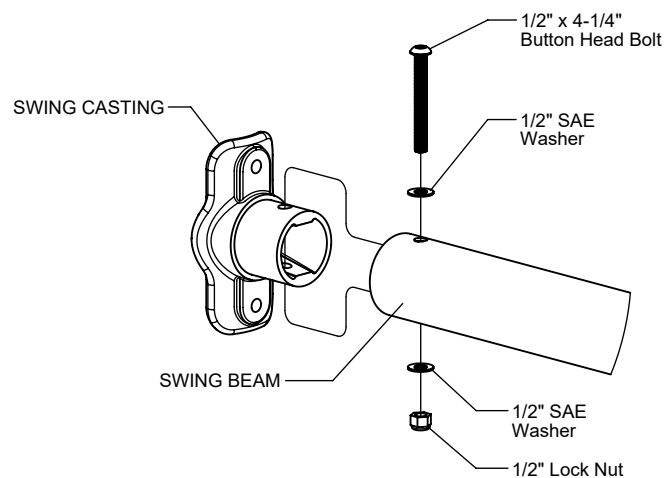

Figure 1.2

Step 5

Place Posts into footing holes and attach Arch Swing Beam to Post as shown in Figure 1.3.
(See Notes A & G)

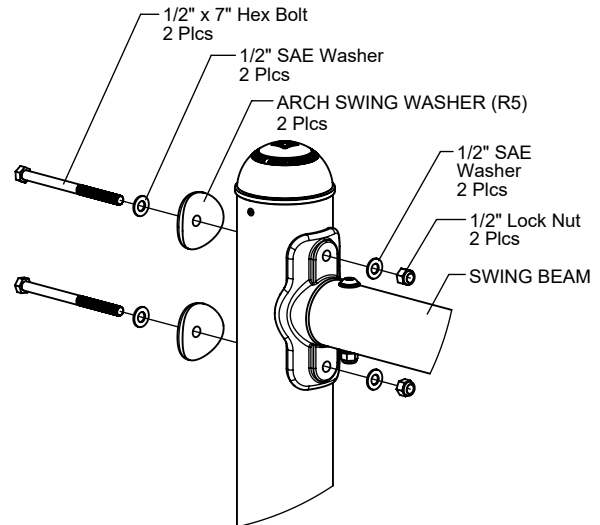

Figure 1.3

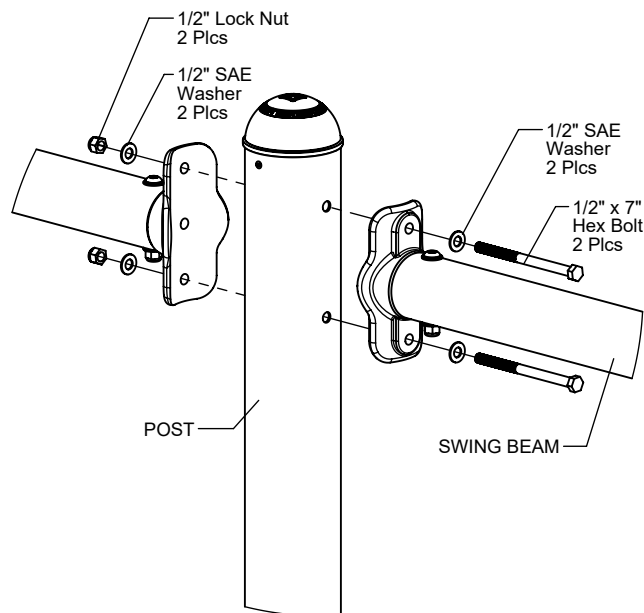

Figure 1.4

Step 6

For Additional Bay Only

Attach additional Arch Swing Beam to Post as shown in Figure 1.4. (See Notes A & G)

Step 7

For Belt and Bucket Seats Only

Attach Swing Seat to Chains as shown in Figure 1.5.
(See Notes A & E)

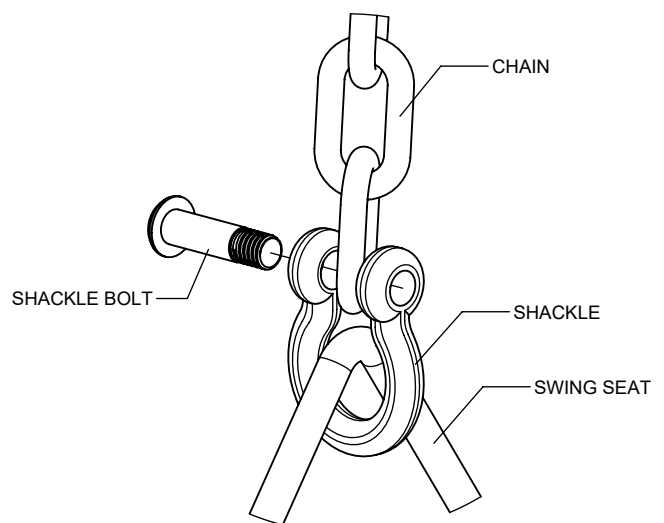

Figure 1.5

Step 8

For Belt, Bucket, and Inclusive Seats Only

Attach Swing Chains to Swing Beam as shown in Figure 1.6. (See Notes A, D & E)

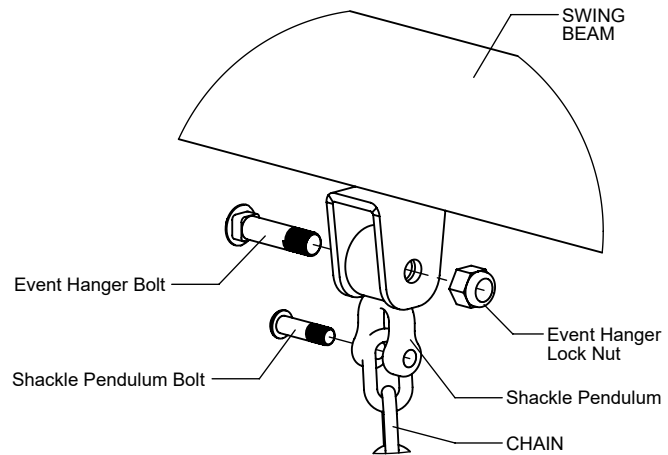

Figure 1.6

Step 9

For Anti Wrap Swings Only

Locate and attach Chains to optional Anti Wrap Collar to Beam as shown in Figure 1.7. (See Notes A, D & E)

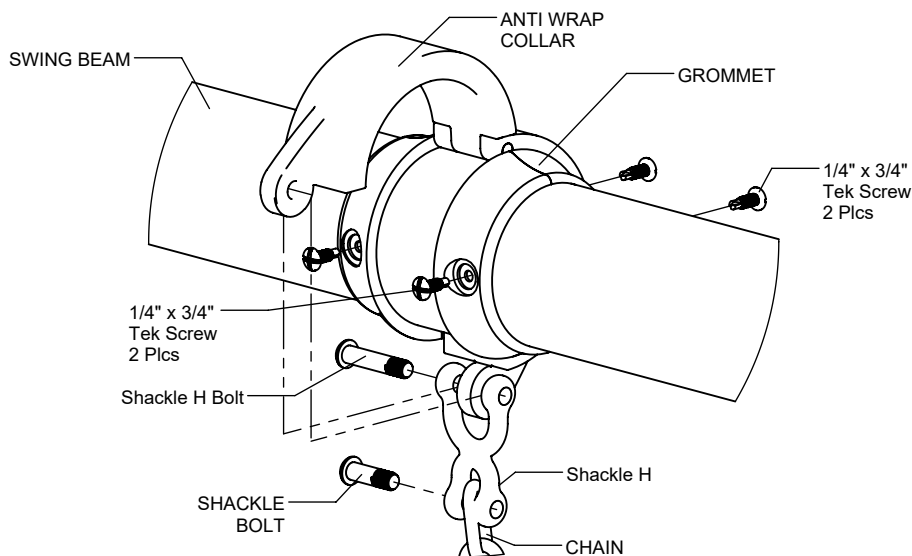

Figure 1.7

Step 10

Apply Warning and 5 - 12 Age Appropriate Label to Swing Post where visible to users as shown in Figure 1.8.
(Dimension indicates suggested placement)

Step 11

Fully tighten all fasteners according to the "TIGHTENING TORQUE FOR HARDWARE" section of the Installation Manual.

Step 12

Plumb and level entire component. Pour concrete into footing holes. Allow at least 72 hours to cure before using this equipment.
(See Note B)

Step 13

Affix "Top of Surfacing" label to base of posts indicating the top of minimum required protective surfacing depth. (See Note H)

Step 14

Place required protective surfacing under and around Single Post Swings. (See Note H)

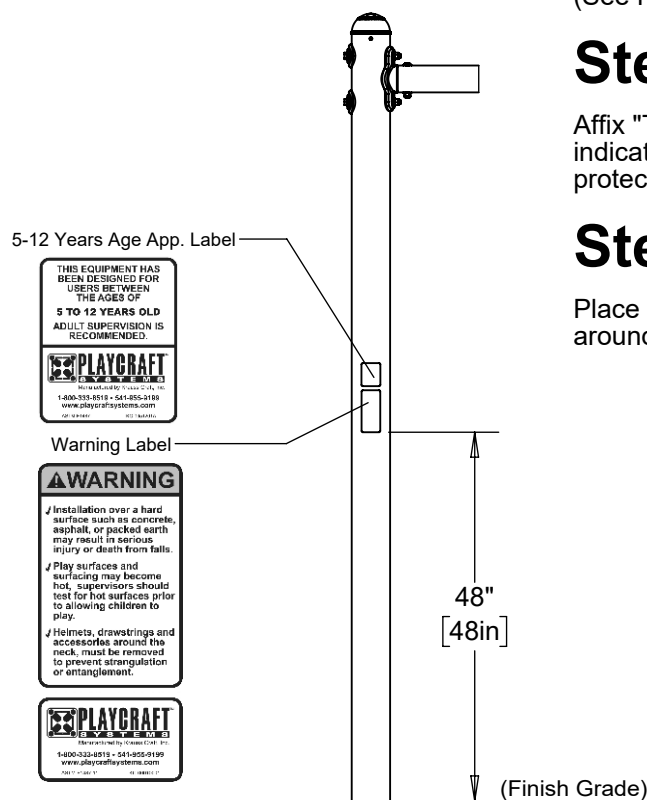

Figure 1.8

Standard Swing Frame Parts Lists

SINGLE BAY		
Part #	Description	QTY
Varies	3.5" Swing Beam	1
GE-0009	Single Post Swing Casting	2
GF-4427	Arch Swing Washer (R5)	4
372010	ASTM 5-12 Years Age App. Label	1
372016	Warning Label	1
372017	Top of Surfacing Label	2
9105182	Bolt Button Head 1/2" x 4-1/4"	2
9123231	Bolt Hex 3/8" x 5-1/2"	2
9125292	Bolt Hex 1/2" x 7"	4
9345002	Washer Flat SAE 1/2"	12
9415132	Nut Lock 1/2"	6
9483602	Nut Hex 3/8"	2

ADDITIONAL BAY		
Part #	DESCRIPTION	QTY
Varies	3.5" Swing Beam	1
GE-0009	Single Post Swing Casting	2
372017	Top of Surfacing Label	1
9105182	Bolt Button Head 1/2" x 4-1/4"	2
9123231	Bolt Hex 3/8" x 5-1/2"	1
9125292	Bolt Hex 1/2" x 7"	2
9345002	Washer Flat SAE 1/2"	8
9415132	Nut Lock 1/2"	4
9483602	Nut Hex 3/8"	1

Standard Swing Frame Assembled Parts Lists

SINGLE BAY		
Part #	Description	QTY
GF-7002	Post Cap R5 Dome	2
Varies	Single Post Swing Post	2
9610012	Rivet 3/16" x 1/2" to 3/4" Pop	4

ADDITIONAL BAY		
Part #	Description	QTY
GF-7002	Post Cap R5 Dome	1
Varies	Single Post Swing Post	1
9610012	Rivet 3/16" x 1/2" to 3/4" Pop	2

Tree Swing Frame Parts Lists

TREE BAY		
Part #	Description	QTY
Varies	3.5" Swing Beam	1
GE-0009	Single Post Swing Casting	2
GF-4427	Arch Swing Washer (R5)	4
JF-0002	Single Post Swing Tree Top Post	2
Varies	Tree Top Assembly (Evergreen or Oak)	2
372010	ASTM 5-12 Years Age App. Label	1
372016	Warning Label	1
372017	Top of Surfacing Label	2
9105182	Bolt Button Head 1/2" x 4-1/4"	2
9123231	Bolt Hex 3/8" x 5-1/2"	2
9125292	Bolt Hex 1/2" x 7"	4
9345002	Washer Flat SAE 1/2"	12
9415132	Nut Lock 1/2"	6
9483602	Nut Hex 3/8"	2

ADDITIONAL TREE BAY		
Part #	DESCRIPTION	QTY
Varies	3.5" Swing Beam	1
GE-0009	Single Post Swing Casting	2
JF-0002	Single Post Swing Tree Top Post	1
Varies	Tree Top Assembly (Evergreen or Oak)	1
372017	Top of Surfacing Label	1
9105182	Bolt Button Head 1/2" x 4-1/4"	2
9123231	Bolt Hex 3/8" x 5-1/2"	1
9125292	Bolt Hex 1/2" x 7"	2
9345002	Washer Flat SAE 1/2"	8
9415132	Nut Lock 1/2"	4
9483602	Nut Hex 3/8"	1

NOTE: Refer to Instructions
R5-1847 Tree Top and
R5-1848 Oak Tree Top

NOTE: All quantities shown are for one unit of each item.



www.playcraftsystems.com
For Customer Service Call
800.333.8519 (U.S.A.) or 541.955.9199 (International)

Rev P
9/17/2025

SINGLE POST SWINGS INSTALLATION INSTRUCTIONS

PC-2181
Page 10 of 11

8' Swing Seat Parts Lists

BELT SEAT		
Part #	DESCRIPTION	QTY
HE-0008-68	7 Ft. Swing Chain (68 Links)	2
313010	Belt Seat	1
451161-SS	Swing Shackle - Stainless Steel	2
471008	Shackle Pendulum Assembly	2

BELT SEAT ANTI WRAP		
Part #	DESCRIPTION	QTY
HE-0008-68	7 Ft. Swing Chain (68 Links)	2
313010	Belt Seat	1
451161-SS	Swing Shackle - Stainless Steel	2
471017	Anti Wrap Collar	2

BUCKET SEAT		
Part #	DESCRIPTION	QTY
HE-0008-49	5 Ft. Swing Chain (49 Links)	2
311010	Bucket Seat	1
451161-SS	Swing Shackle - Stainless Steel	2
471008	Shackle Pendulum Assembly	2

BUCKET SEAT ANTI WRAP		
Part #	DESCRIPTION	QTY
HE-0008-49	5 Ft. Swing Chain (49 Links)	2
311010	Bucket Seat	1
451161-SS	Swing Shackle - Stainless Steel	2
471017	Anti Wrap Collar	2

HALF BUCKET SEAT		
Part #	DESCRIPTION	QTY
HE-0008-49	5 Ft. Swing Chain (49 Links)	2
311010	Bucket Seat	1
451161-SS	Swing Shackle - Stainless Steel	2
471008	Shackle Pendulum Assembly	2

HALF BUCKET SEAT ANTI WRAP		
Part #	DESCRIPTION	QTY
HE-0008-49	5 Ft. Swing Chain (49 Links)	2
311010	Bucket Seat	1
451161-SS	Swing Shackle - Stainless Steel	2
471017	Anti Wrap Collar	2

NOTE: Refer to instructions

PC-131510 for Playshare Swing Seat Upgrade and
PC-131410 for Inclusive Swing Seat Upgrade

NOTE: Chain lengths are adjusted to compensate
for lower height installs.

NOTE: All quantities shown are for one unit of
each item.

10' Swing Seat Parts Lists

BELT SEAT		
Part #	DESCRIPTION	QTY
HE-0008-88	9 Ft. Swing Chain (88 Links)	2
313010	Belt Seat	1
451161-SS	Swing Shackle - Stainless Steel	2
471008	Shackle Pendulum Assembly	2

BELT SEAT ANTI WRAP		
Part #	DESCRIPTION	QTY
HE-0008-88	9 Ft. Swing Chain (88 Links)	2
313010	Belt Seat	1
451161-SS	Swing Shackle - Stainless Steel	2
471017	Anti Wrap Collar	2



www.playcraftsystems.com
For Customer Service Call
800.333.8519 (U.S.A.) or 541.955.9199 (International)

Rev P
9/17/2025

Specifications

8' SINGLE POST SWING POST:

Shall be fabricated using 5" O.D. 11 gauge galvanized steel tubing. The 8' Single Post Swing Post shall have a multi-stage baked-on powder coat finish.

10' SINGLE POST SWING POST:

Shall be fabricated using 5" O.D. 7 gauge galvanized steel tubing. The 10' Single Post Swing Post shall have a multi-stage baked-on powder coat finish.

SINGLE POST SWING TREE TOP POST:

Shall be fabricated using 5" O.D. 11 gauge galvanized steel tubing. The Single Post Swing Tree Top Post shall have a multi-stage baked-on powder coat finish.

SINGLE POST SWING BEAM:

Shall be fabricated using 3.5" O.D. 11 gauge galvanized steel tubing with welded 3/16" thick steel hangers. The Single Post Swing Beam shall have a multi-stage baked-on powder coat finish.

SINGLE POST SWING CASTING:

Shall be cast from a high-strength aluminum alloy. The Single Post Swing Casting shall have a multi-stage baked-on powder coat finish.

POST CAP:

Shall be precision die-cast from a high-strength aluminum alloy. The Post Caps have a multi-stage baked-on powder coat finish.

SWING CHAIN:

Shall be 7mm (1/4") PC Grade 30 chain with a silver shield cold galvanized finish.

SWING SEATS:

Shall be molded from a UV-stabilized flexible rubber compound with slash-proof, reinforced metal inserts.

HARDWARE:

Shall be stainless steel, zinc/nickel plated or galvanized as required to resist rust and corrosion.

Maintenance

Periodically tighten all screws, bolts and nuts. A periodic inspection of all parts is necessary. If a part is broken or worn, replace immediately. For general maintenance please refer to our Playground Maintenance Manual.

