

## IMPORTANT NOTES: Read First

(A) Use liquid thread lock (such as Loctite®) with all threaded hardware. **Important:** Liquid thread lock (prior to curing helps to eliminate the common problem of "thread seizure" in stainless steel hardware by serving as a lubricant during assembly.

(B) Do not pour concrete until the equipment is completely assembled, leveled and plumbed. Concrete must be allowed to cure completely before using the equipment (at least 72 hours).

(C) Use appropriate compliant protective surfacing and adjust footing depths accordingly. See free publication - The Handbook for Public Playground Safety, Publication #325 at [www.CPSC.gov](http://www.CPSC.gov) for the surfacing appropriate for the fall height of the equipment or consult your surfacing supply representative.

(D) All bolt threads protruding beyond the nut must be cut and de-burred until end is smooth to the touch. Sharp edges and/or points of any kind must be eliminated. No more than two threads may be exposed beyond the end of the nut.

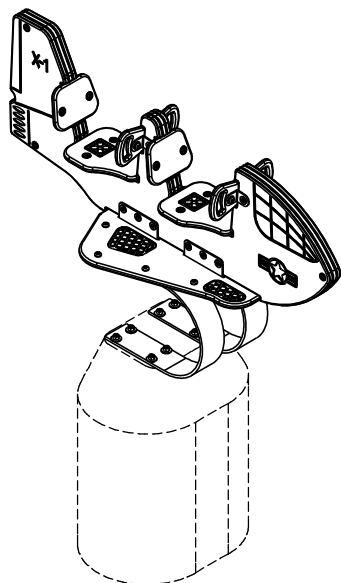

**FIGURE 2**  
Dual Bell X1 Rider

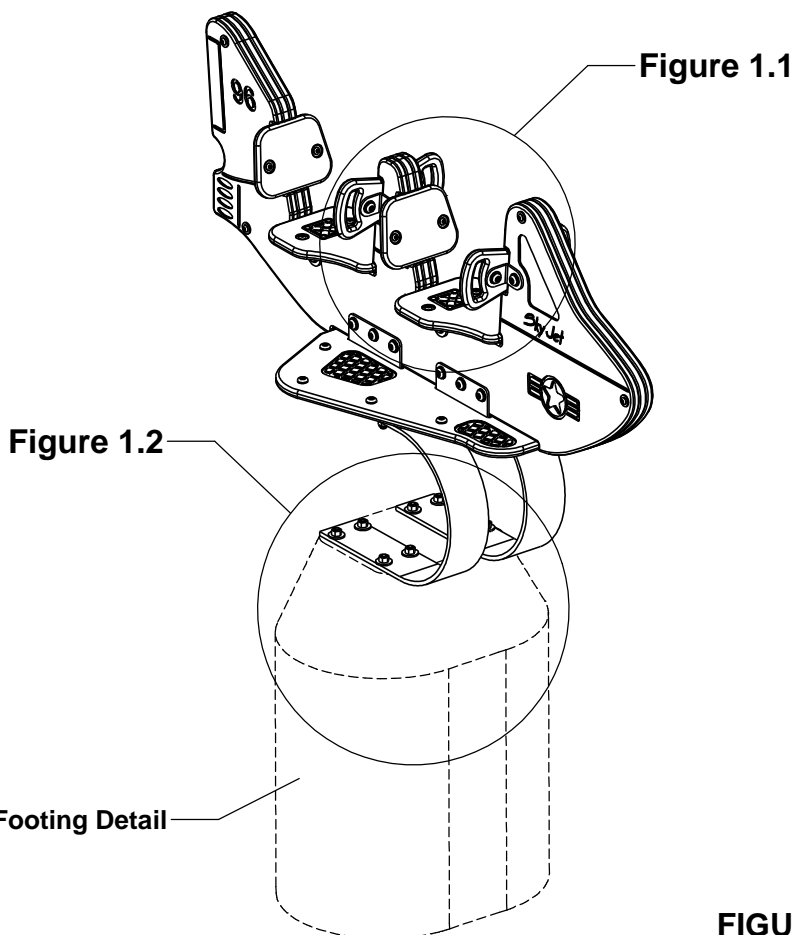

**Figure 1.1**

**Figure 1.2**

See Footing Detail

**FIGURE 1**  
Dual Sky Jet Rider

## Step 1

Dig a 18" x 24" oblong footing hole. Refer to Footing Layout and Footing Detail below for depth and details.

**IMPORTANT:** For areas with soft soil conditions, larger footings may be required.

### Footing Detail

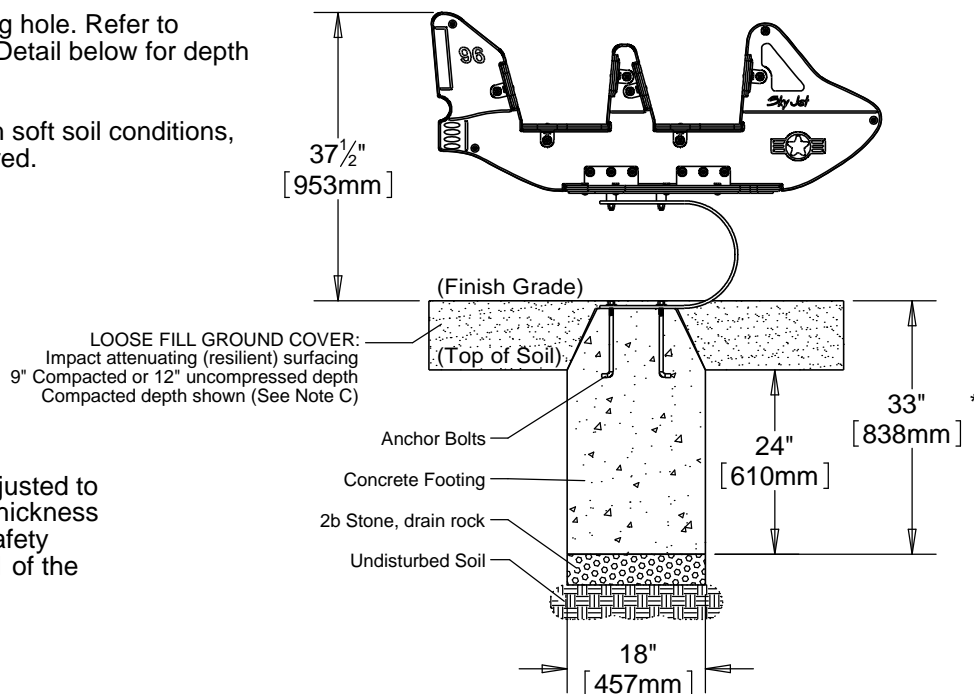

\* Footing depth must be adjusted to compensate for the depth/thickness requirements of selected safety surfacing. See Section 06.1 of the Installation Manual.

### Top View - Footing Layout

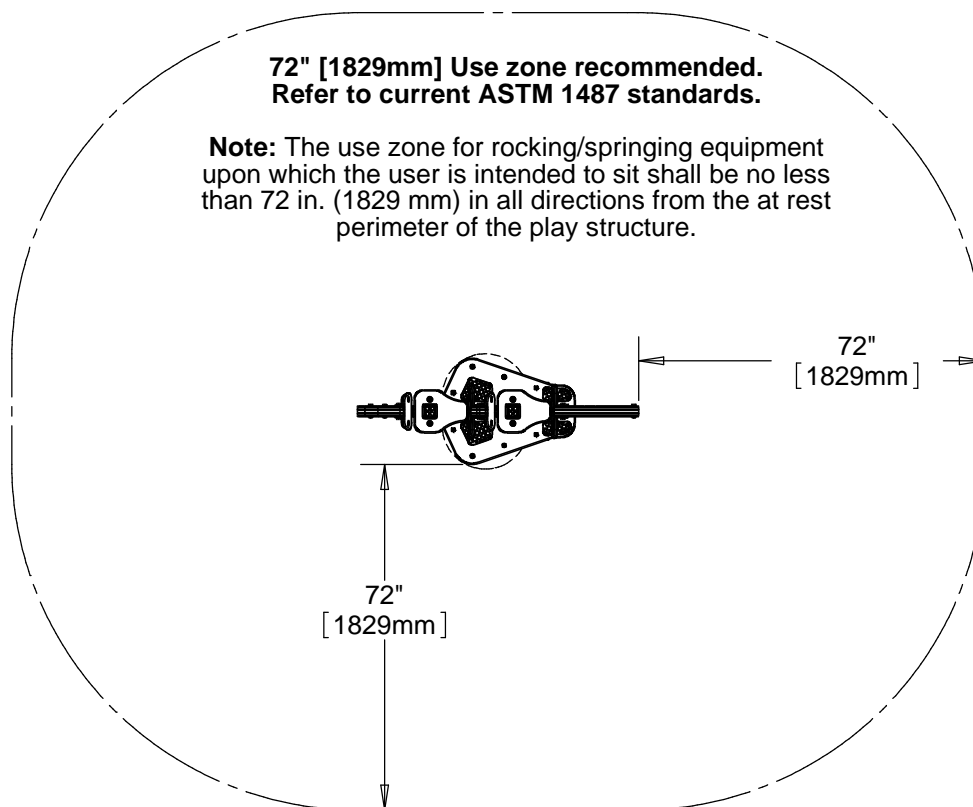

## Step 2

Attach Anchor Bolts to Template. Allow approximately 1" of thread to protrude from the concrete as shown in Figure 3 and Figure 4.

## Step 3

Pour concrete footing and lay template on surface in a level position as shown in Figure 4. Force anchor bolts into concrete. Allow at least 72 hours to cure before proceeding to the next step 10. (See Note B)

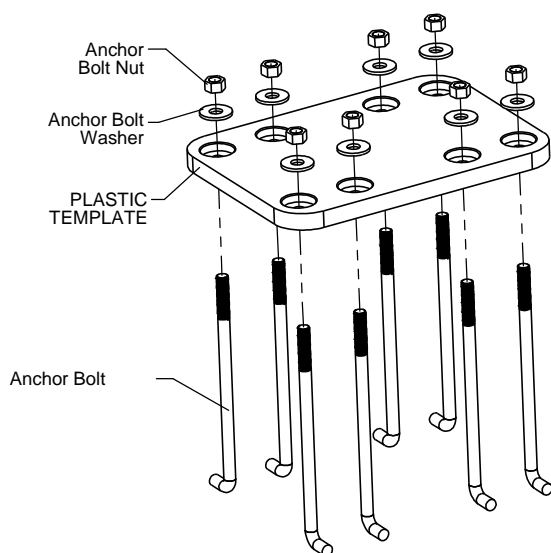

FIGURE 3

## Step 4 (Factory Assembled)

Attach body sides to core as shown in Figure 5. (See Note A)

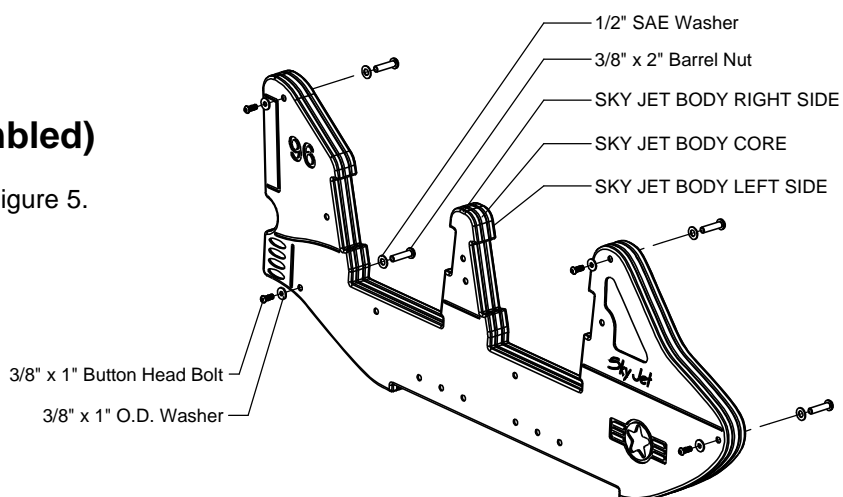

FIGURE 5

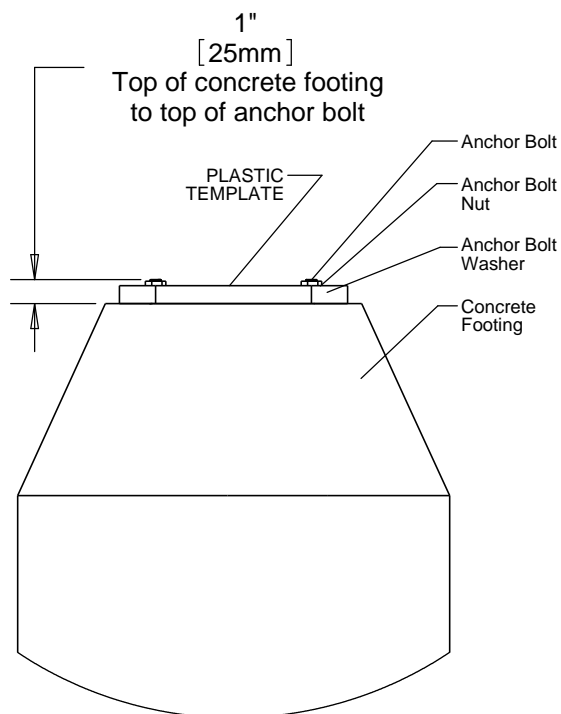

FIGURE 4

## Step 5 (Factory Assembled)

Attach Jet Seats to the jet body as shown in Figure 1.1.  
(See Note A)

## Step 6 (Factory Assembled)

Attach Jet Seat Backs and Jet Handles to the jet body as shown in Figure 6. (See Note A)

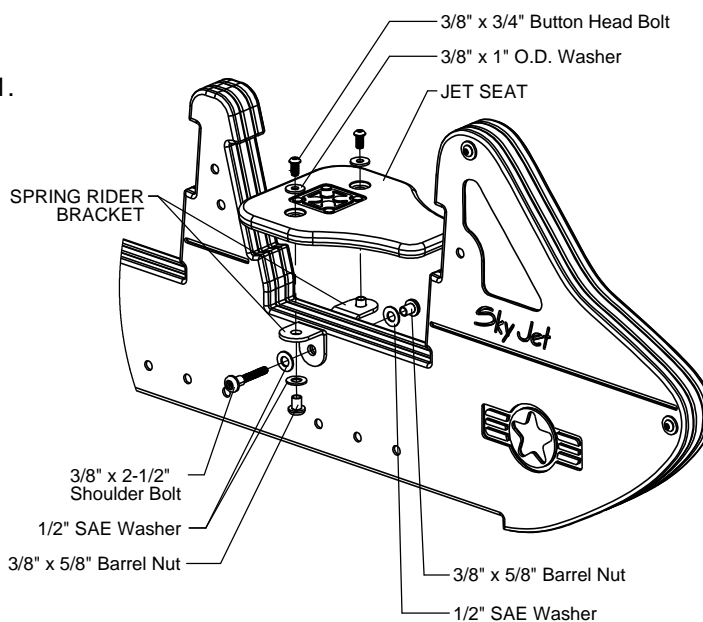

Figure 1.1

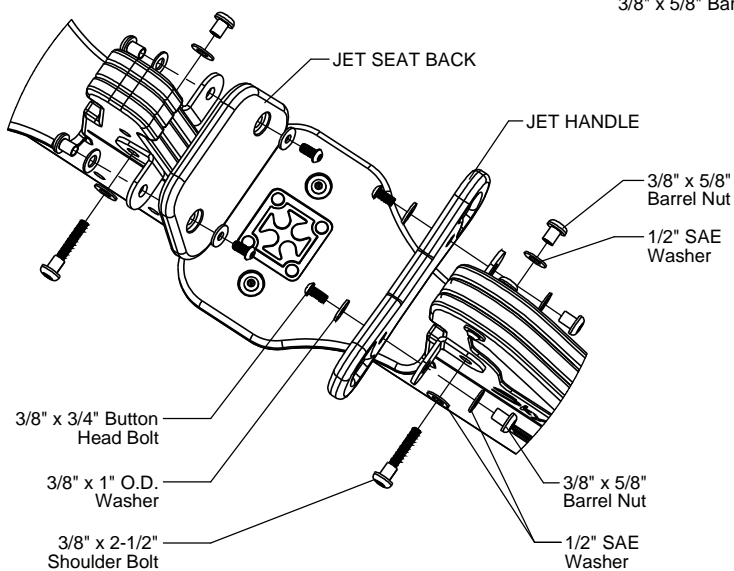

Figure 6

## Step 7 (Factory Assembled)

Attach U-Spring to Base Plate as shown in Figure 7.  
(See Note A)

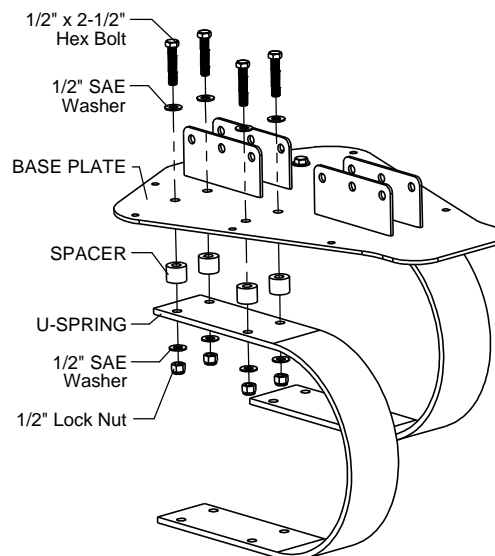

Figure 7

## Step 8 (Factory Assembled)

Attach Jet Wings to the Base Plate as shown in Figure 8.  
(See Note A)

## Step 9 (Factory Assembled)

Attach the jet body to base as shown in Figure 9.  
(See Note A)

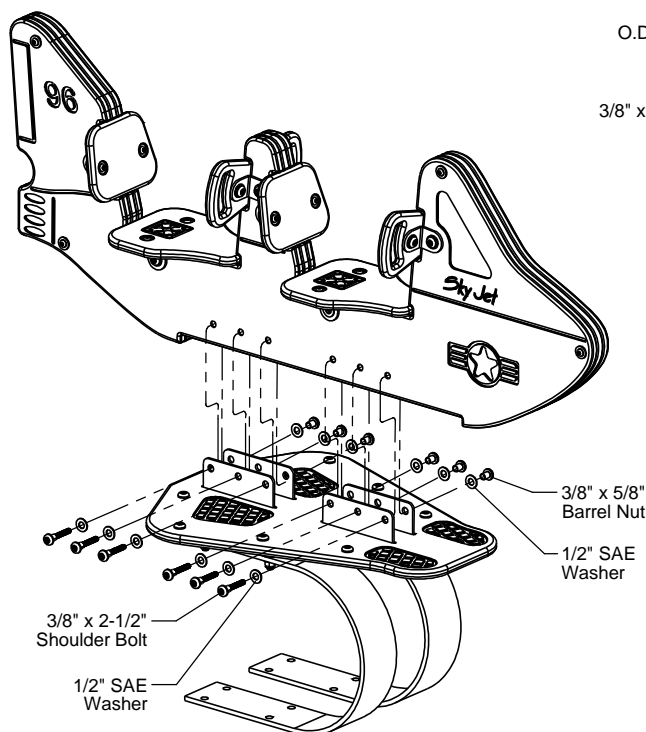

Figure 9

## Step 10

Attach jet to the concrete footing as shown in Figure 1.2. (See Note A and D)

## Step 11

Fully tighten all fasteners according to the "TIGHTENING TORQUE FOR HARDWARE" section of the Installation Manual.

## Step 12

Place appropriate compliant protective surfacing under and around jet spring rider. (See Note C)

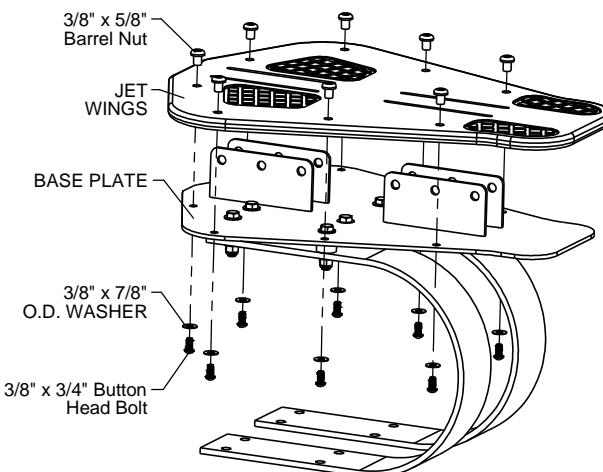

Figure 8

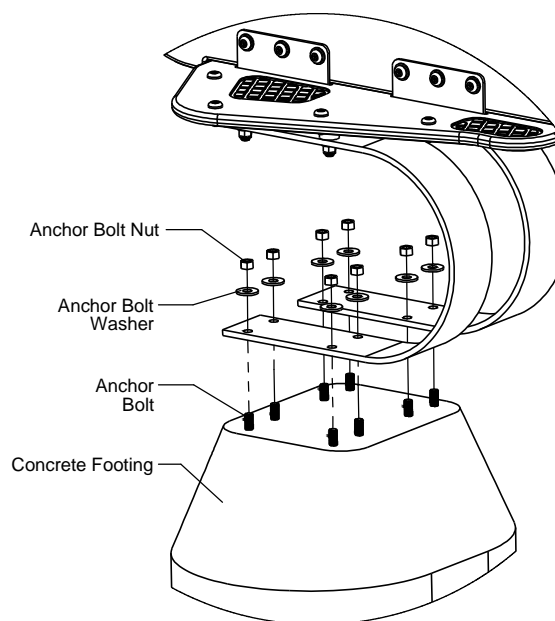

Figure 1.2

## Parts List

PC1394 - Dual Sky Jet Rider		
Part #	Description	Qty.
004889	SkyJet Plastic Template	1
9175393	Bolt Anchor 1/2" x 9-1/2" w/ Washer and Nut	8

PC1393 - Dual Bell X1 Rider		
Part #	Description	Qty.
004889	SkyJet Plastic Template	1
9175393	Bolt Anchor 1/2" x 9-1/2" w/ Washer and Nut	8

## Assembled Parts List

PC1394 - Dual Sky Jet Rider		
Part #	Description	Qty.
004199	U-Spring	2
004466	Spring Rider Bracket	12
004866	1-1/4" O.D. x 9/16" I.D. x 1" Long Spacer	8
004887-C	Sky Jet Body Core	1
004887-L	Sky Jet Body Left Side	1
004887-R	Sky Jet Body Right Side	1
004888	Jet Wings	1
004890	Jet Seat	2
004891	Jet Seat Back	2
004892	Jet Handle	2
FS-PC1393-BASE	C-Spring Rider Base	1
9103032-TR	Bolt Button Head 3/8" x 3/4"	20
9103052-TR	Bolt Button Head 3/8" x 1"	4
9125112	Bolt Hex 1/2" x 2-1/2"	8
9143112-TR	Bolt Shoulder 3/8" x 2-1/2" BH	12
9333002	Washer Flat 3/8" x 1" O.D. x .100" thick	16
9333042	Washer Flat 3/8" x 7/8" O.D.	8
9345002	Washer Flat SAE 1/2"	56
9415132	Nut Lock 1/2"	8
9443022-TR	Nut Barrel 3/8" x 5/8" BH	32
9443092-TR	Nut Barrel 3/8" x 2" BH	4

PC1393 - Dual Bell X1 Rider		
Part #	Description	Qty.
004199	U-Spring	2
004466	Spring Rider Bracket	12
004866	1-1/4" O.D. x 9/16" I.D. x 1" Long Spacer	8
004888	Jet Wings	1
004890	Jet Seat	2
004891	Jet Seat Back	2
004892	Jet Handle	2
004903-C	Bell X Body Core	1
004903-L	Bell X Body Left Side	1
004903-R	Bell X Body Right Side	1
FS-PC1393-BASE	C-Spring Rider Base	1
9103032-TR	Bolt Button Head 3/8" x 3/4"	20
9103052-TR	Bolt Button Head 3/8" x 1"	3
9125112	Bolt Hex 1/2" x 2-1/2"	8
9143112-TR	Bolt Shoulder 3/8" x 2-1/2" BH	12
9333002	Washer Flat 3/8" x 1" O.D. x .100" thick	15
9333042	Washer Flat 3/8" x 7/8" O.D.	8
9345002	Washer Flat SAE 1/2"	55
9415132	Nut Lock 1/2"	8
9443022-TR	Nut Barrel 3/8" x 5/8" BH	32
9443092-TR	Nut Barrel 3/8" x 2" BH	3

## Specifications

### Jet:

Side panels, seats, handles, core panel, wings, and template shall be made from high-density, 3/4" thick, hot extruded polyethylene sheet plastic specially formulated for optimum UV stability and color retention.

### Base Plate:

Shall be fabricated from 3/8" thick sheet steel with welded on 3/16" mounting brackets. The Base Plate has a multi-stage baked on powder coat finish.

### Spacer:

Shall be constructed from 1-1/4" diameter steel. The spacers have a multi-stage baked on powder coat finish.

### U-SPRING:

Shall be formed from 3/8" thick rolled spring steel. The U-Spring has a multi-stage baked on powder coat finish.

### HARDWARE:

Shall be stainless steel, zinc/nickel plated or galvanized as required to resist rust and corrosion.

## Maintenance

Periodically tighten all screws, bolts and nuts. A periodic inspection of all parts is necessary. If a part is broken or worn, replace immediately. For general maintenance please refer to our Playground Maintenance Manual.



Manufactured by Krauss Craft, Inc.  
www.playcraftsystems.com

For Customer Service Call  
800.333.8519 (U.S.A.) or  
541.955.9199 (International)

Rev B