

## IMPORTANT NOTES: Read First

(A) Use liquid thread lock (such as Loctite®) with all threaded hardware. **Important:** Liquid thread lock (prior to curing) helps to eliminate the common problem of "thread seizure" in stainless steel hardware by serving as a lubricant during assembly.

**FIGURE 1**  
Small Chime Panel

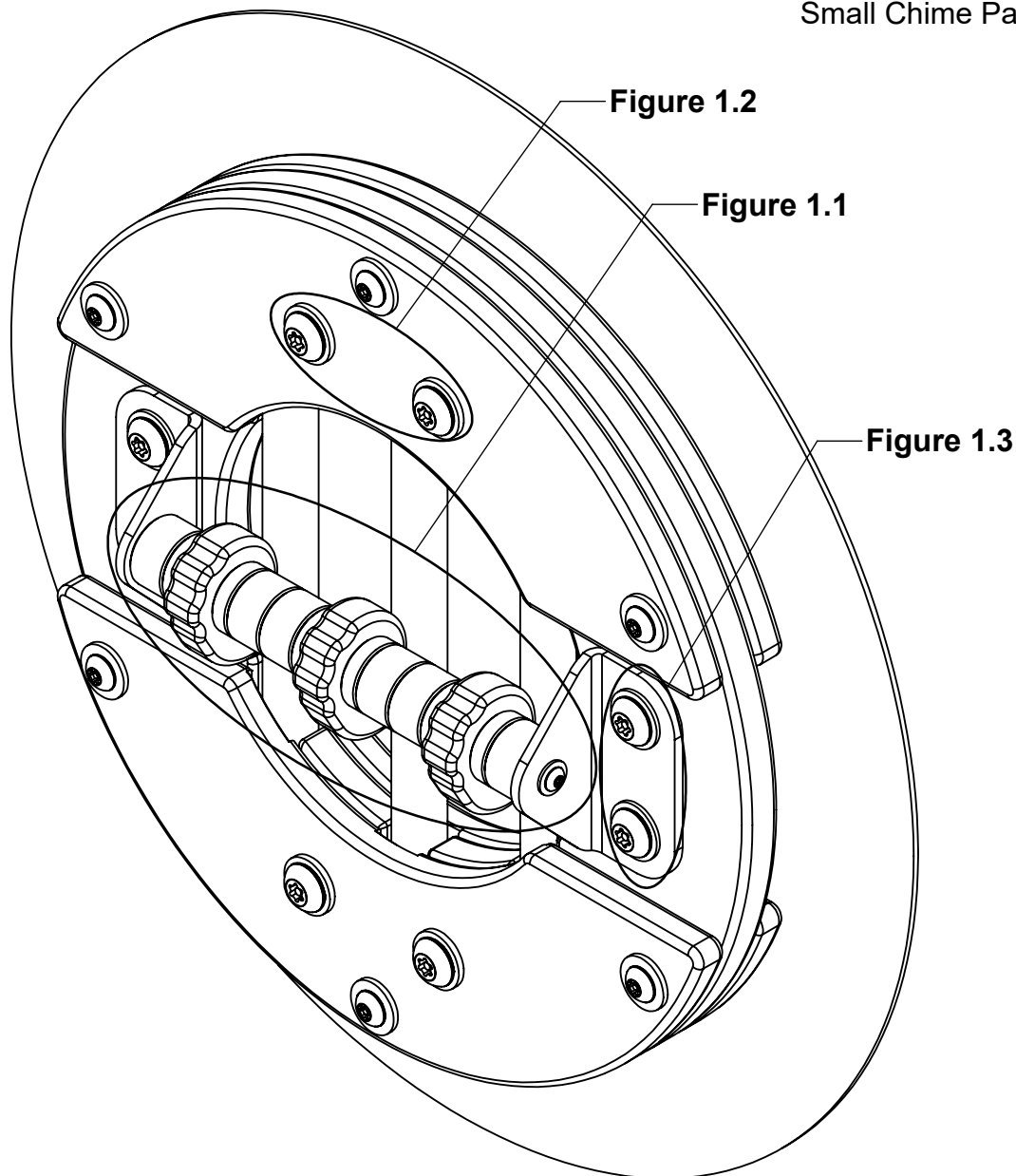

**NOTE:** Small Chime Panel to steel panel shown. Other configurations will vary slightly, but does not affect assembly.

## Step 1 (Factory Assembled)

Place Spacers, Hubs and Hammers onto Pin as indicated and attach Chime Panel Brackets as shown in Figure 1.1. (See Note A).

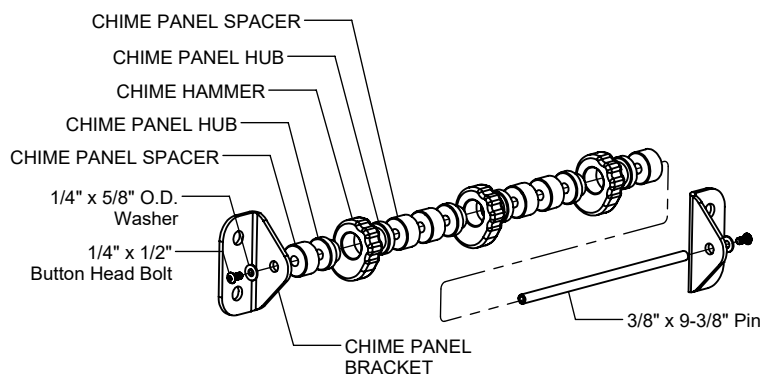

Figure 1.1

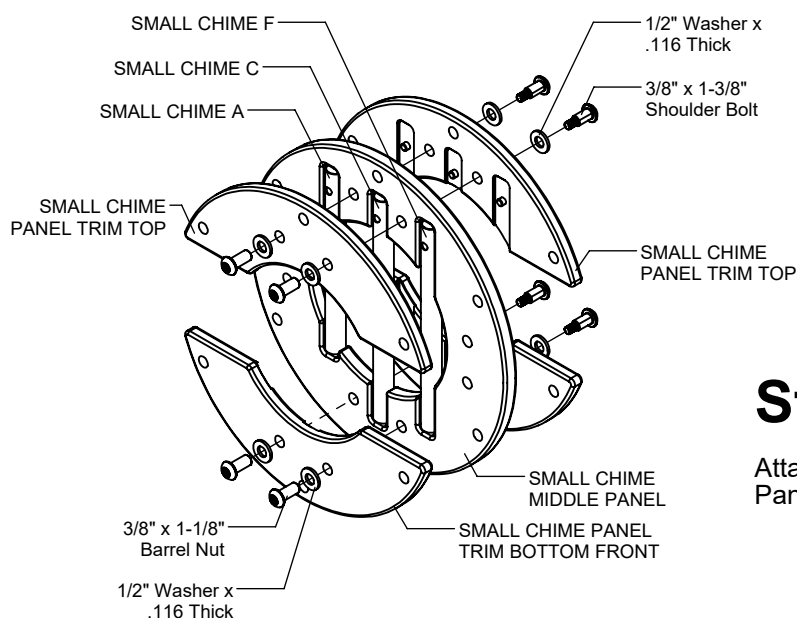

Figure 1.2

## Step 2 (Factory Assembled)

Attach Chimes and Trim to Small Chime Middle Panel as shown in Figure 1.2. (See Note A)

## Step 3 (Factory Assembled)

Attach Chime Panel Brackets to Middle Panel as shown in Figure 1.3. (See Note A).

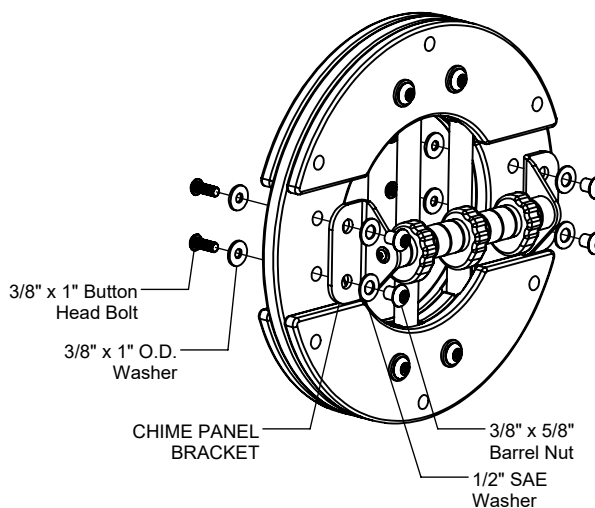
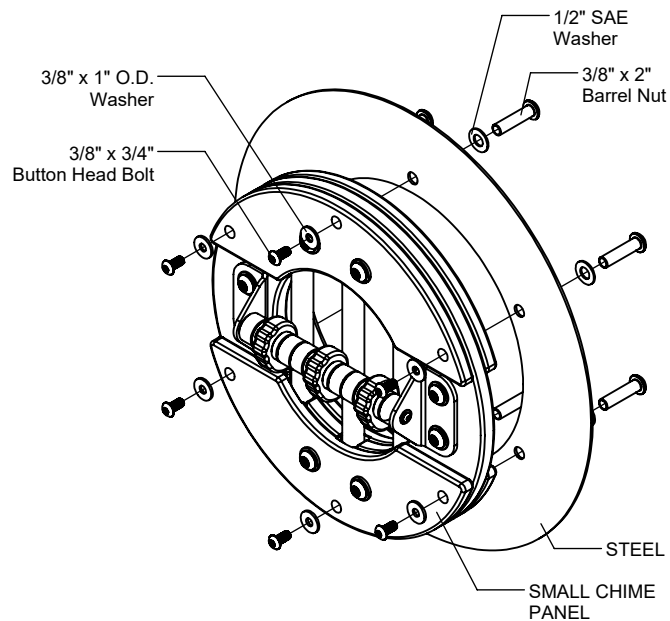

Figure 1.3

## Step 4a

### For Steel Event Panel Only

Attach Small Chime Panel to Steel Event Panel as shown in Figure 2. (See Note A)



**FIGURE 2**

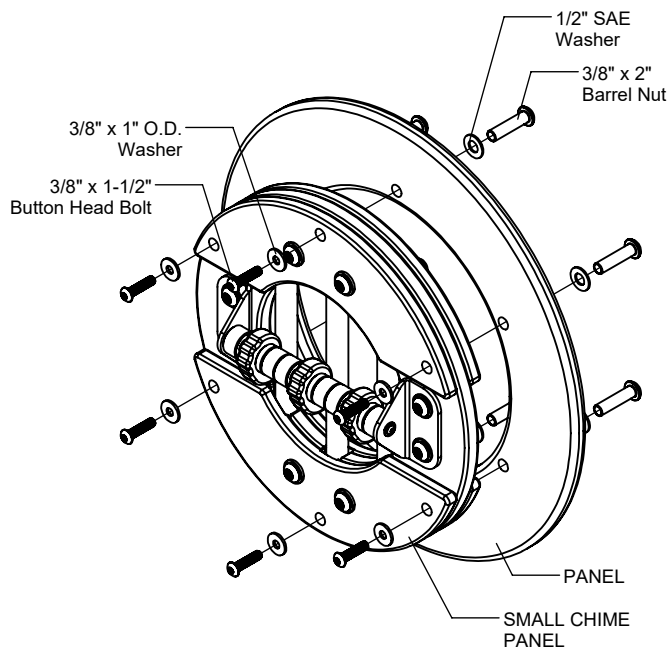

**FIGURE 3**

## Step 4b

### For HDPE Event Panel Only

Attach Small Chime Panel to HDPE Event Panel as shown in Figure 2. (See Note A)

## Step 5

Fully tighten all fasteners according to the "TIGHTENING TORQUE FOR HARDWARE" section of the Installation Manual.

# SMALL CHIME PANEL INSTALLATION INSTRUCTIONS

**1690-CHM**  
Page 4 of 4

## Parts List

STEEL MOUNT		
Part #	DESCRIPTION	QTY
9103032-TR	Bolt Button Head 3/8" x 3/4"	6
9333002	Washer Flat 3/8" x 1" O.D. x .100" thick	6
9345002	Washer Flat SAE 1/2"	6
9443092-TR	Nut Barrel 3/8" x 2" BH	6

HDPE MOUNT		
Part #	DESCRIPTION	QTY
9103072-TR	Bolt Button Head 3/8" x 1-1/2"	6
9333002	Washer Flat 3/8" x 1" O.D. x .100" thick	6
9345002	Washer Flat SAE 1/2"	6
9443092-TR	Nut Barrel 3/8" x 2" BH	6

## Assembled Parts List

Part #	DESCRIPTION	QTY
BE-0835	Chime Panel Bracket	2
EE-0503	Chime Hammer	3
EE-0504-HUB	Chime Panel Hub	6
EE-0504-SPC	Chime Panel Spacer	6
EE-0699-MP	Small Chime Middle Panel	1
EE-0699-TRMBB	Small Chime Panel Trim Bottom Back	1
EE-0699-TRMBF	Small Chime Panel Trim Bottom Front	1
EE-0699-TRMT	Small Chime Panel Trim Top	2
IE-0142	3/8" x 9-3/8" x 1/4-20 Threaded Pin	1
LE-0077-A	Small Chime A	1
LE-0077-C	Small Chime C	1
LE-0077-F	Small Chime F	1
9101012-TR	Bolt Button Head 1/4" x 1/2"	2
9103052-TR	Bolt Button Head 3/8" x 1"	4
9143062-TR	Bolt Shoulder 3/8" x 1-3/8" BH	4
9331002	1/4" x 5/8" x .051 Washer	2
9333002	Washer Flat 3/8" x 1" O.D. x .100" thick	4
9335002	Washer Flat 1/2" (.116" thick)	8
9345002	Washer Flat SAE 1/2"	4
9443022-TR	Nut Barrel 3/8" x 5/8" BH	4
9443052-TR	Nut Barrel 3/8" x 1-1/8" BH	4

## Specifications

### CHIME PANELS & CHIME HAMMER:

Shall be made from high density 3/4" sheet plastic specially formulated for optimum UV stability and color retention.

### CHIME PANEL HUBS & SPACERS:

Shall be made from high density 1" sheet plastic specially formulated for optimum UV stability and color retention.

### CHIMES:

Shall be fabricated using 0.75" Galvanized EMT 18ga and will have a multi-stage baked-on powder coat finish.

### CHIME PANEL BRACKET:

Shall be punched and formed using 3/16" sheet steel and will have a multi-stage baked-on powder coat finish.

### HARDWARE:

Shall be stainless steel, zinc/nickel plated or galvanized as required to resist rust and corrosion.

## Maintenance

Periodically tighten all screws, bolts and nuts. A periodic inspection of all parts is necessary. If a part is broken or worn, replace immediately. For general maintenance please refer to our Playground Maintenance Manual.



www.playcraftsystems.com  
For Customer Service Call  
800.333.8519 (U.S.A.) or 541.955.9199 (International)

**Rev B**  
9/14/2021