

IMPORTANT NOTES: Read First

(A) Use liquid thread lock (such as Loctite®) with all threaded hardware. **Important:** Liquid thread lock (prior to curing) helps to eliminate the common problem of "thread seizure" in stainless steel hardware by serving as a lubricant during assembly.

(B) Refer to Installation Manual for R5-09 Collars and R5-11 Socket Clamps installation instructions.

(C) All gaps created (e.g. between panels, between panel and deck, between panel and roof, etc.) must be less than 3-1/2" [89mm] or greater than 9" [229mm].

(D) An appropriate energy absorbing safety surface is required under and around all playground equipment. Loose fill protective surfacing is shown only as an example for the purpose of this assembly instruction. Other surfacing material may vary in thickness and/or compression depths. See free publication - The Handbook for Public Playground Safety, Publication #325 at www.cpsc.gov for the surfacing appropriate for the fall height of the equipment or consult your surfacing supply representative.

FIGURE 1
Tree House Panel
Assembly

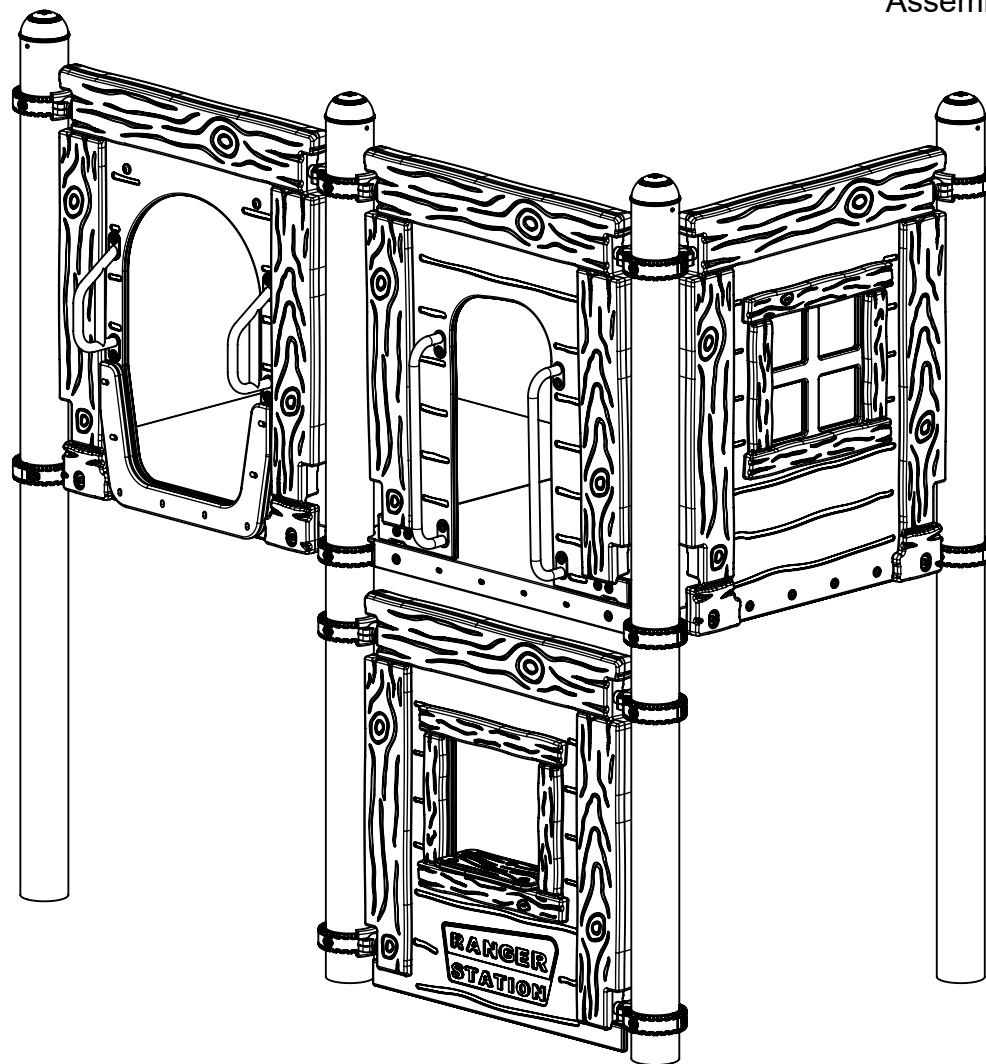

Step 1

Locate and attach collars to posts at heights shown in Elevation View. (See Notes B & C)

* Height shown from top of deck to top of collar.

** Height shown from top of collar to top of collar.

*** Height shown from top of collar to Finish Grade.

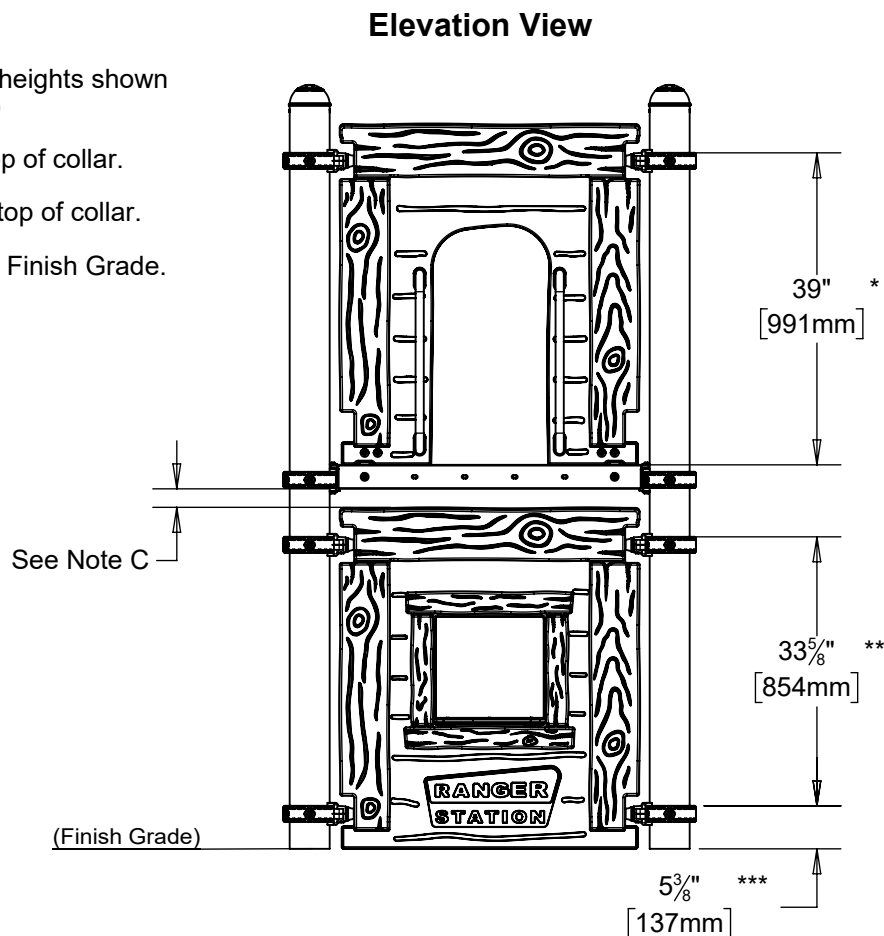

Step 2 (Factory Assembled)

Attach Vent Plug to Panel Trim as shown in Figure 2.

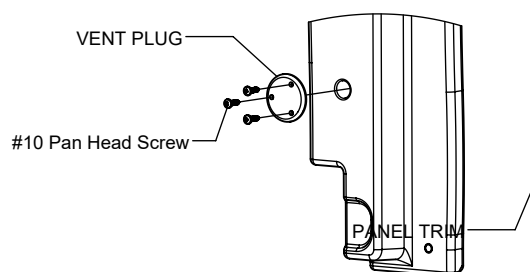

FIGURE 2

CENTER ACCESS PANEL - CUT

Step 1 (Factory Assembled)

Attach Panel Trim to Center Access Panel - Cut as shown in Figure 3. (See Note A)

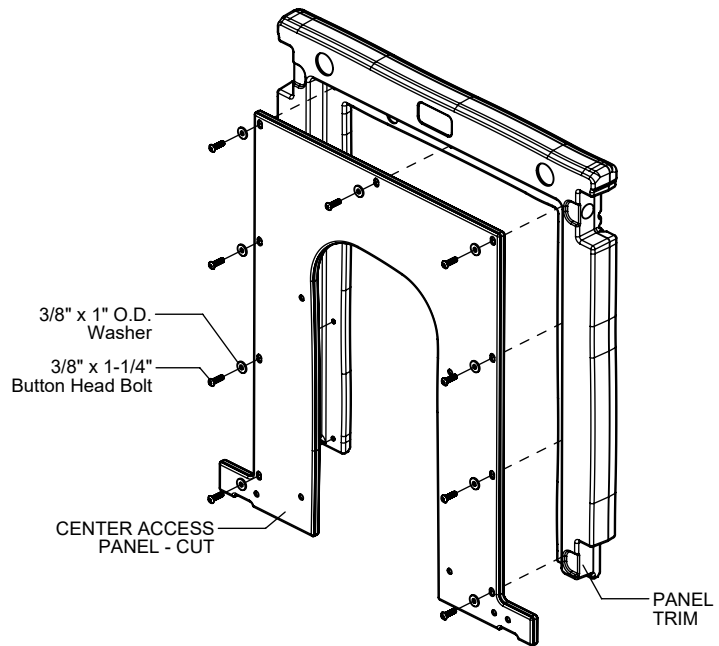

FIGURE 3

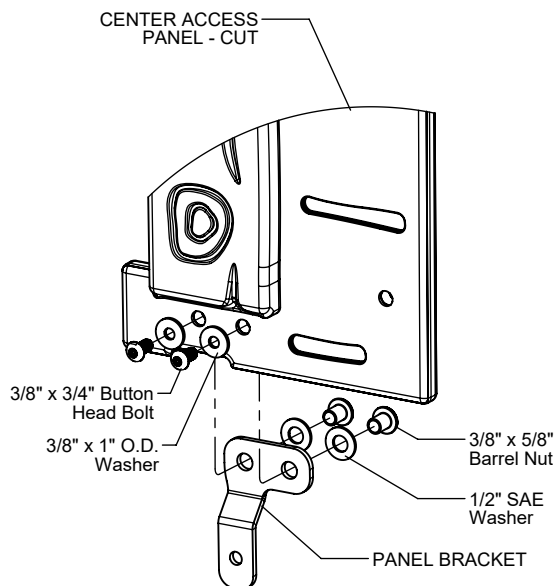

FIGURE 4

Step 2

Attach Panel Brackets to Center Access Panel - Cut as shown in Figure 4. (See Note A)

Step 3

Attach Center Access Panel - Cut to collars as shown in Figure 5. (See Notes A & B)

NOTE: Face flat side of the Lug down.

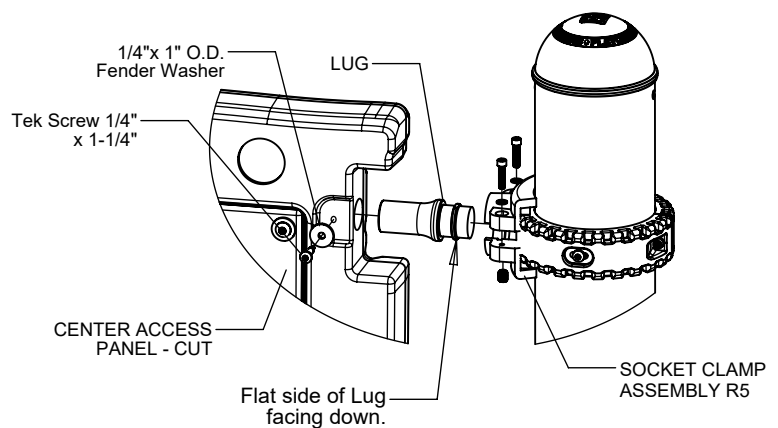

FIGURE 5

Step 4

Attach Panel Brackets to Deck as shown in Figure 6. (See Note A)

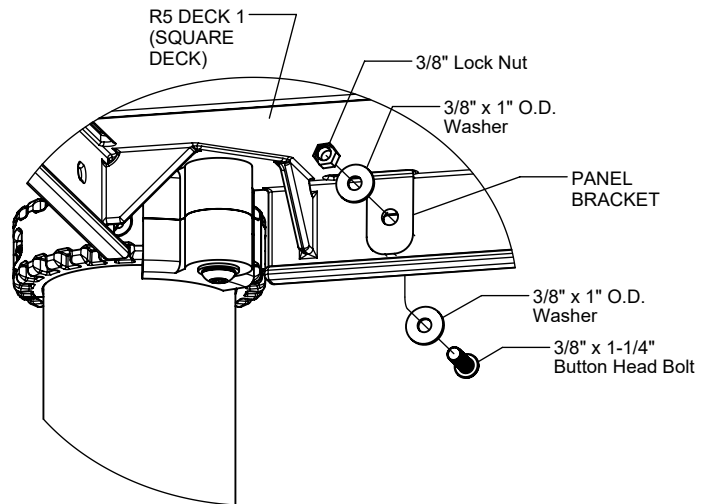

FIGURE 6

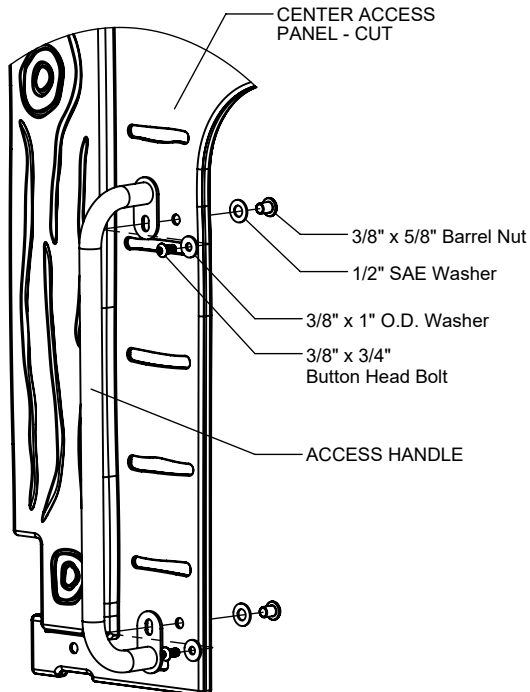

FIGURE 7

Step 5

Attach Access Handles to Center Access Panel - Cut as shown in Figure 7. (See Note A)

DOOR PANEL

Step 1 (Factory Assembled)

Attach Panel Trim to Door Panel as shown in Figure 8.
(See Note A)

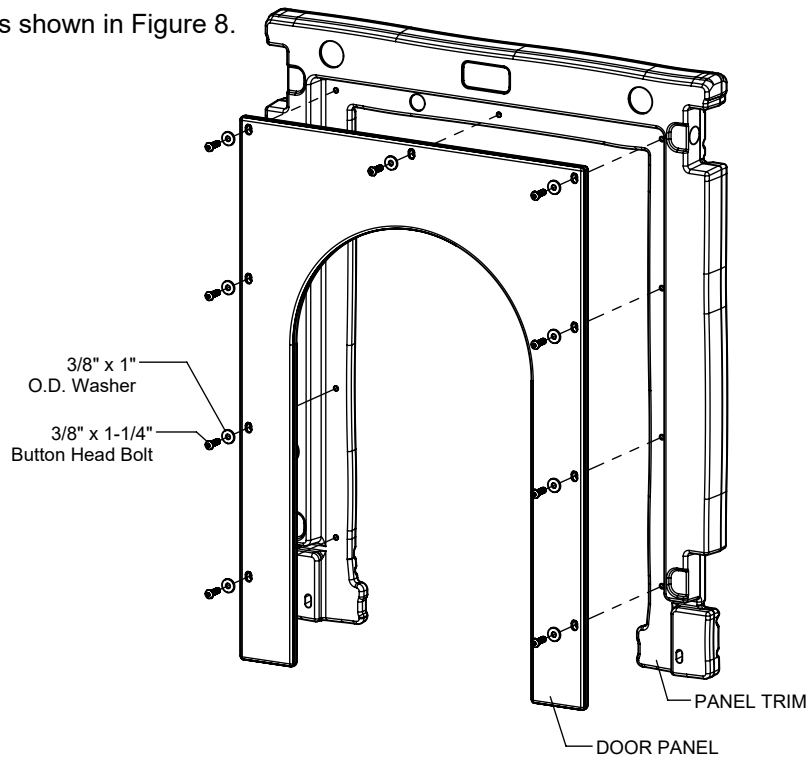

FIGURE 8

Step 2

Attach Door Panel to collars as shown in Figure 9.
(See Notes A & B)

NOTE: Face flat side of the lug down.

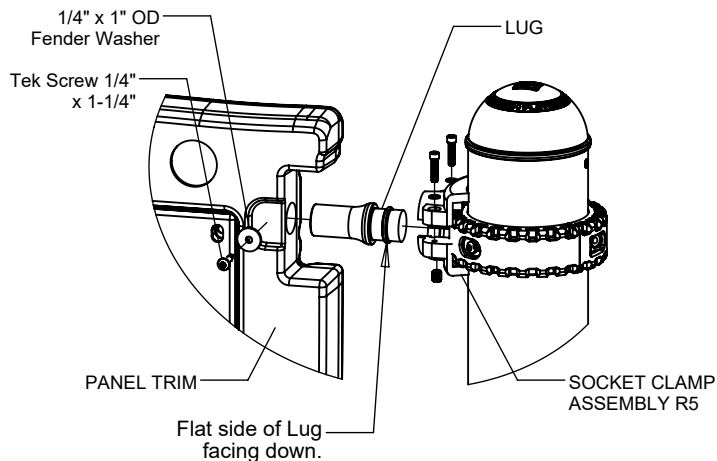
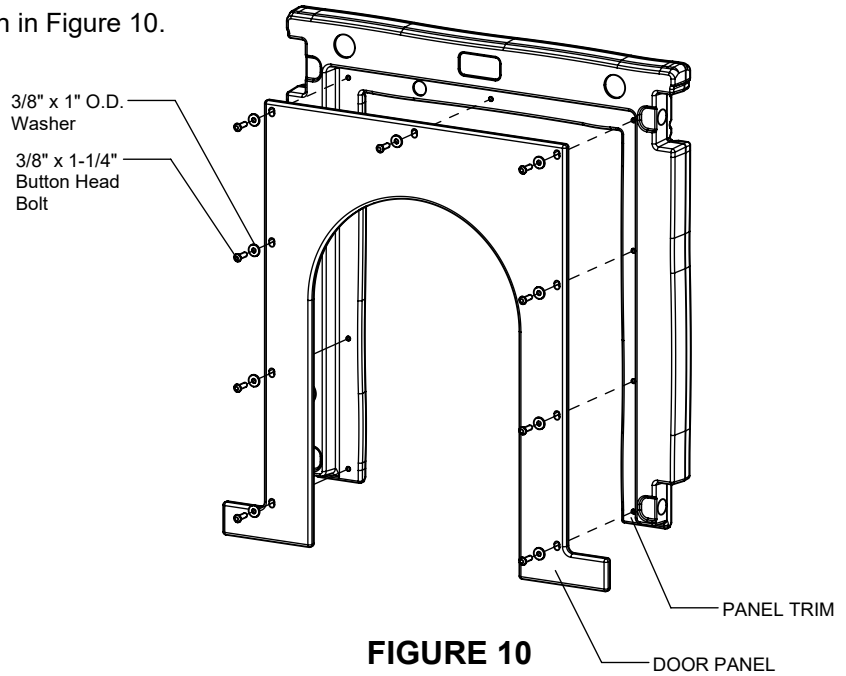

FIGURE 9

DOOR PANEL - CUT

Step 1 (Factory Assembled)

Attach Panel Trim to Door Panel as shown in Figure 10.
(See Note A)



Step 2

Attach Door Panel to collars as shown in Figure 11.
(See Notes A & B)

NOTE: Face flat side of the lug down.

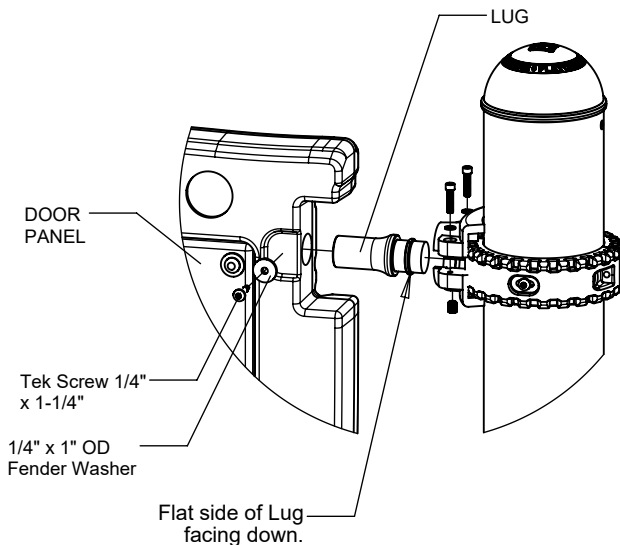

CENTER ACCESS PANEL - FULL & SIDE ACCESS PANEL

Step 1 (Factory Assembled)

Attach Panel Trim to Access Panel as shown in Figure 12. (See Note A)

NOTE: Center Access Panel - Full shown.

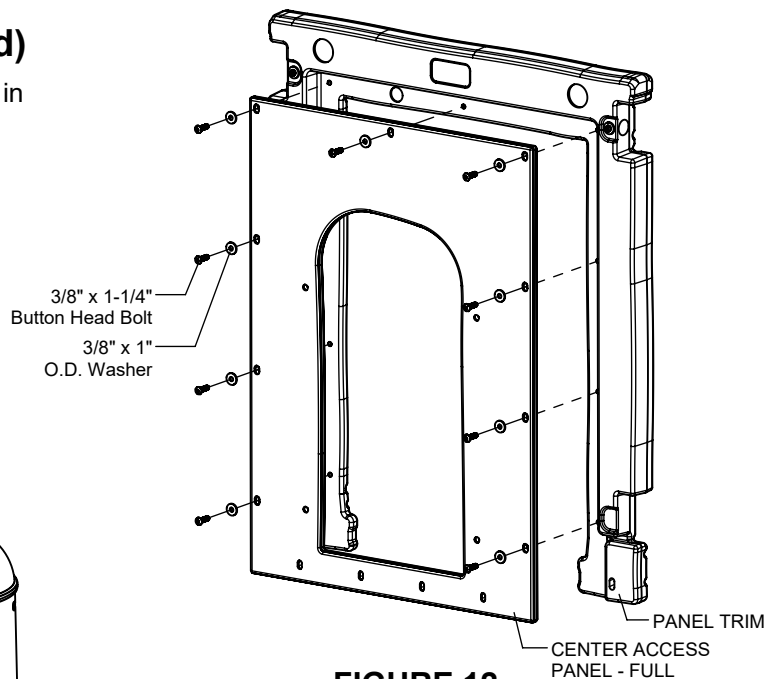

FIGURE 12

Step 2

Attach Access Panel to collars as shown in Figure 13. (See Notes A & B)

NOTE: Center Access Panel - Full shown.

NOTE: Face flat side of the Lug down.

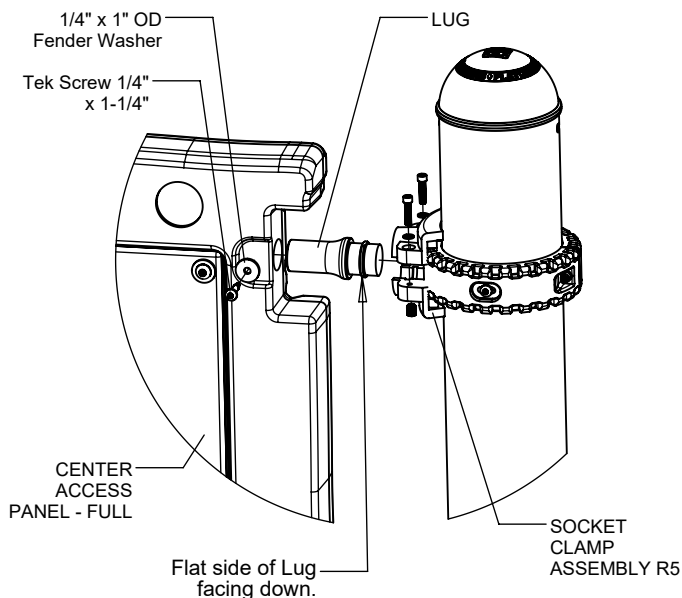

FIGURE 13

Step 3

Attach Access Handles to Access Panel as shown in Figure 14. (See Note A)

NOTE: Center Access Panel - Full shown.

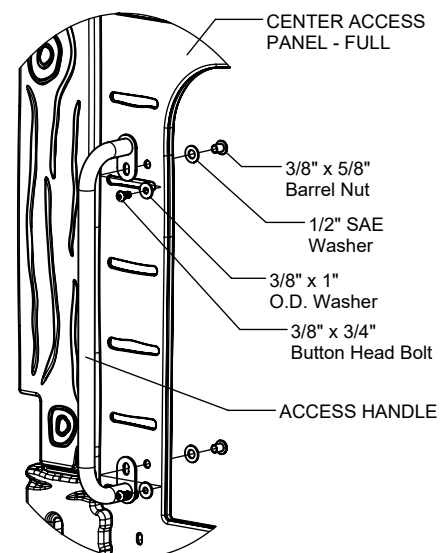

FIGURE 14

Step 4

Refer to appropriate event configuration and attach event to Access Panel as shown in Figure 15.
(See Note A)

NOTE: Use hardware included with Access Panel.

No Event Mount

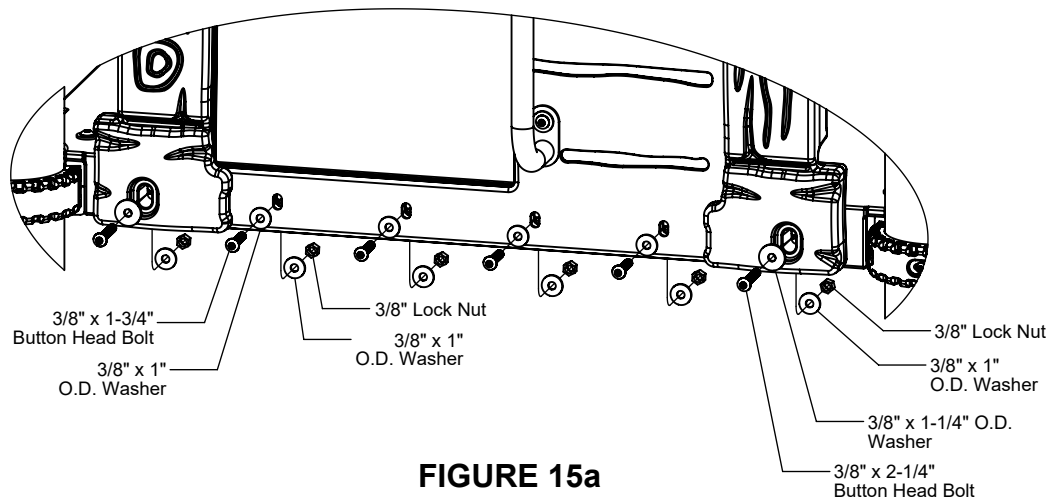

FIGURE 15a

2 Bolt Inside Mount

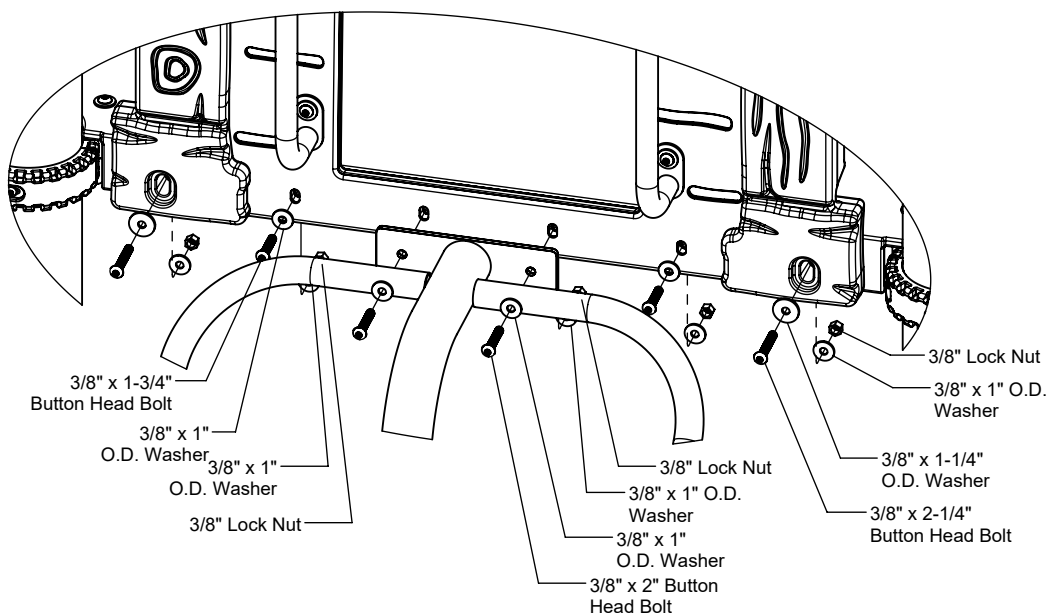

FIGURE 15b

Step 4 (continued)

Refer to appropriate event configuration and attach event to Access Panel as shown in Figure 15.
(See Note A)

NOTE: Use hardware included with Access Panel.

2 Bolt Outside Mount

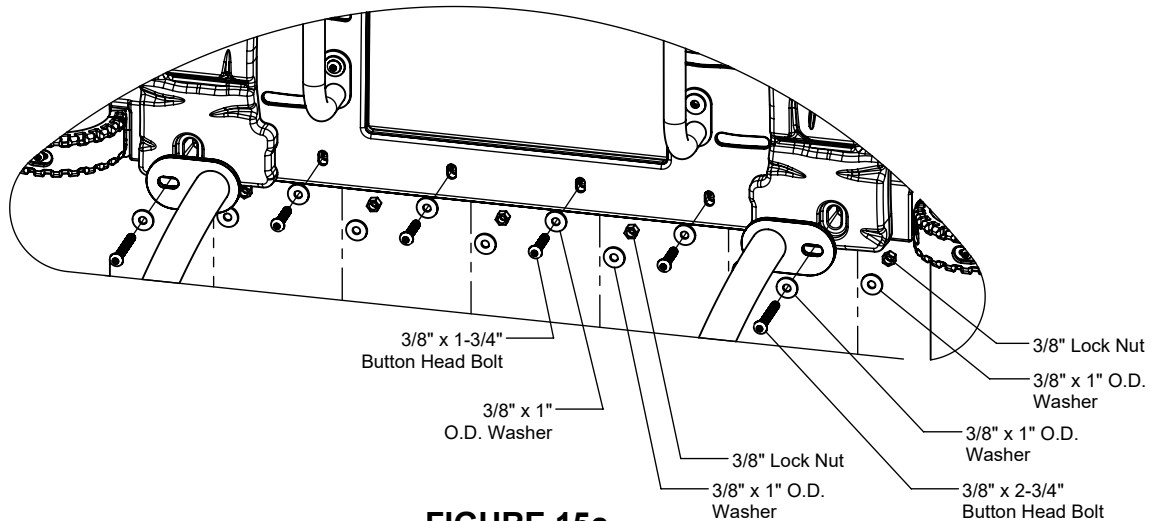

FIGURE 15c

4 Bolt Mount

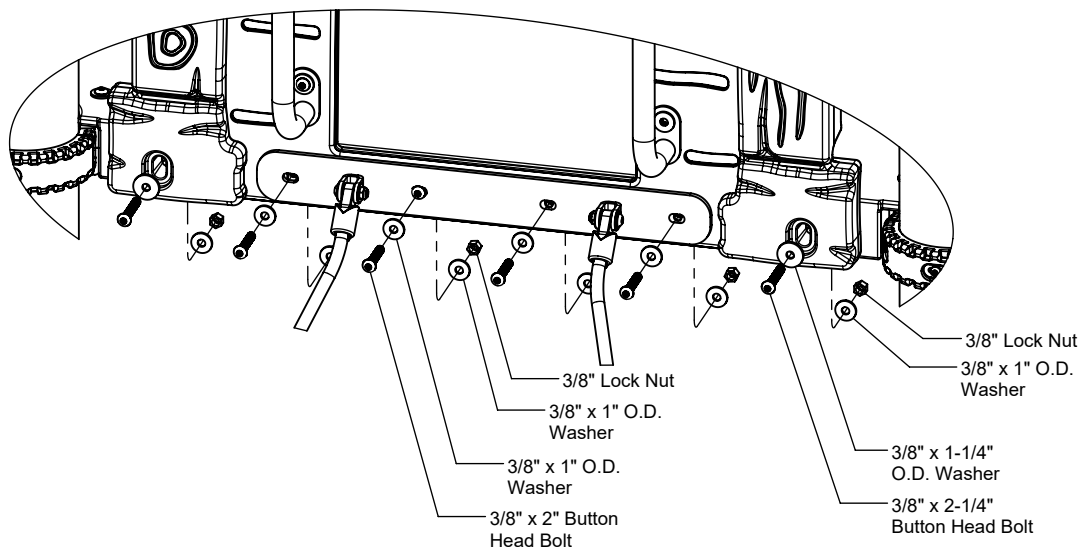

FIGURE 15d

LOG CRAWL TUBE & PANEL

Step 1 (Factory Assembled)

Attach Panel Trim to Log Tube Panel as shown in Figure 16. (See Note A)

NOTE: Assemble Tree House Log Tube Panel Cut as shown in Figure 16 (See Note A)

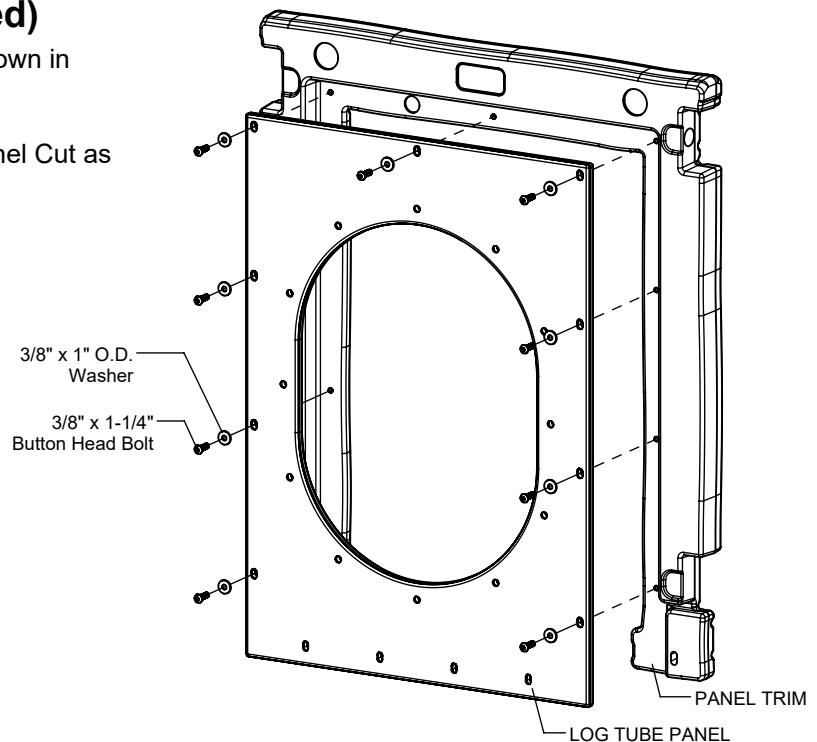

FIGURE 16

Step 2

Attach Log Tube Panel to Collars as shown in Figure 17. (See Notes A & B)

NOTE: Face flat side of the Lug down.

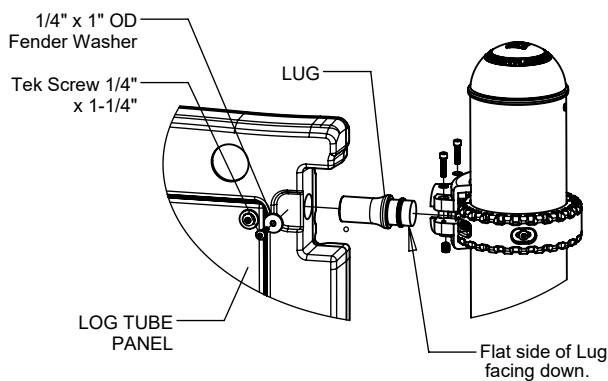

FIGURE 17

Step 3

Attach Log Tube Panel to deck as shown in Figure 18. (See Note A)

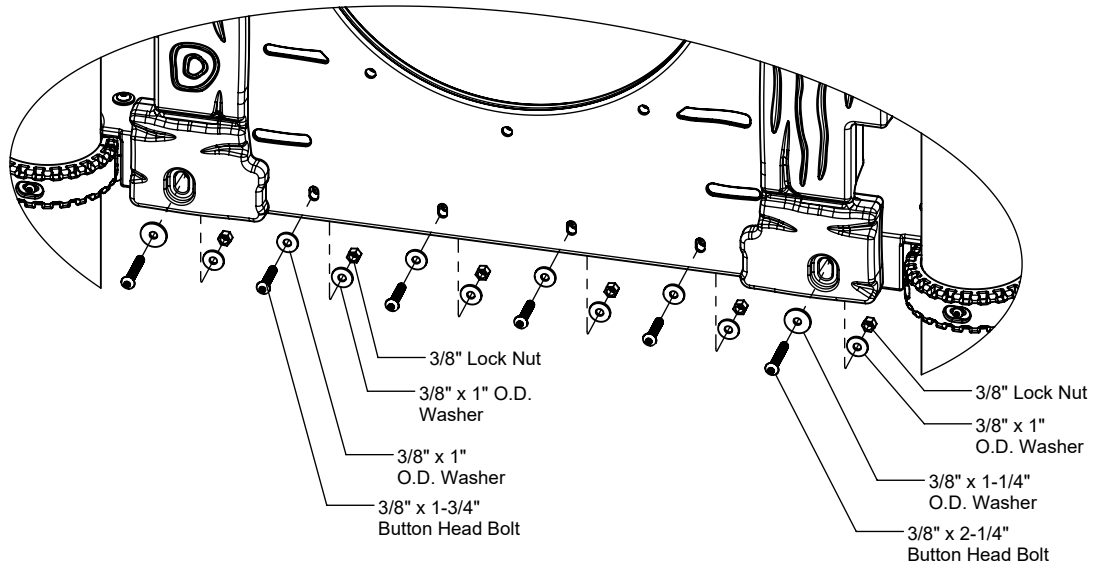

FIGURE 18

Step 4

Attach Crawl Tube to Log Tube Panels as shown in Figure 19. (See Note A)

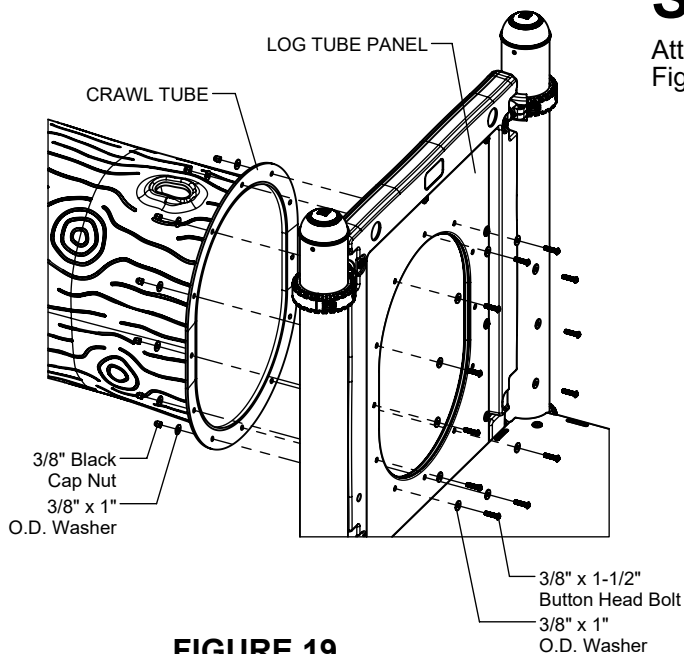

FIGURE 19

RANGER STATION PANEL

Step 1 (Factory Assembled)

Attach Panel and Window Trim to Ranger Station Panel as shown in Figure 20. (See Note A)

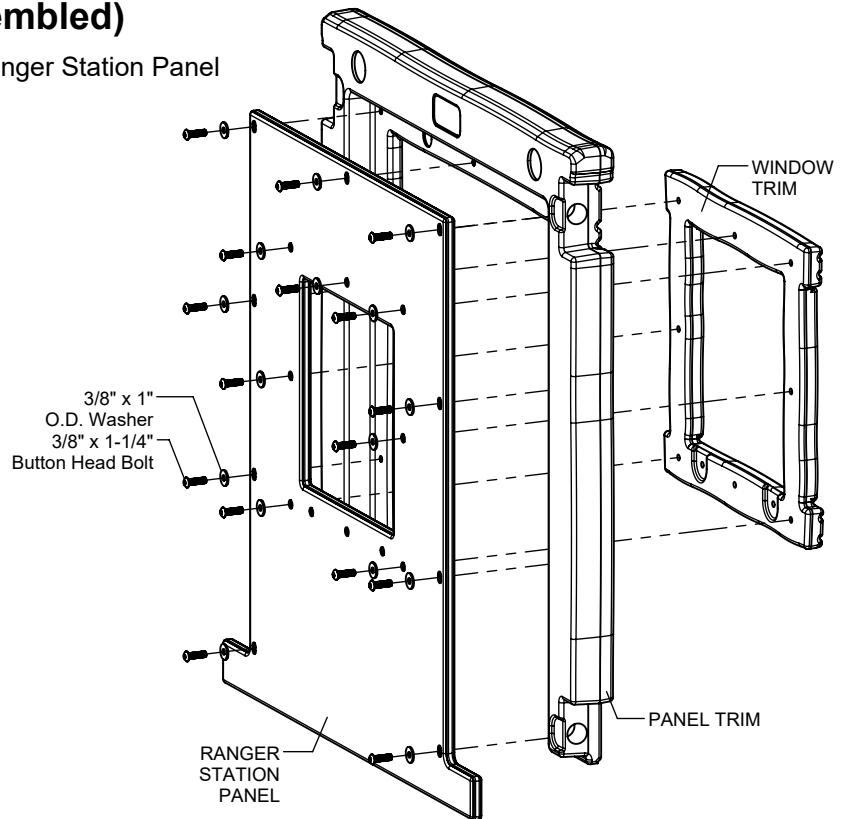

FIGURE 20

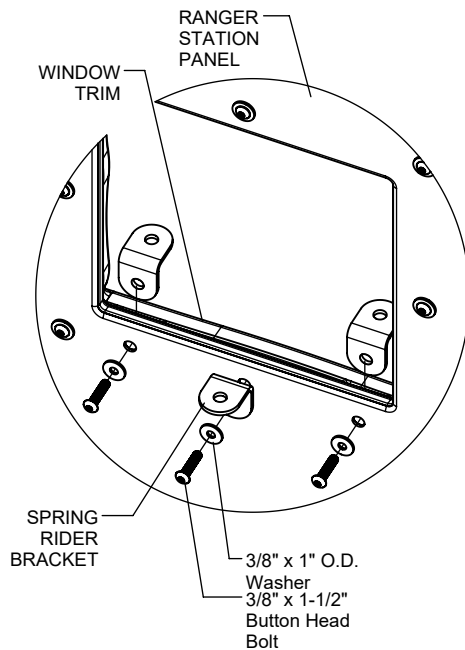

FIGURE 21

Step 2

Attach Spring Rider Brackets to Ranger Station Panel as shown in Figure 21. (See Note A)

Step 3

Attach Ranger Station Counter to Spring Rider Brackets as shown in Figure 22. (See Note A)

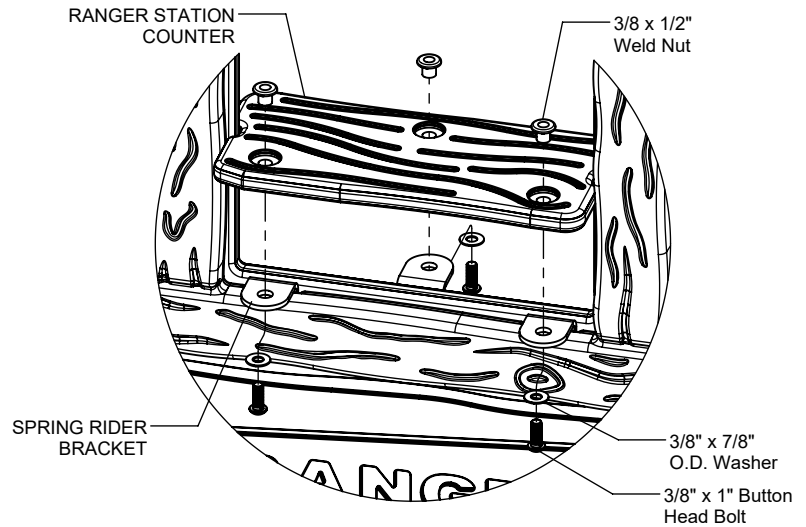

FIGURE 22

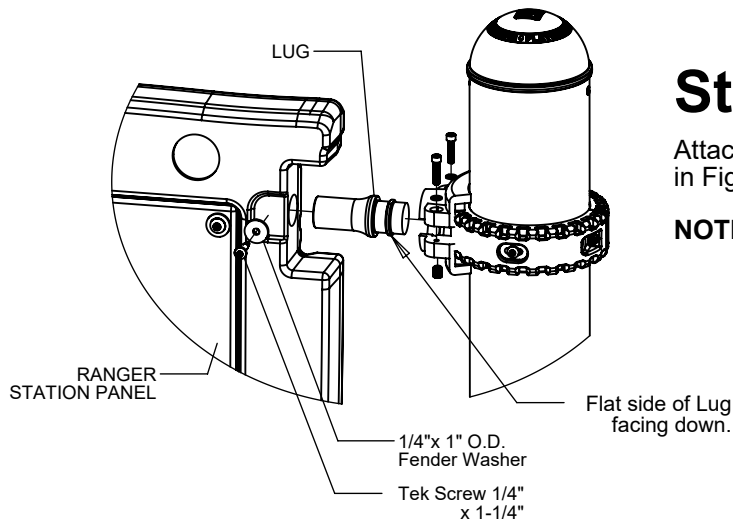

FIGURE 23

Step 4

Attach Ranger Station Panel to collars as shown in Figure 23. (See Notes A & B)

NOTE: Face flat side of the Lug down.

SLIDE PANELS

Step 1 (Factory Assembled)

Attach Panel Trim to Slide Panel as shown in Figure 24.
(See Note A)

NOTE: Twister Slide Panel shown.

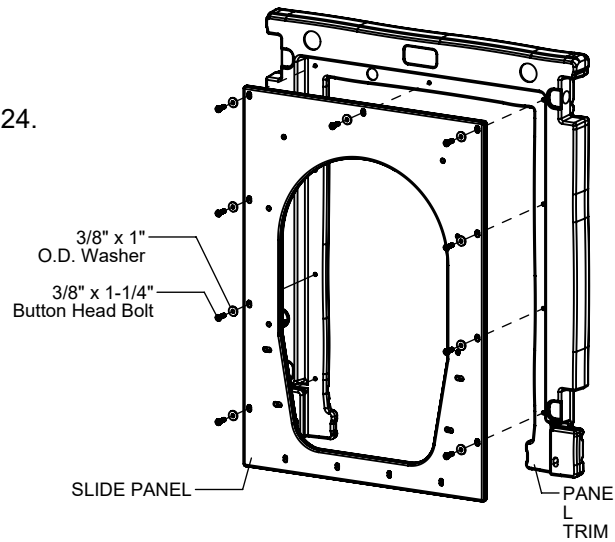

FIGURE 24

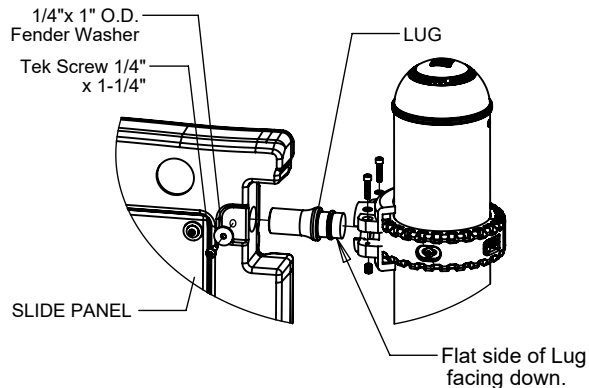

FIGURE 25

Step 2

Attach Slide Panel to collars as shown in Figure 25.
(See Notes A & B)

NOTE: Twister Slide Panel shown.

NOTE: Face flat side of the Lug down.

Step 3

Attach Slide Panel to deck as shown in Figure 26.
(See Note A)

NOTE: Twister Slide Panel shown.

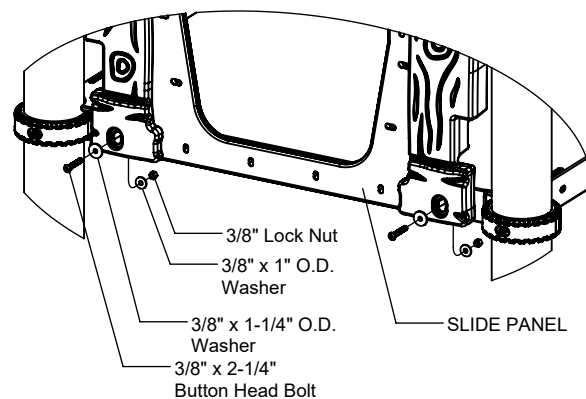

FIGURE 26

Step 4

Attach Access Handle to Slide Panel as shown in Figure 27. (See Note A)

NOTE: Twister Slide Panel shown.

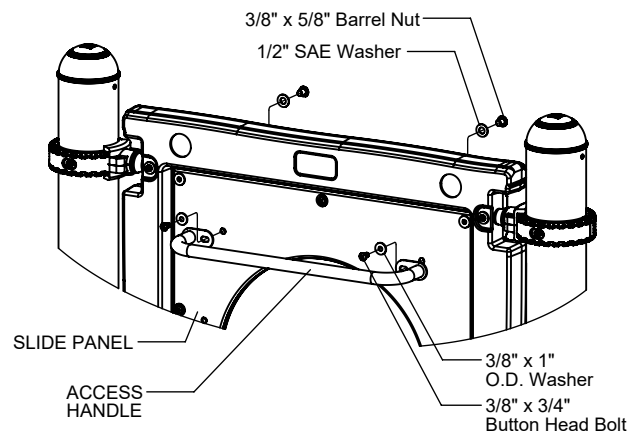

FIGURE 27

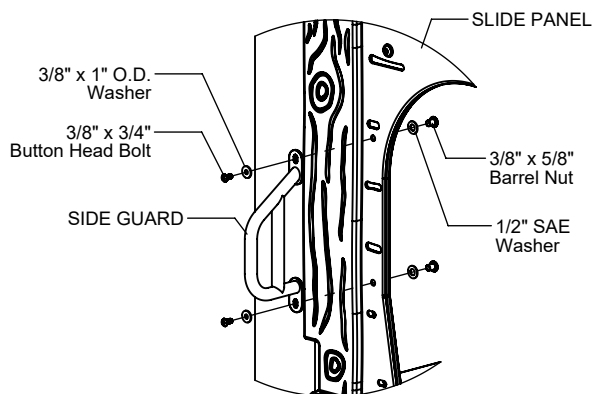

FIGURE 28

Step 5

Attach Side Guards to Slide Panel as shown in Figure 28. (See Note A)

NOTE: Twister Slide Panel shown.

Step 6

For Twister Slide Panel Only

Attach Twister Slide to Slide Panel and deck as shown in Figure 29. (See Note A)

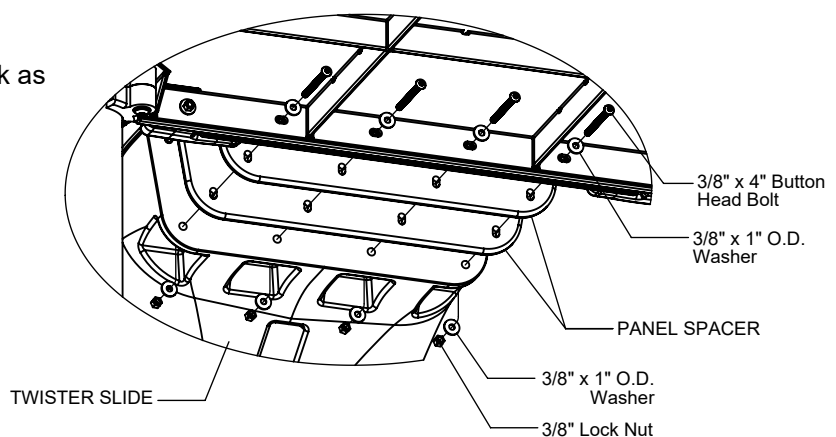

FIGURE 29

Step 7

For Twister Slide Panel Only

Attach Twister Slide to Slide Panel as shown in Figure 30. (See Note A)

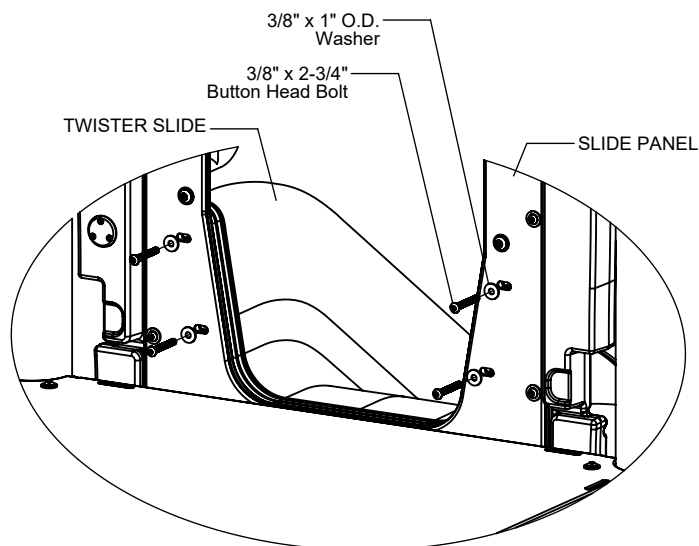

FIGURE 30

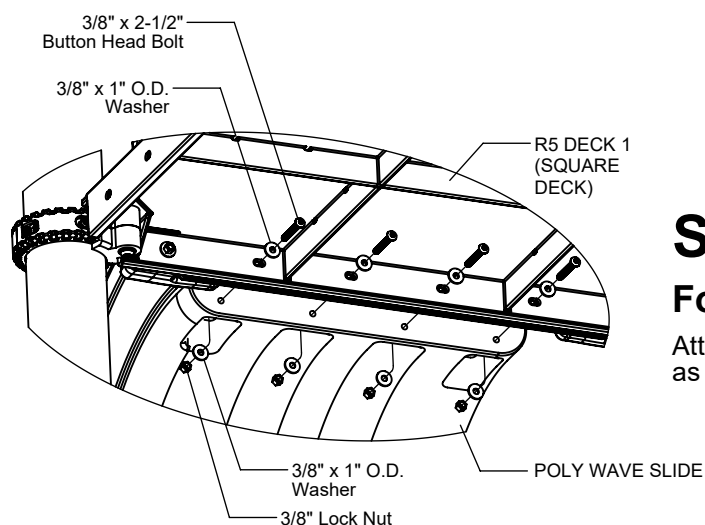

FIGURE 31

Step 8

For Poly Wave Slide Panel Only

Attach Poly Wave Slide to Slide Panel and deck as shown in Figure 31. (See Note A)

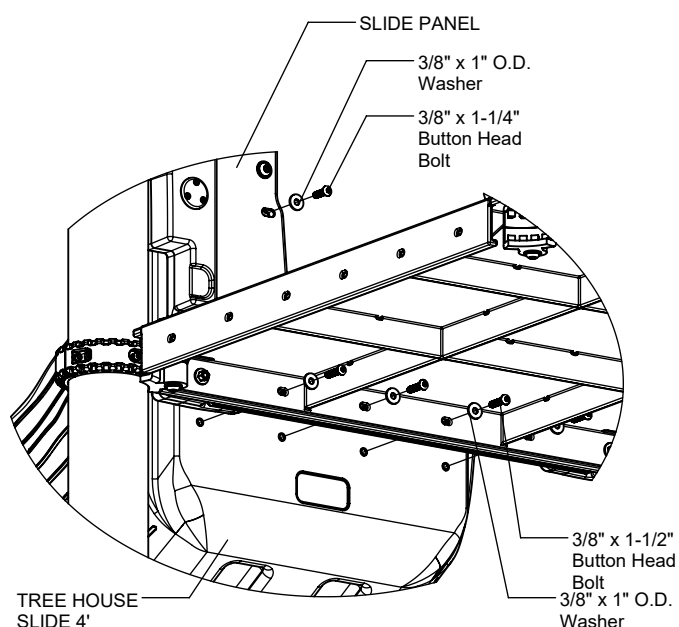

FIGURE 32

Step 9

For Tree House Slide Panel Only

Attach Tree House Slide to Slide Panel and deck as shown in Figure 32. (See Note A)

WINDOW PANEL

Step 1 (Factory Assembled)

Attach Panel Trim and Window Trim to Window Panel as shown in Figure 33. (See Note A)

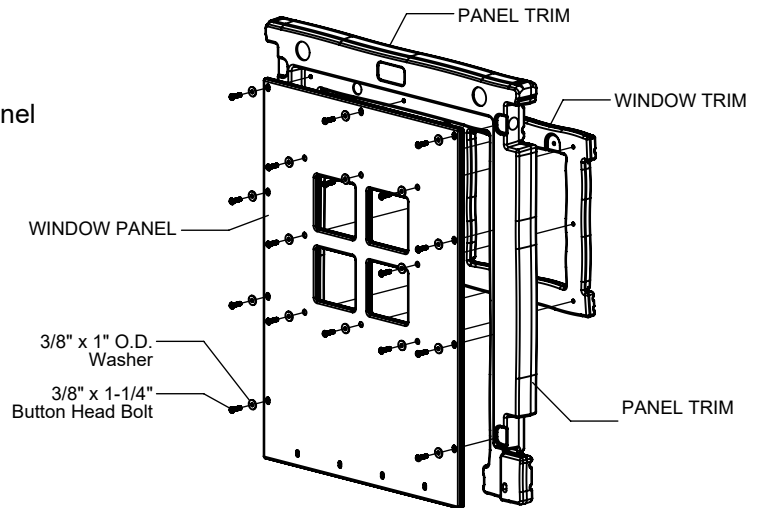

FIGURE 33

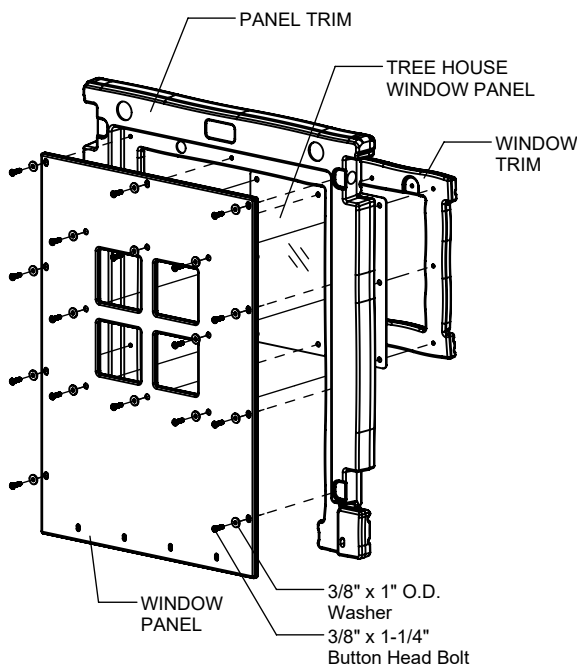

FIGURE 34

Step 2 (Factory Assembled) (Japan Version Only)

Attach Panel Trim and Window Trim to Window Panel as shown in Figure 34. (See Note A)

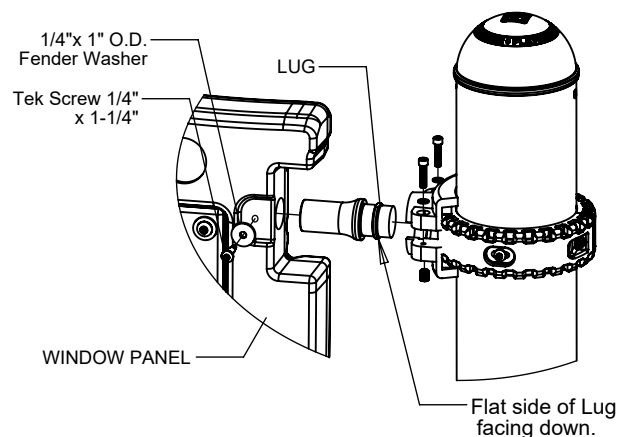

FIGURE 35

Step 3

Attach Window Panel to collars as shown in Figure 35. (See Notes A & B)

NOTE: Face flat side of the Lug down.

Step 4

Attach Window Panel to deck as shown in Figure 36. (See Note A)

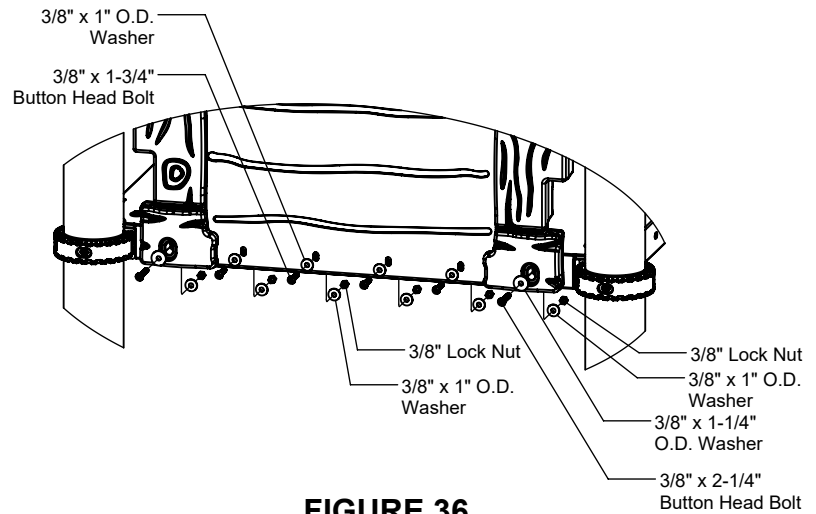

FIGURE 36

TREE HOUSE PANEL ASSEMBLY INSTALLATION INSTRUCTIONS

R5-1677
Page 19 of 22

Center Access Panel - Cut

PARTS LIST		
PART #	DESCRIPTION	QTY
BE-0421-L	Tree House Panel Bracket - Left	1
BE-0421-R	Tree House Panel Bracket - Right	1
FS-1677	TREE HOUSE ACCESS HANDLE	2
HS-1001-R5	Socket Clamp Set R5	2
IE-0029	Roto Panel Lug	2
9103032-TR	Bolt Button Head 3/8" x 3/4"	8
9103062-TR	Bolt Button Head 3/8" x 1-1/4"	2
9271062-TR	1/4" x 1-1/4" Tek Screw	2
9321052-THK	Washer Fender 1/4" x 1" OD x .125" thk	2
9333002	Washer Flat 3/8" x 1" O.D. x .100" thick	12
9345002	Washer Flat SAE 1/2"	8
9413002	Nut Lock 3/8"	2
9443022-TR	Nut Barrel 3/8" x 5/8" BH	8

ASSEMBLED PARTS LIST		
PART #	DESCRIPTION	QTY
DF-0011-CT	Tree House Panel Trim - Cut	1
EE-4867	Geo-Wave Vent Plug	1
EF-0089	Tree House Center Access Panel - Cut	1
9103062-TR	Bolt Button Head 3/8" x 1-1/4"	9
9251032	Screw SQ #10x3/4 DR PH SMS SS	3
9333002	Washer Flat 3/8" x 1" O.D. x .100" thick	9

Side Access Panel

PARTS LIST		
PART #	DESCRIPTION	QTY
FS-1677	TREE HOUSE ACCESS HANDLE	1
HS-1001-R5	Socket Clamp Set R5	2
IE-0029	Roto Panel Lug	2
9103032-TR	Bolt Button Head 3/8" x 3/4"	2
9103082-TR	Bolt Button Head 3/8" x 1-3/4"	4
9103102-TR	Bolt Button Head 3/8" x 2-1/4"	2
9271062-TR	1/4" x 1-1/4" Tek Screw	2
9321052-THK	Washer Fender 1/4" x 1" OD x .125" thk	2
9333002	Washer Flat 3/8" x 1" O.D. x .100" thick	12
9333062	Washer Flat 3/8" x 1-1/4" x .125	2
9345002	Washer Flat SAE 1/2"	2
9413002	Nut Lock 3/8"	6
9443022-TR	Nut Barrel 3/8" x 5/8" BH	2

ASSMEBLED PARTS LIST		
PART #	DESCRIPTION	QTY
DF-0011	Tree House Panel Trim	1
EE-4867	Geo-Wave Vent Plug	1
EF-0090-L	Tree House Left Access Panel	1
9103062-TR	Bolt Button Head 3/8" x 1-1/4"	9
9251032	Screw SQ #10x3/4 DR PH SMS SS	3
9333002	Washer Flat 3/8" x 1" O.D. x .100" thick	9

Center Access Panel - Full

PARTS LIST		
PART #	DESCRIPTION	QTY
FS-1677	TREE HOUSE ACCESS HANDLE	2
HS-1001-R5	Socket Clamp Set R5	2
IE-0029	Roto Panel Lug	2
9103032-TR	Bolt Button Head 3/8" x 3/4"	4
9103082-TR	Bolt Button Head 3/8" x 1-3/4"	4
9103092-TR	Bolt Button Head 3/8" x 2"	4
9103102-TR	Bolt Button Head 3/8" x 2-1/4"	2
9103122-TR	Bolt Button Head 3/8" x 2-3/4"	2
9271062-TR	1/4" x 1-1/4" Tek Screw	2
9321052-THK	Washer Fender 1/4" x 1" OD x .125" thk	2
9333002	Washer Flat 3/8" x 1" O.D. x .100" thick	16
9333062	Washer Flat 3/8" x 1-1/4" x .125	2
9345002	Washer Flat SAE 1/2"	4
9413002	Nut Lock 3/8"	6
9443022-TR	Nut Barrel 3/8" x 5/8" BH	4

ASSEMBLED PARTS LIST		
PART #	DESCRIPTION	QTY
DF-0011	Tree House Panel Trim	1
EE-4867	Geo-Wave Vent Plug	1
EF-0133	Tree House Center Access Panel - Full	1
9103062-TR	Bolt Button Head 3/8" x 1-1/4"	9
9251032	Screw SQ #10x3/4 DR PH SMS SS	3
9333002	Washer Flat 3/8" x 1" O.D. x .100" thick	9

TREE HOUSE PANEL ASSEMBLY INSTALLATION INSTRUCTIONS

R5-1677
Page 20 of 22

Door Panel

PARTS LIST		
PART #	DESCRIPTION	QTY
HS-1001-R5	Socket Clamp Set R5	4
IE-0029	Roto Panel Lug	4
9271062-TR	1/4" x 1-1/4" Tek Screw	4
9321052-THK	Washer Fender 1/4" x 1" OD x .125" thk	4

ASSEMBLED PARTS LIST		
PART #	DESCRIPTION	QTY
DF-0011	Tree House Panel Trim	1
EE-4867	Geo-Wave Vent Plug	1
EF-0221	Tree House Door Panel	1
9103062-TR	Bolt Button Head 3/8" x 1-1/4"	9
9251032	Screw SQ #10x3/4 DR PH SMS SS	3
9333002	Washer Flat 3/8" x 1" O.D. x .100" thick	9

Twister Slide Entry Panel

PARTS LIST		
PART #	DESCRIPTION	QTY
EE-0247	Tree House Twister Panel Spacer	2
FS-1316-CAN	Twister Sit Down Side Guard Canada	2
FS-1677	TREE HOUSE ACCESS HANDLE	1
HS-1001-R5	Socket Clamp Set R5	2
IE-0029	Roto Panel Lug	2
9103032-TR	Bolt Button Head 3/8" x 3/4"	6
9103102-TR	Bolt Button Head 3/8" x 2-1/4"	2
9103122-TR	Bolt Button Head 3/8" x 2-3/4"	4
9103172-TR	Bolt Button Head 3/8" x 4"	4
9271062-TR	1/4" x 1-1/4" Tek Screw	2
9321052-THK	Washer Fender 1/4" x 1" OD x .125" thk	2
9333002	Washer Flat 3/8" x 1" O.D. x .100" thick	20
9333062	Washer Flat 3/8" x 1-1/4" x .125	2
9345002	Washer Flat SAE 1/2"	6
9413002	Nut Lock 3/8"	6
9443022-TR	Nut Barrel 3/8" x 5/8" BH	6

ASSEMBLED PARTS LIST		
PART #	DESCRIPTION	QTY
DF-0011	Tree House Panel Trim	1
EE-4867	Geo-Wave Vent Plug	1
EF-0104-TWS	Tree House Twister Slide Entry Panel	1
9103062-TR	Bolt Button Head 3/8" x 1-1/4"	9
9251032	Screw SQ #10x3/4 DR PH SMS SS	3
9333002	Washer Flat 3/8" x 1" O.D. x .100" thick	9

Door Panel - Cut

PARTS LIST		
PART #	DESCRIPTION	QTY
HS-1001-R5	Socket Clamp Set R5	4
IE-0029	Roto Panel Lug	4
9271062-TR	1/4" x 1-1/4" Tek Screw	4
9321052-THK	Washer Fender 1/4" x 1" OD x .125" thk	4

ASSEMBLED PARTS LIST		
PART #	DESCRIPTION	QTY
DF-0011-CTG	Tree House Panel Trim - Cut Ground	1
EE-4867	Geo-Wave Vent Plug	1
EF-0624	Tree House Door Panel - Cut	1
9103062-TR	Bolt Button Head 3/8" x 1-1/4"	9
9251032	Screw SQ #10x3/4 DR PH SMS SS	3
9333002	Washer Flat 3/8" x 1" O.D. x .100" thick	9

Tree House Slide Entry Panel

PARTS LIST		
PART #	DESCRIPTION	QTY
FS-1304-R35CAN	Sit Down Side Guard R3.5 Canada	2
FS-1677	TREE HOUSE ACCESS HANDLE	1
HS-1001-R5	Socket Clamp Set R5	2
IE-0029	Roto Panel Lug	2
9103032-TR	Bolt Button Head 3/8" x 3/4"	6
9103062-TR	Bolt Button Head 3/8" x 1-1/4"	4
9103072-TR	Bolt Button Head 3/8" x 1-1/2"	4
9103102-TR	Bolt Button Head 3/8" x 2-1/4"	2
9271062-TR	1/4" x 1-1/4" Tek Screw	2
9321052-THK	Washer Fender 1/4" x 1" OD x .125" thk	2
9333002	Washer Flat 3/8" x 1" O.D. x .100" thick	16
9333062	Washer Flat 3/8" x 1-1/4" x .125	2
9345002	Washer Flat SAE 1/2"	6
9413002	Nut Lock 3/8"	2
9443022-TR	Nut Barrel 3/8" x 5/8" BH	6

ASSEMBLED PARTS LIST		
PART #	DESCRIPTION	QTY
DF-0011	Tree House Panel Trim	1
EE-4867	Geo-Wave Vent Plug	1
EF-0104	Tree House Slide Entry Panel	1
9103062-TR	Bolt Button Head 3/8" x 1-1/4"	9
9251032	Screw SQ #10x3/4 DR PH SMS SS	3
9333002	Washer Flat 3/8" x 1" O.D. x .100" thick	9

TREE HOUSE PANEL ASSEMBLY INSTALLATION INSTRUCTIONS

R5-1677
Page 21 of 22

Poly Slide Entry Panel

PARTS LIST		
PART #	DESCRIPTION	QTY
FS-1304-R35CAN	Sit Down Side Guard R3.5 Canada	2
FS-1677	TREE HOUSE ACCESS HANDLE	1
HS-1001-R5	Socket Clamp Set R5	2
IE-0029	Roto Panel Lug	2
9103032-TR	Bolt Button Head 3/8" x 3/4"	6
9103102-TR	Bolt Button Head 3/8" x 2-1/4"	2
9103112-TR	Bolt Button Head 3/8" x 2-1/2"	4
9271062-TR	1/4" x 1-1/4" Tek Screw	2
9321052-THK	Washer Fender 1/4" x 1" OD x .125" thk	2
9333002	Washer Flat 3/8" x 1" O.D. x .100" thick	16
9333062	Washer Flat 3/8" x 1-1/4" x .125	2
9345002	Washer Flat SAE 1/2"	6
9413002	Nut Lock 3/8"	6
9443022-TR	Nut Barrel 3/8" x 5/8" BH	6

ASSEMBLED PARTS LIST		
PART #	DESCRIPTION	QTY
DF-0011	Tree House Panel Trim	1
EE-4867	Geo-Wave Vent Plug	1
EF-0104-SE	Tree House Roto Slide Entry Panel	1
9103062-TR	Bolt Button Head 3/8" x 1-1/4"	9
9251032	Screw SQ #10x3/4 DR PH SMS SS	3
9333002	Washer Flat 3/8" x 1" O.D. x .100" thick	9

Ranger Station Panel

PARTS LIST		
PART #	DESCRIPTION	QTY
BE-4466	Spring Rider Bracket	3
EF-0094	Tree House Ranger Station Counter	1
HS-1001-R5	Socket Clamp Set R5	4
IE-0029	Roto Panel Lug	4
9103052-TR	Bolt Button Head 3/8" x 1"	3
9103072-TR	Bolt Button Head 3/8" x 1-1/2"	3
9271062-TR	1/4" x 1-1/4" Tek Screw	4
9321052-THK	Washer Fender 1/4" x 1" OD x .125" thk	4
9333002	Washer Flat 3/8" x 1" O.D. x .100" thick	3
9333042	Washer Flat 3/8" x 7/8" O.D.	3
9493012	3/8 x 1/2" Weld Nut	3

ASSEMBLED PARTS LIST		
PART #	DESCRIPTION	QTY
DF-0011-CTG	Tree House Panel Trim - Cut Ground	1
DF-0012	Tree House Window Trim	1
EE-4867	Geo-Wave Vent Plug	1
EF-0087	Tree House Ranger Station Panel	1
9103062-TR	Bolt Button Head 3/8" x 1-1/4"	16
9251032	Screw SQ #10x3/4 DR PH SMS SS	3
9333002	Washer Flat 3/8" x 1" O.D. x .100" thick	16

Window Panel

PARTS LIST		
PART #	DESCRIPTION	QTY
HS-1001-R5	Socket Clamp Set R5	2
IE-0029	Roto Panel Lug	2
9103082-TR	Bolt Button Head 3/8" x 1-3/4"	4
9103102-TR	Bolt Button Head 3/8" x 2-1/4"	2
9271062-TR	1/4" x 1-1/4" Tek Screw	2
9321052-THK	Washer Fender 1/4" x 1" OD x .125" thk	2
9333002	Washer Flat 3/8" x 1" O.D. x .100" thick	10
9333062	Washer Flat 3/8" x 1-1/4" x .125	2
9413002	Nut Lock 3/8"	6

ASSEMBLED PARTS LIST		
PART #	DESCRIPTION	QTY
DF-0011	Tree House Panel Trim	1
DF-0012	Tree House Window Trim	1
EE-4867	Geo-Wave Vent Plug	1
EF-0088	Tree House Window Panel	1
9103062-TR	Bolt Button Head 3/8" x 1-1/4"	17
9251032	Screw SQ #10x3/4 DR PH SMS SS	3
9333002	Washer Flat 3/8" x 1" O.D. x .100" thick	17

ASSEMBLED PARTS LIST (JAPAN)		
PART #	DESCRIPTION	QTY
DF-0011	Tree House Panel Trim	1
DF-0012	Tree House Window Trim	1
EE-4867	Geo-Wave Vent Plug	1
EF-0088-JPN	Tree House Window Panel - Japan	1
EF-0588	Tree House Window Panel - Polycarb	1
9103062-TR	Bolt Button Head 3/8" x 1-1/4"	17
9251032	Screw SQ #10x3/4 DR PH SMS SS	3
9333002	Washer Flat 3/8" x 1" O.D. x .100" thick	17

TREE HOUSE PANEL ASSEMBLY

INSTALLATION INSTRUCTIONS

R5-1677
Page 22 of 22

Log Crawl Tube Panel

PARTS LIST		
PART #	DESCRIPTION	QTY
HS-1001-R5	Socket Clamp Set R5	2
IE-0029	Roto Panel Lug	2
9103082-TR	Bolt Button Head 3/8" x 1-3/4"	4
9103102-TR	Bolt Button Head 3/8" x 2-1/4"	2
9271062-TR	1/4" x 1-1/4" Tek Screw	2
9321052-THK	Washer Fender 1/4" x 1" OD x .125" thk	2
9333002	Washer Flat 3/8" x 1" O.D. x .100" thick	10
9333062	Washer Flat 3/8" x 1-1/4" x .125	2
9413002	Nut Lock 3/8"	6

ASSEMBLED PARTS LIST		
PART #	DESCRIPTION	QTY
DF-0011	Tree House Panel Trim	1
EE-4867	Geo-Wave Vent Plug	1
EF-0219	Tree House Log Tube Panel	1
9103062-TR	Bolt Button Head 3/8" x 1-1/4"	9
9251032	Screw SQ #10x3/4 DR PH SMS SS	3
9333002	Washer Flat 3/8" x 1" O.D. x .100" thick	9

Log Crawl Tube Panel Cut

PARTS LIST		
PART #	DESCRIPTION	QTY
HS-1001-R5	Socket Clamp Set R5	4
IE-0029	Roto Panel Lug	4
9271062-TR	1/4" x 1-1/4" Tek Screw	4
9321052-THK	Washer Fender 1/4" x 1" OD x .125" thk	4

ASSEMBLED PARTS LIST		
PART #	DESCRIPTION	QTY
DF-0011-CTG	Tree House Panel Trim - Cut Ground	1
EE-4867	Geo-Wave Vent Plug	1
EF-0219-G	Tree House Log Tube Ground Panel	1
9103062-TR	Bolt Button Head 3/8" x 1-1/4"	9
9251032	Screw SQ #10x3/4 DR PH SMS SS	3
9333002	Washer Flat 3/8" x 1" O.D. x .100" thick	9

Log Crawl Tube

PARTS LIST		
PART #	DESCRIPTION	QTY
DF-0013	Tree House Crawl Tube	1
9103072-TR	Bolt Button Head 3/8" x 1-1/2"	24
9333002	Washer Flat 3/8" x 1" O.D. x .100" thick	48
9413162-BLK	Nut Lock 3/8" w/ Black Cap	24

Specifications

PANELS, SPACER, PLUG & COUNTER:

Shall be made from high density 3/4" sheet plastic specially formulated for optimum UV stability and color retention.

PANEL & SPRING RIDER BRACKET:

Shall be precision laser-cut and formed from 3/16" thick steel and will have a multi-stage baked-on powder coat finish.

TREE HOUSE ACCESS HANDLE & SIT DOWN SIDE GUARD:

Shall be fabricated using 1.029" O.D. 14 gauge steel tubing with welded 10 gauge steel mounting plates and will have a multi-stage baked-on powder coat finish.

TREE HOUSE PANEL TRIM, WINDOW TRIM, & CRAWL TUBE:

Shall be constructed of UV-stabilized, rotationally molded, linear, low density polyethylene with an average wall thickness of .250".

ROTO PANEL LUG:

Shall be machined from high-strength aluminum alloy and will have a multi-stage baked-on powder coat finish.

SOCKET CLAMPS:

Shall be two-part and precision die-cast from a high strength aluminum alloy and will have a multi-stage baked-on powder coat finish.

HARDWARE:

Shall be stainless steel, zinc/nickel plated or galvanized as required to resist rust and corrosion.

Maintenance

Periodically tighten all screws, bolts and nuts. A periodic inspection of all parts is necessary. If a part is broken or worn, replace immediately. For general maintenance please refer to our Playground Maintenance Manual.