

IMPORTANT NOTES: Read First

(A) Use liquid thread lock (such as Loctite) with all threaded hardware. **Important:** Liquid thread lock (prior to curing) helps to eliminate the common problem of "thread seizure" in stainless steel hardware by serving as a lubricant during assembly.

(B) Do not pour concrete until the Equipment is completely assembled, leveled and plumbed. Concrete must be allowed to cure completely before using the equipment (at least 72 hours).

(C) This Assembly requires additional Assembly Pages. See also Assembly Page R5-09 Collars and R5-11 Socket Clamps.

(D) When installing this assembly, make sure that the top of the upper collar is 8" below the seam between the post and post cap. The Lower Collar is 6" below the Upper Collar. See Elevation.

(E) Use appropriate compliant protective surfacing and adjust footing depths accordingly. See free publication - The Handbook for Public Playground Safety, Publication #325 at www.CPSC.gov for the surfacing appropriate for the fall height of the equipment or consult you surfacing supply representative.

Assembly View

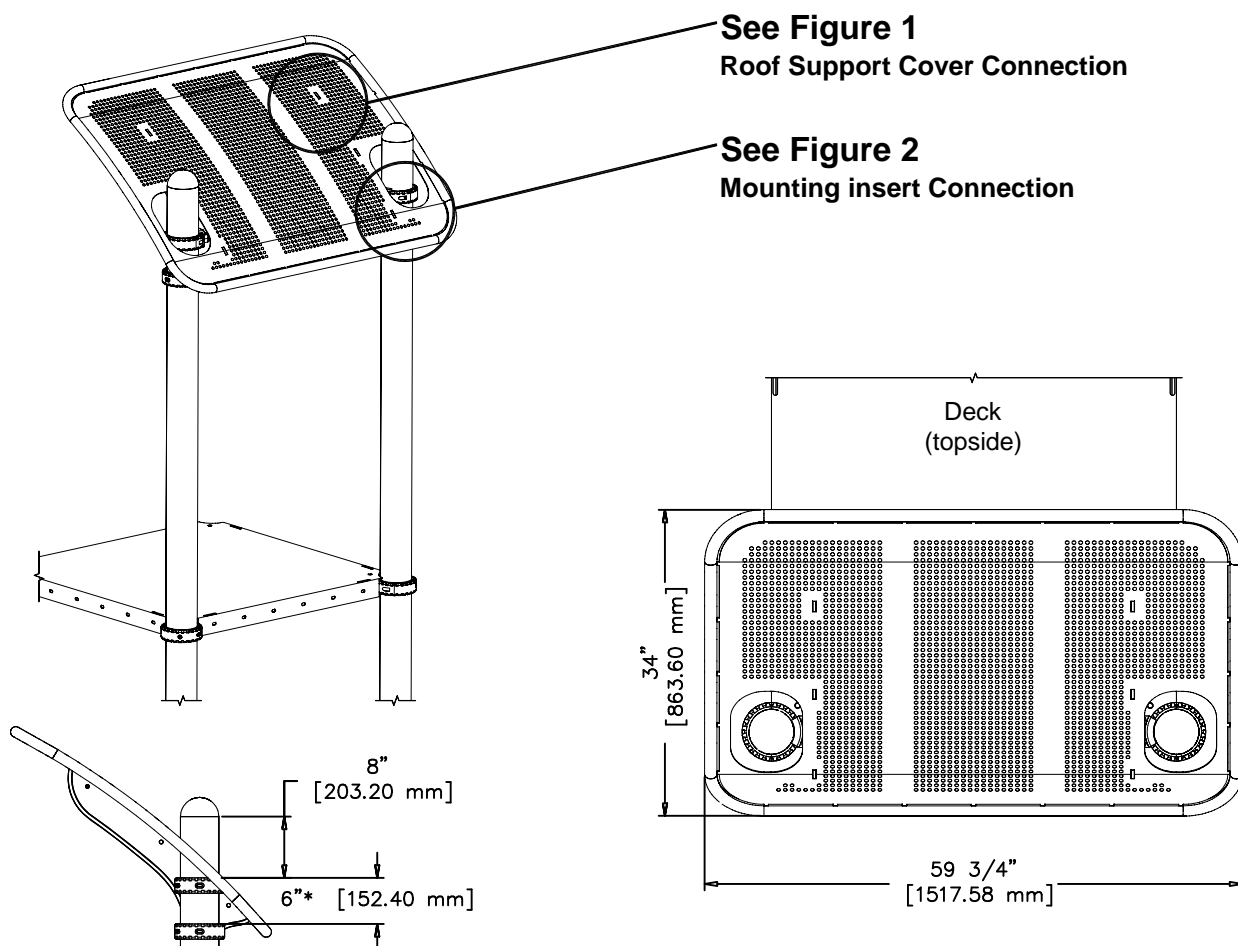

Elevation

Side View

*Dimension given is from top of lower collar to top of upper collar. See Note D.

Plan View

Top View



Manufactured by Krauss Craft, Inc.
www.playcraftsystems.com

For Customer Service Call
800.333.8519 (U.S.A.) or
541.955.9199 (International)

Rev B

Figure 1

Roof Support Cover Connection

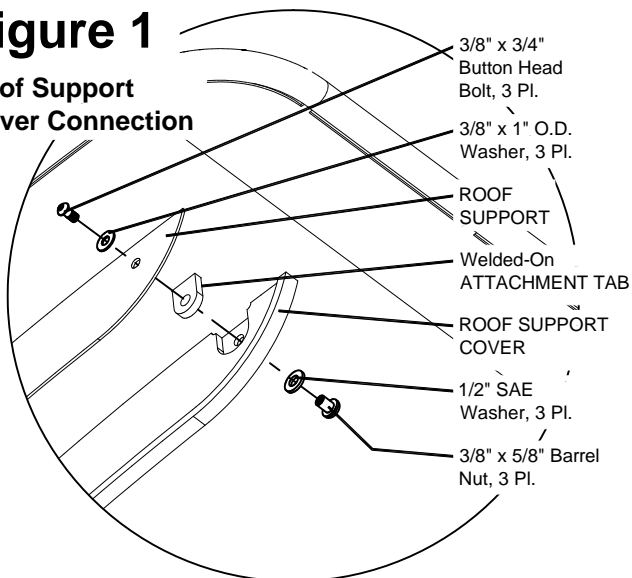
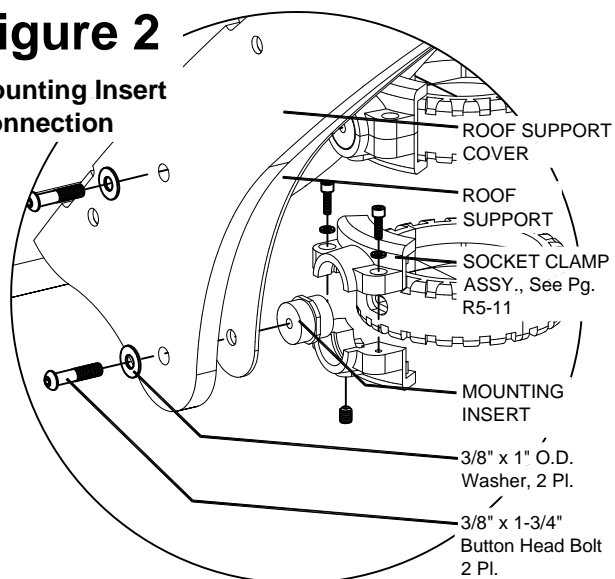

Figure 2

Mounting Insert Connection



Parts List

PART #	DESCRIPTION	QTY.
007015	Mounting Inserts	4
008276	Roof Supports	2
008284	Roof Support Covers	2
FS-18012-R	Roof Steel Shade 2-Post	1
See Pg. R5-11	Socket Clamp Assy.	4
9103032-TR	Bolt Button Head 3/8" x 3/4"	6
9103082-TR	Bolt Button Head 3/8" x 1-3/4"	4
9333002	Washer Flat 3/8" x 1" x .100 thick	10
9345002	Washer Flat SAE 1/2"	6
9443022-TR	Nut Barrel 3/8" x 5/8"	6

Installation

Step 1.

Locate and mark the positions of the collars on the support posts. See Note D. Refer to Elevation for collar location. Refer to Assembly Page R35-09 for hardware type and orientation.

Step 2.

Attach Shade Roof Supports to Shade Roof. Refer to Figure 1 for hardware type and orientation.

Step 3.

Attach Shade Roof to post collars. Refer to Figure 2 for hardware type and orientation.

Step 4.

Apply liquid thread lock and fully tighten all fasteners according to the "TIGHTENING TORQUE FOR HARDWARE" Section of the Installer's Manual. See Note A.

Specifications

STEEL SHADE ROOF:

Shall be constructed of 14 Ga. sheet steel with punched hole pattern welded to a 1.315" O.D., 12 Ga. steel tube frame with welded 3/8" thick attachment tabs. The Steel Shade Roof has a multi-stage baked-on powder coat finish.

ROOF SUPPORT:

Shall be fabricated from 10 Ga. sheet steel. The Roof Support has a multi-stage baked-on powder coat finish.

ROOF SUPPORT COVER:

Shall be fabricated using 3/4" High Density Polyethylene hot-extruded plastic.

COLLARS & SOCKET CLAMPS:

Shall be two-part and precision die-cast from a high strength aluminum alloy. The Collars have a multi-stage baked-on powder coat finish.

MOUNTING INSERTS:

Shall be precision die-cast from a high-strength aluminum alloy.

HARDWARE:

Shall be stainless steel, zinc/nickel plated or galvanized as required to resist rust and corrosion.

Maintenance

Periodically tighten all screws, bolts and nuts. A periodic inspection of all parts is necessary. If a part is broken or worn, replace immediately. For general maintenance please refer to our Playground Maintenance Manual.



Manufactured by Krauss Craft, Inc.
www.playcraftsystems.com

For Customer Service Call
800.333.8519 (U.S.A.) or
541.955.9199 (International)

Rev B