

IMPORTANT NOTES: Read First

(A) Use liquid thread lock (such as Loctite®) with all threaded hardware. **Important:** Liquid thread lock (prior to curing) helps to eliminate the common problem of "thread seizure" in stainless steel hardware by serving as a lubricant during assembly.

(B) Do not pour concrete until the equipment is completely assembled, leveled and plumbed. Concrete must be allowed to cure completely before using the equipment (at least 72 hours).

(C) An appropriate energy absorbing safety surface is required under and around all playground equipment. Loose fill protective surfacing is shown only as an example for the purpose of this assembly instruction. Other surfacing material may vary in thickness and/or compression depths. See free publication - The Handbook for Public Playground Safety, Publication #325 at www.cpsc.gov for the surfacing appropriate for the fall height of the equipment or consult your surfacing supply representative.

FIGURE 1
Tri-Pad Jungle
Traverse 90°

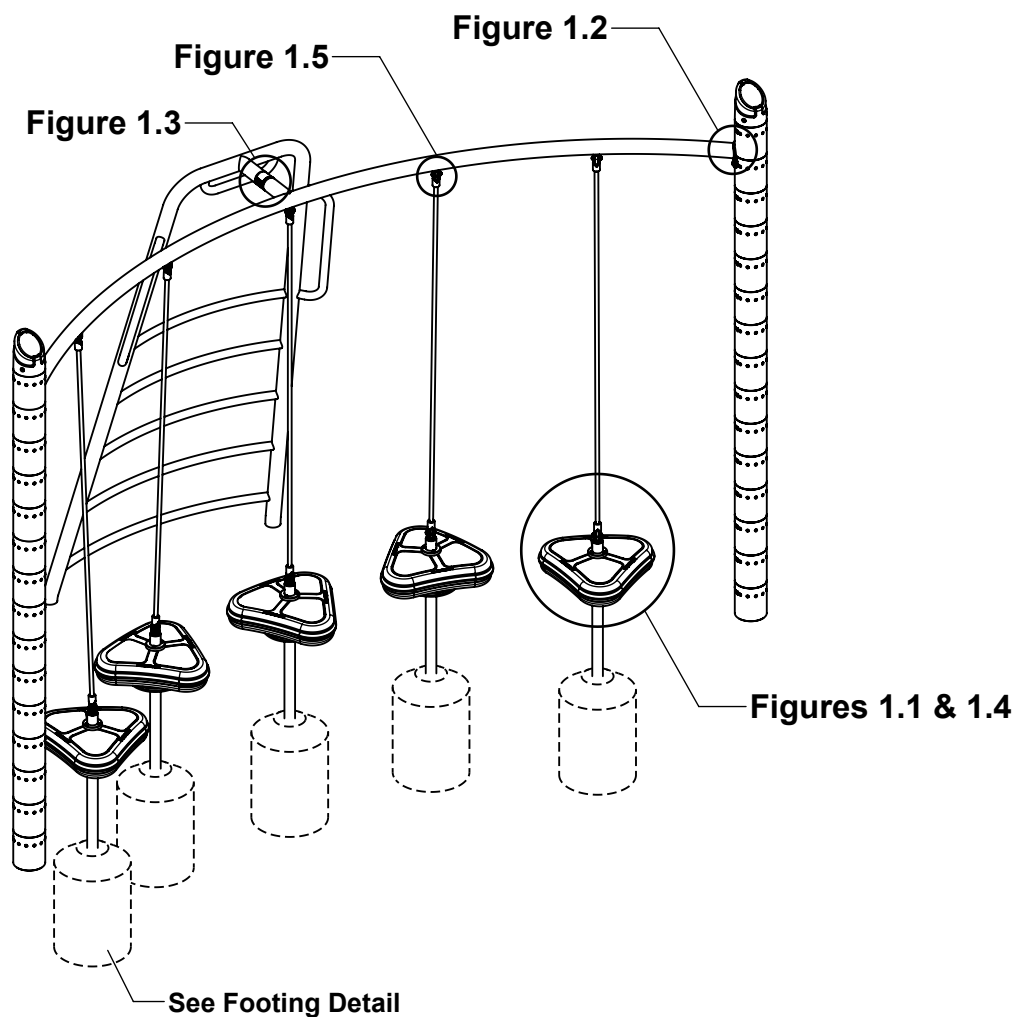

Step 1

Refer to Footing Layout and mark footing hole locations. Dig (5) Ø 12" footing holes. Refer to Footing Detail for depth and details.

IMPORTANT: For areas with soft soil conditions, larger footings may be required.

* Footing depth must be adjusted to compensate for the depth/thickness requirements of selected safety surfacing. See Section 06.1 of the Installation Manual.

** Height shown from finish grade to mounting hole.

Footing Detail

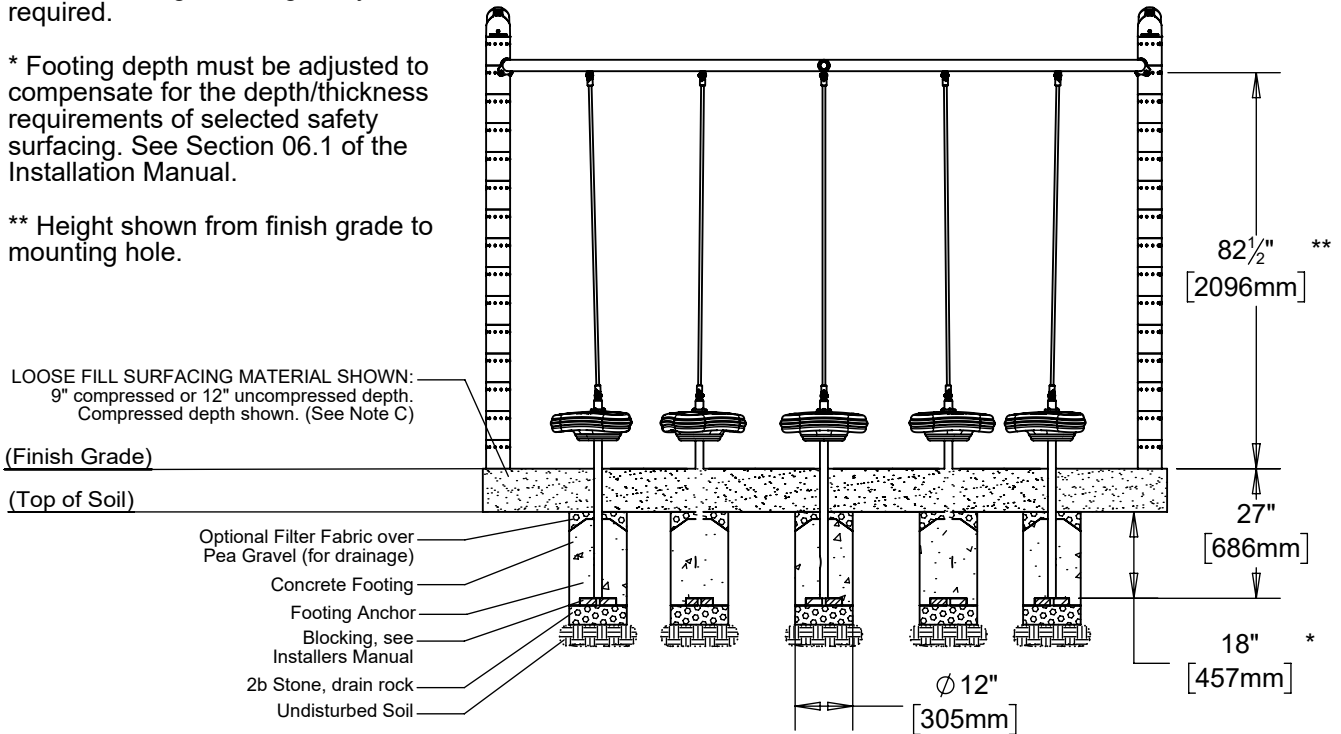

Top View - Footing Layout

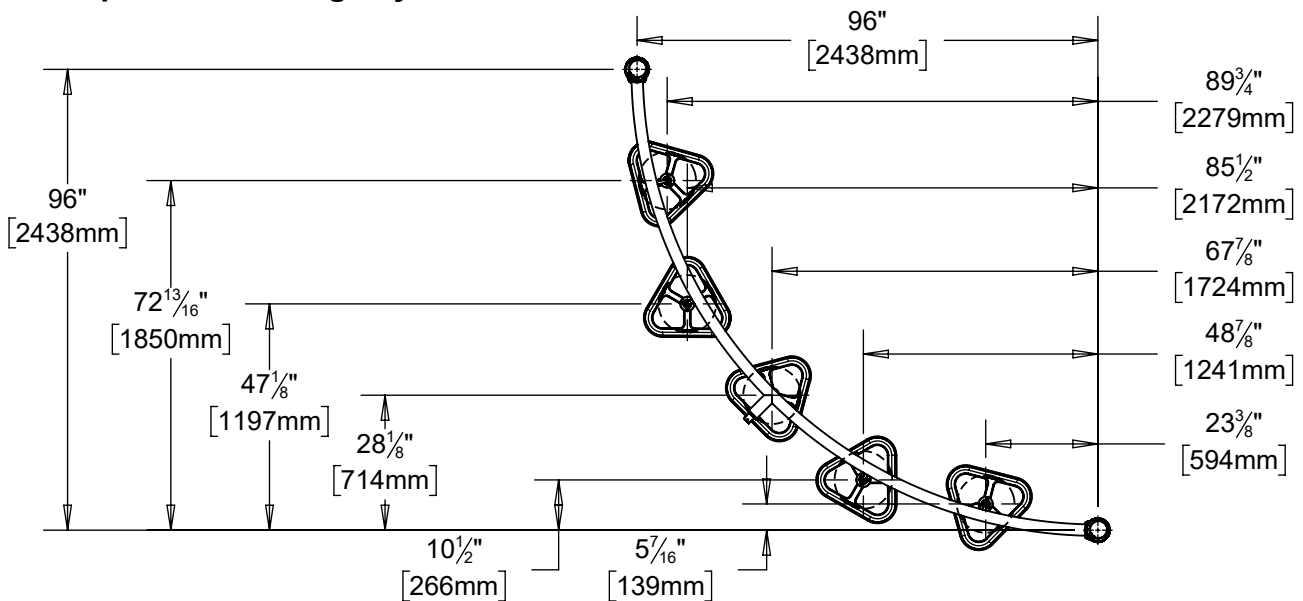

Step 2 (Factory Assembled)

Attach Tri-Pads to Traverse Stations as shown in Figure 1.1. (See Note A)

NOTE: 5 Places

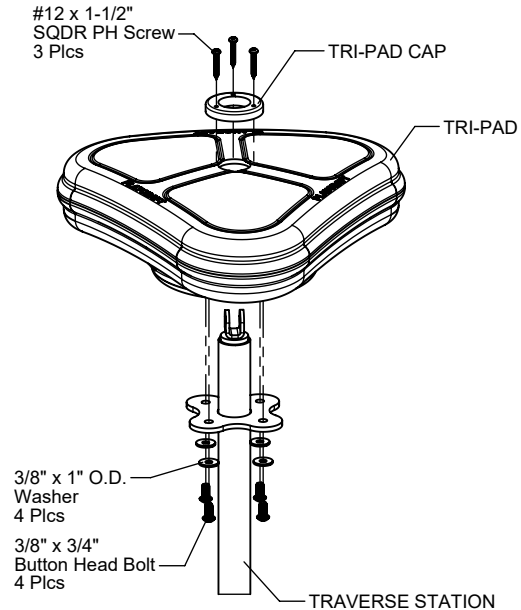

Figure 1.1

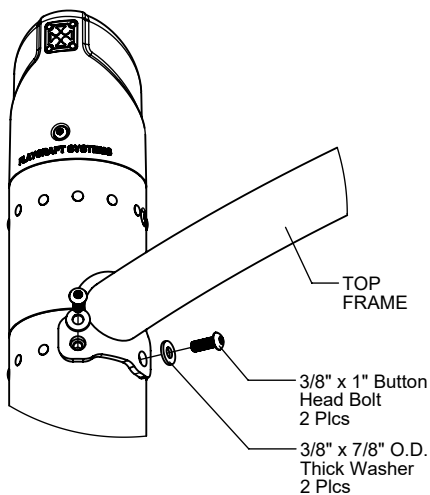

Figure 1.2

Step 4

For Beam To Pin Connection

Locate and attach Event to Top Frame as shown in Figure 1.3. (See Note A)

Step 3

Refer to Footing Detail and remove required post plugs for assembly. Attach Top Frame to Posts as shown in Figure 1.2. (See Note A)

NOTE: 2 Places

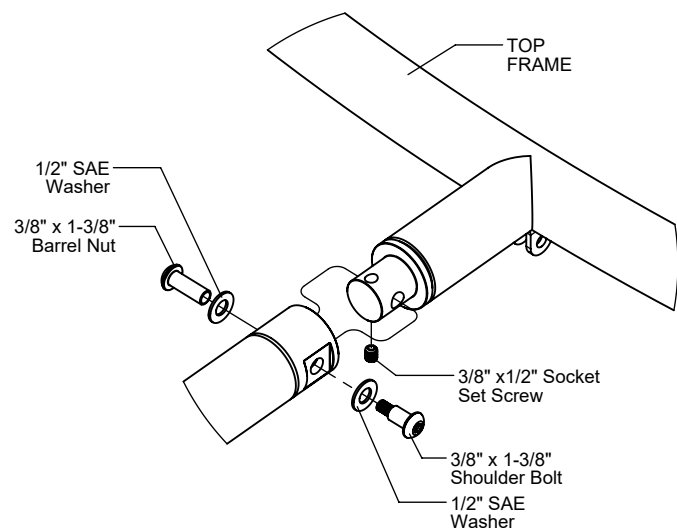

Figure 1.3

Step 5

Attach Vines to Traverse Stations as shown in Figure 1.4.
(See Note A)

NOTE: 5 Places

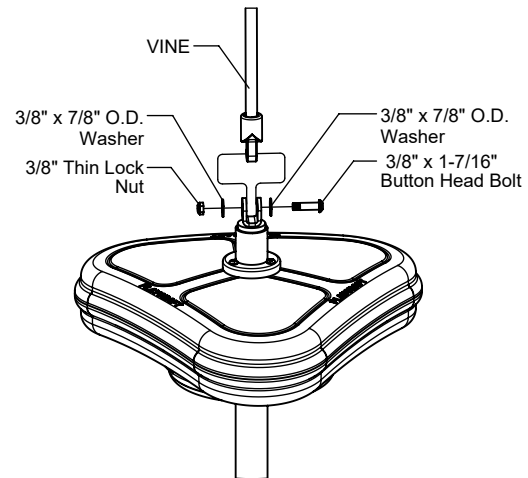

Figure 1.4

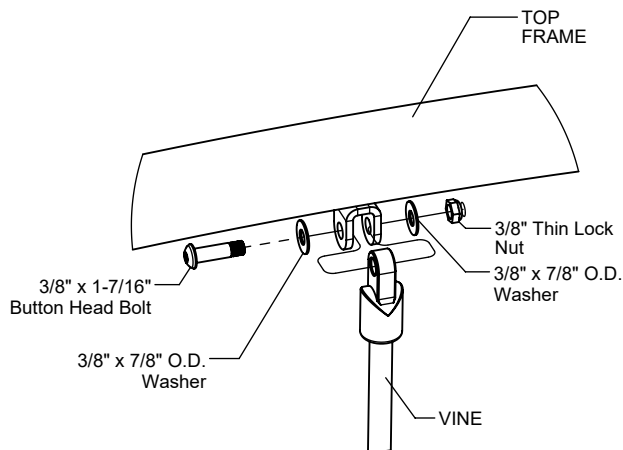

Figure 1.5

Step 6

Place Traverse Stations into footing holes and attach Vines to Top Frame as shown in Figure 1.5.
(See Notes A & B)

NOTE: 5 Places

Step 7

Fully tighten all fasteners according to the "TIGHTENING TORQUE FOR HARDWARE" section of the Installation Manual.

Step 8

Plumb and level entire component. Pour concrete into footing holes. Allow at least 72 hours to cure before using this equipment. (See Note B)

Step 9

Place required protective surfacing under and around Tri-Pad Jungle Traverse 90°.
(See Note C)

TRI-PAD JUNGLE TRAVERSE 90° RV INSTALLATION INSTRUCTIONS

RV-1437
Page 5 of 5

Parts List

Part #	DESCRIPTION	QTY.
FS-1437-RV	Tri-Pad Jungle Traverse 90° Top Frame RV	1
HE-0031	Tri Pad Jungle Traverse Vine	5
9103052-TR	Bolt Button Head 3/8" x 1"	4
9103200-TR	Bolt Button Head 3/8" x 1-7/16"	10
9333042	Washer Flat 3/8" x 7/8" O.D.	20
9339042	Washer Flat 3/8" x 7/8" O.D. x .100" Thick	4
9423002	Nut Lock Thin 3/8"	10

Assembled Parts List

Part #	DESCRIPTION	QTY.
DE-0024-H	Tri-Pad with Hole	5
EE-0142	Tri-Pad Cap	5
FS-1437-TRI	Tri-Pad Jungle Traverse Station	5
9103032-TR	Bolt Button Head 3/8" x 3/4"	20
9221272	Screw #12 x 1-1/2" SQDR PH	15
9333002	Washer Flat 3/8" x 1" O.D. x .100" thick	20

Specifications

TRI-PAD:

Shall be constructed of UV-stabilized, rotationally molded, linear, low density polyethylene with an average wall thickness of .250".

TRI-PAD JUNGLE TRAVERSE 90° TOP FRAME RV:

Shall be fabricated using 2.375" O.D. 10 gauge steel tubing with welded 1/4" thick stainless steel mounting brackets, 3/16" thick stainless steel anchors, and stainless steel pin. The Tri-Pad Jungle Traverse 90° Top Frame RV shall have a multi-stage baked-on powder coat finish.

TRI-PAD JUNGLE TRAVERSE VINE:

Shall be made from 16mm steel-reinforced rope with machined aluminum end clevises.

TRI-PAD JUNGLE TRAVERSE STATION:

Shall be fabricated using 1.660" O.D. 11 gauge steel tubing with welded 1/4" thick steel plate and 3/16" thick stainless steel anchor. The Tri-Pad Jungle Traverse Station shall have a multi-stage baked-on powder coat finish.

TRI-PAD CAP:

Shall be made from high density 3/4" sheet plastic specially formulated for optimum UV stability and color retention.

HARDWARE:

Shall be stainless steel, zinc/nickel plated or galvanized as required to resist rust and corrosion.

Maintenance

Periodically tighten all screws, bolts and nuts. A periodic inspection of all parts is necessary. If a part is broken or worn, replace immediately. For general maintenance please refer to our Playground Maintenance Manual.



www.playcraftsystems.com
For Customer Service Call
800.333.8519 (U.S.A.) or 541.955.9199 (International)

Rev D
5/19/2025