

180° HORIZONTAL LADDER ASSY.

R5-1422

Page 1 of 2

Plan View

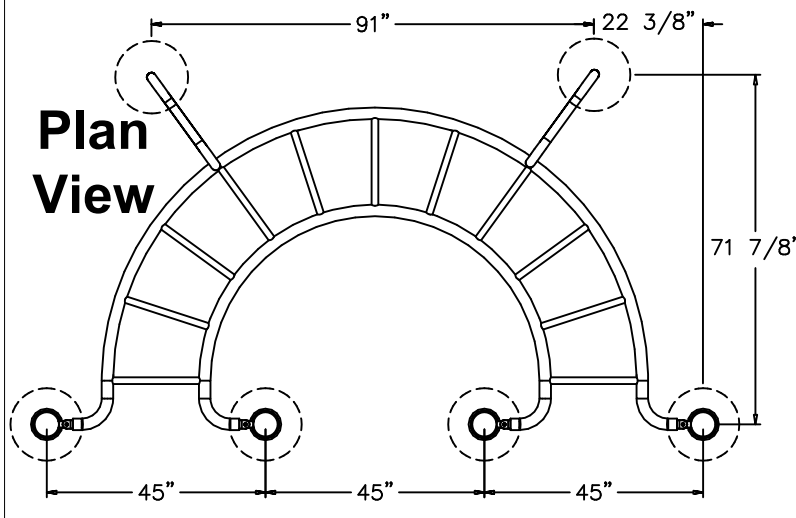

Figure 3

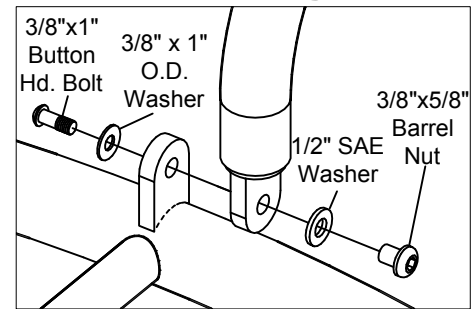

Figure 2

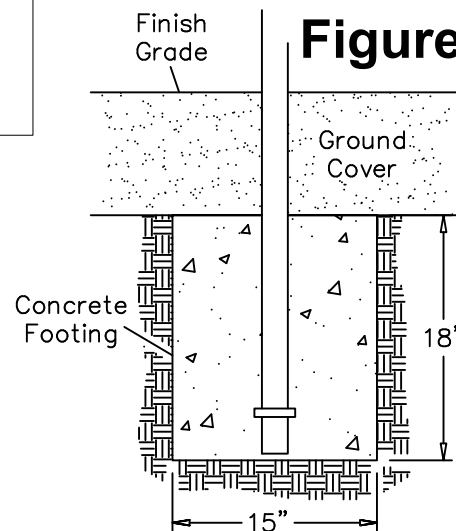
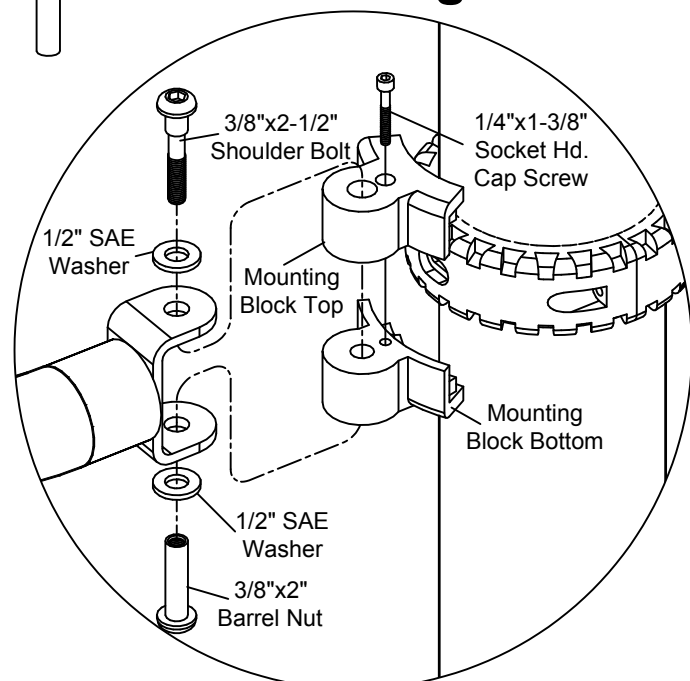

Figure 1



See
Figure 3

See
Figure 1

Assembly View

Parts List

QTY.	DESCRIPTION	PART #
1	180° Horizontal Ladder	1422-R
2	90° Loop Traverse Support	1411-90A
4	Mounting Block Top	7006-T
4	Mounting Block Bottom	7006-B
2	3/8"x1" Button Head Bolt	9103052-TR
4	3/8"x2-1/2" Shoulder Bolts	9143112-TR
4	1/4"x1-3/8" Socket Cap Screws	9281062-5
2	3/8"x1" O.D. Washers	9333002
10	1/2" SAE Washers	9345002
2	3/8"x5/8" Barrel Nuts	9443022-TR
4	3/8"x2" Barrel Nuts	9443092-TR

Specifications

180° HORIZONTAL LADDER TRAVERSE:

Shall be made from 2.375" OD, 10 gage steel tubing with welded 1.315" OD, 12 gage steel tube rungs. Finished with a baked on powder coating.

MOUNTING BLOCKS:

Shall be two-part and precision die-cast from a high strength aluminum alloy. finished with a baked on powder coating.

HARDWARE:

Shall be zinc/nickel plated, galvanized or stainless steel as required to resist rust and corrosion.

Maintenance

Periodically tighten all screws, bolts and nuts. A periodic inspection of all parts is necessary. If a part is broken or worn, replace immediately.

Installation

Notes:

(A) The height of the rungs (at grasping point) from the top of ground cover varies by age group. Ages 2-5: Max. 60" above ground cover. Ages 5-12: Max. 84" above ground cover.

(B) Use liquid thread lock (such as Loctite) with all threaded hardware. **Important:** Liquid thread lock (prior to curing) helps to eliminate the common problem of "thread seizure" in stainless steel hardware by serving as a lubricant during assembly.

Step 1.

Locate and mark the positions of the collars on the support posts and attach as shown in Collar Assembly Page R5-09.

Step 2.

Place Mounting Blocks in position on the collars and secure with Socket Head Cap Screws. Attach Horizontal Ladder to Mounting Blocks as shown in Figure 1.

Step 3.

Check to ensure that the Ladder has been installed to the correct height (see Note A).

Step 4.

Dig a 15" dia. footing hole approx. 18" deep. See Plan View for location and Figure 2 for footing detail.

Step 5.

Place the Traverse Support in the footing hole and attach to the 180° Horizontal Ladder as shown in Figure 3.

Step 6.

Fully tighten all fasteners.

Step 7.

Pour concrete footing. Allow 72 hours for concrete to cure before continuing.