

## IMPORTANT NOTES: Read First

- (A) Use liquid thread lock (such as Loctite®) with all threaded hardware. **Important:** Liquid thread lock (prior to curing) helps to eliminate the common problem of "thread seizure" in stainless steel hardware by serving as a lubricant during assembly.
- (B) Do not pour concrete until the equipment is completely assembled, leveled and plumbed. Concrete must be allowed to cure completely before using the equipment (at least 72 hours).
- (C) Refer to Installation Manual for 09 Collars and 11 Socket Clamps assembly instructions.
- (D) An appropriate energy absorbing safety surface is required under and around all playground equipment. Loose fill protective surfacing is shown only as an example for the purpose of this assembly instruction. Other surfacing material may vary in thickness and/or compression depths. See free publication - The Handbook for Public Playground Safety, Publication #325 at [www.CPSC.gov](http://www.CPSC.gov) for the surfacing appropriate for the fall height of the equipment or consult you surfacing supply representative.

**FIGURE 1**  
Easy Access Stairs 24"

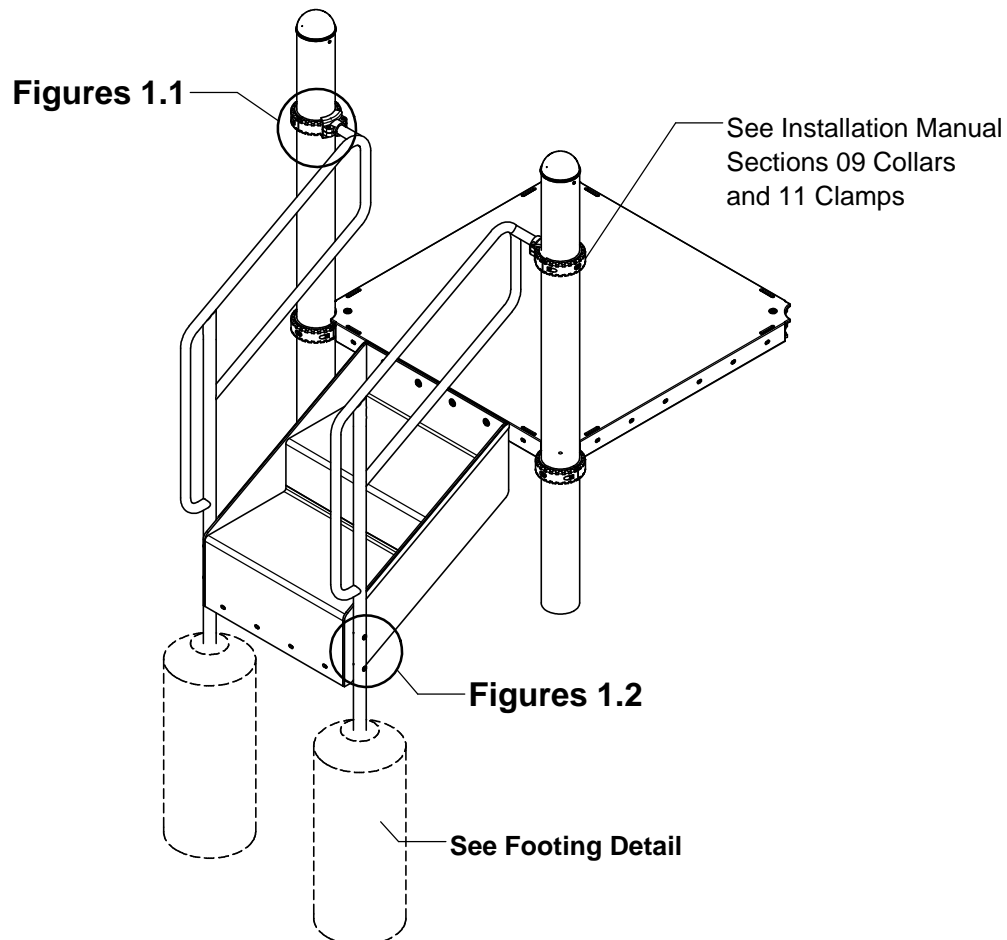

**NOTE:** R5-1201-2 Configuration shown. Other configurations will vary slightly, but will not affect the assembly.

## Step 1

Refer to Footing Layout and mark footing hole locations. Dig 2 Ø 12" footing holes. Refer to Footing Detail for depth and details.

**IMPORTANT:** For areas with soft soil conditions, larger footings may be required.

\* Footing depth must be adjusted to compensate for the depth/thickness requirements of selected safety surfacing. See Section 06.1 of the Installation Manual.

### Footing Detail

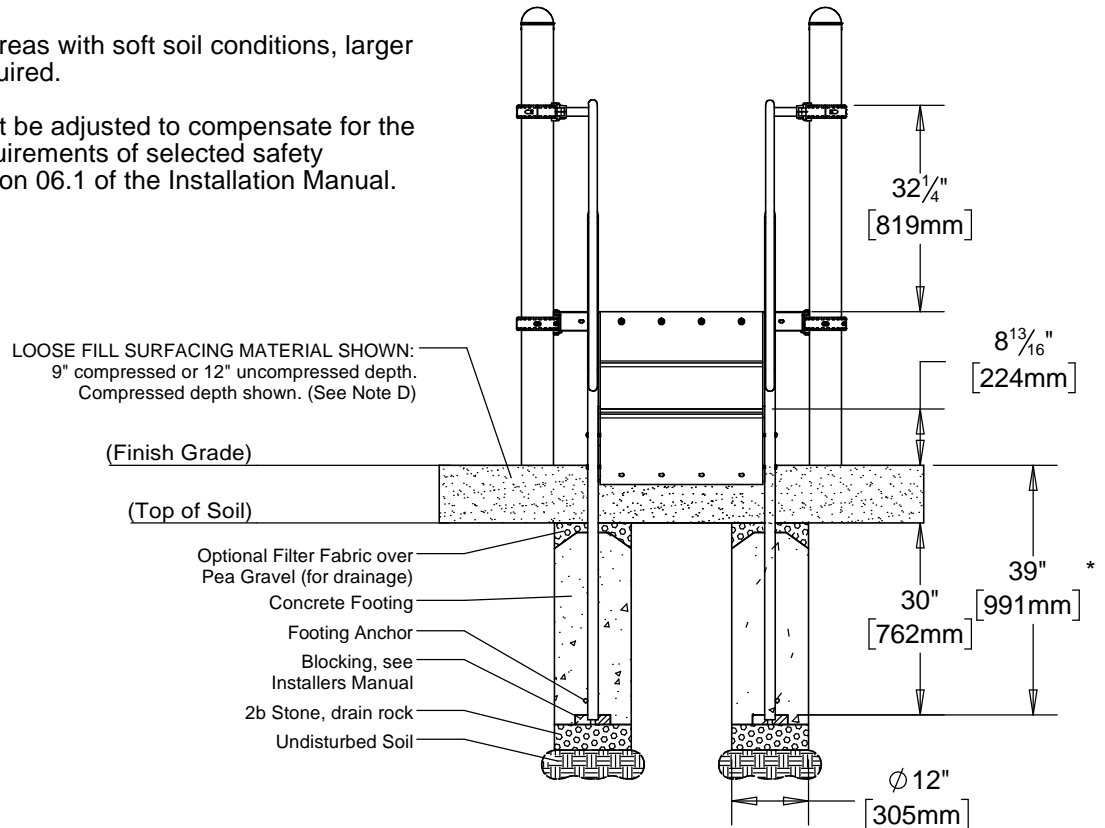

### Top View - Footing Layout

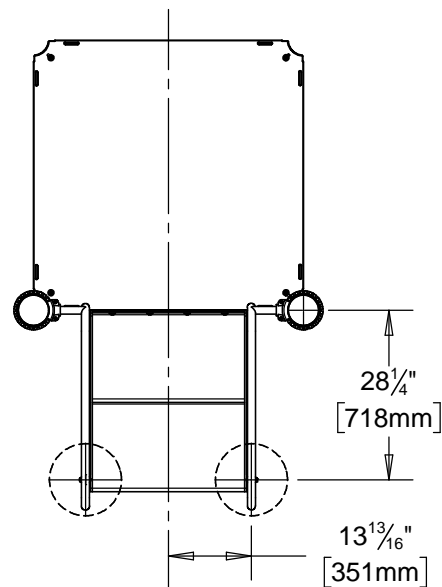

## Step 2

Place Transfer Rails into footing holes and attach to collars as shown in figure 1.1 (See Note C)

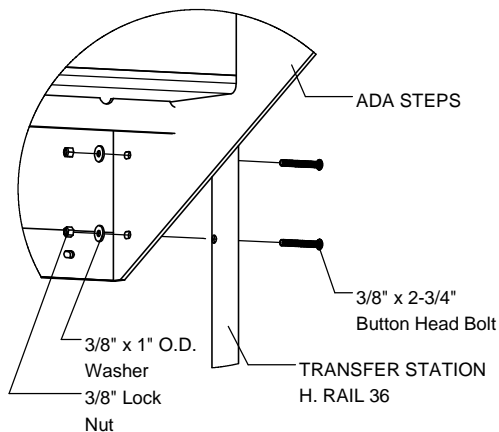

**Figure 1.2**

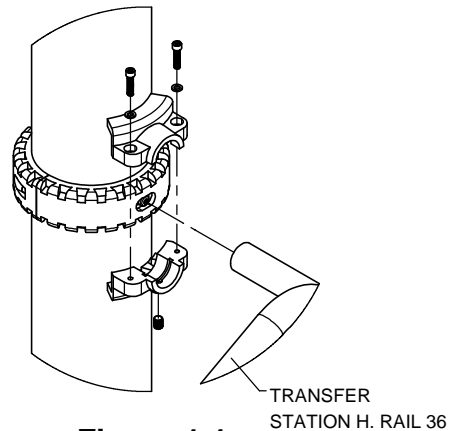

**Figure 1.1**

## Step 3

Attach ADA Steps to Transfer Rails as shown in Figure 1.2. (See Note A)

## Step 4

Attach ADA Steps to deck as shown in Figure 2. (See Note A)

## Step 5

Fully tighten all fasteners according to the "TIGHTENING TORQUE FOR HARDWARE" section of the Installation Manual.

## Step 6

Plumb and level entire component. Pour concrete into footing hole(s). Allow at least 72 hours to cure before using this equipment. (See Note B)

## Step 7

Place required protective surfacing under and around Easy Access Stairs. (See Note D)

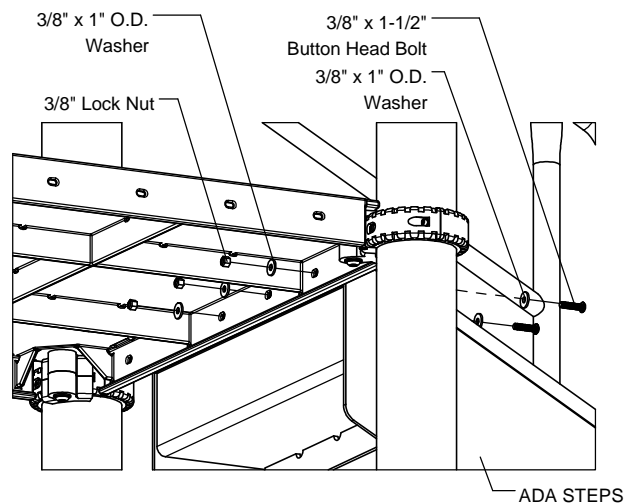

**FIGURE 2**

## Parts List

Easy Access Stairs 24" R5		
Part #	DESCRIPTION	QTY
CE-4203	ADA Steps 24-26	1
FS-1209-24	Transfer Station H. Rail 36	2
HS-1001-R5	Socket Clamp Set R5	2
9103072-TR	Bolt Button Head 3/8" x 1-1/2"	4
9103122-TR	Bolt Button Head 3/8" x 2-3/4"	4
9333002	Washer Flat 3/8" x 1" O.D. x .100" thick	12
9413002	Nut Lock 3/8"	8

Easy Access Stairs 24" R3.5		
Part #	DESCRIPTION	QTY
CE-4203	ADA Steps 24-26	1
FS-1209-24	Transfer Station H. Rail 36	2
HS-1001-R35	Socket Clamp Set R3.5	2
9103072-TR	Bolt Button Head 3/8" x 1-1/2"	4
9103122-TR	Bolt Button Head 3/8" x 2-3/4"	4
9333002	Washer Flat 3/8" x 1" O.D. x .100" thick	12
9413002	Nut Lock 3/8"	8

## Specifications

### STEPS & DECKS:

Shall be fabricated using punched, formed and welded 14 gauge sheet steel. Steps and Decks shall be Play-Tuff™ coated after fabrication.

### STEP RAILS:

Shall be fabricated using 1.315" O.D. 12 gauge steel tubing with welded 1.660" O.D. 11 gauge steel leg. The Step Rails shall have a multi-stage baked-on powder coat finish.

### SOCKET CLAMPS:

Shall be two-part and precision die-cast from a high strength aluminum alloy. The Socket Clamps have a multi-stage baked-on powder coat finish.

### HARDWARE:

Shall be stainless steel, zinc/nickel plated or galvanized as required to resist rust and corrosion.

## Maintenance

Periodically tighten all screws, bolts and nuts. A periodic inspection of all parts is necessary. If a part is broken or worn, replace immediately. For general maintenance please refer to our Playground Maintenance Manual.

