

IMPORTANT NOTES: Read First

- (A) Use liquid thread lock (such as Loctite®) with all threaded hardware. **Important:** Liquid thread lock (prior to curing) helps to eliminate the common problem of "thread seizure" in stainless steel hardware by serving as a lubricant during assembly.
- (B) Do not pour concrete until the equipment is completely assembled, leveled and plumbed. Concrete must be allowed to cure completely before using the equipment (at least 72 hours).
- (C) All bolt threads protruding beyond the nut must be cut and de-burred until end is smooth to the touch. Sharp edges and/or points of any kind must be eliminated. A maximum of two threads may be exposed beyond the end of the nut.
- (D) Height of seat while unloaded and at rest, must be between 14" [360mm] and 28" [710mm] above the finish grade.
- (E) An appropriate energy absorbing safety surface is required under and around all playground equipment. Loose fill protective surfacing is shown only as an example for the purpose of this assembly instruction. Other surfacing material may vary in thickness and/or compression depths. See free publication - The Handbook for Public Playground Safety, Publication #325 at www.cpsc.gov for the surfacing appropriate for the fall height of the equipment or consult your surfacing supply representative.

FIGURE 1
Toddler Bear
Spring Rider

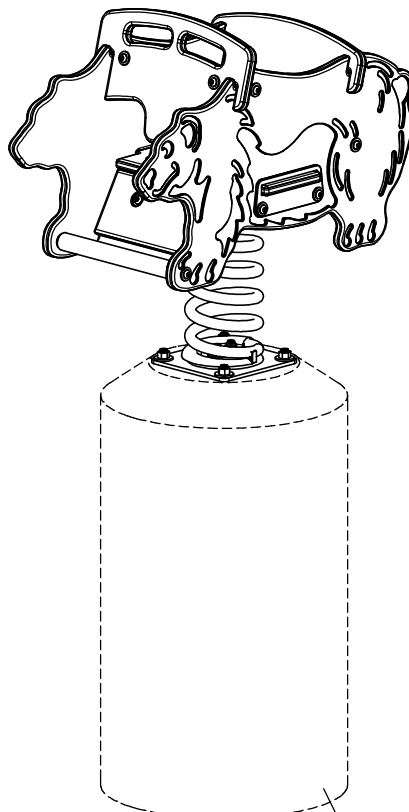

See Footing Detail

Step 1

Refer to Footing Layout and mark footing hole location. Dig (1) Ø 18" footing hole. Refer to Footing Detail for depth and details.

IMPORTANT: For areas with soft soil conditions, larger footings may be required.

* Footing depth must be adjusted to compensate for the depth/thickness requirements of selected safety surfacing. See Section 06.1 of the Installation Manual.

Footing Detail

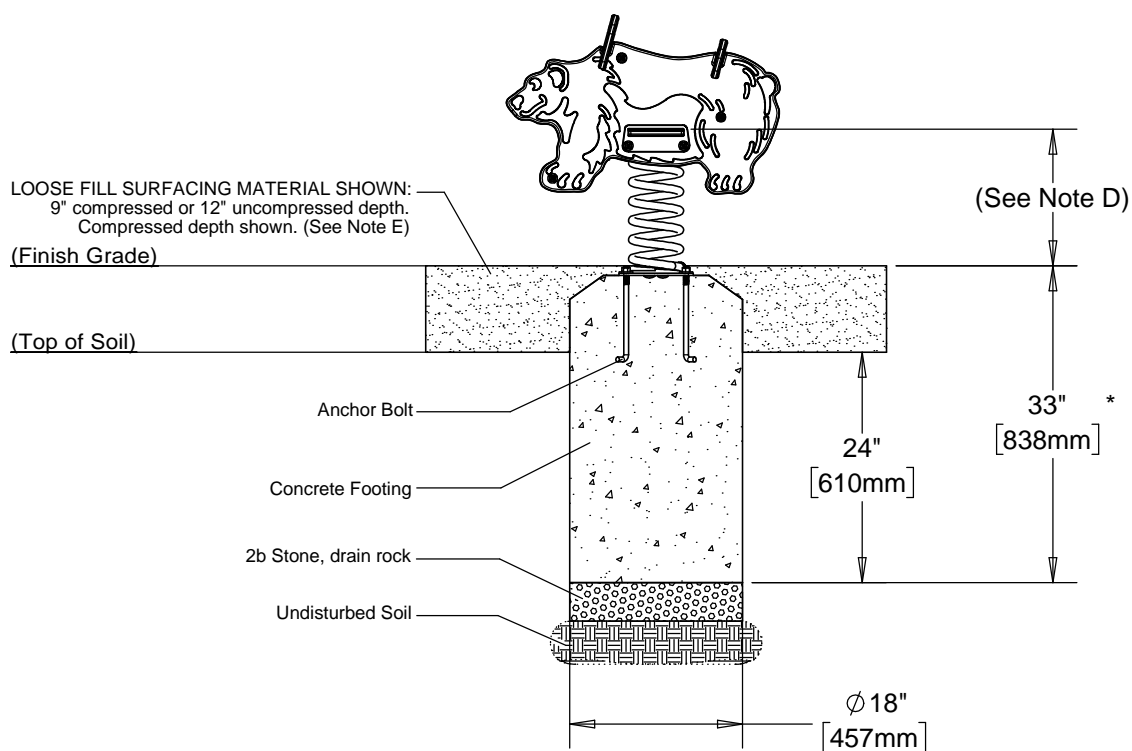

Top View - Footing Layout
72" [1829mm] Use Zone Recommended

Refer to current ASTM 1487 standards:
The Use Zone for Rocking or Spring equipment upon which the user is intended to sit shall be no less than 72" [1829mm] in all directions from the at rest perimeter of the play structure.

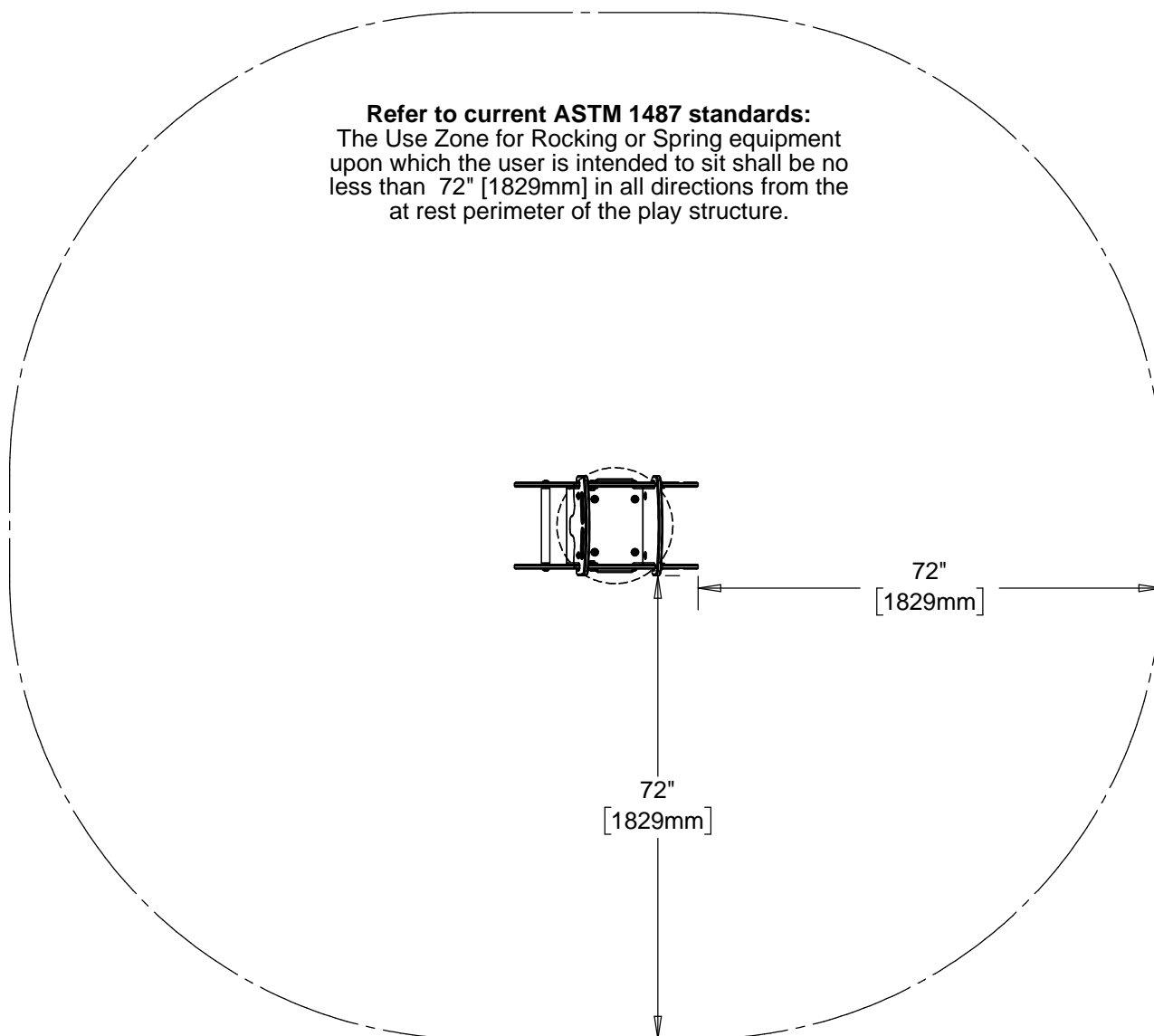

Step 2

Use the Single Spring Bottom Mount Plate as a template to create a plywood template for the placement of the anchor bolts. Attach anchor bolts to template as shown in Figure 2.

NOTE: Plywood not supplied.

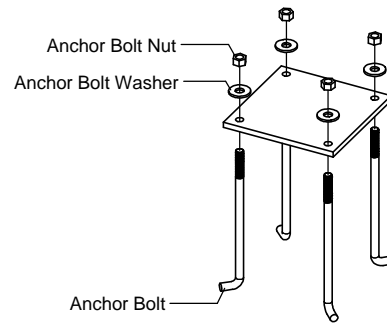

FIGURE 2

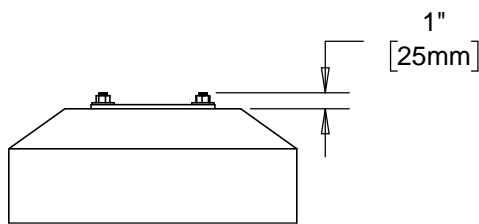

FIGURE 3

Step 3

Pour concrete footing and level template on surface. Orient and set anchor bolts in concrete as shown in footing detail. Allow approximately 1" [25mm] of thread to protrude from the concrete as shown in Figure 3. Allow 72 hours to cure before proceeding to next step. (See Note B)

Step 4 (Factory Assembled)

Insert Event Spring Retainers into Spring and attach to Top Mount Plate and Spring Mount Plate as shown in Figure 4. (See Note A)

NOTE: Ensure Anti-Rotation Spacer is oriented with arrows pointing to the inside and end of the spring.

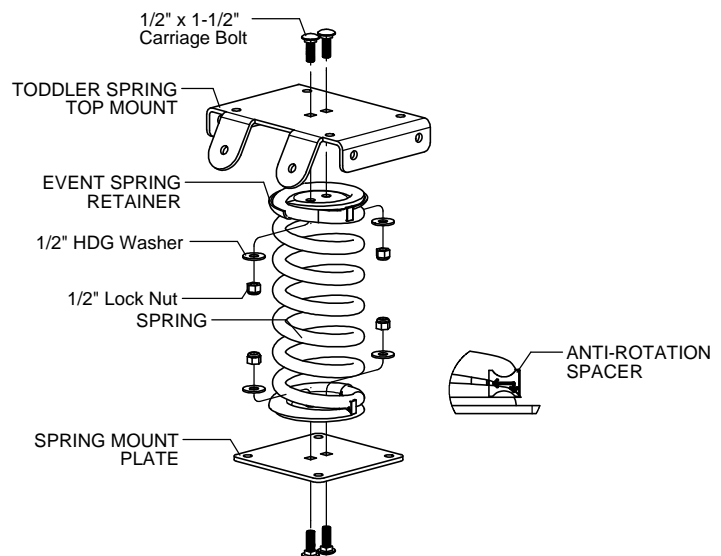

FIGURE 4



FIGURE 5

Step 5 (Factory Assembled)

Install Nutserts into Foot Rest as shown in Figure 5.

Step 6

Attach Seat to Toddler Spring Top Mount as shown in Figure 6. (See Note A)

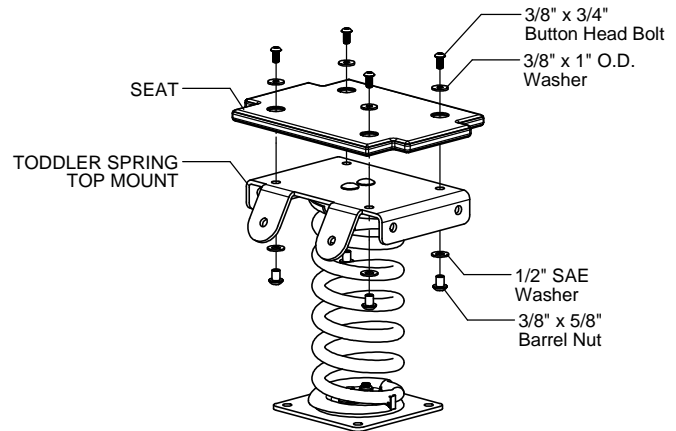

FIGURE 6

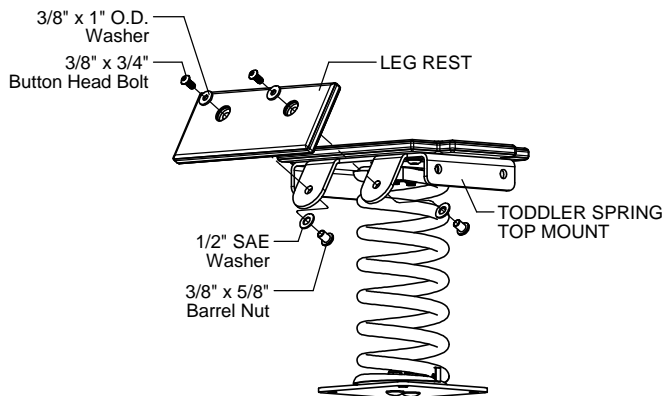

FIGURE 7

Step 7

Attach Leg Rest to Toddler Spring Top Mount as shown in Figure 7. (See Note A)

Step 8

Attach Spring Rider Brackets to Handle as shown in Figure 8. (See Note A)

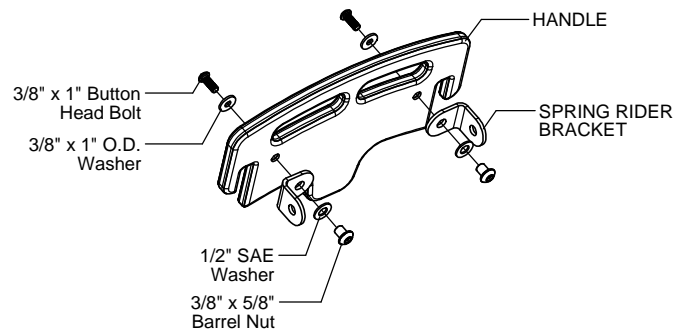

FIGURE 8

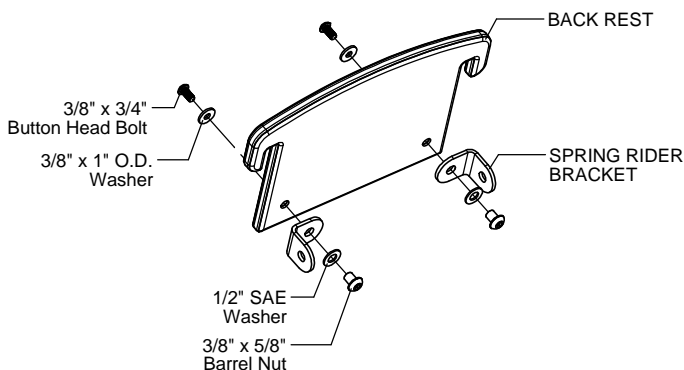

FIGURE 9

Step 9

Attach Spring Rider Brackets to Back Rest as shown in Figure 9. (See Note A)

Step 10

Attach Bear Panels to Toddler Spring Top Mount and Foot Rest as shown in Figure 10. (See Note A)

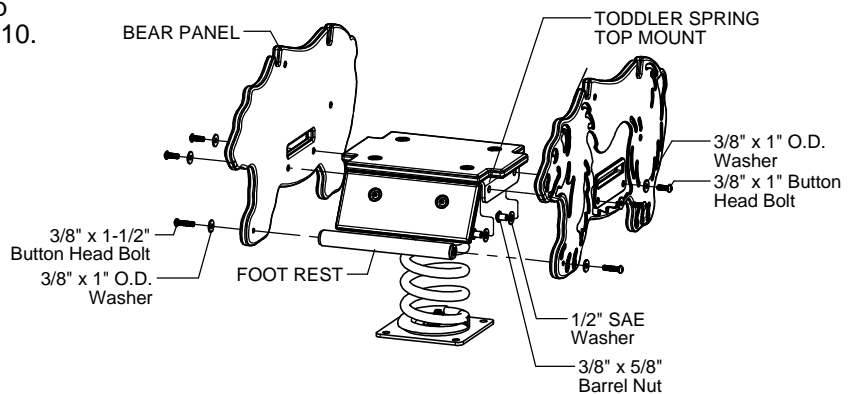

FIGURE 10

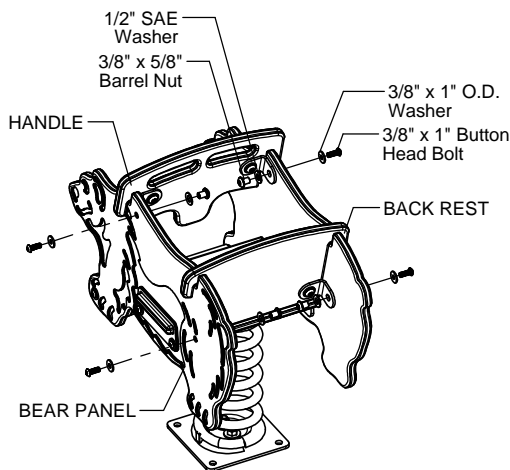

FIGURE 11

Step 11

Attach Handle and Back Rest to Bear Panels as shown in Figure 11. (See Note A)

Step 12

Attach Spring Mount Plate to Anchor Bolts as shown in Figure 12. (See Notes A & C)

Step 13

Fully tighten all fasteners according to the "TIGHTENING TORQUE FOR HARDWARE" section of the Installation Manual.

Step 14

Place required protective surfacing under and around Toddler Bear Spring Rider. (See Note E)

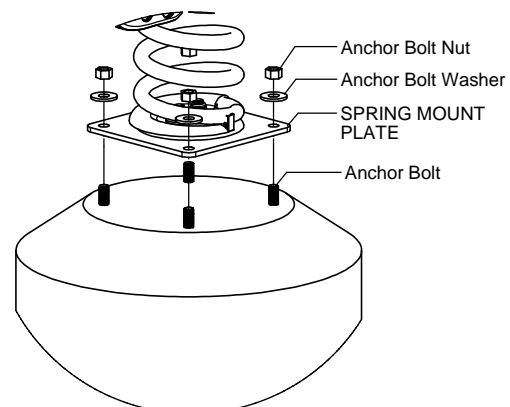

FIGURE 12

TODDLER BEAR SPRING RIDER INSTALLATION INSTRUCTIONS

PC-1345
Page 7 of 7

Parts List

Part #	DESCRIPTION	QTY.
BE-4466	Spring Rider Bracket	4
EE-0213-L	Bear Spring Rider Panel - Left	1
EE-0213-R	Bear Spring Rider Panel - Right	1
EE-4893	Toddler Spring Rider Back Rest	1
EE-4894	Toddler Spring Rider Seat	1
EE-4895	Toddler Spring Rider Handle	1
EE-4896	Toddler Spring Rider Leg Rest	1
9103032-TR	Bolt Button Head 3/8" x 3/4"	8
9103052-TR	Bolt Button Head 3/8" x 1"	10
9103072-TR	Bolt Button Head 3/8" x 1-1/2"	2
9175393	Bolt Anchor 1/2" x 9-1/2" w/ Washer and Nut	4
9333002	Washer Flat 3/8" x 1" O.D. x .100" thick	20
9345002	Washer Flat SAE 1/2"	18
9443022-TR	Nut Barrel 3/8" x 5/8" BH	18

Assembled Parts List

Part #	DESCRIPTION	QTY.
AE-4533	Single Spring Bottom Mount Plate	1
BE-4514	Event Spring Retainer	2
BE-4613	Toddler Spring Top Mount	1
FS-PC1341	Toddler Spring Rider Foot Rest	1
HE-4498	Playground Event Spring	1
IE-0101	Anti-Rotation Spacer	2
455110	Nutsert 3/8 x .690	2
9115072	Bolt Carriage 1/2" x 1-1/2"	4
9315003	Washer Cut 1/2" HDG	4
9415132	Nut Lock 1/2"	4

Specifications

SINGLE SPRING BOTTOM MOUNT PLATE:

Shall be made using 1/4" thick sheet steel. The Single Spring Bottom Mount Plate shall have a multi-stage baked-on powder coat finish.

SPRING RIDER BRACKET:

Shall be made from precision cut and formed 3/16" thick sheet steel. The Spring Rider Bracket shall have a multi-stage baked-on powder coat finish.

TODDLER SPRING TOP MOUNT:

Shall be made using punched and formed 1/4" thick sheet steel. The Toddler Spring Top Mount shall have a multi-stage baked-on powder coat finish.

PLAYGROUND EVENT SPRING:

Shall be 5-3/4" O.D. with a free height of 14". The Playground Event Spring shall have a multi-stage baked-on powder coat finish.

EVENT SPRING RETAINER:

Shall be precision cut and formed 1/8" thick sheet steel. The Event Spring Retainer shall have a multi-stage baked-on powder coat finish.

ANTI-ROTATION SPACER:

Shall be machined from high strength aluminum.

SPRING RIDER PANEL SET:

Shall be made from high density 3/4" sheet plastic specially formulated for optimum UV stability and color retention.

TODDLER SPRING RIDER FOOT REST:

Shall be fabricated using 1.315" O.D. 12 gauge steel tubing with welded 3/16" thick steel plugs. The Toddler Spring Rider Foot Rest shall have a multi-stage baked-on powder coat finish.

HARDWARE:

Shall be stainless steel, zinc/nickel plated or galvanized as required to resist rust and corrosion.

Maintenance

Periodically tighten all screws, bolts and nuts. A periodic inspection of all parts is necessary. If a part is broken or worn, replace immediately. For general maintenance please refer to our Playground Maintenance Manual.



Manufactured by Krauss Craft, Inc.
www.playcraftsystems.com

For Customer Service Call
800.333.8519 (U.S.A.) or
541.955.9199 (International)

Rev B
4/27/2017