

IMPORTANT NOTES: Read First

(A) Use liquid thread lock (such as Loctite®) with all threaded hardware. **Important:** Liquid thread lock (prior to curing) helps to eliminate the common problem of "thread seizure" in stainless steel hardware by serving as a lubricant during assembly.

(B) Refer to Installation Manual for R5-09 Collars and R5-11 Socket Clamps installation instructions.

FIGURE 1
Barn Roof

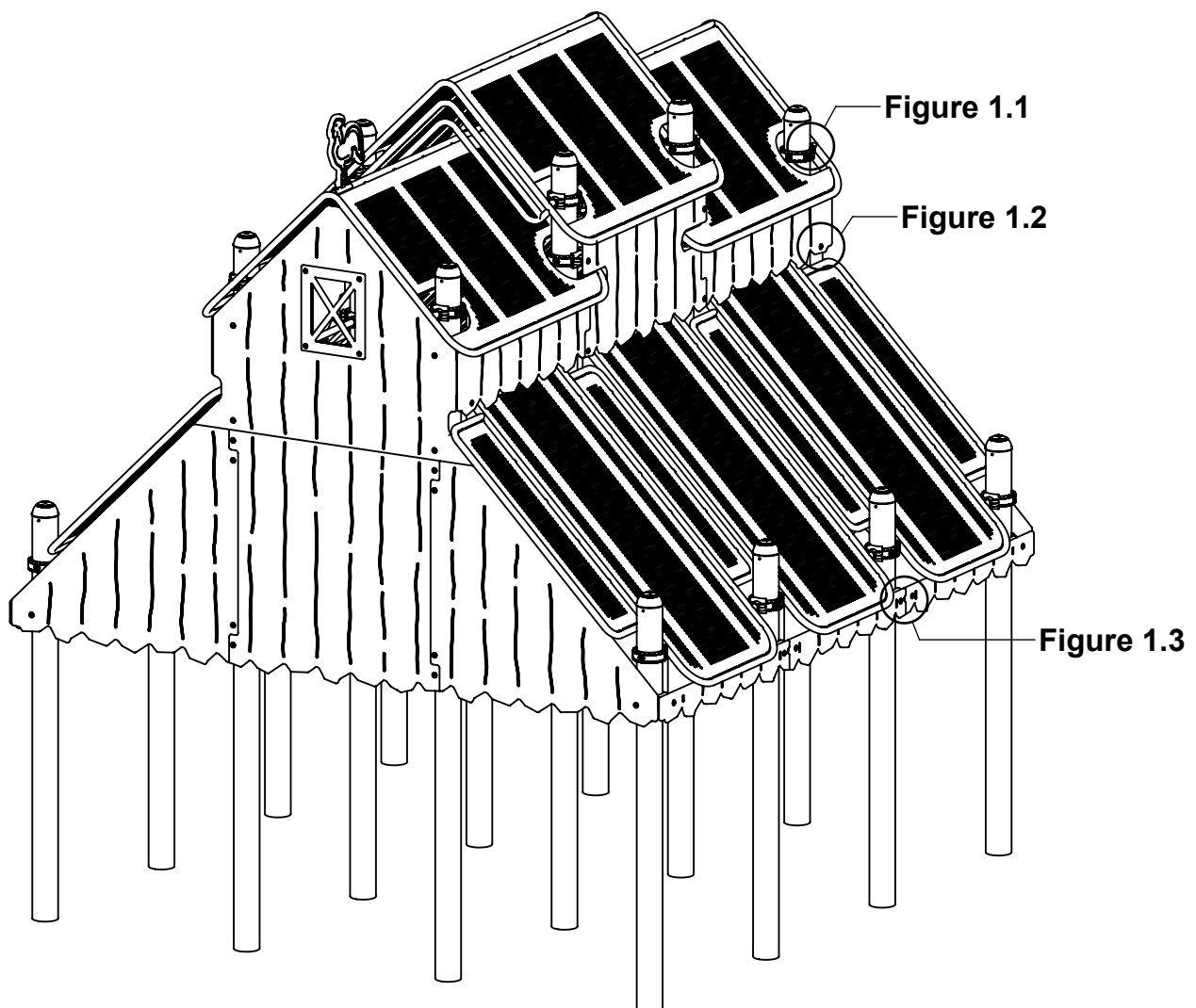

NOTE: R5 Barn Roof shown. Other configurations will vary slightly, but does not affect assembly.

FIGURE 2
Barn Roof

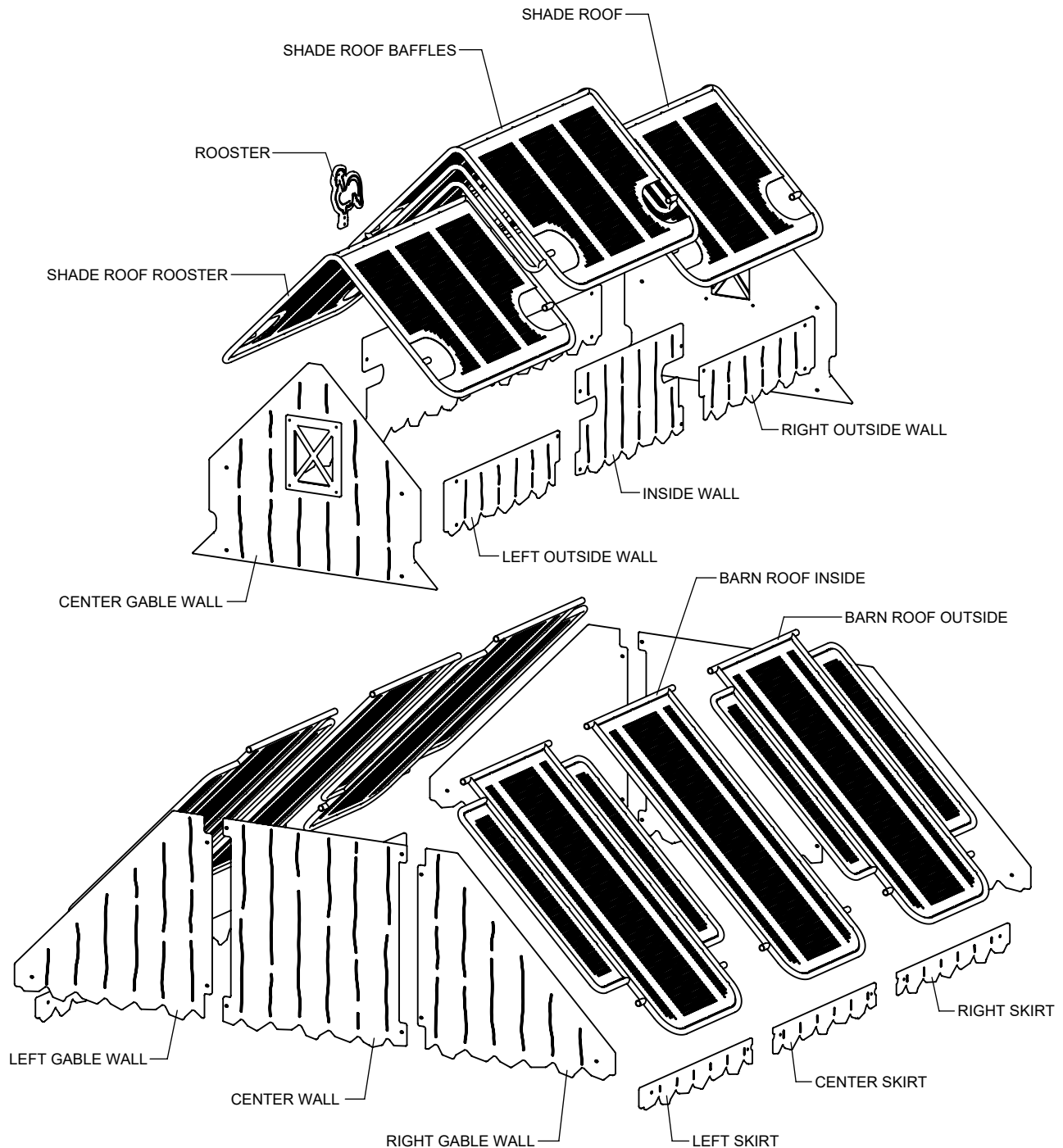
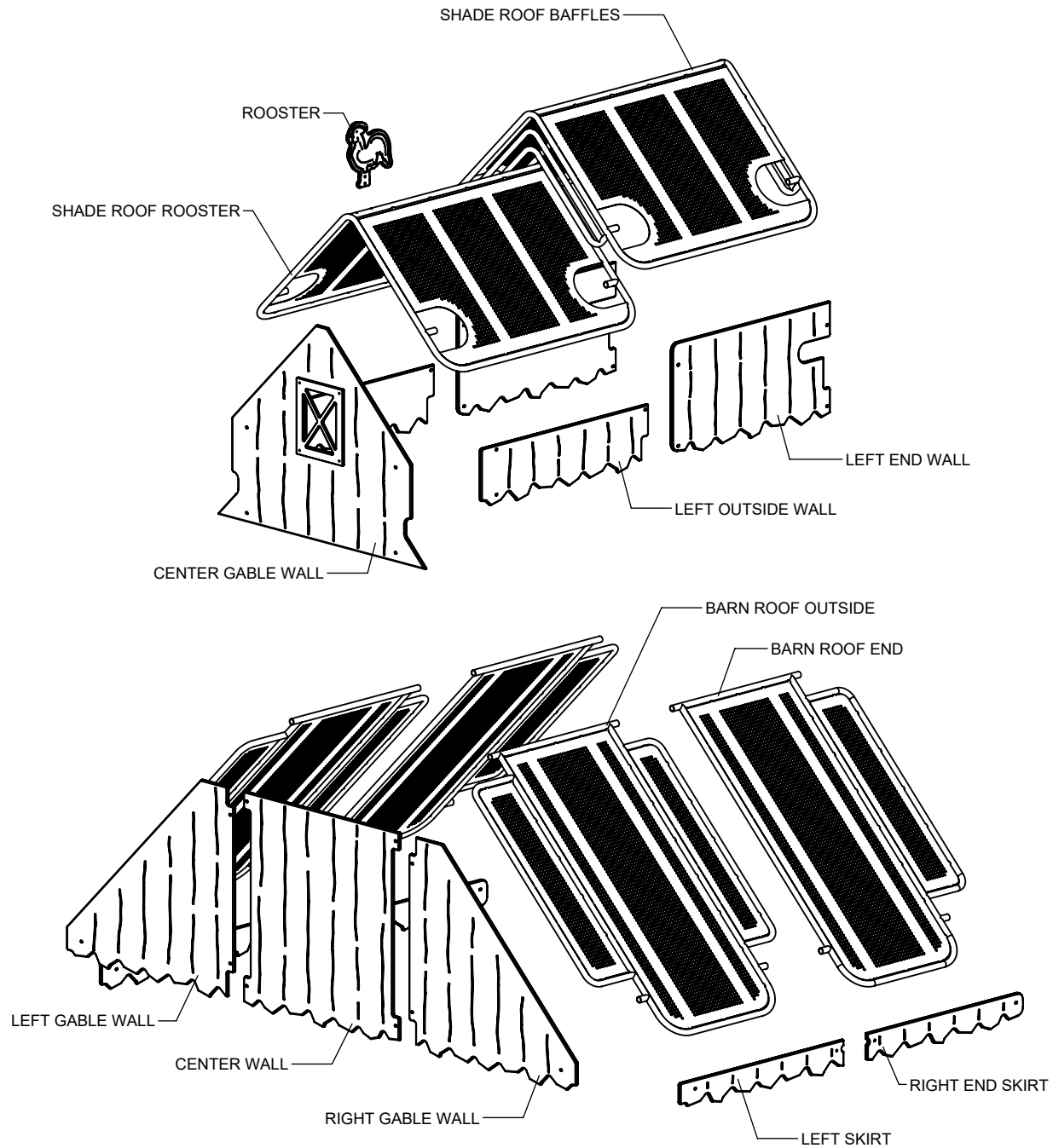

FIGURE 3
Barn Roof 2/3



Step 1 For Multi-Roof Only

Locate and attach collars at heights shown in Elevation View - Outside Collars. (See Note B)

* Height shown from top of post to top of collar.

** Height shown from top of collar to top of collar.

Top View - Outside Collars

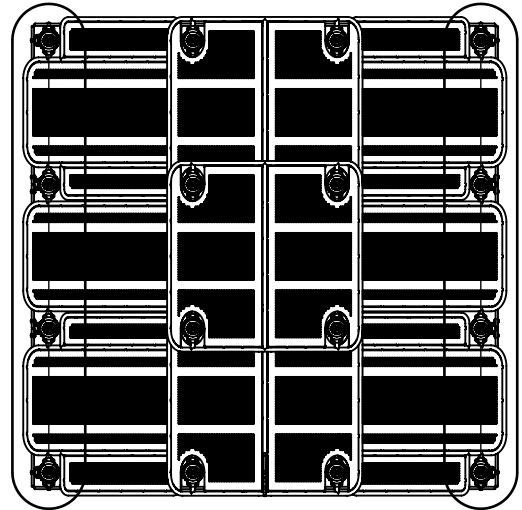

Elevation View - Outside Collars

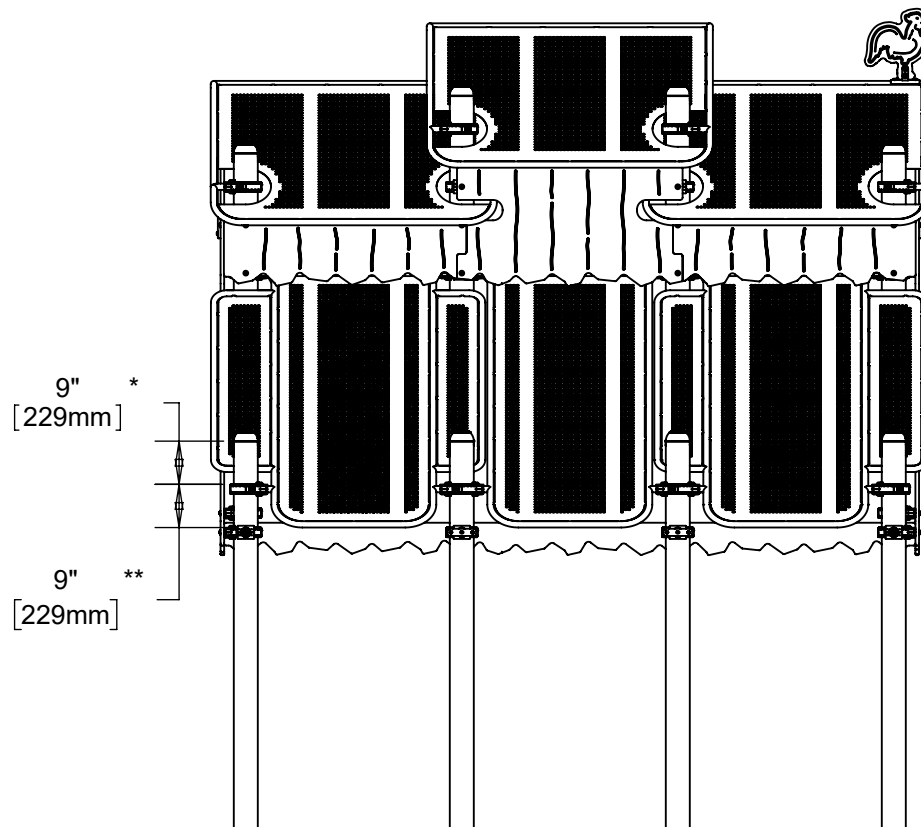

Step 2 For Multi-Roof Only

Locate and attach collars at heights shown in Elevation View - Inside Collars. (See Note B)

* Height shown from top of post to top of collar.

** Height shown from top of collar to top of collar.

Top View - Inside Collars

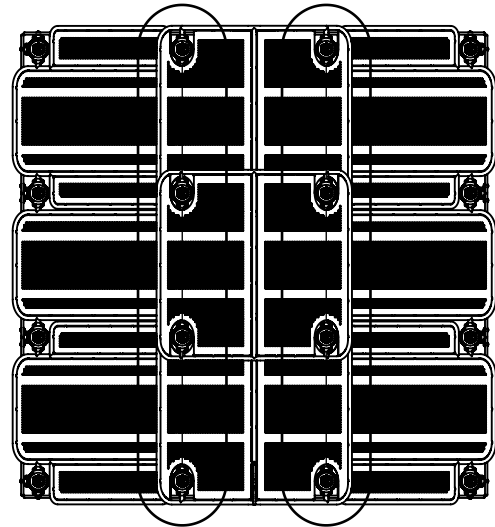

Elevation View - Inside Collars

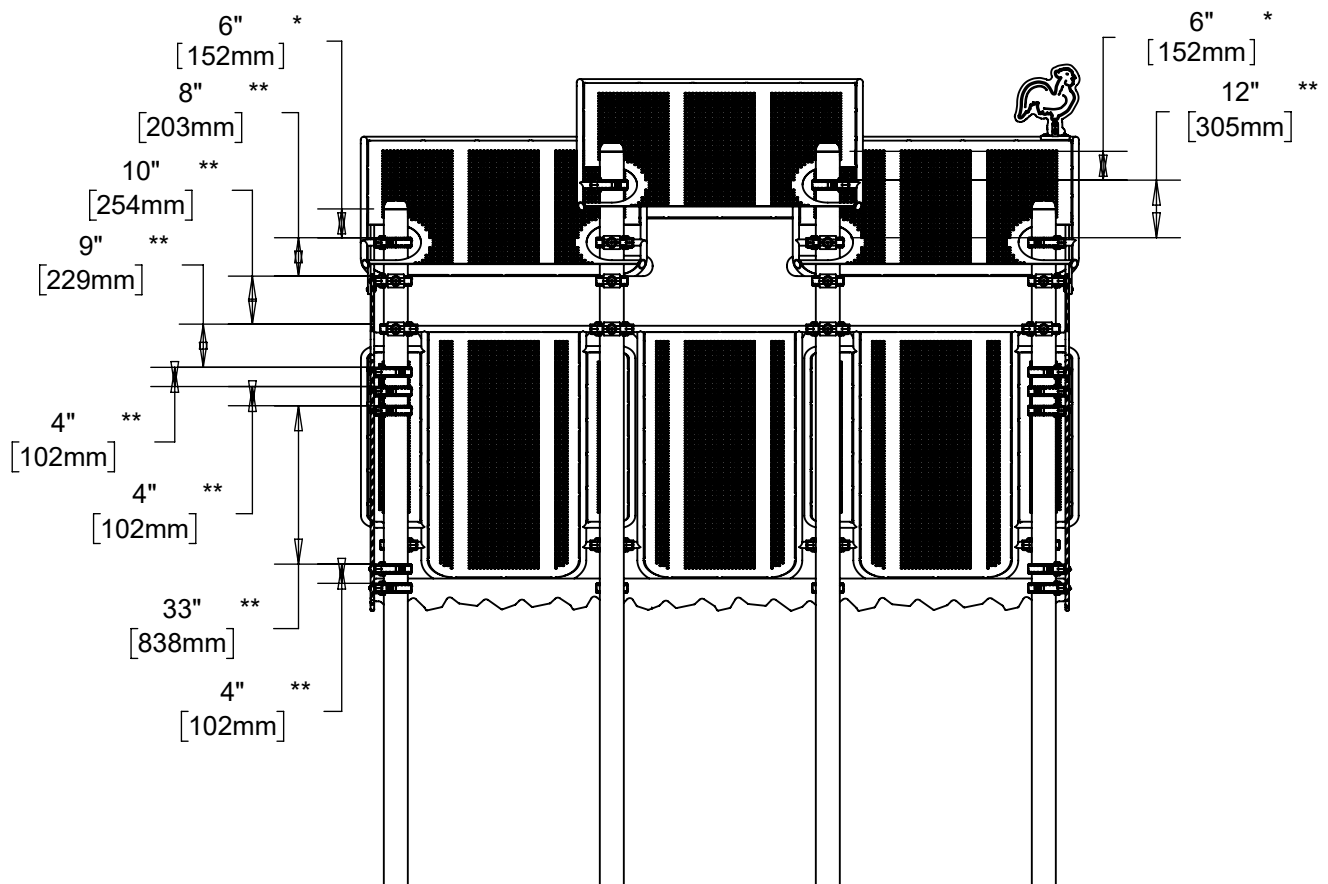

Step 3 For Single Roof Only

Locate and attach collars at heights shown in Elevation View. (See Note B)

* Height shown from top of post to top of collar.

** Height shown from top of collar to top of collar.

Top View

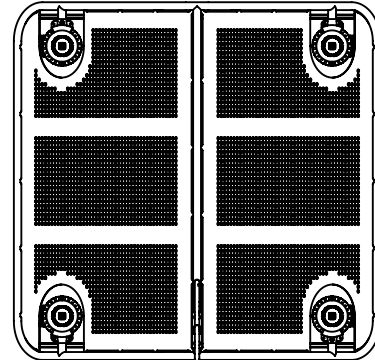

Elevation View

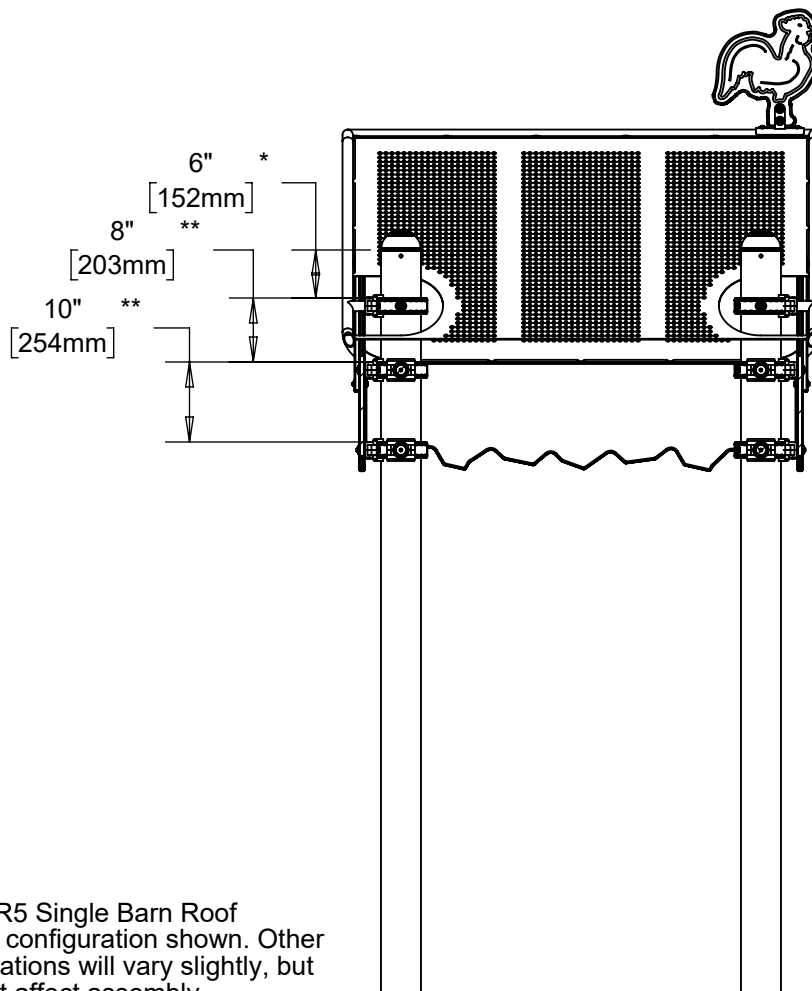

NOTE: R5 Single Barn Roof
Rooster configuration shown. Other
configurations will vary slightly, but
does not affect assembly.

Step 4 (Factory Assembled)

Attach Window Trim to Center Gable Wall as shown in Figure 4. (See Note A)

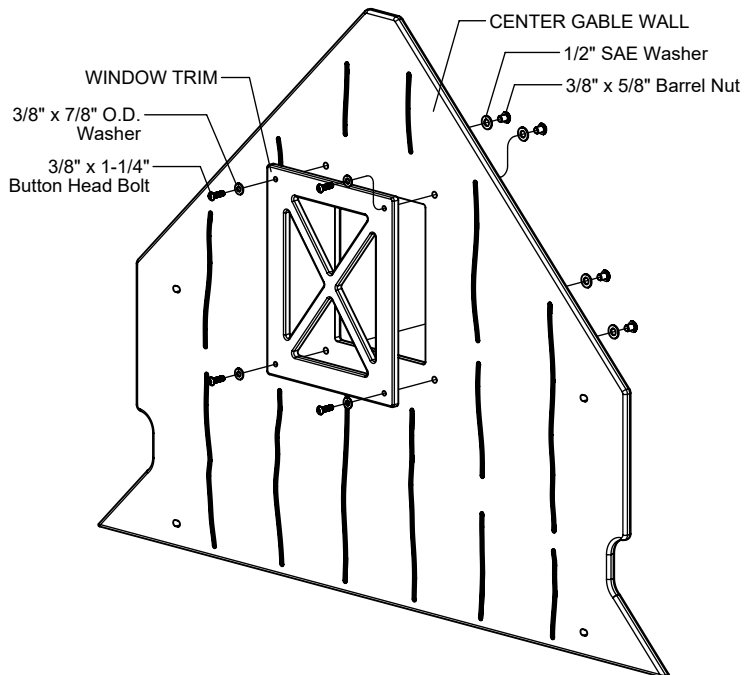

FIGURE 4

Step 5 For Rooster Version Only

Attach Rooster Bracket to Shade Roof Rooster as shown in Figure 5. (See Note A)

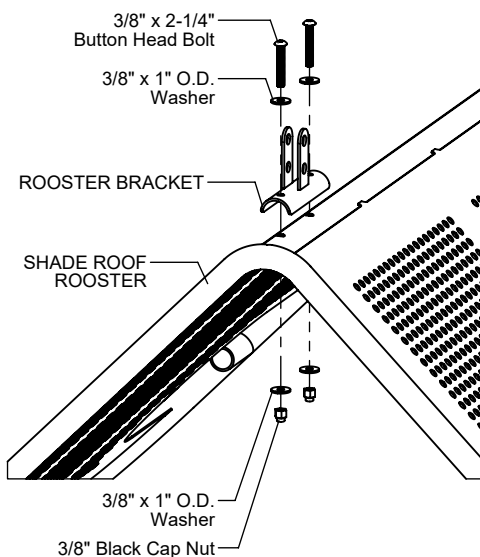

FIGURE 5

Step 6 For Rooster Version Only

Attach Rooster to Rooster Bracket as shown in Figure 6. (See Note A)

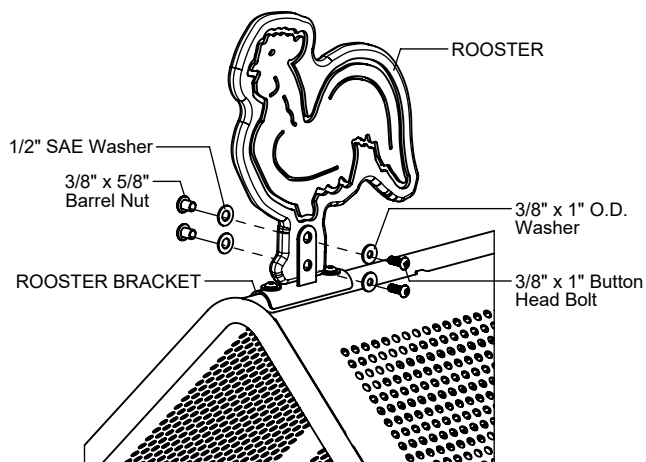

FIGURE 6

Step 7

Attach all Barn and Gable Shade Roofs by stand-offs to collars as shown in Figure 1.1. (See Notes A & B)

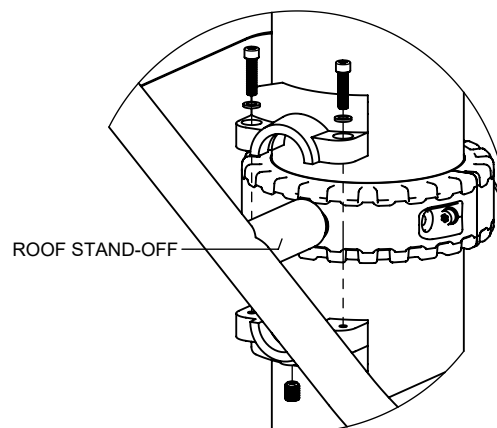

Figure 1.1

Step 8

Attach all Wall Panels to collars as shown in Figure 1.2. (See Notes A & B)

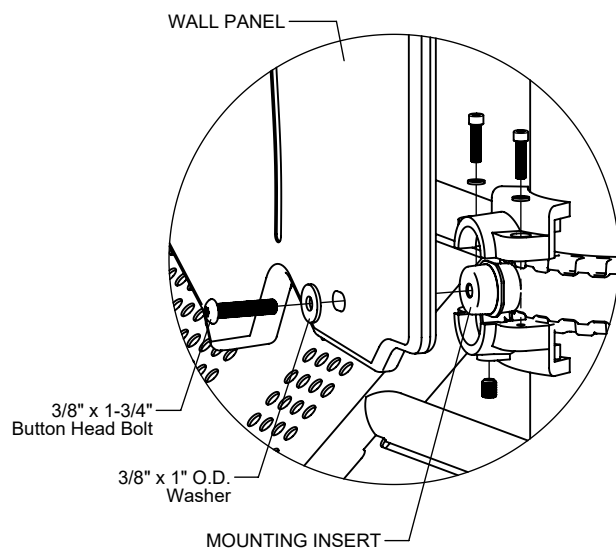

Figure 1.2

Step 9

Attach Panel Brackets to collars as shown in Figure 1.3. (See Notes A & B)

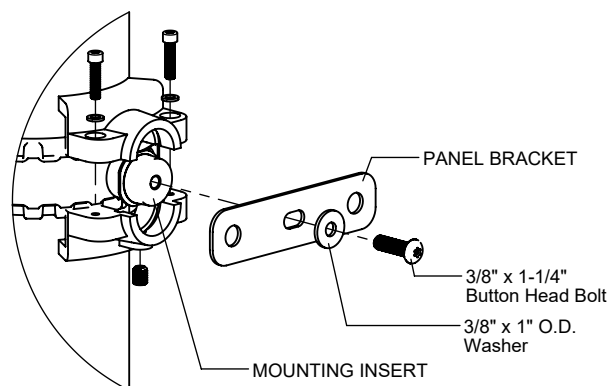

Figure 1.3

Step 10

Attach Center Skirt to Panel Brackets as shown in Figure 7.
(See Note A)

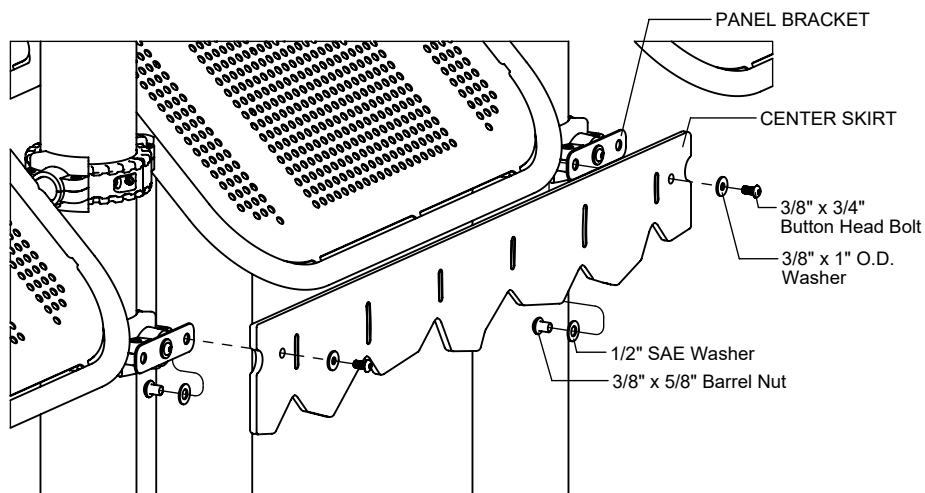

FIGURE 7

Step 11

Attach Left and Right Skirts to Panel Brackets and collars as shown in Figure 8. (See Note A)

NOTE: Left Skirt shown.

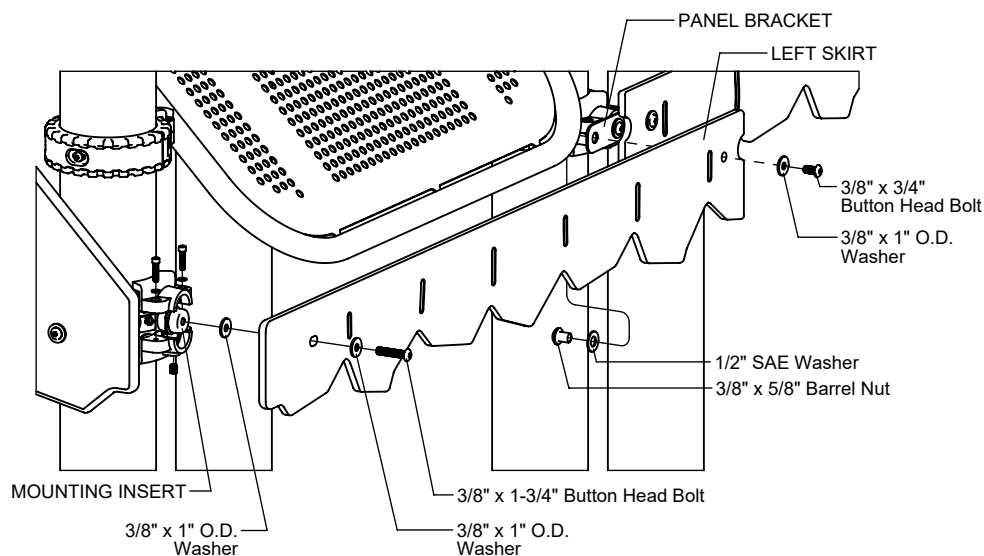

FIGURE 8

Step 12

Fully tighten all fasteners according to the
"TIGHTENING TORQUE FOR HARDWARE"
section of the Installation Manual.

BARN ROOF ASSEMBLY R5

INSTALLATION INSTRUCTIONS

R5-18092
Page 10 of 11

Parts List

S-18092-R5		
Part #	DESCRIPTION	QTY
AF-7263	Barn Roof Panel Bracket R5	4
EE-4668	Rooster For Post	1
EF-7262-CS	Barn Roof Panels R5 - Center Skirt	2
EF-7262-CW	Barn Roof Panels R5 - Center Wall	2
EF-7262-IW	Barn Roof Panels R5 - Inside Wall	2
EF-7262-LG	Barn Roof Panels R5 - Left Gable Wall	2
EF-7262-LO	Barn Roof Panels R5 - Left Outside Wall	2
EF-7262-LS	Barn Roof Panels R5 - Left Skirt	2
EF-7262-RG	Barn Roof Panels R5 - Right Gable Wall	2
EF-7262-RO	Barn Roof Panels R5 - Right Outside Wall	2
EF-7262-RS	Barn Roof Panels R5 - Right Skirt	2
FS-18016-R5	Steel Gable Shade Roof R5	1
FS-18016-R5BFL	Steel Gable Shade Roof Baffles R5	1
FS-18016-R5RST	Steel Gable Shade Roof Rooster R5	1
FS-18092-INS	Barn Roof Inside R5	2
FS-18092-OUT	Barn Roof Outside R5	4
FS-18092-RST	Barn Roof Rooster Bracket	1
GE-7015	Mounting Insert	56
HS-1001-R5	Socket Clamp Set R5	92
9103032-TR	Bolt Button Head 3/8" x 3/4"	8
9103052-TR	Bolt Button Head 3/8" x 1"	2
9103062-TR	Bolt Button Head 3/8" x 1-1/4"	4
9103082-TR	Bolt Button Head 3/8" x 1-3/4"	52
9103102-TR	Bolt Button Head 3/8" x 2-1/4"	2
9333002	Washer Flat 3/8" x 1" O.D. x .100" thick	74
9345002	Washer Flat SAE 1/2"	10
9413162-BLK	Nut Lock 3/8" w/ Black Cap	2
9443022-TR	Nut Barrel 3/8" x 5/8" BH	10

S-18092-1R5		
Part #	DESCRIPTION	QTY
EE-4668	Rooster For Post	1
EF-7262-OW	Barn Roof Panels R5 - Outside Wall	2
FS-18016-R5RST	Steel Gable Shade Roof Rooster R5	1
FS-18092-RST	Barn Roof Rooster Bracket	1
GE-7015	Mounting Insert	16
HS-1001-R5	Socket Clamp Set R5	20
9103052-TR	Bolt Button Head 3/8" x 1"	2
9103082-TR	Bolt Button Head 3/8" x 1-3/4"	16
9103102-TR	Bolt Button Head 3/8" x 2-1/4"	2
9333002	Washer Flat 3/8" x 1" O.D. x .100" thick	22
9345002	Washer Flat SAE 1/2"	2
9413162-BLK	Nut Lock 3/8" w/ Black Cap	2
9443022-TR	Nut Barrel 3/8" x 5/8" BH	2

S-18092-23R5		
Part #	DESCRIPTION	QTY
AF-7263	Barn Roof Panel Bracket R5	2
EE-4668	Rooster For Post	1
EF-0134-L	Barn Roof 23 R5 - Left End Skirt	1
EF-0134-R	Barn Roof 23 R5 - Right End Skirt	1
EF-0135-L	Barn Roof 23 R5 - Left End Wall	1
EF-0135-R	Barn Roof 23 R5 - Right End Wall	1
EF-7262-CW	Barn Roof Panels R5 - Center Wall	1
EF-7262-LG	Barn Roof Panels R5 - Left Gable Wall	1
EF-7262-LO	Barn Roof Panels R5 - Left Outside Wall	1
EF-7262-LS	Barn Roof Panels R5 - Left Skirt	1
EF-7262-RG	Barn Roof Panels R5 - Right Gable Wall	1
EF-7262-RO	Barn Roof Panels R5 - Right Outside Wall	1
EF-7262-RS	Barn Roof Panels R5 - Right Skirt	1
FS-18016-R5BFL	Steel Gable Shade Roof Baffles R5	1
FS-18016-R5RST	Steel Gable Shade Roof Rooster R5	1
FS-18092-23END	Barn Roof End R5	2
FS-18092-OUT	Barn Roof Outside R5	2
FS-18092-RST	Barn Roof Rooster Bracket	1
GE-7015	Mounting Insert	34
HS-1001-R5	Socket Clamp Set R5	58
9103032-TR	Bolt Button Head 3/8" x 3/4"	4
9103052-TR	Bolt Button Head 3/8" x 1"	2
9103062-TR	Bolt Button Head 3/8" x 1-1/4"	2
9103082-TR	Bolt Button Head 3/8" x 1-3/4"	32
9103102-TR	Bolt Button Head 3/8" x 2-1/4"	2
9333002	Washer Flat 3/8" x 1" O.D. x .100" thick	48
9345002	Washer Flat SAE 1/2"	6
9413162-BLK	Nut Lock 3/8" w/ Black Cap	2
9443022-TR	Nut Barrel 3/8" x 5/8" BH	6

S-18092-1R5-FR		
PART #	DESCRIPTION	QTY
EF-7262-OW	Barn Roof Panels R5 - Outside Wall	2
FS-18016-R5	Steel Gable Shade Roof R5	1
GE-7015	Mounting Insert	16
HS-1001-R5	Socket Clamp Set R5	20
9103082-TR	Bolt Button Head 3/8" x 1-3/4"	16
9333002	Washer Flat 3/8" x 1" O.D. x .100" thick	16



www.playcraftsystems.com
For Customer Service Call
800.333.8519 (U.S.A.) or 541.955.9199 (International)

Rev D
2/18/2025

BARN ROOF ASSEMBLY R5

INSTALLATION INSTRUCTIONS

R5-18092
Page 11 of 11

Assembled Parts List

S-18092-R5		
Part #	DESCRIPTION	QTY
EF-7262-CG	Barn Roof Panels R5 - Center Gable Wall	2
EF-7262-WT	Barn Roof Panels R5 - Window Trim	2
9103062-TR	Bolt Button Head 3/8" x 1-1/4"	8
9333042	Washer Flat 3/8" x 7/8" O.D.	8
9345002	Washer Flat SAE 1/2"	8
9443022-TR	Nut Barrel 3/8" x 5/8" BH	8

S-18092-1R5		
Part #	DESCRIPTION	QTY
EF-7262-SG	Barn Roof Panels R5 - Single Gable Wall	2
EF-7262-WT	Barn Roof Panels R5 - Window Trim	2
9103062-TR	Bolt Button Head 3/8" x 1-1/4"	8
9333042	Washer Flat 3/8" x 7/8" O.D.	8
9345002	Washer Flat SAE 1/2"	8
9443022-TR	Nut Barrel 3/8" x 5/8" BH	8

S-18092-23R5		
Part #	DESCRIPTION	QTY.
EF-7262-CG	Barn Roof Panels R5 - Center Gable Wall	1
EF-7262-WT	Barn Roof Panels R5 - Window Trim	1
9103062-TR	Bolt Button Head 3/8" x 1-1/4"	4
9333042	Washer Flat 3/8" x 7/8" O.D.	4
9345002	Washer Flat SAE 1/2"	4
9443022-TR	Nut Barrel 3/8" x 5/8" BH	4

S-18092-1R5-FR		
PART #	DESCRIPTION	QTY
EF-7262-SG	Barn Roof Panels R5 - Single Gable Wall	2
EF-7262-WT	Barn Roof Panels R5 - Window Trim	2
9103062-TR	Bolt Button Head 3/8" x 1-1/4"	8
9333042	Washer Flat 3/8" x 7/8" O.D.	8
9345002	Washer Flat SAE 1/2"	8
9443022-TR	Nut Barrel 3/8" x 5/8" BH	8

Specifications

BARN & GABLE SHADE ROOFS R5:

Shall be fabricated using 1.315" O.D. 12 gauge steel tubing with welded 14 gauge sheet steel panels. The Barn Roofs R5 shall have a multi-stage baked-on powder coat finish.

BARN ROOF PANELS & ROOSTER:

Shall be made from high density 3/4" sheet plastic specially formulated for optimum UV stability and color retention.

BARN ROOF PANEL BRACKET R5:

Shall be punched from 12 gauge sheet steel. The Barn Roof Panel Bracket R5 shall have a multi-stage baked-on powder coat finish.

MOUNTING INSERT:

Shall be precision die-cast from a high-strength aluminum alloy

SOCKET CLAMPS:

Shall be two-part and precision die-cast from a high strength aluminum alloy. The Socket Clamps have a multi-stage baked-on powder coat finish.

HARDWARE:

Shall be stainless steel, zinc/nickel plated or galvanized as required to resist rust and corrosion.

Maintenance

Periodically tighten all screws, bolts and nuts. A periodic inspection of all parts is necessary. If a part is broken or worn, replace immediately. For general maintenance please refer to our Playground Maintenance Manual.



www.playcraftsystems.com
For Customer Service Call
800.333.8519 (U.S.A.) or 541.955.9199 (International)

Rev D
2/18/2025