

IMPORTANT NOTES: Read First

(A) Use liquid thread lock (such as Loctite®) with all threaded hardware. **Important:** Liquid thread lock (prior to curing) helps to eliminate the common problem of "thread seizure" in stainless steel hardware by serving as a lubricant during assembly.

(B) Refer to Installation Manual for R35-1600 R3.5 Panel Assembly and R5-1601 Panel Type 1 (Rotomold) installation instructions.

FIGURE 1
Labyrinth Panel

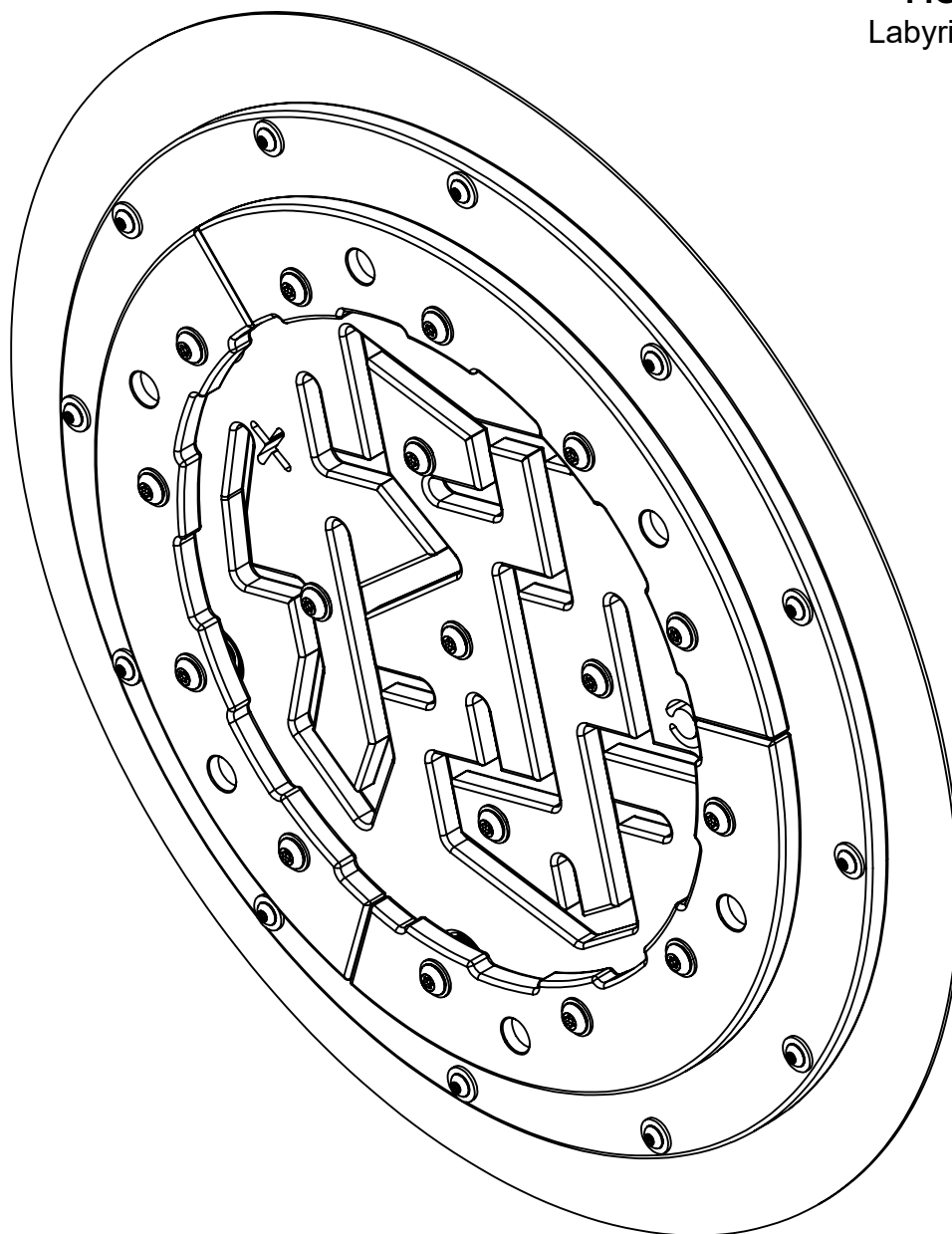

NOTE: Labyrinth Panel to steel panel shown. Other configurations will vary slightly, but does not affect assembly.

Step 1 (Factory Assembled)

Attach Flange Bearings to Roller Bearing as shown in Figure 2.

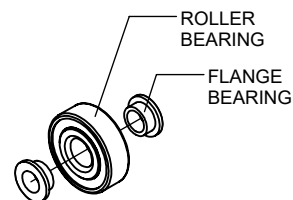

FIGURE 2

Step 2 (Factory Assembled)

Attach Labyrinth Panel Rotator and Labyrinth Panel Retainers to Mounting Ring as shown in Figure 3.
(See Note A)

NOTE: For R35 Panel assemblies, replace the Mounting Ring with the Main Mounting Panel.

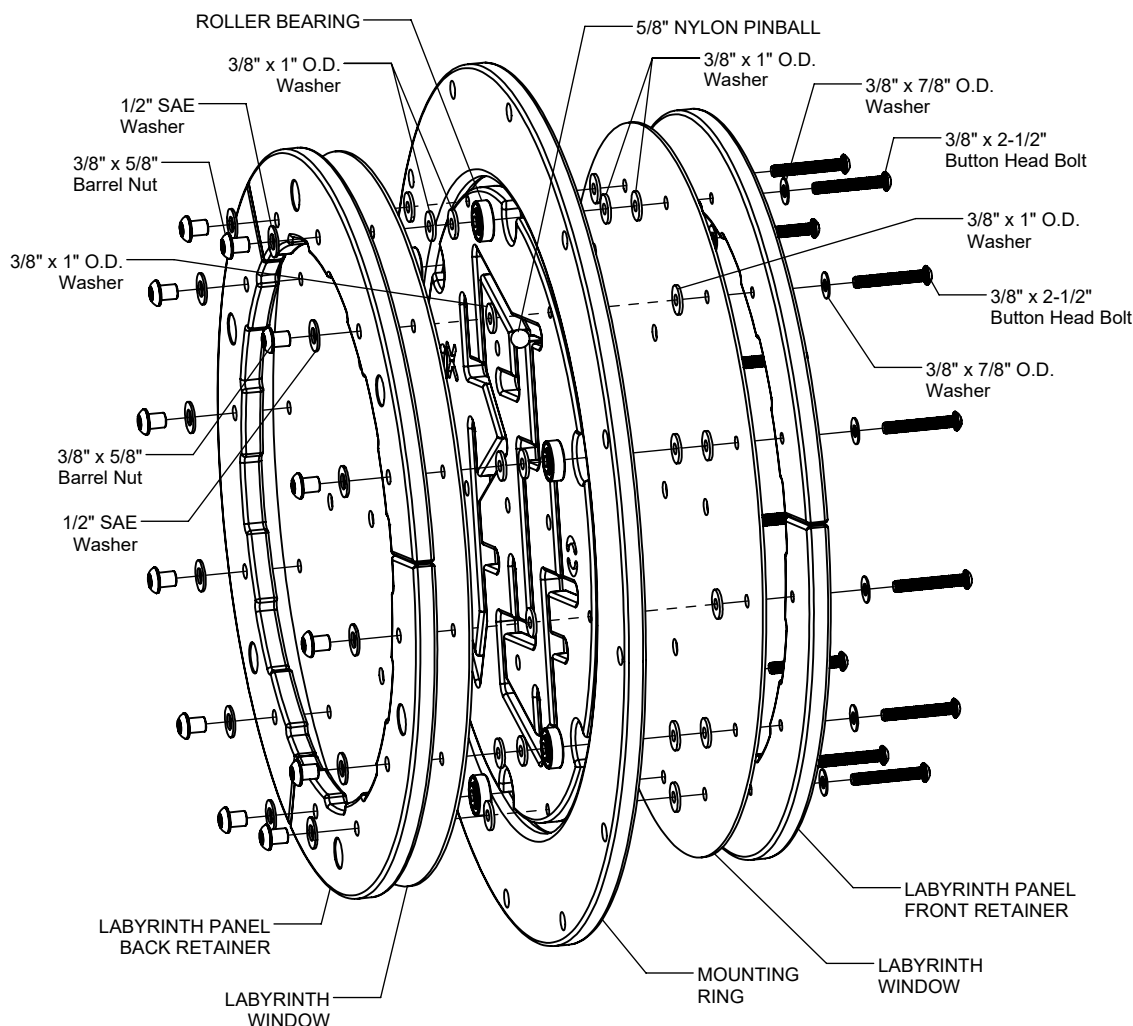

FIGURE 3

Step 3 (Factory Assembled)

Attach Window to Rotator as shown in Figure 4.
(See Note A)

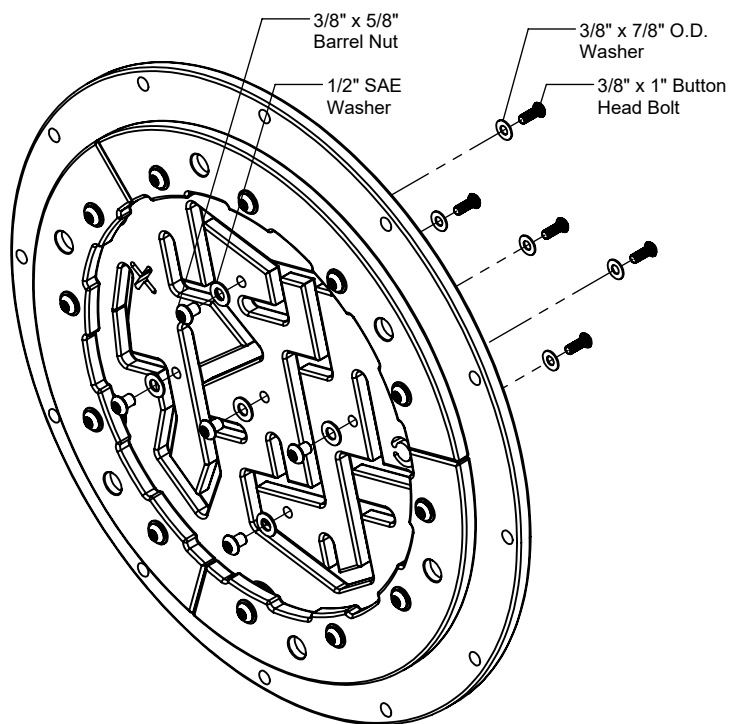

FIGURE 4

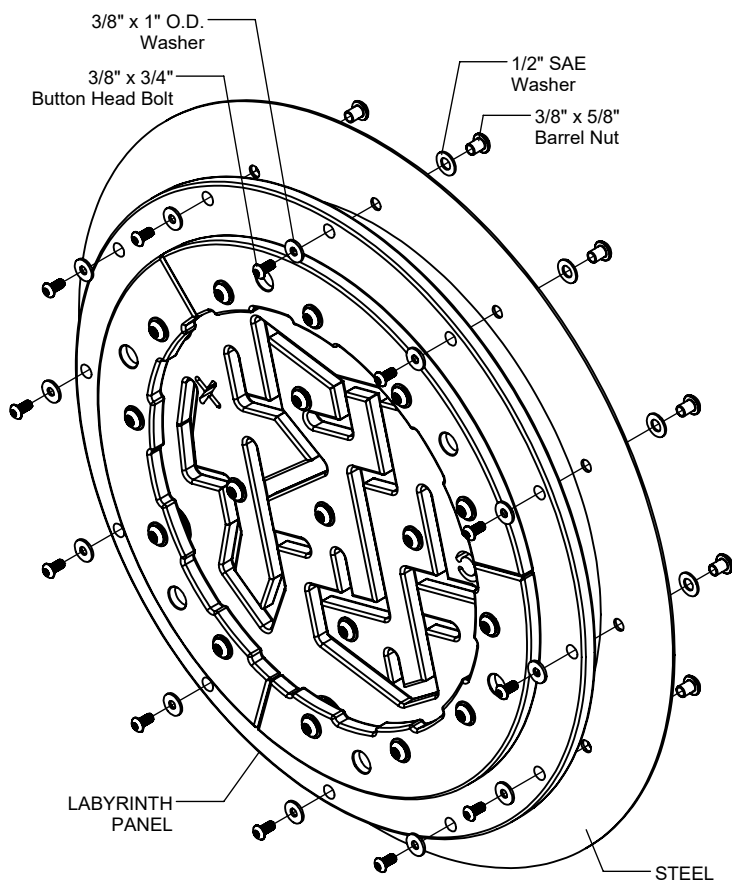

FIGURE 5

Step 4a

For Steel Event Panel Only

Attach Labyrinth Panel to Steel Event Panel
as shown in Figure 5. (See Note A)

NOTE: This step may be factory assembled.
See Bill of Materials for Assembled Parts List.

Step 4b

For HDPE Event Panel Only

Attach Labyrinth Panel to HDPE Event Panel as shown in Figure 6. (See Note A)

NOTE: This step may be factory assembled. See Bill of Materials for Assembled Parts List.

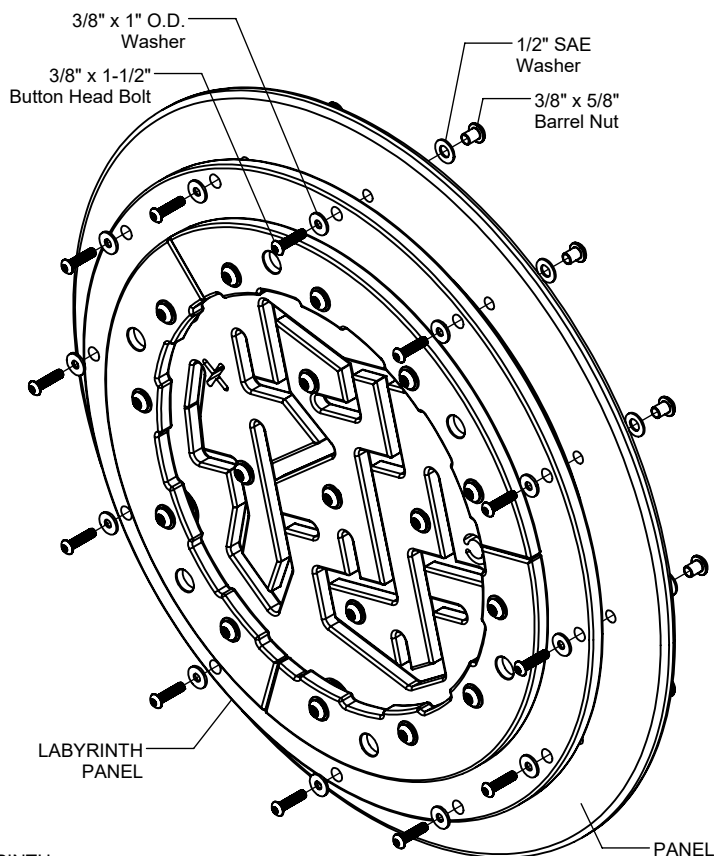

FIGURE 6

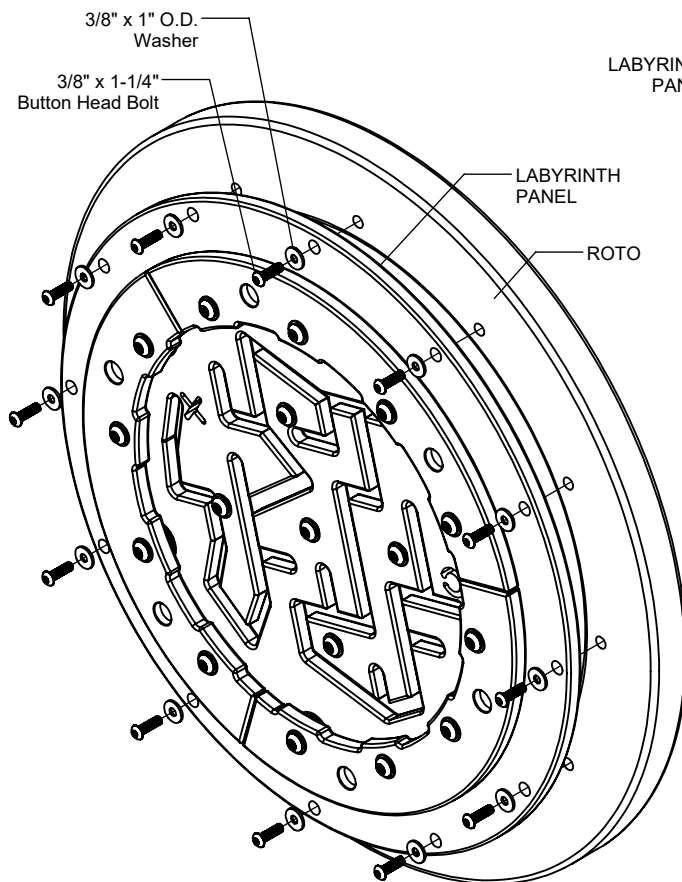

FIGURE 7

Step 4c

For Roto Event Panel Only

Attach Labyrinth Panel to Roto Event Panel as shown in Figure 7. (See Note A)

NOTE: This step may be factory assembled. See Bill of Materials for Assembled Parts List.

Step 5

For Standard R5/R35 Panel Only

Complete standard panel assembly as described in R35-1600 R3.5 Panel Assembly and R5-1601 Panel Type 1 (Rotomold) installation instructions (See Note B)

Step 6

Fully tighten all fasteners according to the "TIGHTENING TORQUE FOR HARDWARE" section of the Installation Manual.

LABYRINTH PANEL INSTALLATION INSTRUCTIONS

1634
Page 5 of 6

Parts List

| STEEL INSERT MOUNT | | |
|--------------------|------------------------------------------|-----|
| Part # | DESCRIPTION | QTY |
| 9103032-TR | Bolt Button Head 3/8" x 3/4" | 12 |
| 9333002 | Washer Flat 3/8" x 1" O.D. x .100" thick | 12 |
| 9345002 | Washer Flat SAE 1/2" | 12 |
| 9443022-TR | Nut Barrel 3/8" x 5/8" BH | 12 |

| HDPE INSERT MOUNT | | |
|-------------------|------------------------------------------|-----|
| Part # | DESCRIPTION | QTY |
| 9103072-TR | Bolt Button Head 3/8" x 1-1/2" | 12 |
| 9333002 | Washer Flat 3/8" x 1" O.D. x .100" thick | 12 |
| 9345002 | Washer Flat SAE 1/2" | 12 |
| 9443022-TR | Nut Barrel 3/8" x 5/8" BH | 12 |

| ROTO INSERT MOUNT | | |
|-------------------|------------------------------------------|-----|
| Part # | DESCRIPTION | QTY |
| 9103062-TR | Bolt Button Head 3/8" x 1-1/4" | 12 |
| 9333002 | Washer Flat 3/8" x 1" O.D. x .100" thick | 12 |

Assembled Parts List

| INSERT MOUNT | | |
|--------------|------------------------------------------|-----|
| Part # | DESCRIPTION | QTY |
| EE-4334 | Labyrinth Window | 2 |
| EF-4246-R | Pin Ball Panel Mounting Ring | 1 |
| EG-8163-BRET | Labyrinth Panel Back Retainer R3.5 | 3 |
| EG-8163-FRET | Labyrinth Panel Front Retainer R3.5 | 3 |
| EG-8163-R | Labyrinth Panel Rotator R3.5 | 1 |
| 481000 | Roller Bearing 1/2"x1-3/8"x7/16" thick | 6 |
| 562000 | Flange Bearing | 12 |
| 579000 | 5/8" Nylon Pinball | 1 |
| 9103052-TR | Bolt Button Head 3/8" x 1" | 5 |
| 9103112-TR | Bolt Button Head 3/8" x 2-1/2" | 12 |
| 9333002 | Washer Flat 3/8" x 1" O.D. x .100" thick | 36 |
| 9333042 | Washer Flat 3/8" x 7/8" O.D. | 17 |
| 9345002 | Washer Flat SAE 1/2" | 17 |
| 9443022-TR | Nut Barrel 3/8" x 5/8" BH | 17 |

Parts List

| R35 DECK MOUNT | | |
|----------------|------------------------------------------|-----|
| Part # | DESCRIPTION | QTY |
| BE-0361-L | R35 Panel Bracket - Left | 1 |
| BE-0361-R | R35 Panel Bracket - Right | 1 |
| GG-8113 | Mounting Lug R3.5 | 2 |
| HS-1001-R35 | Socket Clamp Set R3.5 | 2 |
| 9103052-TR | Bolt Button Head 3/8" x 1" | 4 |
| 9103062-TR | Bolt Button Head 3/8" x 1-1/4" | 2 |
| 9143062-TR | Bolt Shoulder 3/8" x 1-3/8" BH | 2 |
| 9333002 | Washer Flat 3/8" x 1" O.D. x .100" thick | 8 |
| 9345002 | Washer Flat SAE 1/2" | 6 |
| 9413002 | Nut Lock 3/8" | 2 |
| 9443022-TR | Nut Barrel 3/8" x 5/8" BH | 4 |

| R35 GROUND MOUNT | | |
|------------------|--------------------------------|-----|
| Part # | DESCRIPTION | QTY |
| GG-8113 | Mounting Lug R3.5 | 4 |
| HS-1001-R35 | Socket Clamp Set R3.5 | 4 |
| 9143062-TR | Bolt Shoulder 3/8" x 1-3/8" BH | 4 |
| 9345002 | Washer Flat SAE 1/2" | 4 |

Assembled Parts List

| R35 PANEL | | |
|--------------|------------------------------------------|-----|
| Part # | DESCRIPTION | QTY |
| EE-4334 | Labyrinth Window | 2 |
| EG-8161-P | Round Insert Panel R3.5 | 1 |
| EG-8163-BRET | Labyrinth Panel Back Retainer R3.5 | 3 |
| EG-8163-FRET | Labyrinth Panel Front Retainer R3.5 | 3 |
| EG-8163-R | Labyrinth Panel Rotator R3.5 | 1 |
| 481000 | Roller Bearing 1/2"x1-3/8"x7/16" thick | 6 |
| 562000 | Flange Bearing | 12 |
| 579000 | 5/8" Nylon Pinball | 1 |
| 9103052-TR | Bolt Button Head 3/8" x 1" | 5 |
| 9103112-TR | Bolt Button Head 3/8" x 2-1/2" | 12 |
| 9333002 | Washer Flat 3/8" x 1" O.D. x .100" thick | 36 |
| 9333042 | Washer Flat 3/8" x 7/8" O.D. | 17 |
| 9345002 | Washer Flat SAE 1/2" | 17 |
| 9443022-TR | Nut Barrel 3/8" x 5/8" BH | 17 |



www.playcraftsystems.com
For Customer Service Call
800.333.8519 (U.S.A.) or 541.955.9199 (International)

Rev A
1/21/2022

LABYRINTH PANEL INSTALLATION INSTRUCTIONS

1634
Page 6 of 6

Parts List

| R5 GROUND MOUNT | | |
|-----------------|---------------------|-----|
| Part # | DESCRIPTION | QTY |
| HS-1001-R5 | Socket Clamp Set R5 | 4 |

Assembled Parts List

| R5 GROUND MOUNT | | |
|-----------------|------------------------------------------|-----|
| Part # | DESCRIPTION | QTY |
| DF-7107-G | Roto Panel Round-Ground | 1 |
| EE-4334 | Labyrinth Window | 2 |
| EF-4246-R | Pin Ball Panel Mounting Ring | 1 |
| EG-8163-BRET | Labyrinth Panel Back Retainer R3.5 | 3 |
| EG-8163-FRET | Labyrinth Panel Front Retainer R3.5 | 3 |
| EG-8163-R | Labyrinth Panel Rotator R3.5 | 1 |
| GE-0011 | Zinc Collar | 4 |
| LF-0733 | Panel Roto Pipe | 2 |
| 481000 | Roller Bearing 1/2"x1-3/8"x7/16" thick | 6 |
| 562000 | Flange Bearing | 12 |
| 579000 | 5/8" Nylon Pinball | 1 |
| 9103052-TR | Bolt Button Head 3/8" x 1" | 5 |
| 9103062-TR | Bolt Button Head 3/8" x 1-1/4" | 12 |
| 9103112-TR | Bolt Button Head 3/8" x 2-1/2" | 12 |
| 9248112 | Screw Drywall #8 x 2-1/2" Sq Dr | 8 |
| 9263012 | Screw Soc Set 3/8" x 1/2" | 4 |
| 9333002 | Washer Flat 3/8" x 1" O.D. x .100" thick | 48 |
| 9333042 | Washer Flat 3/8" x 7/8" O.D. | 17 |
| 9345002 | Washer Flat SAE 1/2" | 17 |
| 9443022-TR | Nut Barrel 3/8" x 5/8" BH | 17 |

Specifications

PIN BALL PANEL MOUNTING RING, LABYRINTH PANEL ROTATOR AND LABYRINTH PANEL FRONT AND BACK RETAINER:

Shall be made from high density 3/4" sheet plastic specially formulated for optimum UV stability and color retention.

LABYRINTH WINDOW:

Shall be made from .118 thick polycarbonate sheet plastic.

HARDWARE:

Shall be stainless steel, zinc/nickel plated or galvanized as required to resist rust and corrosion.

Parts List

| R5 DECK MOUNT | | |
|---------------|------------------------------------------|-----|
| Part # | DESCRIPTION | QTY |
| BF-7117-L | Roto Panel Bracket Left (R5) | 1 |
| BF-7117-R | Roto Panel Bracket Right (R5) | 1 |
| HS-1001-R5 | Socket Clamp Set R5 | 2 |
| 9103062-TR | Bolt Button Head 3/8" x 1-1/4" | 2 |
| 9103082-TR | Bolt Button Head 3/8" x 1-3/4" | 4 |
| 9333002 | Washer Flat 3/8" x 1" O.D. x .100" thick | 12 |
| 9413002 | Nut Lock 3/8" | 6 |

Assembled Parts List

| R5 DECK MOUNT | | |
|---------------|------------------------------------------|-----|
| Part # | DESCRIPTION | QTY |
| DF-7107 | Roto Panel Round | 1 |
| EE-4334 | Labyrinth Window | 2 |
| EF-4246-R | Pin Ball Panel Mounting Ring | 1 |
| EG-8163-BRET | Labyrinth Panel Back Retainer R3.5 | 3 |
| EG-8163-FRET | Labyrinth Panel Front Retainer R3.5 | 3 |
| EG-8163-R | Labyrinth Panel Rotator R3.5 | 1 |
| GE-0011 | Zinc Collar | 2 |
| LF-0733 | Panel Roto Pipe | 1 |
| 481000 | Roller Bearing 1/2"x1-3/8"x7/16" thick | 6 |
| 562000 | Flange Bearing | 12 |
| 579000 | 5/8" Nylon Pinball | 1 |
| 9103052-TR | Bolt Button Head 3/8" x 1" | 5 |
| 9103062-TR | Bolt Button Head 3/8" x 1-1/4" | 12 |
| 9103112-TR | Bolt Button Head 3/8" x 2-1/2" | 12 |
| 9248112 | Screw Drywall #8 x 2-1/2" Sq Dr | 4 |
| 9263012 | Screw Soc Set 3/8" x 1/2" | 2 |
| 9333002 | Washer Flat 3/8" x 1" O.D. x .100" thick | 48 |
| 9333042 | Washer Flat 3/8" x 7/8" O.D. | 17 |
| 9345002 | Washer Flat SAE 1/2" | 17 |
| 9443022-TR | Nut Barrel 3/8" x 5/8" BH | 17 |

Maintenance

Periodically tighten all screws, bolts and nuts. A periodic inspection of all parts is necessary. If a part is broken or worn, replace immediately. For general maintenance please refer to our Playground Maintenance Manual.



www.playcraftsystems.com
For Customer Service Call
800.333.8519 (U.S.A.) or 541.955.9199 (International)

Rev A
1/21/2022