

## IMPORTANT NOTES: Read First

(A) Use liquid thread lock (such as Loctite®) with all threaded hardware. **Important:** Liquid thread lock (prior to curing) helps to eliminate the common problem of "thread seizure" in stainless steel hardware by serving as a lubricant during assembly.

**FIGURE 1**  
Small Hypno  
Station Panel

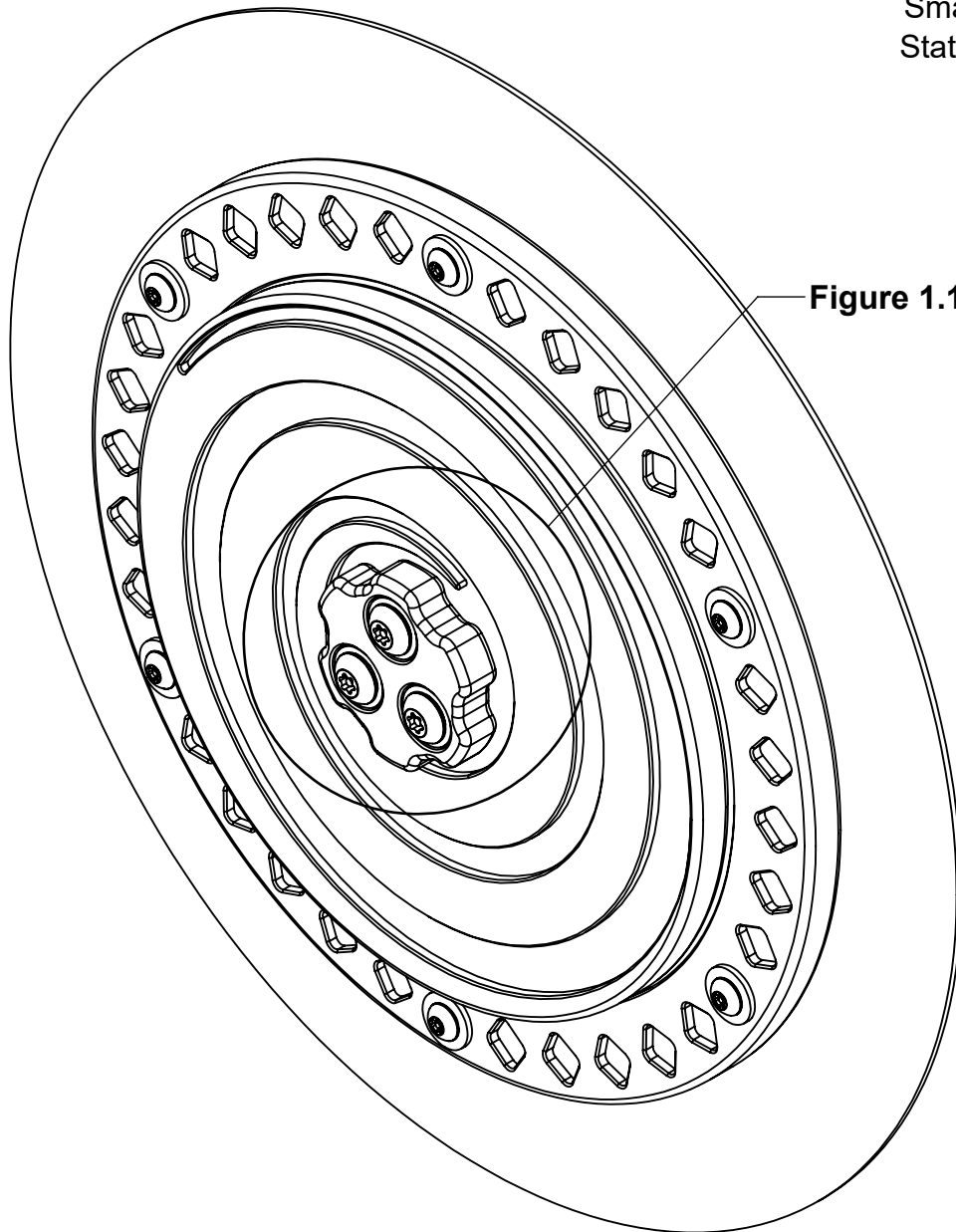

**NOTE:** Small Hypno Station Panel to steel panel shown. Other configurations will vary slightly, but does not affect assembly.

## Step 1 (Factory Assembled)

Attach Handles, Rotators and Axle to Holder as shown in Figure 1.1. (See Note A)

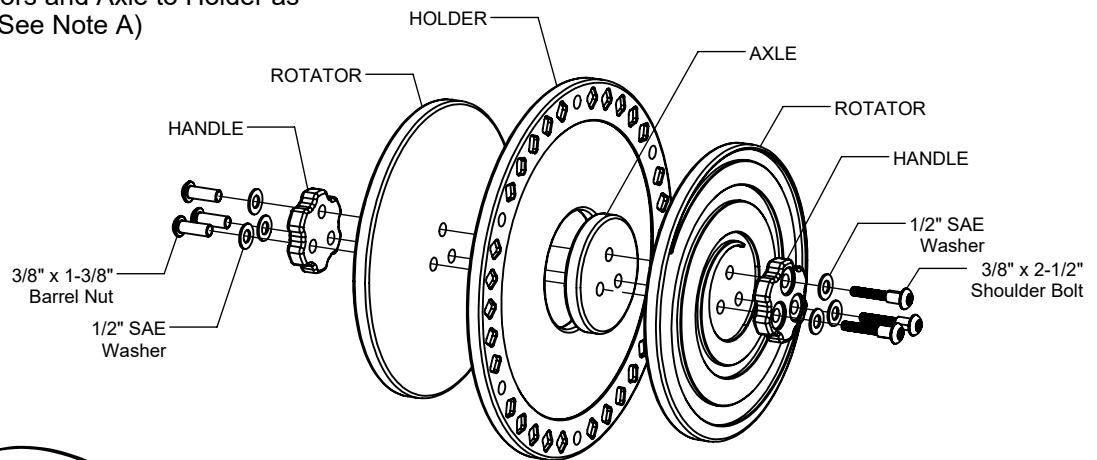

Figure 1.1

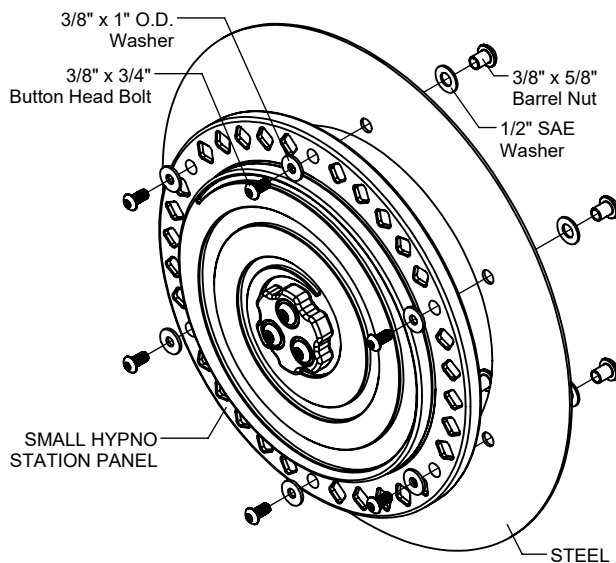

FIGURE 2

## Step 2a

### For Steel Event Panel Only

Attach Small Hypno Station Panel to Steel Event Panel as shown in Figure 2. (See Note A)

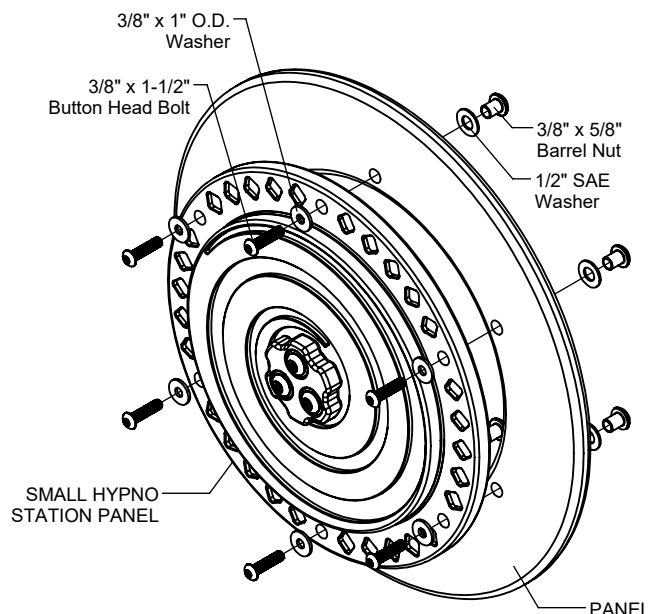

FIGURE 3

## Step 2b

### For HDPE Event Panel Only

Attach Small Hypno Station Panel to HDPE Event Panel as shown in Figure 3. (See Note A)

## Step 3

Fully tighten all fasteners according to the "TIGHTENING TORQUE FOR HARDWARE" section of the Installation Manual.

# SMALL HYPNO STATION PANEL INSTALLATION INSTRUCTIONS

**1690-HYP**  
Page 3 of 3

## Parts List

STEEL MOUNT		
Part #	DESCRIPTION	QTY
9103032-TR	Bolt Button Head 3/8" x 3/4"	6
9333002	Washer Flat 3/8" x 1" O.D. x .100" thick	6
9345002	Washer Flat SAE 1/2"	6
9443022-TR	Nut Barrel 3/8" x 5/8" BH	6

HDPE MOUNT		
Part #	DESCRIPTION	QTY
9103072-TR	Bolt Button Head 3/8" x 1-1/2"	6
9333002	Washer Flat 3/8" x 1" O.D. x .100" thick	6
9345002	Washer Flat SAE 1/2"	6
9443022-TR	Nut Barrel 3/8" x 5/8" BH	6

## Assembled Parts List

Part #	DESCRIPTION	QTY
EE-0685-AXLE	Small Hypno Station Axle	1
EE-0685-HLDR	Small Hypno Station Holder	1
EE-0685-HND	Small Hypno Station Handle	2
EE-0685-ROT	Small Hypno Station Rotator	2
9143112-TR	Bolt Shoulder 3/8" x 2-1/2" BH	3
9345002	Washer Flat SAE 1/2"	6
9443062-TR	Nut Barrel 3/8" x 1-3/8" BH	3

## Specifications

### SMALL HYPNO STATION AXLE,HOLDER, HANDLE & ROTATOR:

Shall be made from high density 3/4" sheet plastic specially formulated for optimum UV stability and color retention.

### HARDWARE:

Shall be stainless steel, zinc/nickel plated or galvanized as required to resist rust and corrosion.

## Maintenance

Periodically tighten all screws, bolts and nuts. A periodic inspection of all parts is necessary. If a part is broken or worn, replace immediately. For general maintenance please refer to our Playground Maintenance Manual.



www.playcraftsystems.com  
For Customer Service Call  
800.333.8519 (U.S.A.) or 541.955.9199 (International)

**Rev A**  
6/22/2021