

IMPORTANT NOTES: Read First

(A) Use liquid thread lock (such as Loctite®) with all threaded hardware. **Important:** Liquid thread lock (prior to curing) helps to eliminate the common problem of "thread seizure" in stainless steel hardware by serving as a lubricant during assembly.

(B) Refer to Installation Manual for R35-1600 R3.5 Panel Assembly, R5-1601 Panel - Type 1 (Rotomolded LLDPE) and R5-1600-STL Steel Panel Assembly R5 installation instructions.

FIGURE 1
Abacus Panel

Figure 1.1

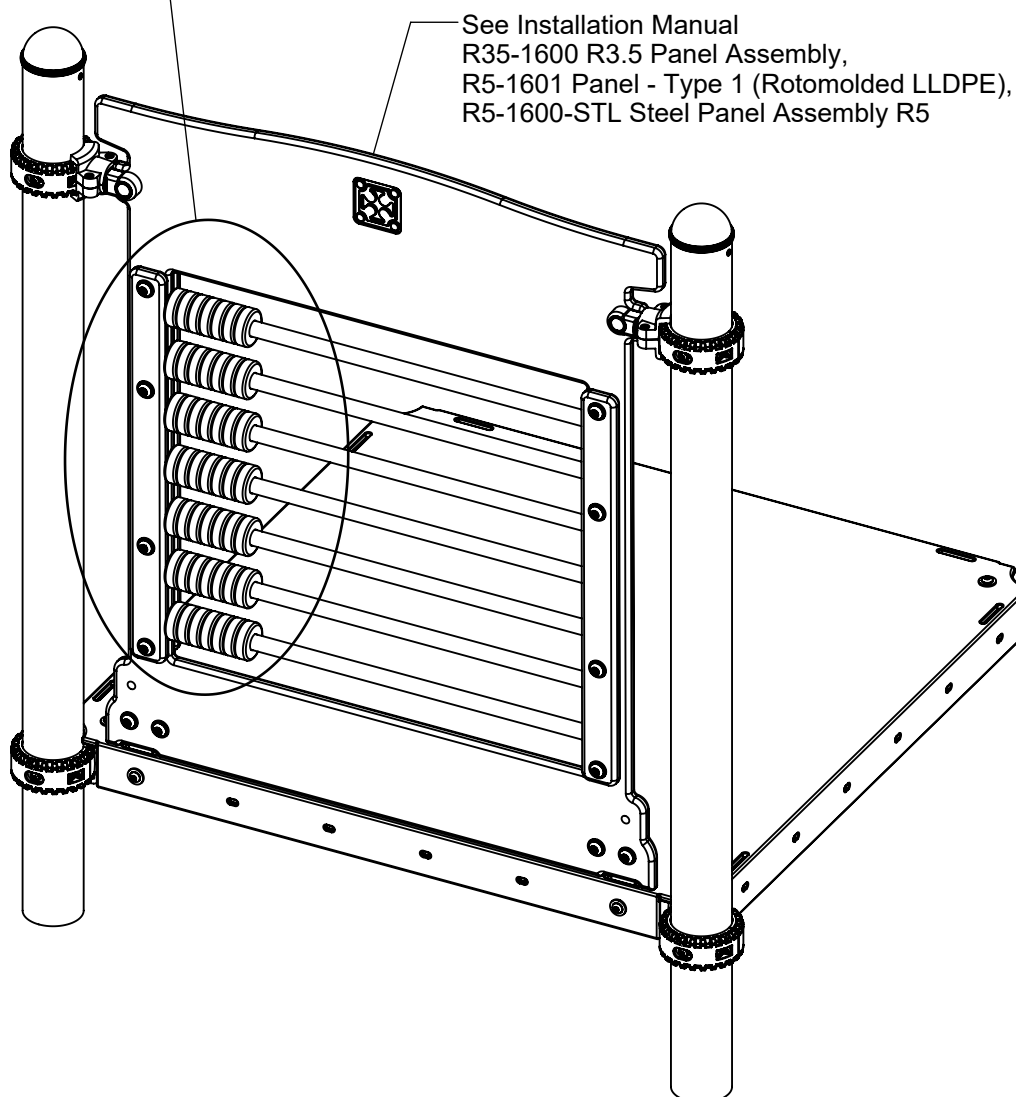

NOTE: Abacus Panel R35 shown. Other configurations will vary slightly, but does not affect assembly.

R35 ABACUS PANEL

Step 1 (Factory Assembled)

Place (7) Abacus Panel Beads onto each Activity Panel Tube 28.5" and attach to Abacus Panel as shown in Figure 1.1. (See Note A)

NOTE: See assembly instruction R35-1600 R3.5 Panel Assembly for complete deck mount or ground mount assembly.

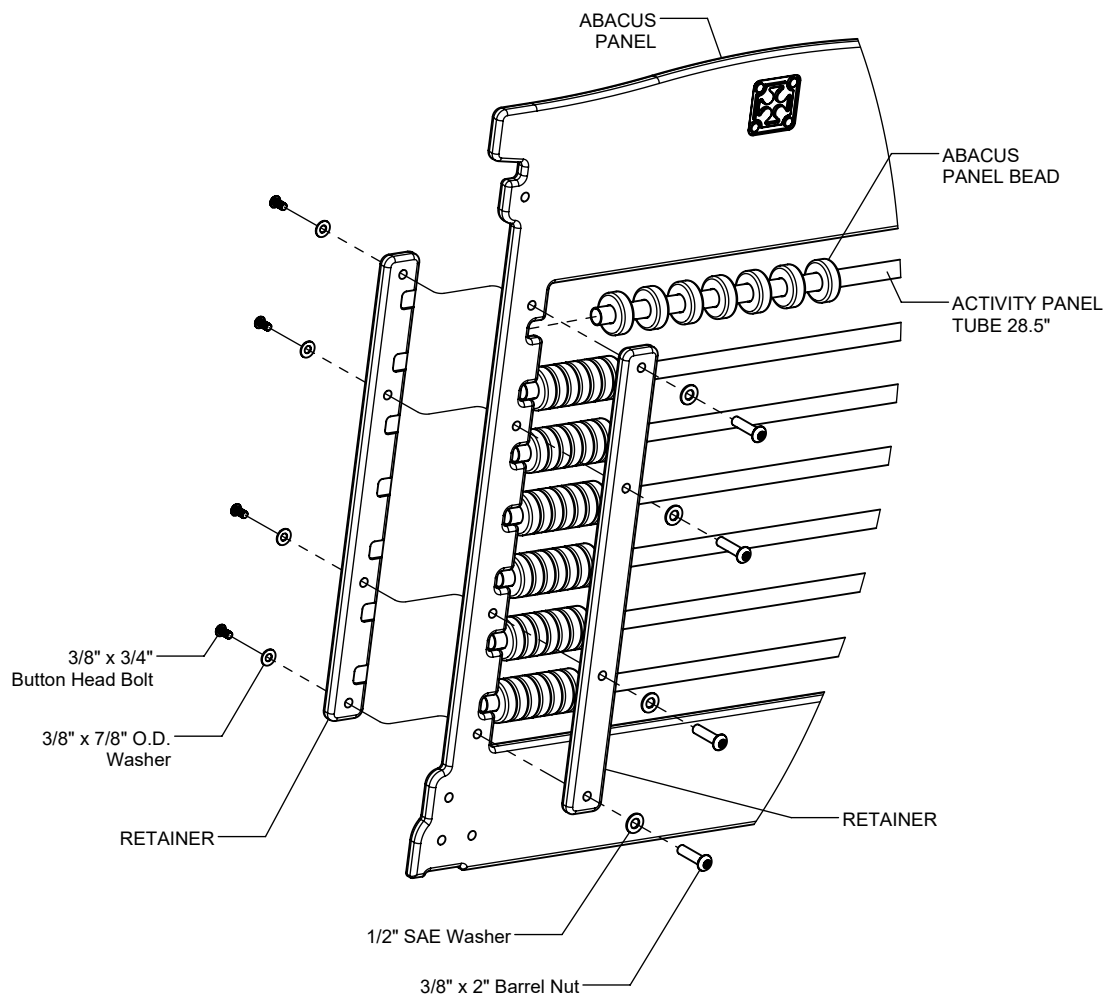

Figure 1.1

R5 ABACUS PANEL

Step 2 (Factory Assembled)

Attach Bracket to Roto Panel as shown in Figure 2 (See Note A). Match drill holes through Bracket into Roto Panel as shown in Figure 3 to allow for Activity Panel Tube 29" to pass through.

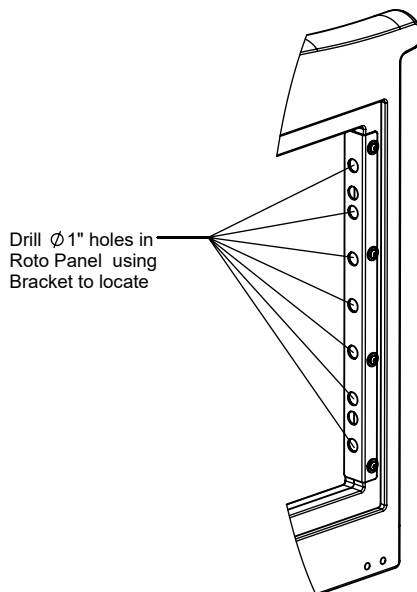

FIGURE 3

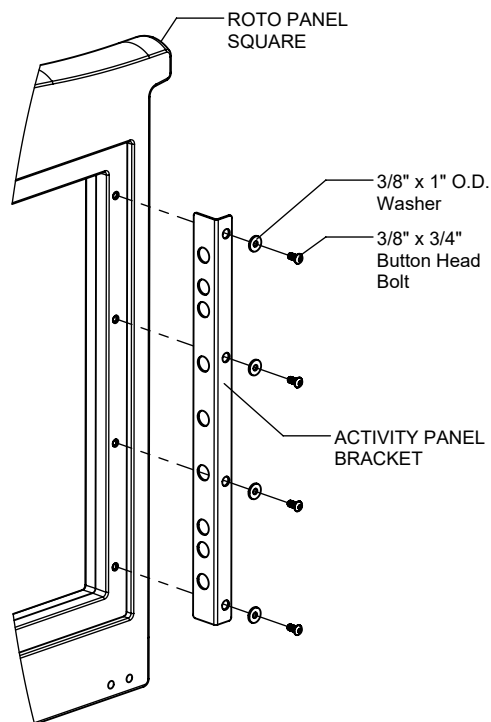

FIGURE 2

Step 3 (Factory Assembled)

Place (7) Abacus Panel Beads onto each Activity Panel Tube of Abacus Tube Weldment and attach to Abacus Panel as shown in Figure 4. (See Note A)

NOTE: See assembly instruction R5-1601 Panel - Type 1 (ROTOMOLDED LLDPE) for complete deck mount or ground mount assembly.

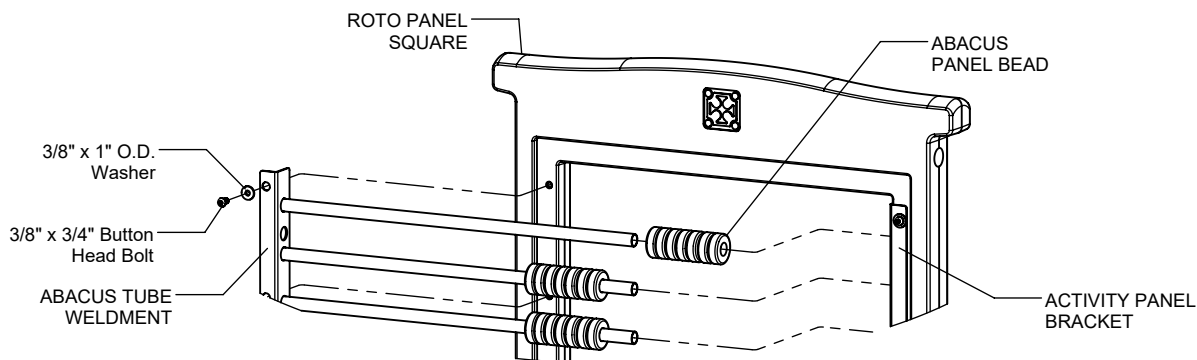

FIGURE 4

R5 STEEL ABACUS PANEL

Step 4 (Factory Assembled)

Place (7) Abacus Panel Beads onto each Activity Panel Tube 29.5" and attach to Abacus Panel as shown in Figure 5. (See Note A)

NOTE: See assembly instruction R5-1600-STL Steel Panel Assembly R5 for complete deck mount or ground mount assembly.

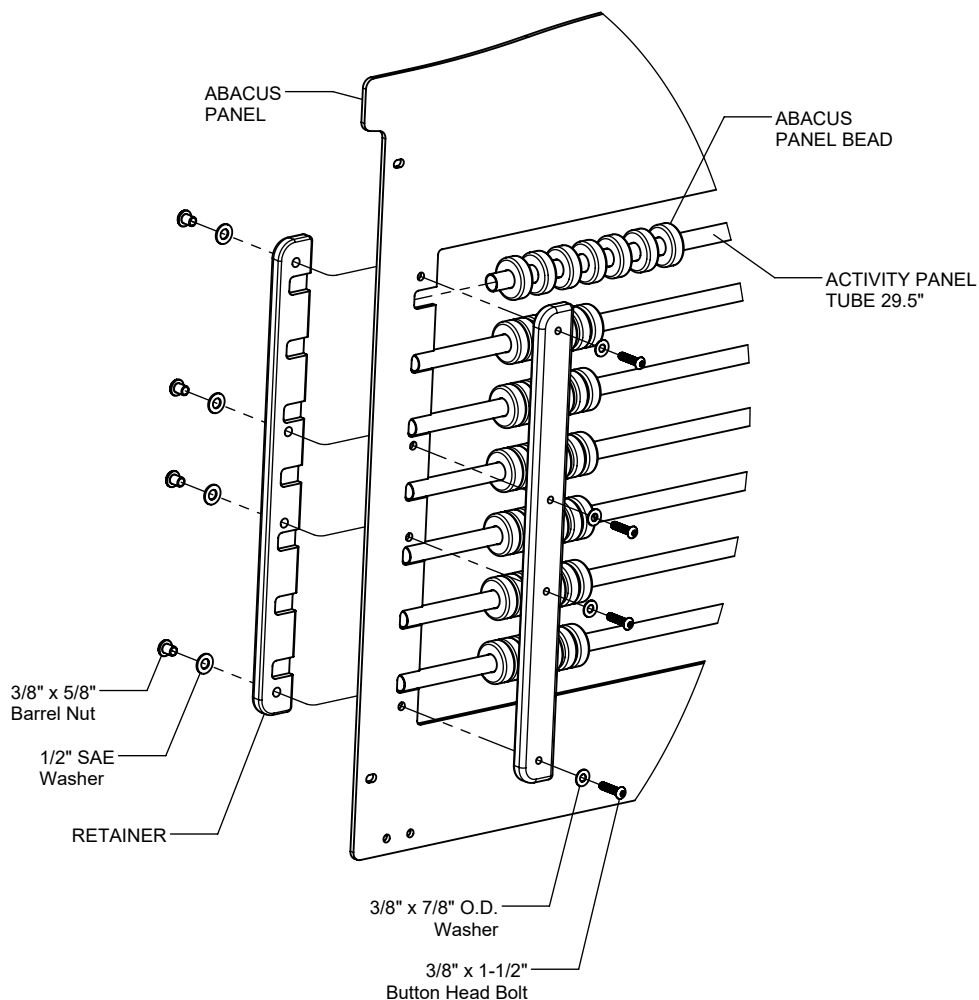

FIGURE 5

Step 5

Fully tighten all fasteners according to the "TIGHTENING TORQUE FOR HARDWARE" section of the Installation Manual.

ABACUS PANEL INSTALLATION INSTRUCTIONS

1627
Page 5 of 5

Assembled Parts List

ABACUS PANEL R35		
PART #	DESCRIPTION	QTY
EG-8127-R	Abacus Panel R3.5 Retainer	4
EG-8172	Abacus Panel R3.5	1
EG-8173	Abacus Panel Bead R3.5	49
LE-0075-2850	Activity Panel Tube 28.5"	7
9103032-TR	Bolt Button Head 3/8" x 3/4"	8
9333042	Washer Flat 3/8" x 7/8" O.D.	8
9345002	Washer Flat SAE 1/2"	8
9443092-TR	Nut Barrel 3/8" x 2" BH	8

ABACUS PANEL R5		
PART #	DESCRIPTION	QTY
BE-4053	Activity Panel Bracket	1
DF-7108-S	Roto Panel Square	1
EG-8173	Abacus Panel Bead R3.5	49
FS-1627	Abacus Panel Weldment Tube R5	1
9103032-TR	Bolt Button Head 3/8" x 3/4"	8
9333002	Washer Flat 3/8" x 1" O.D. x .100" thick	8

STEEL ABACUS PANEL R5		
PART #	DESCRIPTION	QTY
AF-0670	Steel Abacus Panel R5	1
EF-0356-BRET	Steel Abacus Panel Back Retainer R5	2
EF-0356-FRET	Steel Abacus Panel Front Retainer R5	2
EG-8173	Abacus Panel Bead R3.5	49
LE-0075-2950	Activity Panel Tube 29.5"	7
9103072-TR	Bolt Button Head 3/8" x 1-1/2"	8
9333042	Washer Flat 3/8" x 7/8" O.D.	8
9345002	Washer Flat SAE 1/2"	8
9443022-TR	Nut Barrel 3/8" x 5/8" BH	8

Specifications

ABACUS PANEL R35, ABACUS PANEL RETAINER & ABACUS PANEL BEAD:

Shall be made from high density 3/4" sheet plastic specially formulated for optimum UV stability and color retention.

ABACUS ROTO PANEL R5:

Shall be constructed of UV-stabilized, rotationally molded, linear, low density polyethylene with an average wall thickness of .250"

STEEL R5 ABACUS PANEL:

Shall be precision cut from 1/4" sheet steel and will have a multi-stage baked-on powder coat finish.

PANEL BRACKET:

Shall be fabricated using 3/16" sheet steel and will have a multi-stage baked-on powder coat finish.

ACTIVITY PANEL TUBE:

Shall be fabricated using 0.75" galvanized EMT 18 ga. steel tubing and will have a multi-stage baked-on powder coat finish.

HARDWARE:

Shall be stainless steel, zinc/nickel plated or galvanized as required to resist rust and corrosion.

Maintenance

Periodically tighten all screws, bolts and nuts. A periodic inspection of all parts is necessary. If a part is broken or worn, replace immediately. For general maintenance please refer to our Playground Maintenance Manual.



www.playcraftsystems.com
For Customer Service Call
800.333.8519 (U.S.A.) or 541.955.9199 (International)

Rev C
11/14/2024