

IMPORTANT NOTES: Read First

(A) Use liquid thread lock (such as Loctite®) with all threaded hardware. **Important:** Liquid thread lock (prior to curing) helps to eliminate the common problem of "thread seizure" in stainless steel hardware by serving as a lubricant during assembly.

(B) Do not pour concrete until the equipment is completely assembled, leveled and plumbed. Concrete must be allowed to cure completely before using the equipment (at least 72 hours).

(C) An appropriate energy absorbing safety surface is required under and around all playground equipment. Loose fill protective surfacing is shown only as an example for the purpose of this assembly instruction. Other surfacing material may vary in thickness and/or compression depths. See free publication - The Handbook for Public Playground Safety, Publication #325 at www.cpsc.gov for the surfacing appropriate for the fall height of the equipment or consult your surfacing supply representative.

(D) All gaps created (e.g. between panels, between panel and deck, between panel and roof, etc.) must be less than 3-1/2" [89mm] or greater than 9" [229mm].

FIGURE 1
Thunder Wedge

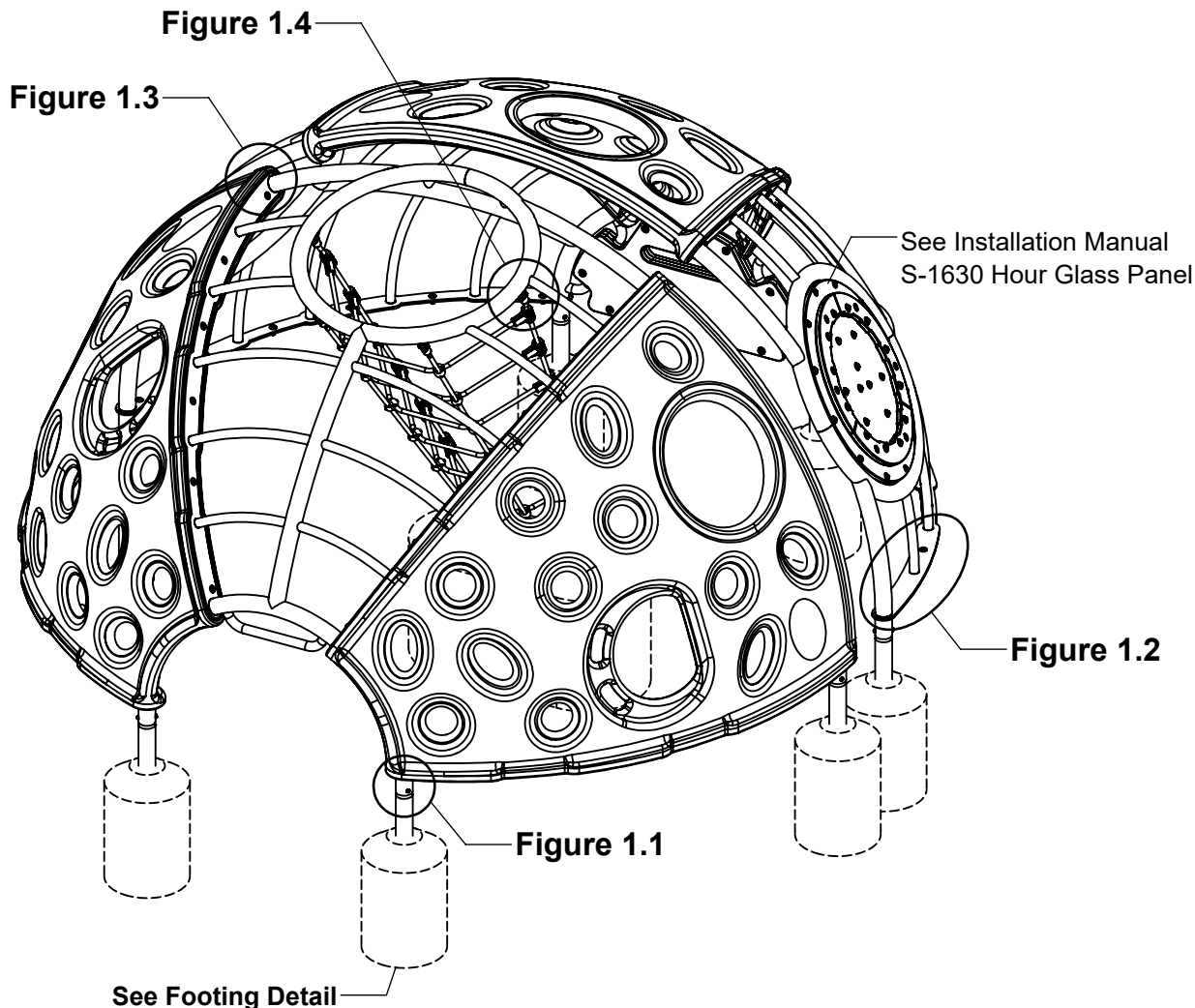

Step 1

Refer to Footing Layout and mark footing hole locations. Dig (4) or (8) Ø 12" footing holes and (1) 18" x 36" oval footing hole. Refer to Footing Detail for depth and details.

IMPORTANT: For areas with soft soil conditions, larger footings may be required.

* Footing depth must be adjusted to compensate for the depth/thickness requirements of selected safety surfacing. See Section 06.1 of the Installation Manual.

Elevation View

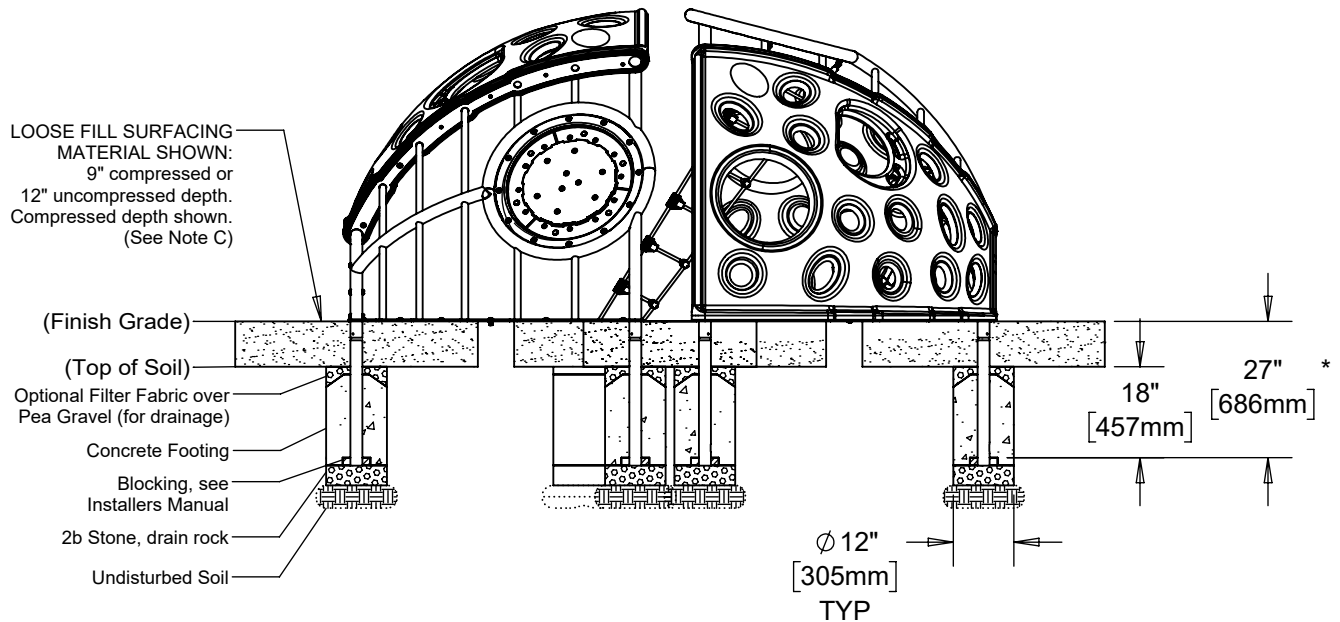

Top View - Footing Layout

Refer to current ASTM 1487 standards.

The Use Zone for Stationary Play equipment shall be no less than 72" [1829mm] in all directions from the perimeter of the play structure.

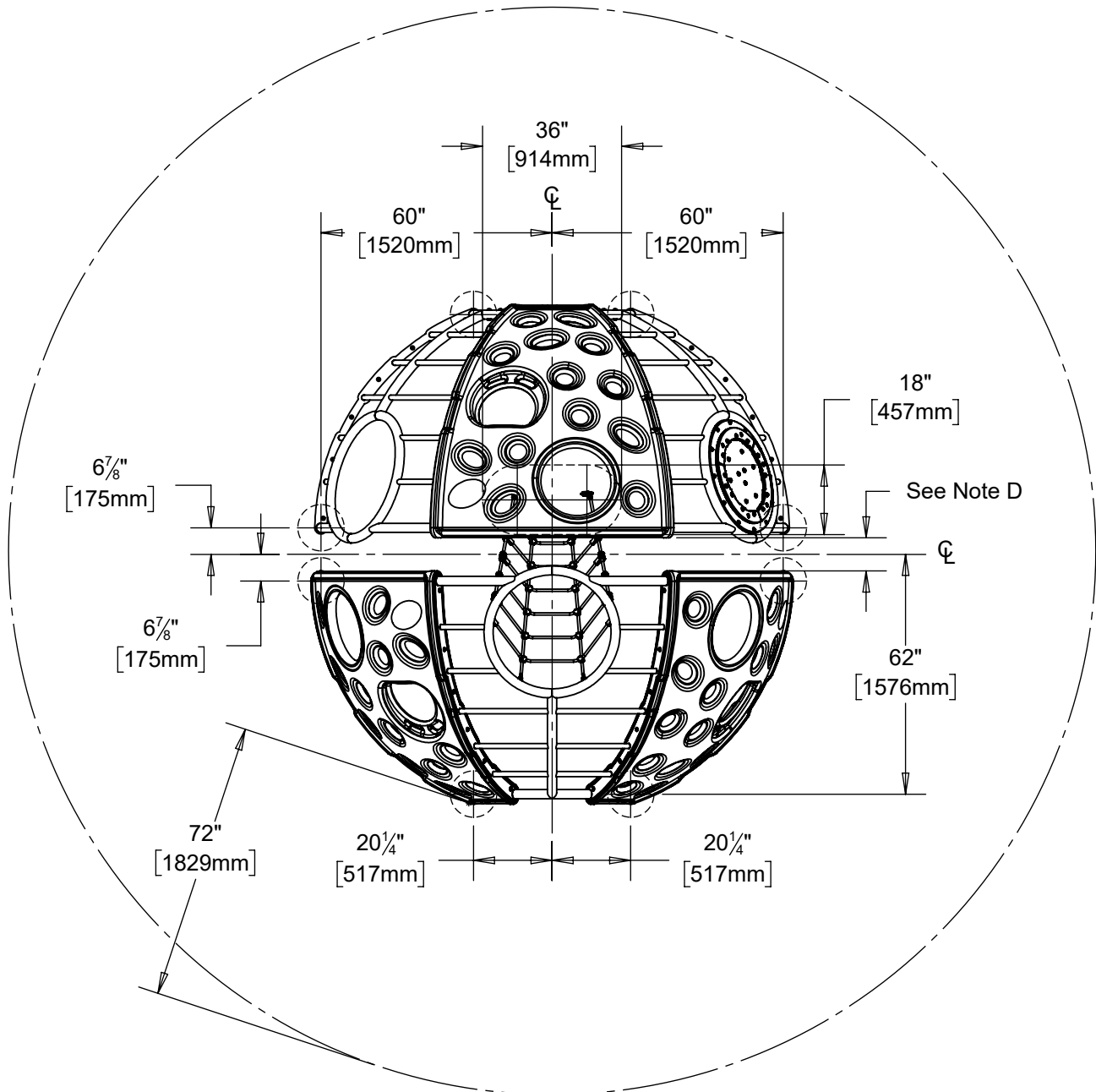

Bottom View - Surface Mount Layout

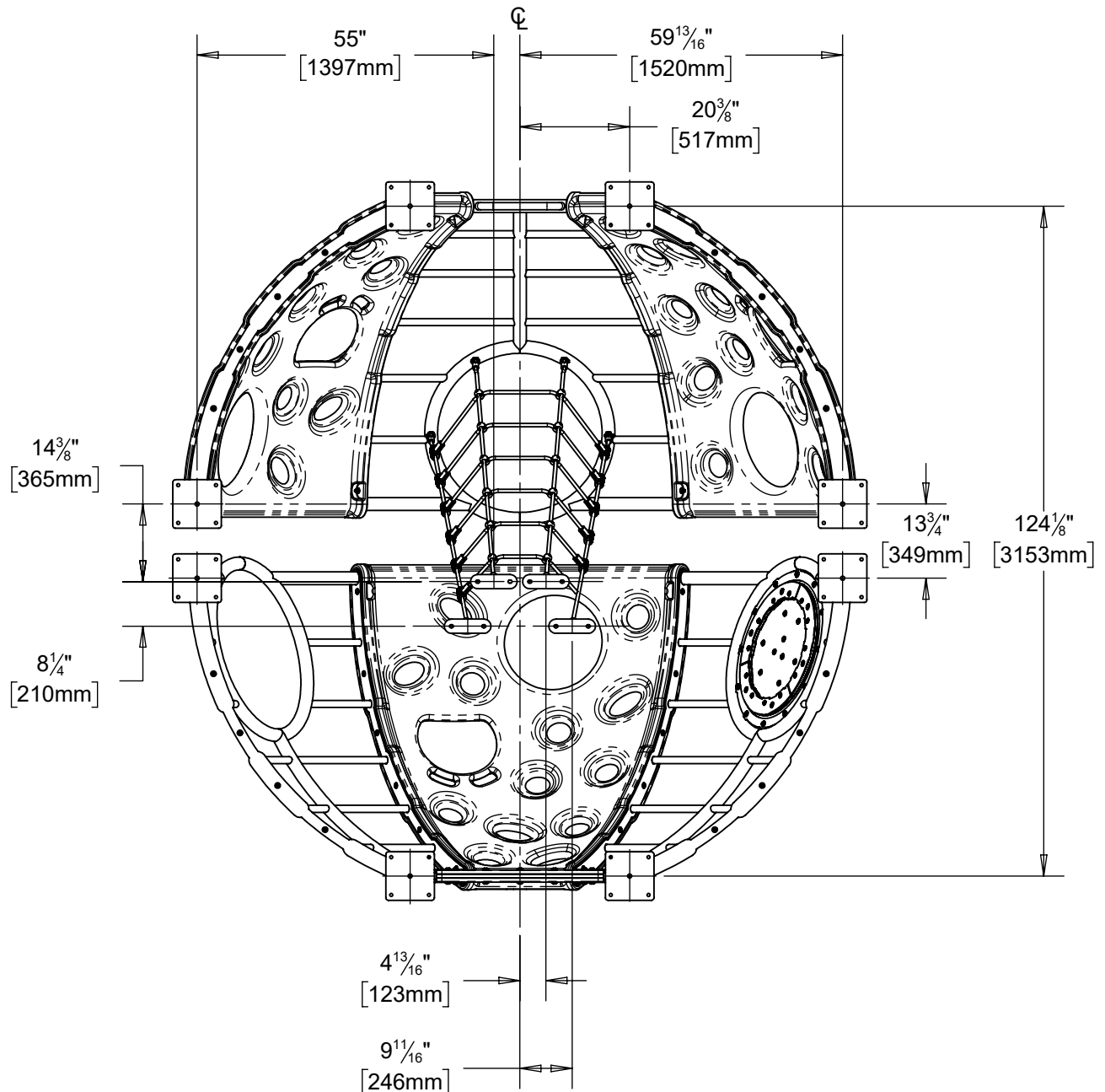

Step 2

For In-Ground Only

Attach Thunder Dome Leg to Thunder Wedge Leg as shown in Figure 1.1. (See Note A)

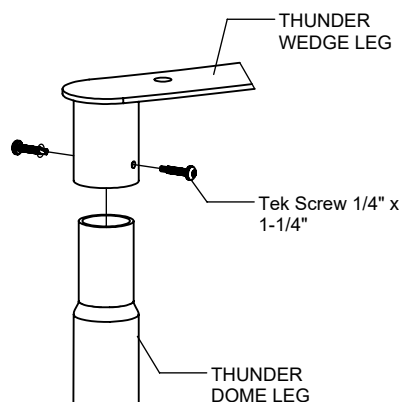
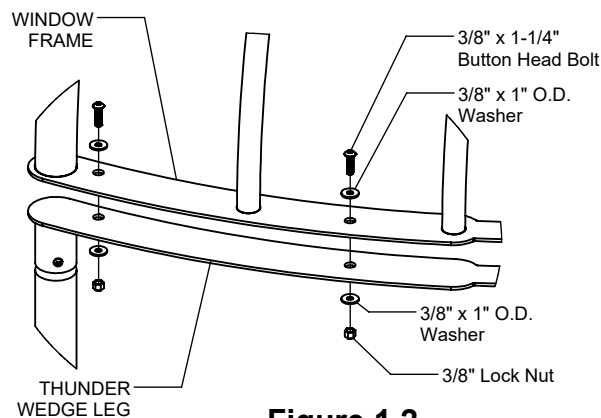

Figure 1.1

Step 3

For Thunder Wedge Only

Attach Thunder Wedge Leg to Window and Insert Frame as shown in Figure 1.2. (See Note A)

Step 4

Attach Thunder Wedge Leg to Thunder Dome Wall as shown in Figure 2. (See Note A)

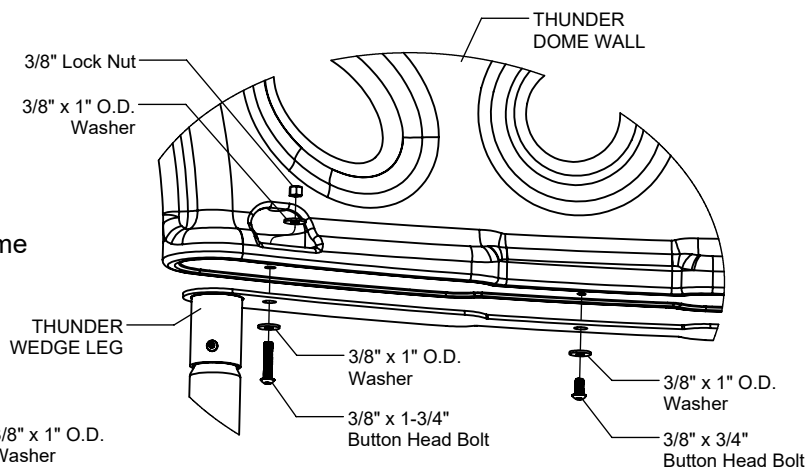
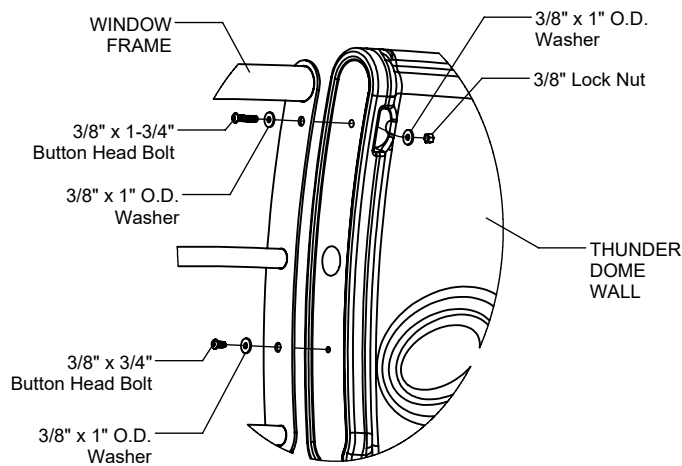

FIGURE 2

Step 5

Place Legs into footing holes and attach Frames to Thunder Dome Wall as shown in Figure 1.3. (See Note A)

Figure 1.3

Step 6

For In-Ground Only

Attach Chain to Thunder Wedge Net as shown in Figure 3. (See Note A)

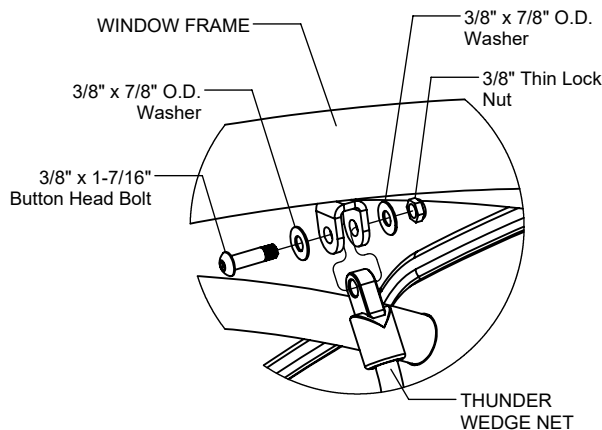

Figure 1.4

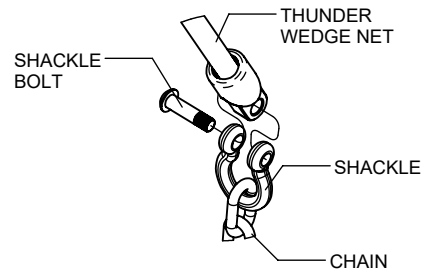

FIGURE 3

Step 7

Attach Thunder Wedge Net to Window Frame as shown in Figure 1.4. (See Note A)

Step 8

For Thunder Wedge Only

Attach Thunder Wedge Step to Insert Frame as shown in Figure 4. (See Note A)

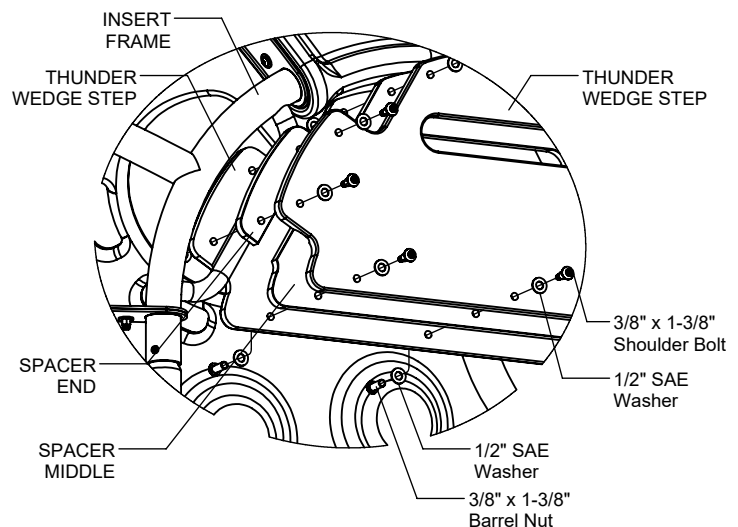

FIGURE 4

Step 9

For Surface Mount Only

Attach Thunder Wedge Net to Surface Mount Bracket as shown in Figure 5. (See Note A)

Step 10

For Thunder Wedge Only

Install Hour Glass Panel per Installation Manual S-1603 Hour Glass Panel. (See Figure 1)

Step 11

Fully tighten all fasteners according to the "TIGHTENING TORQUE FOR HARDWARE" section of the Installation Manual.

Step 12

Plumb and level entire component. Pour concrete into footing holes. Allow at least 72 hours to cure before using this equipment. (See Note B)

Step 13

Place required protective surfacing under and around Thunder Wedge. (See Note C)

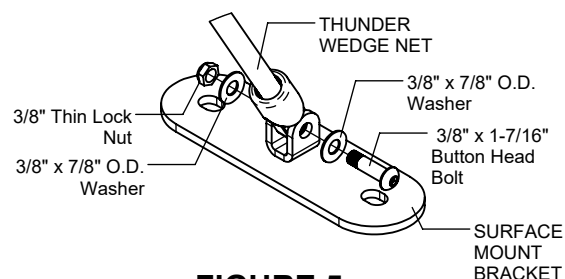

FIGURE 5

THUNDER WEDGE INSTALLATION INSTRUCTIONS

PC-1906
Page 7 of 8

Parts List

THUNDER WEDGE - GROUND MOUNT		
Part #	DESCRIPTION	QTY
DE-0061	Thunder Dome Wall	3
EE-0701	Thunder Wedge Step	2
EE-0701-SE	Thunder Wedge Step Spacer End	2
EE-0701-SM	Thunder Wedge Step Spacer Middle	1
FS-PC1906-L	Thunder Wedge Leg-Left	2
FS-PC1906-R	Thunder Wedge Leg-Right	2
FS-PC1906-WINS	Thunder Wedge Insert Frame	1
FS-PC1906-WNET	Thunder Wedge Net Frame	1
FS-PC1906-WWIN	Thunder Wedge Window Frame	1
HE-0008-16	16-Link Galvanized Chain	4
HE-0146	Thunder Wedge Net	1
LE-0034	Thunder Dome Leg	8
S-1630	Hour Glass Panel	1
451161-SS	Swing Shackle - Stainless Steel	4
9103032-TR	Bolt Button Head 3/8" x 3/4"	24
9103062-TR	Bolt Button Head 3/8" x 1-1/4"	12
9103082-TR	Bolt Button Head 3/8" x 1-3/4"	12
9103200-TR	Bolt Button Head 3/8" x 1-7/16"	4
9143062-TR	Bolt Shoulder 3/8" x 1-3/8" BH	10
9271062-TR	1/4" x 1-1/4" Tek Screw	16
9333002	Washer Flat 3/8" x 1" O.D. x .100" thick	72
9333042	Washer Flat 3/8" x 7/8" O.D.	8
9345002	Washer Flat SAE 1/2"	20
9413002	Nut Lock 3/8"	24
9423002	Nut Lock Thin 3/8"	4
9443062-TR	Nut Barrel 3/8" x 1-3/8" BH	10

HALF THUNDER WEDGE - GROUND MOUNT		
Part #	DESCRIPTION	QTY
DE-0061	Thunder Dome Wall	2
FS-PC1906-L	Thunder Wedge Leg-Left	1
FS-PC1906-R	Thunder Wedge Leg-Right	1
FS-PC1906-WNET	Thunder Wedge Net Frame	1
HE-0008-16	16-Link Galvanized Chain	4
HE-0146	Thunder Wedge Net	1
LE-0034	Thunder Dome Leg	4
451161-SS	Swing Shackle - Stainless Steel	4
9103032-TR	Bolt Button Head 3/8" x 3/4"	16
9103082-TR	Bolt Button Head 3/8" x 1-3/4"	8
9103200-TR	Bolt Button Head 3/8" x 1-7/16"	4
9271062-TR	1/4" x 1-1/4" Tek Screw	8
9333002	Washer Flat 3/8" x 1" O.D. x .100" thick	32
9333042	Washer Flat 3/8" x 7/8" O.D.	8
9413002	Nut Lock 3/8"	8
9423002	Nut Lock Thin 3/8"	4

THUNDER WEDGE - SURFACE MOUNT		
Part #	DESCRIPTION	QTY
DE-0061	Thunder Dome Wall	3
EE-0701	Thunder Wedge Step	2
EE-0701-SE	Thunder Wedge Step Spacer End	2
EE-0701-SM	Thunder Wedge Step Spacer Middle	1
FS-12461-SM	Cargo Net Surface Mount Bracket	4
FS-PC1906-L-SM	Thunder Wedge Leg-Left Surface Mount	2
FS-PC1906-R-SM	Thunder Wedge Leg-Right Surface Mount	2
FS-PC1906-WINS	Thunder Wedge Insert Frame	1
FS-PC1906-WNET	Thunder Wedge Net Frame	1
FS-PC1906-WWIN	Thunder Wedge Window Frame	1
HE-0146	Thunder Wedge Net	1
S-1630	Hour Glass Panel	1
9103032-TR	Bolt Button Head 3/8" x 3/4"	24
9103062-TR	Bolt Button Head 3/8" x 1-1/4"	12
9103082-TR	Bolt Button Head 3/8" x 1-3/4"	12
9103200-TR	Bolt Button Head 3/8" x 1-7/16"	8
9143062-TR	Bolt Shoulder 3/8" x 1-3/8" BH	10
9333002	Washer Flat 3/8" x 1" O.D. x .100" thick	72
9333042	Washer Flat 3/8" x 7/8" O.D.	16
9345002	Washer Flat SAE 1/2"	20
9413002	Nut Lock 3/8"	24
9423002	Nut Lock Thin 3/8"	8
9443062-TR	Nut Barrel 3/8" x 1-3/8" BH	10

HALF THUNDER WEDGE - SURFACE MOUNT		
Part #	DESCRIPTION	QTY
DE-0061	Thunder Dome Wall	2
FS-12461-SM	Cargo Net Surface Mount Bracket	4
FS-PC1906-L-SM	Thunder Wedge Leg-Left Surface Mount	1
FS-PC1906-R-SM	Thunder Wedge Leg-Right Surface Mount	1
FS-PC1906-WNET	Thunder Wedge Net Frame	1
HE-0146	Thunder Wedge Net	1
9103032-TR	Bolt Button Head 3/8" x 3/4"	16
9103082-TR	Bolt Button Head 3/8" x 1-3/4"	8
9103200-TR	Bolt Button Head 3/8" x 1-7/16"	8
9333002	Washer Flat 3/8" x 1" O.D. x .100" thick	32
9333042	Washer Flat 3/8" x 7/8" O.D.	16
9413002	Nut Lock 3/8"	8
9423002	Nut Lock Thin 3/8"	8



www.playcraftsystems.com
For Customer Service Call
800.333.8519 (U.S.A.) or 541.955.9199 (International)

Rev A
4/5/2022

Specifications

THUNDER DOME WALL:

Shall be constructed of UV-stabilized, rotationally molded, linear, low density polyethylene with an average wall thickness of .250".

THUNDER WEDGE STEP:

Shall be made from high density 3/4" sheet plastic specially formulated for optimum UV stability and color retention.

THUNDER WEDGE NET FRAME, THUNDER WEDGE WINDOW & INSERT FRAME:

Shall be fabricated using 2.375" O.D. 11 gauge steel tubing with welded 1.315" O.D. 12 gauge steel rungs, 3/16" thick sheet steel and ASAI 304 stainless steel anchors and will have a multi-stage baked-on powder coat finish.

THUNDER WEDGE NET:

Shall be made from 16mm steel-reinforced rope with high-strength copolymer plastic intersection connectors and machined aluminum end ferrules.

THUNDER WEDGE LEG:

Shall be fabricated using 2.375" O.D. 11 gauge steel tubing, 3/16" sheet steel and 1/4" sheet steel and will have a multi-stage baked-on powder coat finish.

THUNDER DOME LEG:

Shall be fabricated using 2.375" O.D. 11 gauge steel tubing and will have a multi-stage baked-on powder coat finish.

CARGO NET SURFACE MOUNT BRACKET:

Shall be fabricated using 1/4" sheet steel plate with a 3/16" stainless steel clevis and will have a multi-stage baked-on powder coat finish.

CHAIN:

Shall be fabricated from 5/0 galvanized steel chain with silver shield finish.

HARDWARE:

Shall be stainless steel, zinc/nickel plated or galvanized as required to resist rust and corrosion.

Maintenance

Periodically tighten all screws, bolts and nuts. A periodic inspection of all parts is necessary. If a part is broken or worn, replace immediately. For general maintenance please refer to our Playground Maintenance Manual.