

TYPE 1 - R35 Mounting Block 4 (Applies to most decks)

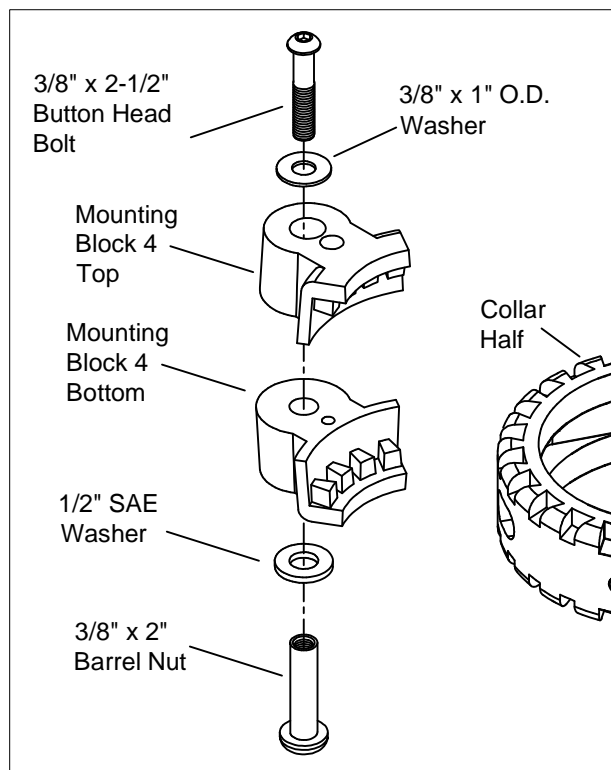

TYPE 2 - R35 Mounting Block 6 & Clevis (Applies to ALL OVERHEAD EVENTS)

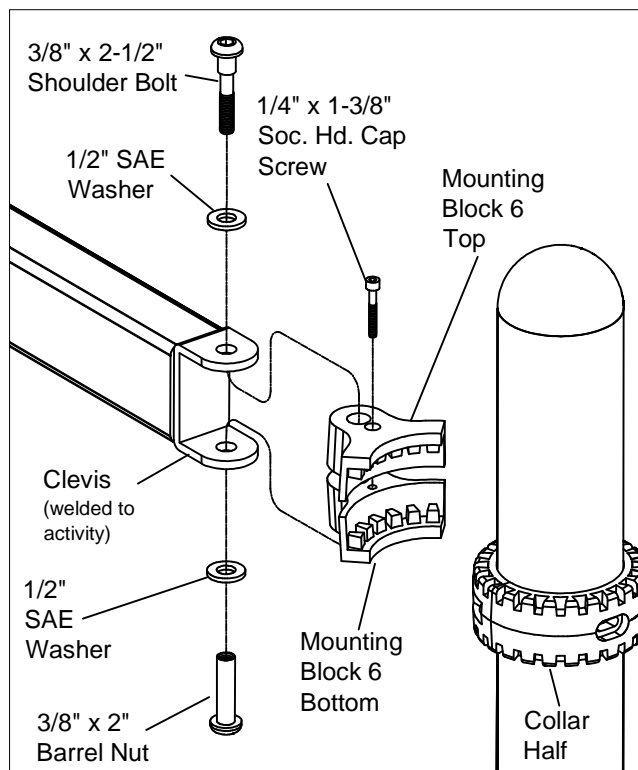

TYPE 3 - R35 Mounting Block 3 (Applies to R3.5 Deck #5 only)

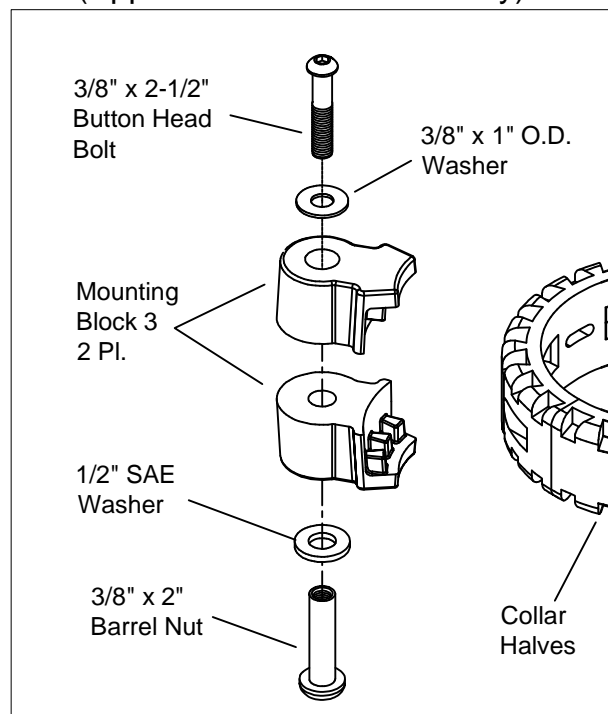

R3.5 Deck #5

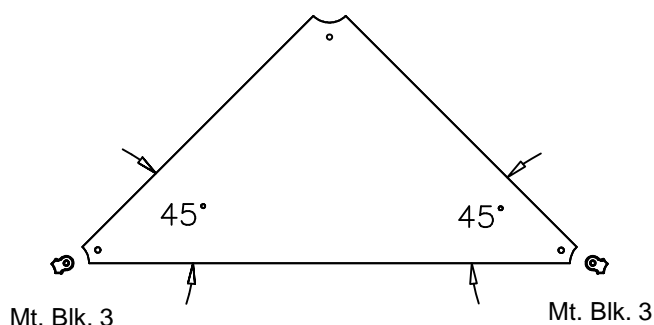

Mounting Block 3 is used ONLY on the 45° corners of this deck, 2 Pl.

Parts List - Type 1

<u>PART #</u>	<u>DESCRIPTION</u>	<u>QTY.</u>
008110	Mounting Block 4 Top	1
008111	Mounting Block 4 Bottom	1
9103112-TR	Bolt Button Head 3/8" x 2-1/2"	1
9333002	Washer Flat 3/8" x 1" x .100 thick	1
9345002	Washer Flat SAE 1/2"	1
9443092-TR	Nut Barrel 3/8" x 2" BH	1

Parts List - Type 2

<u>PART #</u>	<u>DESCRIPTION</u>	<u>QTY.</u>
008125	Mounting Block 6 Top	1
008127	Mounting Block 6 Bottom	1
9143112-TR	Bolt Shoulder 3/8" x 2-1/2"	1
9281062-5	Screw Soc HD CS 1/4" x 1-3/8"	1
9345002	Washer Flat SAE 1/2"	2
9443092-TR	Nut Barrel 3/8" x 2" BH	1

Parts List - Type 3

<u>PART #</u>	<u>DESCRIPTION</u>	<u>QTY.</u>
008112	Mounting Block 3	2
9103112-TR	Bolt Button Head 3/8" x 2-1/2"	1
9333002	Washer Flat 3/8" x 1" x .100 thick	1
9345002	Washer Flat SAE 1/2"	1
9443092-TR	Nut Barrel 3/8" x 2" BH	1

Installation

NOTES: More detailed instructions will be supplied with the specific components being installed on your play system.

Step 1.

Attach Collar halves to Post. Refer to Collar Assembly Page R3.5-09.

Step 2.

Attach Mounting Blocks to Collar and activity to Mounting Blocks using type (1-3) hardware as specified.

Step 3.

Snug tighten all fasteners.

Step 4.

Check to ensure proper placement of the activity.

Step 5.

Apply liquid thread lock and fully tighten all fasteners according to the "TIGHTENING TORQUE FOR HARDWARE" Section of the Installer's Manual.

Specifications

MOUNTING BLOCKS:

Shall be two-part and precision die-cast from a high strength aluminum alloy. The Mounting Blocks have a multi-stage baked-on powder coat finish.

HARDWARE:

Shall be stainless steel, zinc/nickel plated or galvanized as required to resist rust and corrosion.

Maintenance

Periodically tighten all screws, bolts and nuts. A periodic inspection of all parts is necessary. If a part is broken or worn, replace immediately. For general maintenance please refer to our Playground Maintenance Manual.



Manufactured by Krauss Craft, Inc.
www.playcraftsystems.com

For Customer Service Call
800.333.8519 (U.S.A.) or
541.955.9199 (International)

Rev C