

## IMPORTANT NOTES: Read First

(A) Use liquid thread lock (such as Loctite®) with all threaded hardware. **Important:** Liquid thread lock (prior to curing) helps to eliminate the common problem of "thread seizure" in stainless steel hardware by serving as a lubricant during assembly.

(B) When installing Orbital Shade, make sure that the lowest point of the roof is a minimum of 84" [2130mm] above the underlying play surface.

(C) Remove canopy from Orbital Shade in high wind and heavy snow conditions. Block protrusions while canopy is removed to maintain CPSC/ASTM compliance.

**FIGURE 1**  
Orbital Shade

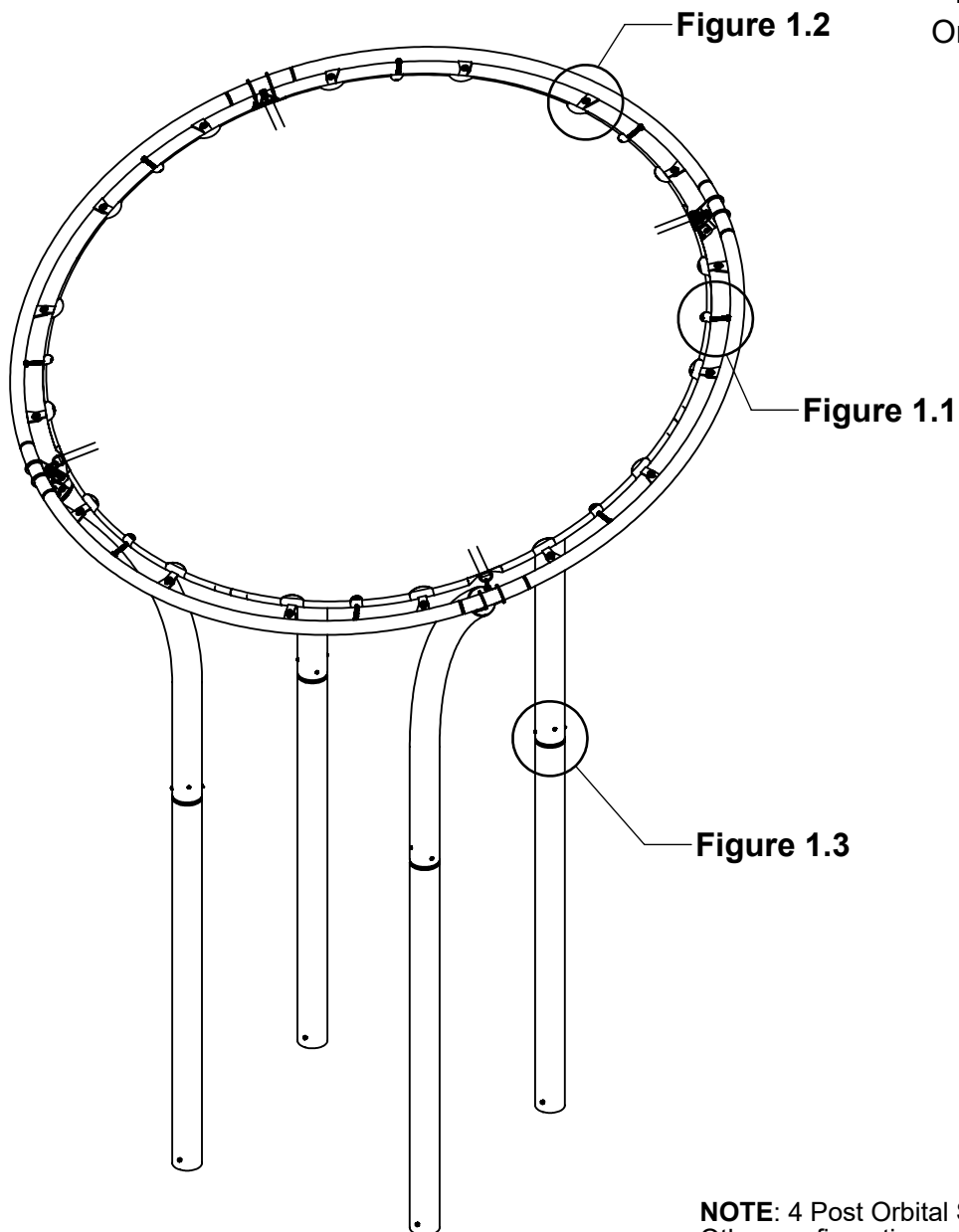

**NOTE:** 4 Post Orbital Shade shown.  
Other configurations will vary slightly,  
but does not affect assembly.

### 3 POST ORBITAL SHADE

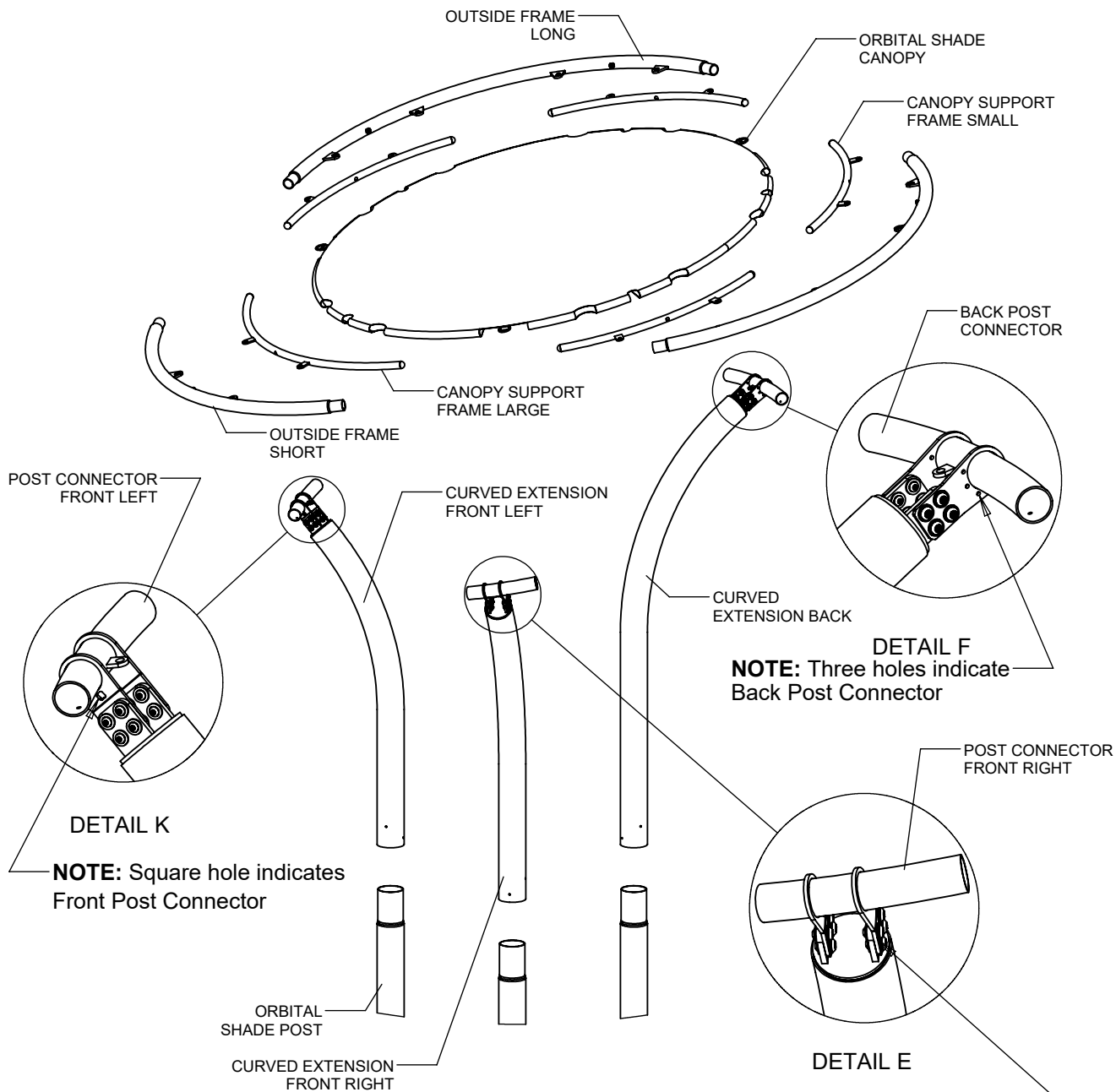

**FIGURE 2**

**NOTE:** Alignment of Post Connector Brackets on Curved Extensions is important for proper assembly.

**NOTE:** Front Post Connector Brackets are to be mounted **on top** of the Curved Extension tabs. All Post Connector Brackets are **bent towards** the lower end of the shade when properly assembled.

### 3 POST ORBITAL SHADE

#### BACK POST

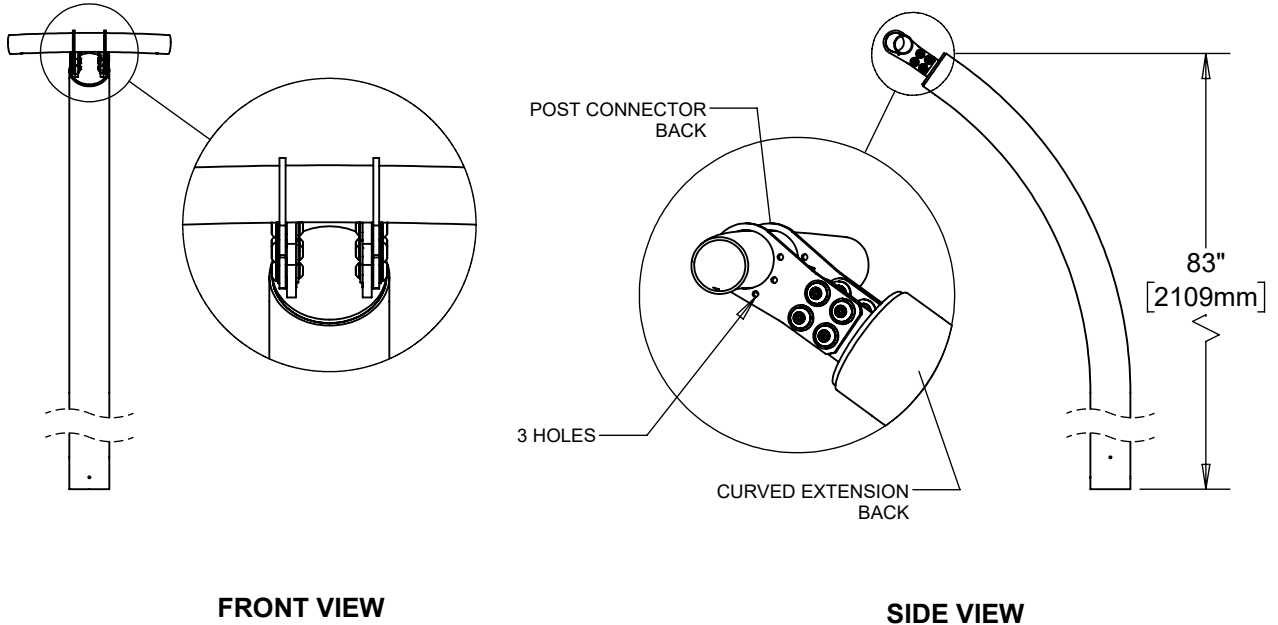

**FRONT VIEW**

**SIDE VIEW**

#### FRONT RIGHT POST

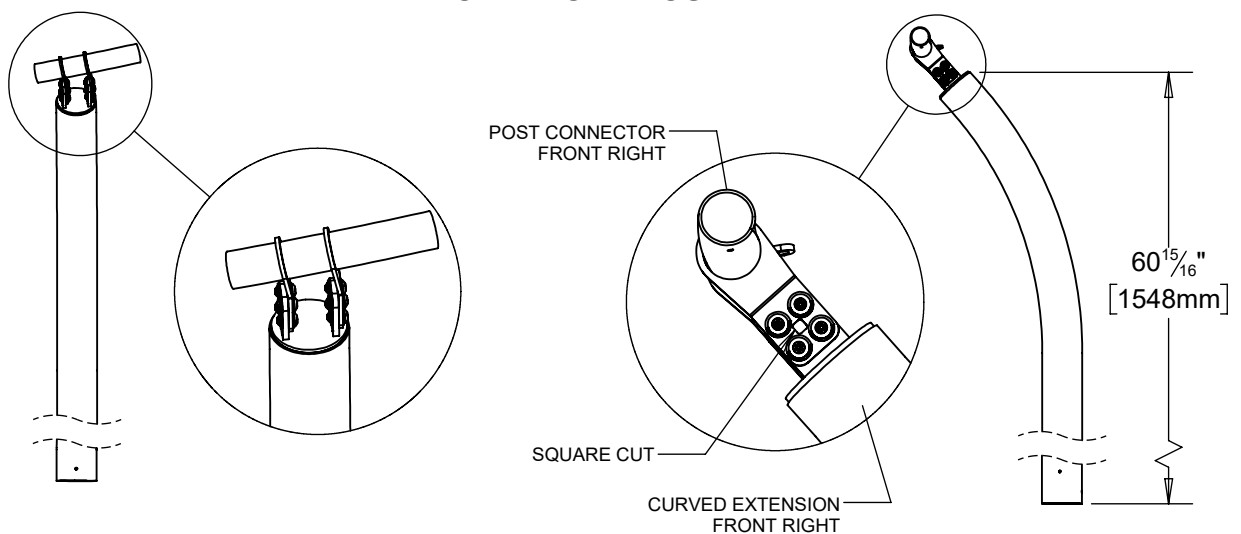

**FRONT VIEW**

**SIDE VIEW**

# ORBITAL SHADE INSTALLATION INSTRUCTIONS

**R5-18030**  
Page 4 of 16

## FRONT LEFT POST

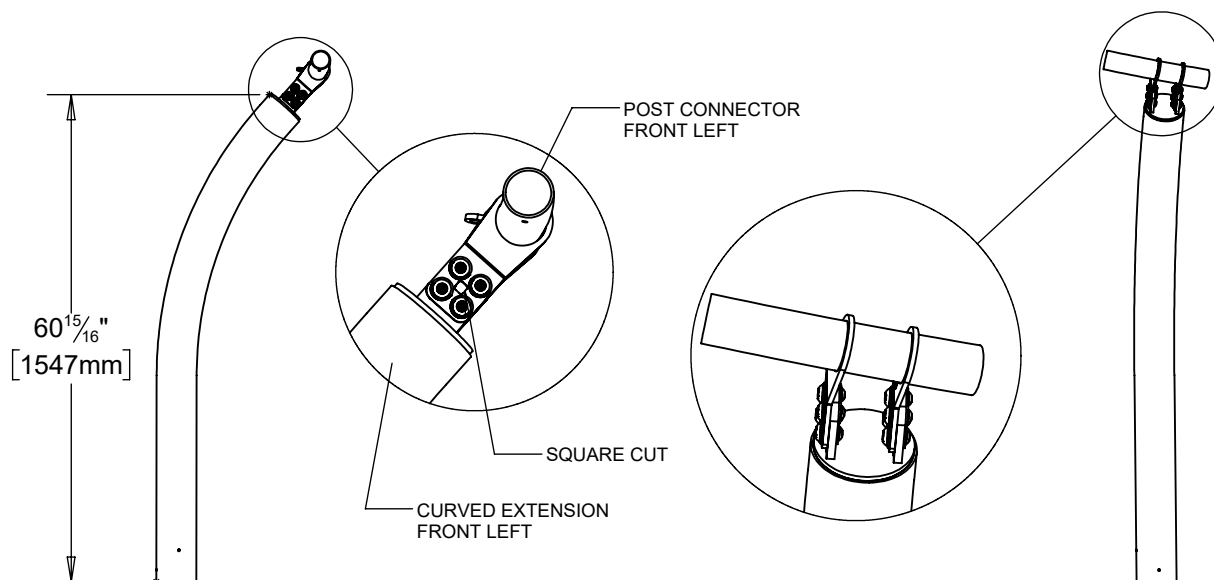

**SIDE VIEW**

**FRONT VIEW**

### 4 POST ORBITAL SHADE

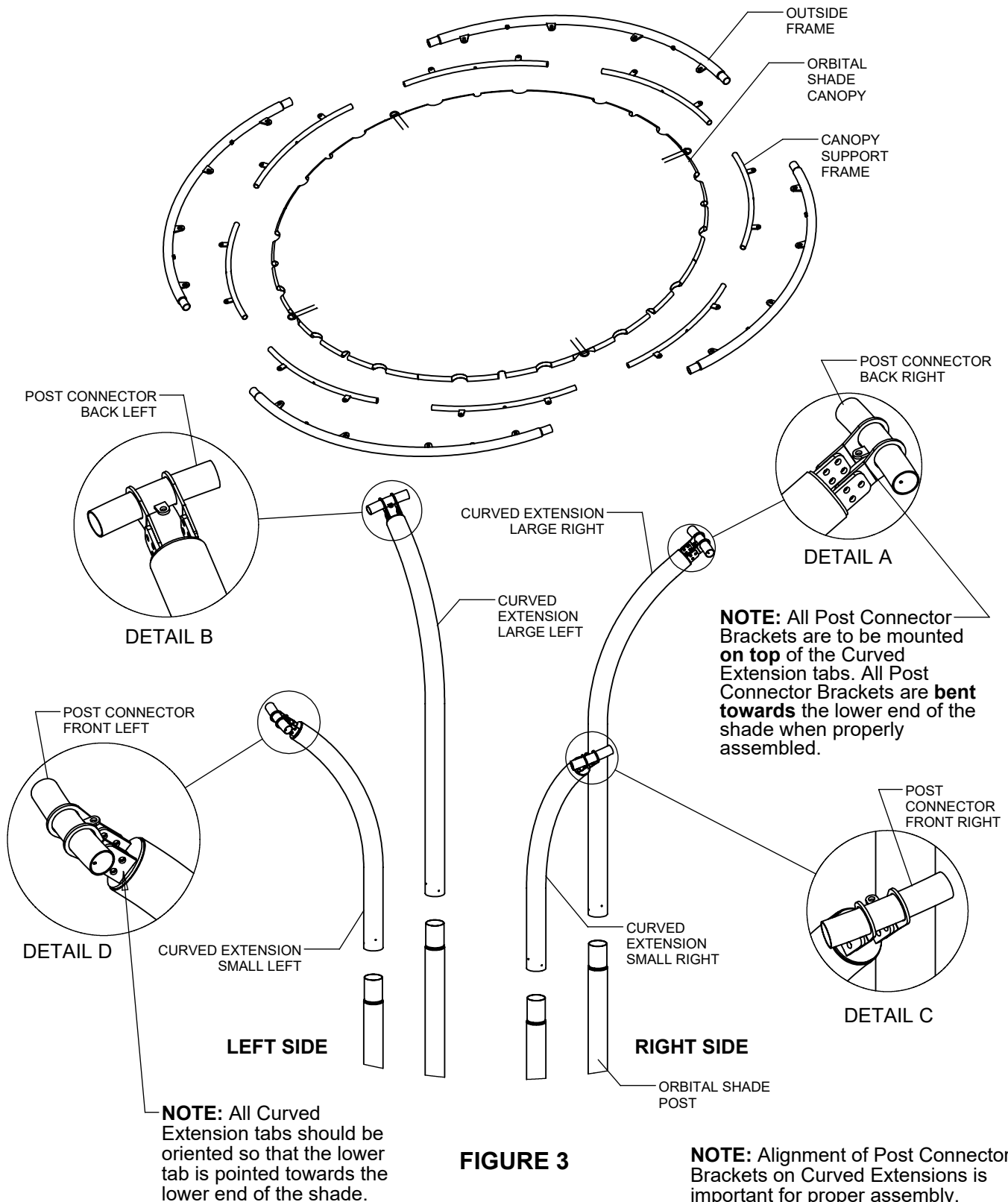
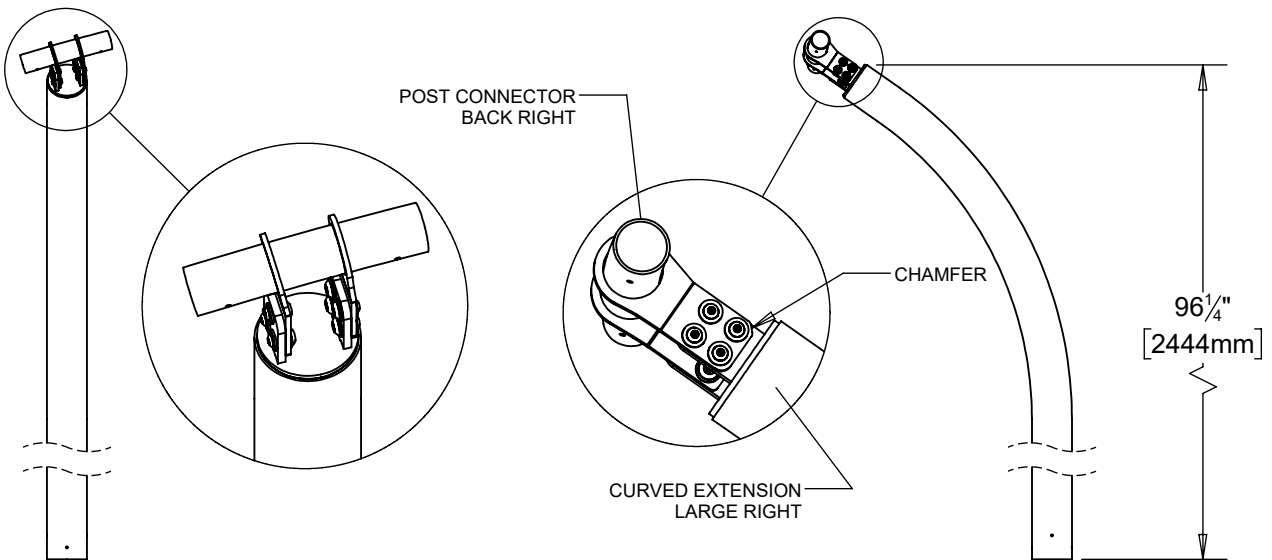

FIGURE 3

NOTE: Alignment of Post Connector Brackets on Curved Extensions is important for proper assembly.

**4 POST ORBITAL SHADE**

**BACK RIGHT POST**



**FRONT VIEW**

**SIDE VIEW**

**BACK LEFT POST**

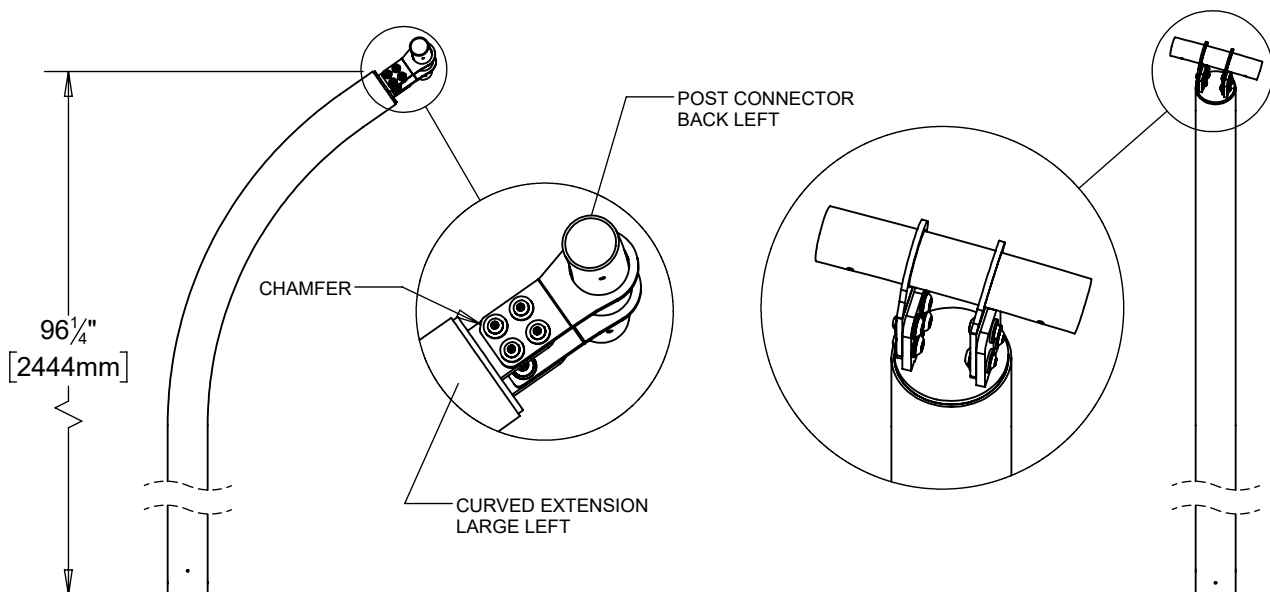

**SIDE VIEW**

**FRONT VIEW**

# ORBITAL SHADE INSTALLATION INSTRUCTIONS

**R5-18030**  
Page 7 of 16

## FRONT RIGHT POST

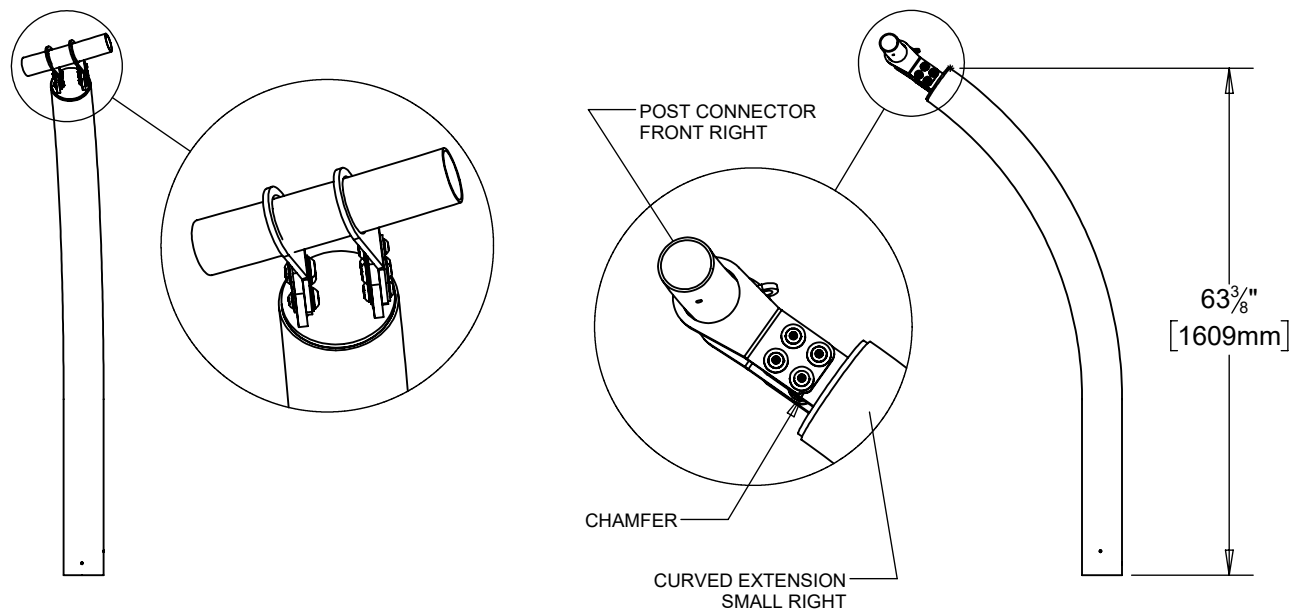

FRONT VIEW

SIDE VIEW

## FRONT LEFT POST

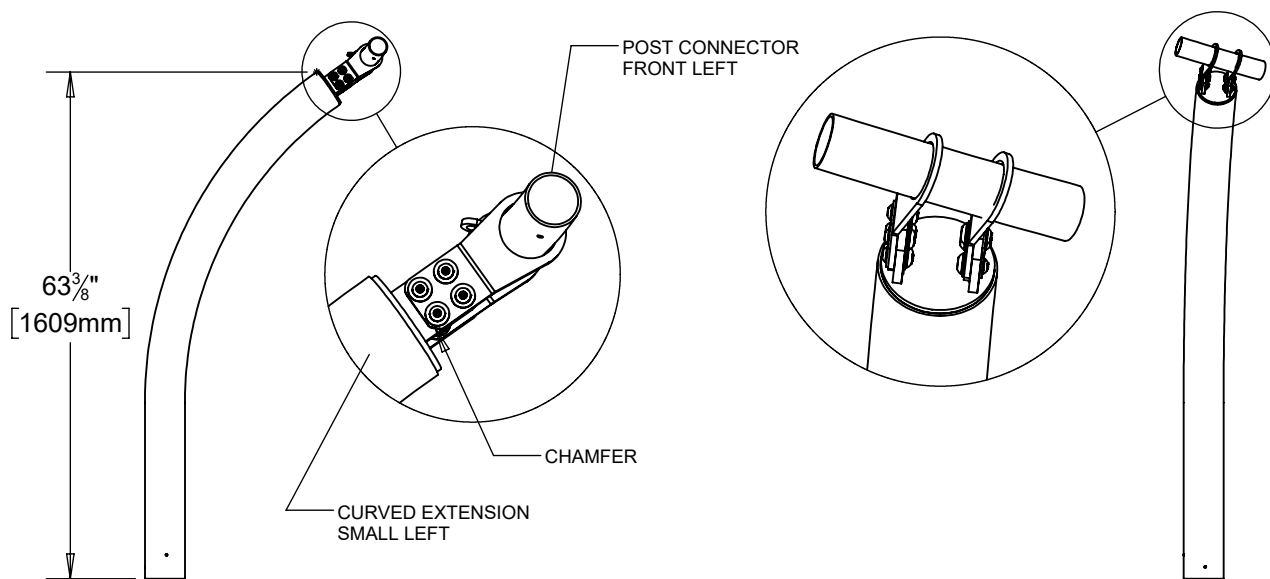

SIDE VIEW

FRONT VIEW

**6 POST ORBITAL SHADE**

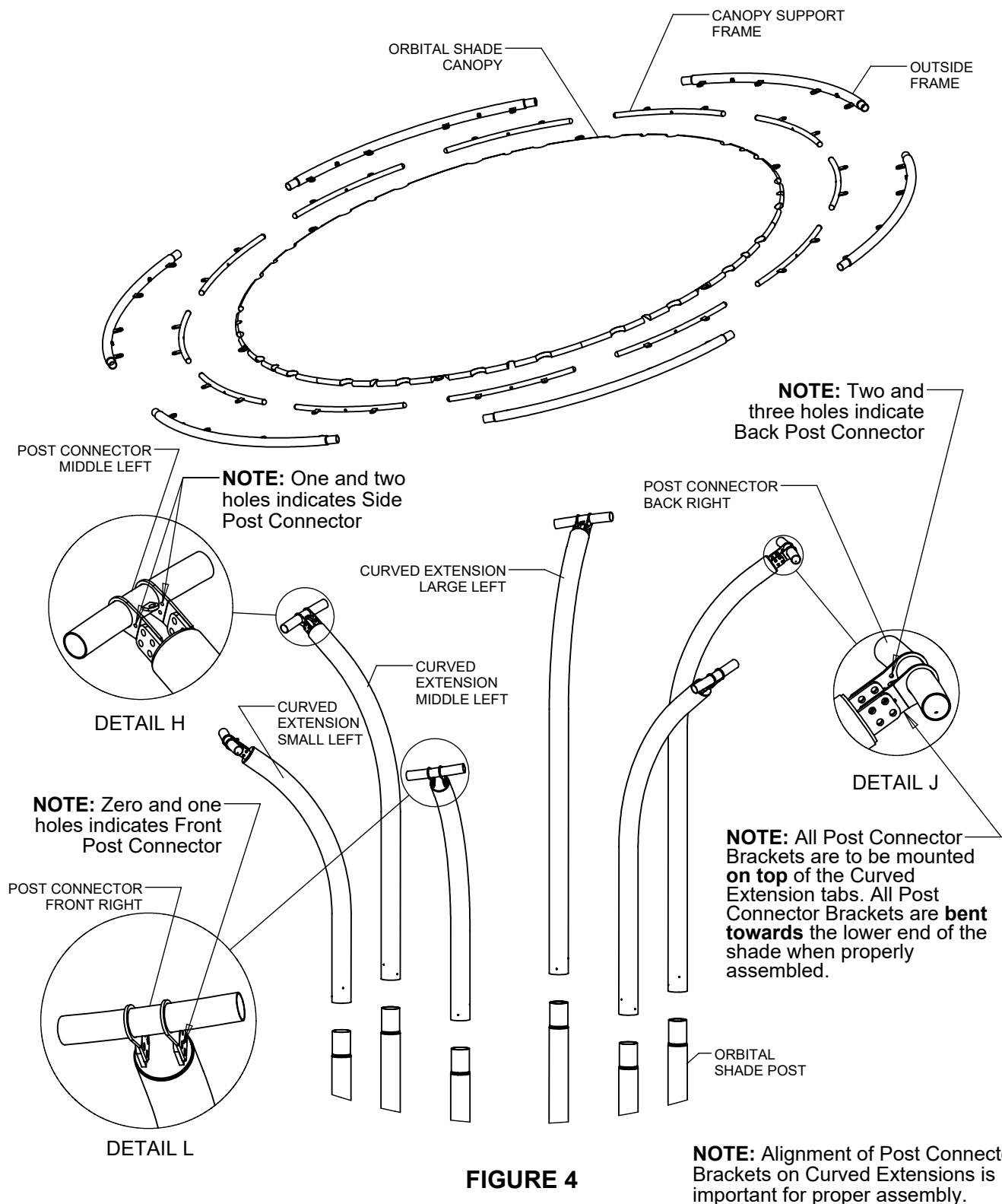
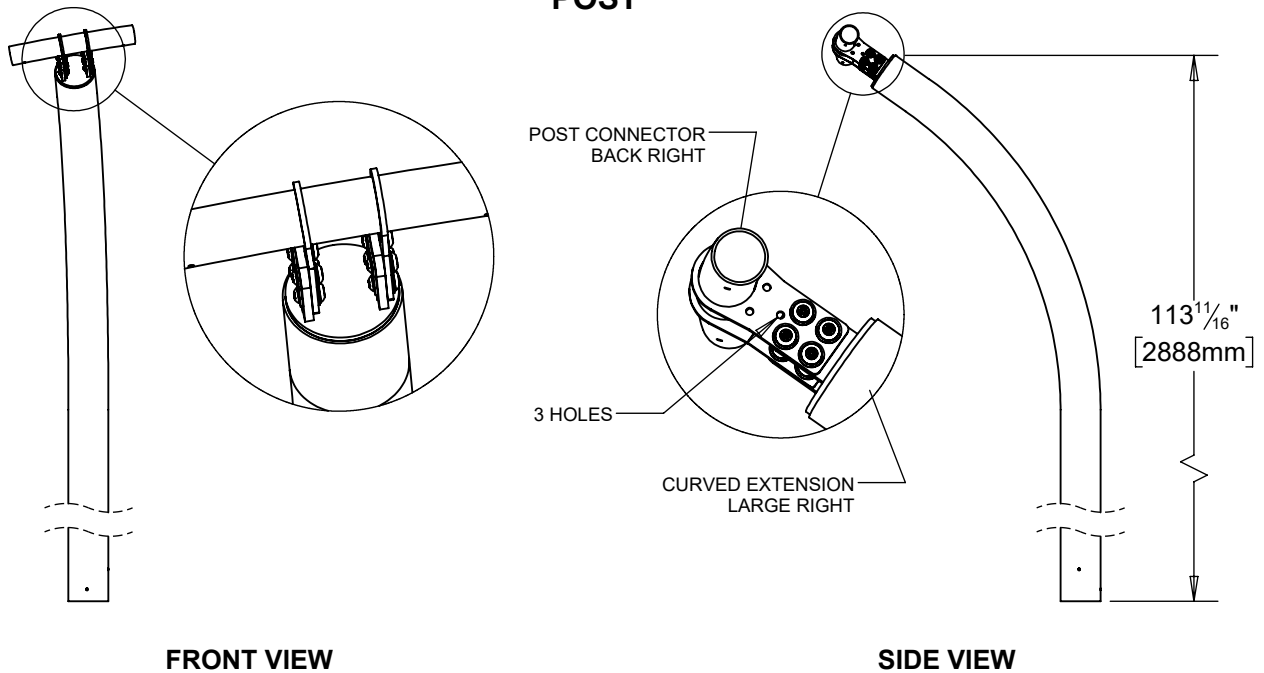

**FIGURE 4**



**6 POST ORBITAL SHADE**

**BACK RIGHT POST**



**BACK LEFT POST**

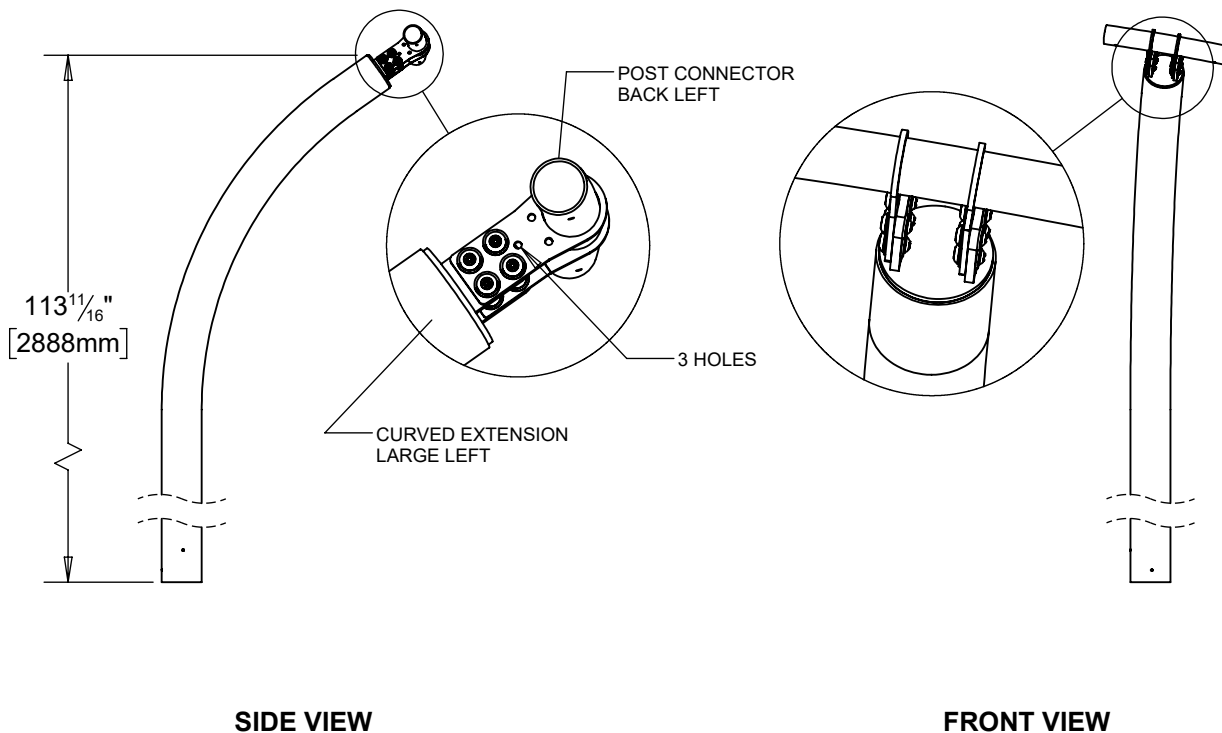

**MIDDLE RIGHT POST**

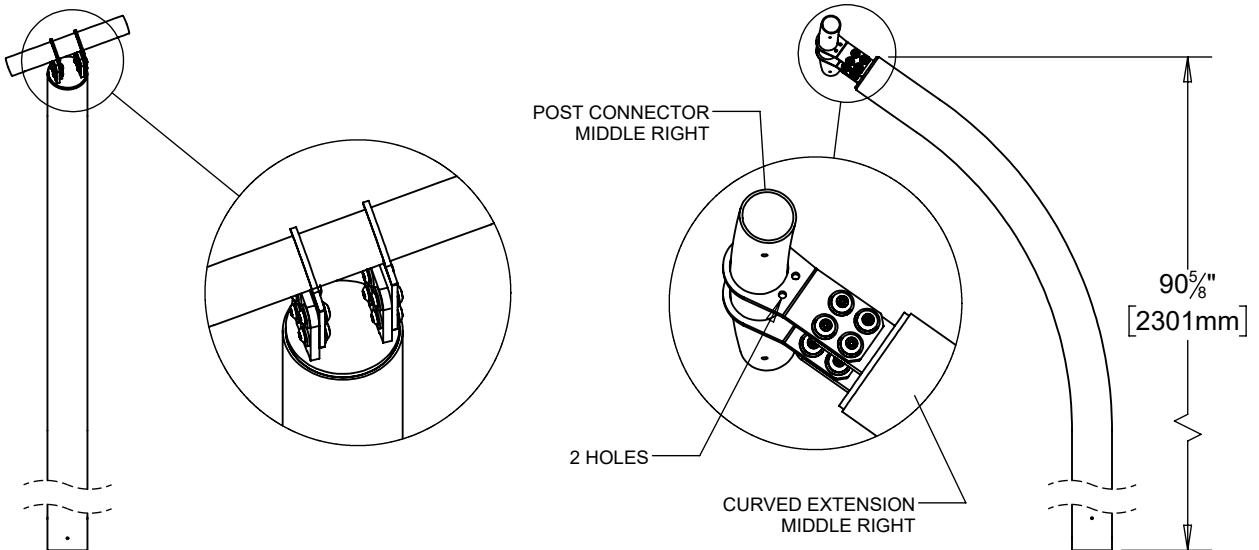

**FRONT VIEW**

**SIDE VIEW**

**MIDDLE LEFT POST**

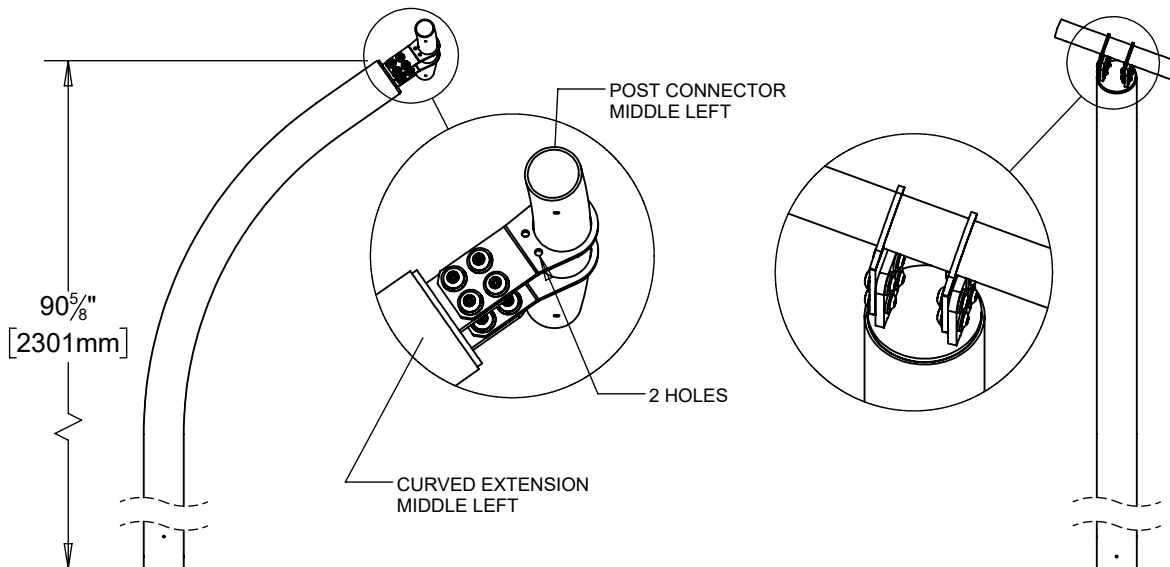

**SIDE VIEW**

**FRONT VIEW**

## FRONT RIGHT POST

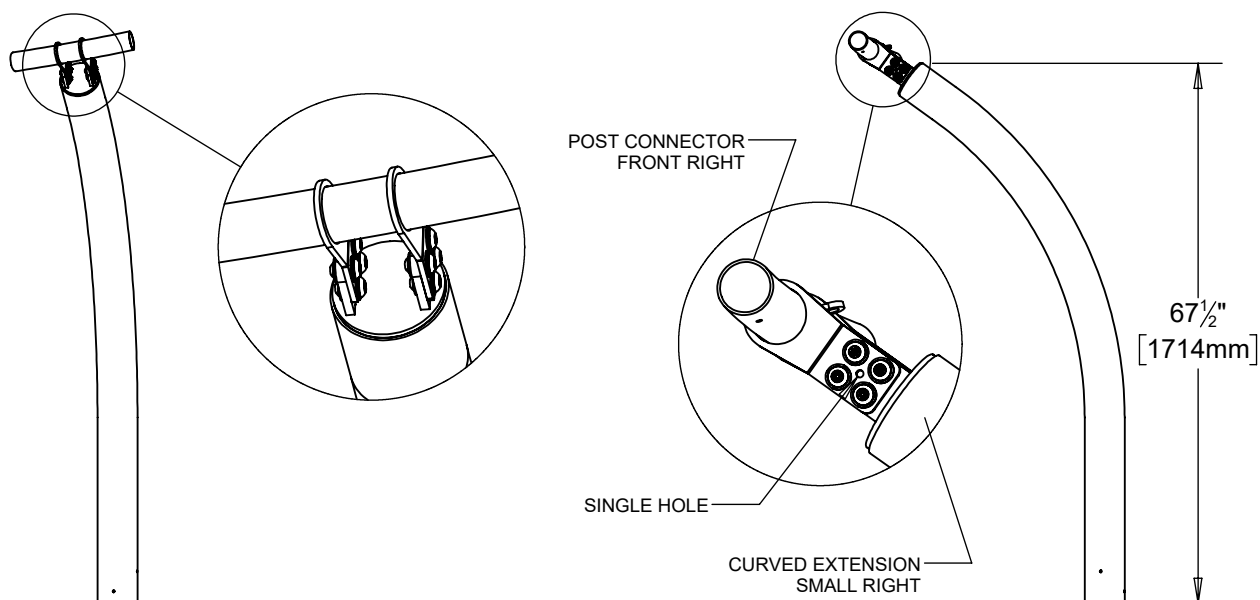

FRONT VIEW

SIDE VIEW

## FRONT LEFT POST

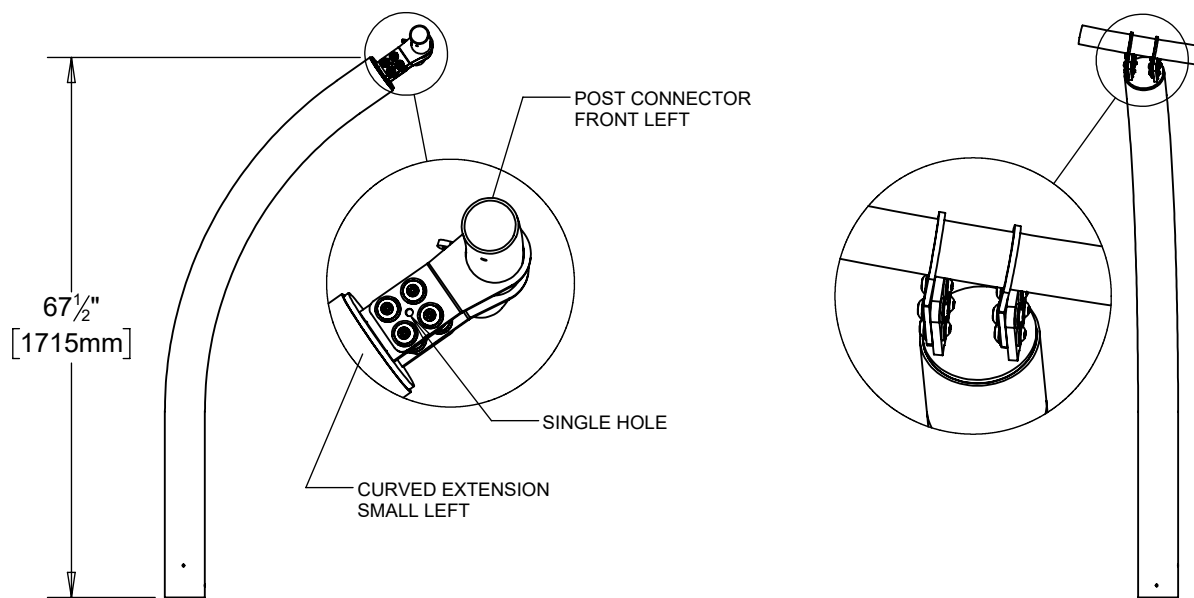

SIDE VIEW

FRONT VIEW

## **Step 1 (Factory Assembled)**

Attach Pipe End Caps to Canopy Support Frames as shown in Figure 5.

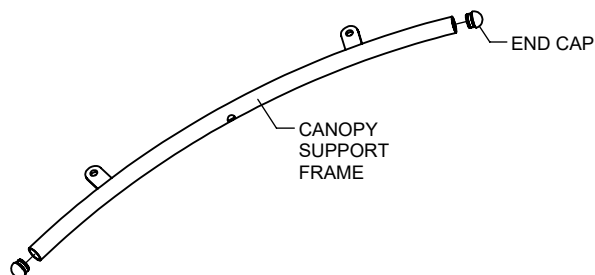

**FIGURE 5**

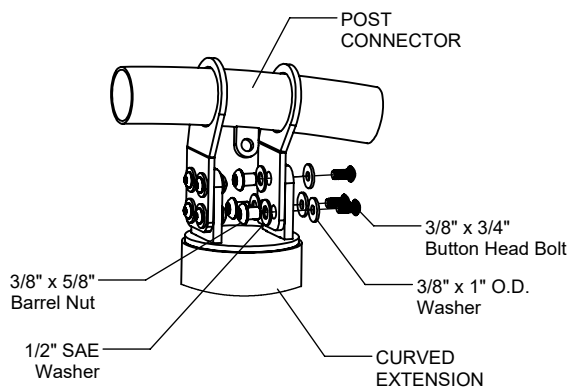

**FIGURE 6**

## **Step 2 (Factory Assembled)**

Attach each Post Connector to its corresponding Curved Extension as shown in Figure 6. Reference Figures 2, 3, 4 and Post Details for orientation and overall locations. (See Note A)

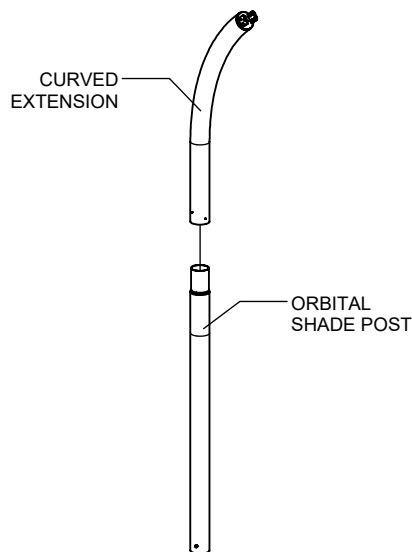

**FIGURE 7**

## **Step 3**

Slide Curved Extensions over Orbital Shade Posts as shown in Figure 7.

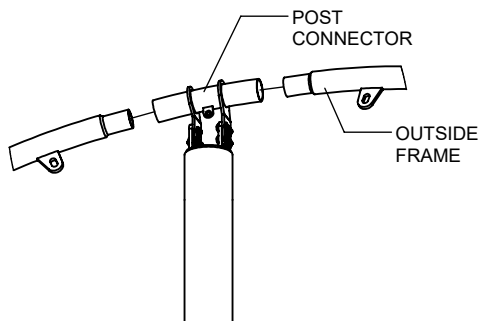

**FIGURE 8**

## **Step 4**

Slide Outside Frames into the Post Connectors as shown in Figure 8.

## **Step 5**

Attach Orbital Shade Canopy to each Post Connector as shown in Figure 9.

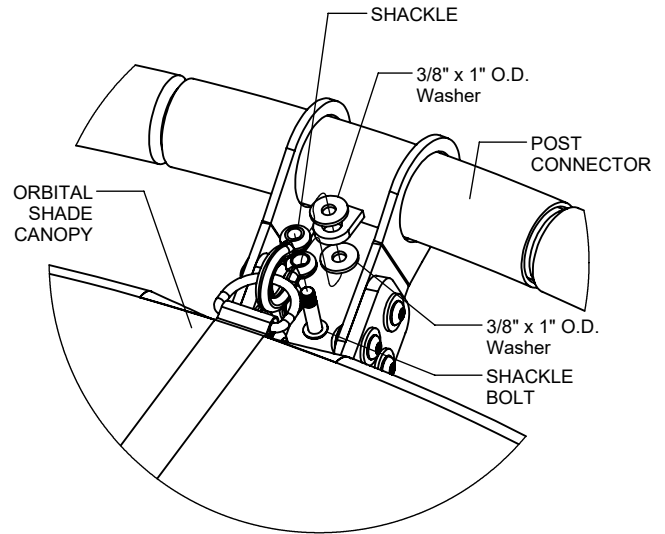

**FIGURE 9**

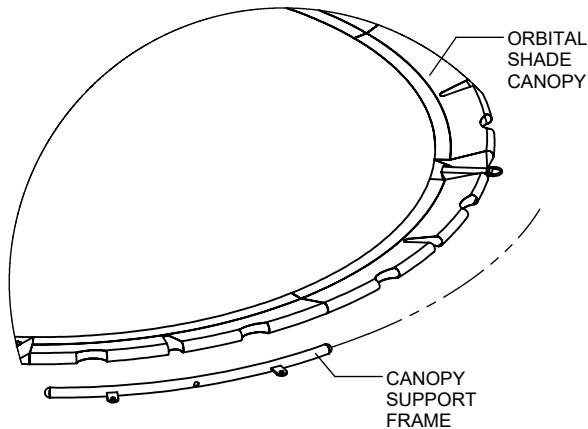

**FIGURE 10**

## **Step 6**

Slide Canopy Support Frames into the Orbital Shade Canopy as shown in Figure 10.

## **Step 7**

Assemble each Tensioner as shown in Figure 1.1.  
Adjust bolts to desired tension.

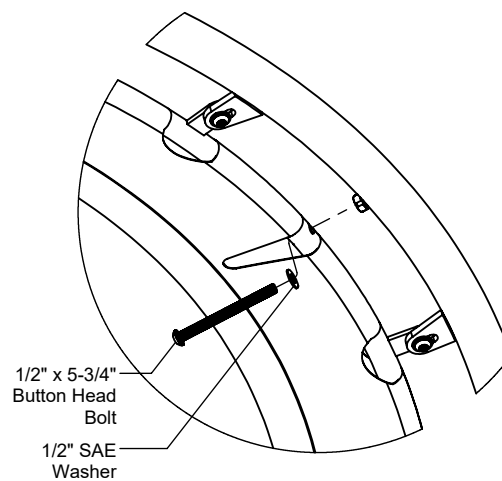
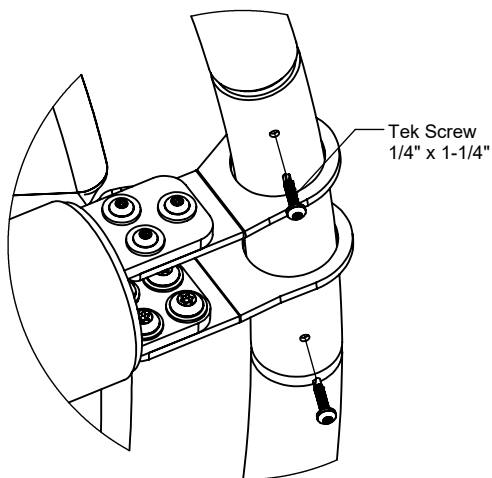

**Figure 1.1**

## Step 8

Attach Canopy Support Frame to Outside Frame as shown in Figure 1.2. (See Note A)

**NOTE:** Leave loose until end of assembly.



**FIGURE 11**

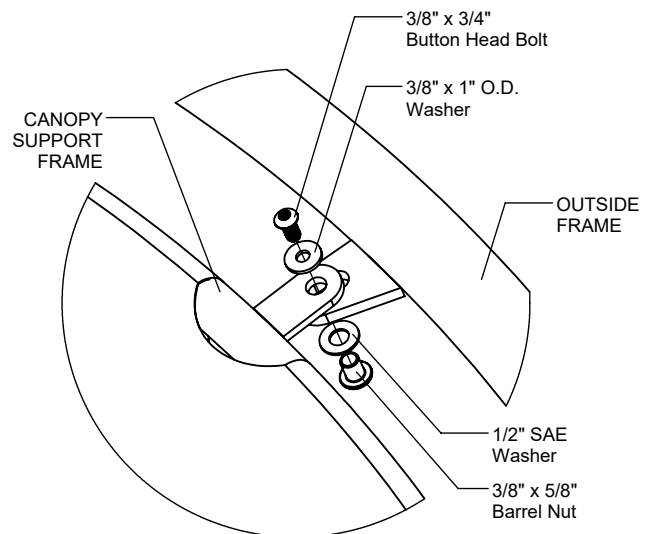

**Figure 1.2**

## Step 9

Attach Tek Screws to Outer Frame as shown in Figure 11. (See Note A)

## Step 10

Attach Tek Screws to Orbital Shade Posts as shown in Figure 1.3. (See Note A)

## Step 11

Fully tighten all fasteners according to the "TIGHTENING TORQUE FOR HARDWARE" section of the Installation Manual.

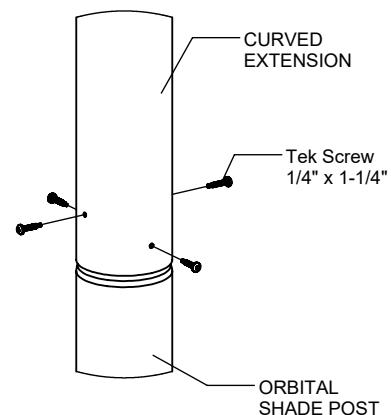

**Figure 1.3**

# **ORBITAL SHADE** **INSTALLATION INSTRUCTIONS**

**R5-18030**  
Page 15 of 16

## **Parts List**

ORBITAL SHADE 3 POST		
Part #	DESCRIPTION	QTY
FS-18030-3OFL	Orbital Shade 3 Post - Outside Frame Long	2
FS-18030-3OFS	Orbital Shade 3 Post - Outside Frame Short	1
HF-0023	Orbital Shade 3 Post - Canopy	1
451161-SS	Swing Shackle - Stainless Steel	3
9103032-TR	Bolt Button Head 3/8" x 3/4"	10
9105242	Bolt Button Head 1/2" x 5-3/4"	5
9271062-TR	1/4" x 1-1/4" Tek Screw	18
9333002	Washer Flat 3/8" x 1" O.D. x .100" thick	16
9345002	Washer Flat SAE 1/2"	15
9443022-TR	Nut Barrel 3/8" x 5/8" BH	10

ORBITAL SHADE 4 POST		
Part #	DESCRIPTION	QTY
FS-18030-OF	Orbital Shade - Outside Frame	4
HF-0021	Orbital Shade Canopy	1
451161-SS	Swing Shackle - Stainless Steel	4
9103032-TR	Bolt Button Head 3/8" x 3/4"	16
9105242	Bolt Button Head 1/2" x 5-3/4"	8
9271062-TR	1/4" x 1-1/4" Tek Screw	24
9333002	Washer Flat 3/8" x 1" O.D. x .100" thick	24
9345002	Washer Flat SAE 1/2"	24
9443022-TR	Nut Barrel 3/8" x 5/8" BH	16

ORBITAL SHADE 6 POST		
Part #	DESCRIPTION	QTY
FS-18030-6OF	Orbital Shade 6 Post - Outside Frame	6
HF-0027	Orbital Shade 6 Post - Canopy	1
451161-SS	Swing Shackle - Stainless Steel	6
9103032-TR	Bolt Button Head 3/8" x 3/4"	24
9105242	Bolt Button Head 1/2" x 5-3/4"	12
9271062-TR	1/4" x 1-1/4" Tek Screw	36
9333002	Washer Flat 3/8" x 1" O.D. x .100" thick	36
9345002	Washer Flat SAE 1/2"	36
9443022-TR	Nut Barrel 3/8" x 5/8" BH	24

## **Assembled Parts List**

ORBITAL SHADE 3 POST		
Part #	DESCRIPTION	QTY
FS-18030-3BC	Orbital Shade 3 Post - Back Post Connector	1
FS-18030-3BP	Orbital Shade 3 Post - Curved Extension Back	1
FS-18030-3FC	Orbital Shade 3 Post - Front Post Connector Right	1
FS-18030-3FC	Orbital Shade 3 Post - Post Connector Front Left	1
FS-18030-3FP	Orbital Shade 3 Post - Curved Extension Front Right	1
FS-18030-3FP	Orbital Shade 3 Post - Curved Extension Front Left	1
FS-18030-3SFL	Orbital Shade 3 Post - Canopy Support Frame Large	1
FS-18030-3SFS	Orbital Shade 3 Post - Canopy Support Frame Small	4
IE-0023	Pipe End Cap 1"	10
9103032-TR	Bolt Button Head 3/8" x 3/4"	24
9333002	Washer Flat 3/8" x 1" O.D. x .100" thick	24
9345002	Washer Flat SAE 1/2"	24
9443022-TR	Nut Barrel 3/8" x 5/8" BH	24

ORBITAL SHADE 4 POST		
Part #	DESCRIPTION	QTY
FS-18030-BCK	Orbital Shade 4 Post - Post Connector Back Right	1
FS-18030-BCK	Orbital Shade 4 Post - Post Connector Back Left	1
FS-18030-CSP	Orbital Shade - Canopy Support Frame	8
FS-18030-FRT	Orbital Shade 4 Post - Post Connector Front Right	1
FS-18030-FRT	Orbital Shade 4 Post - Post Connector Front Left	1
FS-18030-LRG	Orbital Shade 4 Post - Curved Extension Large Right	1
FS-18030-LRG	Orbital Shade 4 Post - Curved Extension Large Left	1
FS-18030-SM	Orbital Shade 4 Post - Curved Extension Small Right	1
FS-18030-SM	Orbital Shade 4 Post - Curved Extension Small Left	1
IE-0023	Pipe End Cap 1"	16
9103032-TR	Bolt Button Head 3/8" x 3/4"	28
9333002	Washer Flat 3/8" x 1" O.D. x .100" thick	28
9345002	Washer Flat SAE 1/2"	28
9443022-TR	Nut Barrel 3/8" x 5/8" BH	28



www.playcraftsystems.com  
For Customer Service Call  
800.333.8519 (U.S.A.) or 541.955.9199 (International)

**Rev C**  
12/7/2022

# ORBITAL SHADE INSTALLATION INSTRUCTIONS

**R5-18030**  
Page 16 of 16

## Assembled Parts List

ORBITAL SHADE 6 POST		
Part #	DESCRIPTION	QTY
FS-18030-6BK	Orbital Shade 6 Post - Post Connector Back Right	1
FS-18030-6BK	Orbital Shade 6 Post - Post Connector Back Left	1
FS-18030-6CSP	Orbital Shade 6 Post - Canopy Support Frame	12
FS-18030-6FRT	Orbital Shade 6 Post - Post Connector Front Right	1
FS-18030-6FRT	Orbital Shade 6 Post - Post Connector Front Left	1
FS-18030-6LRG	Orbital Shade 6 Post - Curved Extension Large Right	1
FS-18030-6LRG	Orbital Shade 6 Post - Curved Extension Large Left	1
FS-18030-6MID	Orbital Shade 6 Post - Curved Extension Middle Right	1
FS-18030-6MID	Orbital Shade 6 Post - Curved Extension Middle Left	1
FS-18030-6SDE	Orbital Shade 6 Post - Post Connector Middle Right	1
FS-18030-6SDE	Orbital Shade 6 Post - Post Connector Middle Left	1
FS-18030-6SM	Orbital Shade 6 Post - Curved Extension Small Left	1
FS-18030-6SM	Orbital Shade 6 Post - Curved Extension Small Right	1
IE-0023	Pipe End Cap 1"	24
9103032-TR	Bolt Button Head 3/8" x 3/4"	48
9333002	Washer Flat 3/8" x 1" O.D. x .100" thick	48
9345002	Washer Flat SAE 1/2"	48
9443022-TR	Nut Barrel 3/8" x 5/8" BH	48

## Specifications

### ORBITAL SHADE - POST CONNECTORS:

Shall be fabricated using 2.375" O.D. 11 gauge steel tubing with welded 1/4" thick steel brackets and tabs and will have a multi-stage baked-on powder coat finish.

### ORBITAL SHADE - CURVED EXTENSIONS:

Shall be fabricated using 5" O.D. 11 gauge steel tubing with a welded 1/4" thick steel cap and 3/8" thick steel brackets and will have a multi-stage baked-on powder coat finish.

### ORBITAL SHADE - OUTSIDE FRAMES:

Shall be fabricated using 2.375" O.D. 11 gauge steel tubing with welded 3/8" thick steel tabs and a welded nut and will have a multi-stage baked-on powder coat finish.

### ORBITAL SHADE - CANOPY SUPPORT FRAMES:

Shall be fabricated using 1.315" O.D. 12 gauge steel tubing with welded 1/4" thick steel tabs and will have a multi-stage baked-on powder coat finish.

### ORBITAL SHADE CANOPY:

Shall be UV & mildew resistant woven acrylic fabric, folded and stitched for strength and to accommodate steel tensioner.

### HARDWARE:

Shall be stainless steel, zinc/nickel plated or galvanized as required to resist rust and corrosion.

## Maintenance

Periodically tighten all screws, bolts and nuts. A periodic inspection of all parts is necessary. If a part is broken or worn, replace immediately. For general maintenance please refer to our Playground Maintenance Manual.



www.playcraftsystems.com  
For Customer Service Call  
800.333.8519 (U.S.A.) or 541.955.9199 (International)

**Rev C**  
12/7/2022