

IMPORTANT NOTES: Read First

(A) Use liquid thread lock (such as Loctite®) with all threaded hardware. **Important:** Liquid thread lock (prior to curing) helps to eliminate the common problem of "thread seizure" in stainless steel hardware by serving as a lubricant during assembly.

(B) Refer to Installation Manual for R5-09 Collars and R5-11 Socket Clamps installation instructions.

(C) All gaps created (e.g. between panels, between panel and deck, between panel and roof, etc.) must be less than 3-1/2" [89mm] or greater than 9" [229mm].

(D) An appropriate energy absorbing safety surface is required under and around all playground equipment. Loose fill protective surfacing is shown only as an example for the purpose of this assembly instruction. Other surfacing material may vary in thickness and/or compression depths. See free publication - The Handbook for Public Playground Safety, Publication #325 at www.cpsc.gov for the surfacing appropriate for the fall height of the equipment or consult your surfacing supply representative.

FIGURE 1
Tree House Panel
Assembly

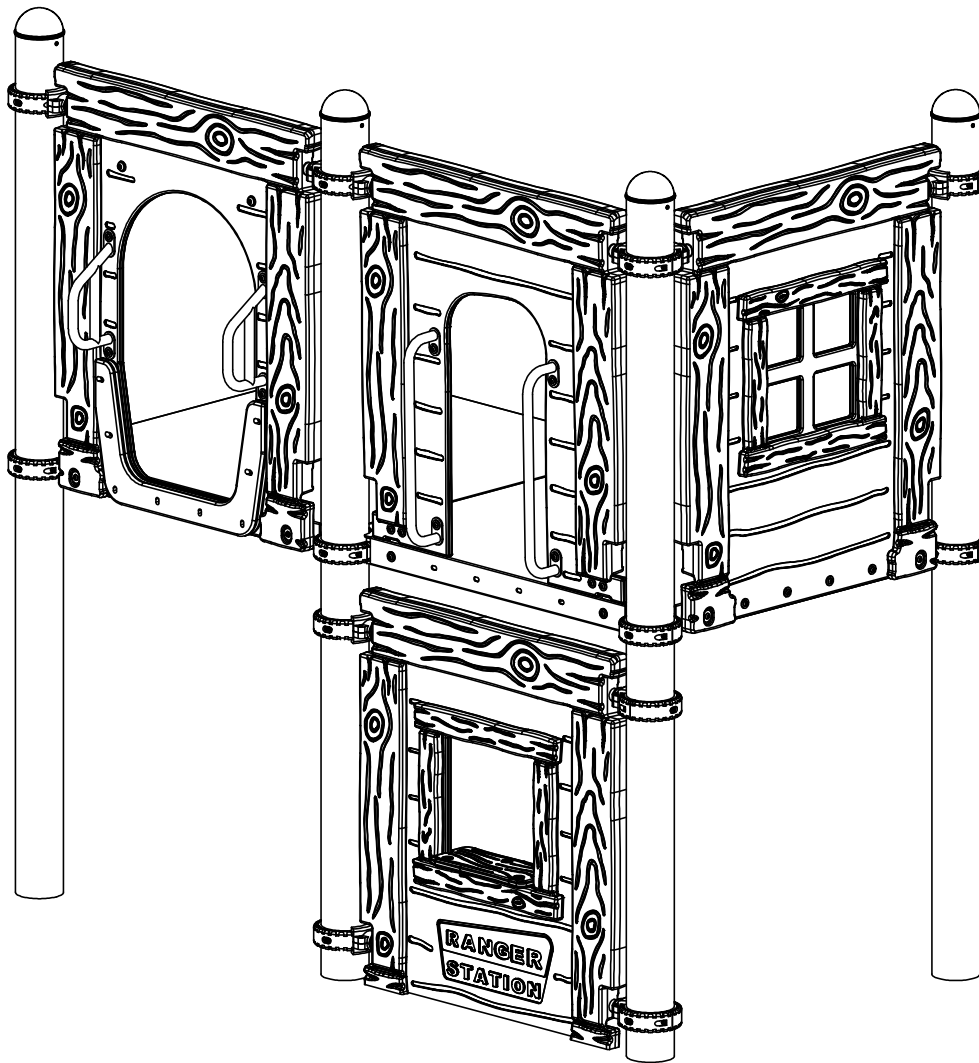

Step 1

Locate and attach collars to posts at heights shown in Elevation View. (See Notes B & C)

* Height shown from top of deck to top of collar.

** Height shown from top of collar to top of collar.

*** Height shown from top of collar to Finish Grade.

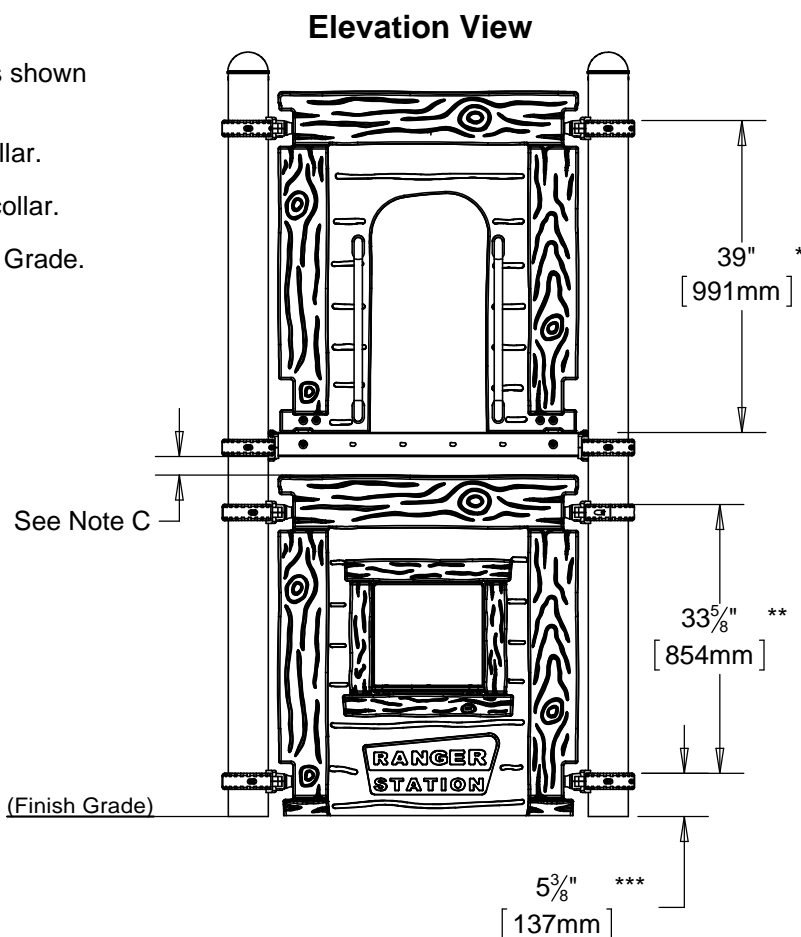

Step 2 (Factory Assembled)

Attach Vent Plug to Panel Trim as shown in Figure 2.

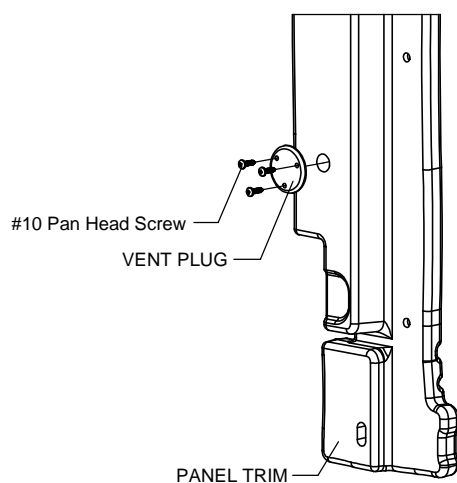

FIGURE 2

CENTER ACCESS PANEL - CUT

Step 1 (Factory Assembled)

Attach Panel Trim to Center Access Panel - Cut as shown in Figure 3. (See Note A)

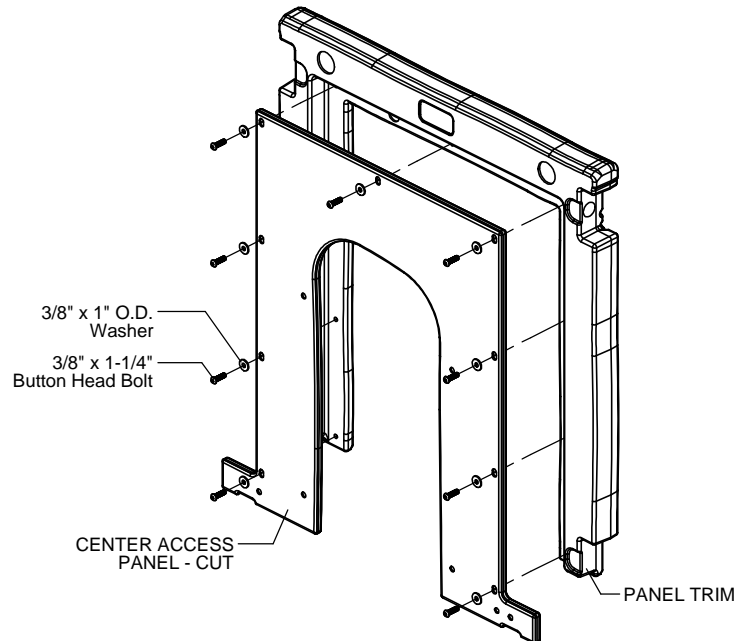

FIGURE 3

Step 2

Attach Panel Brackets to Center Access Panel - Cut as shown in Figure 4. (See Note A)

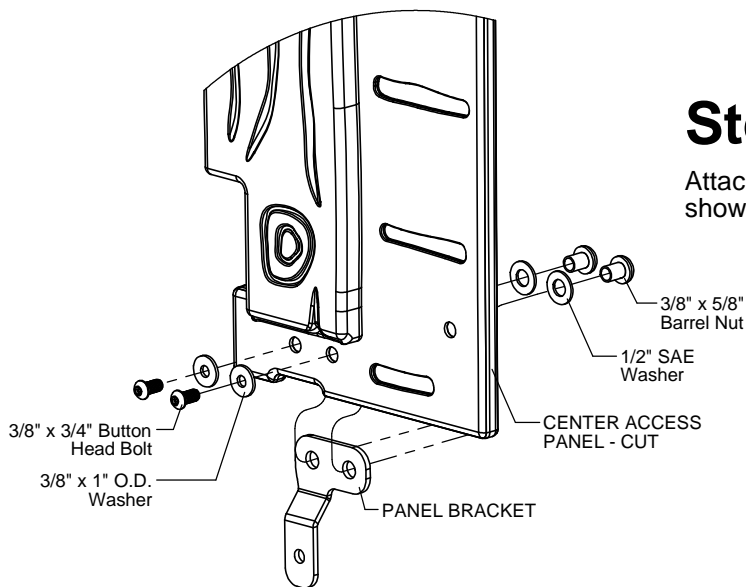

FIGURE 4

Step 3

Attach Center Access Panel - Cut to collars as shown in Figure 5. (See Notes A & B)

NOTE: Face flat side of the Lug down.

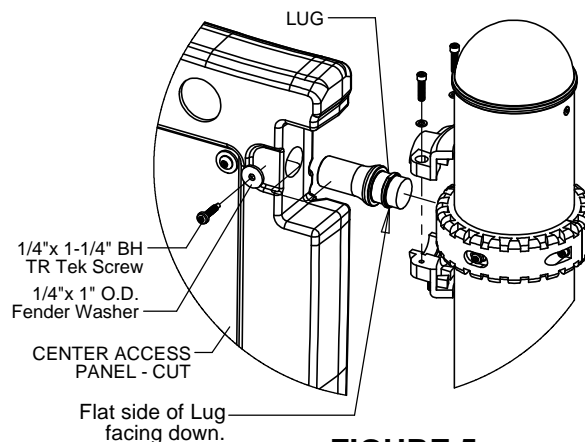

FIGURE 5

Step 4

Attach Panel Brackets to deck as shown in Figure 6.
(See Note A)

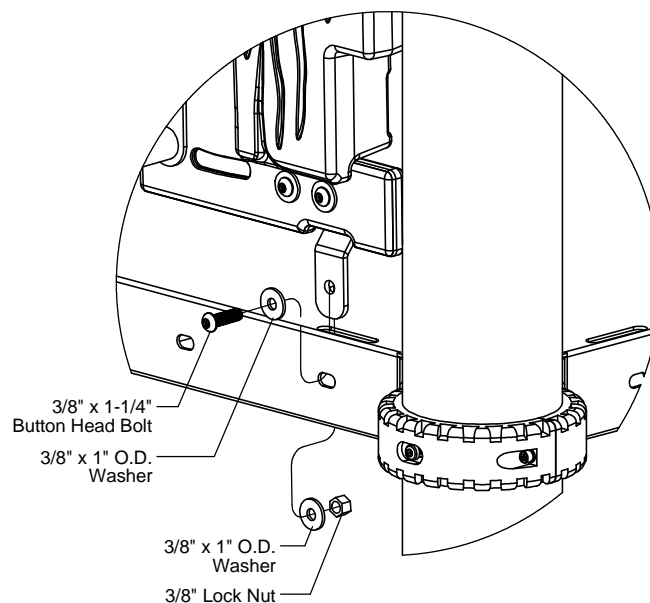

FIGURE 6

Step 5

Attach Access Handles to Center Access Panel - Cut as shown in Figure 7. (See Note A)

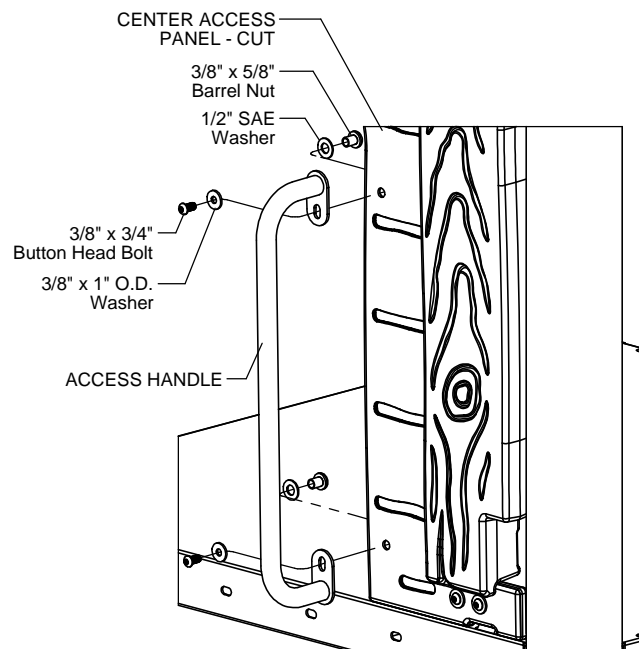

FIGURE 7

DOOR PANEL

Step 1 (Factory Assembled)

Attach Panel Trim to Door Panel as shown in Figure 8.
(See Note A)

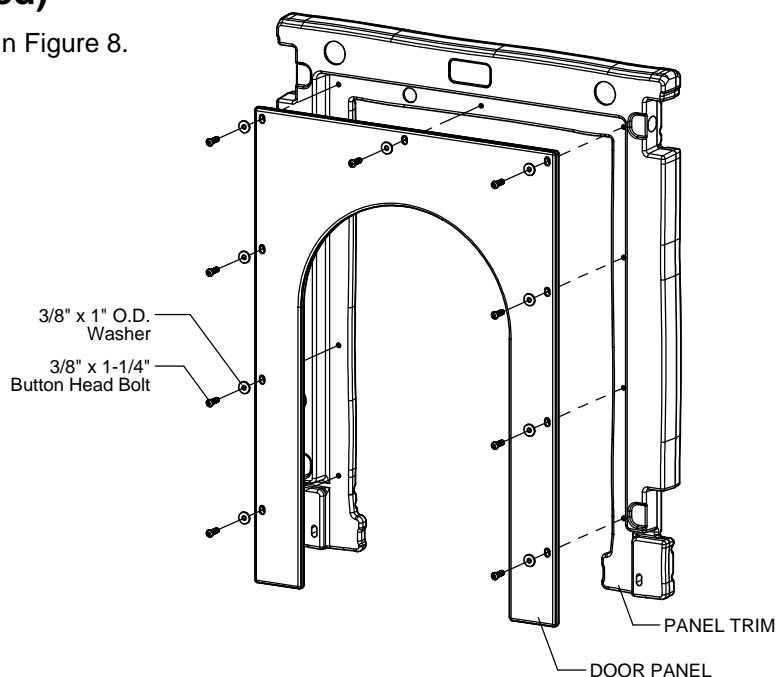

FIGURE 8

Step 2

Attach Door Panel to collars as shown in Figure 9.
(See Notes A & B)

NOTE: Face flat side of the Lug down.

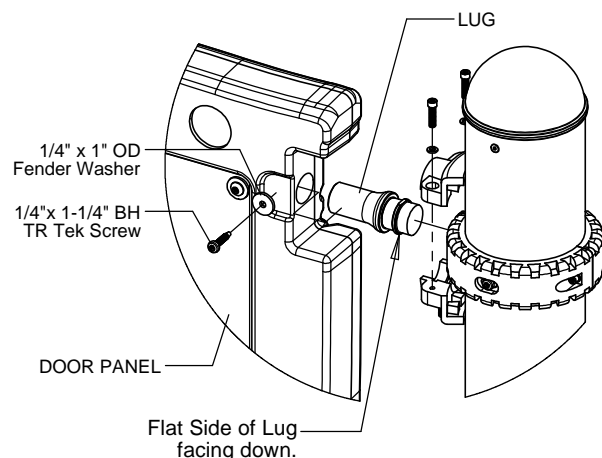

FIGURE 9

CENTER ACCESS PANEL - FULL & SIDE ACCESS PANEL

Step 1 (Factory Assembled)

Attach Panel Trim to Access Panel as shown in Figure 10.
(See Note A)

NOTE: Center Access Panel - Full shown.

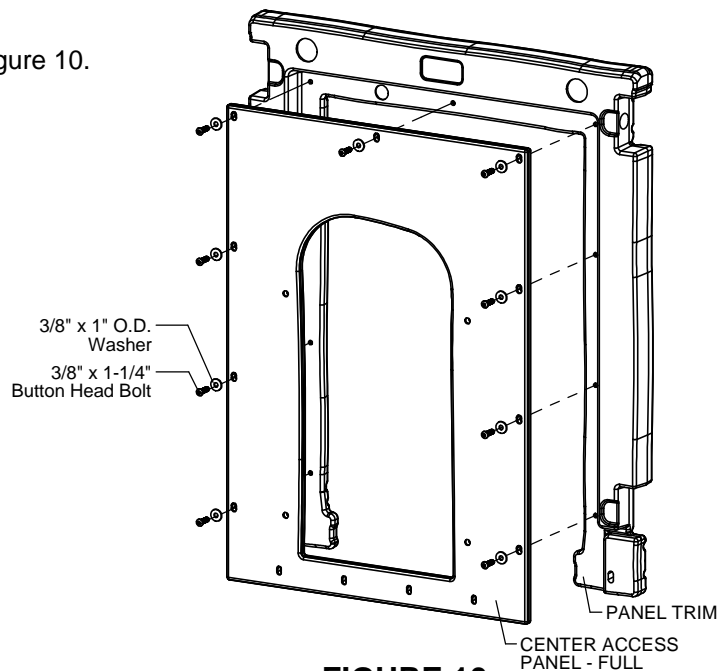

FIGURE 10

Step 2

Attach Access Panel to collars as shown in Figure 11.
(See Notes A & B)

NOTE: Face flat side of the Lug down.

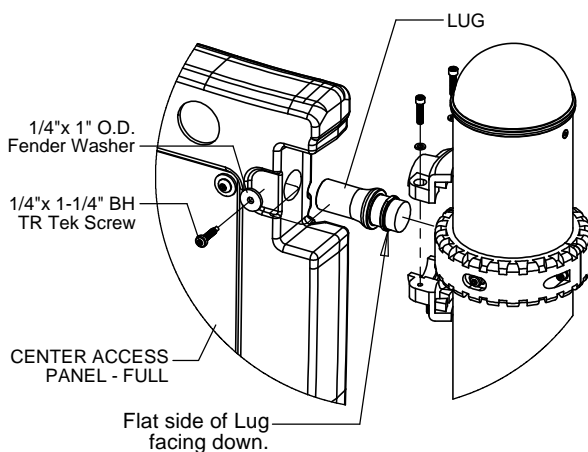

FIGURE 11

Step 3

Attach Access Handles to Access Panel as shown in Figure 12. (See Note A)

NOTE: Center Access Panel - Full shown.

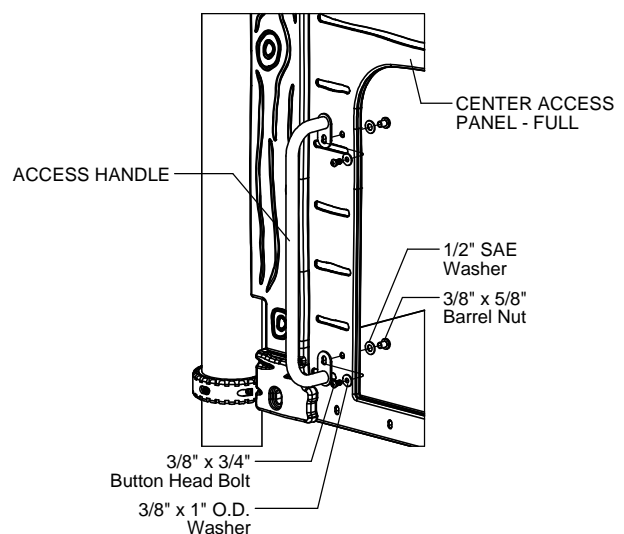

FIGURE 12

Step 4

Refer to appropriate event configuration and attach event to Access Panel as shown in Figure 13.
(See Note A)

NOTE: Use hardware included with Access Panel.

No Event Mount

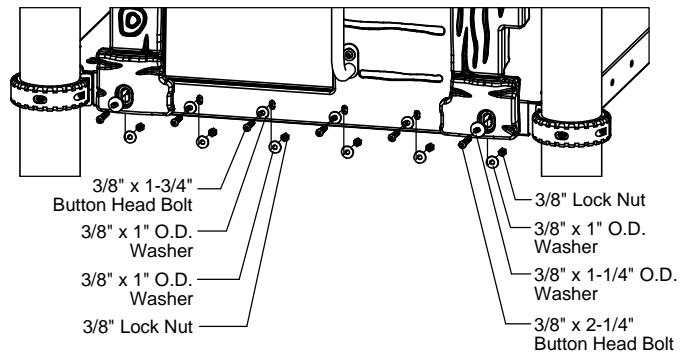

FIGURE 13a

2 Bolt Inside Mount

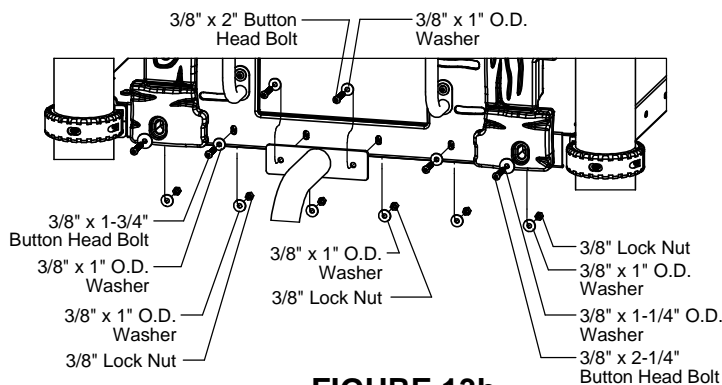

FIGURE 13b

2 Bolt Outside Mount

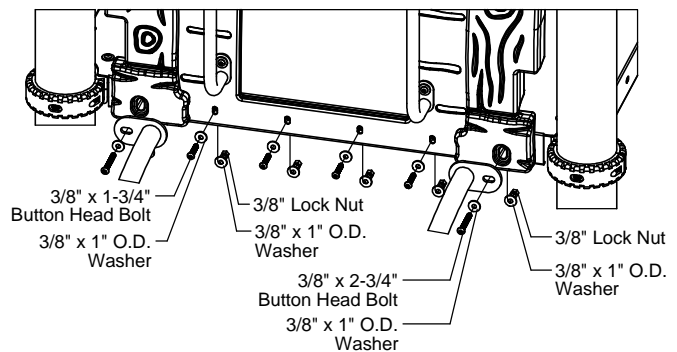

FIGURE 13c

4 Bolt Mount

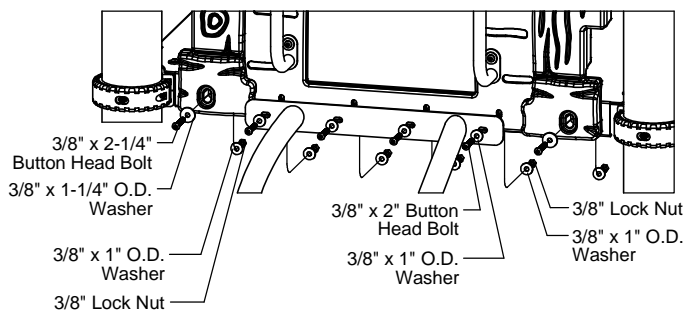

FIGURE 13d

LOG CRAWL TUBE & PANEL

Step 1 (Factory Assembled)

Attach Panel Trim to Log Tube Panel as shown in Figure 14. (See Note A)

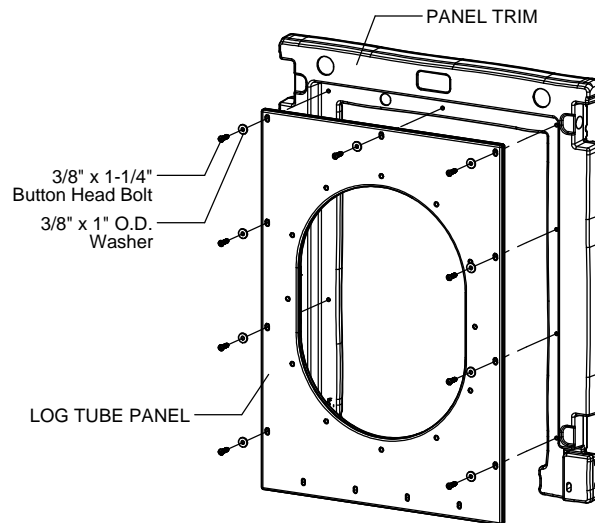

FIGURE 14

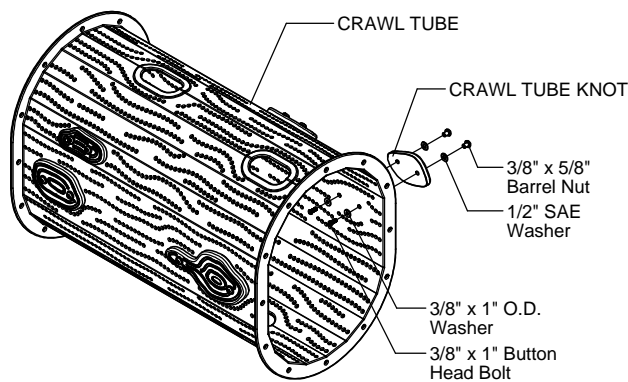

FIGURE 15

Step 2 (Factory Assembled)

Attach Crawl Tube Knots to Crawl Tube as shown in Figure 15. (See Note A)

Step 3

Attach Log Tube Panel to collars as shown in Figure 16. (See Notes A & B)

NOTE: Face flat side of the Lug down.

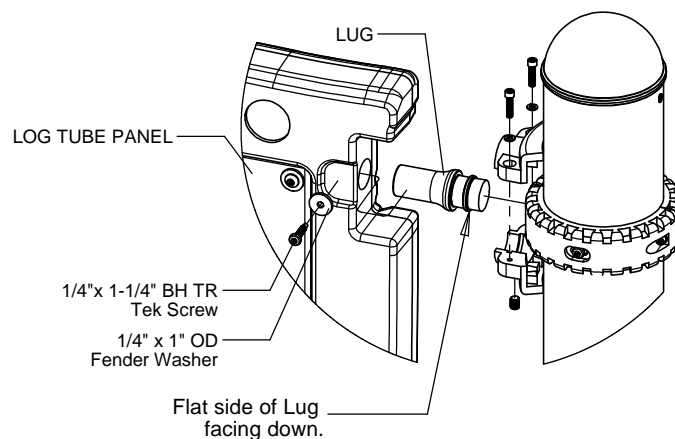

FIGURE 16

Step 4

Attach Log Tube Panel to deck as shown in Figure 17. (See Note A)

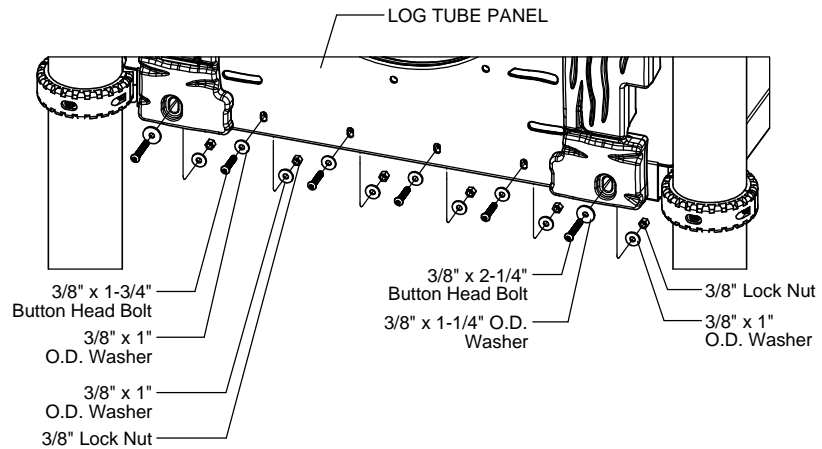

FIGURE 17

Step 5

Attach Crawl Tube to Log Tube Panels as shown in Figure 18. (See Note A)

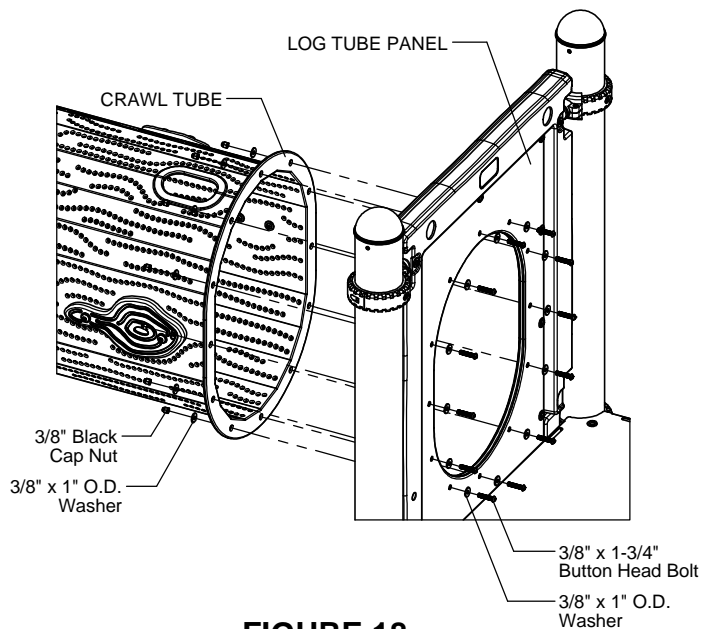

FIGURE 18

RANGER STATION PANEL

Step 1 (Factory Assembled)

Attach Panel and Window Trim to Ranger Station Panel as shown in Figure 19. (See Note A)

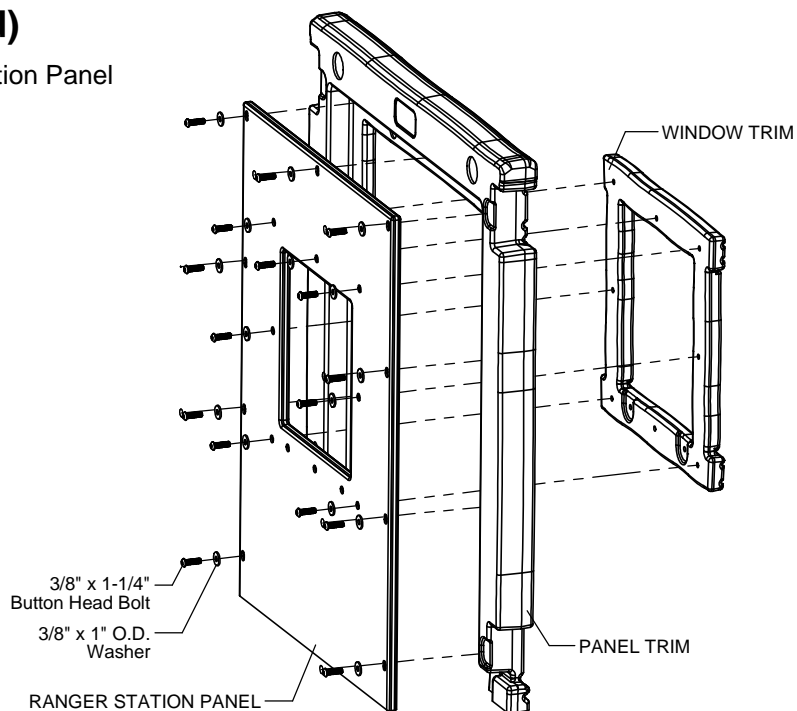

FIGURE 19

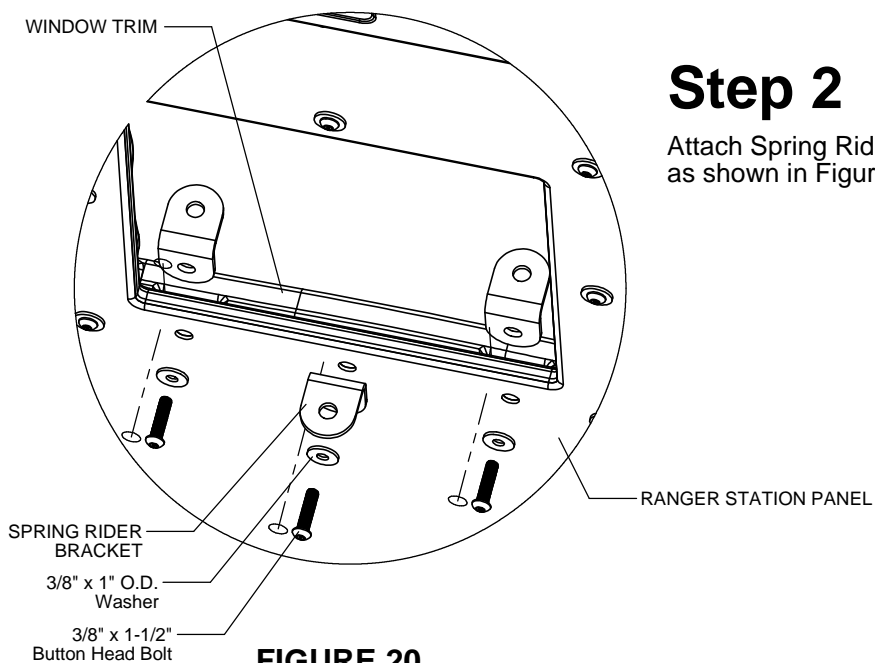

FIGURE 20

Step 2

Attach Spring Rider Brackets to Ranger Station Panel as shown in Figure 20. (See Note A)

Step 3

Attach Ranger Station Counter to Spring Rider Brackets as shown in Figure 21. (See Note A)

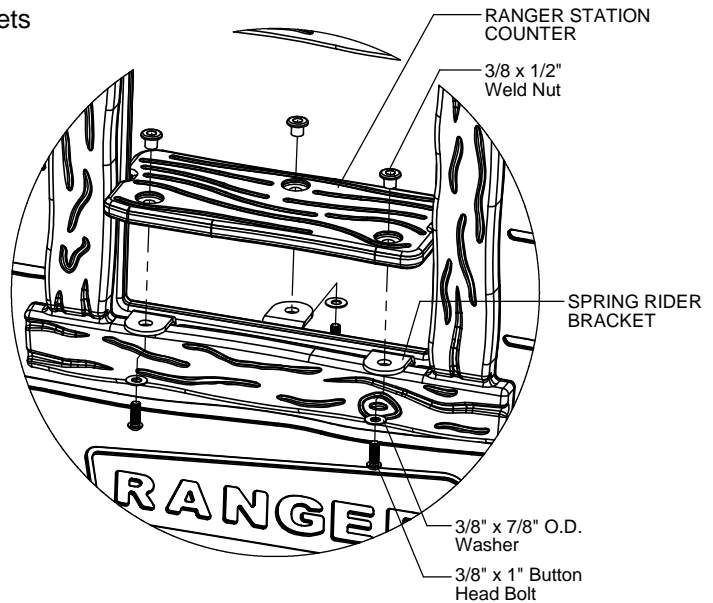

FIGURE 21

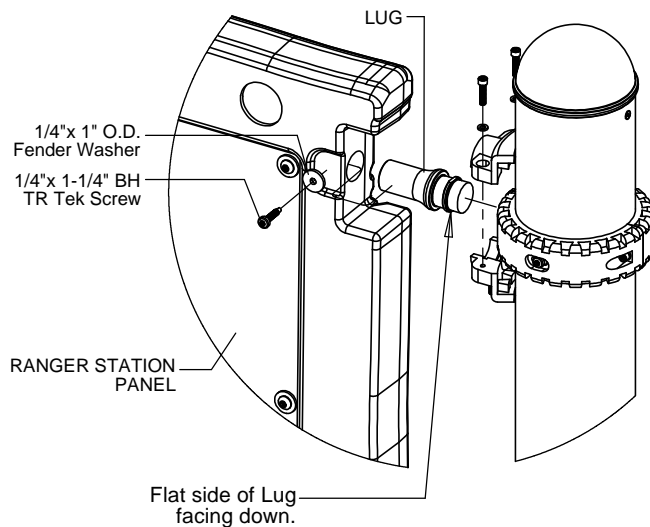

FIGURE 22

Step 4

Attach Ranger Station Panel to collars as shown in Figure 22. (See Notes A & B)

NOTE: Face flat side of the Lug down.

SLIDE PANELS

Step 1 (Factory Assembled)

Attach Panel Trim to Slide Panel as shown in Figure 23.
(See Note A)

NOTE: Twister Slide Panel shown.

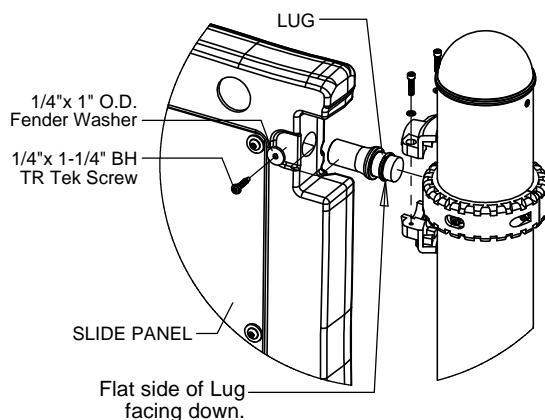

FIGURE 24

Step 3

Attach Slide Panel to deck as shown in Figure 25.
(See Note A)

NOTE: Twister Slide Panel shown.

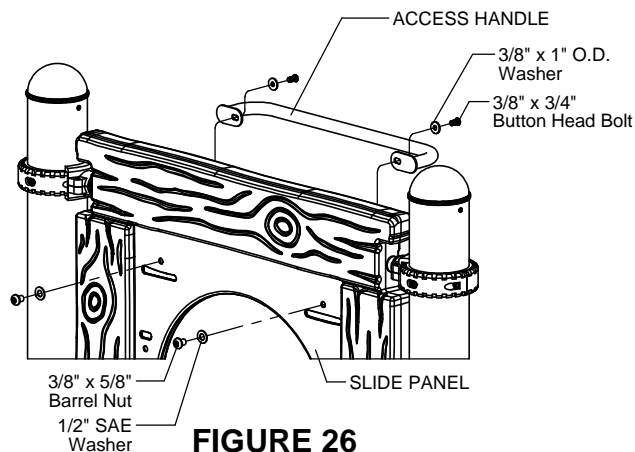

FIGURE 26

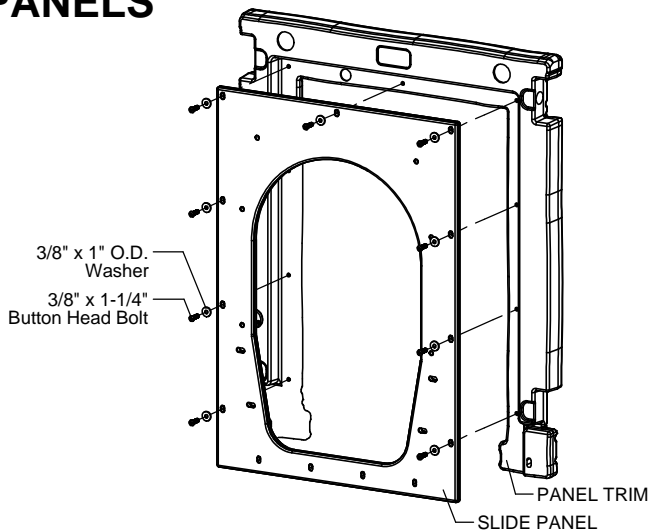

FIGURE 23

Step 2

Attach Slide Panel to collars as shown in Figure 24.
(See Notes A & B)

NOTE: Face flat side of the Lug down.

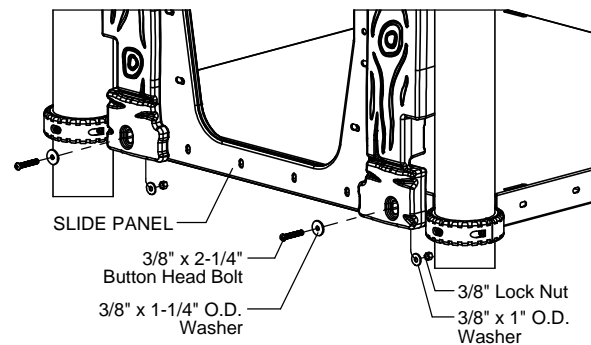

FIGURE 25

Step 4

Attach Access Handle to Slide Panel as shown in Figure 26. (See Note A)

Step 5

Attach Side Guards to Slide Panel as shown in Figure 27. (See Note A)

NOTE: Twister Slide Panel shown.

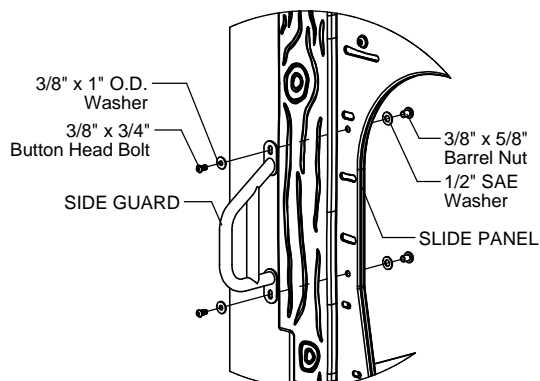

FIGURE 27

Step 6

For Twister Slide Panel Only

Attach Twister Slide to Slide Panel and deck as shown in Figure 28. (See Note A)

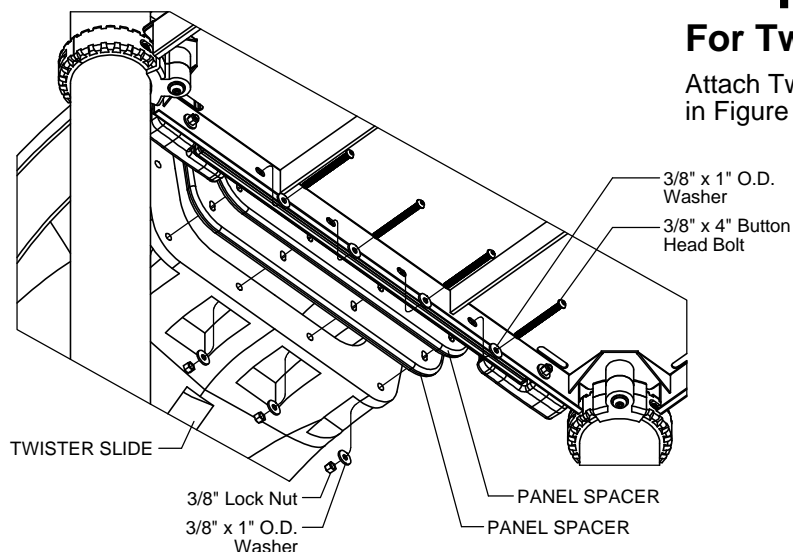

FIGURE 28

Step 7

For Twister Slide Panel Only

Attach Twister Slide to Slide Panel as shown in Figure 29. (See Note A)

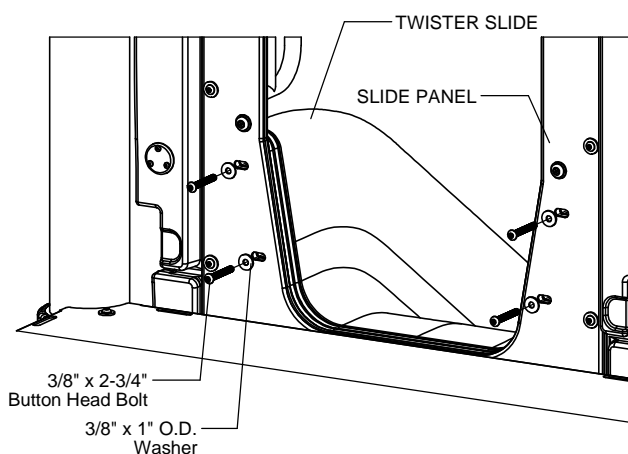

FIGURE 29

Step 8

For Poly Slide Panel Only

Attach Poly Slide to Slide Panel and deck as shown in Figure 30. (See Note A)

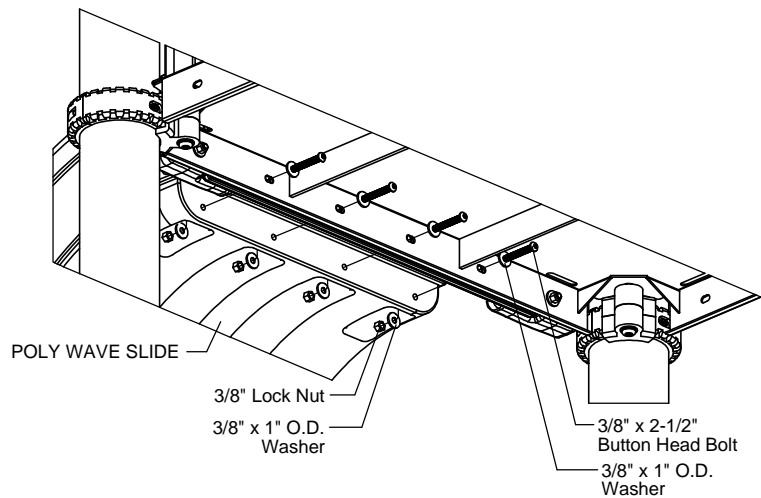

FIGURE 30

Step 9

For Tree House Slide Panel Only

Attach Tree House Slide to Slide Panel and deck as shown in Figure 31. (See Note A)

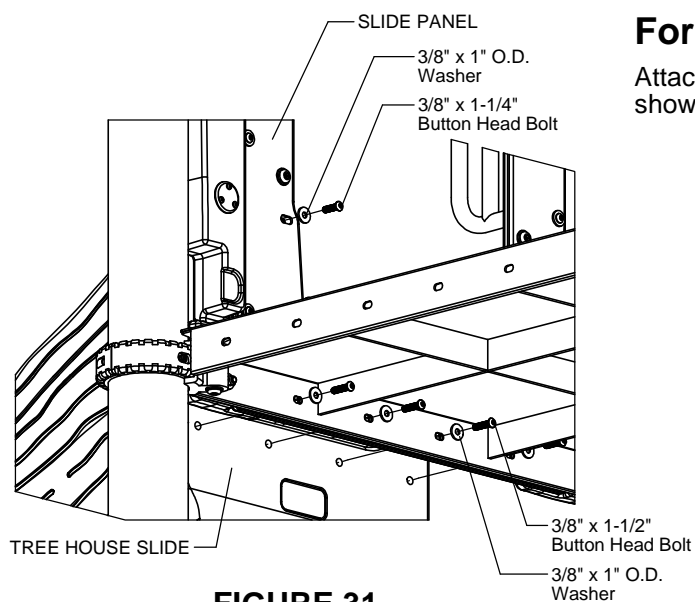

FIGURE 31

WINDOW PANEL

Step 1 (Factory Assembled)

Attach Panel Trim and Window Trim to Window Panel as shown in Figure 32. (See Note A)

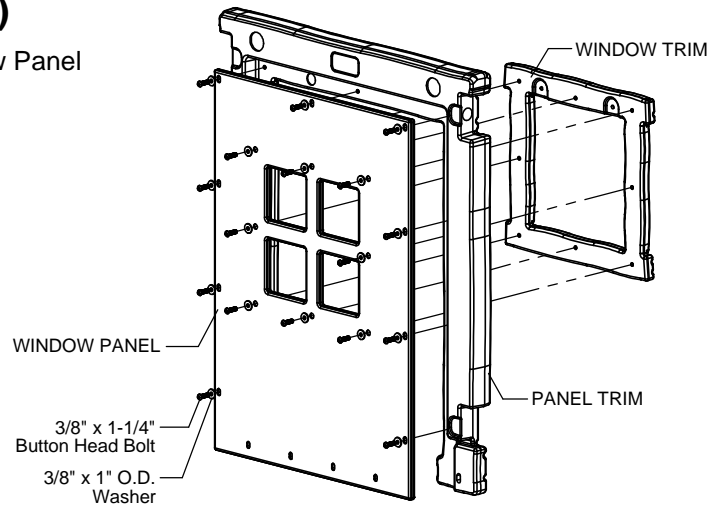

FIGURE 32

Step 2

Attach Window Panel to collars as shown in Figure 33. (See Notes A & B)

NOTE: Face flat side of the Lug down.

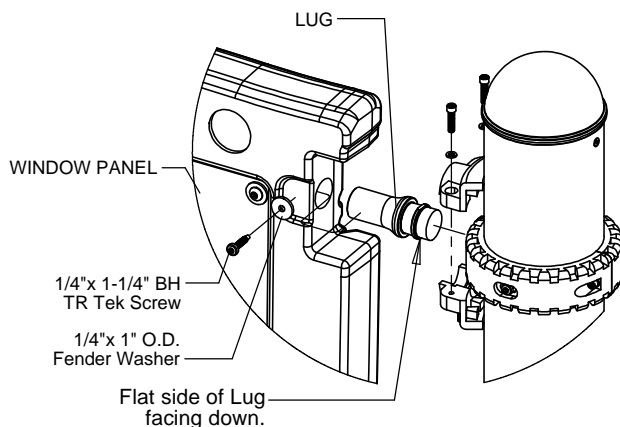

FIGURE 33

Step 3

Attach Window Panel to deck as shown in Figure 34. (See Note A)

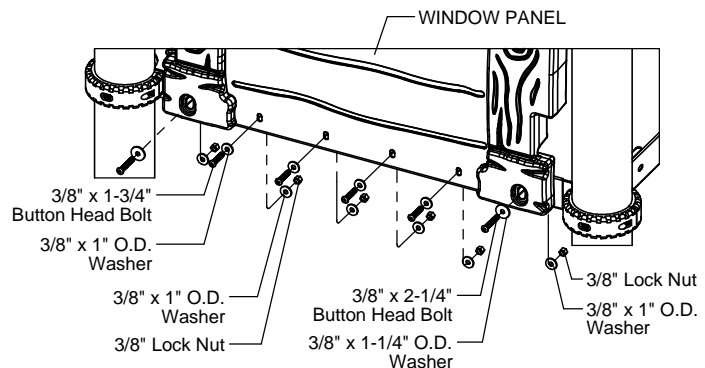

FIGURE 34

TREE HOUSE PANEL ASSEMBLY INSTALLATION INSTRUCTIONS

R5-1677
Page 16 of 19

Center Access Panel - Cut

PARTS LIST		
Part #	DESCRIPTION	QTY.
BE-0421-L	Tree House Panel Bracket - Left	1
BE-0421-R	Tree House Panel Bracket - Right	1
FS-1677	Tree House Access Handle	2
HS-1001-R5	Socket Clamp Set R5	2
IE-0029	Roto Panel Lug	2
9103032-TR	Bolt Button Head 3/8" x 3/4"	8
9103062-TR	Bolt Button Head 3/8" x 1-1/4"	2
9271062-TR	Screw Tek 1/4" x 1-1/4" BH TR	2
9321052-THK	Washer Fender 1/4" x 1" OD x .125" thk	2
9333002	Washer Flat 3/8" x 1" O.D. x .100" thick	12
9345002	Washer Flat SAE 1/2"	8
9413002	Nut Lock 3/8"	2
9443022-TR	Nut Barrel 3/8" x 5/8" BH	8

ASSEMBLED PARTS LIST		
Part #	DESCRIPTION	QTY.
DF-0011-CT	Tree House Panel Trim - Cut	1
EE-4867	Geo-Wave Vent Plug	1
EF-0089	Tree House Center Access Panel - Cut	1
9103062-TR	Bolt Button Head 3/8" x 1-1/4"	9
9251032	Screw SQ #10x3/4 DR PH SMS SS	3
9333002	Washer Flat 3/8" x 1" O.D. x .100" thick	9

Side Access Panel

PARTS LIST		
Part #	DESCRIPTION	QTY.
FS-1677	Tree House Access Handle	1
HS-1001-R5	Socket Clamp Set R5	2
IE-0029	Roto Panel Lug	2
9103032-TR	Bolt Button Head 3/8" x 3/4"	2
9103082-TR	Bolt Button Head 3/8" x 1-3/4"	4
9103102-TR	Bolt Button Head 3/8" x 2-1/4"	2
9271062-TR	Screw Tek 1/4" x 1-1/4" BH TR	2
9321052-THK	Washer Fender 1/4" x 1" OD x .125" thk	2
9333002	Washer Flat 3/8" x 1" O.D. x .100" thick	12
9333062	Washer Flat 3/8" x 1-1/4" x .125	2
9345002	Washer Flat SAE 1/2"	2
9413002	Nut Lock 3/8"	6
9443022-TR	Nut Barrel 3/8" x 5/8" BH	2

ASSEMBLED PARTS LIST		
Part #	DESCRIPTION	QTY.
DF-0011	Tree House Panel Trim	1
EE-4867	Geo-Wave Vent Plug	1
EF-0090-R	Tree House Access Panel - Right	1
9103062-TR	Bolt Button Head 3/8" x 1-1/4"	9
9251032	Screw SQ #10x3/4 DR PH SMS SS	3
9333002	Washer Flat 3/8" x 1" O.D. x .100" thick	9

Center Access Panel - Full

PARTS LIST		
Part #	DESCRIPTION	QTY.
FS-1677	Tree House Access Handle	2
HS-1001-R5	Socket Clamp Set R5	2
IE-0029	Roto Panel Lug	2
9103032-TR	Bolt Button Head 3/8" x 3/4"	4
9103082-TR	Bolt Button Head 3/8" x 1-3/4"	4
9103092-TR	Bolt Button Head 3/8" x 2"	4
9103102-TR	Bolt Button Head 3/8" x 2-1/4"	2
9103122-TR	Bolt Button Head 3/8" x 2-3/4"	2
9271062-TR	Screw Tek 1/4" x 1-1/4" BH TR	2
9321052-THK	Washer Fender 1/4" x 1" OD x .125" thk	2
9333002	Washer Flat 3/8" x 1" O.D. x .100" thick	16
9333062	Washer Flat 3/8" x 1-1/4" x .125	2
9345002	Washer Flat SAE 1/2"	4
9413002	Nut Lock 3/8"	6
9443022-TR	Nut Barrel 3/8" x 5/8" BH	4

ASSEMBLED PARTS LIST		
Part #	DESCRIPTION	QTY.
DF-0011	Tree House Panel Trim	1
EE-4867	Geo-Wave Vent Plug	1
EF-0133	Tree House Center Access Panel - Full	1
9103062-TR	Bolt Button Head 3/8" x 1-1/4"	9
9251032	Screw SQ #10x3/4 DR PH SMS SS	3
9333002	Washer Flat 3/8" x 1" O.D. x .100" thick	9

Door Panel

PARTS LIST		
Part #	DESCRIPTION	QTY.
HS-1001-R5	Socket Clamp Set R5	4
IE-0029	Roto Panel Lug	4
9271062-TR	Screw Tek 1/4" x 1-1/4" BH TR	4
9321052-THK	Washer Fender 1/4" x 1" OD x .125" thk	4

ASSEMBLED PARTS LIST		
Part #	DESCRIPTION	QTY.
DF-0011	Tree House Panel Trim	1
EE-4867	Geo-Wave Vent Plug	1
EF-0221	Tree House Door Panel	1
9103062-TR	Bolt Button Head 3/8" x 1-1/4"	9
9251032	Screw SQ #10x3/4 DR PH SMS SS	3
9333002	Washer Flat 3/8" x 1" O.D. x .100" thick	9



Manufactured by Krauss Craft, Inc.
www.playcraftsystems.com

For Customer Service Call
800.333.8519 (U.S.A.) or
541.955.9199 (International)

Rev F
2/17/2014

TREE HOUSE PANEL ASSEMBLY INSTALLATION INSTRUCTIONS

R5-1677
Page 17 of 19

Log Crawl Tube Panel

PARTS LIST		
Part #	DESCRIPTION	QTY.
HS-1001-R5	Socket Clamp Set R5	2
IE-0029	Roto Panel Lug	2
9103082-TR	Bolt Button Head 3/8" x 1-3/4"	4
9103102-TR	Bolt Button Head 3/8" x 2-1/4"	2
9271062-TR	Screw Tek 1/4" x 1-1/4" BH TR	2
9321052-THK	Washer Fender 1/4" x 1" OD x .125" thk	2
9333002	Washer Flat 3/8" x 1" O.D. x .100" thick	10
9333062	Washer Flat 3/8" x 1-1/4" x .125	2
9413002	Nut Lock 3/8"	6

ASSEMBLED PARTS LIST		
Part #	DESCRIPTION	QTY.
DF-0011	Tree House Panel Trim	1
EE-4867	Geo-Wave Vent Plug	1
EF-0219	Tree House Log Tube Panel	1
9103062-TR	Bolt Button Head 3/8" x 1-1/4"	9
9251032	Screw SQ #10x3/4 DR PH SMS SS	3
9333002	Washer Flat 3/8" x 1" O.D. x .100" thick	9

Poly Slide Entry Panel

PARTS LIST		
Part #	DESCRIPTION	QTY.
FS-1304-R35CAN	Sit Down Side Guard R3.5 Canada	2
FS-1677	Tree House Access Handle	1
HS-1001-R5	Socket Clamp Set R5	2
IE-0029	Roto Panel Lug	2
9103032-TR	Bolt Button Head 3/8" x 3/4"	6
9103102-TR	Bolt Button Head 3/8" x 2-1/4"	2
9103112-TR	Bolt Button Head 3/8" x 2-1/2"	4
9271062-TR	Screw Tek 1/4" x 1-1/4" BH TR	2
9321052-THK	Washer Fender 1/4" x 1" OD x .125" thk	2
9333002	Washer Flat 3/8" x 1" O.D. x .100" thick	16
9333062	Washer Flat 3/8" x 1-1/4" x .125	2
9345002	Washer Flat SAE 1/2"	6
9413002	Nut Lock 3/8"	6
9443022-TR	Nut Barrel 3/8" x 5/8" BH	6

ASSEMBLED PARTS LIST		
Part #	DESCRIPTION	QTY.
DF-0011	Tree House Panel Trim	1
EE-4867	Geo-Wave Vent Plug	1
EF-0104-SE	Tree House Roto Slide Entry Panel	1
9103062-TR	Bolt Button Head 3/8" x 1-1/4"	9
9251032	Screw SQ #10x3/4 DR PH SMS SS	3
9333002	Washer Flat 3/8" x 1" O.D. x .100" thick	9

Tree House Slide Entry Panel

PARTS LIST		
Part #	DESCRIPTION	QTY.
FS-1304-R35CAN	Sit Down Side Guard R3.5 Canada	2
FS-1677	Tree House Access Handle	1
HS-1001-R5	Socket Clamp Set R5	2
IE-0029	Roto Panel Lug	2
9103032-TR	Bolt Button Head 3/8" x 3/4"	6
9103062-TR	Bolt Button Head 3/8" x 1-1/4"	4
9103072-TR	Bolt Button Head 3/8" x 1-1/2"	4
9103102-TR	Bolt Button Head 3/8" x 2-1/4"	2
9271062-TR	Screw Tek 1/4" x 1-1/4" BH TR	2
9321052-THK	Washer Fender 1/4" x 1" OD x .125" thk	2
9333002	Washer Flat 3/8" x 1" O.D. x .100" thick	16
9333062	Washer Flat 3/8" x 1-1/4" x .125	2
9345002	Washer Flat SAE 1/2"	6
9413002	Nut Lock 3/8"	2
9443022-TR	Nut Barrel 3/8" x 5/8" BH	6

ASSEMBLED PARTS LIST		
Part #	DESCRIPTION	QTY.
DF-0011	Tree House Panel Trim	1
EE-4867	Geo-Wave Vent Plug	1
EF-0104	Tree House Slide Entry Panel	1
9103062-TR	Bolt Button Head 3/8" x 1-1/4"	9
9251032	Screw SQ #10x3/4 DR PH SMS SS	3
9333002	Washer Flat 3/8" x 1" O.D. x .100" thick	9

Twister Slide Entry Panel

PARTS LIST		
Part #	DESCRIPTION	QTY.
EE-0247	Tree House Twister Panel Spacer	2
FS-1316-CAN	Twister Sit Down Side Guard Canada	2
FS-1677	Tree House Access Handle	1
HS-1001-R5	Socket Clamp Set R5	2
IE-0029	Roto Panel Lug	2
9103032-TR	Bolt Button Head 3/8" x 3/4"	6
9103102-TR	Bolt Button Head 3/8" x 2-1/4"	2
9103172	Bolt Button Head 3/8" x 4"	4
9103122-TR	Bolt Button Head 3/8" x 2-3/4"	4
9271062-TR	Screw Tek 1/4" x 1-1/4" BH TR	2
9321052-THK	Washer Fender 1/4" x 1" OD x .125" thk	2
9333002	Washer Flat 3/8" x 1" O.D. x .100" thick	20
9333062	Washer Flat 3/8" x 1-1/4" x .125	2
9345002	Washer Flat SAE 1/2"	6
9413002	Nut Lock 3/8"	6
9443022-TR	Nut Barrel 3/8" x 5/8" BH	6

ASSEMBLED PARTS LIST		
Part #	DESCRIPTION	QTY.
DF-0011	Tree House Panel Trim	1
EE-4867	Geo-Wave Vent Plug	1
EF-0104-TWS	Tree House Twister Slide Entry Panel	1
9103062-TR	Bolt Button Head 3/8" x 1-1/4"	9
9251032	Screw SQ #10x3/4 DR PH SMS SS	3
9333002	Washer Flat 3/8" x 1" O.D. x .100" thick	9



Manufactured by Krauss Craft, Inc.
www.playcraftsystems.com

For Customer Service Call
800.333.8519 (U.S.A.) or
541.955.9199 (International)

Rev F
2/17/2014

TREE HOUSE PANEL ASSEMBLY INSTALLATION INSTRUCTIONS

R5-1677
Page 18 of 19

Ranger Station Panel

PARTS LIST		
Part #	DESCRIPTION	QTY.
BE-4466	Spring Rider Bracket	3
EF-0094	Tree House Ranger Station Counter	1
HS-1001-R5	Socket Clamp Set R5	4
IE-0029	Roto Panel Lug	4
9103052-TR	Bolt Button Head 3/8" x 1"	3
9103072-TR	Bolt Button Head 3/8" x 1-1/2"	3
9271062-TR	Screw Tek 1/4" x 1-1/4" BH TR	4
9321052-THK	Washer Fender 1/4" x 1" OD x .125" thk	4
9333002	Washer Flat 3/8" x 1" O.D. x .100" thick	3
9333042	Washer Flat 3/8" x 7/8" O.D.	3
9493012	3/8 x 1/2" Weld Nut	3

ASSEMBLED PARTS LIST		
Part #	DESCRIPTION	QTY.
DF-0011	Tree House Panel Trim	1
DF-0012	Tree House Window Trim	1
EE-4867	Geo-Wave Vent Plug	1
EF-0087	Tree House Ranger Station Panel	1
9103062-TR	Bolt Button Head 3/8" x 1-1/4"	16
9251032	Screw SQ #10x3/4 DR PH SMS SS	3
9333002	Washer Flat 3/8" x 1" O.D. x .100" thick	16

Steel Log Crawl Tube

PARTS LIST		
Part #	DESCRIPTION	QTY.
9103082-TR	Bolt Button Head 3/8" x 1-3/4"	24
9333002	Washer Flat 3/8" x 1" O.D. x .100" thick	48
9413162-BLK	Nut Lock 3/8" w/ Black Cap	24

ASSEMBLED PARTS LIST		
Part #	DESCRIPTION	QTY.
CF-0528	Tree House Steel Crawl Tube R5	1
EE-0338-K1	Steel Log Crawl Tube Knot 1	3
EE-0338-K2	Steel Log Crawl Tube Knot 2	2
EE-0338-K3	Steel Log Crawl Tube Knot 3	1
EE-0338-K4	Steel Log Crawl Tube Knot 4	1
9103052-TR	Bolt Button Head 3/8" x 1"	14
9333002	Washer Flat 3/8" x 1" O.D. x .100" thick	14
9345002	Washer Flat SAE 1/2"	14
9443022-TR	Nut Barrel 3/8" x 5/8" BH	14

Window Panel

PARTS LIST		
Part #	DESCRIPTION	QTY.
HS-1001-R5	Socket Clamp Set R5	2
IE-0029	Roto Panel Lug	2
9103082-TR	Bolt Button Head 3/8" x 1-3/4"	4
9103102-TR	Bolt Button Head 3/8" x 2-1/4"	2
9271062-TR	Screw Tek 1/4" x 1-1/4" BH TR	2
9321052-THK	Washer Fender 1/4" x 1" OD x .125" thk	2
9333002	Washer Flat 3/8" x 1" O.D. x .100" thick	10
9333062	Washer Flat 3/8" x 1-1/4" x .125	2
9413002	Nut Lock 3/8"	6

ASSEMBLED PARTS LIST		
Part #	DESCRIPTION	QTY.
DF-0011	Tree House Panel Trim	1
DF-0012	Tree House Window Trim	1
EE-4867	Geo-Wave Vent Plug	1
EF-0088	Tree House Window Panel	1
9103062-TR	Bolt Button Head 3/8" x 1-1/4"	17
9251032	Screw SQ #10x3/4 DR PH SMS SS	3
9333002	Washer Flat 3/8" x 1" O.D. x .100" thick	17



Manufactured by Krauss Craft, Inc.
www.playcraftsystems.com

For Customer Service Call
800.333.8519 (U.S.A.) or
541.955.9199 (International)

Rev F
2/17/2014

Specifications

PANELS, SPACER, PLUG & COUNTER:

Shall be made from high density 3/4" sheet plastic specially formulated for optimum UV stability and color retention.

PANEL & SPRING RIDER BRACKET:

Shall be precision laser-cut and formed from 3/16" thick steel. The Panel and Spring Rider Brackets shall have a multi-stage baked-on powder coat finish.

TREE HOUSE ACCESS HANDLE & SIT DOWN SIDE GUARD:

Shall be fabricated using 1.029" O.D. 14 gauge steel tubing with welded 10 gauge steel mounting plates. The Tree House Access Handle and Sit Down Side Guard shall have a multi-stage baked-on powder coat finish.

TREE HOUSE PANEL TRIM & WINDOW TRIM:

Shall be constructed of UV-stabilized, rotationally molded, linear, low density polyethylene with an average wall thickness of .250".

ROTO PANEL LUG:

Shall be machined from high-strength aluminum alloy. The Roto Panel Lug shall have a multi-stage baked-on powder coat finish.

STEEL LOG CRAWL TUBE:

Shall be made from punched and formed 12 gauge sheet steel with welded 12 gauge sheet steel flanges and stiffeners. The Steel Log Crawl Tube shall be Play-Tuff™ coated after fabrication.

SOCKET CLAMPS:

Shall be two-part and precision die-cast from a high strength aluminum alloy. The Socket Clamps have a multi-stage baked-on powder coat finish.

HARDWARE:

Shall be stainless steel, zinc/nickel plated or galvanized as required to resist rust and corrosion.

Maintenance

Periodically tighten all screws, bolts and nuts. A periodic inspection of all parts is necessary. If a part is broken or worn, replace immediately. For general maintenance please refer to our Playground Maintenance Manual.

