

IMPORTANT NOTES: Read First

(A) Use liquid thread lock (such as Loctite®) with all threaded hardware. **Important:** Liquid thread lock (prior to curing) helps to eliminate the common problem of "thread seizure" in stainless steel hardware by serving as a lubricant during assembly.

(B) Refer to Installation Manual for R3.5-09 Collars and R3.5-11 Socket Clamps assembly instructions.

FIGURE 1
Sit Down Wall R3.5

Figure 1.2
See Installation Manual
Sections R3.5-09 Collars and
R3.5-11 Socket Clamps

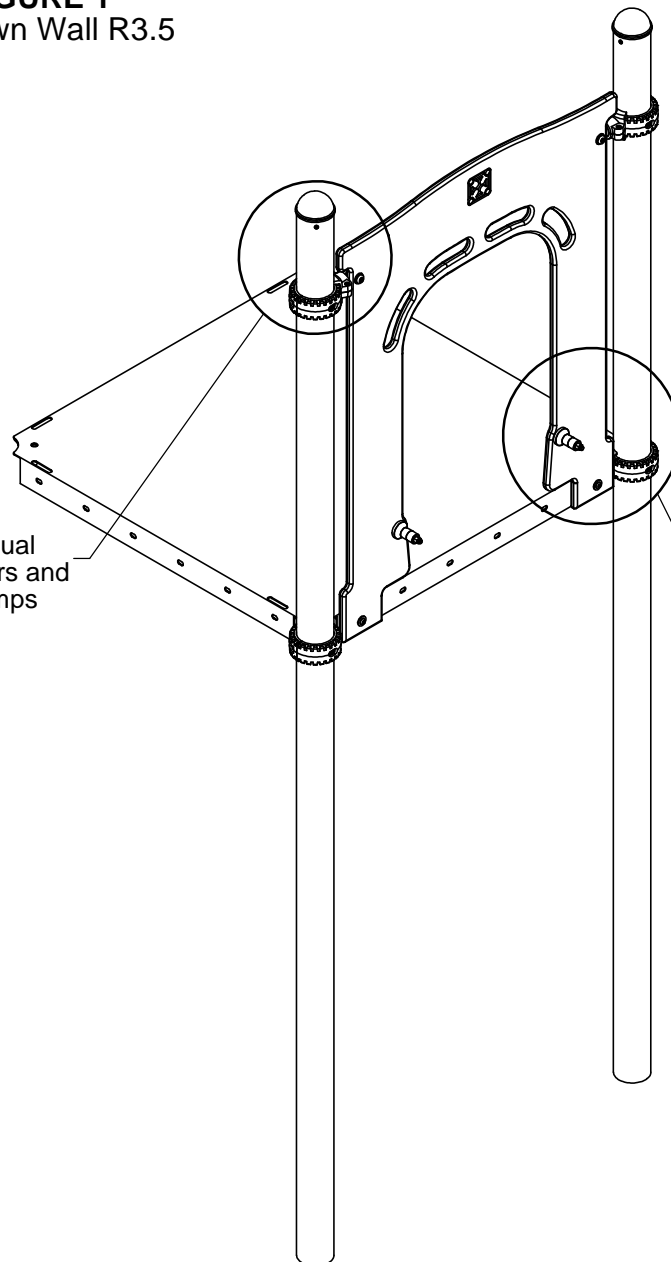

Figures 1.1 and 1.3

Step 1

Loosely attach collars at height shown in Front View. (See Note B)

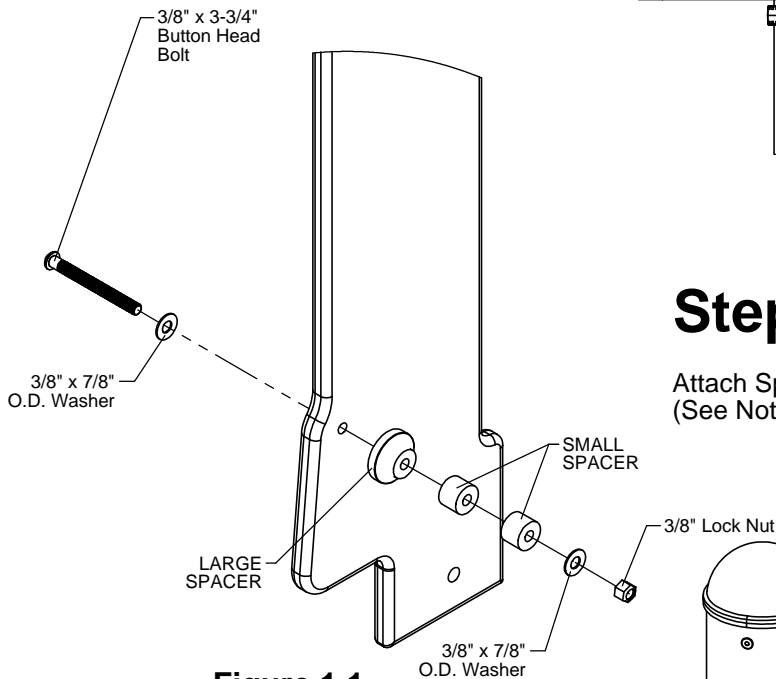
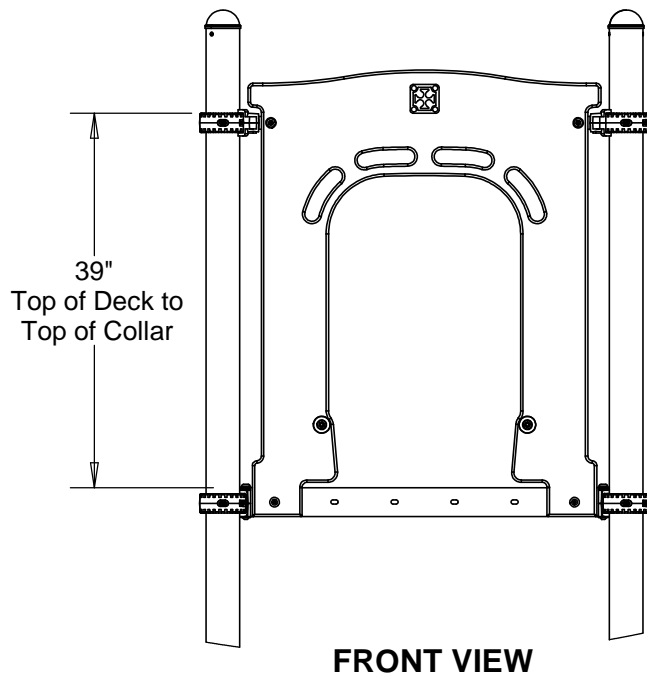

Figure 1.1

Step 2

Attach Spacers to Sit Down Wall as shown in Figure 1.1. (See Note A)

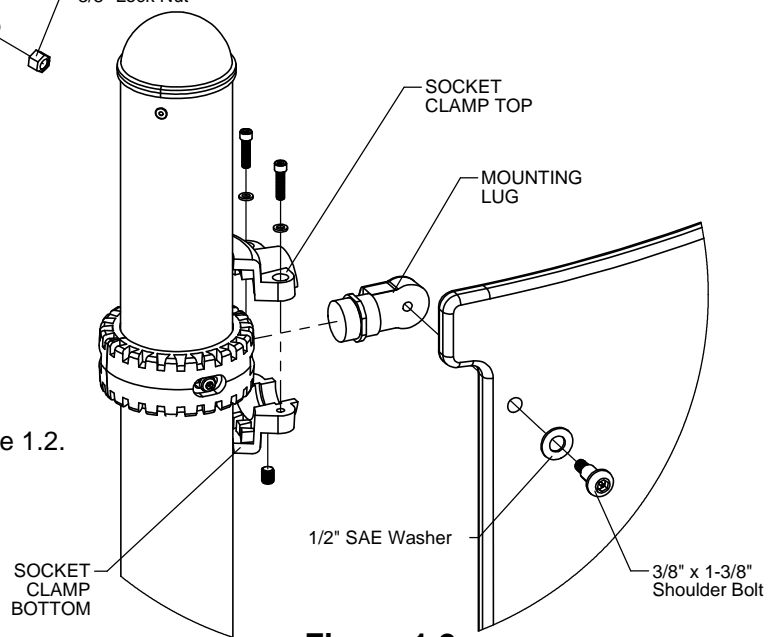

Figure 1.2

Step 3

Attach Sit Down Wall to collars as shown in Figure 1.2. (See Notes A and B)

Step 4

Attach Sit Down Wall to deck as shown in Figure 1.3.
(See Note A)

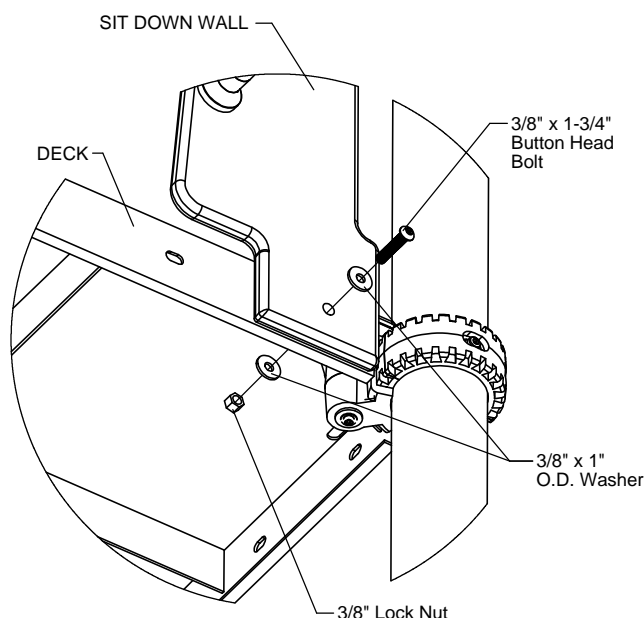

Figure 1.3

Step 5

Fully tighten all fasteners according to the "TIGHTENING TORQUE FOR HARDWARE" section of the Installation Manual.

Specifications

SIT DOWN WALL and SPACERS:

Shall be made from high density 3/4" thick hot extruded polyethylene sheet plastic specially formulated for optimum UV stability and color retention.

MOUNTING LUGS:

Shall be precision die-cast from a high-strength aluminum alloy. The Mounting Lugs have a multi-stage baked-on powder coat finish.

HARDWARE:

Shall be stainless steel, zinc/nickel plated or galvanized as required to resist rust and corrosion.

Parts List

| Part # | DESCRIPTION | QTY. |
|-------------|--|------|
| EG-8102 | Sit Down Wall R3.5 | 1 |
| EG-8102-LS | Sit Down Wall R3.5 - Large Spacer | 2 |
| EG-8102-SS | Sit Down Wall R3.5 - Small Spacer | 4 |
| GG-8113 | Mounting Lug R3.5 | 2 |
| HS-1001-R35 | R3.5 Socket Clamp Set | 2 |
| 9103082-TR | Bolt Button Head 3/8" x 1-3/4" | 2 |
| 9103162-TR | Bolt Button Head 3/8" x 3-3/4" | 2 |
| 9143062-TR | Bolt Shoulder 3/8" x 1-3/8" BH | 2 |
| 9333002 | Washer Flat 3/8" x 1" O.D. x .100" thick | 4 |
| 9333042 | Washer Flat 3/8" x 7/8" O.D. | 4 |
| 9345002 | Washer Flat SAE 1/2" | 2 |
| 9413002 | Nut Lock 3/8" | 4 |

Maintenance

Periodically tighten all screws, bolts and nuts. A periodic inspection of all parts is necessary. If a part is broken or worn, replace immediately. For general maintenance please refer to our Playground Maintenance Manual.