

Playground Equipment Manual

This manual and all of its contents must be kept on hand at the Playground Equipment Site.



Project Name SCULPTOR PLAYGROUND
Distributor Advanced Recreational Concepts
Purchase ID 9691e332e2a571a2b6ba
SO Number SO-00054335
PO Number 10858
Order Date 5/1/2024

R35

FOR KIDS
AGES
5-12

Contents

- Packing List and Installation Guide for every component in your Playground Equipment.
- Warning and Age Appropriate Labels.
- Installation Manual
- Construction Views (Top View, Site Plan, Perspective Views).
- Maintenance Manual w/ Safety and Repair Information.



(800) 333-8519

SCULPTOR PLAYGROUND
TOP VIEW

ADA ACCESSIBILITY GUIDELINES - ADAAG CONFORMANCE

ELEVATED	ACCESSIBLE	RAMP ACCESSIBLE	GROUND	TYPES
8	8/4	0/0	6/3	4/3
CHILD CAPACITY	114	MAX FALL HEIGHT	108	

R35

FOR KIDS
AGES
5-12

GENERAL NOTES

This conceptual plan is based on information provided prior to construction. Detailed site information, including the following, should be obtained, evaluated, and utilized in the final project design. Exact site dimensions, topography, existing utilities, soil conditions and drainage solutions.

WARNING: Accessible safety surfacing material is required beneath and around this equipment that has a critical height value (Fall Height) appropriate for the highest accessible part of this equipment. Refer to the CPSC'S Handbook For Public Playground Safety, Section 4: Surfacing.

- NOTES:
- 1. Post footing dimensions are from centers of support posts.
 - 2. Deck heights shown are finished heights at top of decks above ground cover. Adjust footing depth of support posts, compensating for required ground cover depth.
 - 3. This structure is accessible by transfer point.
 - 4. It is the opinion of the manufacturer that this design meets the accessibility requirements of the ADAAG and ASTM F1487-17 when properly installed over accessible surfacing.
 - 5. This structure meets the USCPSC and ASTM guidelines for playground safety.
 - 6. This equipment was designed for use by children 5-12 years of age.
 - 7. WARNING: An impact absorbing safety surfacing is required under and around all playground equipment.

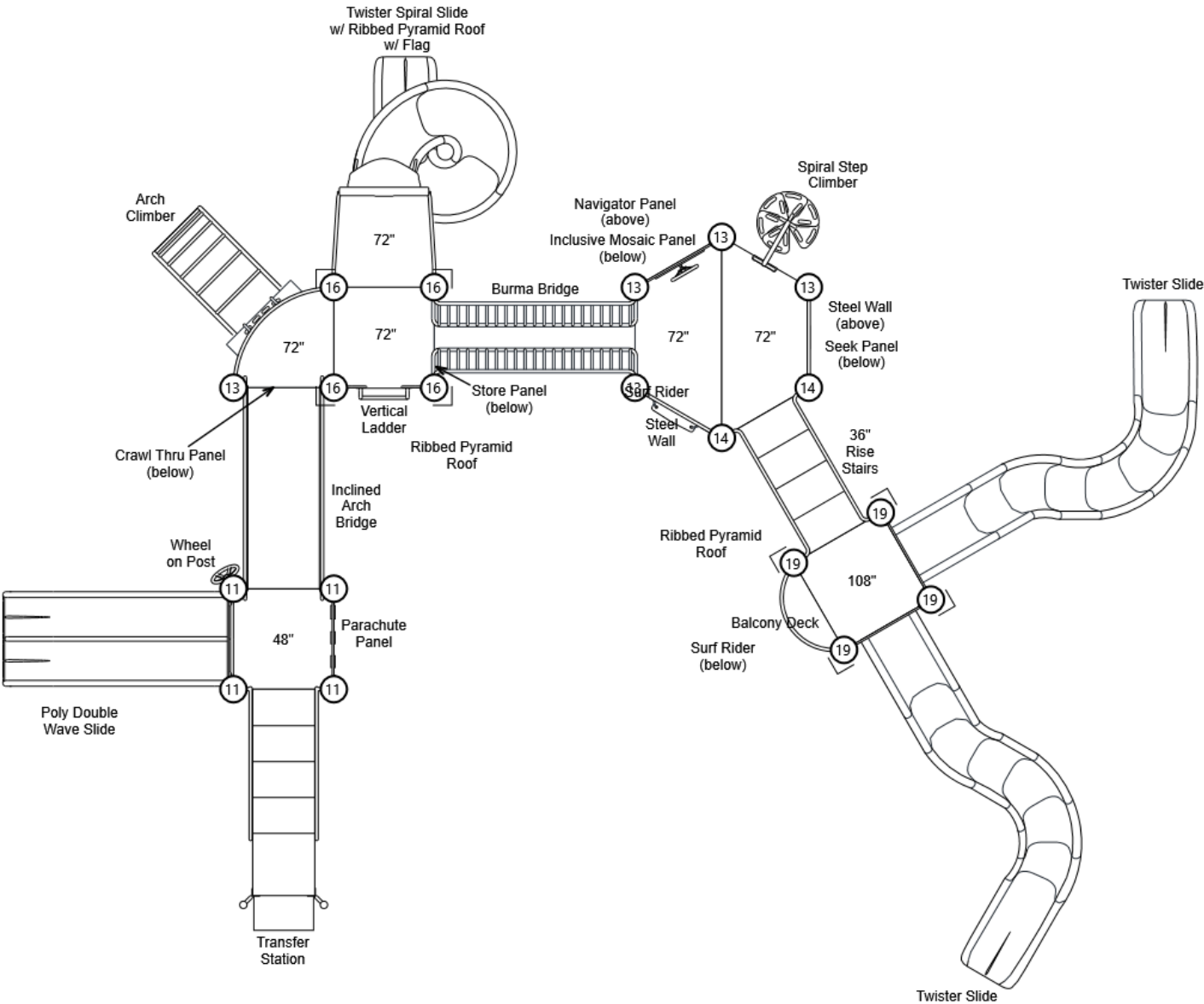

STRUCTURE # R35904B3C
PROJECT # ARC249A282C
DATE 5/15/2024

Advanced Recreational Concepts
MIN. USE ZONE 54' x 47' (16.353m x 14.081m)



SCULPTOR PLAYGROUND

TOP VIEW (Footings)

ADA ACCESSIBILITY GUIDELINES - ADAAG CONFORMANCE

ELEVATED	ACCESSIBLE	RAMP ACCESSIBLE	GROUND	TYPES
8	8/4	0/0	6/3	4/3
CHILD CAPACITY	114	MAX FALL HEIGHT	108	

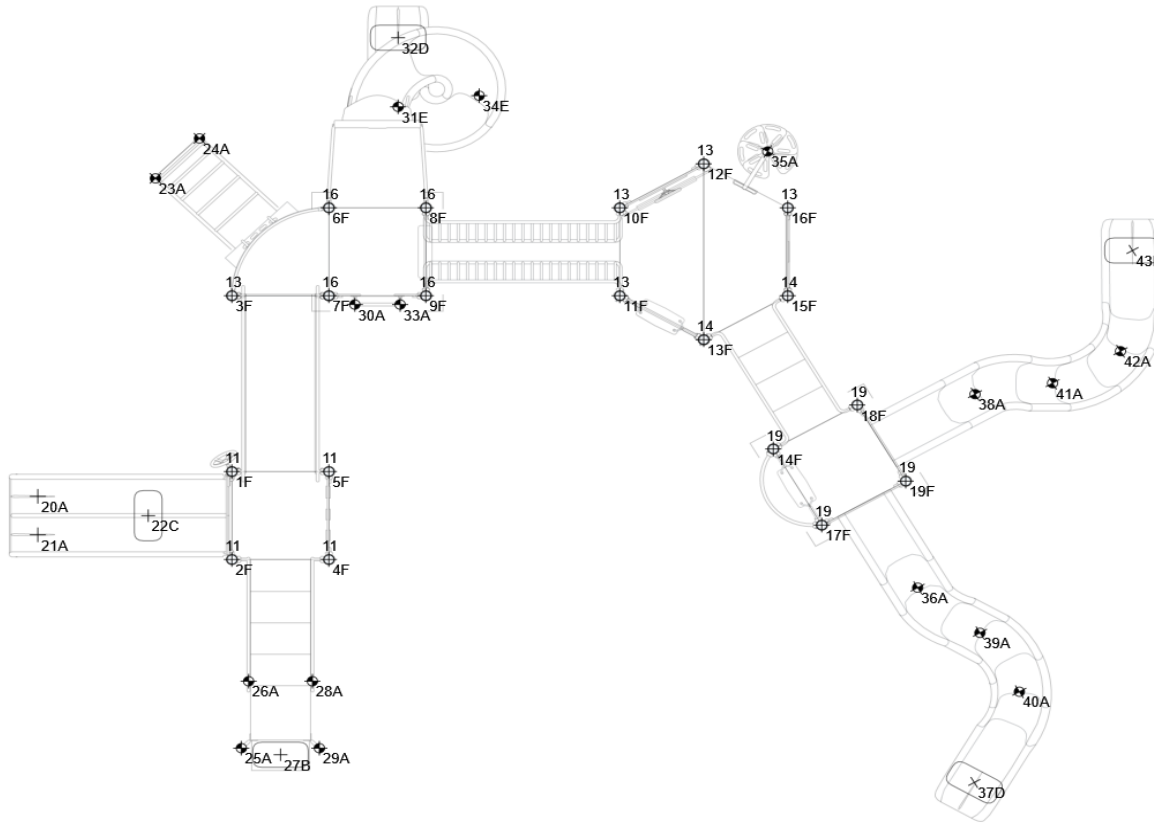
R35FOR KIDS
AGES
5-12**MOUNT LOCATIONS TABLE**

#	TYPE	SIZE/DEPTH	LOCATIONS
A	EF12	W:12" x L:12" x D:18"	17
B	EFO	W:12" x L:24" x D:21.5"	1
C	EFO	W:12" x L:24" x D:26"	1
D	EFO	W:12" x L:24" x D:25"	3
E	EF18	W:18" x L:18" x D:30"	2
F	PostFooting	W:18" x L:18" x D:30"	19

MOUNT ORDINATE TABLE

#	X	Y	DIAG	#	X	Y	DIAG
1	0'-0"	0'-0"	0'-0"	23	-2'-9"	11'-8"	12'-0"
2	0'-0"	-3'-6"	3'-6"	24	-1'-2"	13'-3"	13'-4"
3	0'-0"	7'-0"	7'-0"	25	0'-4"	-11'-0"	11'-0"
4	3'-6"	-3'-6"	4'-11"	26	0'-7"	-8'-4"	8'-4"
5	3'-6"	0'-0"	3'-6"	27	1'-9"	-11'-3"	11'-5"
6	3'-6"	10'-6"	11'-1"	28	2'-11"	-8'-4"	8'-10"
7	3'-6"	7'-0"	7'-10"	29	3'-2"	-11'-0"	11'-5"
8	7'-0"	10'-6"	12'-7"	30	4'-5"	6'-8"	8'-0"
9	7'-0"	7'-0"	9'-11"	31	6'-0"	14'-6"	15'-9"
10	14'-0"	10'-6"	17'-6"	32	6'-0"	17'-3"	18'-3"
11	14'-0"	7'-0"	15'-8"	33	6'-1"	6'-8"	9'-0"
12	17'-0"	12'-3"	21'-0"	34	8'-11"	15'-0"	17'-5"
13	17'-0"	5'-3"	17'-10"	35	19'-4"	12'-9"	23'-2"
14	19'-6"	0'-11"	19'-7"	36	24'-9"	-4'-7"	25'-2"
15	20'-1"	7'-0"	21'-3"	37	26'-10"	-12'-4"	29'-6"
16	20'-1"	10'-6"	22'-8"	38	26'-10"	3'-1"	27'-0"
17	21'-3"	-2'-2"	21'-5"	39	27'-0"	-6'-5"	27'-9"
18	22'-7"	2'-8"	22'-9"	40	28'-5"	-8'-9"	29'-9"
19	24'-4"	-0'-5"	24'-4"	41	29'-7"	3'-6"	29'-10"
20	-7'-0"	-1'-0"	7'-1"	42	32'-1"	4'-10"	32'-5"
21	-7'-0"	-2'-6"	7'-5"	43	32'-6"	8'-10"	33'-8"
22	-3'-0"	-1'-9"	3'-6"				

STRUCTURE # R35904B3C
PROJECT # ARC249A282C
DATE 5/15/2024

Advanced Recreational Concepts
MIN. USE ZONE 54' x 47' (16.353m x 14.081m)

SCULPTOR PLAYGROUND

SITE PLAN

ADA ACCESSIBILITY GUIDELINES - ADAAG CONFORMANCE

ELEVATED	ACCESSIBLE	RAMP ACCESSIBLE	GROUND	TYPES
9	9/5	0/0	7/3	1/3

R35

FOR KIDS
AGES
5-12

GENERAL NOTES

This Preliminary Site Plan is based on measurements that were provided in the initial planning phase. All dimensions must be verified prior to the submission of a purchase order. Playcraft Systems will not be held responsible for any discrepancies between actual dimensions and dimensions submitted in the planning phase.

The Minimum Use Zone for a play structure is based on the product design at the time of proposal. Components and structure designs may be subject to change which may affect dimensions. Therefore, before preparing the site, we strongly recommend obtaining final drawings from the factory (available after the order is placed and included in the Assembly Manual).

WARNING: Accessible safety surfacing material is required beneath and around this equipment that has a critical height value (Fall Height) appropriate for the highest accessible part of this equipment. Refer to the CPSC'S Handbook For Public Playground Safety, Section 4: Surfacing.

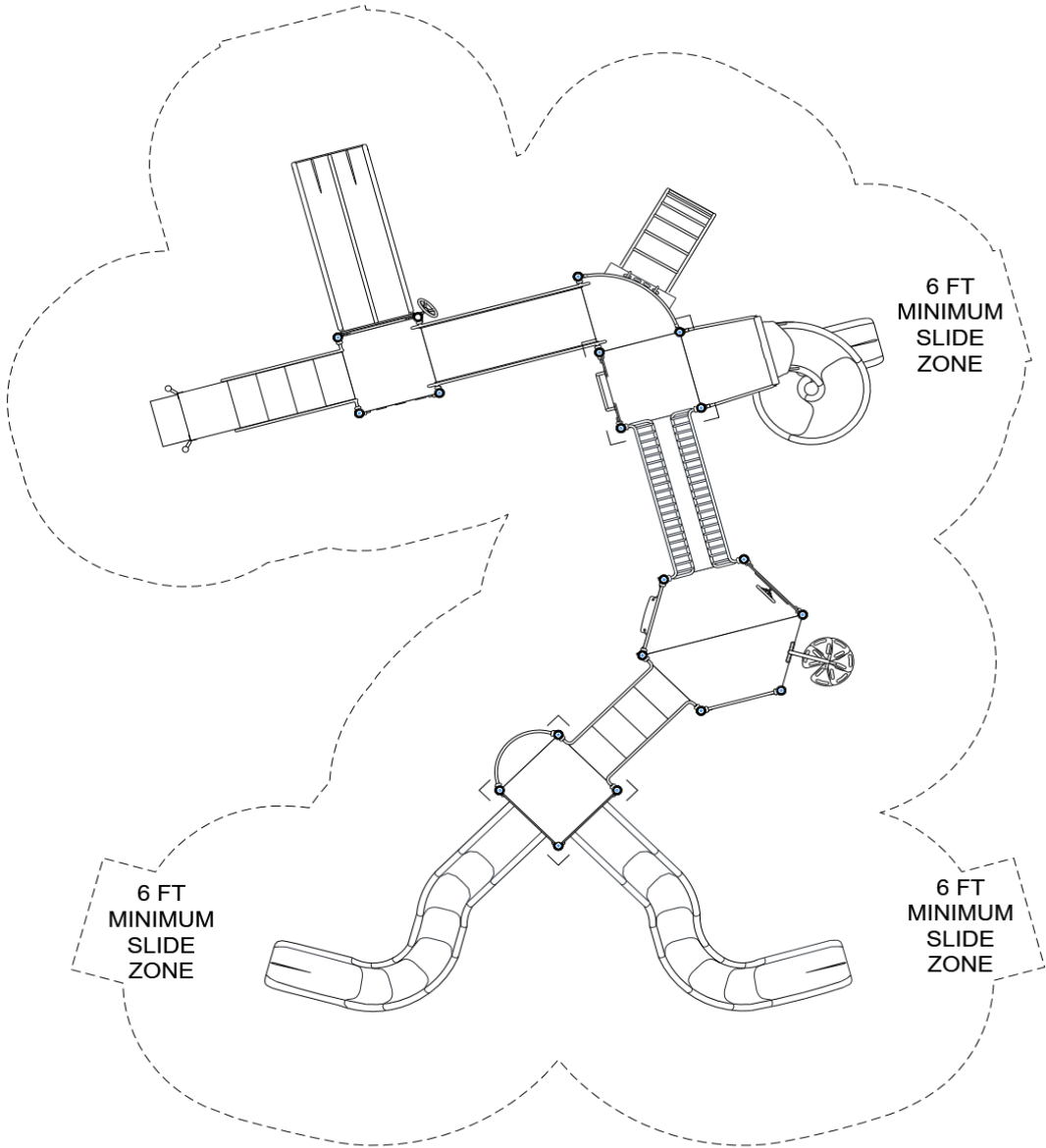

PROJECT # ARC249A282C
DATE 5/15/2024

Advanced Recreational Concepts
MIN. USE ZONE -30' x 64' (-9.373m x 19.431m)



SCULPTOR PLAYGROUND

SW VIEW

R35

FOR KIDS
AGES
5-12



STRUCTURE # R35904B3C
PROJECT # ARC249A282C
DATE 5/15/2024

SCULPTOR PLAYGROUND

SE VIEW

R35

FOR KIDS
AGES
5-12



STRUCTURE # R35904B3C
PROJECT # ARC249A282C
DATE 5/15/2024

SCULPTOR PLAYGROUND

NE VIEW

R35

FOR KIDS
AGES
5-12



STRUCTURE # R35904B3C
PROJECT # ARC249A282C
DATE 5/15/2024

SCULPTOR PLAYGROUND

NW VIEW

R35

FOR KIDS
AGES
5-12



STRUCTURE # R35904B3C
PROJECT # ARC249A282C
DATE 5/15/2024