

IMPORTANT NOTES: Read First

(A) Use liquid thread lock (such as Loctite®) with all threaded hardware. **Important:** Liquid thread lock (prior to curing) helps to eliminate the common problem of "thread seizure" in stainless steel hardware by serving as a lubricant during assembly.

(B) Refer to Installation Manual R35-1600 R3.5 Panel Assembly or R5-1601 Panel - Type 1 (Rotomolded LLDPE) .

FIGURE 1
Memory Panel

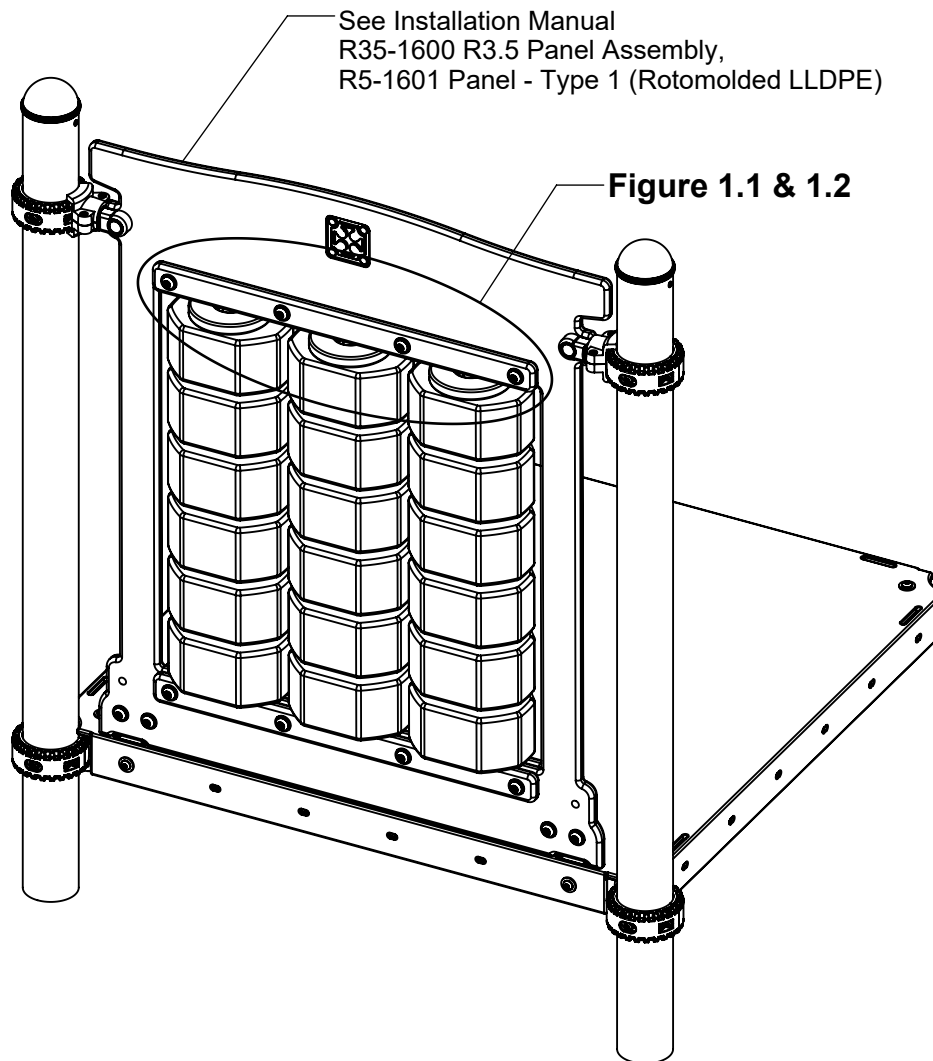

NOTE: Memory Panel R35 Deck Mount shown. Other configurations will vary slightly, but does not affect assembly.

MEMORY PANEL R35

Step 1 (Factory Assembled)

Place Memory Blocks and washers onto Activity Panel Tube 29.5" and attach to Activity Panel as shown in Figures 1.1

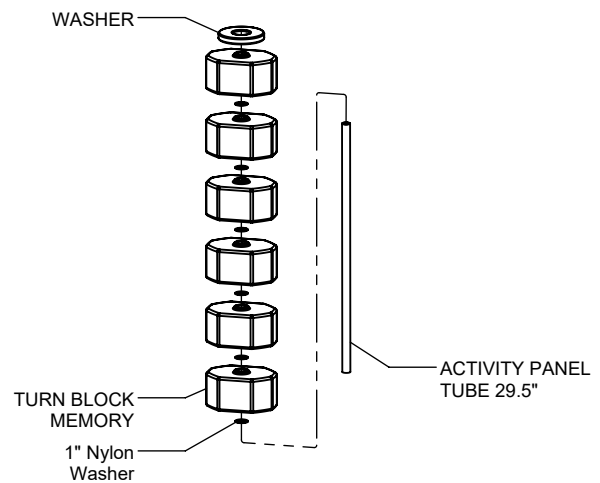

Figure 1.1

Step 2 (Factory Assembled)

Attach to Activity Panel as shown in Figures 1.2 (See Note A)

NOTE: See assembly instruction R35-1600 R3.5 Panel Assembly for complete deck mount or ground mount assembly.

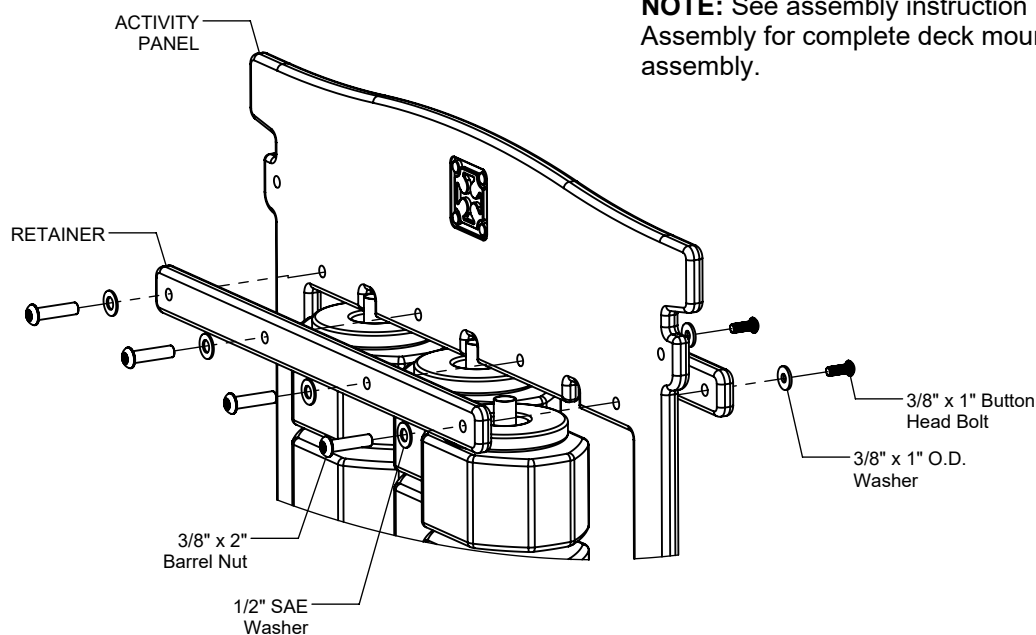

Figure 1.2

MEMORY PANEL R5

Step 3 (Factory Assembled)

Place Memory Blocks and washers onto Activity Panel Bracket and attach to Activity Panel as shown in Figure 2.

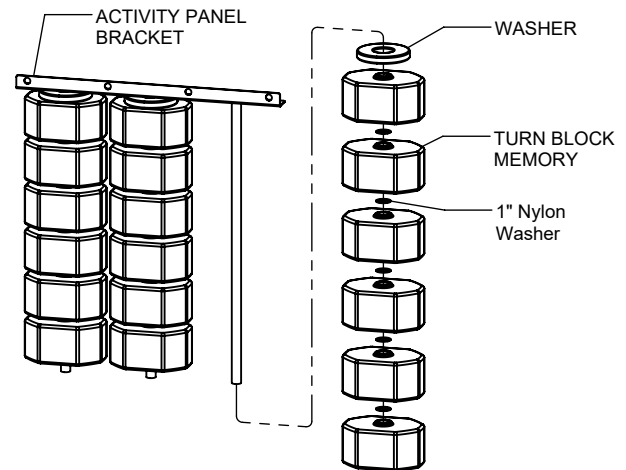

FIGURE 2

Step 4 (Factory Assembled)

Attach Panel to Collar as shown in Figure 1.3.
(See Note A)

NOTE: See assembly instruction R5-1601
Panel - Type 1 (ROTOMOLDED LLDPE) for complete
deck mount or ground mount assembly.

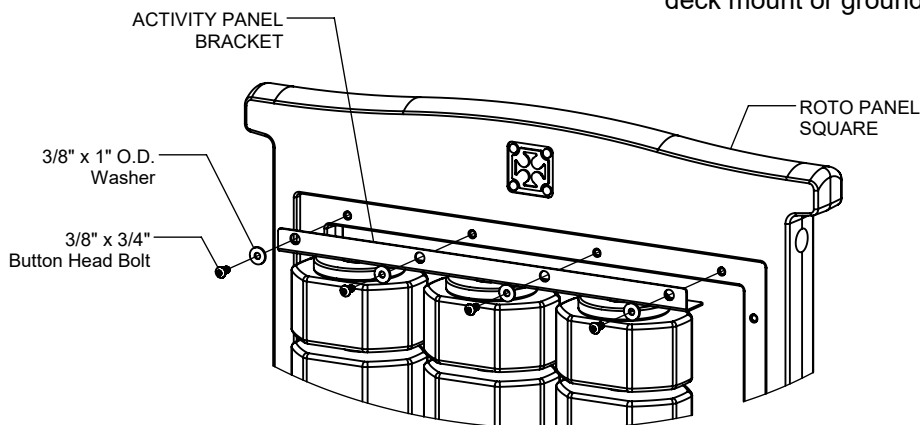

FIGURE 3

Step 5

Fully tighten all fasteners according to the
"TIGHTENING TORQUE FOR HARDWARE"
section of the Installation Manual.

MEMORY PANEL INSTALLATION INSTRUCTIONS

1608
Page 4 of 4

Assembled Parts List

MEMORY PANEL R35		
Part #	DESCRIPTION	QTY
DE-0048-BIC	Turn Block Memory - Bicycle	2
DE-0048-CRV	Turn Block Memory - Curve	2
DE-0048-DET	Turn Block Memory - Detour	2
DE-0048-RHT	Turn Block Memory - Right Turn	2
DE-0048-SCH	Turn Block Memory - School Crossing	2
DE-0048-SIG	Turn Block Memory - Signal Light	2
DE-0048-SLP	Turn Block Memory - Slippery Road	2
DE-0048-STP	Turn Block Memory - Stop Sign	2
DE-0048-YLD	Turn Block Memory - Yield Sign	2
EE-0616	Large HDPE Washer	3
EG-8105	Activity Panel R3.5	1
EG-8105-R	Activity Panel Retainer R3.5	4
LE-0075-2950	Activity Panel Tube 29.5"	3
9103052-TR	9103052-TR	8
9333002	Washer Flat 3/8" x 1" O.D. x .100" thick	8
9345002	9345002	8
9369060	1" nylon washer	18
9443092-TR	Nut Barrel 3/8" x 2" BH	8

MEMORY PANEL R5		
PART #	DESCRIPTION	QTY
BE-4053	Activity Panel Bracket	1
DE-0048-BIC	Turn Block Memory - Bicycle	2
DE-0048-CRV	Turn Block Memory - Curve	2
DE-0048-DET	Turn Block Memory - Detour	2
DE-0048-RHT	Turn Block Memory - Right Turn	2
DE-0048-SCH	Turn Block Memory - School Crossing	2
DE-0048-SIG	Turn Block Memory - Signal Light	2
DE-0048-SLP	Turn Block Memory - Slippery Road	2
DE-0048-STP	Turn Block Memory - Stop Sign	2
DE-0048-YLD	Turn Block Memory - Yield Sign	2
EE-0616	Large HDPE Washer	3
FS-1616	Activity Panel Weldment	1
S-1601-R5	Square Panel R5	1
9103032-TR	Bolt Button Head 3/8" x 3/4"	8
9333002	Washer Flat 3/8" x 1" O.D. x .100" thick	8
9369060	1" nylon washer	18

Specifications

ACTIVITY PANEL R35 & ACTIVITY PANEL RETAINER R35:

Shall be made from high density 3/4" sheet plastic specially formulated for optimum UV stability and color retention.

R35 PANEL BRACKET:

Shall be fabricated using 3/16" sheet steel and will have a multi-stage baked-on powder coat finish.

ACTIVITY PANEL TUBE 29.5":

Shall be fabricated using 0.75" galvanized EMT 18ga. steel tubing.

TURN BLOCK:

Shall be constructed of UV-stabilized, rotationally molded, linear, low density polyethylene with an average wall thickness of .250".

MOUNTING LUGS & SOCKET CLAMPS:

Shall be precision die-cast from a high-strength aluminum alloy and will have a multi-stage baked-on powder coat finish.

HARDWARE:

Shall be stainless steel, zinc/nickel plated or galvanized as required to resist rust and corrosion.

Maintenance

Periodically tighten all screws, bolts and nuts. A periodic inspection of all parts is necessary. If a part is broken or worn, replace immediately. For general maintenance please refer to our Playground Maintenance Manual.



www.playcraftsystems.com
For Customer Service Call
800.333.8519 (U.S.A.) or 541.955.9199 (International)

Rev C
11/14/2024