

## IMPORTANT NOTES: Read First

(A) Use liquid thread lock (such as Loctite®) with all threaded hardware. **Important:** Liquid thread lock (prior to curing) helps to eliminate the common problem of "thread seizure" in stainless steel hardware by serving as a lubricant during assembly.

(B) Refer to Installation Manual for R5-09 Collars and R5-11 Socket Clamps assembly instructions.

**FIGURE 1**  
Slide Sit Down Hood

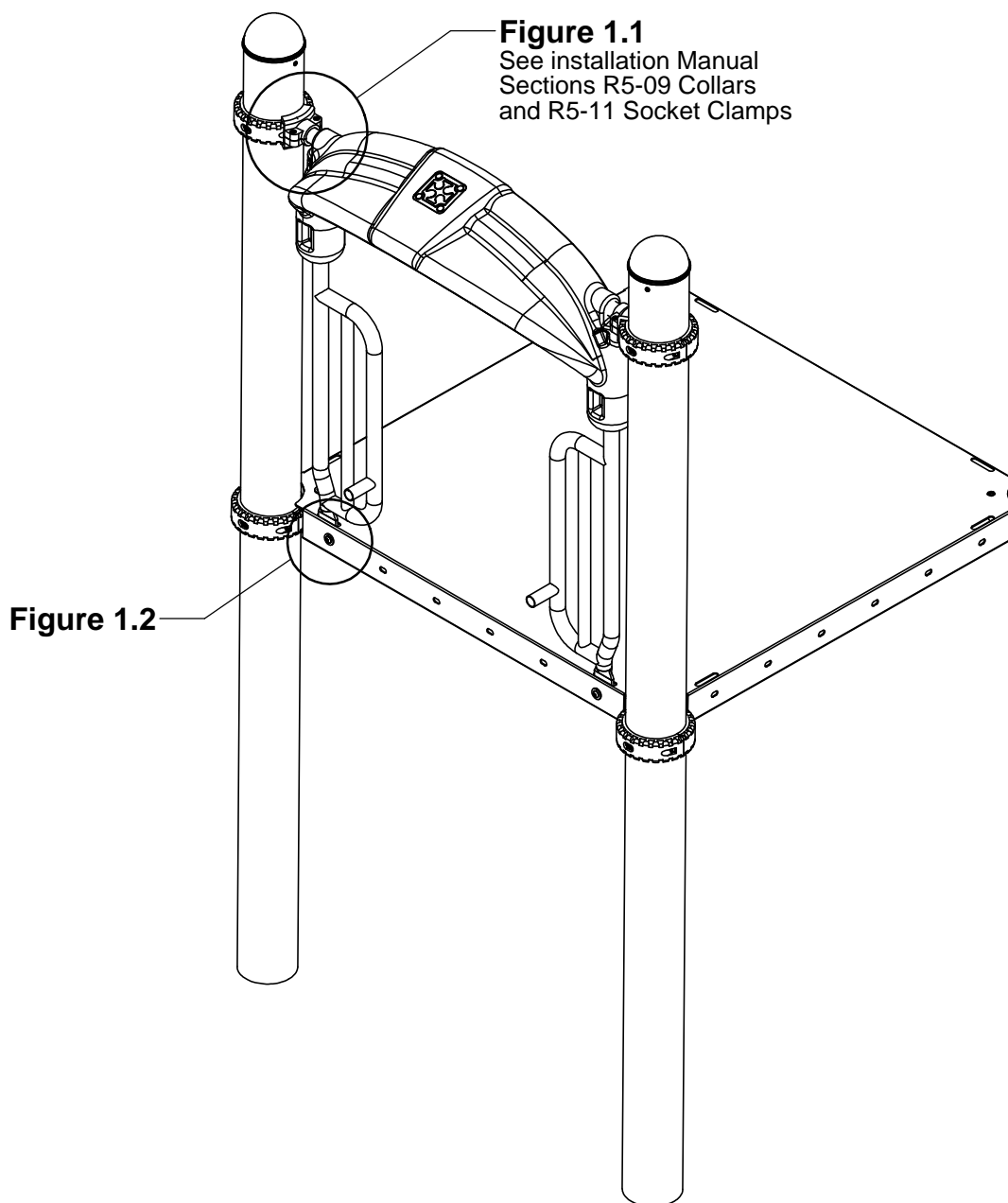

### Step 1 (Factory Assembled)

Attach Sit Down Hood Guards to the Slide Hood as shown in Figure 2.

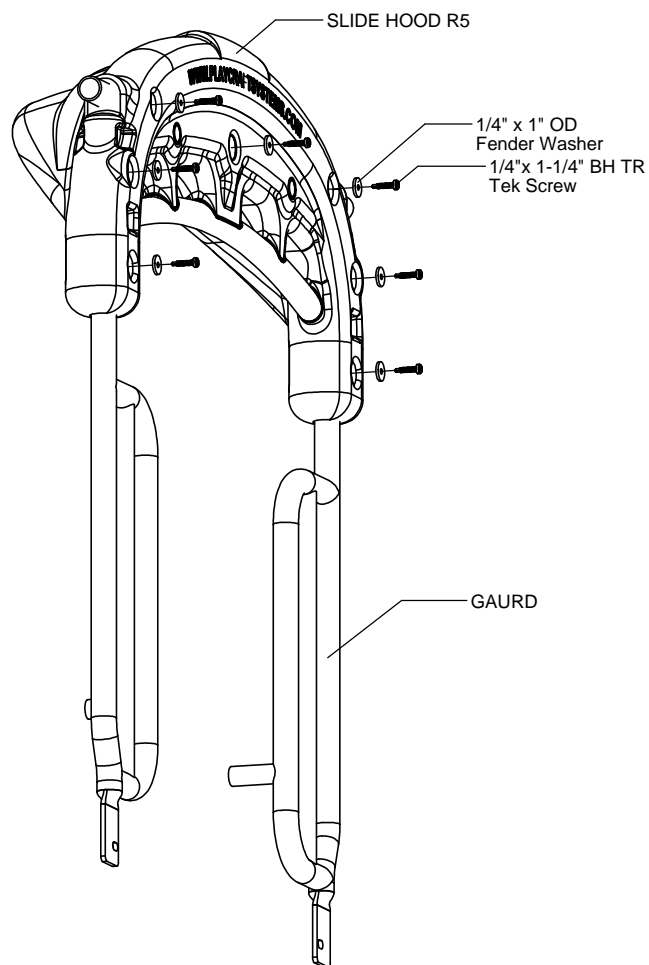
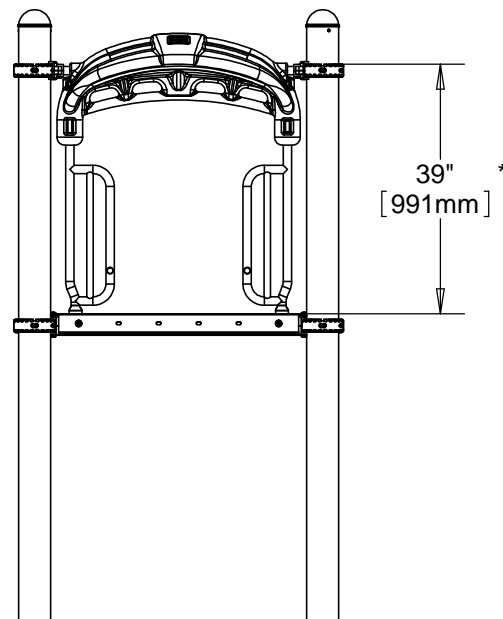

FIGURE 2



FRONT ELEVATION

### Step 2

Locate and attach collars at the height shown in Front Elevation (See Note B).

\* Height shown from top of deck to top of collar.

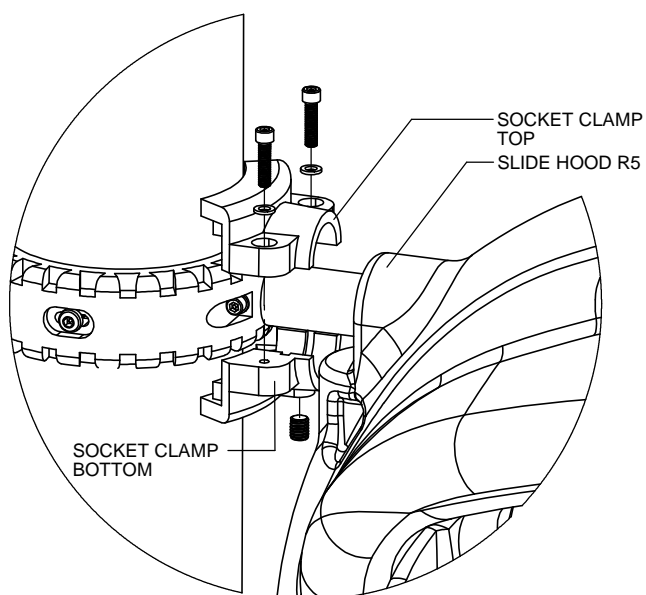

Figure 1.1

### Step 3

Insert the bottom tabs of Slide Sit Down Hood into the slots of Deck and attach Slide Sit Down Hood to collars as shown in Figure 1.1. (See Note B)

## Step 4

Attach Slide Sit Down Hood to Deck as shown in Figure 1.2. (See Note A)

## Step 5

Fully tighten all fasteners according to the "TIGHTENING TORQUE FOR HARDWARE" section of the Installation Manual.

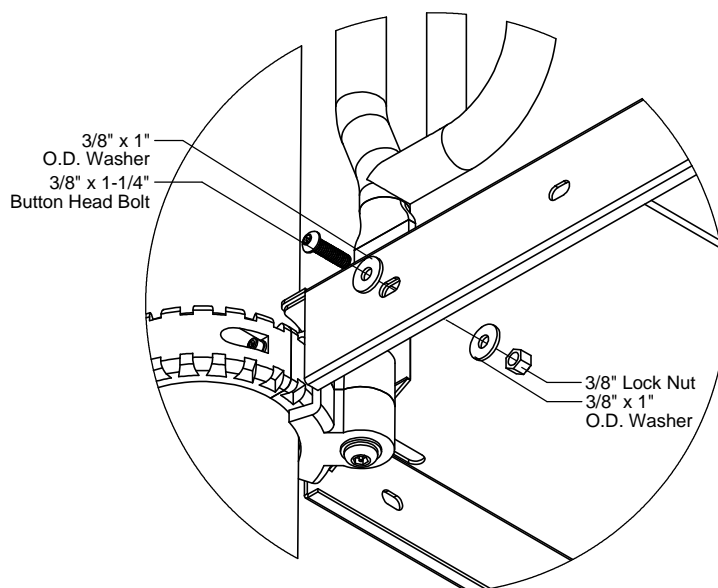

**Figure 1.2**

## Specifications

### SLIDE SIT DOWN HOOD:

Shall be constructed of UV-stabilized, rotationally molded, linear, low density polyethylene with an average wall thickness of .250".

### SIT DOWN HOOD - TOP RAIL:

Shall be constructed of 1.315" O.D. 12 gauge steel tubing. Sit Down Hood - Top Rail shall have a multi-stage baked-on powder coat finish.

### SIT DOWN HOOD GUARD SINGLE:

Shall be constructed of 1.315" O.D. 12 gauge and 1.029" O.D. 14 gauge steel tubing. Sit Down Hood Guard shall have a multi-stage baked-on powder coat finish.

### HARDWARE:

Shall be stainless steel, zinc/nickel plated or galvanized as required to resist rust and corrosion.

## Parts List

Part #	DESCRIPTION	QTY.
HS-1001-R5	Socket Clamp Set R5	2
9103062-TR	Bolt Button Head 3/8" x 1-1/4"	2
9333002	Washer Flat 3/8" x 1" O.D. x .100" thick	4
9413002	Nut Lock 3/8"	2

## Assembled Parts List

Part #	DESCRIPTION	QTY.
DF-4827	Slide Hood R5	1
FS-1303-R5	Sit Down Hood Guard	2
LF-0009	Sit Down Hood - Top Rail	1
9271062-TR	Screw Tek 1/4" x 1-1/4" BH TR	7
9321052-THK	Washer Fender 1/4" x 1" OD x .125" thk	7

## Maintenance

Periodically tighten all screws, bolts and nuts. A periodic inspection of all parts is necessary. If a part is broken or worn, replace immediately. For general maintenance please refer to our Playground Maintenance Manual.