

IMPORTANT NOTES: Read First

(A) Use liquid thread lock (such as Loctite®) with all threaded hardware. **Important:** Liquid thread lock (prior to curing) helps to eliminate the common problem of "thread seizure" in stainless steel hardware by serving as a lubricant during assembly.

(B) Do not pour concrete until the equipment is completely assembled, leveled and plumbed. Concrete must be allowed to cure completely before using the equipment (at least 72 hours).

(C) Refer to Installation Manual for 09 Collars and 11 Socket Clamps.

(D) An appropriate energy absorbing safety surface is required under and around all playground equipment. Loose fill protective surfacing is shown only as an example for the purpose of this assembly instruction. Other surfacing material may vary in thickness and/or compression depths. See free publication - The Handbook for Public Playground Safety, Publication #325 at www.cpsc.gov for the surfacing appropriate for the fall height of the equipment or consult your surfacing supply representative.

FIGURE 1
NFuse Round Panel Extension

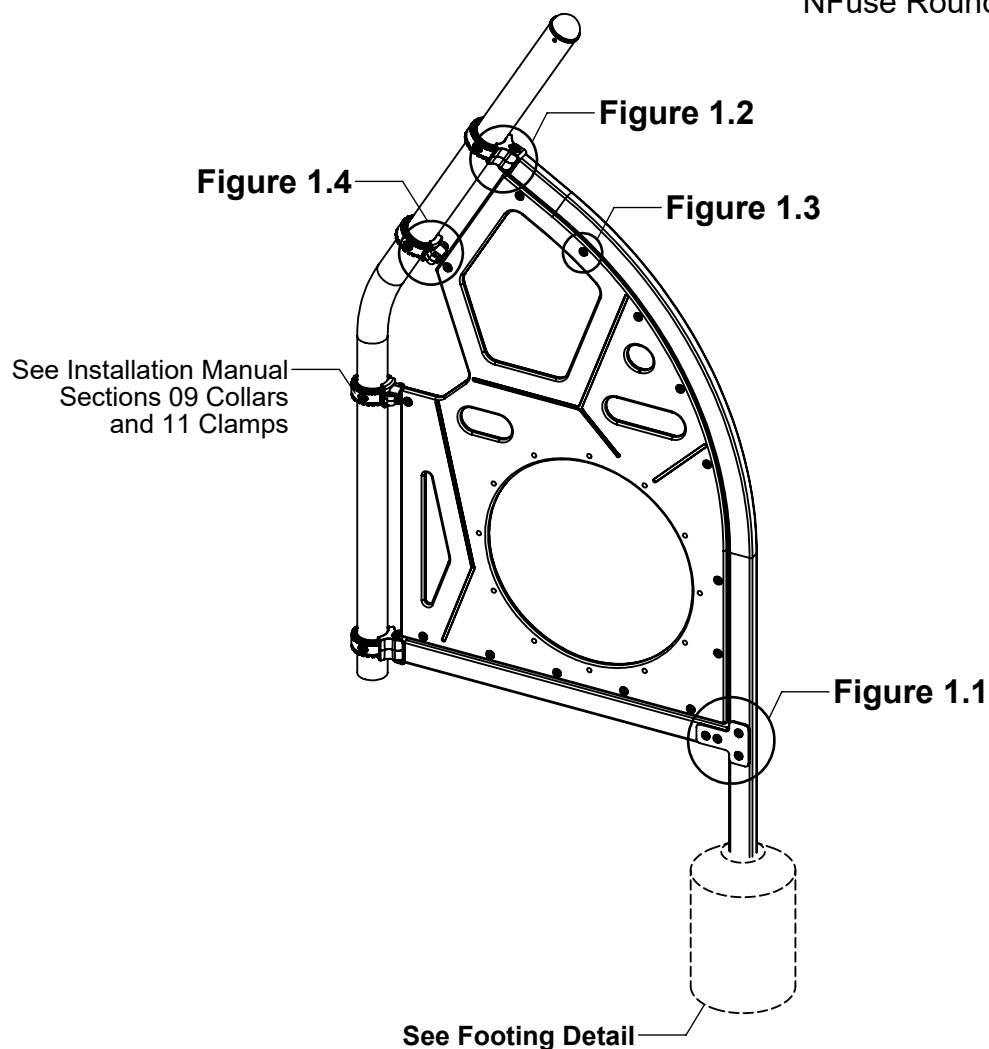

Step 1

Elevation View - Footing Detail

Refer to Footing Layout and mark footing hole location. Dig a Ø 12" footing hole. Refer to Footing Detail for depth and details.

Locate and attach collars at heights shown in Elevation View. (See Note C)

IMPORTANT: For areas with soft soil conditions, larger footings may be required.

* Footing depth must be adjusted to compensate for the depth/thickness requirements of selected safety surfacing. See Section 06.1 of the Installation Manual.

** Height shown from top of collar to top of collar.

*** Height shown from finish grade to top of collar.

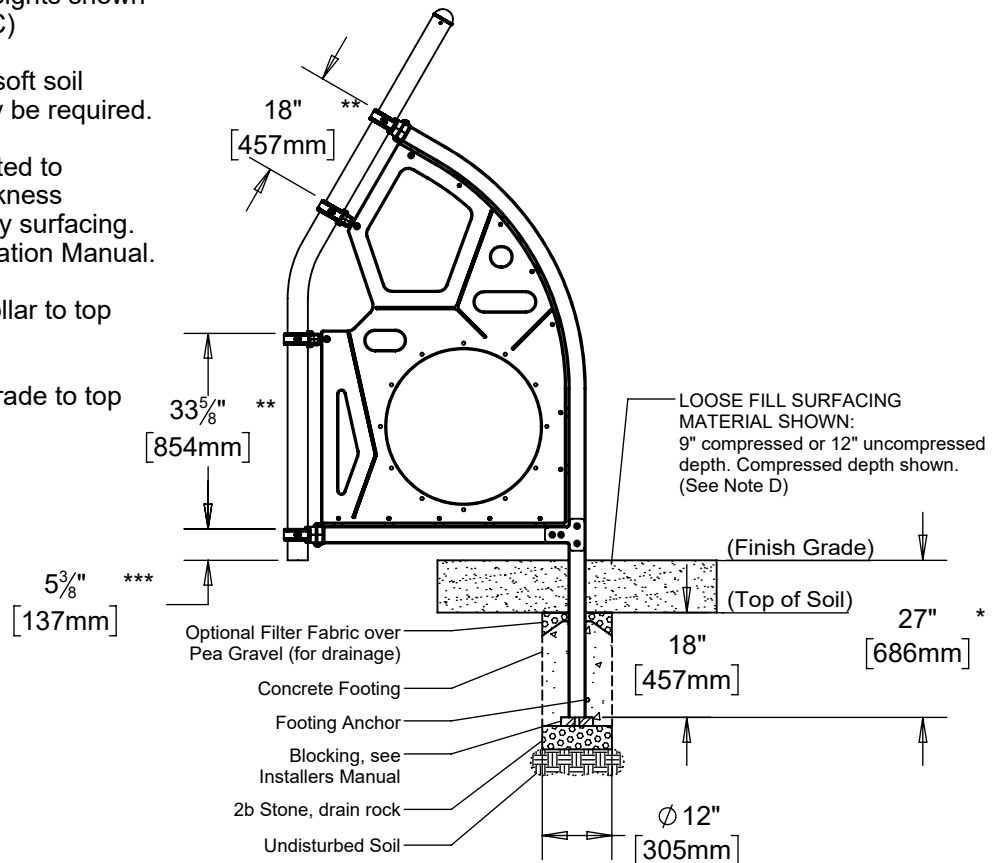

Top View - Footing Layout

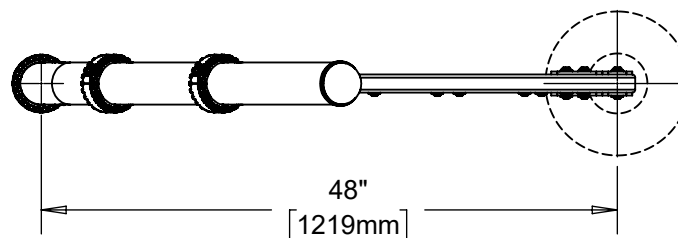

Step 2

Attach Bottom Rail to NFuse Frame as shown in Figure 1.1. (See Note A)

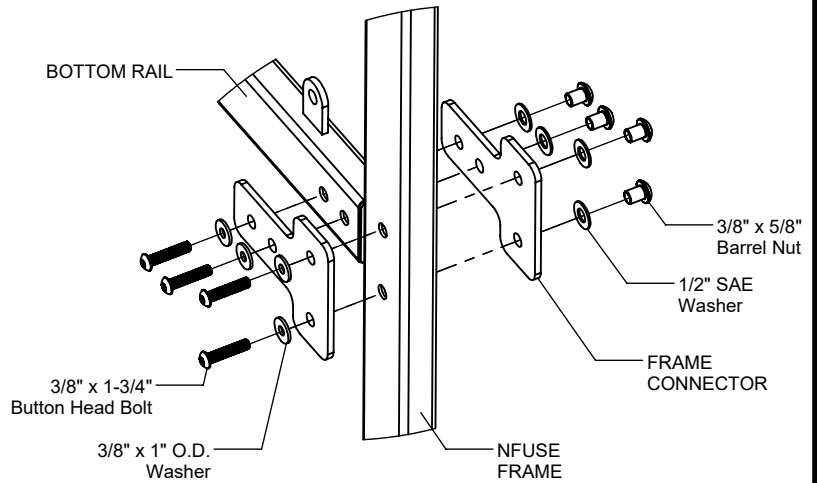

Figure 1.1

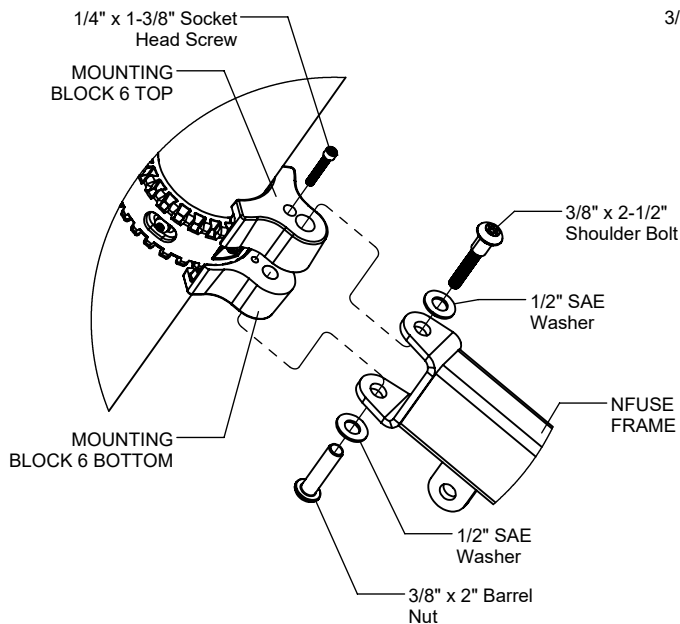

Figure 1.2

Step 3

Attach NFuse Frame to Post as shown in Figure 1.2. (See Note A)

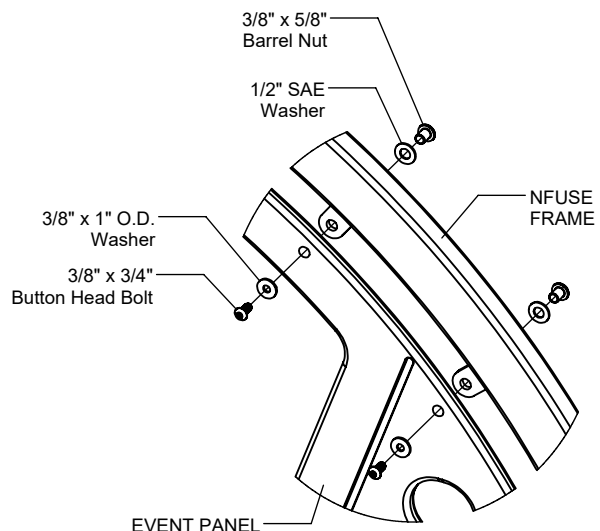

Figure 1.3

Step 4

Attach Event Panel to NFuse Frame as shown in Figure 1.3. (See Note A)

Step 5

Attach Event Panel to Post as shown in Figure 1.4. (See Notes A & C)

Step 6

Fully tighten all fasteners according to the "TIGHTENING TORQUE FOR HARDWARE" section of the Installation Manual.

Step 7

Plumb and level entire component. Pour concrete into footing hole. Allow at least 72 hours to cure before using this equipment. (See Note B)

Step 8

Place required protective surfacing under and around NFuse Round Panel Extension. (See Note D)

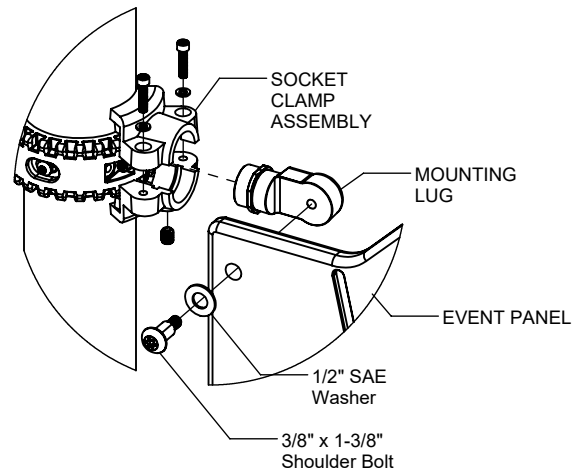

Figure 1.4

NFUSE ROUND PANEL EXTENSION INSTALLATION INSTRUCTIONS

5304
Page 5 of 5

Parts List

GROUND MOUNT		
Part #	DESCRIPTION	QTY
AE-1169	Frame Connector	2
EM-0003	NFuse Round Panel Extension	1
FS-5304-E	NFuse Round Panel Extension - Frame Rail	1
FS-5304-EBR	NFuse Round Event Panel Extension - Bottom Rail	1
GG-8113	Mounting Lug R3.5	2
GG-8125	Mounting Block 6 Top R3.5	2
GG-8127	Mounting Block 6 Bottom R3.5	2
HS-1001-R35	Socket Clamp Set R3.5	2
9103032-TR	Bolt Button Head 3/8" x 3/4"	12
9103082-TR	Bolt Button Head 3/8" x 1-3/4"	4
9143062-TR	Bolt Shoulder 3/8" x 1-3/8" BH	2
9143112-TR	Bolt Shoulder 3/8" x 2-1/2" BH	2
9281062-5-TR	Screw Soc HD 1/4" x 1-3/8"	2
9333002	Washer Flat 3/8" x 1" O.D. x .100" thick	16
9345002	Washer Flat SAE 1/2"	22
9443022-TR	Nut Barrel 3/8" x 5/8" BH	16
9443092-TR	Nut Barrel 3/8" x 2" BH	2

SURFACE MOUNT		
Part #	DESCRIPTION	QTY
AE-1169	Frame Connector	2
EM-0003	NFuse Round Panel Extension	1
FS-5304-E-SM	NFuse Round Panel Extension - Frame Rail - Surface Mount	1
FS-5304-EBR	NFuse Round Event Panel Extension - Bottom Rail	1
GG-8113	Mounting Lug R3.5	2
GG-8125	Mounting Block 6 Top R3.5	2
GG-8127	Mounting Block 6 Bottom R3.5	2
HS-1001-R35	Socket Clamp Set R3.5	2
9103032-TR	Bolt Button Head 3/8" x 3/4"	12
9103082-TR	Bolt Button Head 3/8" x 1-3/4"	4
9143062-TR	Bolt Shoulder 3/8" x 1-3/8" BH	2
9143112-TR	Bolt Shoulder 3/8" x 2-1/2" BH	2
9281062-5-TR	Screw Soc HD 1/4" x 1-3/8"	2
9333002	Washer Flat 3/8" x 1" O.D. x .100" thick	16
9345002	Washer Flat SAE 1/2"	22
9443022-TR	Nut Barrel 3/8" x 5/8" BH	16
9443092-TR	Nut Barrel 3/8" x 2" BH	2

Specifications

NFUSE ROUND EVENT PANEL EXTENSION FRAME RAILS:

Shall be fabricated using 1-1/2" x 3" Rectangle Tube with 1/4" thick steel clevises and tabs and will have a multi-stage baked-on powder coat finish.

FRAME CONNECTOR:

Shall be fabricated using 1/4" thick steel and will have a multi-stage baked-on powder coat finish.

NFUSE ROUND PANEL EXTENSION:

Shall be made from high density 3/4" sheet plastic specially formulated for optimum UV stability and color retention.

MOUNTING BLOCKS:

Shall be two-part and precision die-cast from a high strength aluminum alloy and will have a multi-stage baked-on powder coat finish.

MOUNTING LUGS:

Shall be precision die-cast from a high-strength aluminum alloy and will have a multi-stage baked-on powder coat finish.

SOCKET CLAMPS:

Shall be two-part and precision die-cast from a high strength aluminum alloy and will have a multi-stage baked-on powder coat finish.

HARDWARE:

Shall be stainless steel, zinc/nickel plated or galvanized as required to resist rust and corrosion.

Maintenance

Periodically tighten all screws, bolts and nuts. A periodic inspection of all parts is necessary. If a part is broken or worn, replace immediately. For general maintenance please refer to our Playground Maintenance Manual.



www.playcraftsystems.com
For Customer Service Call
800.333.8519 (U.S.A.) or 541.955.9199 (International)

Rev A
8/24/2021