

IMPORTANT NOTES: Read First

(A) Use liquid thread lock (such as Loctite®) with all threaded hardware. **Important:** Liquid thread lock (prior to curing) helps to eliminate the common problem of "thread seizure" in stainless steel hardware by serving as a lubricant during assembly.

(B) See component assembly instructions for collar heights and locations.

(C) The Collar splits should be aligned parallel with deck faces and should always be parallel to the collars of the same component. (See Figure 3)

(D) **Important:** On overhead event's the collars should be oriented so that the Socket Clamps or Mounting Blocks are installed over the Tek Screw. (See Figure 4)

FIGURE 1
Collar Assembly

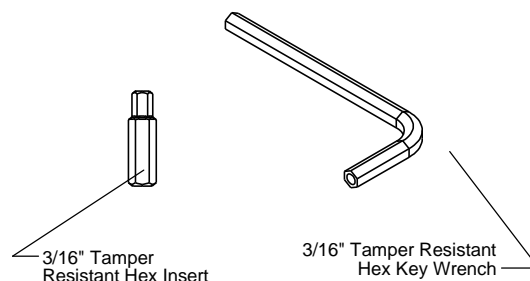
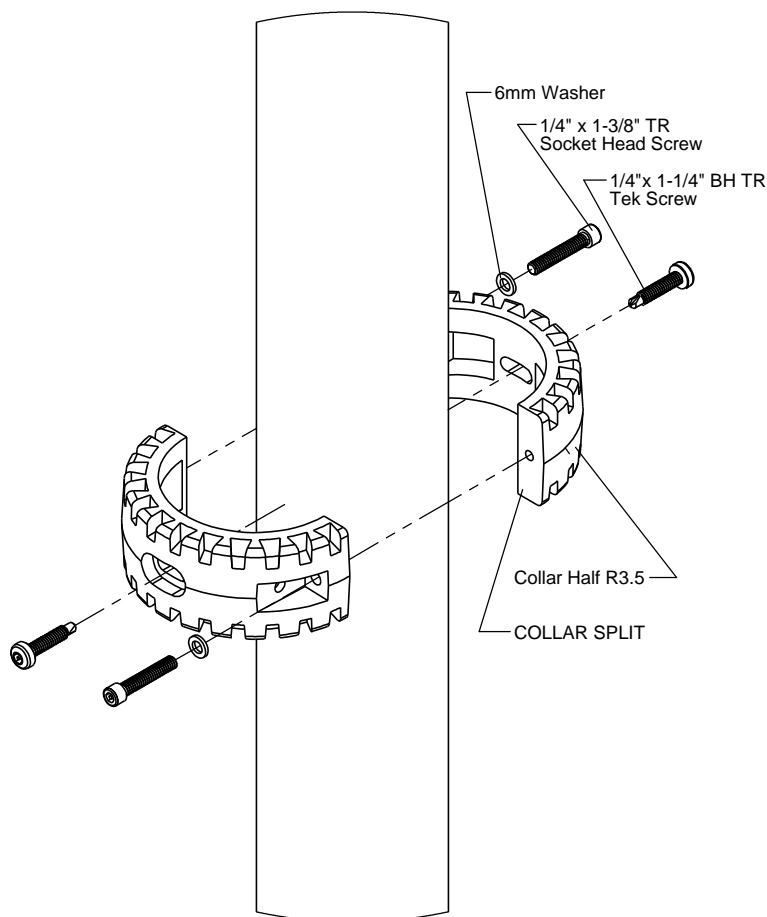

FIGURE 2
Tamper Resistant Tools

Step 1

Locate and mark the position of the collar on the support post, place in the correct position and attach as shown in Figure 1 using the tools shown in Figure 2. (See Figures 3 and 4 and Notes A, B, C and D)

Important: Do not install Tek Screws until the components location and orientation have been established.

Step 2

Check to ensure the placement of the collar assembly is at the specified height and orientation then install the Tek Screws as shown in Figure 1.

Step 3

Fully tighten all fasteners according to the "TIGHTENING TORQUE FOR HARDWARE" section of the Installation Manual. (See Note A)

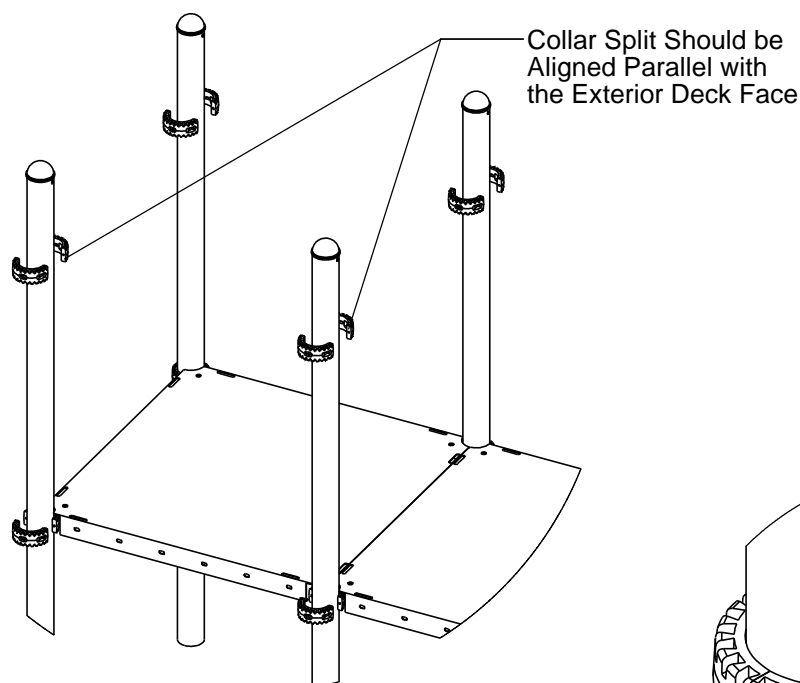

FIGURE 3
Collar Alignment

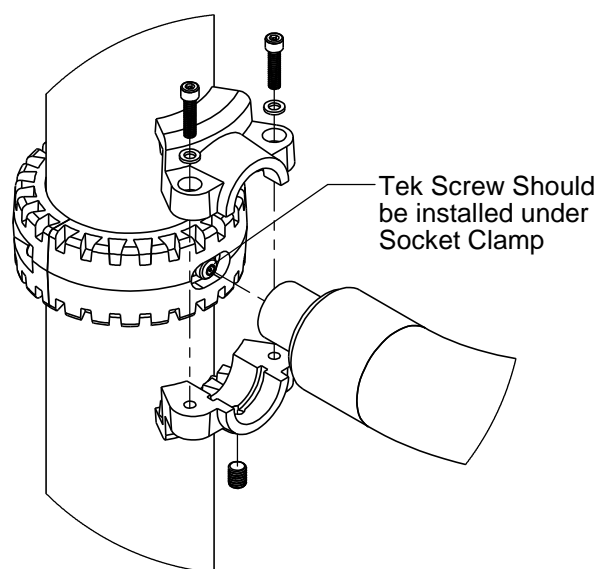

FIGURE 4
Overhead Event Collar Alignment

Specifications

COLLARS:

Shall be two-part and precision die-cast from a high strength aluminum alloy. The Collars have a multi-stage baked-on powder coat finish.

HARDWARE:

Shall be stainless steel, zinc/nickel plated or galvanized as required to resist rust and corrosion.

Parts List

Part #	DESCRIPTION	QTY.
008107	R3.5 Collar Half	2
9271062-TR	Screw Tek 1/4" x 1-1/4" BH TR	2
9281062-5-TR	Screw Soc HD CS 1/4" x 1-3/8" TR	2
9333602	Washer Flat 6 mm	2

Maintenance

Periodically tighten all screws, bolts and nuts. A periodic inspection of all parts is necessary. If a part is broken or worn, replace immediately. For general maintenance please refer to our Playground Maintenance Manual.