

**IMPORTANT NOTES: Read First**

(A) Use liquid thread lock (such as Loctite®) with all threaded hardware. **Important:** Liquid thread lock (prior to curing) helps to eliminate the common problem of "thread seizure" in stainless steel hardware by serving as a lubricant during assembly.

(B) An appropriate energy absorbing safety surface is required under and around all playground equipment. Loose fill protective surfacing is shown only as an example for the purpose of this assembly instruction. Other surfacing material may vary in thickness and/or compression depths. See free publication - The Handbook for Public Playground Safety, Publication #325 at [www.cpsc.gov](http://www.cpsc.gov) for the surfacing appropriate for the fall height of the equipment or consult your surfacing supply representative.

**FIGURE 1**  
Driver Wheel to Post

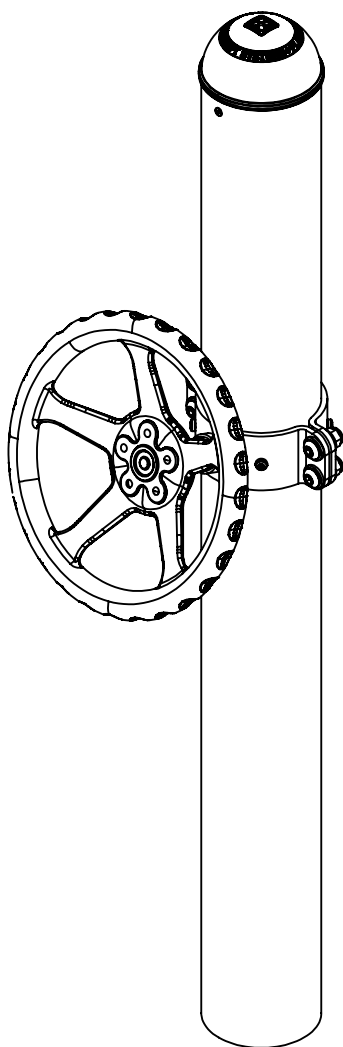

**NOTE:** R5 Driver Wheel to Post shown.  
Other configurations will vary slightly,  
but does not affect assembly.

## Step 1 (Factory Assembled)

Press Bearings into Wheel Hub as shown in Figure 2.

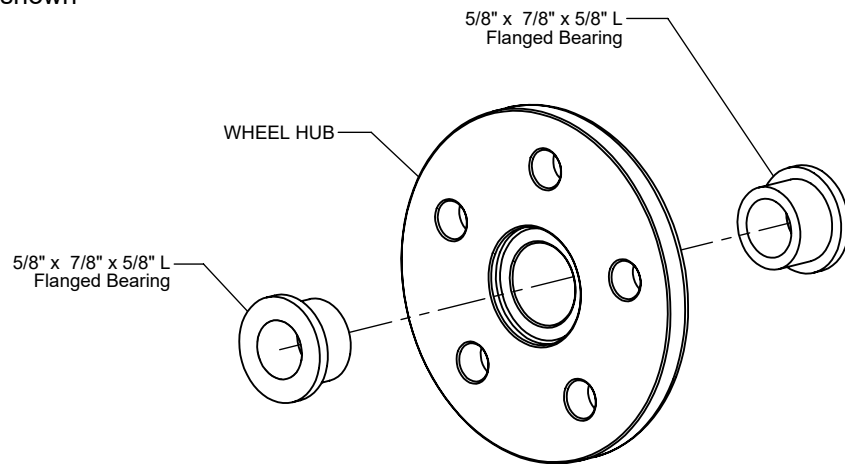

**FIGURE 2**

## Step 2

Locate Driver Wheel height and attach Steering Wheel Bracket as shown in Figure 3. (See Note A)

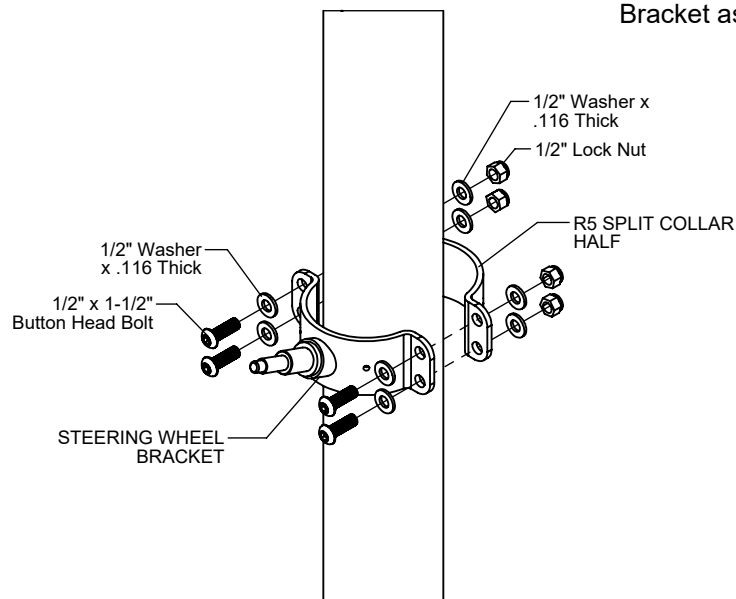

**FIGURE 3**

## Step 3

Secure Steering Wheel Bracket to post as shown in Figure 4. (See Note A)

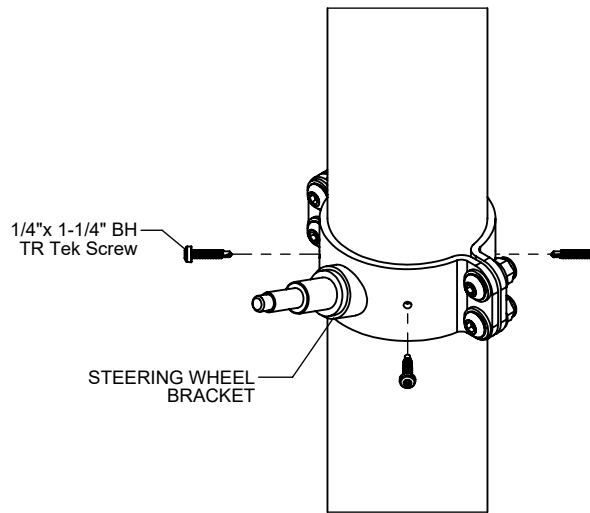

**FIGURE 4**

## Step 4

Attach Driver Wheel Casting to Steering Wheel Bracket as shown in Figure 5. (See Note A)

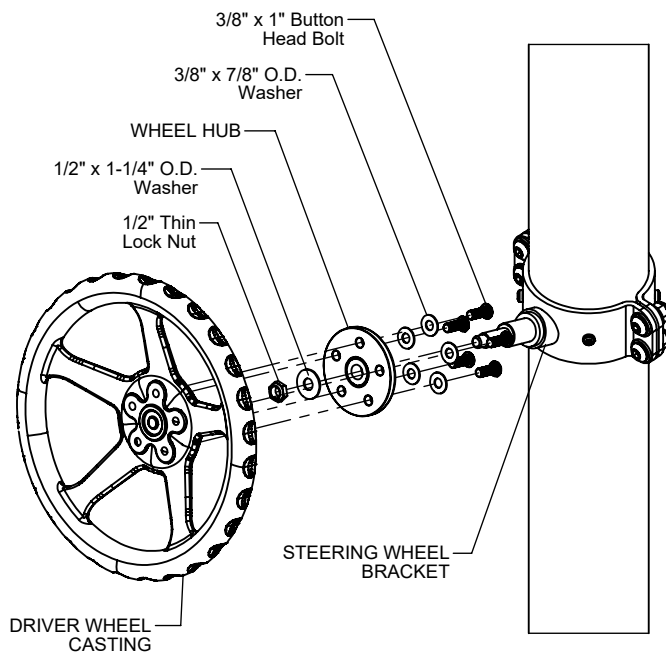

**FIGURE 5**

## Step 5

Attach Ships Wheel to Steering Wheel  
Bracket as shown in Figure 6.  
(See Note A)

## Step 6

Fully tighten all fasteners according to the  
"TIGHTENING TORQUE FOR HARDWARE"  
section of the Installation Manual.

## Step 7

Place required protective surfacing under  
and around Driver Wheel to Post.  
(See Note B)

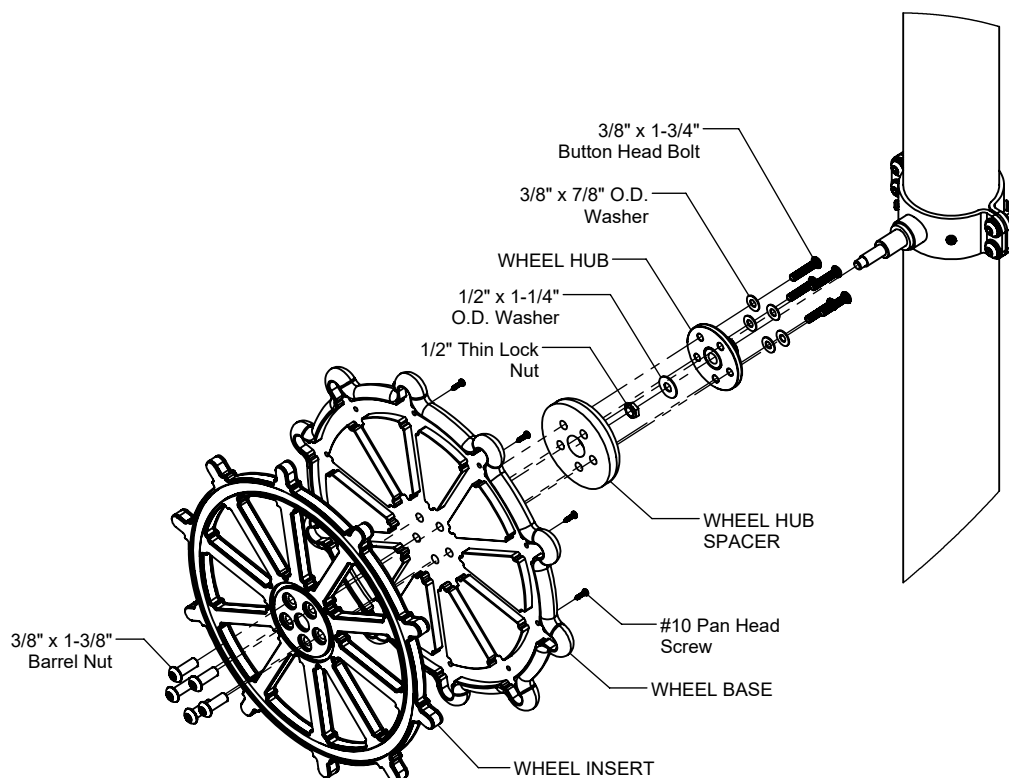

**FIGURE 6**

# DRIVER WHEEL TO POST INSTALLATION INSTRUCTIONS

**1812**  
Page 5 of 5

## Parts List

S-1812-R35		
Part #	DESCRIPTION	QTY.
BG-8133	Split Collar Half R3.5	1
FS-1812-R35	Steering Wheel to Post Bracket R3.5	1
GE-4728	Driver Wheel Casting	1
9103052-TR	Bolt Button Head 3/8" x 1"	5
9105072	Bolt Button Head 1/2" x 1-1/2"	4
9271062-TR	Screw Tek 1/4" x 1-1/4" BH TR	4
9333042	Washer Flat 3/8" x 7/8" O.D.	5
9335062	Washer Flat 1/2" x 1-1/4" OD	1
9415132	Nut Lock 1/2"	4
9425002	Nut Lock 1/2" Thin	1
9335002	Washer Flat 1/2" (.116" thick)	8
451172	Hex Key Wrench 1/8" SA	1

S-1812-R		
Part #	DESCRIPTION	QTY.
BF-7068	Split Collar Half R5	1
FS-1812-R	Steering Wheel to Post Bracket	1
GE-4728	Driver Wheel Casting	1
9103052-TR	Bolt Button Head 3/8" x 1"	5
9105072	Bolt Button Head 1/2" x 1-1/2"	4
9271062-TR	Screw Tek 1/4" x 1-1/4" BH TR	4
9333042	Washer Flat 3/8" x 7/8" O.D.	5
9335002	Washer Flat 1/2" (.116" thick)	8
9335062	Washer Flat 1/2" x 1-1/4" OD	1
9415132	Nut Lock 1/2"	4
9425002	Nut Lock 1/2" Thin	1
451172	Hex Key Wrench 1/8" SA	1

S-1812-RSHP		
Part #	DESCRIPTION	QTY
BF-7068	Split Collar Half R5	1
EE-0156-H	Solid Driver Wheel Hub	1
EE-0357	Pirate Ship Wheel Base	1
EE-0357-I	Pirate Ship Wheel Insert	1
FS-1812-RSHP	Ship Wheel to Post Bracket	1
481058-58	5/8" x 7/8" x 5/8" L Flanged Bearing	2
9103082-TR	Bolt Button Head 3/8" x 1-3/4"	5
9105072	Bolt Button Head 1/2" x 1-1/2"	4
9251032	Screw SQ #10x3/4 DR PH SMS SS	10
9271062-TR	Screw Tek 1/4" x 1-1/4" BH TR	4
9333042	Washer Flat 3/8" x 7/8" O.D.	5
9335002	Washer Flat 1/2" (.116" thick)	8
9335062	Washer Flat 1/2" x 1-1/4" OD	1
9415132	Nut Lock 1/2"	4
9425002	Nut Lock 1/2" Thin	1
9443062-TR	Nut Barrel 3/8" x 1-3/8" BH	5
451172	Hex Key Wrench 1/8" SA	1

## Assembled Parts List

Part #	DESCRIPTION	QTY.
IE-4662	Wheel Hub	1
481058-58	5/8" x 7/8" x 5/8" L Flanged Bearing	2

## Specifications

### DRIVER WHEEL CASTING:

Shall be precision die-cast from a high strength aluminum alloy. The Driver Wheel Casting shall have a multi-stage baked-on powder coat finish coat finish.

### WHEEL HUB:

Shall be machined from Ø 3-3/4" high strength aluminum alloy. The Wheel Hub shall have a multi-staged baked-on powder coat finish.

### STEERING WHEEL TO POST BRACKET:

Shall be precision laser cut from 1/4" thick rolled sheet steel with welded 1.660" 11 gauge steel tubing and Ø 1" machined stainless steel spindle. The Steering Wheel to Post Bracket shall have a multi-stage baked-on powder coat finish.

### SPLIT COLLAR HALF:

Shall be precision laser cut from 1/4" thick rolled sheet steel. The Split Collar Half shall have a multi-stage baked-on powder coat finish.

### HARDWARE:

Shall be stainless steel, zinc/nickel plated or galvanized as required to resist rust and corrosion.

## Maintenance

Periodically tighten all screws, bolts and nuts. A periodic inspection of all parts is necessary. If a part is broken or worn, replace immediately. For general maintenance please refer to our Playground Maintenance Manual.



www.playcraftsystems.com  
For Customer Service Call  
800.333.8519 (U.S.A.) or 541.955.9199 (International)

**Rev H**  
7/19/2019