

IMPORTANT NOTES: Read First

(A) Use liquid thread lock (such as Loctite®) with all threaded hardware. **Important:** Liquid thread lock (prior to curing) helps to eliminate the common problem of "thread seizure" in stainless steel hardware by serving as a lubricant during assembly.

(B) Do not pour concrete until the equipment is completely assembled, leveled and plumbed. Concrete must be allowed to cure completely before using the equipment (at least 72 hours).

(C) Refer to Installation Manual for R5-1310 Transition Wall installation instructions.

(D) An appropriate energy absorbing safety surface is required under and around all playground equipment. Loose fill protective surfacing is shown only as an example for the purpose of this assembly instruction. Other surfacing material may vary in thickness and/or compression depths. See free publication - The Handbook for Public Playground Safety, Publication #325 at www.cpsc.gov for the surfacing appropriate for the fall height of the equipment or consult your surfacing supply representative.

FIGURE 1
Spiral Step Climber R5

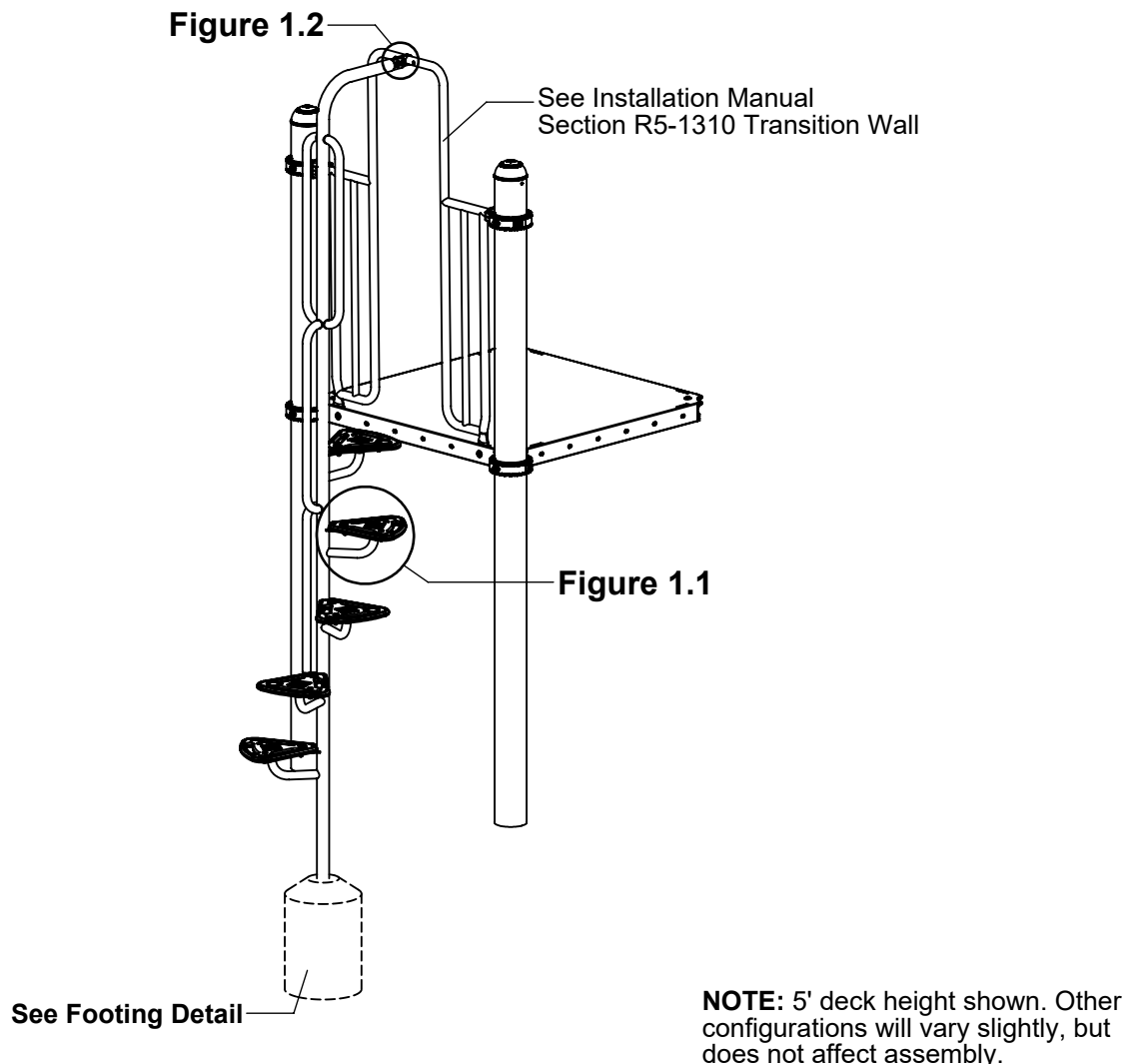

Step 1

Refer to Footing Layout and mark footing hole location. Dig (1) Ø 12" footing hole. Refer to Footing Detail for depth and details.

IMPORTANT: For areas with soft soil conditions, larger footings may be required. Additionally, half foot deck heights will require 6" deeper footing holes.

* Footing depth must be adjusted to compensate for the depth/thickness requirements of selected safety surfacing. See Section 06.1 of the Installation Manual.

Footing Detail

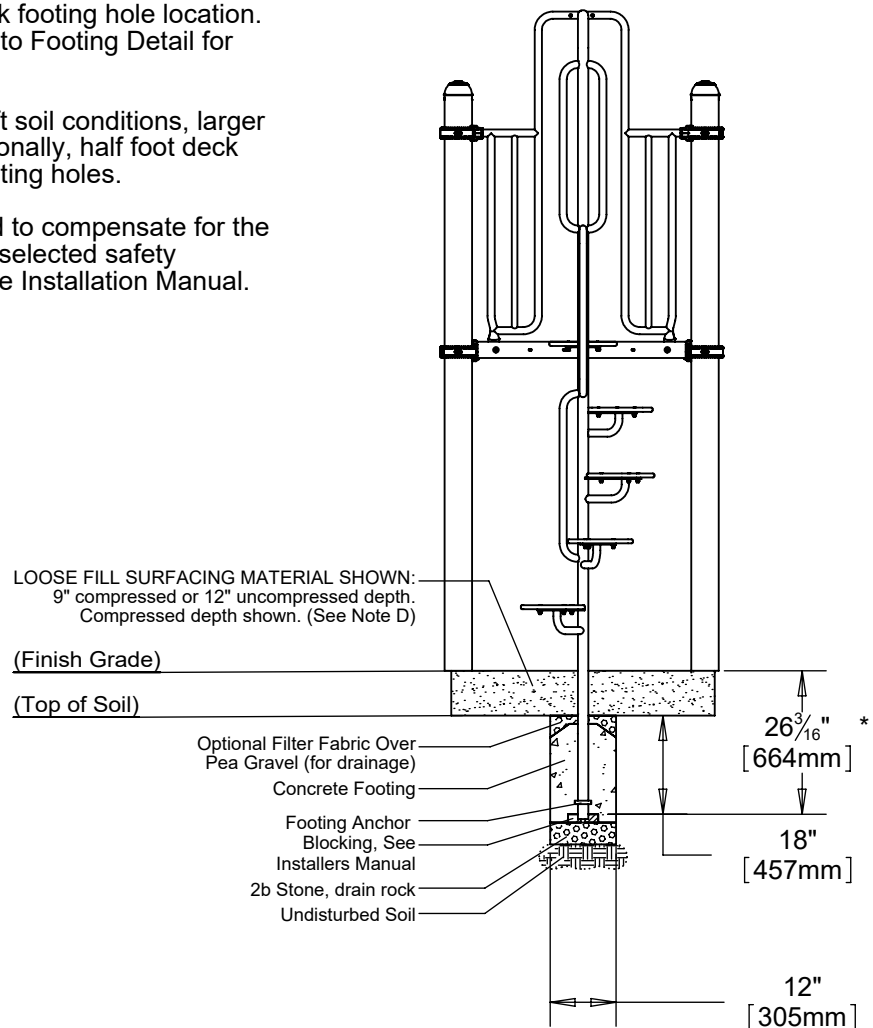

Top View - Footing Layout

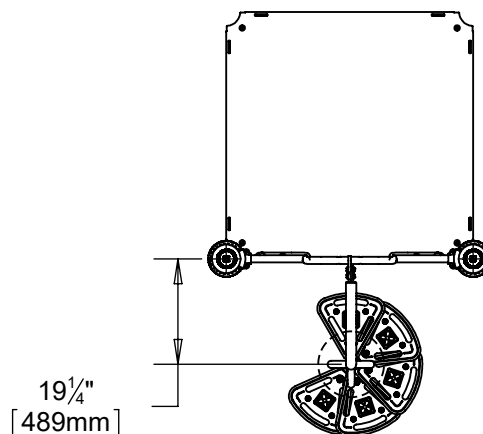

Step 2 (Factory Assembled)

Attach Spiral Step Climber Treads to Spiral Step Climber as shown in Figure 1.1. (See Note A)

Step 3

Attach Transition Wall. (See Note C)

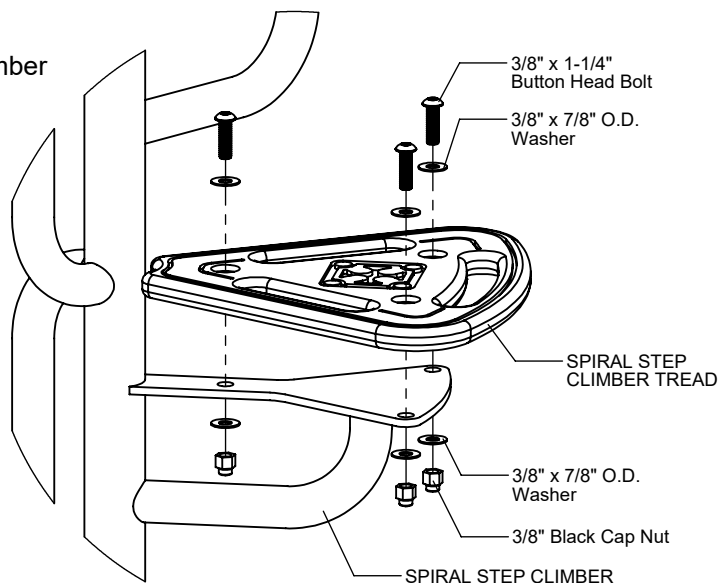

Figure 1.1

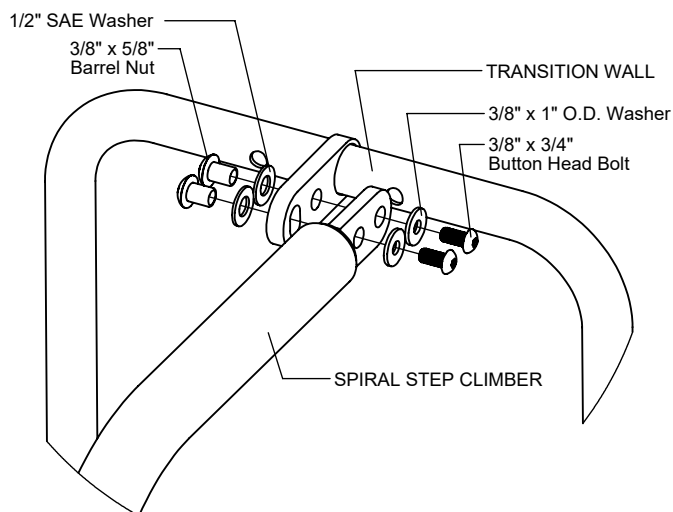

Figure 1.2

Step 4

Place Spiral Step Climber into footing hole and attach to Transition Wall as shown in Figure 1.2. (See Note A)

Step 5

Fully tighten all fasteners according to the "TIGHTENING TORQUE FOR HARDWARE" section of the Installation Manual.

Step 6

Plumb and level entire component. Pour concrete into footing hole. Allow at least 72 hours to cure before using this equipment. (See Note B)

Step 7

Place required protective surfacing under and around Spiral Step Climber. (See Note D)

SPIRAL STEP CLIMBER R5 **INSTALLATION INSTRUCTIONS**

R5-1234
Page 4 of 4

Assembled Parts List

24" DECK HEIGHT		
Part #	DESCRIPTION	QTY
EE-4420	Spiral Step Climber Tread	2
FS-1234-2R	Spiral Step Climber 24" R5	1
9103062-TR	Bolt Button Head 3/8" x 1-1/4"	6
9333042	Washer Flat 3/8" x 7/8" O.D.	12
9413162-BLK	Nut Lock 3/8" w/ Black Cap	6

36" DECK HEIGHT		
Part #	DESCRIPTION	QTY
EE-4420	Spiral Step Climber Tread	3
FS-1234-3R	Spiral Step Climber 36" R5	1
9103062-TR	Bolt Button Head 3/8" x 1-1/4"	9
9333042	Washer Flat 3/8" x 7/8" O.D.	18
9413162-BLK	Nut Lock 3/8" w/ Black Cap	9

48" DECK HEIGHT		
Part #	DESCRIPTION	QTY
EE-4420	Spiral Step Climber Tread	4
FS-1234-4R	Spiral Step Climber 48" R5	1
9103062-TR	Bolt Button Head 3/8" x 1-1/4"	12
9333042	Washer Flat 3/8" x 7/8" O.D.	24
9413162-BLK	Nut Lock 3/8" w/ Black Cap	12

60" DECK HEIGHT		
Part #	DESCRIPTION	QTY
EE-4420	Spiral Step Climber Tread	5
FS-1234-5R	Spiral Step Climber 60" R5	1
9103062-TR	Bolt Button Head 3/8" x 1-1/4"	15
9333042	Washer Flat 3/8" x 7/8" O.D.	30
9413162-BLK	Nut Lock 3/8" w/ Black Cap	15

72" DECK HEIGHT		
Part #	DESCRIPTION	QTY
EE-4420	Spiral Step Climber Tread	6
FS-1234-6R	Spiral Step Climber 72" R5	1
9103062-TR	Bolt Button Head 3/8" x 1-1/4"	18
9333042	Washer Flat 3/8" x 7/8" O.D.	36
9413162-BLK	Nut Lock 3/8" w/ Black Cap	18

84" DECK HEIGHT		
Part #	DESCRIPTION	QTY
EE-4420	Spiral Step Climber Tread	7
FS-1234-7R	Spiral Step Climber 84" R5	1
9103062-TR	Bolt Button Head 3/8" x 1-1/4"	21
9333042	Washer Flat 3/8" x 7/8" O.D.	42
9413162-BLK	Nut Lock 3/8" w/ Black Cap	21

96" DECK HEIGHT		
Part #	DESCRIPTION	QTY
EE-4420	Spiral Step Climber Tread	8
FS-1234-8R	Spiral Step Climber 96" R5	1
9103062-TR	Bolt Button Head 3/8" x 1-1/4"	24
9333042	Washer Flat 3/8" x 7/8" O.D.	48
9413162-BLK	Nut Lock 3/8" w/ Black Cap	24

Parts List

Part #	DESCRIPTION	QTY
9103032-TR	Bolt Button Head 3/8" x 3/4"	2
9333002	Washer Flat 3/8" x 1" O.D. x .100" thick	2
9345002	Washer Flat SAE 1/2"	2
9443022-TR	Nut Barrel 3/8" x 5/8" BH	2

Specifications

SPIRAL STEP CLIMBER:

Shall be fabricated from 1.900" O.D. 11 gauge steel tubing with welded 1.315" O.D. 12 gauge steel tubing handles, tread supports, and 1/4" thick steel plates. Spiral Step Climber shall have a multi-stage baked-on powder coat finish.

SPIRAL STEP CLIMBER TREAD:

Shall be made from high density 3/4" sheet plastic specially formulated for optimum UV stability and color retention.

HARDWARE:

Shall be stainless steel, zinc/nickel plated or galvanized as required to resist rust and corrosion.

Maintenance

Periodically tighten all screws, bolts and nuts. A periodic inspection of all parts is necessary. If a part is broken or worn, replace immediately. For general maintenance please refer to our Playground Maintenance Manual.



www.playcraftsystems.com
 For Customer Service Call
 800.333.8519 (U.S.A.) or 541.955.9199 (International)

Rev E
 12/19/2018