

Mounting Lug Application - Steel

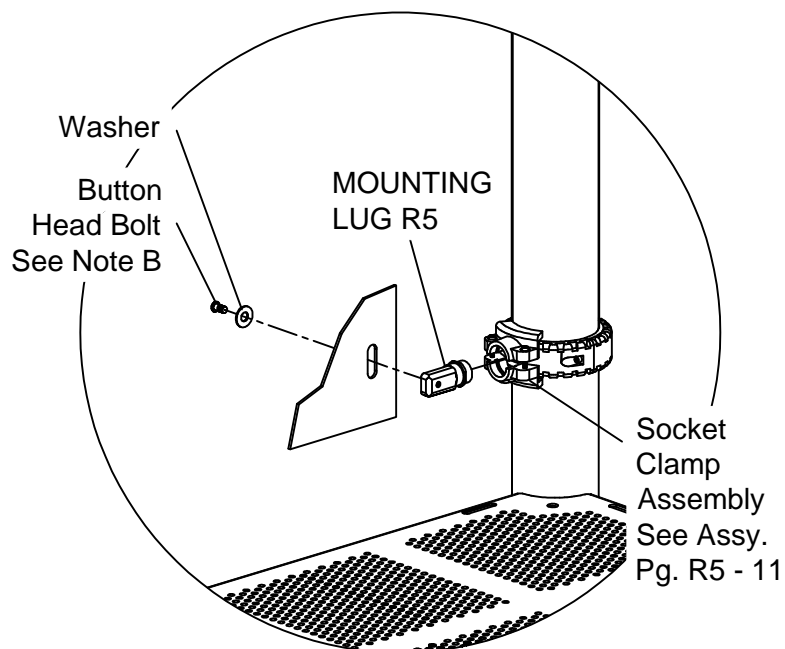

Mounting Lug Application - HDPE

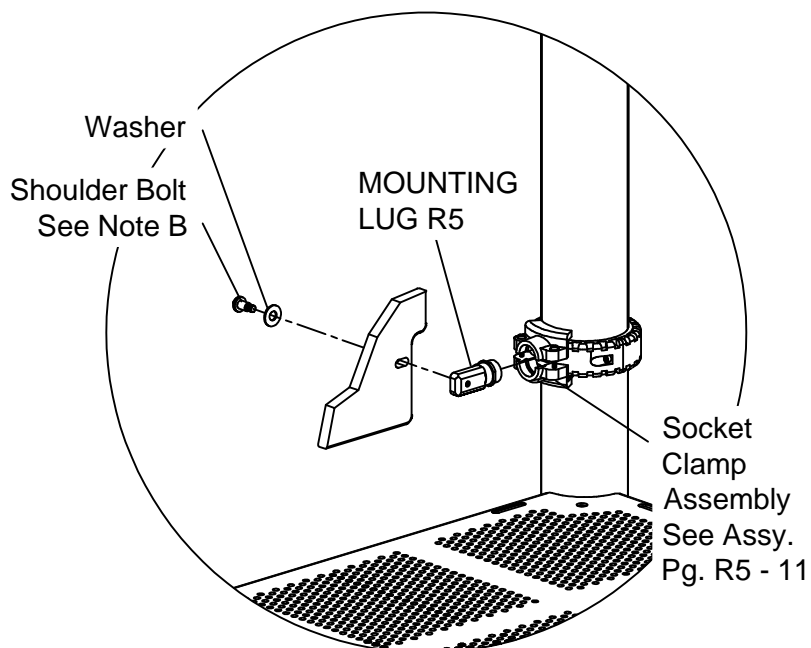

Parts List

<u>PART #</u>	<u>DESCRIPTION</u>	<u>QTY.</u>
007007	Mounting Lug R5	1

Installation

Notes:

A) More detailed instructions will be supplied with the specific components being installed on your play system.

B) Note that the length of the Button Head Bolt or Shoulder Bolt varies depending upon the application.

Step 1.

Attach Collar halves to Post. Refer to Collar Assembly Page R5 - 09.

Step 2.

Attach Socket Clamp Assembly to Collar. Refer to Socket Clamp Assembly Page R5 - 11.

Step 3.

Attach the activity to the Mounting Lug using the hardware as specified for the specific application.

Step 4.

Snug tighten all fasteners.

Step 5.

Check to ensure proper placement of the activity and make adjustments if necessary.

Step 6.

Apply liquid thread lock and fully tighten all fasteners according to the "TIGHTENING TORQUE FOR HARDWARE" Section of the Installer's Manual.

Specifications

MOUNTING LUG:

Shall be precision die-cast from a high strength aluminum alloy. The Mounting Lug has a multi-stage baked-on powder coat finish.

Maintenance

Periodically tighten all screws, bolts and nuts. A periodic inspection of all parts is necessary. If a part is broken or worn, replace immediately. For general maintenance please refer to our Playground Maintenance Manual.



Manufactured by Krauss Craft, Inc.
www.playcraftsystems.com

For Customer Service Call
800.333.8519 (U.S.A.) or
541.955.9199 (International)

Rev B