

## IMPORTANT NOTES: Read First

(A) Use liquid thread lock (such as Loctite®) with all threaded hardware. **Important:** Liquid thread lock (prior to curing) helps to eliminate the common problem of "thread seizure" in stainless steel hardware by serving as a lubricant during assembly.

**FIGURE 1**  
Gear Panel Round

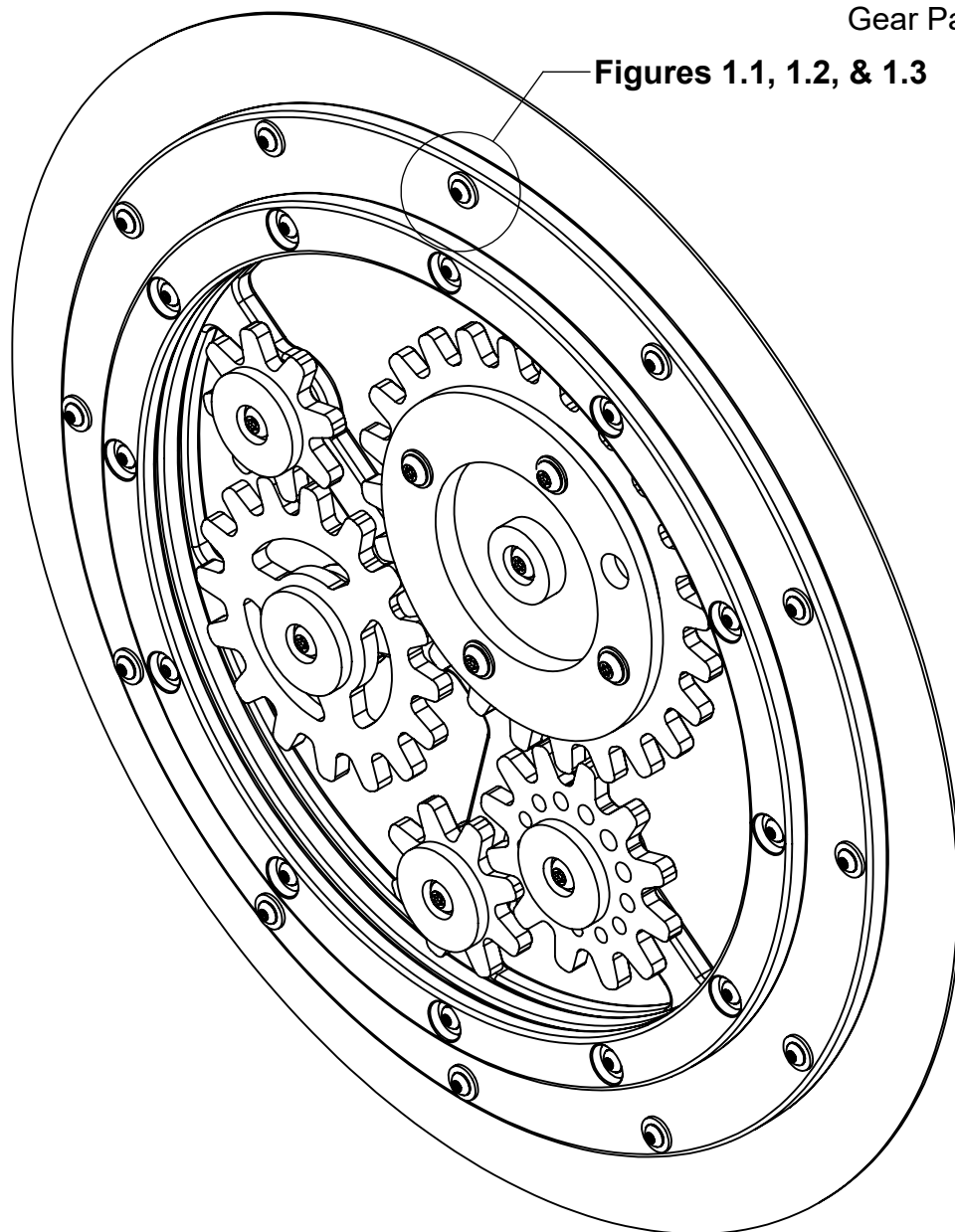

**NOTE:** Gear Panel Round to steel panel shown. Other configurations will vary slightly, but does not affect assembly.

### Step 1 (Factory Assembled)

Press Barrel Nuts through Hubs and partially assemble Gears to Window Front as shown in Figure 2. (See Note A)

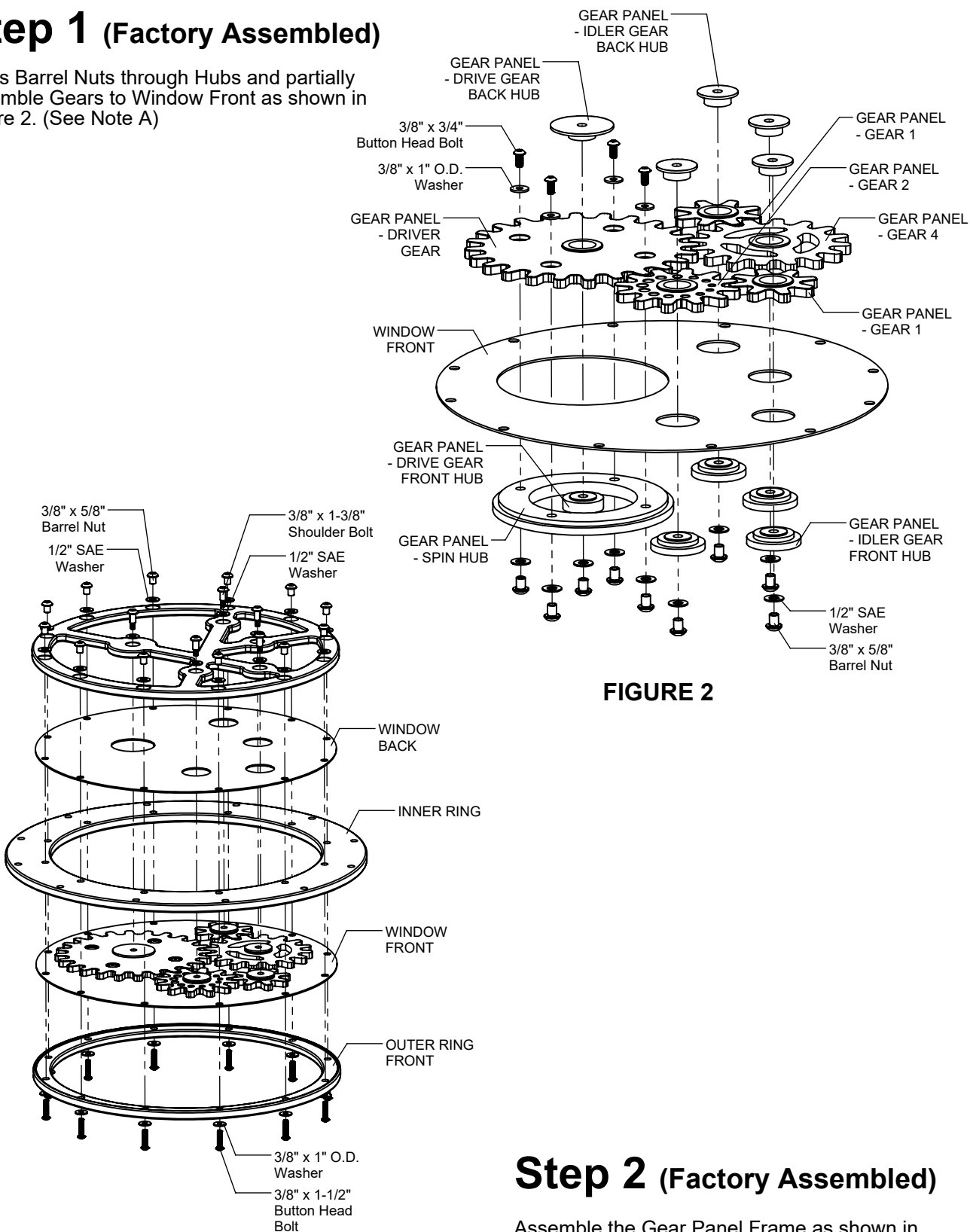

FIGURE 2

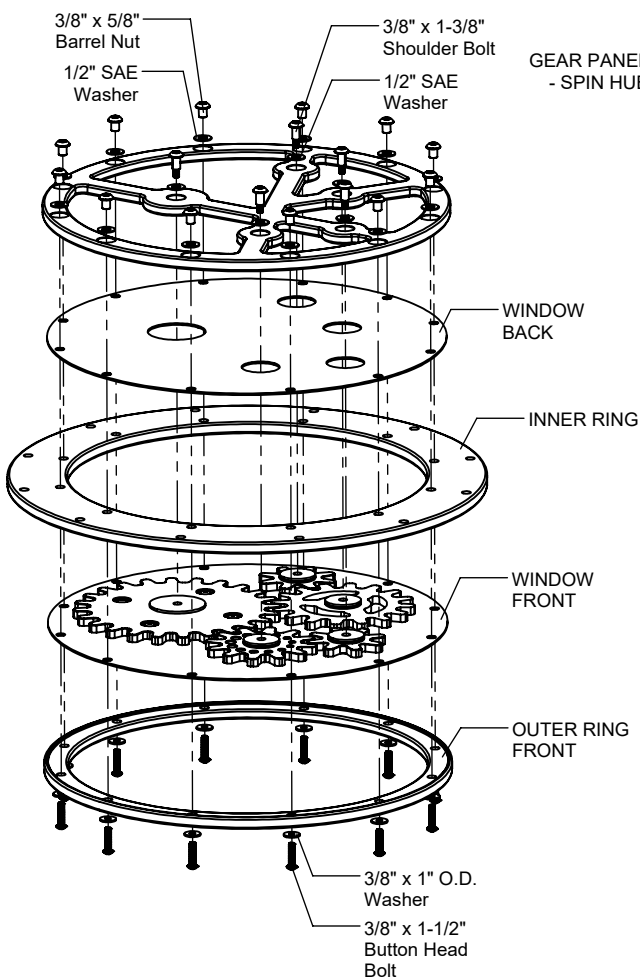

FIGURE 3

### Step 2 (Factory Assembled)

Assemble the Gear Panel Frame as shown in Figure 3. (See Note A)

## Step 3a

### For Steel Event Panel Only

Attach Gear Panel Round to Steel Event Panel as shown in Figure 1.1. (See Note A)

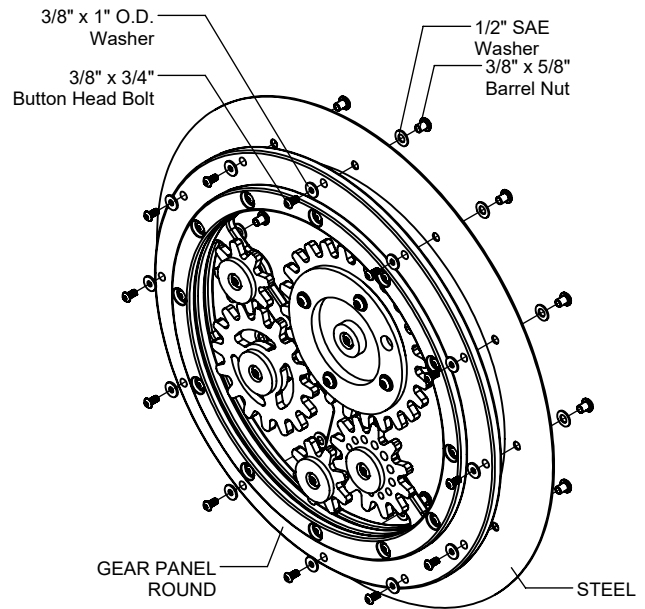

Figure 1.1

## Step 3b

### For HDPE Event Panel Only

Attach Gear Panel Round to HDPE Event Panel as shown in Figure 1.2. (See Note A)

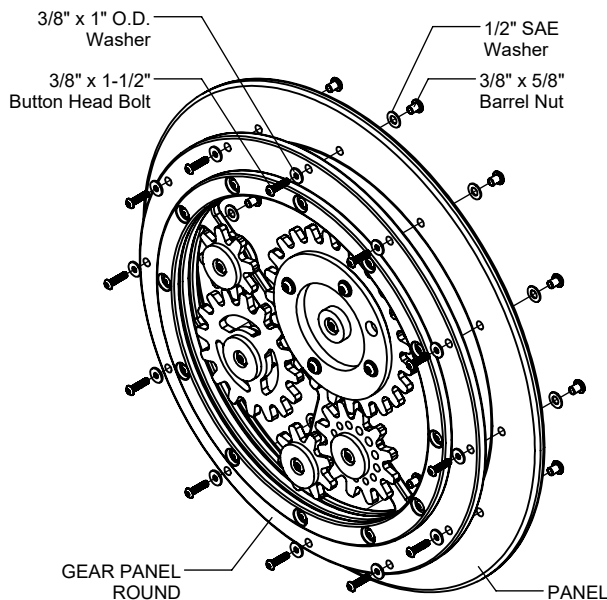

Figure 1.2

## Step 3c

### For Roto Event Panel Only

Attach Gear Panel Round to Roto Event Panel as shown in Figure 1.3. (See Note A)

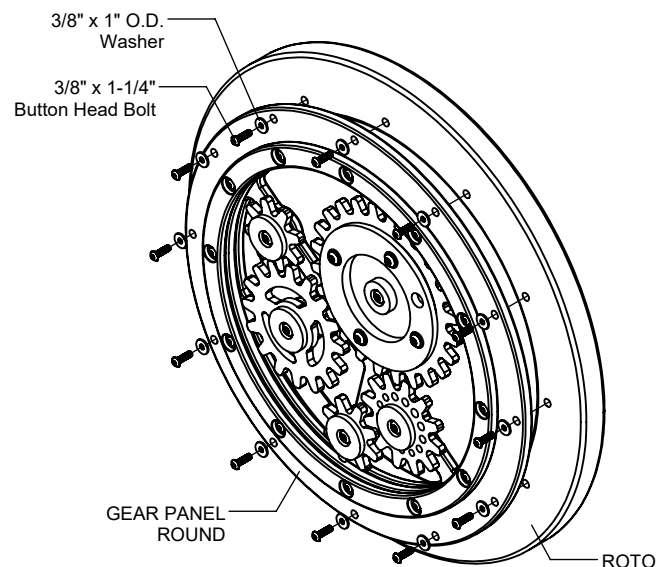

Figure 1.3

# GEAR PANEL ROUND INSTALLATION INSTRUCTIONS

**1644-RND**  
Page 4 of 4

## Parts List

| STEEL MOUNT |  |     |
|-------------|--|-----|
| Part #      | DESCRIPTION                              | QTY |
| 9103032-TR  | Bolt Button Head 3/8" x 3/4"             | 12  |
| 9333002     | Washer Flat 3/8" x 1" O.D. x .100" thick | 12  |
| 9345002     | Washer Flat SAE 1/2"                     | 12  |
| 9443022-TR  | Nut Barrel 3/8" x 5/8" BH                | 12  |

| HDPE MOUNT |  |     |
|------------|--|-----|
| Part #     | DESCRIPTION                              | QTY |
| 9103072-TR | Bolt Button Head 3/8" x 1-1/2"           | 12  |
| 9333002    | Washer Flat 3/8" x 1" O.D. x .100" thick | 12  |
| 9345002    | Washer Flat SAE 1/2"                     | 12  |
| 9443022-TR | Nut Barrel 3/8" x 5/8" BH                | 12  |

| ROTO MOUNT |  |     |
|------------|--|-----|
| Part #     | DESCRIPTION                              | QTY |
| 9103062-TR | Bolt Button Head 3/8" x 1-1/4"           | 12  |
| 9333002    | Washer Flat 3/8" x 1" O.D. x .100" thick | 12  |

## Assembled Parts List

| Part #       | DESCRIPTION                              | QTY |
|--------------|--|-----|
| EE-0688-IR   | Gear Panel Round Inner Ring              | 1   |
| EE-0688-ORB  | Gear Panel Round Outer Ring Back         | 1   |
| EE-0688-ORF  | Gear Panel Round Outer Ring Front        | 1   |
| EE-0689-WB   | Gear Panel Round Window Back             | 1   |
| EE-0689-WF   | Gear Panel Round Window Front            | 1   |
| EE-8216-DG   | Gear Panel - Driver Gear                 | 1   |
| EE-8216-DGBH | Gear Panel - Drive Gear Back Hub         | 1   |
| EE-8216-DGFH | Gear Panel - Drive Gear Front Hub        | 1   |
| EE-8216-G1   | Gear Panel - Gear 1                      | 2   |
| EE-8216-G2   | Gear Panel - Gear 2                      | 1   |
| EE-8216-G4   | Gear Panel - Gear 4                      | 1   |
| EE-8216-IGBH | Gear Panel - Idler Gear Back Hub         | 4   |
| EE-8216-IGFH | Gear Panel - Idler Gear Front Hub        | 4   |
| EE-8216-SH   | Gear Panel - Spin Hub                    | 1   |
| 9103032-TR   | Bolt Button Head 3/8" x 3/4"             | 4   |
| 9103072-TR   | Bolt Button Head 3/8" x 1-1/2"           | 12  |
| 9143062-TR   | Bolt Shoulder 3/8" x 1-3/8" BH           | 5   |
| 9333002      | Washer Flat 3/8" x 1" O.D. x .100" thick | 16  |
| 9345002      | Washer Flat SAE 1/2"                     | 26  |
| 9443022-TR   | Nut Barrel 3/8" x 5/8" BH                | 21  |

## Specifications

### GEAR PANEL COMPONENTS:

Shall be made from high density 3/4" sheet plastic specially formulated for optimum UV stability and color retention.

### GEAR PANEL WINDOWS:

Shall be made from .118 Polycarbonate sheet plastic.

### HARDWARE:

Shall be stainless steel, zinc/nickel plated or galvanized as required to resist rust and corrosion.

## Maintenance

Periodically tighten all screws, bolts and nuts. A periodic inspection of all parts is necessary. If a part is broken or worn, replace immediately. For general maintenance please refer to our Playground Maintenance Manual.



www.playcraftsystems.com  
For Customer Service Call  
800.333.8519 (U.S.A.) or 541.955.9199 (International)

**Rev A**  
6/30/2021