

IMPORTANT NOTES: Read First

(A) Use liquid thread lock (such as Loctite®) with all threaded hardware. **Important:** Liquid thread lock (prior to curing) helps to eliminate the common problem of "thread seizure" in stainless steel hardware by serving as a lubricant during assembly.

FIGURE 1
Solo Instrument Panel

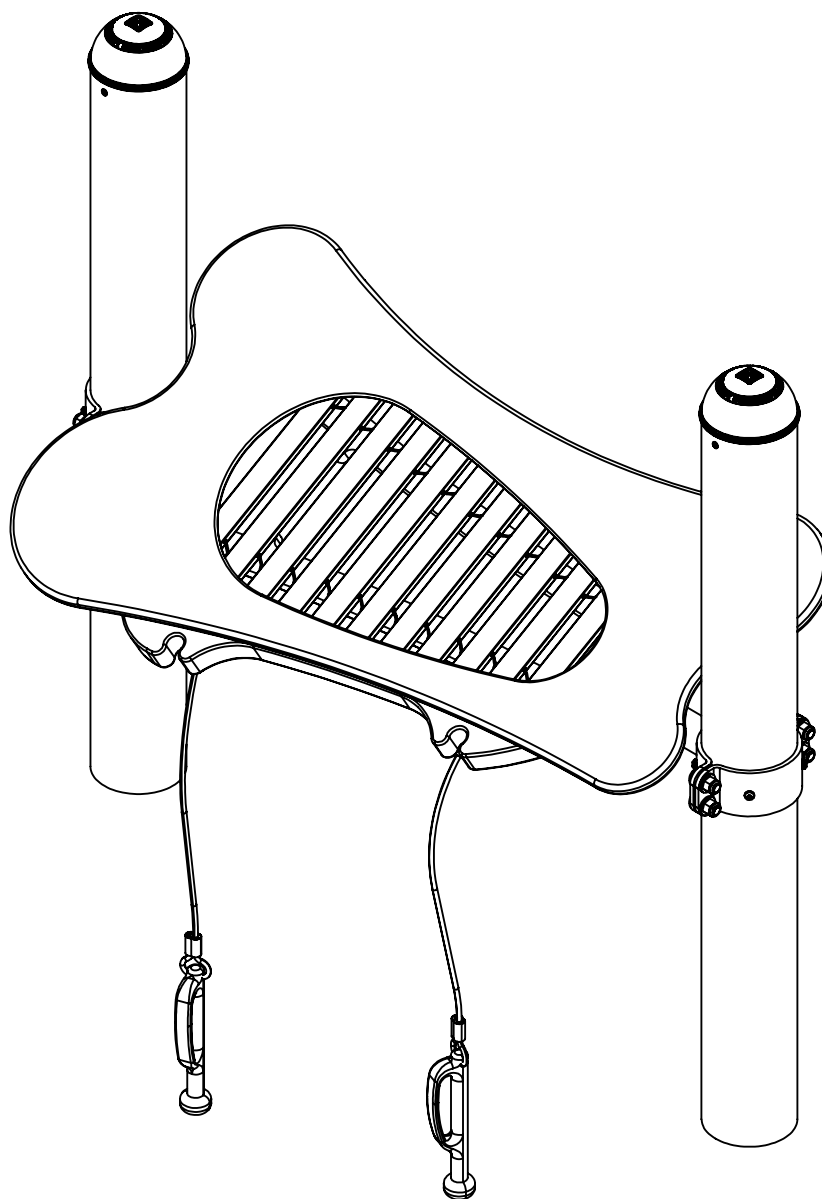

NOTE: R5 Solo Aluminum Instrument Panel shown. Other configurations will vary slightly, but does not affect assembly.

Step 1 (Factory Assembled)

Attach Solo Panel to Solo using Mounting Screws packaged with Solo as shown in Figure 2.

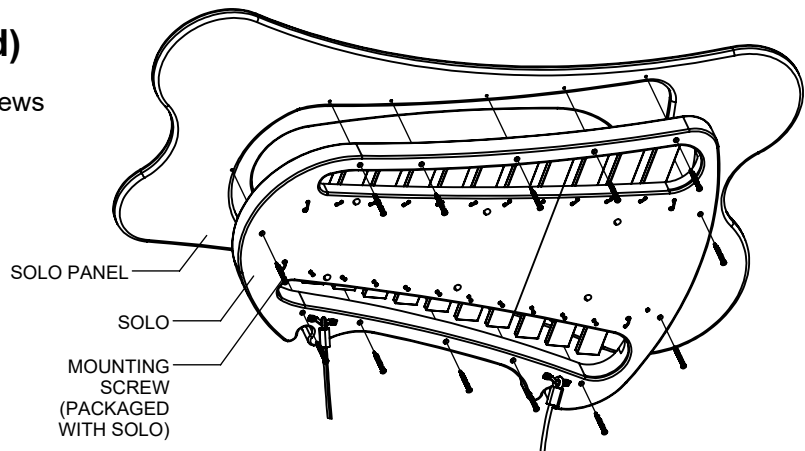

FIGURE 2

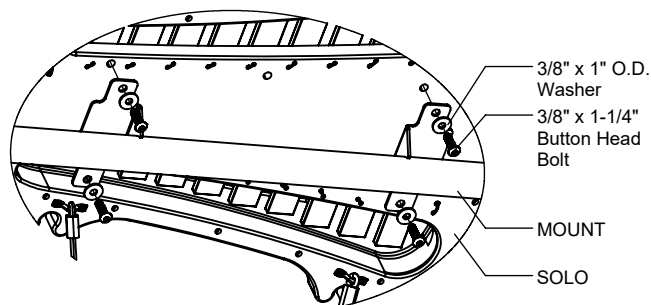

FIGURE 3

Step 2

Attach Solo to Mount as shown in Figure 3. (See Note A)

Step 3

Attach Mount to Post as shown in Figure 4. Locate Split Collars at height shown in Elevation View. (See Note A)

* Height shown from finish grade to top of collar.

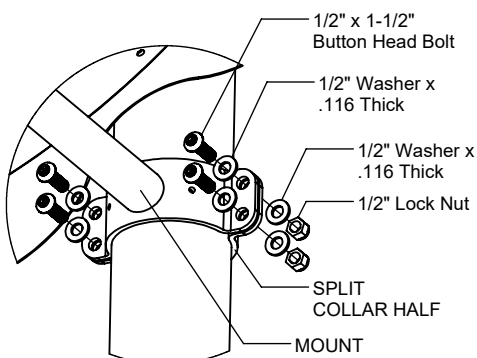
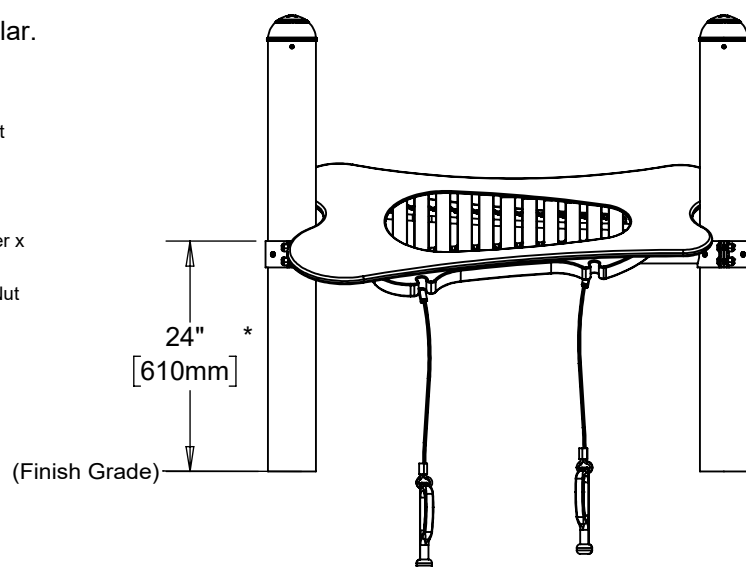

FIGURE 4

Elevation View



Step 4

Secure Mount to Post as shown in Figure 5.
(See Note A)

Step 5

Fully tighten all fasteners according to the
"TIGHTENING TORQUE FOR HARDWARE"
section of the Installation Manual.

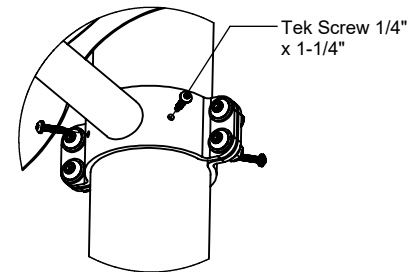

FIGURE 5

Parts List

| R5 | | |
|-------------|--|-----|
| Part # | DESCRIPTION | QTY |
| BF-7068 | Split Collar Half R5 | 2 |
| FS-16521-R5 | Solo Mount R5 | 1 |
| 9103062-TR | Bolt Button Head 3/8" x 1-1/4" | 4 |
| 9105072 | Bolt Button Head 1/2" x 1-1/2" | 8 |
| 9271062-TR | 1/4" x 1-1/4" Tek Screw | 8 |
| 9333002 | Washer Flat 3/8" x 1" O.D. x .100" thick | 4 |
| 9335002 | Washer Flat 1/2" (.116" thick) | 16 |
| 9415132 | Nut Lock 1/2" | 8 |

Assembled Parts List

| SOLO ALUMINUM R5 | | |
|------------------|-----------------------------------|-----|
| Part # | DESCRIPTION | QTY |
| EF-0671 | Solo Aluminum Instrument Panel R5 | 1 |
| FHP-SOLO-AL-36 | Solo Aluminum | 1 |

| SOLO FIBERGLASS R5 | | |
|--------------------|-------------------------------------|-----|
| Part # | DESCRIPTION | QTY |
| EF-0672 | Solo Fiberglass Instrument Panel R5 | 1 |
| FHP-SOLO-FG-36 | Solo Fiberglass | 1 |

Parts List

| R35 | | |
|--------------|--|-----|
| Part # | DESCRIPTION | QTY |
| BG-8133 | Split Collar Half R3.5 | 2 |
| FS-16521-R35 | Solo Mount R35 | 1 |
| 9103062-TR | Bolt Button Head 3/8" x 1-1/4" | 4 |
| 9105072 | Bolt Button Head 1/2" x 1-1/2" | 8 |
| 9271062-TR | 1/4" x 1-1/4" Tek Screw | 8 |
| 9333002 | Washer Flat 3/8" x 1" O.D. x .100" thick | 4 |
| 9335002 | Washer Flat 1/2" (.116" thick) | 16 |
| 9415132 | Nut Lock 1/2" | 8 |

Assembled Parts List

| SOLO ALUMINUM R35 | | |
|-------------------|------------------------------------|-----|
| Part # | DESCRIPTION | QTY |
| EG-0076 | Solo Aluminum Instrument Panel R35 | 1 |
| FHP-SOLO-AL-36 | Solo Aluminum | 1 |

| SOLO FIBERGLASS R35 | | |
|---------------------|--------------------------------------|-----|
| Part # | DESCRIPTION | QTY |
| EG-0077 | Solo Fiberglass Instrument Panel R35 | 1 |
| FHP-SOLO-FG-36 | Solo Fiberglass | 1 |

Specifications

SPLIT COLLAR HALF:

Shall be precision cut and formed from 1/4" thick steel and will have a multi-stage baked-on powder coat finish.

SOLO MOUNT:

Shall be fabricated using 1.900" O.D. 11 gauge steel tubing with welded 10 gauge and 1/4" thick steel brackets and will have a multi-stage baked-on powder coat finish.

SOLO INSTRUMENT PANEL:

Shall be made from high density 3/4" sheet plastic specially formulated for optimum UV stability and color retention.

SOLO:

Shall be an assembly consisting of a plastic framework, aluminum or fiberglass chimes, and molded mallets. Contact Freenotes Harmony Park for complete technical specifications.

HARDWARE:

Shall be stainless steel, zinc/nickel plated or galvanized as required to resist rust and corrosion.

Maintenance

Periodically tighten all screws, bolts and nuts. A periodic inspection of all parts is necessary. If a part is broken or worn, replace immediately. For general maintenance please refer to our Playground Maintenance Manual.

