

IMPORTANT NOTES: Read First

(A) Use liquid thread lock (such as Loctite®) with all threaded hardware. **Important:** Liquid thread lock (prior to curing) helps to eliminate the common problem of "thread seizure" in stainless steel hardware by serving as a lubricant during assembly.

(B) Refer to Installation Manual for 09 Collars and 11 Socket Clamps installation instructions.

(C) All gaps created (e.g. between panels, between panel and deck, between panel and roof, etc.) must be less than 3-1/2" [89mm] or greater than 9" [229mm].

(D) An appropriate energy absorbing safety surface is required under and around all playground equipment. Loose fill protective surfacing is shown only as an example for the purpose of this assembly instruction. Other surfacing material may vary in thickness and/or compression depths. See free publication - The Handbook for Public Playground Safety, Publication #325 at www.cpsc.gov for the surfacing appropriate for the fall height of the equipment or consult your surfacing supply representative.

(E) These assembly instructions apply to all R5 Round and Square Rotomolded Panel Frames that deck and/or collar mount. Use specific panel instructions when available if installation requires different hardware and/or panel configurations other than shown in these instructions.

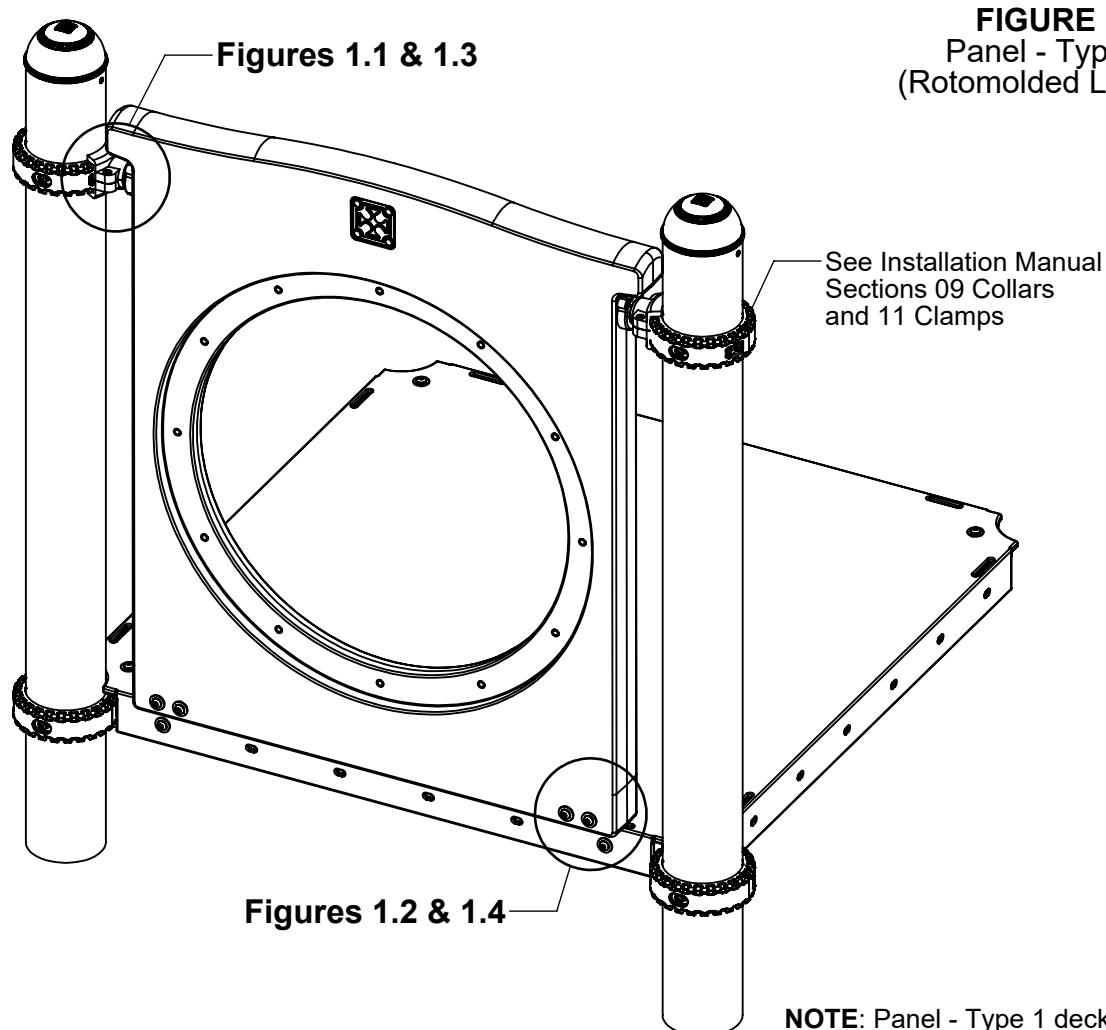

FIGURE 1
Panel - Type 1
(Rotomolded LLDPE)

NOTE: Panel - Type 1 deck mount shown. Other configurations will vary slightly, but does not affect assembly.

Step 1

Locate and attach collars at heights shown in Elevation View. (See Note B)

* Height shown from top of deck to top of collar.

** Height shown from top of collar to top of collar.

*** Height shown from finish grade to top of collar.

Elevation View

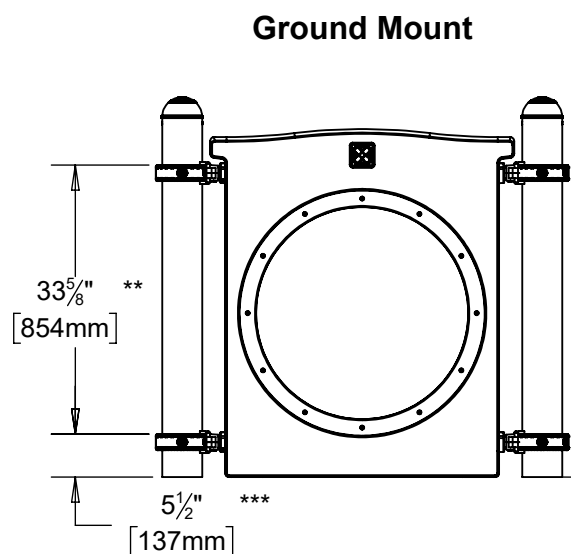

Deck Mount

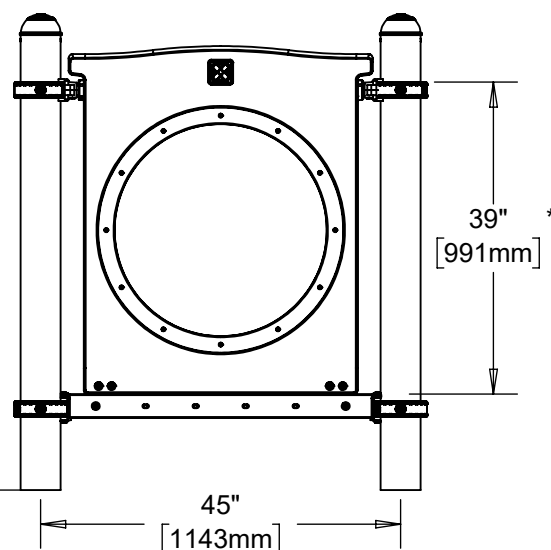

Step 2 (Factory Assembled)

Insert Panel Roto Pipe into Roto Panel and attach Zinc Collar as shown in Figure 1.1.
 (See Note A set screw only)

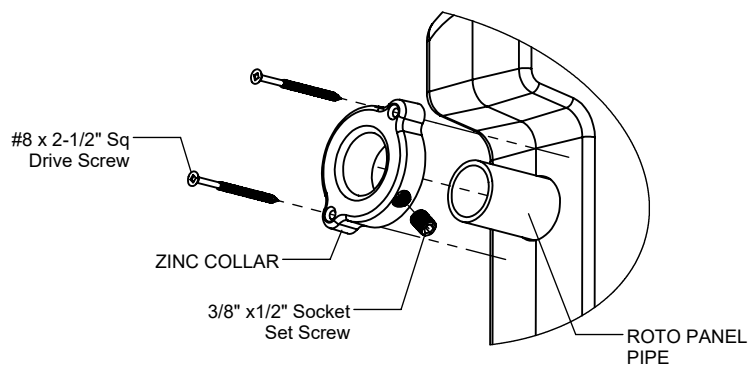
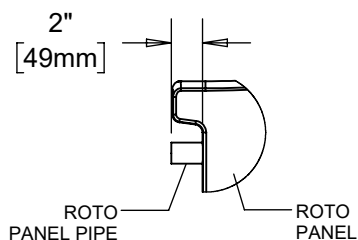

Figure 1.1

Step 3

For Deck Mount Only

Attach Roto Panel Bracket to Roto Panel as shown in Figure 1.2. (See Note A)

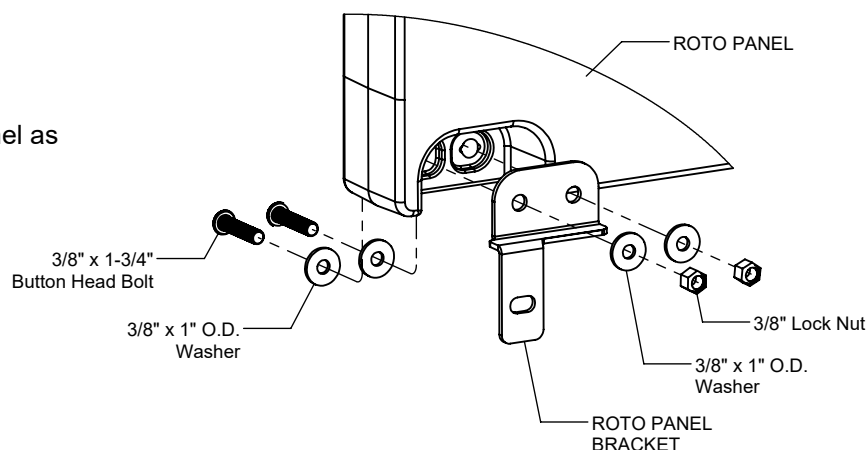

Figure 1.2

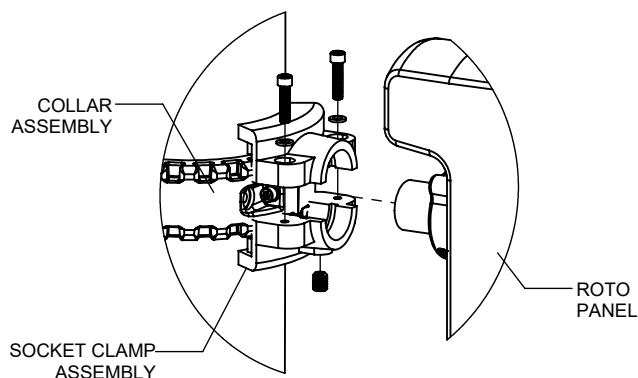

Figure 1.3

Step 4

Attach Roto Panel to Collars as shown in Figure 1.3. (See Notes A & B)

Step 5

For Deck Mount Only

Attach Roto Panel Bracket to Deck as shown in Figure 1.4. (See Note A)

Step 6

Fully tighten all fasteners according to the "TIGHTENING TORQUE FOR HARDWARE" section of the Installation Manual.

Step 7

Place required protective surfacing under and around Panels. (See Note D)

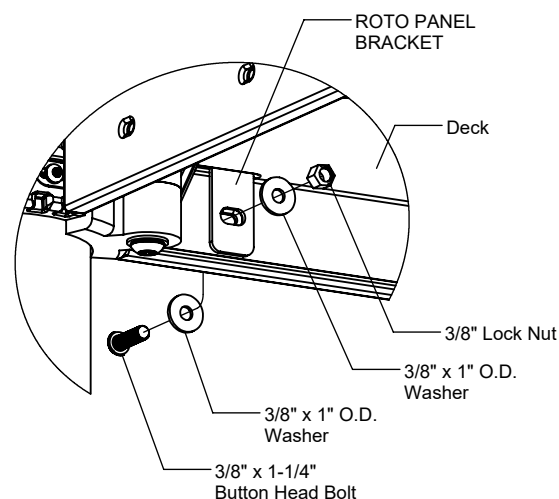

Figure 1.4

PANEL - TYPE 1 (ROTOMOLDED LLDPE)

INSTALLATION INSTRUCTIONS

R5-1601
Page 4 of 4

Parts List

| DECK MOUNT | | |
|------------|--|-----|
| Part # | DESCRIPTION | QTY |
| BF-7117-L | Roto Panel Bracket Left (R5) | 1 |
| BF-7117-R | Roto Panel Bracket Right (R5) | 1 |
| HS-1001-R5 | Socket Clamp Set R5 | 2 |
| 9103062-TR | Bolt Button Head 3/8" x 1-1/4" | 2 |
| 9103082-TR | Bolt Button Head 3/8" x 1-3/4" | 4 |
| 9333002 | Washer Flat 3/8" x 1" O.D. x .100" thick | 12 |
| 9413002 | Nut Lock 3/8" | 6 |

| GROUND MOUNT | | |
|--------------|---------------------|-----|
| Part # | DESCRIPTION | QTY |
| HS-1001-R5 | Socket Clamp Set R5 | 4 |

Assembled Parts List

| DECK MOUNT | | |
|------------|---------------------------------|-----|
| Part # | DESCRIPTION | QTY |
| Varies | Roto Panel | 1 |
| GE-0011 | Zinc Collar | 2 |
| LF-0733 | Panel Roto Pipe | 1 |
| 9248112 | Screw Drywall #8 x 2-1/2" Sq Dr | 4 |
| 9263012 | Screw Soc Set 3/8" x 1/2" | 2 |

| GROUND MOUNT | | |
|--------------|---------------------------------|-----|
| Part # | DESCRIPTION | QTY |
| Varies | Roto Panel | 1 |
| GE-0011 | Zinc Collar | 4 |
| LF-0733 | Panel Roto Pipe | 2 |
| 9248112 | Screw Drywall #8 x 2-1/2" Sq Dr | 8 |
| 9263012 | Screw Soc Set 3/8" x 1/2" | 4 |

Specifications

ROTO PANEL:

Shall be constructed of UV-stabilized, rotationally molded, linear, low density polyethylene with an average wall thickness of .250".

PANEL ROTO PIPE:

Shall be fabricated using Ø1.315 12ga steel tubing.

ROTO PANEL BRACKET:

Shall be fabricated using 10ga sheet steel and will have a multi-stage baked-on powder coat finish.

SOCKET CLAMPS:

Shall be two-part and precision die-cast from a high strength aluminum alloy and will have a multi-stage baked-on powder coat finish.

HARDWARE:

Shall be stainless steel, zinc/nickel plated or galvanized as required to resist rust and corrosion.

Maintenance

Periodically tighten all screws, bolts and nuts. A periodic inspection of all parts is necessary. If a part is broken or worn, replace immediately. For general maintenance please refer to our Playground Maintenance Manual.



www.playcraftsystems.com
For Customer Service Call
800.333.8519 (U.S.A.) or 541.955.9199 (International)

Rev H
5/5/2022