

IMPORTANT NOTES: Read First

(A) Use liquid thread lock (such as Loctite®) with all threaded hardware. **Important:** Liquid thread lock (prior to curing) helps to eliminate the common problem of "thread seizure" in stainless steel hardware by serving as a lubricant during assembly.

(B) Do not pour concrete until the equipment is completely assembled, leveled and plumbed. Concrete must be allowed to cure completely before using the equipment (at least 72 hours).

(C) Refer to the Site Plan included with the Installation Guidelines for additional Footing Layout dimensions. Actual hole locations may vary according to system design.

(D) An appropriate energy absorbing safety surface is required under and around all playground equipment. Loose fill protective surfacing is shown only as an example for the purpose of this assembly instruction. Other surfacing material may vary in thickness and/or compression depths. See free publication - The Handbook for Public Playground Safety, Publication #325 at www.cpsc.gov for the surfacing appropriate for the fall height of the equipment or consult your surfacing supply representative.

FIGURE 1
Angled Lunar Climber
to Mount

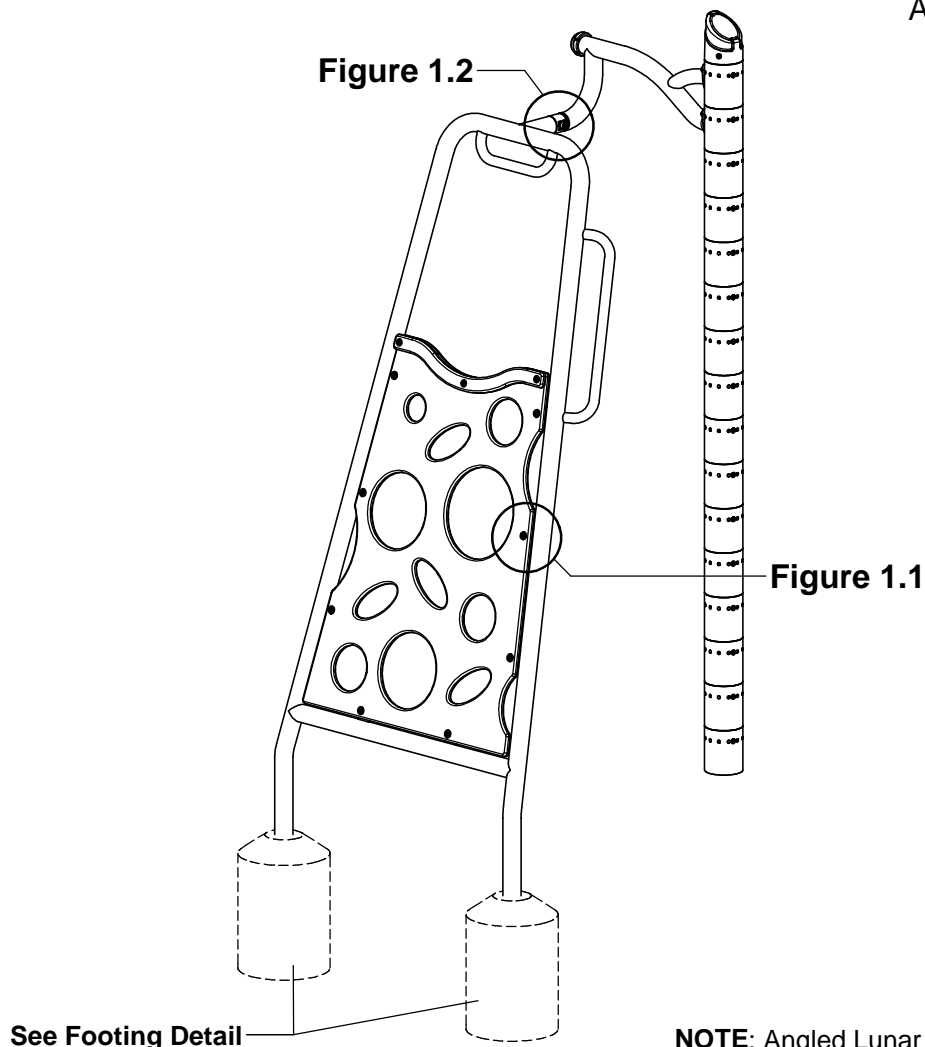

NOTE: Angled Lunar Climber to Turn Left Event Hanger shown. Other configurations will vary slightly, but does not affect assembly.

Step 1

Refer to Footing Layout and mark footing hole locations. Dig (2) Ø 12" footing holes. Refer to Footing Detail for depth and details.

* Footing depth must be adjusted to compensate for the depth/thickness requirements of selected safety surfacing. See Section 06.1 of the Installation Manual.

Footing Detail

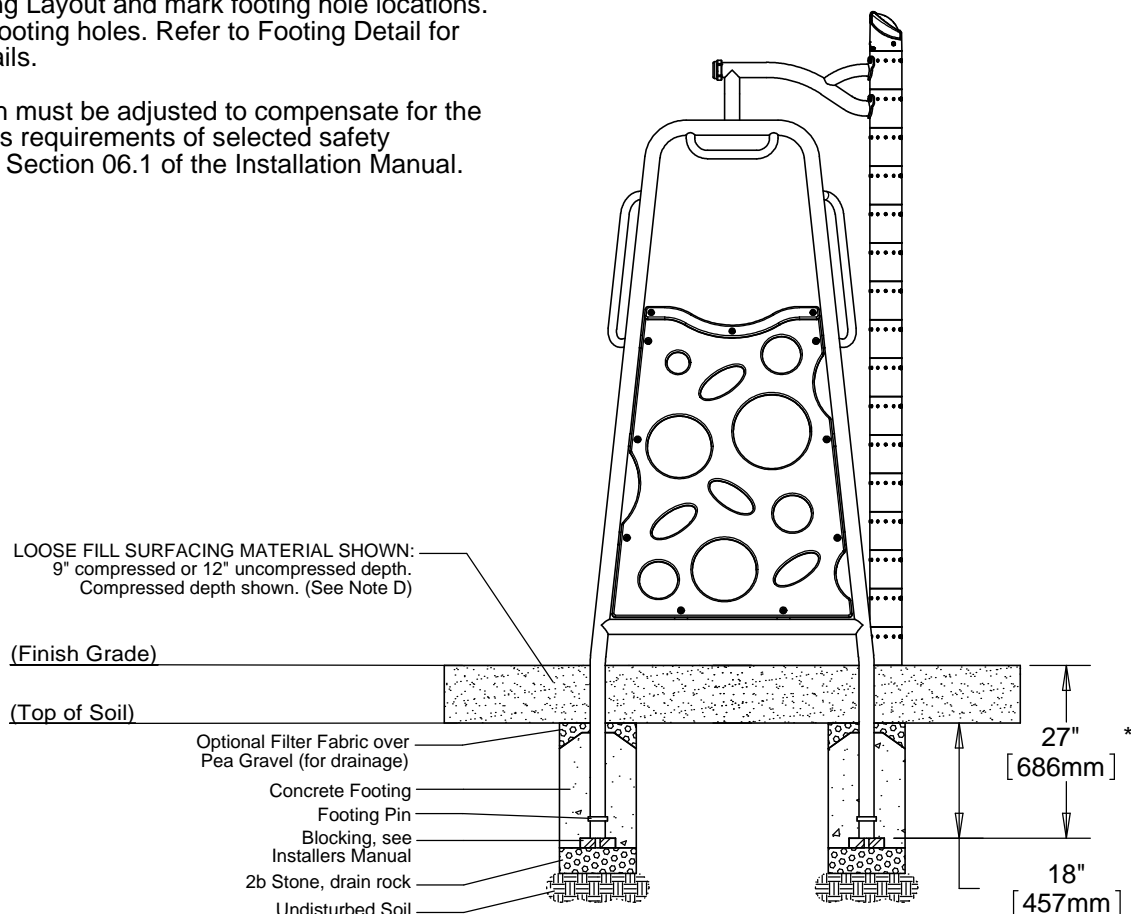

Top View - Footing Layout

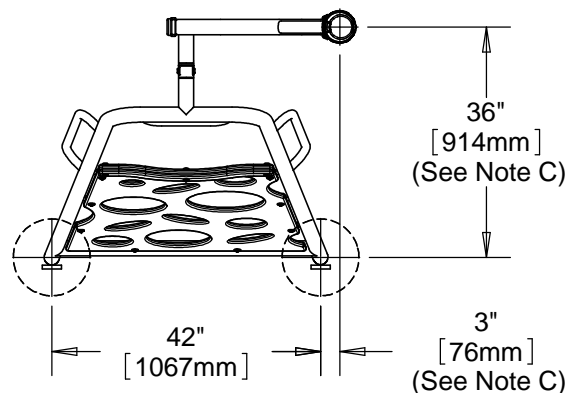

Step 2 (Factory Assembled)

Attach Trim to Angled Bubble Climber Panel as shown in Figure 2. (See Note A)

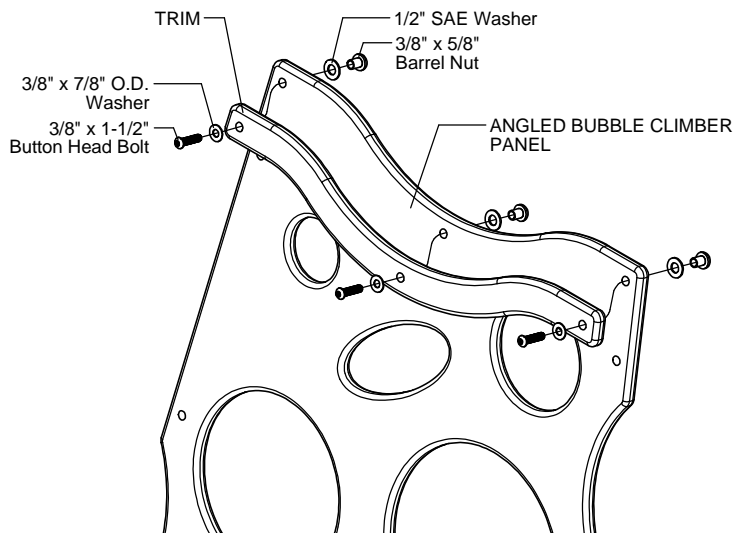

FIGURE 2

Step 3 (Factory Assembled)

Attach Angled Bubble Climber Panel to Angled Panel Climber Frame as shown in Figure 1.1. (See Note A)

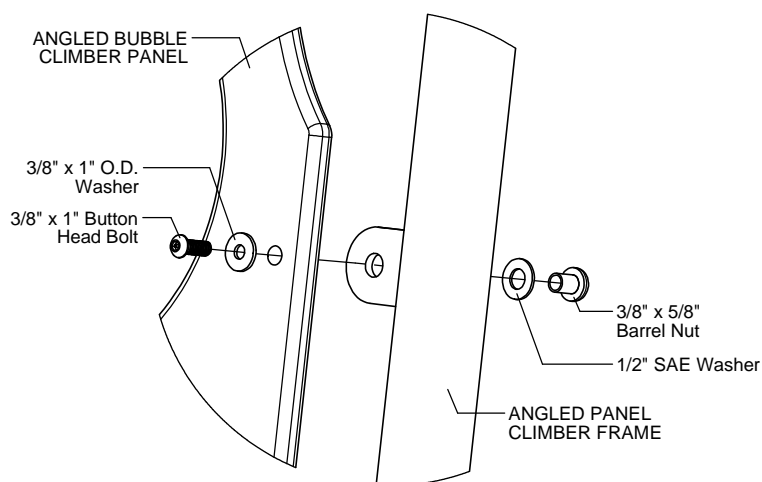

Figure 1.1

Step 4

Attach Angled Panel Climber Frame to Pin as shown in Figure 1.2. (See Note A)

Step 5

Fully tighten all fasteners according to the "TIGHTENING TORQUE FOR HARDWARE" section of the Installation Manual.

Step 6

Plumb and level entire component. Pour concrete into footing holes. Allow at least 72 hours to cure before using this equipment. (See Note B)

Step 7

Place required protective surfacing under and around Angled Lunar Climber to Mount. (See Note D)

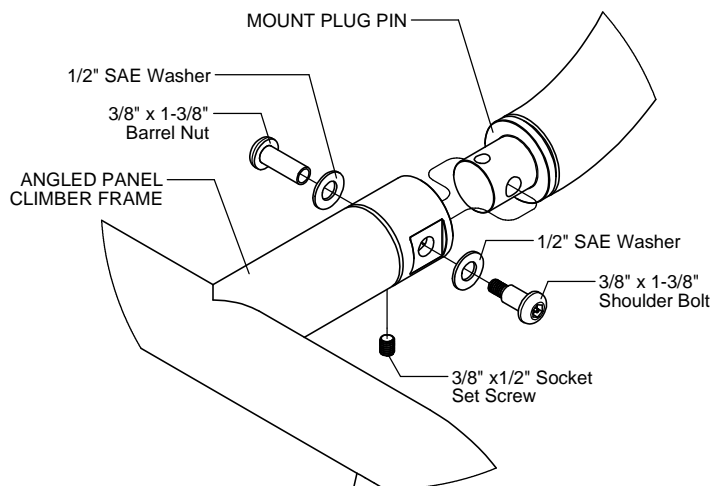

Figure 1.2

ANGLED LUNAR CLIMBER TO MOUNT RV INSTALLATION INSTRUCTIONS

1277-MNT
Page 4 of 4

Parts List

Part #	DESCRIPTION	QTY
9143062-TR	Bolt Shoulder 3/8" x 1-3/8" BH	1
9263012-TR	3/8" x 1/2" Socket Set Screw	1
9345002	Washer Flat SAE 1/2"	2
9443062-TR	Nut Barrel 3/8" x 1-3/8"	1

Assembled Parts List

Part #	DESCRIPTION	QTY
EE-0109	Angled Bubble Climber Panel	1
EE-0109-T	Angled Climber Panel Trim	1
FS-1277-MNT	Angled Panel Climber to Mount Frame RV	1
9103052-TR	Bolt Button Head 3/8" x 1"	8
9103072-TR	Bolt Button Head 3/8" x 1-1/2"	3
9333002	Washer Flat 3/8" x 1" O.D. x .100" thick	8
9333042	Washer Flat 3/8" x 7/8" O.D.	3
9345002	Washer Flat SAE 1/2"	11
9443022-TR	Nut Barrel 3/8" x 5/8" BH	11

Specifications

ANGLED BUBBLE CLIMBER PANEL & TRIM:

Shall be made from high density 3/4" sheet plastic specially formulated for optimum UV stability and color retention.

ANGLED BUBBLE CLIMBER TO MOUNT FRAME:

Shall be fabricated using 2.375" O.D. 11 gauge steel tubing with welded 1.315" O.D. 12 gauge steel handles and stainless steel housing. The Angled Panel Climber To Mount Frame RV shall have a multi-stage baked-on powder coat finish.

HARDWARE:

Shall be stainless steel, zinc/nickel plated or galvanized as required to resist rust and corrosion.

Maintenance

Periodically tighten all screws, bolts and nuts. A periodic inspection of all parts is necessary. If a part is broken or worn, replace immediately. For general maintenance please refer to our Playground Maintenance Manual.



Manufactured by Krauss Craft, Inc.
www.playcraftsystems.com

For Customer Service Call
800.333.8519 (U.S.A.) or
541.955.9199 (International)

Rev B
3/30/2013