

### IMPORTANT NOTES: Read First

(A) Use liquid thread lock (such as Loctite®) with all threaded hardware. **Important:** Liquid thread lock (prior to curing) helps to eliminate the common problem of "thread seizure" in stainless steel hardware by serving as a lubricant during assembly.

(B) Refer to Installation Manual for R5-09 Collars and R5-11 Socket Clamps installation instructions.

(C) All gaps created (e.g. between panels, between panel and deck, between panel and roof, etc.) must be less than 3-1/2" [89mm] or greater than 9" [229mm].

(D) An appropriate energy absorbing safety surface is required under and around all playground equipment. Loose fill protective surfacing is shown only as an example for the purpose of this assembly instruction. Other surfacing material may vary in thickness and/or compression depths. See free publication - The Handbook for Public Playground Safety, Publication #325 at [www.cpsc.gov](http://www.cpsc.gov) for the surfacing appropriate for the fall height of the equipment or consult your surfacing supply representative.

**FIGURE 1**  
Castle Panel Assembly

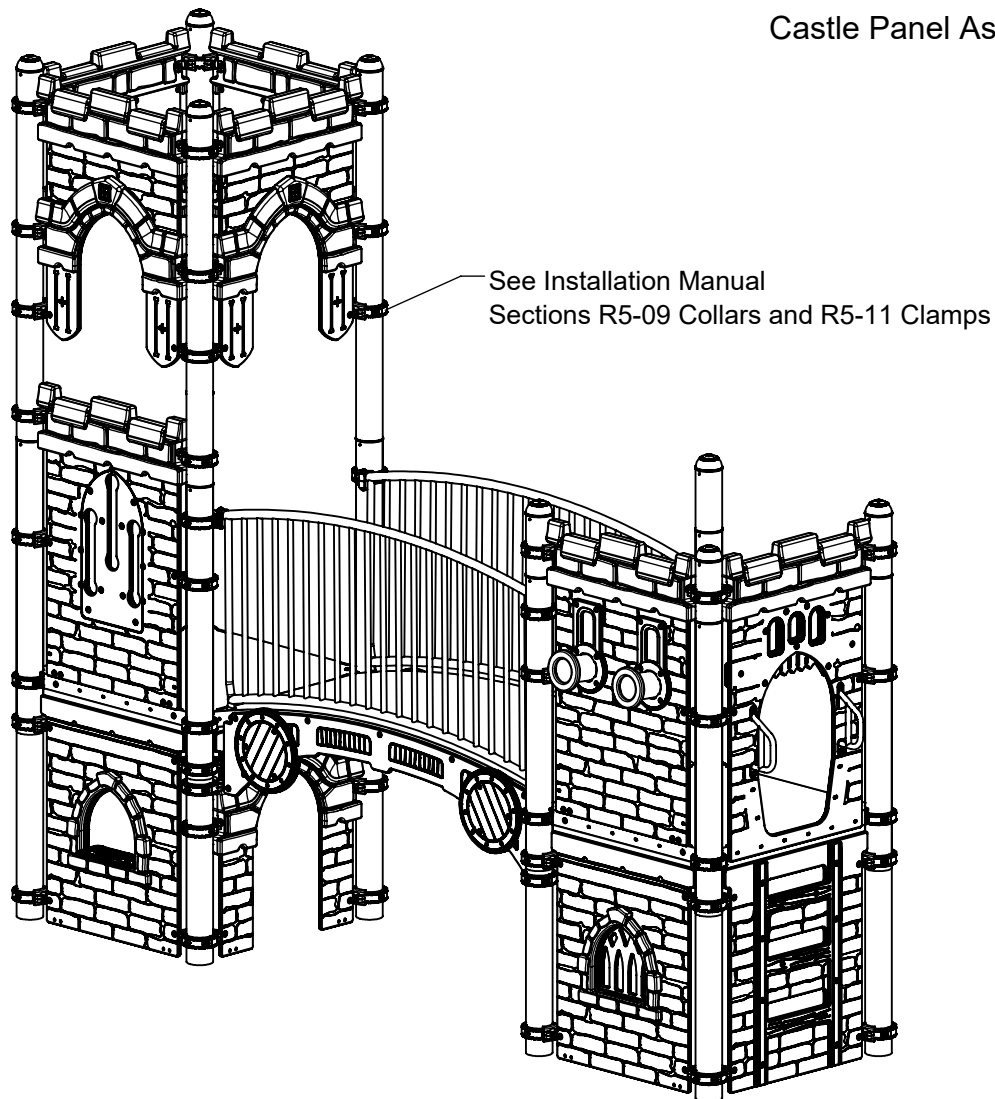

## Step 1

Locate and attach collars to posts at heights shown in Elevation View. (See Notes B & C)

\* Height shown from top of deck to top of collar.

\*\* Height shown from top of collar to top of collar.

\*\*\* Height shown from finish grade to top of collar.

### Elevation View

**Castle Panel 48" Ground Mount**

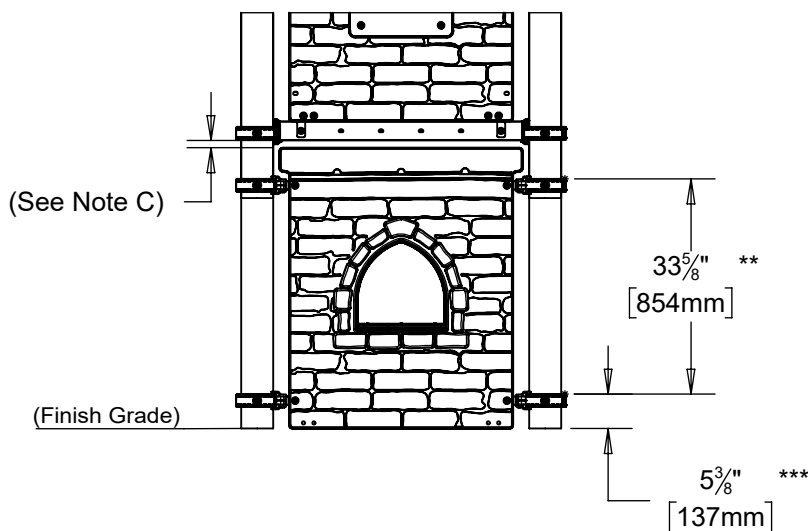

**Castle Panel 60" Deck Mount**

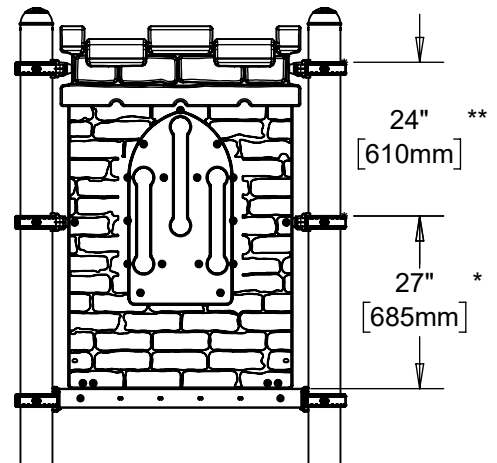

**Castle Panel with Arch  
48" Ground Mount**

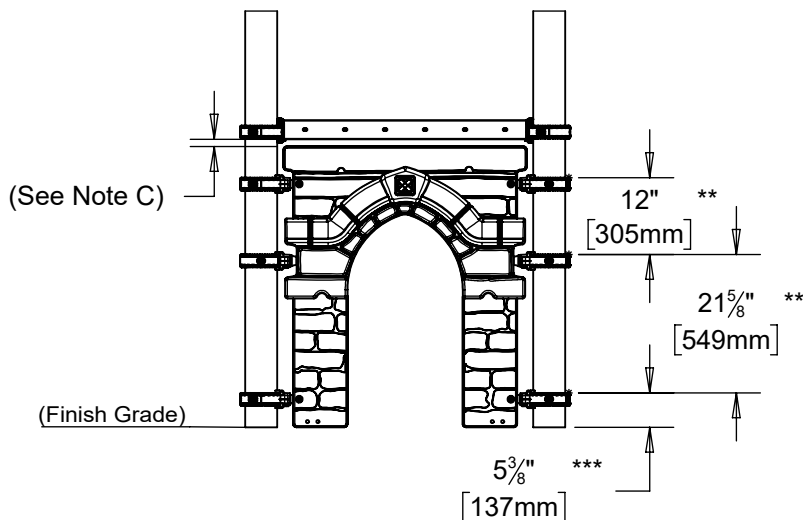

**Castle Panel 48" Deck Mount**

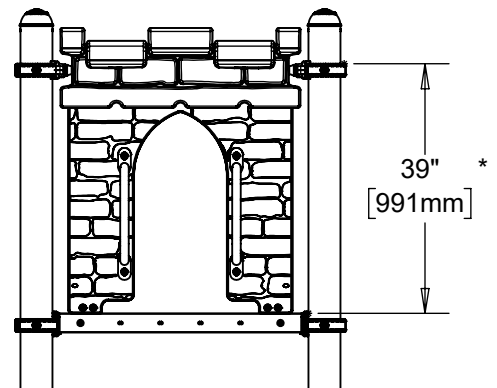

### ACCESS PANEL

## Step 1 (Factory Assembled) For 60" Panel Only

Attach Castle Access Trim to Castle Access Panel 60" as shown in Figure 2. (See Note A)

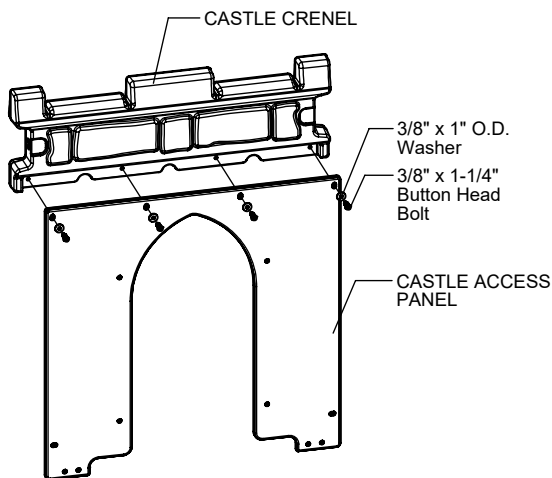

FIGURE 3

## Step 3

Attach Flat Panel Brackets to Castle Access Panel as shown in Figure 4. (See Note A)

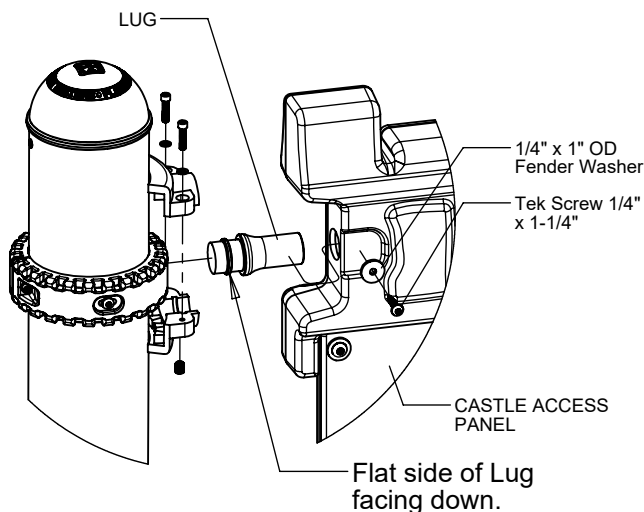

FIGURE 5

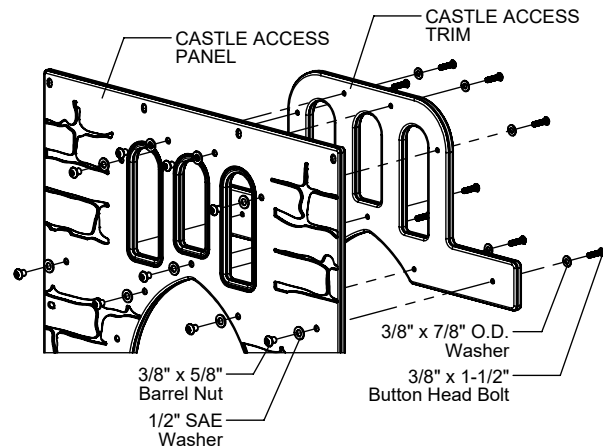

FIGURE 2

## Step 2 (Factory Assembled)

Attach Castle Crenel to Castle Access Panel as shown in Figure 3. (See Note A)

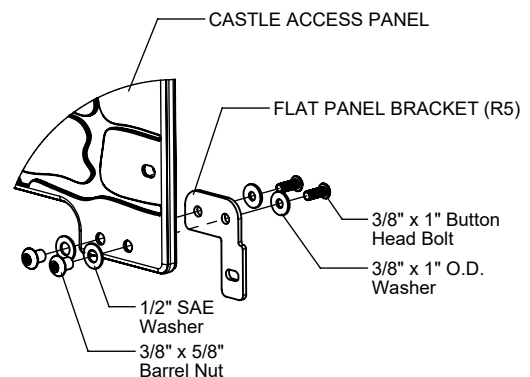

FIGURE 4

## Step 4

Attach Castle Access Panel to collars as shown in Figure 5. (See Notes A & B)

**NOTE:** Face flat side of the Lug down

## Step 4

### For 60" Panel Only

Attach Castle Access Panel to collars as shown in Figure 6. (See Notes A & B)

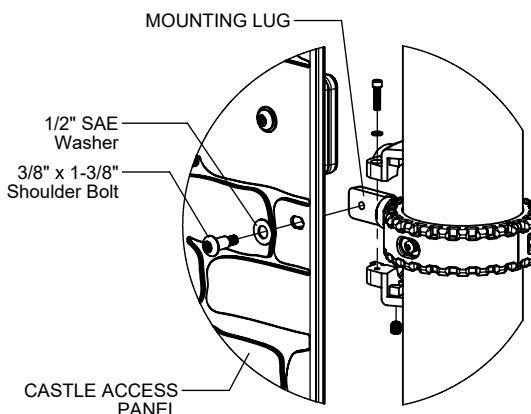

**FIGURE 6**

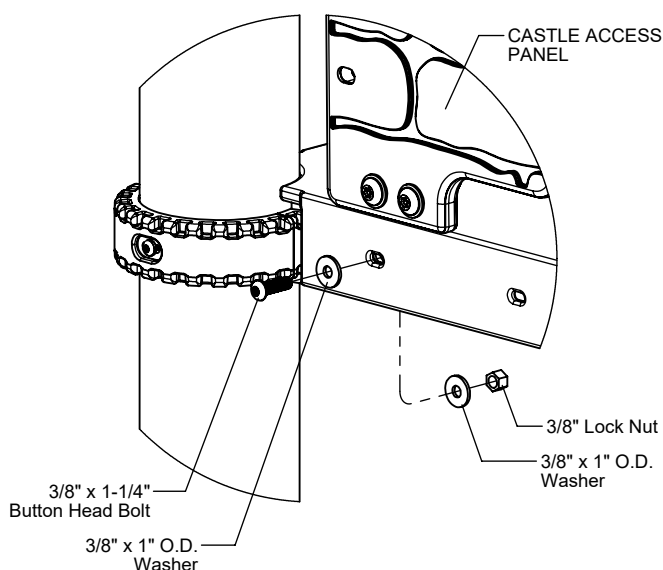

**FIGURE 7**

## Step 5

Attach Castle Access Panel to deck as shown in Figure 7. (See Note A)

## Step 6

Attach Vertical Rock Climber Handle to Castle Access Panel as shown in Figure 8. (See Note A)

## Step 7

Fully tighten all fasteners according to the "TIGHTENING TORQUE FOR HARDWARE" section of the Installation Manual.

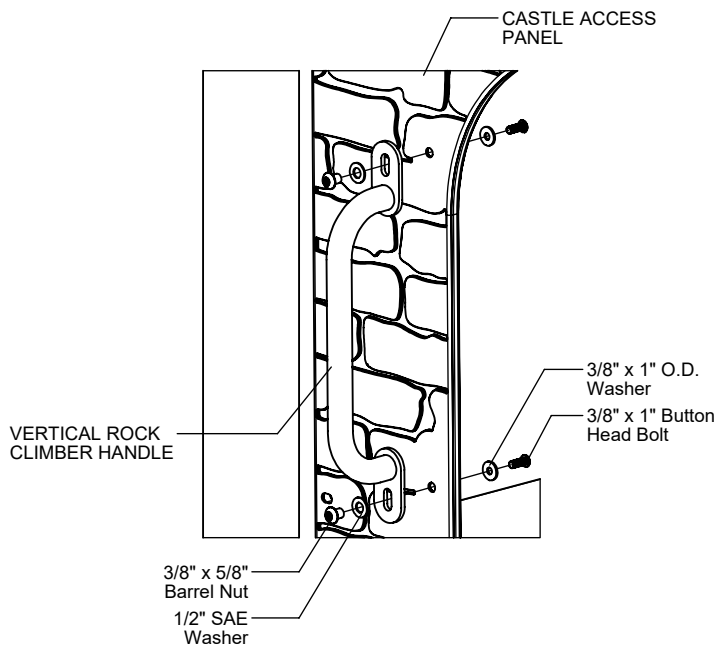

**FIGURE 8**

## ARCH BRIDGE

### Step 1

Locate and attach collars to posts at heights shown in Elevation View. Height shown from top of deck to top of collar. (See Note B)

Elevation View

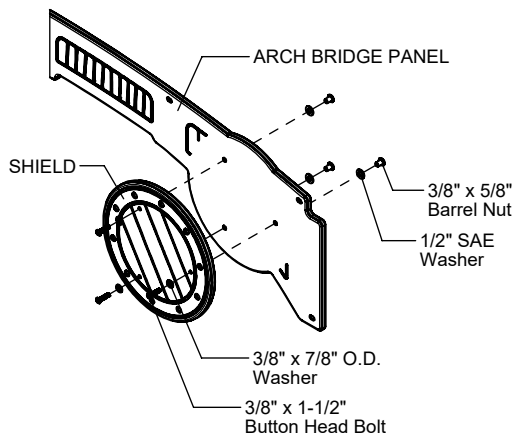
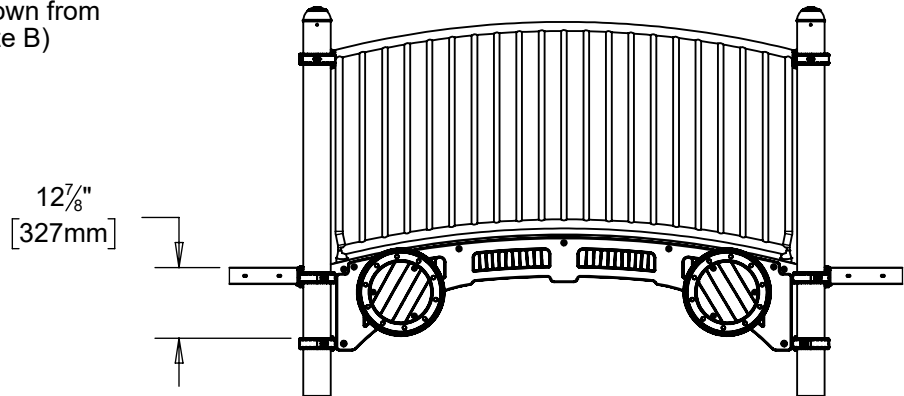

FIGURE 9

### Step 3

Attach Castle Tabs to Arch Bridge Panels as shown in Figure 10. (See Note A)

### Step 2 (Factory Assembled)

Attach Shields to Arch Bridge Panels as shown in Figure 9. (See Note A)

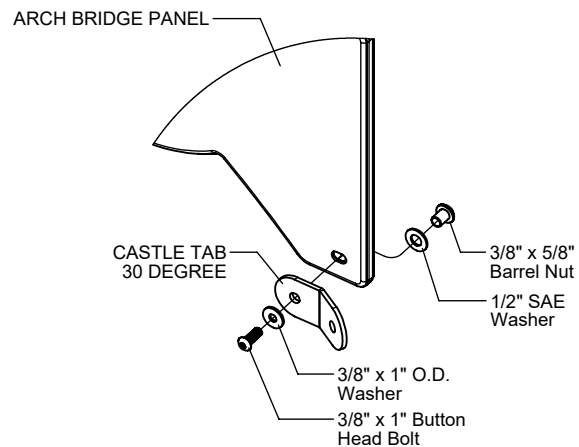
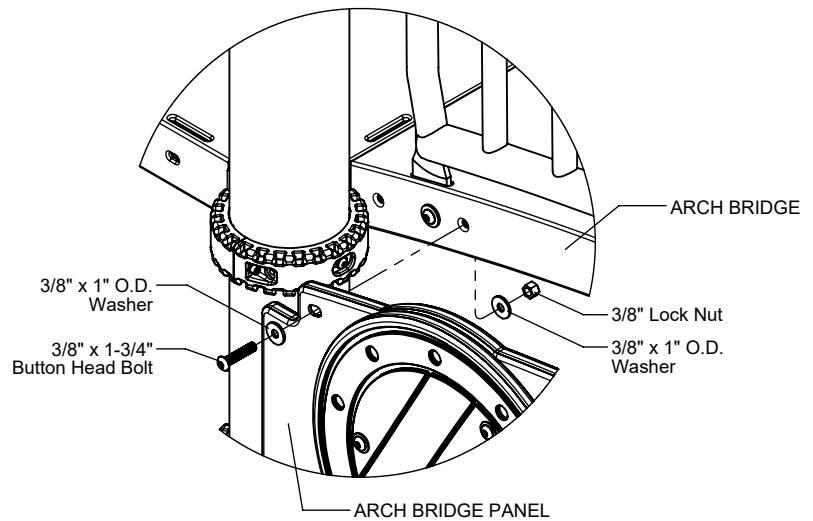

FIGURE 10

## Step 4

Attach Arch Bridge Panels to Arch Bridge as shown in Figure 11. (See Note A)



**FIGURE 11**

## Step 5

Attach Arch Bridge Panels to collars as shown in Figure 12. (See Notes A & B)

## Step 6

Fully tighten all fasteners according to the "TIGHTENING TORQUE FOR HARDWARE" section of the Installation Manual.

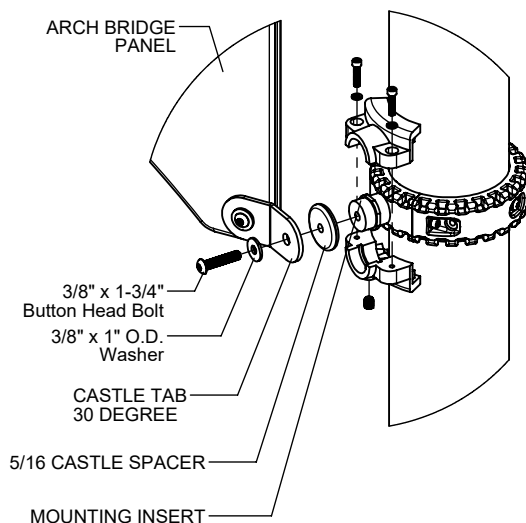

**FIGURE 12**

## ARCHERS WINDOW PANEL

### Step 1 (Factory Assembled)

Attach Trim to Archers Window Panel as shown in Figure 13. (See Note A)

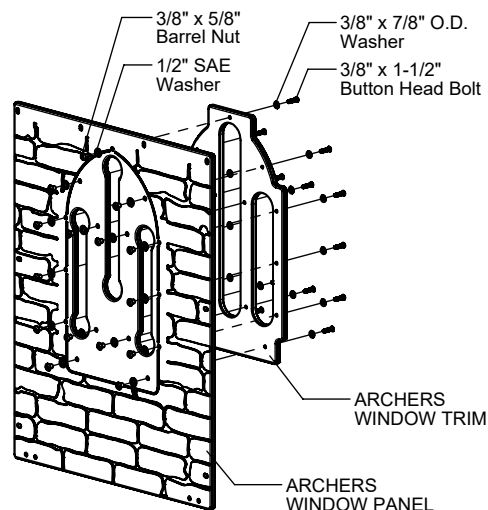

FIGURE 13

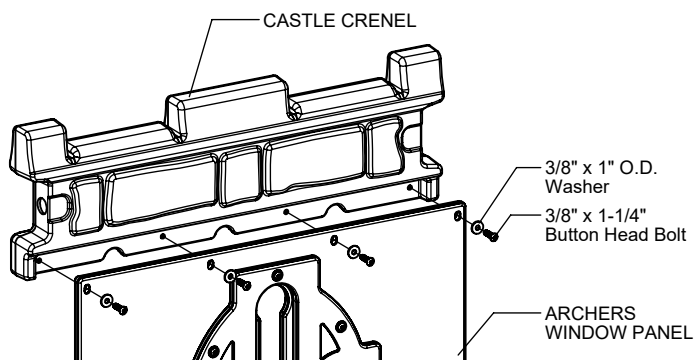

FIGURE 14

### Step 2 (Factory Assembled)

Attach Castle Crenel to Archers Window Panel as shown in Figure 14. (See Note A)

### Step 3

Attach Flat Panel Brackets to Archers Window Panel as shown in Figure 15. (See Note A)

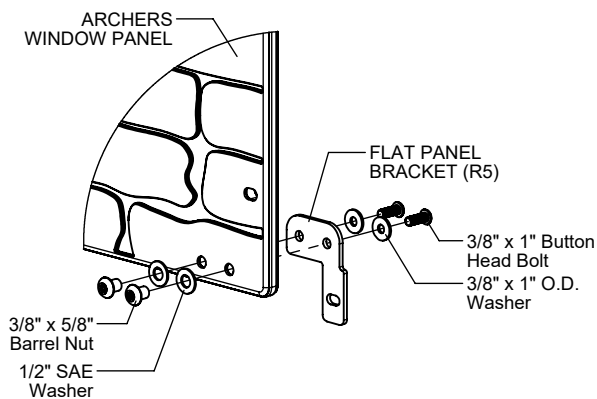
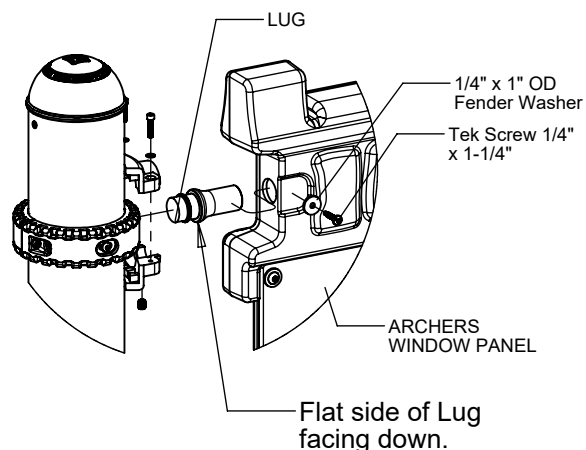

FIGURE 15

## Step 4

Attach Archers Window Panel to collars as shown in Figure 16. (See Notes A & B)

**NOTE:** Face flat side of the Lug down



**FIGURE 16**

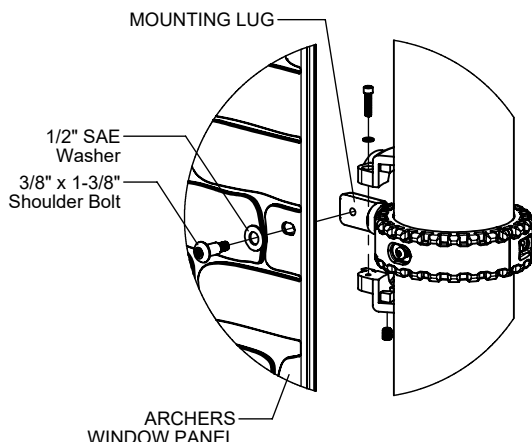

**FIGURE 17**

## Step 6

Attach Archers Window Panel to Deck as shown in Figure 18. (See Note A)

## Step 7

Fully tighten all fasteners according to the "TIGHTENING TORQUE FOR HARDWARE" section of the Installation Manual.

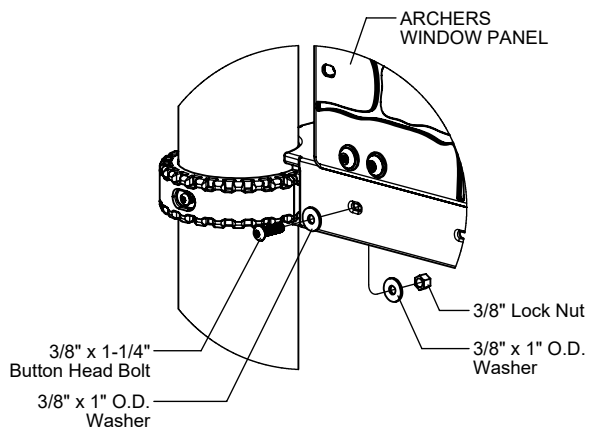

**FIGURE 18**



## CANNON PANEL

### Step 1 (Factory Assembled)

Attach Cannon Trim and Cannon Blocker to Cannon as shown in Figure 19. (See Note A)

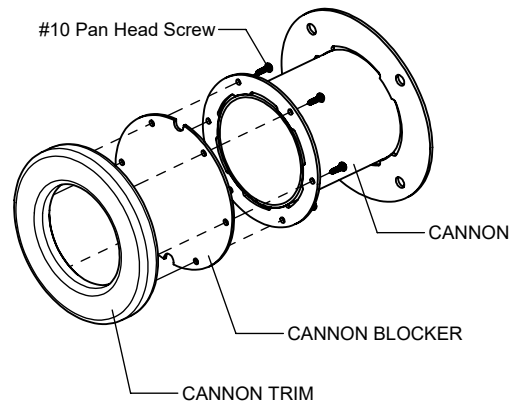

**FIGURE 19**

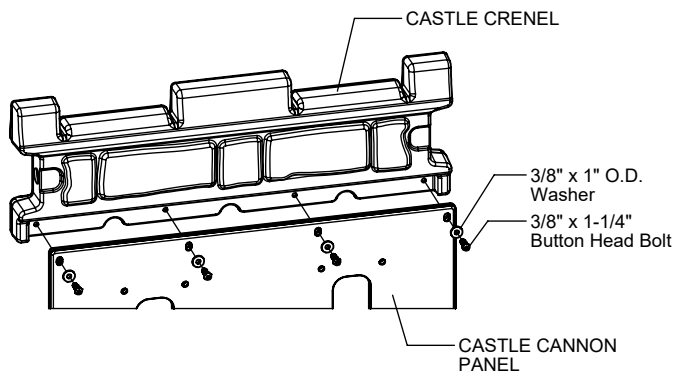

**FIGURE 20**

### Step 3 (Factory Assembled)

Attach Cannons, Cannon Panel Trim and Cannon Window Blockers to Castle Cannon Panel as shown in Figure 21. (See Note A)

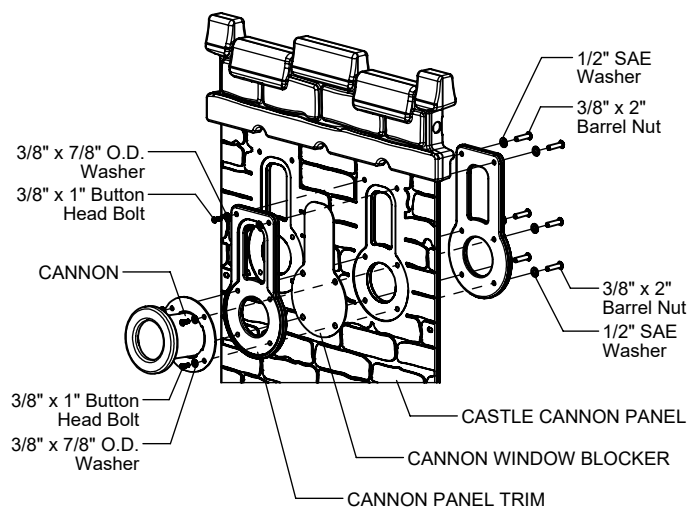

**FIGURE 21**

## Step 4

Attach Flat Panel Brackets to Castle Cannon Panel as shown in Figure 22. (See Note A)

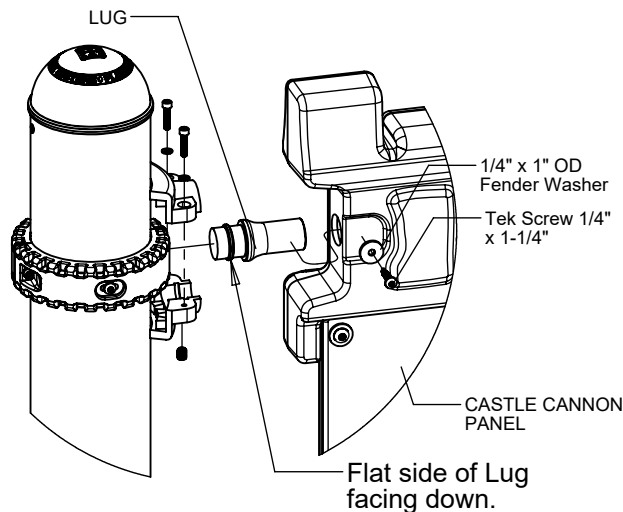

**FIGURE 22**

## Step 5

Attach Castle Cannon Panel to collars as shown in Figure 23. (See Notes A, B & C)

**NOTE:** Face flat side of the Lug down

**FIGURE 23**

## Step 6

### For 60" Panel Only

Attach Castle Cannon Panel to collars as shown in Figure 24. (See Notes A & B)

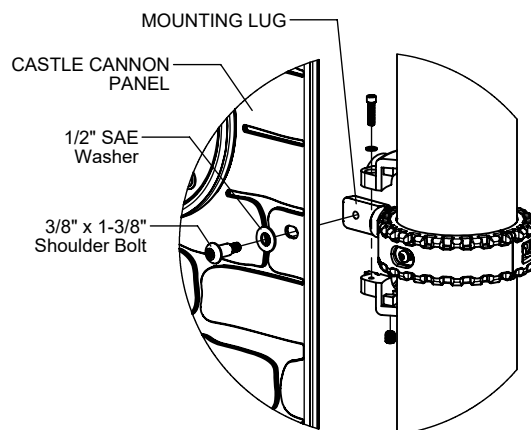

**FIGURE 24**

## Step 7

Attach Castle Cannon Panel to deck as shown in Figure 25. (See Note A)

## Step 8

Fully tighten all fasteners according to the "TIGHTENING TORQUE FOR HARDWARE" section of the Installation Manual.

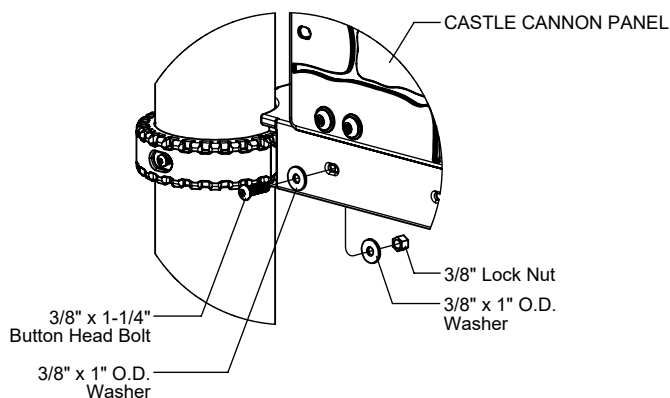
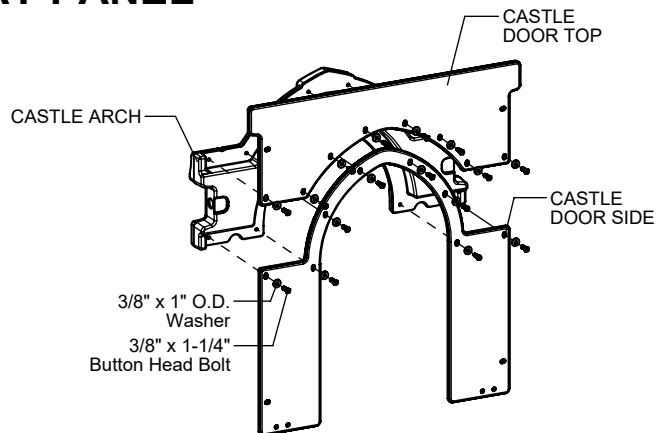

**FIGURE 25**

## DOORWAY PANEL

### Step 1 (Factory Assembled)

Attach Castle Arch to Castle Door Top and Side Panels as shown in Figure 26. (See Note A)



**FIGURE 26**

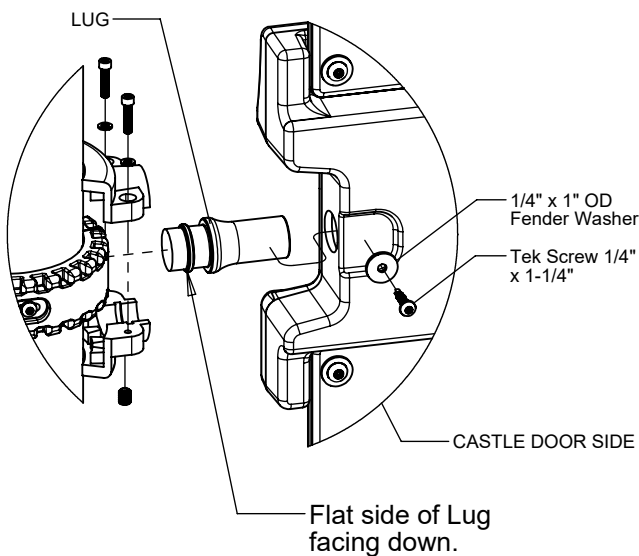

**FIGURE 27**

### Step 2

Attach Doorway Panel to collars as shown in Figure 27. (See Notes A, B & C)

**NOTE:** Face flat side of the Lug down

### Step 3

Attach Doorway Panel to collars as shown in Figure 28. (See Notes A, B & C)

### Step 4

Fully tighten all fasteners according to the "TIGHTENING TORQUE FOR HARDWARE" section of the Installation Manual.

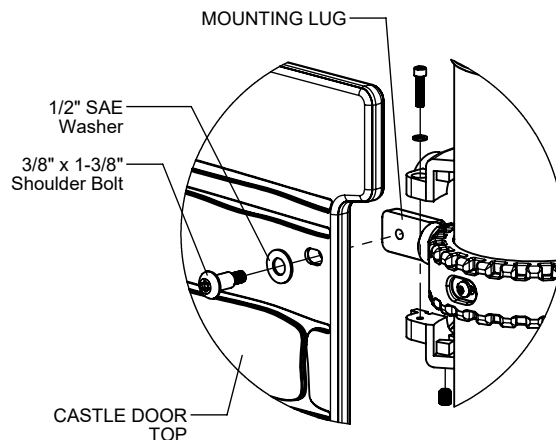
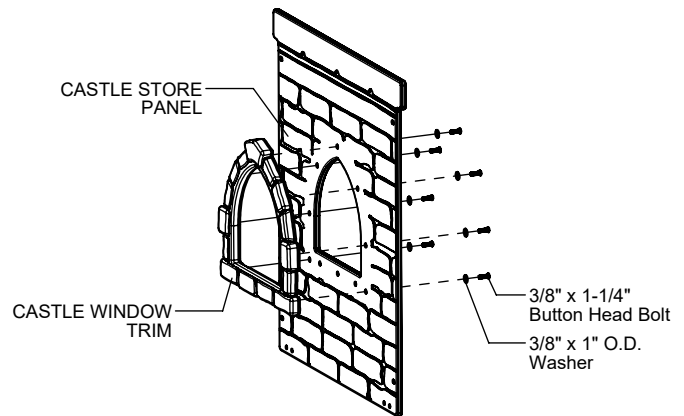

**FIGURE 28**

## STORE PANEL

### Step 1 (Factory Assembled)

Attach Castle Window Trim to Castle Store Panel as shown in Figure 29. (See Note A)



**FIGURE 29**

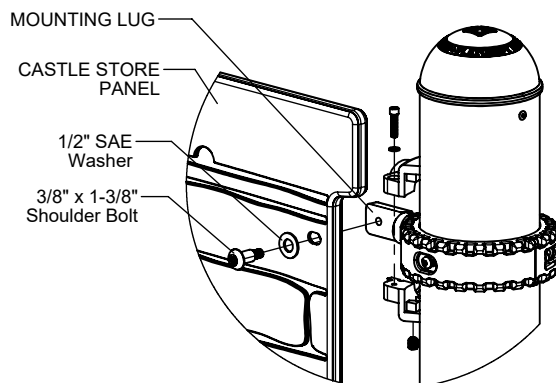

**FIGURE 30**

### Step 3

Attach Spring Rider Brackets to Castle Store Panel as shown in Figure 31. (See Note A)

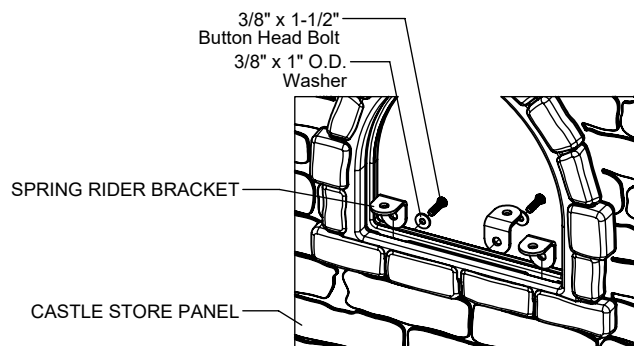

**FIGURE 31**

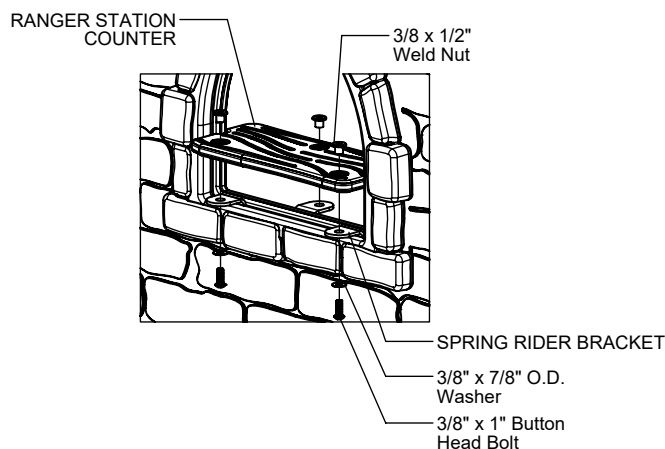

**FIGURE 32**

### Step 4

Attach Ranger Station Counter to Spring Rider Brackets as shown in Figure 32. (See Note A)

## TOWER BATTLEMENT

### Step 1

Locate and attach collars to posts at heights shown in Elevation View. Height shown from top of collar to top of collar. (See Notes B & C)

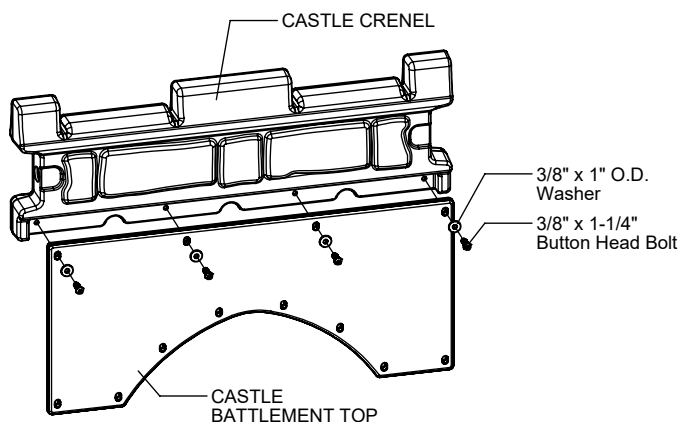
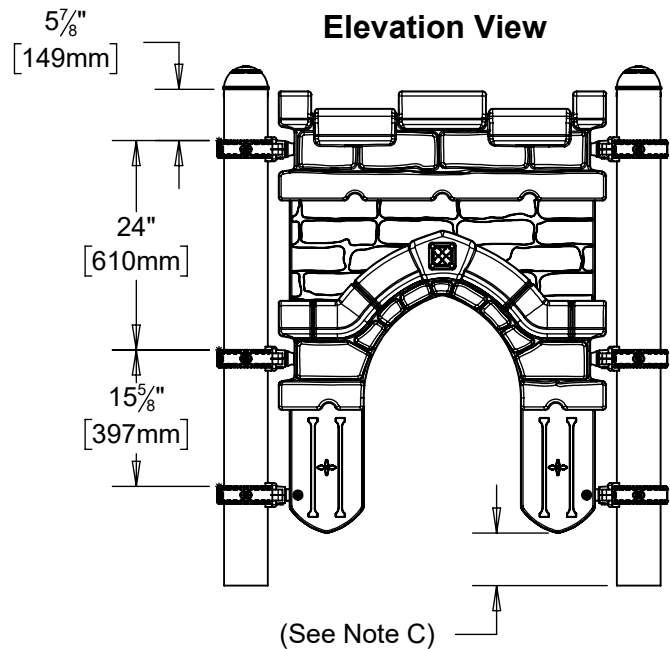

**FIGURE 33**

### Step 3 (Factory Assembled)

Attach Castle Arch to Castle Battlement top and Castle Tower Banners as shown in Figure 34. (See Note A)

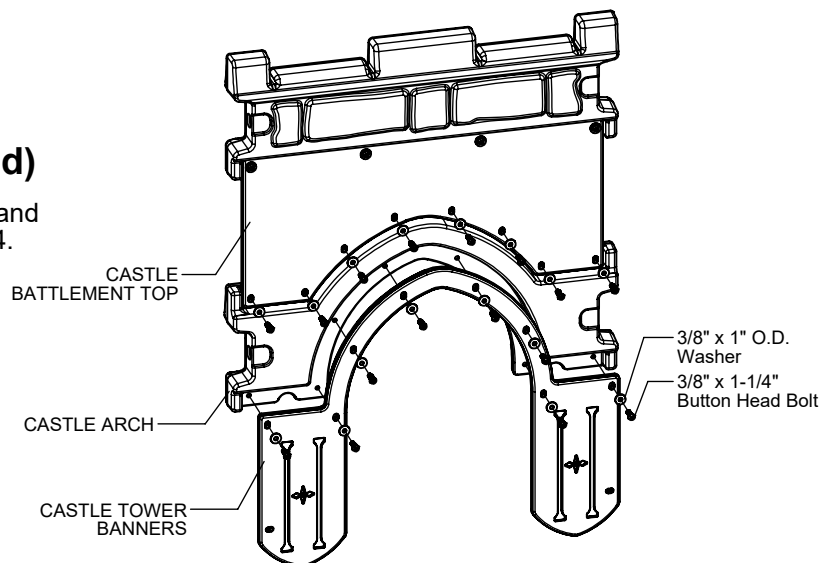
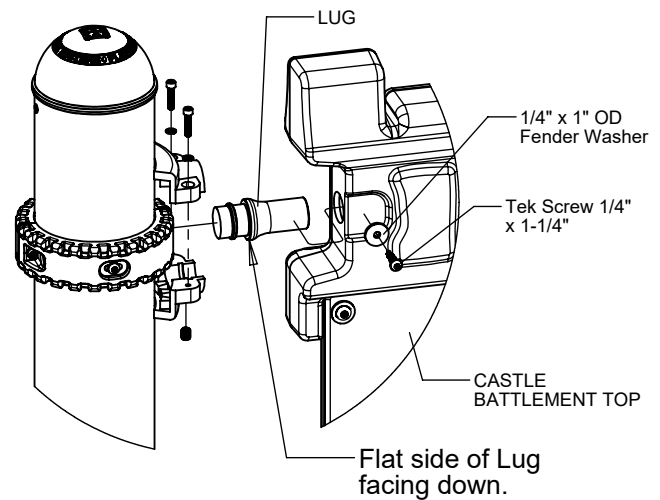

**FIGURE 34**

## Step 4

Attach Castle Battlement to collars as shown in Figure 35. (See Notes A, B & C)

**NOTE:** Face flat side of the Lug down



**FIGURE 35**

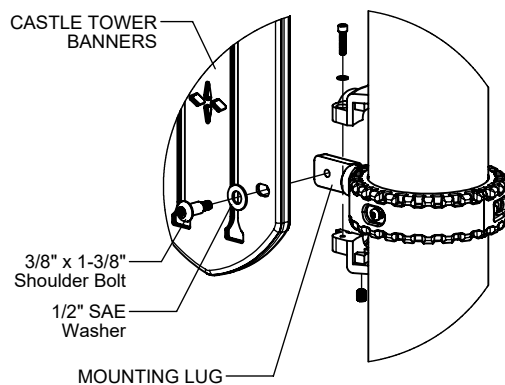

**FIGURE 36**

## Step 5

Attach Castle Tower Banners to collars as shown in Figure 36. (See Notes A, B & C)

## Step 6

Fully tighten all fasteners according to the "TIGHTENING TORQUE FOR HARDWARE" section of the Installation Manual.

## TWISTER ENTRY PANEL

### Step 1 (Factory Assembled)

Attach Twister Entry Panel Trim to Twister Entry Panel as shown in Figure 37. (See Note A)

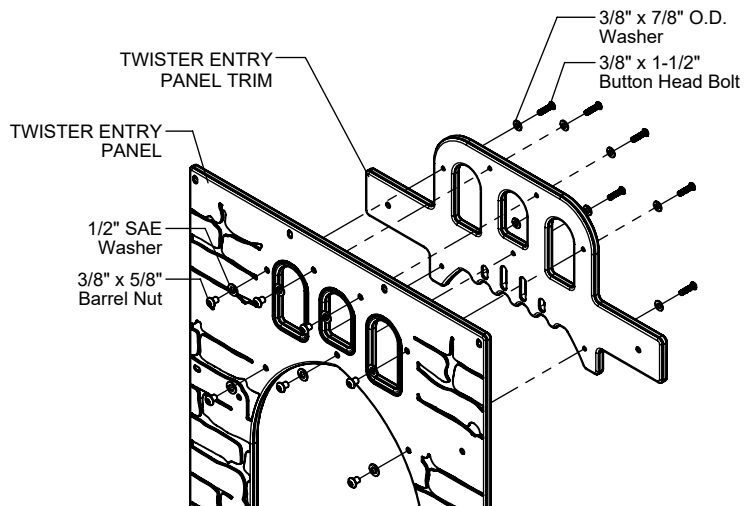

**FIGURE 37**

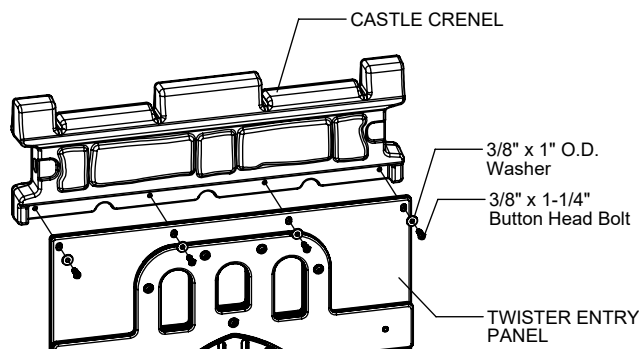

**FIGURE 38**

### Step 2 (Factory Assembled)

Attach Castle Crenel to Twister Entry Panel as shown in Figure 38. (See Note A)

### Step 3

Attach Twister Entry Panel to collars as shown in Figure 39. (See Notes A & B)

**NOTE:** Face flat side of the Lug down

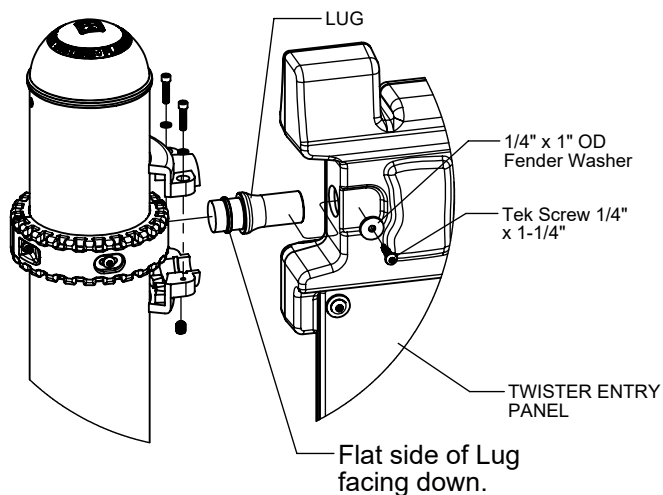

**FIGURE 39**

## Step 4

Attach Twister Entry Panel to collars as shown in Figure 37. (See Notes A & B)

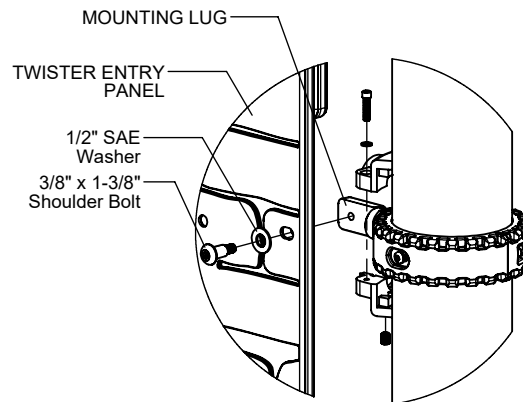

**FIGURE 37**

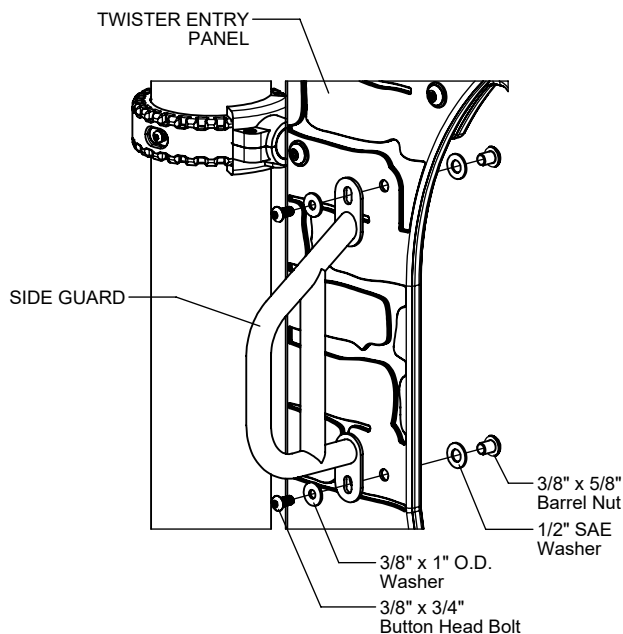

**FIGURE 38**

## Step 6

Attach Sit Down Panel Handle Single to Twister Entry Panel as shown in Figure 39. (See Note A)

## Step 7

Fully tighten all fasteners according to the "TIGHTENING TORQUE FOR HARDWARE" section of the Installation Manual.

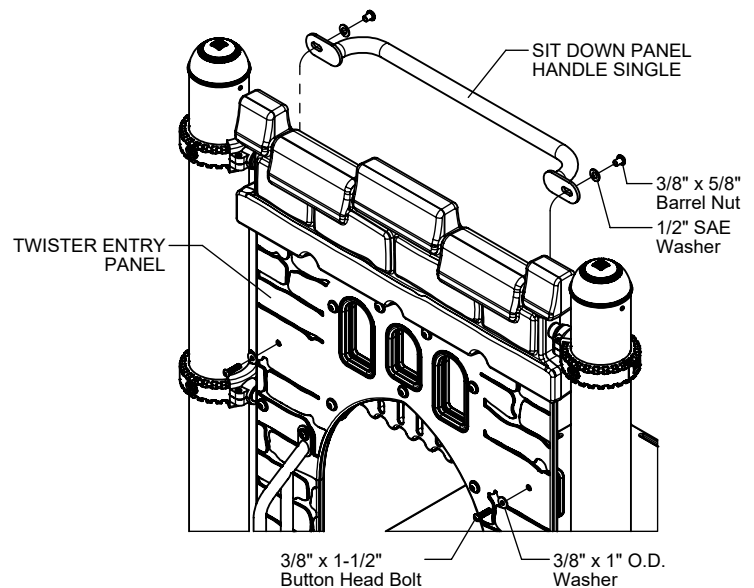

**FIGURE 39**



## WINDOW PANEL

### Step 1 (Factory Assembled)

Attach Castle Window Trim and Window Frame to Castle Store Panel as shown in Figure 40.  
(See Note A)

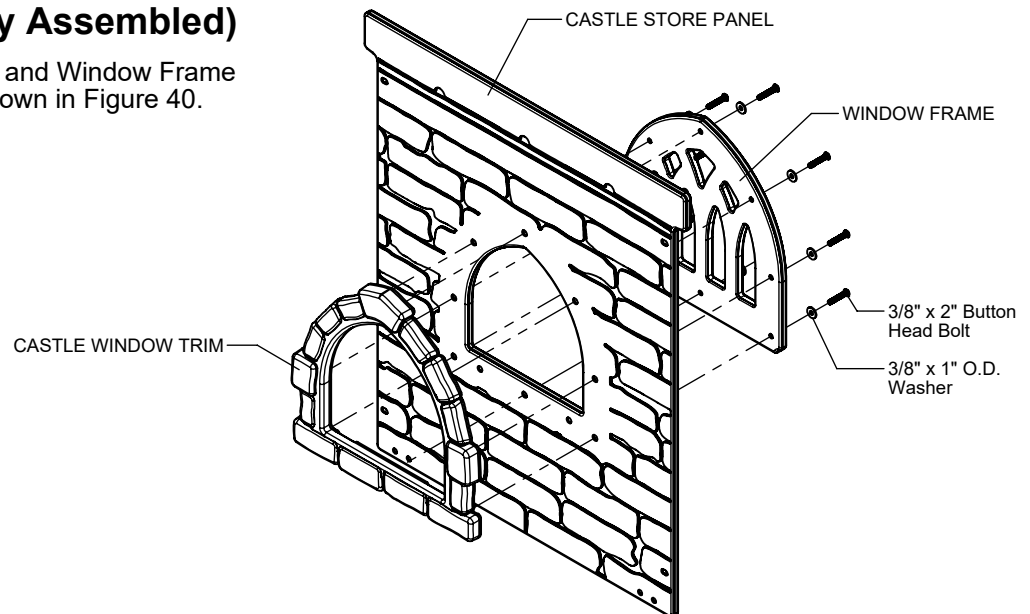

**FIGURE 40**

### Step 2

Attach Castle Store Panel to collars as shown in Figure 41. (See Notes A, B & C)

### Step 3

Fully tighten all fasteners according to the "TIGHTENING TORQUE FOR HARDWARE" section of the Installation Manual.

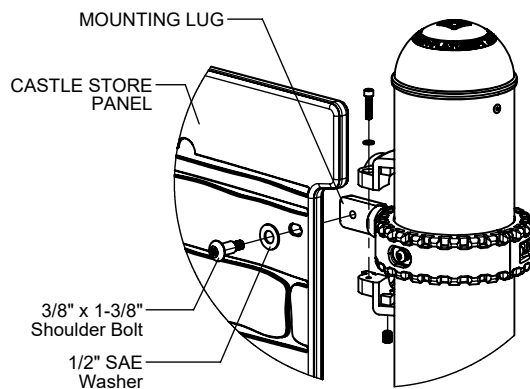
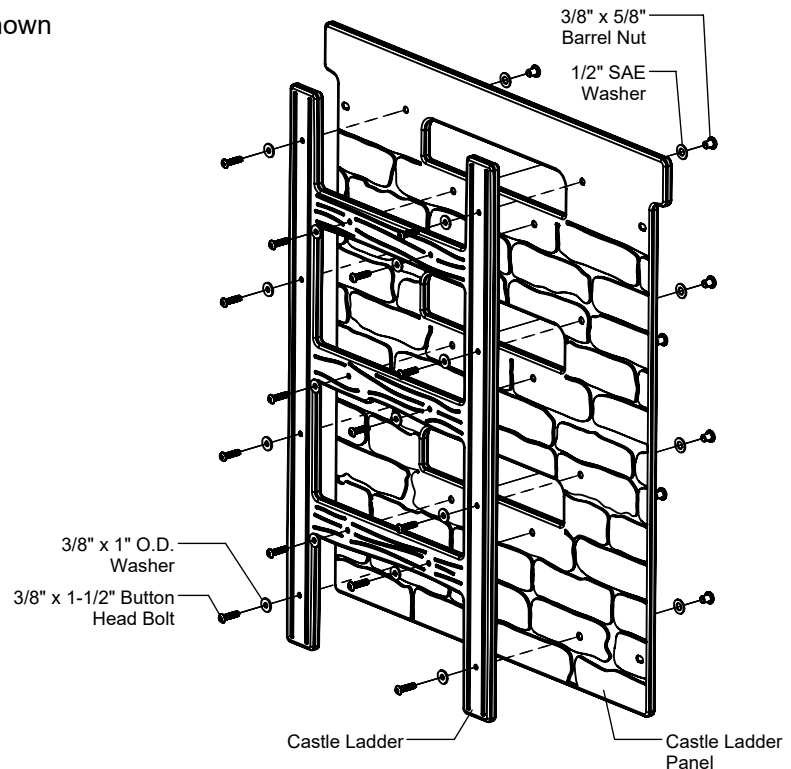

**FIGURE 41**

## CASTLE LADDER PANEL

### Step 1 (Factory Assembled)

Attach Ladder to Castle Ladder Panel as shown in Figure 42. (See Note A)



**FIGURE 42**

### Step 2

Attach Castle Ladder Panel to collars as shown in Figure 41. (See Notes A, B & C)

### Step 3

Fully tighten all fasteners according to the "TIGHTENING TORQUE FOR HARDWARE" section of the Installation Manual.

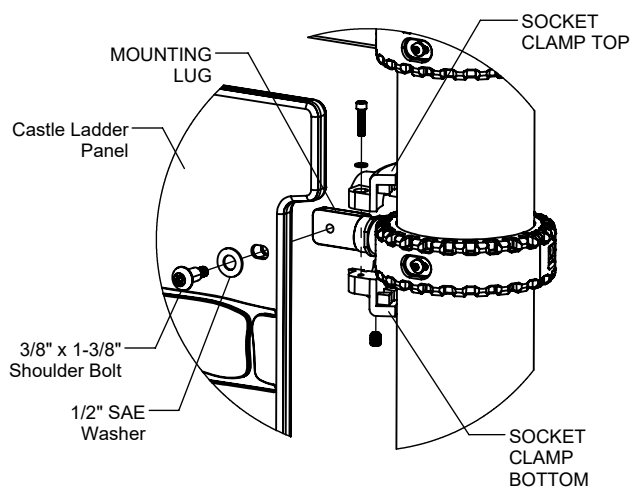

**FIGURE 43**

# CASTLE PANEL ASSEMBLY INSTALLATION INSTRUCTIONS

**R5-16211**  
Page 19 of 22

## Access Panel

PARTS LIST		
Part #	DESCRIPTION	QTY.
AF-7118	Flat Panel Bracket (R5)	2
FS-1237	Vertical Rock Climber Handle	2
HS-1001-R5	Socket Clamp Set R5	2
IE-0029	Roto Panel Lug	2
9103052-TR	Bolt Button Head 3/8" x 1"	8
9103062-TR	Bolt Button Head 3/8" x 1-1/4"	2
9271062-TR	1/4" x 1-1/4" Tek Screw	2
9321052-THK	Washer Fender 1/4" x 1" OD x .125" thk	2
9333002	Washer Flat 3/8" x 1" O.D. x .100" thick	12
9345002	Washer Flat SAE 1/2"	8
9413002	Nut Lock 3/8"	2
9443022-TR	Nut Barrel 3/8" x 5/8" BH	8

ASSEMBLED PARTS LIST		
Part #	DESCRIPTION	QTY.
DF-0005	Castle Crenel R5	1
EF-0294	Castle Access Crenel Panel R5	1
9103062-TR	Bolt Button Head 3/8" x 1-1/4"	4
9333002	Washer Flat 3/8" x 1" O.D. x .100" thick	4

## Access Panel 60"

PARTS LIST		
Part #	DESCRIPTION	QTY.
AF-7118	Flat Panel Bracket (R5)	2
FS-1237	Vertical Rock Climber Handle	2
GF-7007	Mounting Lug R5	2
HS-1001-R5	Socket Clamp Set R5	4
IE-0029	Roto Panel Lug	2
9103052-TR	Bolt Button Head 3/8" x 1"	8
9103062-TR	Bolt Button Head 3/8" x 1-1/4"	2
9143062-TR	Bolt Shoulder 3/8" x 1-3/8" BH	2
9271062-TR	1/4" x 1-1/4" Tek Screw	2
9321052-THK	Washer Fender 1/4" x 1" OD x .125" thk	2
9333002	Washer Flat 3/8" x 1" O.D. x .100" thick	12
9345002	Washer Flat SAE 1/2"	10
9413002	Nut Lock 3/8"	2
9443022-TR	Nut Barrel 3/8" x 5/8" BH	8

ASSEMBLED PARTS LIST		
Part #	DESCRIPTION	QTY.
EF-0417	Castle Access Crenel Panel 60" R5	1
EF-0417-T	Castle Access 60" Trim	1
9103062-TR	Bolt Button Head 3/8" x 1-1/4"	4
9103072-TR	Bolt Button Head 3/8" x 1-1/2"	9
9333002	Washer Flat 3/8" x 1" O.D. x .100" thick	4
9333042	Washer Flat 3/8" x 7/8" O.D.	9
9345002	Washer Flat SAE 1/2"	9
9443022-TR	Nut Barrel 3/8" x 5/8" BH	9
DF-0005	Castle Crenel R5	1

## Arch Bridge

PARTS LIST		
Part #	DESCRIPTION	QTY.
BE-7036-B30	Castle Tab 30 Degree	4
EE-7149-SPCR	Castle Panel Arch Bridge Spacer	4
GE-7015	Mounting Insert	4
HS-1001-R5	Socket Clamp Set R5	4
9103052-TR	Bolt Button Head 3/8" x 1"	4
9103082-TR	Bolt Button Head 3/8" x 1-3/4"	14
9333002	Washer Flat 3/8" x 1" O.D. x .100" thick	28
9345002	Washer Flat SAE 1/2"	4
9413002	Nut Lock 3/8"	10
9443022-TR	Nut Barrel 3/8" x 5/8" BH	4

ASSEMBLED PARTS LIST		
Part #	DESCRIPTION	QTY.
EE-0370	Castle Banded Shield	4
EF-0296	Castle Arch Bridge Panel	2
9103072-TR	Bolt Button Head 3/8" x 1-1/2"	12
9333042	Washer Flat 3/8" x 7/8" O.D.	12
9345002	Washer Flat SAE 1/2"	12
9443022-TR	Nut Barrel 3/8" x 5/8" BH	12

## Castle Ladder Panel

PARTS LIST		
Part #	DESCRIPTION	QTY.
GF-7007	Mounting Lug R5	4
HS-1001-R5	Socket Clamp Set R5	4
9143062-TR	Bolt Shoulder 3/8" x 1-3/8" BH	4
9345002	Washer Flat SAE 1/2"	4

ASSEMBLED PARTS LIST		
Part #	DESCRIPTION	QTY.
EE-0450	Castle Ground to Deck Ladder 48"	1
EF-0411	Castle Ground to Deck Panel 48" R5	1
9103072-TR	Bolt Button Head 3/8" x 1-1/2"	14
9333002	Washer Flat 3/8" x 1" O.D. x .100" thick	14
9345002	Washer Flat SAE 1/2"	14
9443022-TR	Nut Barrel 3/8" x 5/8" BH	14



www.playcraftsystems.com  
For Customer Service Call  
800.333.8519 (U.S.A.) or 541.955.9199 (International)

**Rev B**  
2/6/2020

# CASTLE PANEL ASSEMBLY INSTALLATION INSTRUCTIONS

**R5-16211**  
Page 20 of 22

## Archers Window 60"

PARTS LIST		
Part #	DESCRIPTION	QTY.
AF-7118	Flat Panel Bracket (R5)	2
GF-7007	Mounting Lug R5	2
HS-1001-R5	Socket Clamp Set R5	4
IE-0029	Roto Panel Lug	2
9103052-TR	Bolt Button Head 3/8" x 1"	4
9103062-TR	Bolt Button Head 3/8" x 1-1/4"	2
9143062-TR	Bolt Shoulder 3/8" x 1-3/8" BH	2
9271062-TR	1/4" x 1-1/4" Tek Screw	2
9321052-THK	Washer Fender 1/4" x 1" OD x .125" thk	2
9333002	Washer Flat 3/8" x 1" O.D. x .100" thick	8
9345002	Washer Flat SAE 1/2"	6
9413002	Nut Lock 3/8"	2
9443022-TR	Nut Barrel 3/8" x 5/8" BH	4

ASSEMBLED PARTS LIST		
Part #	DESCRIPTION	QTY.
EF-0412-T	Castle Archer Window Trim	1
EF-0421	Castle Archers Window Crenel Panel 60" R5	1
9103062-TR	Bolt Button Head 3/8" x 1-1/4"	4
9103072-TR	Bolt Button Head 3/8" x 1-1/2"	15
9333002	Washer Flat 3/8" x 1" O.D. x .100" thick	4
9333042	Washer Flat 3/8" x 7/8" O.D.	15
9345002	Washer Flat SAE 1/2"	15
9443022-TR	Nut Barrel 3/8" x 5/8" BH	15
DF-0005	Castle Crenel R5	1

## Doorway Panel

PARTS LIST		
Part #	DESCRIPTION	QTY.
GF-7007	Mounting Lug R5	4
HS-1001-R5	Socket Clamp Set R5	6
IE-0029	Roto Panel Lug	2
9143062-TR	Bolt Shoulder 3/8" x 1-3/8" BH	4
9271062-TR	1/4" x 1-1/4" Tek Screw	2
9321052-THK	Washer Fender 1/4" x 1" OD x .125" thk	2
9345002	Washer Flat SAE 1/2"	4

ASSEMBLED PARTS LIST		
Part #	DESCRIPTION	QTY.
DF-0007	Castle Arch Trim R5	1
EF-0416	Castle Door Side R5	1
EF-0419	Castle Door Top R5	1
9103062-TR	Bolt Button Head 3/8" x 1-1/4"	16
9333002	Washer Flat 3/8" x 1" O.D. x .100" thick	16

## Cannon Panel

PARTS LIST		
Part #	DESCRIPTION	QTY.
AF-7118	Flat Panel Bracket (R5)	2
GF-7007	Mounting Lug R5	2
HS-1001-R5	Socket Clamp Set R5	4
IE-0029	Roto Panel Lug	2
9103052-TR	Bolt Button Head 3/8" x 1"	4
9103062-TR	Bolt Button Head 3/8" x 1-1/4"	2
9143062-TR	Bolt Shoulder 3/8" x 1-3/8" BH	2
9271062-TR	1/4" x 1-1/4" Tek Screw	2
9321052-THK	Washer Fender 1/4" x 1" OD x .125" thk	2
9333002	Washer Flat 3/8" x 1" O.D. x .100" thick	8
9345002	Washer Flat SAE 1/2"	6
9413002	Nut Lock 3/8"	2
9443022-TR	Nut Barrel 3/8" x 5/8" BH	4

ASSEMBLED PARTS LIST		
Part #	DESCRIPTION	QTY.
EE-0358	Panel Cannon Trim	2
EE-0358-B	Panel Cannon Blocker	2
EF-0264-B	Cannon Panel Window Blocker	2
EF-0264-T	Ship Cannon Panel Trim	4
EF-0418	Castle Cannon Crenel Panel 60" R5	1
FS-16461-CAN	Panel Cannon	2
9103052-TR	Bolt Button Head 3/8" x 1"	12
9103062-TR	Bolt Button Head 3/8" x 1-1/4"	4
9251032	Screw SQ #10x3/4 DR PH SMS SS	12
9333002	Washer Flat 3/8" x 1" O.D. x .100" thick	4
9333042	Washer Flat 3/8" x 7/8" O.D.	12
9345002	Washer Flat SAE 1/2"	12
9443092-TR	Nut Barrel 3/8" x 2" BH	12
DF-0005	Castle Crenel R5	1



www.playcraftsystems.com  
For Customer Service Call  
800.333.8519 (U.S.A.) or 541.955.9199 (International)

**Rev B**  
2/6/2020

# CASTLE PANEL ASSEMBLY INSTALLATION INSTRUCTIONS

**R5-16211**  
Page 21 of 22

## Store Panel

PARTS LIST		
Part #	DESCRIPTION	QTY.
BE-4466	Spring Rider Bracket	3
EF-0094	Tree House Ranger Station Counter	1
GF-7007	Mounting Lug R5	4
HS-1001-R5	Socket Clamp Set R5	4
9103052-TR	Bolt Button Head 3/8" x 1"	3
9103072-TR	Bolt Button Head 3/8" x 1-1/2"	3
9143062-TR	Bolt Shoulder 3/8" x 1-3/8" BH	4
9333002	Washer Flat 3/8" x 1" O.D. x .100" thick	3
9333042	Washer Flat 3/8" x 7/8" O.D.	3
9345002	Washer Flat SAE 1/2"	4
9493012	3/8 x 1/2" Weld Nut	3

ASSEMBLED PARTS LIST		
Part #	DESCRIPTION	QTY.
DE-0056	Castle Window Trim	1
EF-0300	Castle Store Panel R5	1
9103062-TR	Bolt Button Head 3/8" x 1-1/4"	7
9333002	Washer Flat 3/8" x 1" O.D. x .100" thick	7

## Tower Battlement

PARTS LIST		
Part #	DESCRIPTION	QTY.
GF-7007	Mounting Lug R5	2
HS-1001-R5	Socket Clamp Set R5	6
IE-0029	Roto Panel Lug	4
9143062-TR	Bolt Shoulder 3/8" x 1-3/8" BH	2
9271062-TR	1/4" x 1-1/4" Tek Screw	4
9321052-THK	Washer Fender 1/4" x 1" OD x .125" thk	4
9345002	Washer Flat SAE 1/2"	2

ASSEMBLED PARTS LIST		
Part #	DESCRIPTION	QTY.
DF-0005	Castle Crenel R5	1
DF-0007	Castle Arch Trim R5	1
EF-0295	Castle Tower Banners R5	1
EF-0301	Castle Battlement Top R5	1
9103062-TR	Bolt Button Head 3/8" x 1-1/4"	20
9333002	Washer Flat 3/8" x 1" O.D. x .100" thick	20

## Twister Entry

PARTS LIST		
Part #	DESCRIPTION	QTY.
FS-1316-CAN	Twister Sit Down Side Guard Canada	2
FS-1321	Sit Down Panel Handle Single	1
GF-7007	Mounting Lug R5	2
HS-1001-R5	Socket Clamp Set R5	4
IE-0029	Roto Panel Lug	2
9103032-TR	Bolt Button Head 3/8" x 3/4"	4
9103072-TR	Bolt Button Head 3/8" x 1-1/2"	2
9143062-TR	Bolt Shoulder 3/8" x 1-3/8" BH	2
9271062-TR	1/4" x 1-1/4" Tek Screw	2
9321052-THK	Washer Fender 1/4" x 1" OD x .125" thk	2
9333002	Washer Flat 3/8" x 1" O.D. x .100" thick	6
9345002	Washer Flat SAE 1/2"	8
9443022-TR	Nut Barrel 3/8" x 5/8" BH	6

ASSEMBLED PARTS LIST		
Part #	DESCRIPTION	QTY.
DF-0005	Castle Crenel R5	1
EF-0304	Castle Twister Entry Crenel Panel 60" R5	1
EF-0304-T	Castle Twister Entry Panel Trim	1
9103062-TR	Bolt Button Head 3/8" x 1-1/4"	4
9103072-TR	Bolt Button Head 3/8" x 1-1/2"	7
9333002	Washer Flat 3/8" x 1" O.D. x .100" thick	4
9333042	Washer Flat 3/8" x 7/8" O.D.	7
9345002	Washer Flat SAE 1/2"	7
9443022-TR	Nut Barrel 3/8" x 5/8" BH	7

## Window Panel

PARTS LIST		
Part #	DESCRIPTION	QTY.
GF-7007	Mounting Lug R5	4
HS-1001-R5	Socket Clamp Set R5	4
9143062-TR	Bolt Shoulder 3/8" x 1-3/8" BH	4
9345002	Washer Flat SAE 1/2"	4

ASSEMBLED PARTS LIST		
Part #	DESCRIPTION	QTY.
DE-0056	Castle Window Trim	1
EE-0454	Castle Window Frame	1
EF-0300	Castle Store Panel R5	1
9103092-TR	Bolt Button Head 3/8" x 2"	8
9333002	Washer Flat 3/8" x 1" O.D. x .100" thick	8



www.playcraftsystems.com  
For Customer Service Call  
800.333.8519 (U.S.A.) or 541.955.9199 (International)

**Rev B**  
2/6/2020

## Specifications

### **CASTLE ARCH TRIM, CRENEL & WINDOW TRIM:**

Shall be constructed of UV-stabilized, rotationally molded, linear, low density polyethylene with an average wall thickness of .250".

### **CASTLE PANELS & TRIM:**

Shall be made from high density 3/4" sheet plastic specially formulated for optimum UV stability and color retention.

### **CASTLE TAB & SPRING RIDER BRACKET:**

Shall be precision cut and formed from 3/16" thick sheet steel. The Castle Tab & Spring Rider Bracket shall have a multi-stage baked-on powder coat finish.

### **FLAT PANEL BRACKET:**

Shall be precision cut from 3/16" thick sheet steel. The Flat Panel Bracket shall have a multi-stage baked-on powder coat finish.

### **PANEL CANNON:**

Shall be fabricated using 5" O.D. 11 gauge steel tubing with welded 10 gauge steel mounting plates. The Panel Cannon shall have a multi-stage baked-on powder coat finish.

### **ROTO PANEL LUG:**

Shall be machined from high-strength aluminum alloy. The Roto Panel Lug shall have a multi-stage baked-on powder coat finish.

### **SIT DOWN PANEL HANDLE SINGLE:**

Shall be fabricated using 1.315" O.D. 12 gauge steel tubing with welded 1/4" thick steel mounting plates. The Sit Down Panel Handle Single shall have a multi-stage baked-on powder coat finish.

### **TWISTER SIT DOWN SIDE GUARD:**

Shall be fabricated using 1.029" O.D. 14 gauge steel tubing with welded 10 gauge steel mounting tabs. The Twister Sit Down Side Guard shall have a multi-stage baked-on powder coat finish.

### **VERTICAL ROCK CLIMBER HANDLE:**

Shall be fabricated using 1.029" O.D. 14 gauge steel tubing with welded 1/4" thick steel mounting plates. The Vertical Rock Climber Handle shall have a multi-stage baked-on powder coat finish.

### **MOUNTING LUGS:**

Shall be precision die-cast from a high-strength aluminum alloy. The Mounting Lugs have a multi-stage baked-on powder coat finish.

### **HARDWARE:**

Shall be stainless steel, zinc/nickel plated or galvanized as required to resist rust and corrosion.

## Maintenance

Periodically tighten all screws, bolts and nuts. A periodic inspection of all parts is necessary. If a part is broken or worn, replace immediately. For general maintenance please refer to our Playground Maintenance Manual.