

R50F38DFA
TOP VIEW - 0

ADA ACCESSIBILITY GUIDELINES - ADAAG CONFORMANCE

ELEVATED	ACCESSIBLE	RAMP ACCESSIBLE	GROUND	TYPES
28	17/7	12/7	29/9	5/5
CHILD CAPACITY	332	MAX FALL HEIGHT	156	

R5

FOR KIDS
AGES
5-12

GENERAL NOTES

This conceptual plan is based on information provided prior to construction. Detailed site information, including the following, should be obtained, evaluated, and utilized in the final project design. Exact site dimensions, topography, existing utilities, soil conditions and drainage solutions.

WARNING: Accessible safety surfacing material is required beneath and around this equipment that has a critical height value (Fall Height) appropriate for the highest accessible part of this equipment. Refer to the CPSC'S Handbook For Public Playground Safety, Section 4: Surfacing.

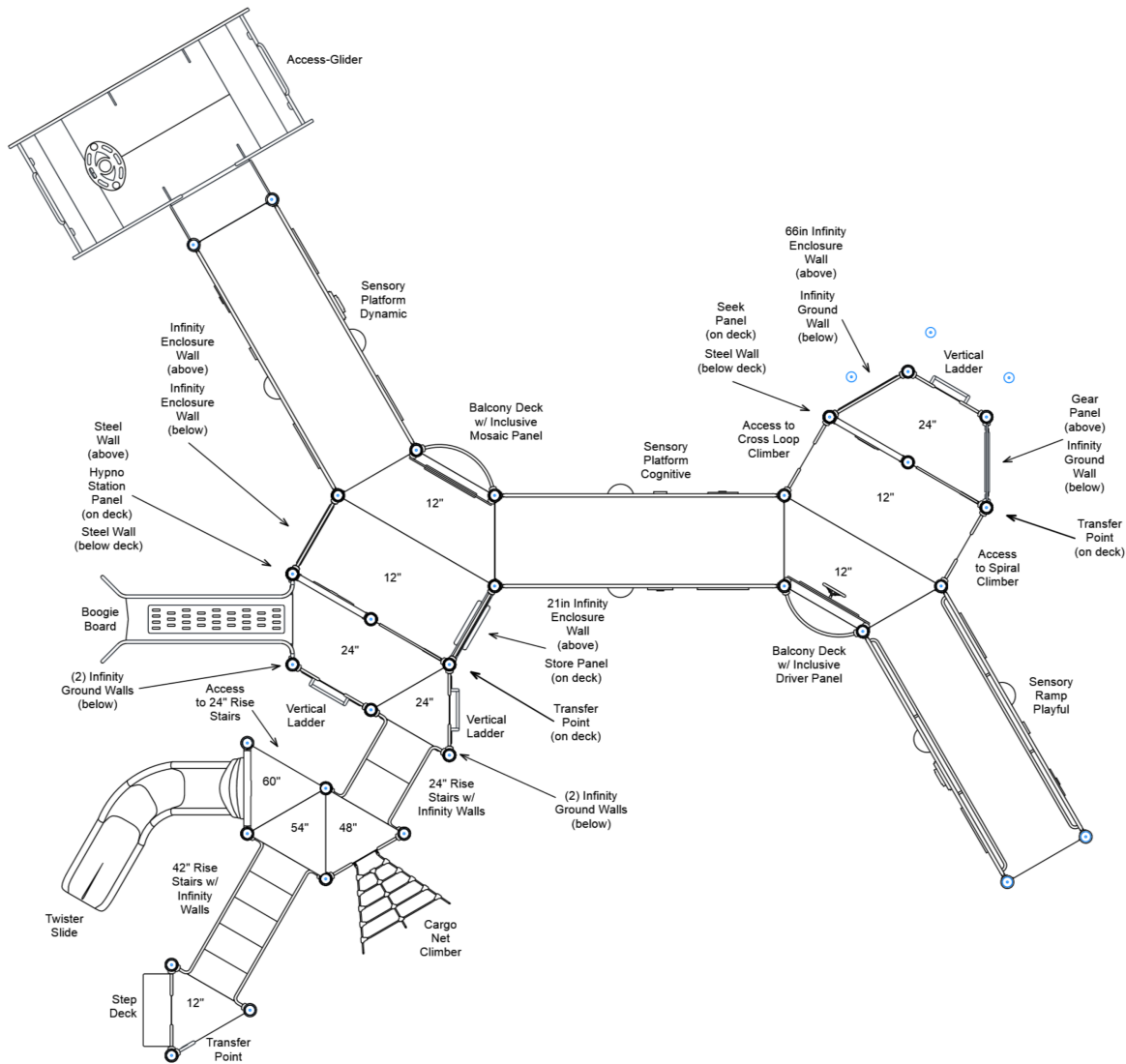

STRUCTURE # R50F38DFA
PROJECT # R50F38DFA
DATE 1/15/2026

Playcraft Systems
MIN. USE ZONE 69' x 56' (20.796m x 16.909m)



R50F38DFA
TOP VIEW - 1

ADA ACCESSIBILITY GUIDELINES - ADAAG CONFORMANCE

ELEVATED	ACCESSIBLE	RAMP ACCESSIBLE	GROUND	TYPES
28	17/7	12/7	29/9	5/5
CHILD CAPACITY	332	MAX FALL HEIGHT	156	

R5

FOR KIDS
AGES
5-12

GENERAL NOTES

This conceptual plan is based on information provided prior to construction. Detailed site information, including the following, should be obtained, evaluated, and utilized in the final project design. Exact site dimensions, topography, existing utilities, soil conditions and drainage solutions.

WARNING: Accessible safety surfacing material is required beneath and around this equipment that has a critical height value (Fall Height) appropriate for the highest accessible part of this equipment. Refer to the CPSC'S Handbook For Public Playground Safety, Section 4: Surfacing.

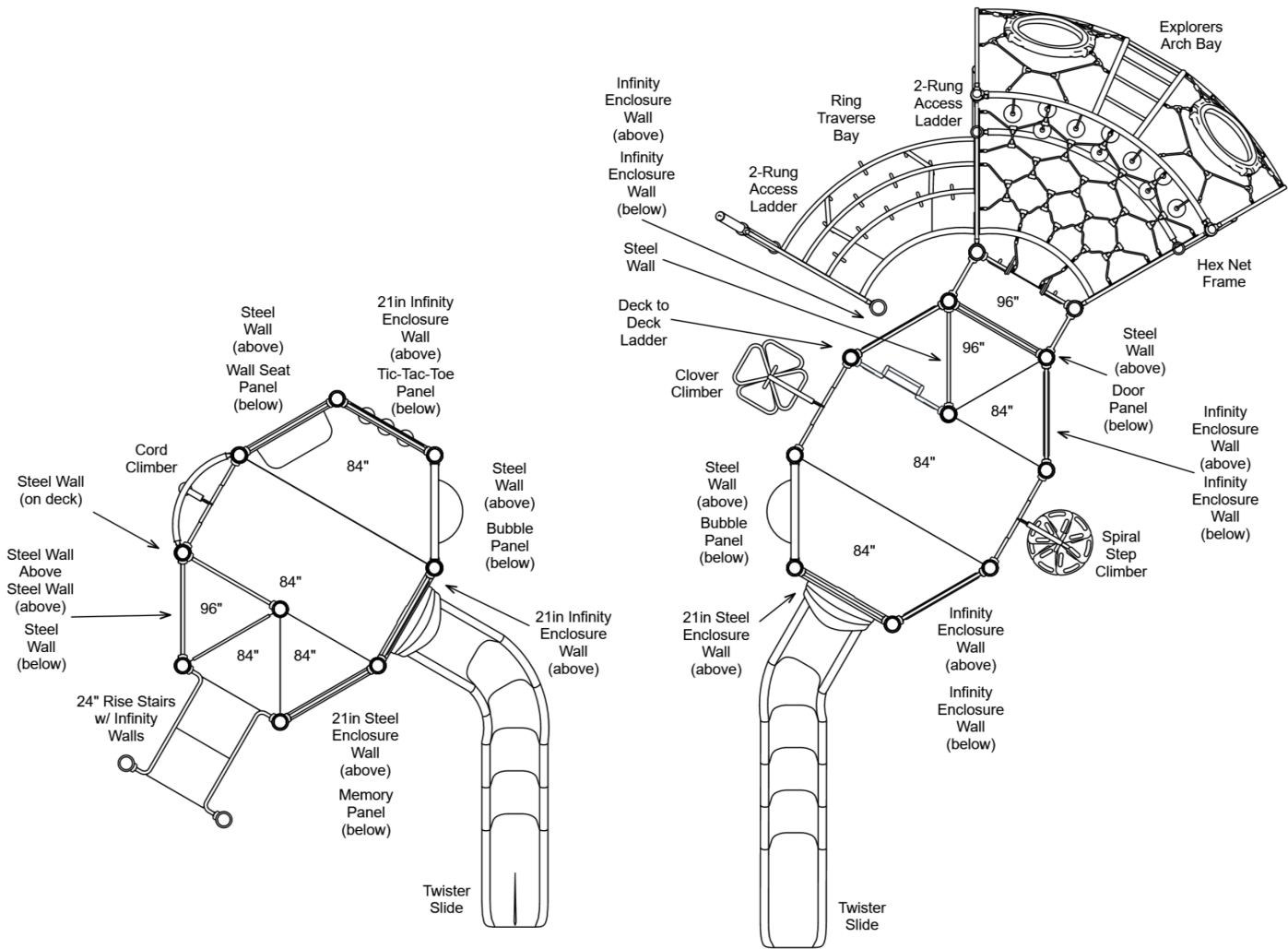

STRUCTURE # R50F38DFA
PROJECT # R50F38DFA
DATE 1/15/2026

Playcraft Systems
MIN. USE ZONE 69' x 56' (20.796m x 16.909m)



R50F38DFA
TOP VIEW - 2

ADA ACCESSIBILITY GUIDELINES - ADAAG CONFORMANCE

ELEVATED	ACCESSIBLE	RAMP ACCESSIBLE	GROUND	TYPES
28	17/7	12/7	29/9	5/5
CHILD CAPACITY	332	MAX FALL HEIGHT	156	

R5

FOR KIDS
AGES
5-12

GENERAL NOTES

This conceptual plan is based on information provided prior to construction. Detailed site information, including the following, should be obtained, evaluated, and utilized in the final project design. Exact site dimensions, topography, existing utilities, soil conditions and drainage solutions.

WARNING: Accessible safety surfacing material is required beneath and around this equipment that has a critical height value (Fall Height) appropriate for the highest accessible part of this equipment. Refer to the CPSC'S Handbook For Public Playground Safety, Section 4: Surfacing.

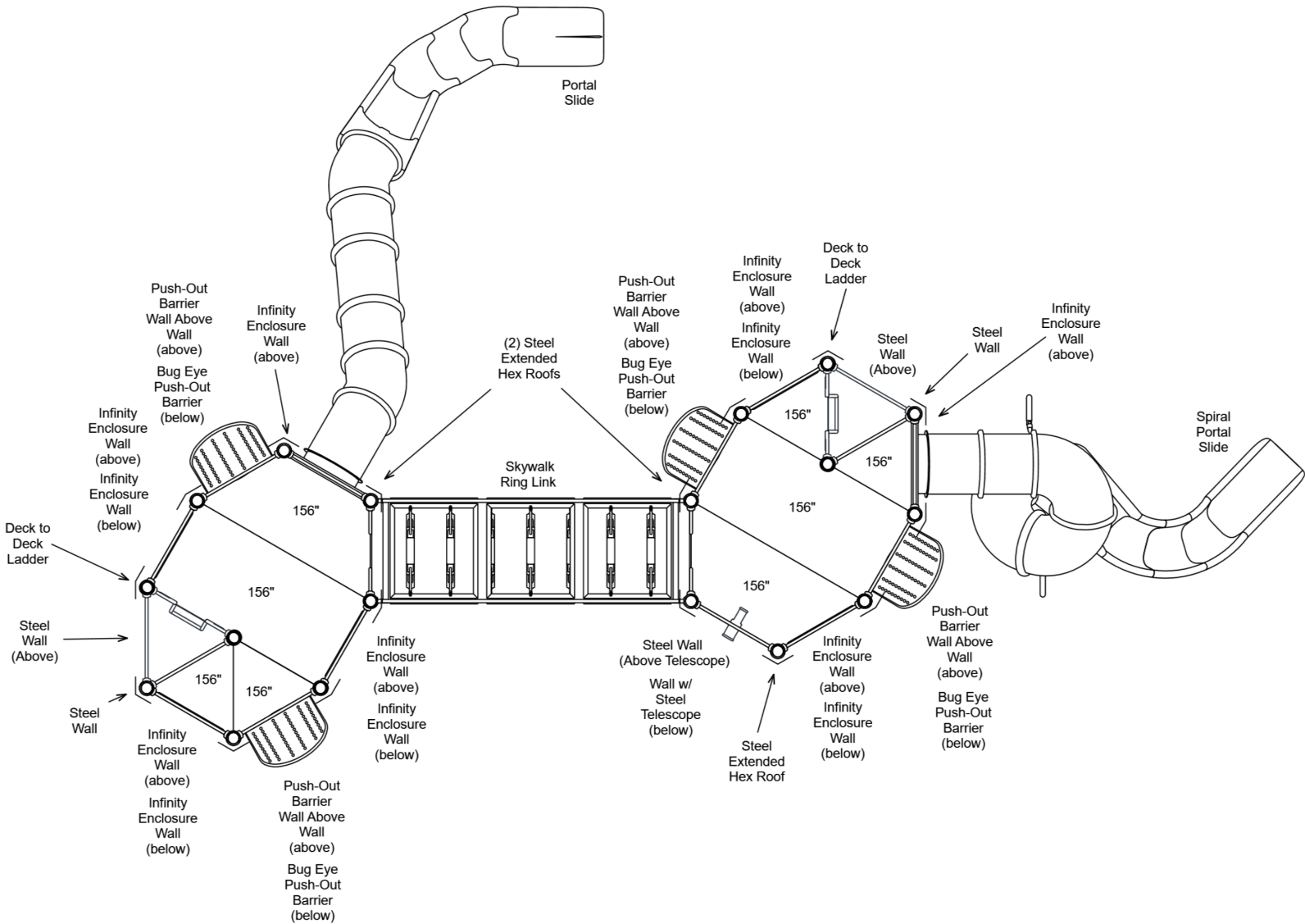

STRUCTURE # R50F38DFA
PROJECT # R50F38DFA
DATE 1/15/2026

Playcraft Systems
MIN. USE ZONE 69' x 56' (20.796m x 16.909m)



R50F38DFA SITE PLAN

ADA ACCESSIBILITY GUIDELINES - ADAAG CONFORMANCE

ELEVATED	ACCESSIBLE	RAMP ACCESSIBLE	GROUND	TYPES
28	17/7	12/7	29/9	5/5

R5

FOR KIDS
AGES
5-12

GENERAL NOTES

This Preliminary Site Plan is based on measurements that were provided in the initial planning phase. All dimensions must be verified prior to the submission of a purchase order. Playcraft Systems will not be held responsible for any discrepancies between actual dimensions and dimensions submitted in the planning phase.

The Minimum Use Zone for a play structure is based on the product design at the time of proposal. Components and structure designs may be subject to change which may affect dimensions. Therefore, before preparing the site, we strongly recommend obtaining final drawings from the factory (available after the order is placed and included in the Assembly Manual).

WARNING: Accessible safety surfacing material is required beneath and around this equipment that has a critical height value (Fall Height) appropriate for the highest accessible part of this equipment. Refer to the CPSC'S Handbook For Public Playground Safety, Section 4: Surfacing.

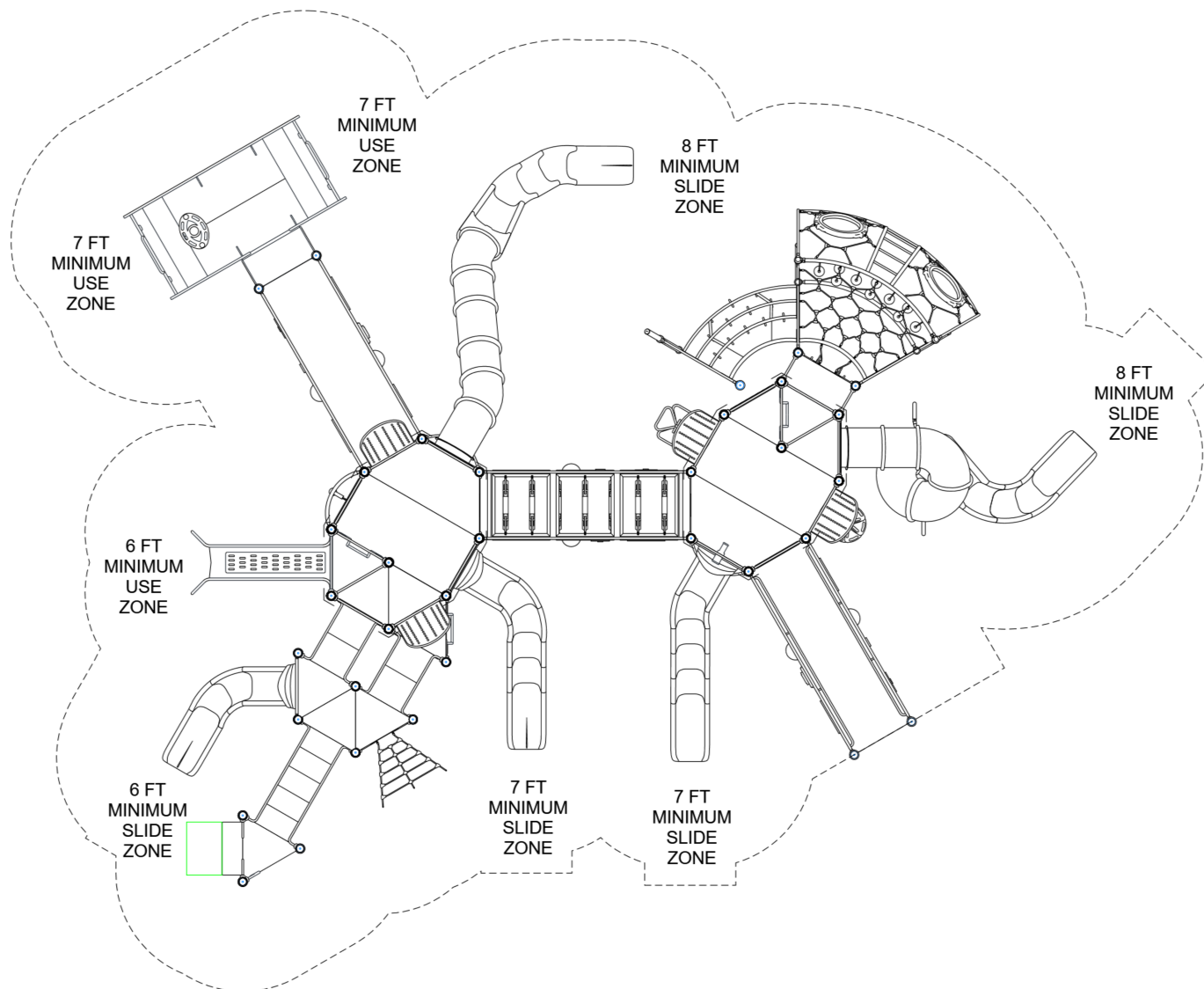

PROJECT #
DATE

R50F38DFA
1/15/2026

Playcraft Systems

MIN. USE ZONE 69' x 56' (20.795m x 16.908m)



R50F38DFA
SW VIEW

R5

FOR KIDS
AGES
5-12

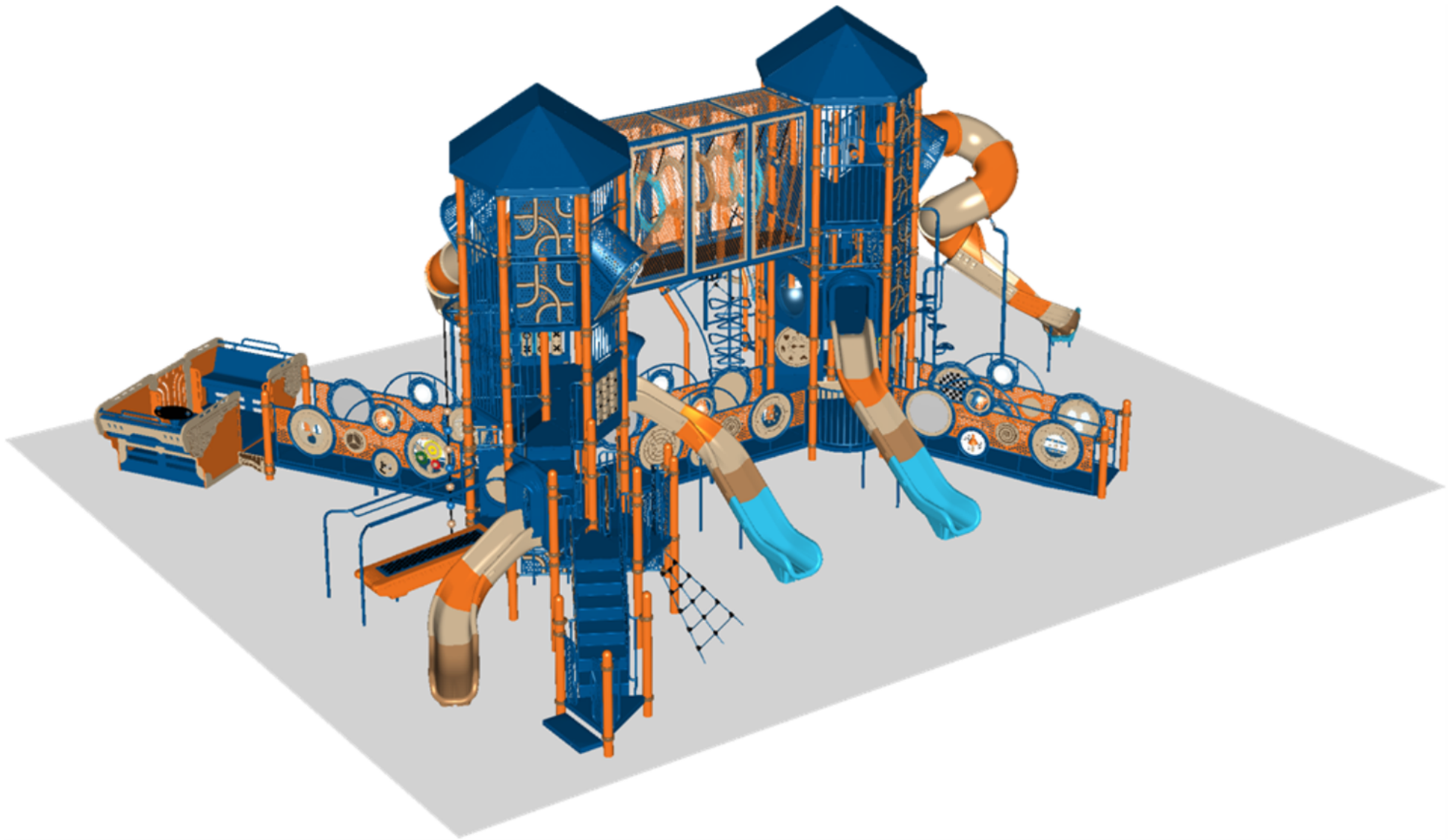

STRUCTURE # R50F38DFA
PROJECT # R50F38DFA
DATE 1/15/2026

R50F38DFA
SE VIEW

R5

FOR KIDS
AGES
5-12



STRUCTURE # R50F38DFA
PROJECT # R50F38DFA
DATE 1/15/2026

R50F38DFA
NE VIEW

R5

FOR KIDS
AGES
5-12



STRUCTURE # R50F38DFA
PROJECT # R50F38DFA
DATE 1/15/2026

R50F38DFA
NW VIEW

R5

FOR KIDS
AGES
5-12



STRUCTURE # R50F38DFA
PROJECT # R50F38DFA
DATE 1/15/2026

R50F38DFA
Project # R50F38DFA

Date 1/15/2026

Item / Part Number	Description	Qty
[R50F38DFA]		
HS-1004-R	Collars	335
HS-1004-R35	Collars R35	9
GF-7002	Dome Cap, R5	18
S-1007-R5-07ft	Post, 07ft R5	2
S-1008-R5-08ft	Post, 08ft R5	3
S-1009-R5-09ft	Post, 09ft R5	2
S-1010-R5-10ft	Post, 10ft R5	1
S-1011-R5-11ft	Post, 11ft R5	1
S-1012-R5-12ft	Post, 12ft R5	3
S-1013-R5-13ft	Post, 13ft R5	2
S-1015-R5-15ft	Post, 15ft R5	1
S-1016-R5-16ft	Post, 16ft R5	1
S-1020-R5-20ft	Post, 20ft R5	2
S-1023-R5-23ft	Post, 23ft R5	16
S-11011-13011-R5	Half Square Deck w Walls R5	1
S-1102-R5	Tri-Deck	14
S-1103-R5	Hex Deck, Half (5 Post)	2
S-1104-R5-90	Long Deck (90in)	6
S-1106-R5	Hex Deck, Half (4 Post)	6
S-1109-R5	Balcony Deck	2
S-1110-R	Filler, Universal (12in)	6
S-1202-R5-NOWALLS	Step Deck, 12in (No Half-Walls)	1
S-1206-24IW45	ADA Stairs, 24in Rise w/ Infinity Walls	2
S-1206-42IW	ADA Stairs, 42in Rise w/ Infinity Walls	1
S-1208-SPC-12	Sensory Platform 144in (Height: 12in Cognitive)	1
S-1208-SPD-12	Sensory Platform 144in (Height: 12in Dynamic)	1
S-1208-SRP	Sensory Ramp 144in (Ground, Playful, Inc.)	1
S-1210-24	Climber, Vertical Ladder 18-24in	3
S-1230-7R	Climber, Clover 78-84in	1
S-1234-7R	Climber, Spiral Step 78-84in	1
S-1242-R5	Deck to Deck Ladder (60in Rise)	3
S-12461-4	Climber, Cargo Net 42-48in	1
S-1298-7R5	Climber, Cord 84in	1
S-1301-12R5	Wall, Steel (12in)	6
S-1301-52R5	Wall, Steel (52in, Behind Ladder)	3
S-1301-56R5	Steel Wall (Above Wall) 56in	1

Item / Part Number	Description	Qty
S-1301-IG24	Infinity Ground Wall 24	6
S-1301-IU21	Wall, Infinity (Below Deck, Above Panel, 72)	3
S-1301-IU30	Wall, Infinity (Below Deck, Above Wall, 72)	4
S-1301-IU36	Wall, Infinity (Below Deck, Above Wall, 78)	1
S-1301-IUD3175	Wall, Infinity (Above Panel, Steel Roof)	2
S-1301-IUD3475	Wall, Infinity (Above Wall, Steel Roof)	5
S-1301-IW	Wall, Infinity (Standard)	8
S-1301-IW66	Wall, Infinity 66in (Filler)	1
S-1301-R5	Wall, Steel 36in (Standard)	3
S-1301-RSP-3475R5	Steel Wall (Above Wall, Double Bar)	2
S-1301-RSSP1675	Push-Out Barrier (Above Wall, Double Bar)	4
S-1301-RU21	Wall, Steel (Below Deck, Above Panel, 72)	2
S-1309-ADA-L-R5	Half Walls ADA (Single, Left)	1
S-1309-IW-R5	Infinity Half Walls (Pair)	7
S-1309-R5	Transfer Point (Half Wall - Left)	1
S-1309-R5	Transfer Point (Half Wall - Right)	1
S-1309-RSPC-R5	Space Port Half Walls (Pair)	1
S-1310-IW-R5	Infinity Transition Wall	3
S-1316-RE-R5	Roto Twister Entry Panel	3
S-1325-DB-25R5	Steel Wall (Above Telescope, Double Bar)	1
S-1333-R5-T	Wall Seat Panel (Tall)	1
S-1362-16132-R5	Push-Out Barrier (Bug Eye)	4
S-1531-R5-RL	Link, Skywalk Ring (144)	1
S-1602-R5	Bubble Panel	2
S-1608-R5	Memory Panel	1
S-1615-R5G	Store Panel	1
S-1616-R5	Tic-Tac-Toe Panel	1
S-1618-R5G	Seek Panel (Standard)	1
S-1628-R5	Inclusive Panel, Driver	1
S-1644-R5	Gear Panel	1
S-16506-R5G	Hypno Station Panel	1
S-1654-R5	Door Panel	1
S-1686-R5	Inclusive Panel, Mosaic	1
S-1709-13SP-LLL	Slide, Portal 156in (Spiral, Right)	1
S-1709-13S-RSR	Slide, Portal 156in (R-S-R, Right)	1
S-1710-5-LL	Slide, Twister 60in (L2)	1
S-1710-7-LSSS	Slide, Twister 84in (L-S-S-S)	1
S-1710-7-RRSS	Slide, Twister 84in (R-R-S-S)	1
S-1806-R5STL	Metal Roof, Hex (Extended)	2
S-1830-STL-R5	Wall w/ Steel Telescope	1

Item / Part Number	Description	Qty
S-1941-R5	Boogie Board	1
S-1975-R5	Access-Glider	1
S-5102	2-Rung Access Ladder	2
S-5104	Hex Net Frame	1
S-5205	Ring Traverse Bay	1
S-5206-DL	Explorers Arch Bay (Deck)	1