

### TOP VIEW

ELEVATED	ACCESSIBLE	RAMP ACCESSIBLE	GROUND	TYPES
19	15/10	0/0	14/6	2/3
<b>CHILD CAPACITY</b>	191	<b>MAX FALL HEIGHT</b>	96	

## R5

FOR KIDS  
AGES  
5-12

## GENERAL NOTES

This conceptual plan is based on information provided prior to construction. Detailed site information, including the following, should be obtained, evaluated, and utilized in the final project design. Exact site dimensions, topography, existing utilities, soil conditions and drainage solutions.

**WARNING:** Accessible safety surfacing material is required beneath and around this equipment that has a critical height value (Fall Height) appropriate for the highest accessible part of this equipment. Refer to the CPSC'S Handbook For Public Playground Safety, Section 4: Surfacing.

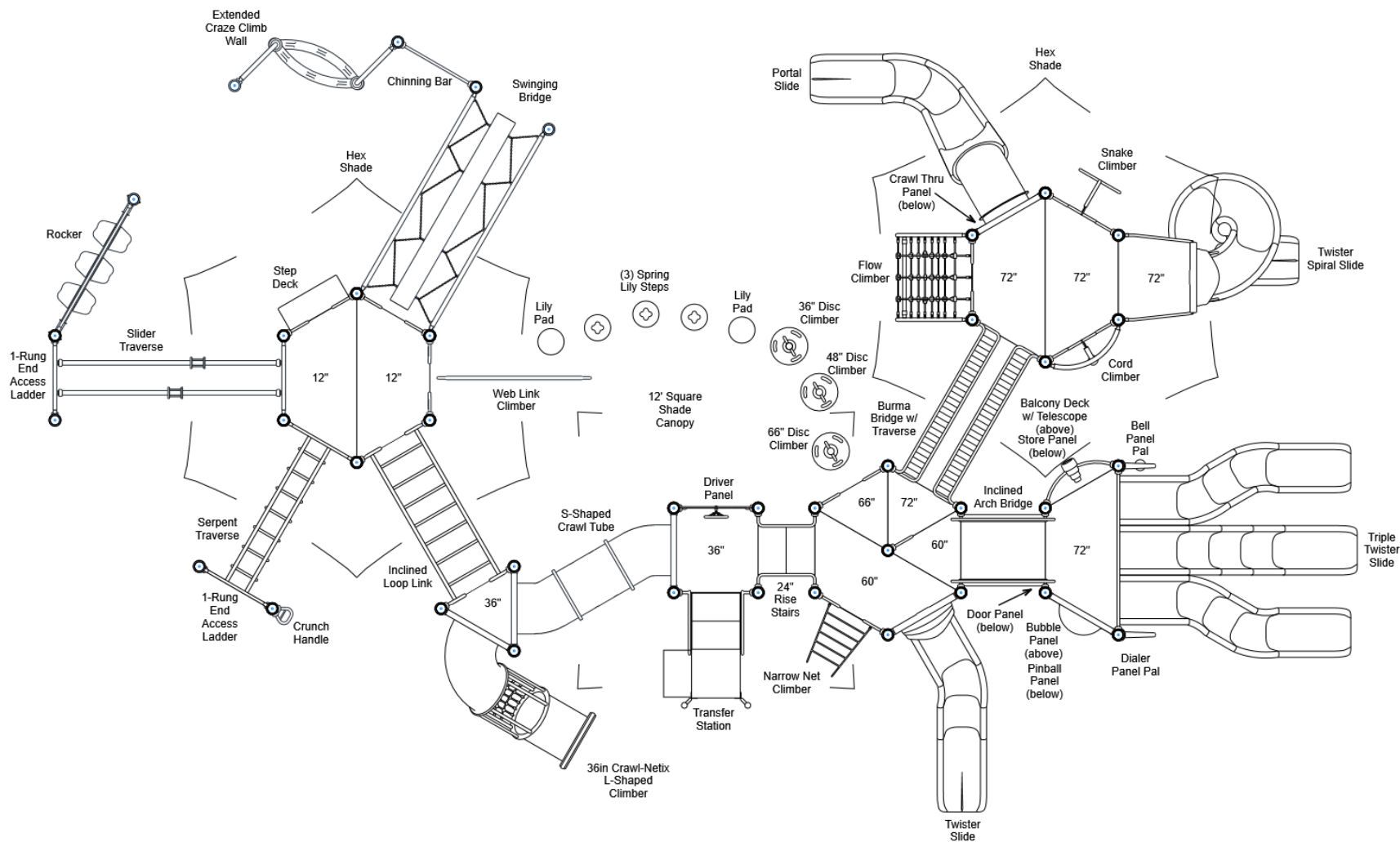

**STRUCTURE #** R50CFFF7A  
**PROJECT #** R50CFFF7A  
**DATE** 6/2/2023

**Playcraft Direct, Inc.**

**MIN. USE ZONE** 71' x 47' (21.346m x 14.134m)



R50CFFF7A  
SITE PLAN

ADA ACCESSIBILITY GUIDELINES - ADAAG CONFORMANCE

ELEVATED	ACCESSIBLE	RAMP ACCESSIBLE	GROUND	TYPES
20	15/5	0/5	10/7	1/4

R5

FOR KIDS  
AGES  
5-12

GENERAL NOTES

This Preliminary Site Plan is based on measurements that were provided in the initial planning phase. All dimensions must be verified prior to the submission of a purchase order. Playcraft Systems will not be held responsible for any discrepancies between actual dimensions and dimensions submitted in the planning phase.

The Minimum Use Zone for a play structure is based on the product design at the time of proposal. Components and structure designs may be subject to change which may affect dimensions. Therefore, before preparing the site, we strongly recommend obtaining final drawings from the factory (available after the order is placed and included in the Assembly Manual).

WARNING: Accessible safety surfacing material is required beneath and around this equipment that has a critical height value (Fall Height) appropriate for the highest accessible part of this equipment. Refer to the CPSC'S Handbook For Public Playground Safety, Section 4: Surfacing.

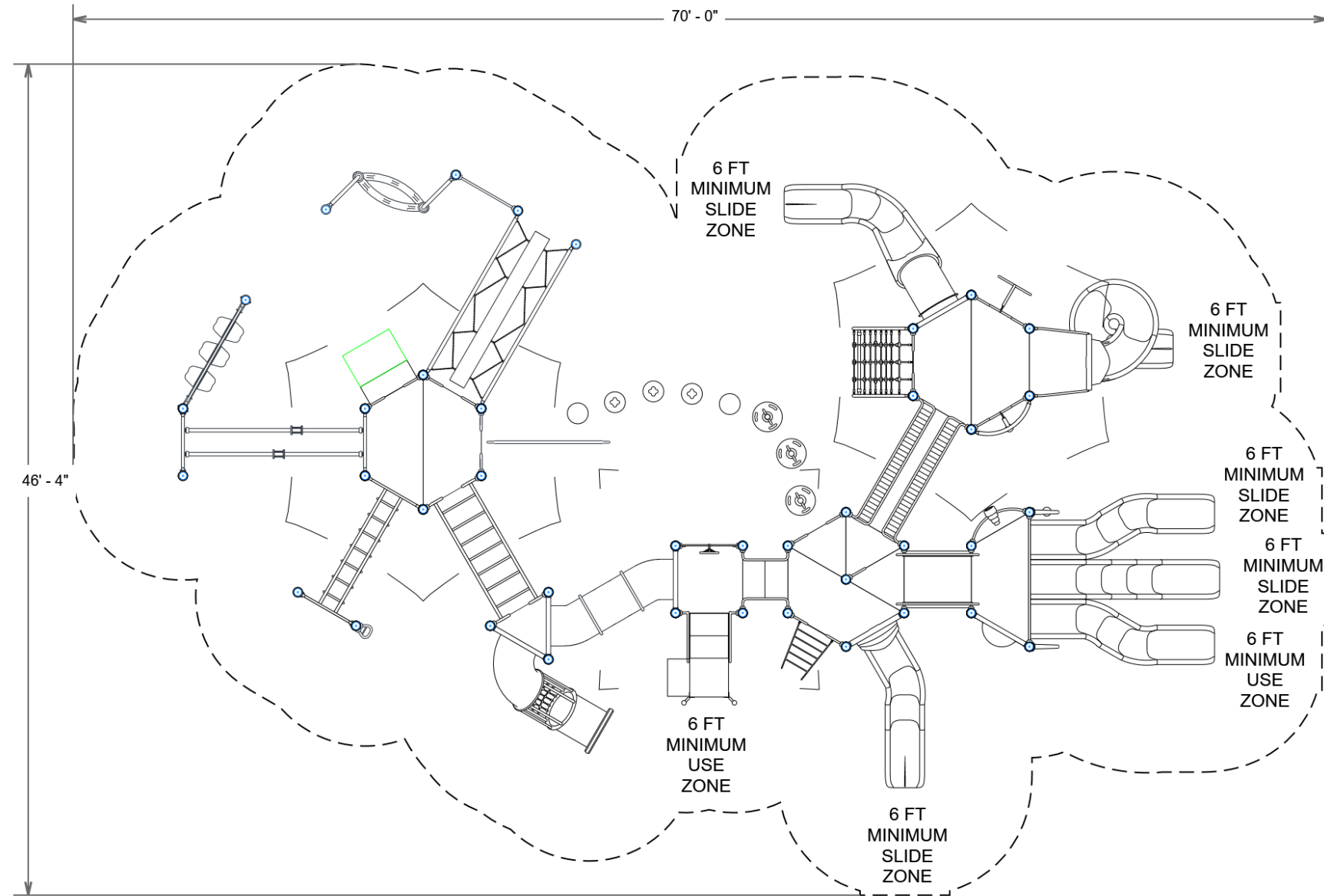

**R50CFFF7A**  
**SW VIEW**

**R5**

FOR KIDS  
AGES  
5-12



**STRUCTURE #** R50CFFF7A  
**PROJECT #** R50CFFF7A  
**DATE** 6/2/2023

**R50CFFF7A**  
**NE VIEW**

**R5**

FOR KIDS  
AGES  
5-12



**STRUCTURE #** R50CFFF7A  
**PROJECT #** R50CFFF7A  
**DATE** 6/2/2023

## R50CFFF7A

**Project #** R50CFFF7A

**Date** 6/2/2023

Item / Part Number	Description	Qty
<b>[R50CFFF7A]</b>		
HS-1004-R	Collars	127
A2-1943	Spring Lily Step	3
GF-7002	Dome Cap, R5	23
S-1008-R5-08ft	Post, 08ft R5	1
S-1009-R5-09ft	Post, 09ft R5	2
S-1010-R5-10ft	Post, 10ft R5	3
S-1011-R5-11ft	Post, 11ft R5	6
S-1012-R5-12ft	Post, 12ft R5	3
S-1013-R5-13ft	Post, 13ft R5	8
S-1014-R5-14ft	Post, 14ft R5	6
S-1017-R5-17ft	Post, 17ft R5	4
S-1018-R5-18ft	Post, 18ft R5	6
S-1101-R5	Square Deck	1
S-1102-R5	Tri-Deck	4
S-1103-R5	Hex Deck, Half (5 Post)	1
S-1106-R5	Hex Deck, Half (4 Post)	5
S-1109-R5-T	Balcony Deck w/ Telescope	1
S-1110-R	Filler, 12in	1
S-1202-R5	Step Deck, 12in	1
S-1206-24R5	ADA Stairs, 24in Rise w/ Walls (Short)	1
S-1209-24-R5	Transfer Station, 36in-L	1
S-1222-6R	Climber, Snake 66-72in	1
S-1233-3-MC	Climber, Disc 30-36in (MC)	1
S-1233-4-MC	Climber, Disc 42-48in (MC)	1
S-1233-6-HW	Climber, Disc 66-72in (w/ HW)	1
S-12462	Climber, Narrow Net 54-60in	1
S-1261-R5F	Climber, Flow	1
S-1297-EXT	Climber, Craze Wall (Right, Extended)	1
S-1298-6R5	Climber, Cord 72in	1
S-1309-2-R5	Half Walls (Pair) R5	4
S-1309-R5	Half Walls (Single, Left)	1
S-1310-R5	Transition Wall	2
S-1316-RE-R5	Roto Twister Entry Panel	1
S-1401-R5	End Access Ladder (1-Rung)	2
S-1414	Lily Pad Step 12-18in	2
S-1416-122R5	Traverse, Slider (122in)	1

<b>Item / Part Number</b>	<b>Description</b>	<b>Qty</b>
S-1418-R5	Traverse, Serpent	1
S-1500-42-3SR5	Crawl Tube, S-Shaped (3-Sect., 36-42in)	1
S-1507-127R5	Bridge, Swinging	1
S-1508-90R5	Link, Loop 90in (Inclined 24in)	1
S-1509-90TR5	Bridge, Burma w/ Traverse (90in)	1
S-1514-45R5	Bridge, Inclined Arch (45in)	1
S-1517-C-R5	Climber, Web Link 12in	1
S-1535-DTG-LR36	Climber, Crawl-Netix 36in (L-Shaped, DTG, R)	1
S-1600-R5G	Crawl Thru Panel	1
S-1602-R5	Bubble Panel	1
S-1615-R5	Store Panel	1
S-1625-R5	Driver Panel	1
S-1631-R5G	Pinball Panel	1
S-1654-R5	Door Panel	1
S-1661-R5	Panel Pal, Bell	1
S-1665-R5	Panel Pal, Dialer	1
S-1706-S6L-R5	Slide, Twister Spiral 72in (L)	1
S-1709-6L-LL	Slide, Portal 72in (L-L, Left)	1
S-1710-3-6R5-LRS5RL	Slide, Triple Twister 72in (L-R-S5-R-L)	1
S-1710-5-RS	Slide, Twister 60in (R-S)	1
S-18021-12R5	Shade Canopy, 12ft Square	1
S-18026-18-R5	Shade Canopy, Hex 18ft	2
S-1930-R5	Chinning Bar	1
S-1937-R5	Crunch Handle	1
S-1946-R5	Rocker	1