

TREEHOUSE CATALOG
TOP VIEW - 0

ADA ACCESSIBILITY GUIDELINES - ADAAG CONFORMANCE

ELEVATED	ACCESSIBLE	RAMP ACCESSIBLE	GROUND	TYPES
5	5/3	0/0	3/2	3/2
CHILD CAPACITY	79	MAX FALL HEIGHT	72	

R5

FOR KIDS
AGES
5-12

GENERAL NOTES

This conceptual plan is based on information provided prior to construction. Detailed site information, including the following, should be obtained, evaluated, and utilized in the final project design. Exact site dimensions, topography, existing utilities, soil conditions and drainage solutions.

WARNING: Accessible safety surfacing material is required beneath and around this equipment that has a critical height value (Fall Height) appropriate for the highest accessible part of this equipment. Refer to the CPSC'S Handbook For Public Playground Safety, Section 4: Surfacing.

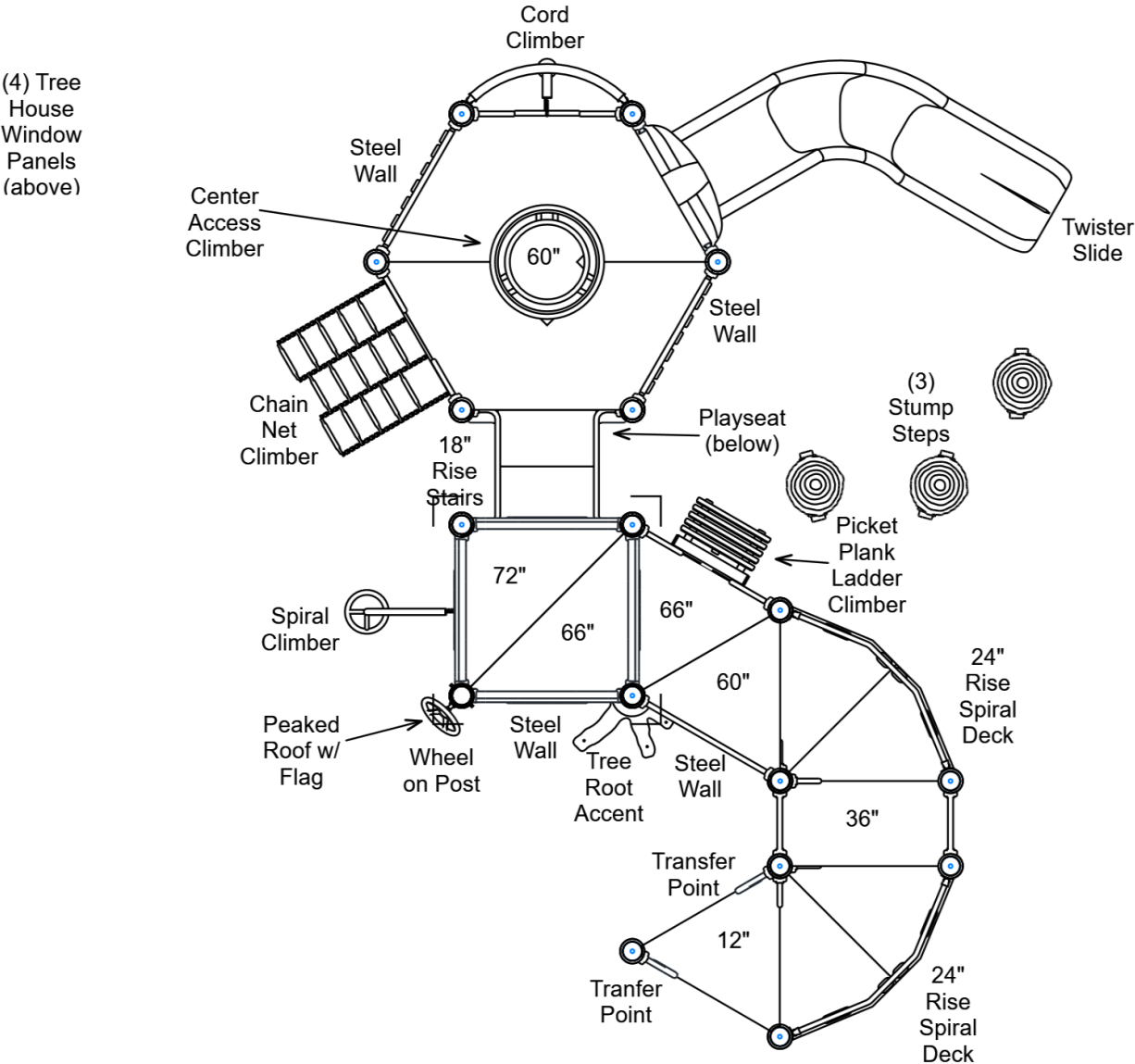

STRUCTURE # R50A64FFA
PROJECT # R50A64FFA
DATE 1/14/2026

Playcraft Systems
MIN. USE ZONE 30' x 34' (9m x 10.309m)



TREEHOUSE CATALOG
SITE PLAN

ADA ACCESSIBILITY GUIDELINES - ADAAG CONFORMANCE

ELEVATED	ACCESSIBLE	RAMP ACCESSIBLE	GROUND	TYPES
5	5/3	0/0	3/2	3/2

R5

FOR KIDS
AGES
5-12

GENERAL NOTES

This Preliminary Site Plan is based on measurements that were provided in the initial planning phase. All dimensions must be verified prior to the submission of a purchase order. Playcraft Systems will not be held responsible for any discrepancies between actual dimensions and dimensions submitted in the planning phase.

The Minimum Use Zone for a play structure is based on the product design at the time of proposal. Components and structure designs may be subject to change which may affect dimensions. Therefore, before preparing the site, we strongly recommend obtaining final drawings from the factory (available after the order is placed and included in the Assembly Manual).

WARNING: Accessible safety surfacing material is required beneath and around this equipment that has a critical height value (Fall Height) appropriate for the highest accessible part of this equipment. Refer to the CPSC'S Handbook For Public Playground Safety, Section 4: Surfacing.

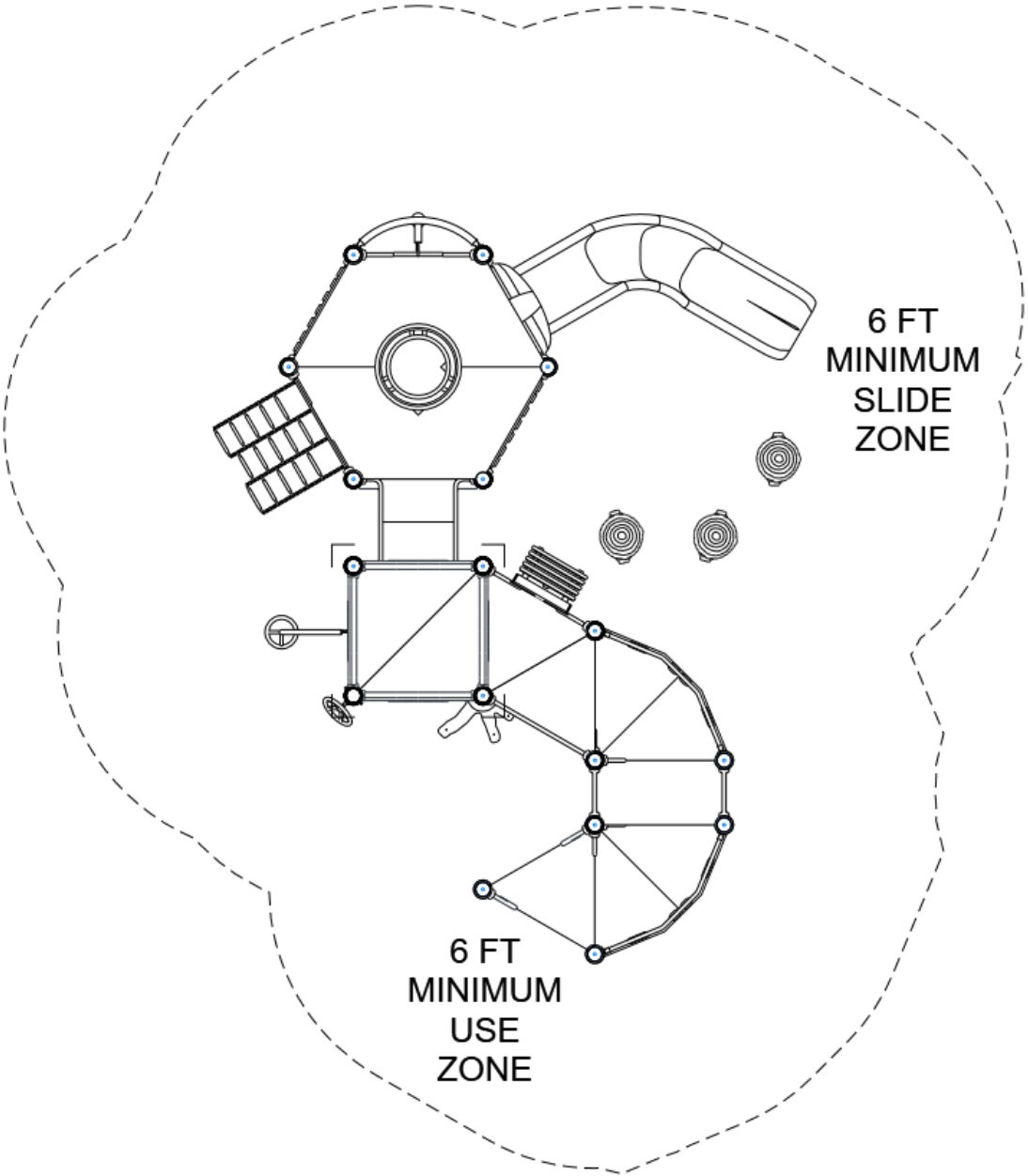

PROJECT # R50A64FFA
DATE 1/14/2026

Playcraft Systems
MIN. USE ZONE 30' x 34' (9m x 10.309m)



TREEHOUSE CATALOG

SW VIEW

R5

FOR KIDS
AGES
5-12



STRUCTURE # R50A64FFA
PROJECT # R50A64FFA
DATE 1/14/2026

TREEHOUSE CATALOG

NE VIEW

R5

FOR KIDS
AGES
5-12



STRUCTURE # R50A64FFA
PROJECT # R50A64FFA
DATE 1/14/2026

TREEHOUSE CATALOG

Project # R50A64FFA

Date 1/14/2026

Item / Part Number	Description	Qty
[R50A64FFA]		
HS-1004-R	Collars	69
GF-7002	Dome Cap, R5	14
S-1008-R5-08ft	Post, 08ft R5	1
S-1010-R5-10ft	Post, 10ft R5	3
S-1012-R5-12ft	Post, 12ft R5	6
S-1013-R5-13ft	Post, 13ft R5	1
S-1014-R5-14ft	Post, 14ft R5	2
S-1019-R5-19ft	Post, 19ft R5	4
S-11011-13011-R5	Half Square Deck w Walls R5	1
S-11021-L	Spiral Deck, (Left, 24in)	2
S-1102-R5	Tri-Deck	3
S-1105-R5	Half Deck	2
S-1206-18R5	ADA Stairs, 18in Rise w/ Walls	1
S-12102-6	Climber, Picket Plank Ladder 66-72in	1
S-1221-5	Climber, Chain Net 54-60in	1
S-1223-6R	Climber, Spiral 66-72in	1
S-12891-5-HEX	Center Access Hex Deck (60in)	1
S-1298-5R5	Climber, Cord 60in	1
S-1301-R5	Wall, Steel 36in (Standard)	1
S-1301-TMB	Picket Play Wall (Standard)	3
S-1303-TW-R5	Twister Entry Panel w/ Hood	1
S-1309-2-R5	Half Walls (Pair) R5	2
S-1309-ADA-L-R5	Half Walls ADA (Single, Left)	2
S-1310-R5	Transition Wall	2
S-1677-WND-DM_R5	Tree House Window	4
S-1710-5-RR	Slide, Twister 60in (R2)	1
S-18018-R5-F	Roof, Peaked w/ Flag (HDPE/Steel)	1
S-1812-R5	Driver Wheel (Post Mounted)	1
S-1849-R5	Tree Root Accent	1
S-1961	Stump Step 12-18in	3
S-1962-R5	Playseat	1