

R5080C84A
TOP VIEW - 0

ADA ACCESSIBILITY GUIDELINES - ADAAG CONFORMANCE

ELEVATED	ACCESSIBLE	RAMP ACCESSIBLE	GROUND	TYPES
28	26/7	14/7	17/9	5/5
CHILD CAPACITY	264	MAX FALL HEIGHT	156	

R5

FOR KIDS
AGES
5-12

GENERAL NOTES

This conceptual plan is based on information provided prior to construction. Detailed site information, including the following, should be obtained, evaluated, and utilized in the final project design. Exact site dimensions, topography, existing utilities, soil conditions and drainage solutions.

WARNING: Accessible safety surfacing material is required beneath and around this equipment that has a critical height value (Fall Height) appropriate for the highest accessible part of this equipment. Refer to the CPSC'S Handbook For Public Playground Safety, Section 4: Surfacing.

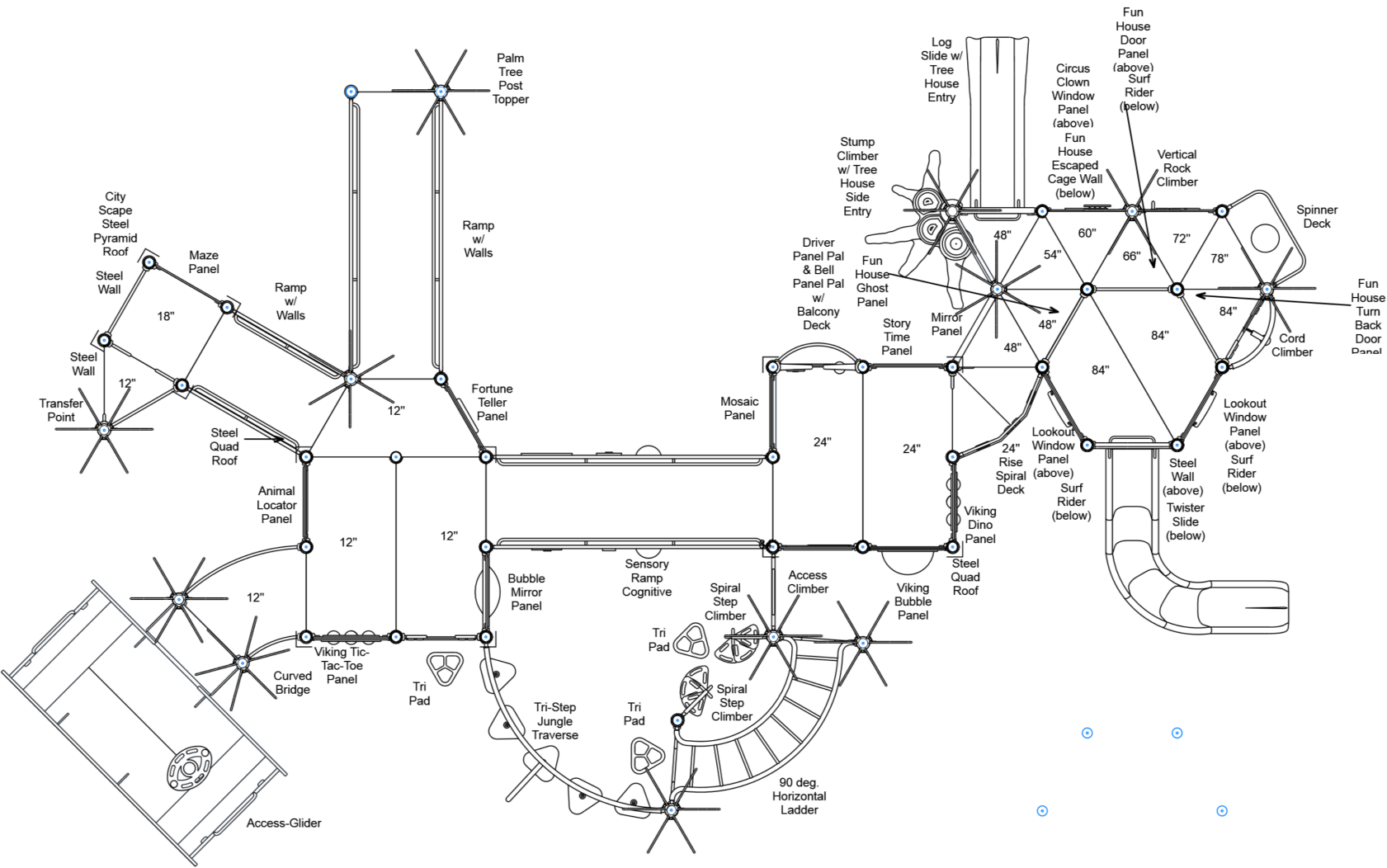

STRUCTURE # R5080C84A
PROJECT # R5080C84A
DATE 1/16/2026

Playcraft Systems
MIN. USE ZONE 80' x 55' (24.265m x 16.694m)



R5080C84A
TOP VIEW - 1

ADA ACCESSIBILITY GUIDELINES - ADAAG CONFORMANCE

ELEVATED	ACCESSIBLE	RAMP ACCESSIBLE	GROUND	TYPES
28	26/7	14/7	17/9	5/5
CHILD CAPACITY	264	MAX FALL HEIGHT	156	

R5

FOR KIDS
AGES
5-12

GENERAL NOTES

This conceptual plan is based on information provided prior to construction. Detailed site information, including the following, should be obtained, evaluated, and utilized in the final project design. Exact site dimensions, topography, existing utilities, soil conditions and drainage solutions.

WARNING: Accessible safety surfacing material is required beneath and around this equipment that has a critical height value (Fall Height) appropriate for the highest accessible part of this equipment. Refer to the CPSC'S Handbook For Public Playground Safety, Section 4: Surfacing.

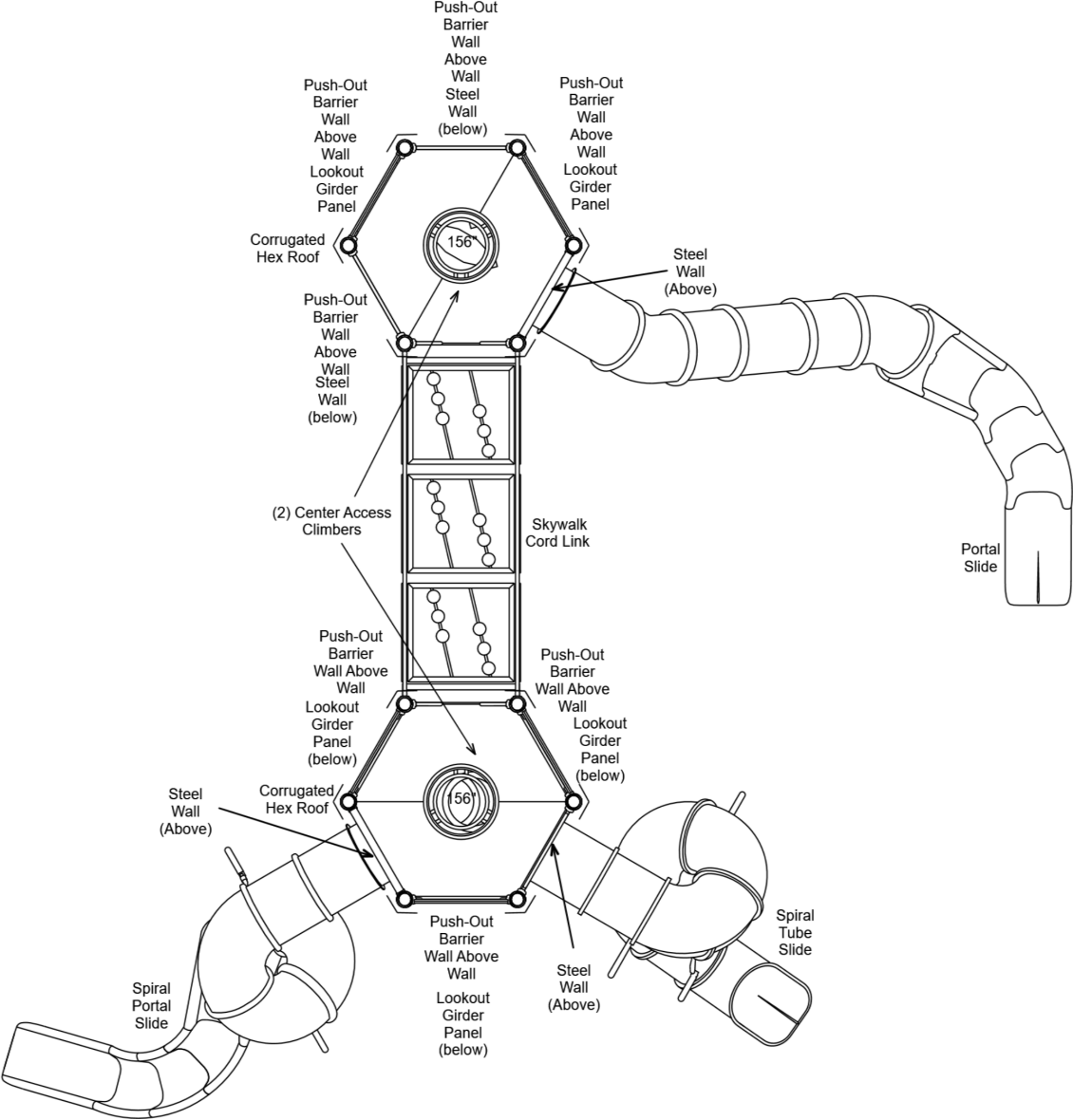

STRUCTURE # R5080C84A
PROJECT # R5080C84A
DATE 1/16/2026

Playcraft Systems
MIN. USE ZONE 80' x 55' (24.265m x 16.694m)



R5080C84A
SITE PLAN

ADA ACCESSIBILITY GUIDELINES - ADAAG CONFORMANCE

ELEVATED	ACCESSIBLE	RAMP ACCESSIBLE	GROUND	TYPES
28	26/7	14/7	17/0	5/0

R5

FOR KIDS
AGES
5-12

GENERAL NOTES

This Preliminary Site Plan is based on measurements that were provided in the initial planning phase. All dimensions must be verified prior to the submission of a purchase order. Playcraft Systems will not be held responsible for any discrepancies between actual dimensions and dimensions submitted in the planning phase.

The Minimum Use Zone for a play structure is based on the product design at the time of proposal. Components and structure designs may be subject to change which may affect dimensions. Therefore, before preparing the site, we strongly recommend obtaining final drawings from the factory (available after the order is placed and included in the Assembly Manual).

WARNING: Accessible safety surfacing material is required beneath and around this equipment that has a critical height value (Fall Height) appropriate for the highest accessible part of this equipment. Refer to the CPSC'S Handbook For Public Playground Safety, Section 4: Surfacing.

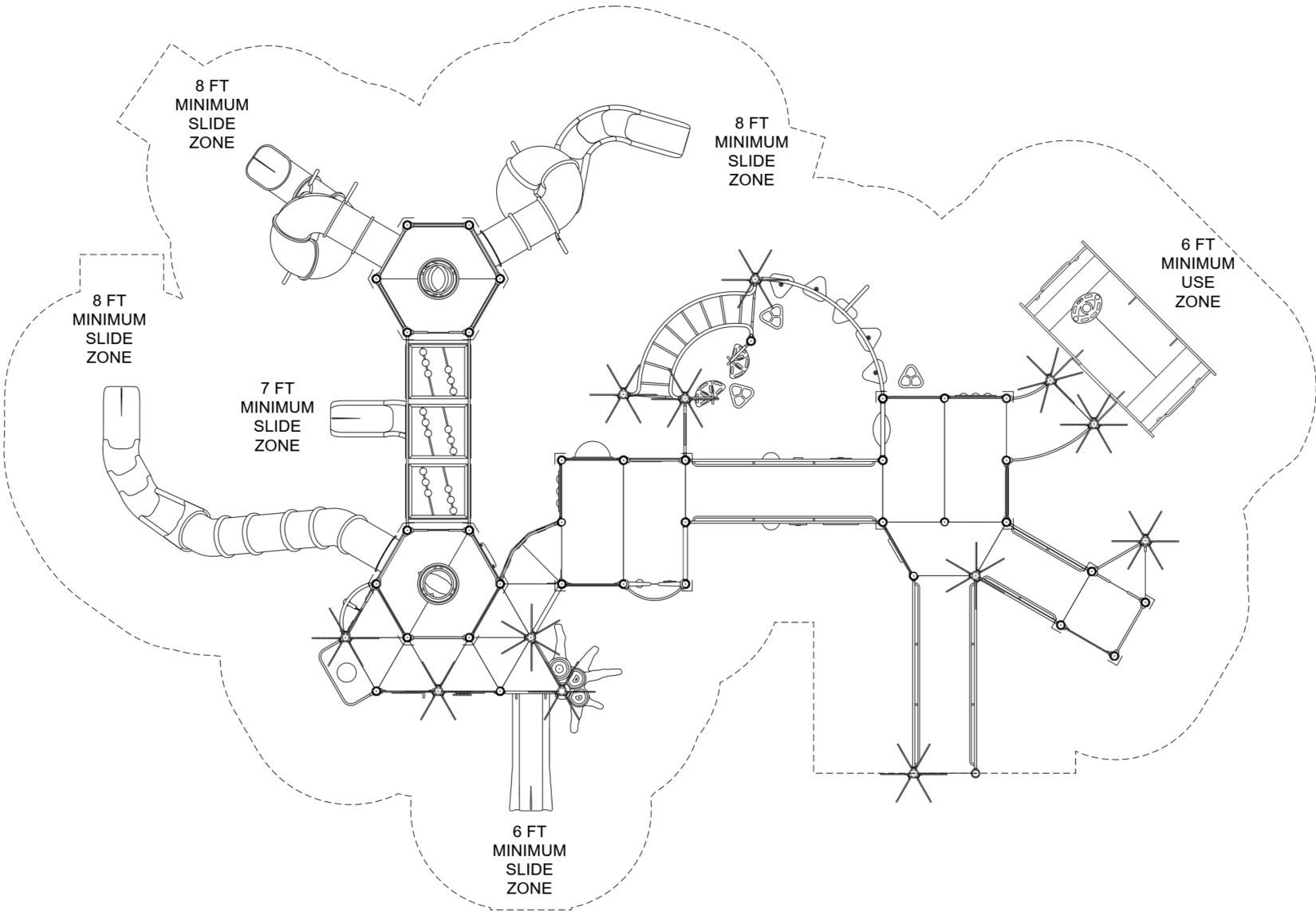

PROJECT # R5080C84A
DATE 1/16/2026

Playcraft Systems
MIN. USE ZONE 80' x 55' (24.265m x 16.693m)



R5080C84A
SW VIEW

R5

FOR KIDS
AGES
5-12



STRUCTURE # R5080C84A
PROJECT # R5080C84A
DATE 1/16/2026

R5080C84A
NE VIEW

R5

FOR KIDS
AGES
5-12



STRUCTURE # R5080C84A
PROJECT # R5080C84A
DATE 1/16/2026

R5080C84A
Project # R5080C84A

Date 1/16/2026

Item / Part Number	Description	Qty
[R5080C84A]		
HS-1004-R	Collars	361
GF-7001	Flat Cap, R5	1
GF-7002	Dome Cap, R5	24
S-1005-R5F-9-012-051	Post, 5ft, 12in (51in)	1
S-1007-R5-07ft	Post, 07ft R5	1
S-1008-R5-08ft	Post, 08ft R5	4
S-1009-R5-09ft	Post, 09ft R5	2
S-1010-R5-10ft	Post, 10ft R5	1
S-1011-R5-11ft	Post, 11ft R5	5
S-1012-R5-12ft	Post, 12ft R5	10
S-1013-R5-13ft	Post, 13ft R5	3
S-1014-R5-14ft	Post, 14ft R5	1
S-1015-R5-15ft	Post, 15ft R5	2
S-1016-R5-16ft	Post, 16ft R5	3
S-1017-R5-17ft	Post, 17ft R5	2
S-1018-R5-18ft	Post, 18ft R5	2
S-1023-R5-23ft	Post, 23ft R5	12
S-1101-R5	Square Deck	1
S-11021-L	Spiral Deck, (Left, 24in)	1
S-1102-R5	Tri-Deck	10
S-1103-R5	Hex Deck, Half (5 Post)	1
S-11048-48R5	Log Slide 48in	1
S-1104-R5-90	Long Deck (90in)	4
S-1106-R5	Hex Deck, Half (4 Post)	2
S-1109-LRG-R5-SPN	Spinner Deck	1
S-1109-R5	Balcony Deck	1
S-1112-R	Filler, 18in	1
S-1208-RW-6	Ramp 72in (6in Incline w/ Walls)	1
S-1208-R-WALL12	Ramp 144in (Ground w/ Walls, Inc.)	1
S-1208-SRC-12	Sensory Ramp 144in (6-12, Cognitive, Inc.)	1
S-1211-18R5	Filler, Step 18in	1
S-1234-DSC-3R5	Climber, Spiral Step 36in	2
S-1237-6R5	Climber, Vertical Rock 66-72in	1
S-1257-R5	Climber, Access	1
S-12891-DD6-HEX	Center Access Hex Deck (DTD, 72in)	1
S-1292-48R5SE	Climber, Stump (T.H. Side Entry) 48in	1

Item / Part Number	Description	Qty
S-1298-7R5	Climber, Cord 84in	1
S-1301-12R5	Wall, Steel (12in)	4
S-1301-36R5	Wall, Steel (36in)	1
S-1301-60R5	Wall, Steel 55in (60in gap)	2
S-1301-R5	Wall, Steel 36in (Standard)	2
S-1301-RSSP1675	Push-Out Barrier (Above Wall, Double Bar)	7
S-1301-RSSP-3175R5	Steel Wall (Above Panel, Double Bar)	3
S-1302-DB-20	Filler, Below Deck Mesh Wall (24in)	1
S-1302-DB-32	Filler, Below Deck Mesh Wall (36in)	5
S-1309-2-R5	Half Walls (Pair) R5	1
S-1309-TMB-2	Picket Play Half Walls (Pair) R5	1
S-1310-TMB	Picket Play Transition Wall	1
S-1313-R5	Handle	1
S-1314-R5L	Access Wall (Left)	1
S-1343-R560	Fun House Escaped Cage Wall	1
S-1402-R5	End Access Ladder (2-Rung)	2
S-1429-R5	Traverse, Horizontal Ladder (90 deg)	1
S-1437-R5	Traverse, Jungle Tri-Step	1
S-1511-R5	Bridge, Curved	1
S-1531-R5	Link, Skywalk Cord (144)	1
S-1603-R5	Bubble Mirror Panel	1
S-16071-R5-DM	Story Time Panel	1
S-1607-R5	Maze Panel	1
S-1609-R5	Mirror Panel	1
S-16461-BD	Below Deck Panel	10
S-16501	Fortune Teller Panel	1
S-16502	Circus Clown Window Panel	1
S-16503	Fun House Door Panel (Turn Back)	1
S-16504	Fun House Ghost Panel	1
S-16505	Fun House Door Panel	1
S-1652-R5	Animal Locator Panel	1
S-1661-R5	Panel Pal, Bell	1
S-1667-R5	Panel Pal, Driver	1
S-1672-GDR	Girder Panel	5
S-1672-WIN	Window Panel	2
S-1676-R5-BBL	Viking Bubble Panel	1
S-1676-R5-DTB	Viking Dino Panel	1
S-1676-R5-TTT	Viking Tic-Tac-Toe Panel	1
S-1677-TE-R5	TreeHouse Twister Entry Panel	1
S-1685-R5	Mosaic Panel	1

Item / Part Number	Description	Qty
S-1707-13SPR5	Slide, Tube 156in (Spiral, Left)	1
S-1709-13SP-RRR	Slide, Portal 156in (Spiral, Left)	1
S-1709-13S-RSR	Slide, Portal 156in (R-S-R, Right)	1
S-1710-7-SLLL	Slide, Twister 84in (S-L-L-L)	1
S-18011-R5	Metal Roof, Quad	2
S-18031-R5	Metal Roof, Hex (Corrugated)	2
S-18071-R5CTY	City Scape Steel Pyramid Roof	1
S-1840-R5	Palm Tree Topper	12
S-1926-13R5	Center Access Hex Net Deck (156in)	1
S-1948-R5	Surf Rider	3
S-1961-RV	Tri Pad Seat	3
S-1975-R5	Access-Glider	1