

R50313D7A  
TOP VIEW

ADA ACCESSIBILITY GUIDELINES - ADAAG CONFORMANCE

ELEVATED	ACCESSIBLE	RAMP ACCESSIBLE	GROUND	TYPES
8	8/4	0/0	4/3	4/3
CHILD CAPACITY	68	MAX FALL HEIGHT	60	

R5

FOR KIDS  
AGES  
2-5

GENERAL NOTES

This conceptual plan is based on information provided prior to construction. Detailed site information, including the following, should be obtained, evaluated, and utilized in the final project design. Exact site dimensions, topography, existing utilities, soil conditions and drainage solutions.

WARNING: Accessible safety surfacing material is required beneath and around this equipment that has a critical height value (Fall Height) appropriate for the highest accessible part of this equipment. Refer to the CPSC'S Handbook For Public Playground Safety, Section 4: Surfacing.

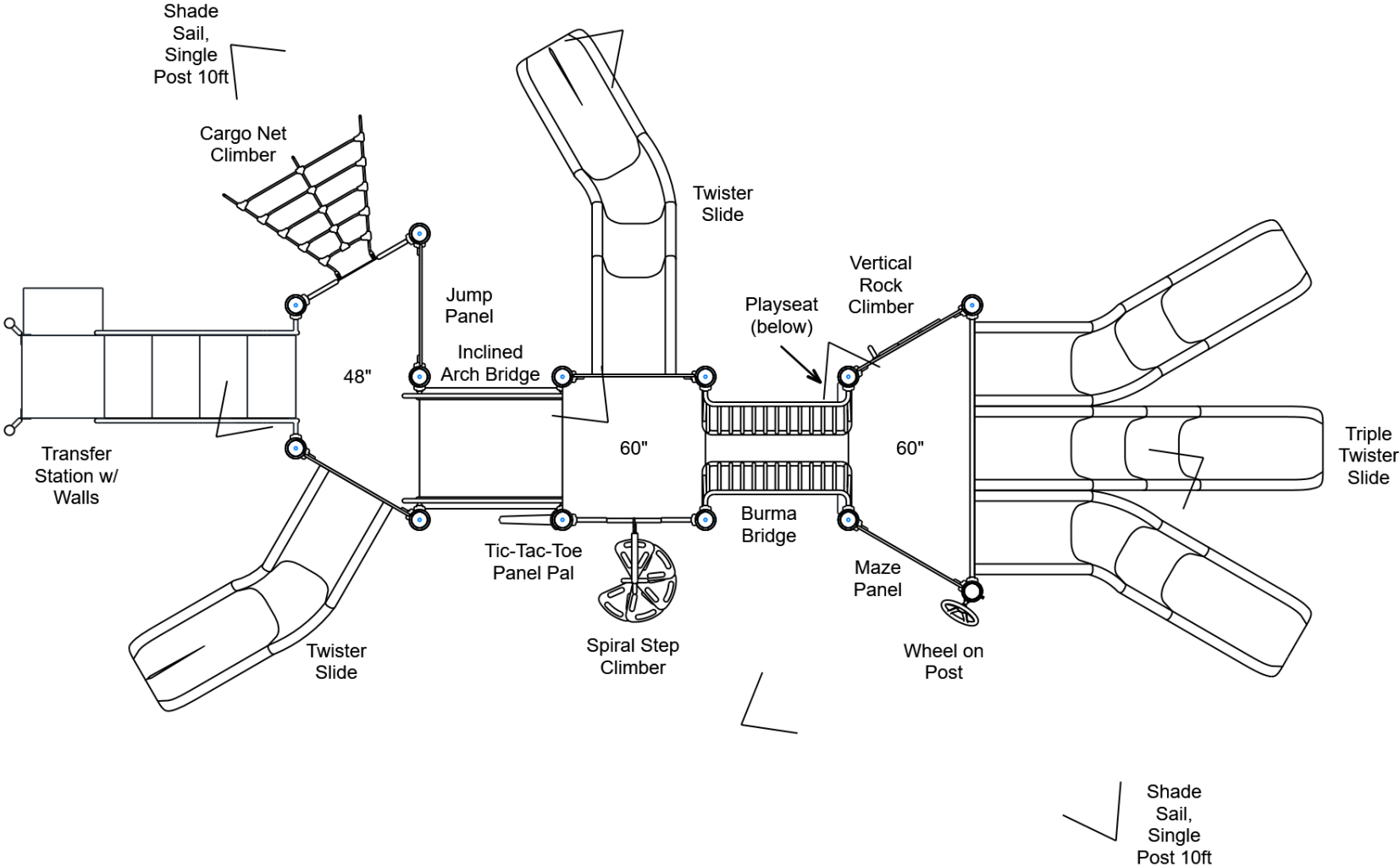

STRUCTURE # R50313D7A  
PROJECT # R50313D7A  
DATE 8/20/2024

Playcraft Direct, Inc.  
MIN. USE ZONE 47' x 30' (14.068m x 9.108m)



R50313D7A  
SITE PLAN

ADA ACCESSIBILITY GUIDELINES - ADAAG CONFORMANCE

ELEVATED	ACCESSIBLE	RAMP ACCESSIBLE	GROUND	TYPES
8	8/4	0/0	4/3	4/3

R5

FOR KIDS  
AGES  
2-5

GENERAL NOTES

This Preliminary Site Plan is based on measurements that were provided in the initial planning phase. All dimensions must be verified prior to the submission of a purchase order. Playcraft Systems will not be held responsible for any discrepancies between actual dimensions and dimensions submitted in the planning phase.

The Minimum Use Zone for a play structure is based on the product design at the time of proposal. Components and structure designs may be subject to change which may affect dimensions. Therefore, before preparing the site, we strongly recommend obtaining final drawings from the factory (available after the order is placed and included in the Assembly Manual).

WARNING: Accessible safety surfacing material is required beneath and around this equipment that has a critical height value (Fall Height) appropriate for the highest accessible part of this equipment. Refer to the CPSC'S Handbook For Public Playground Safety, Section 4: Surfacing.

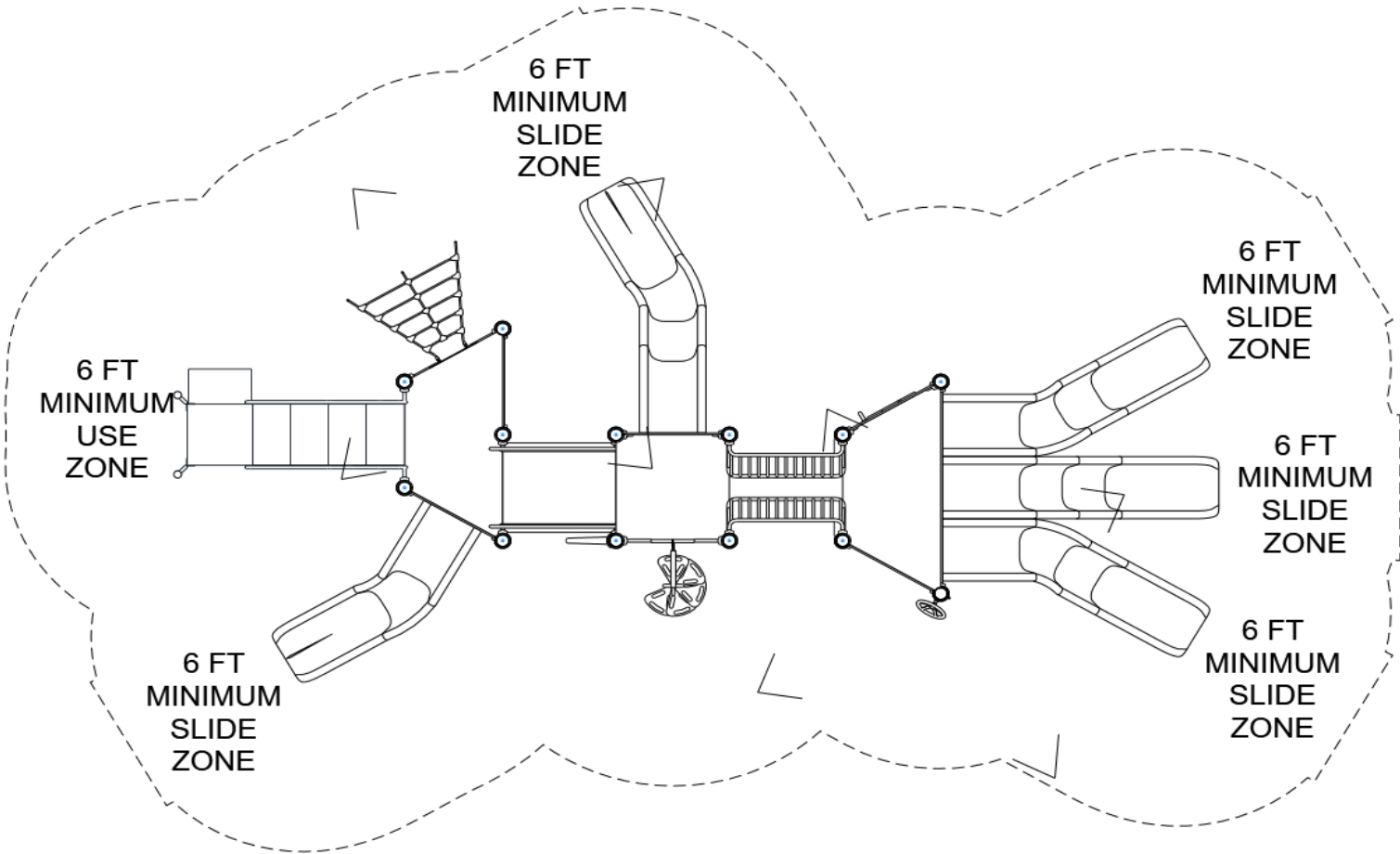

PROJECT # R50313D7A  
DATE 8/20/2024

Playcraft Direct, Inc.  
MIN. USE ZONE 47' x 30' (14.072m x 9.093m)



**R50313D7A**  
**SW VIEW**

**R5**

FOR KIDS  
AGES  
2-5



**STRUCTURE #** R50313D7A  
**PROJECT #** R50313D7A  
**DATE** 8/20/2024

**R50313D7A**  
**NE VIEW**

**R5**

FOR KIDS  
AGES  
2-5



**STRUCTURE #** R50313D7A  
**PROJECT #** R50313D7A  
**DATE** 8/20/2024

## R50313D7A

Project # R50313D7A

Date 8/20/2024

Item / Part Number	Description	Qty
<b>[R50313D7A]</b>		
HS-1004-R	Collars	43
GF-7002	Dome Cap, R5	13
S-1011-R5-11ft	Post, 11ft R5	4
S-1012-R5-12ft	Post, 12ft R5	7
S-1019-R5-19ft	Post, 19ft R5	1
S-1020-R5-20ft	Post, 20ft R5	1
S-1101-R5	Square Deck	1
S-1103-R5	Hex Deck, Half (5 Post)	1
S-1106-R5	Hex Deck, Half (4 Post)	1
S-1209-36W-R5	Transfer Station, 48in-L (W)	1
S-1234-5R	Climber, Spiral Step 54-60in	1
S-1237-5R5	Climber, Vertical Rock 54-60in	1
S-12461-4	Climber, Cargo Net 42-48in	1
S-1309-2-R5	Half Walls (Pair) R5	1
S-1310-R5	Transition Wall	1
S-1316-R5	Twister Entry Panel	2
S-1509-R5-45	Bridge, Burma (45in)	1
S-1514-45R5	Bridge, Inclined Arch (45in)	1
S-1607-R5	Maze Panel	1
S-1620-R5	Jump Panel	1
S-1664-R5	Panel Pal, Tic-Tac-Toe	1
S-1710-3-5R5-LS4R	Slide, Triple Twister 60in (L-S-R)	1
S-1710-4-R	Slide, Twister 48in (R)	1
S-1710-5-SL	Slide, Twister 60in (S-L)	1
S-18029-R5	Shade Sail, Single Post 10ft	2
S-1812-R5	Driver Wheel (Post Mounted)	1
S-1962-R5	Playseat	1