

# R501955DA

## TOP VIEW

### ADA ACCESSIBILITY GUIDELINES - ADAAG CONFORMANCE

ELEVATED	ACCESSIBLE	RAMP ACCESSIBLE	GROUND	TYPES
0	0/0	0/0	9/0	1/0
CHILD CAPACITY	93	MAX FALL HEIGHT	84	

R5

FOR KIDS  
AGES  
5-12

### GENERAL NOTES

This conceptual plan is based on information provided prior to construction. Detailed site information, including the following, should be obtained, evaluated, and utilized in the final project design. Exact site dimensions, topography, existing utilities, soil conditions and drainage solutions.

**WARNING:** Accessible safety surfacing material is required beneath and around this equipment that has a critical height value (Fall Height) appropriate for the highest accessible part of this equipment. Refer to the CPSC'S Handbook For Public Playground Safety, Section 4: Surfacing.

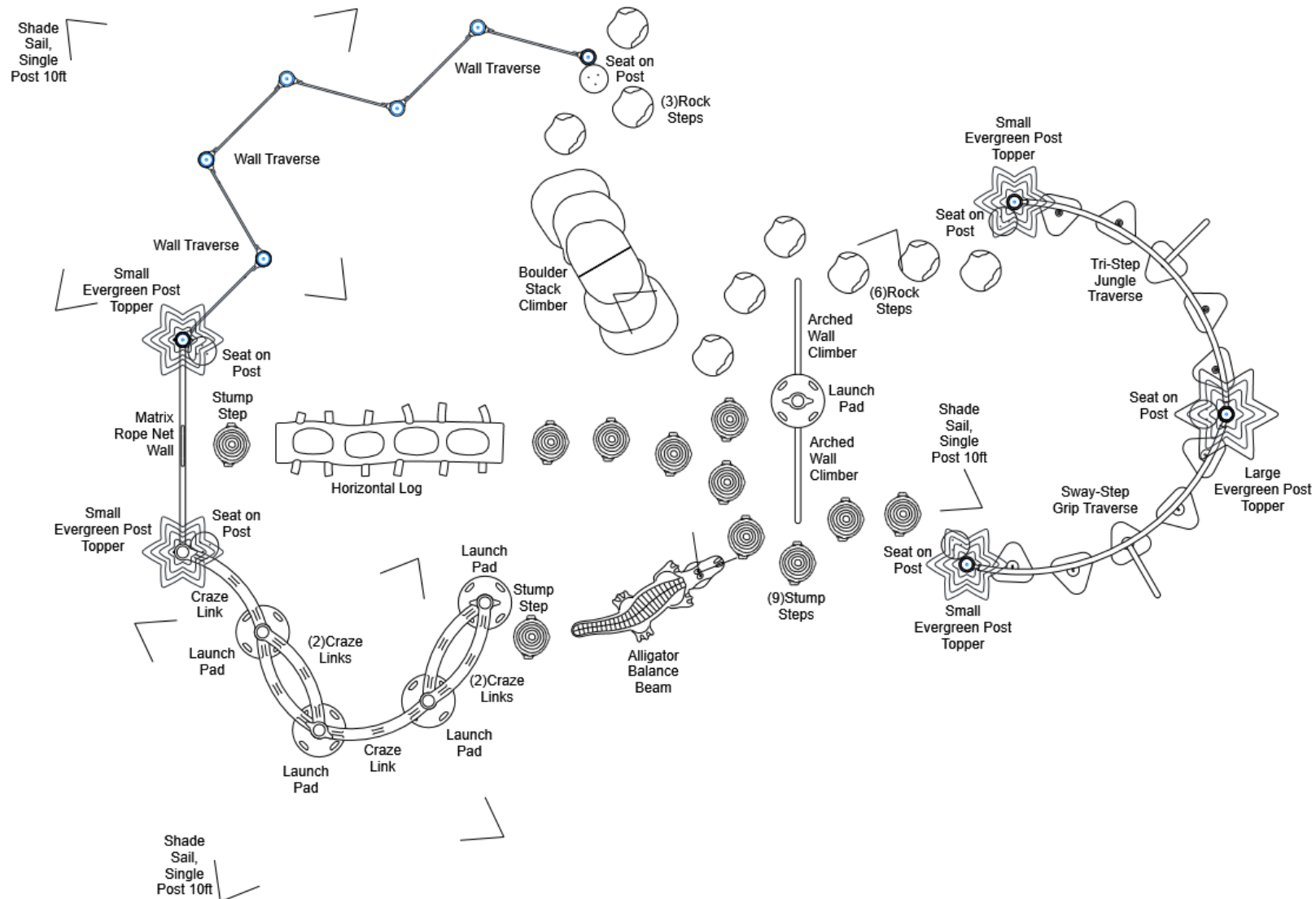

STRUCTURE # R501955DA  
PROJECT # R501955DA  
DATE 8/13/2024

**Playcraft Direct, Inc.**

MIN. USE ZONE 50' x 39' (15.029m x 11.725m)

R501955DA  
SITE PLAN

ADA ACCESSIBILITY GUIDELINES - ADAAG CONFORMANCE

ELEVATED	ACCESSIBLE	RAMP ACCESSIBLE	GROUND	TYPES
0	0/0	0/0	9/0	1/0

R5

FOR KIDS  
AGES  
5-12

GENERAL NOTES

This Preliminary Site Plan is based on measurements that were provided in the initial planning phase. All dimensions must be verified prior to the submission of a purchase order. Playcraft Systems will not be held responsible for any discrepancies between actual dimensions and dimensions submitted in the planning phase.

The Minimum Use Zone for a play structure is based on the product design at the time of proposal. Components and structure designs may be subject to change which may affect dimensions. Therefore, before preparing the site, we strongly recommend obtaining final drawings from the factory (available after the order is placed and included in the Assembly Manual).

WARNING: Accessible safety surfacing material is required beneath and around this equipment that has a critical height value (Fall Height) appropriate for the highest accessible part of this equipment. Refer to the CPSC'S Handbook For Public Playground Safety, Section 4: Surfacing.

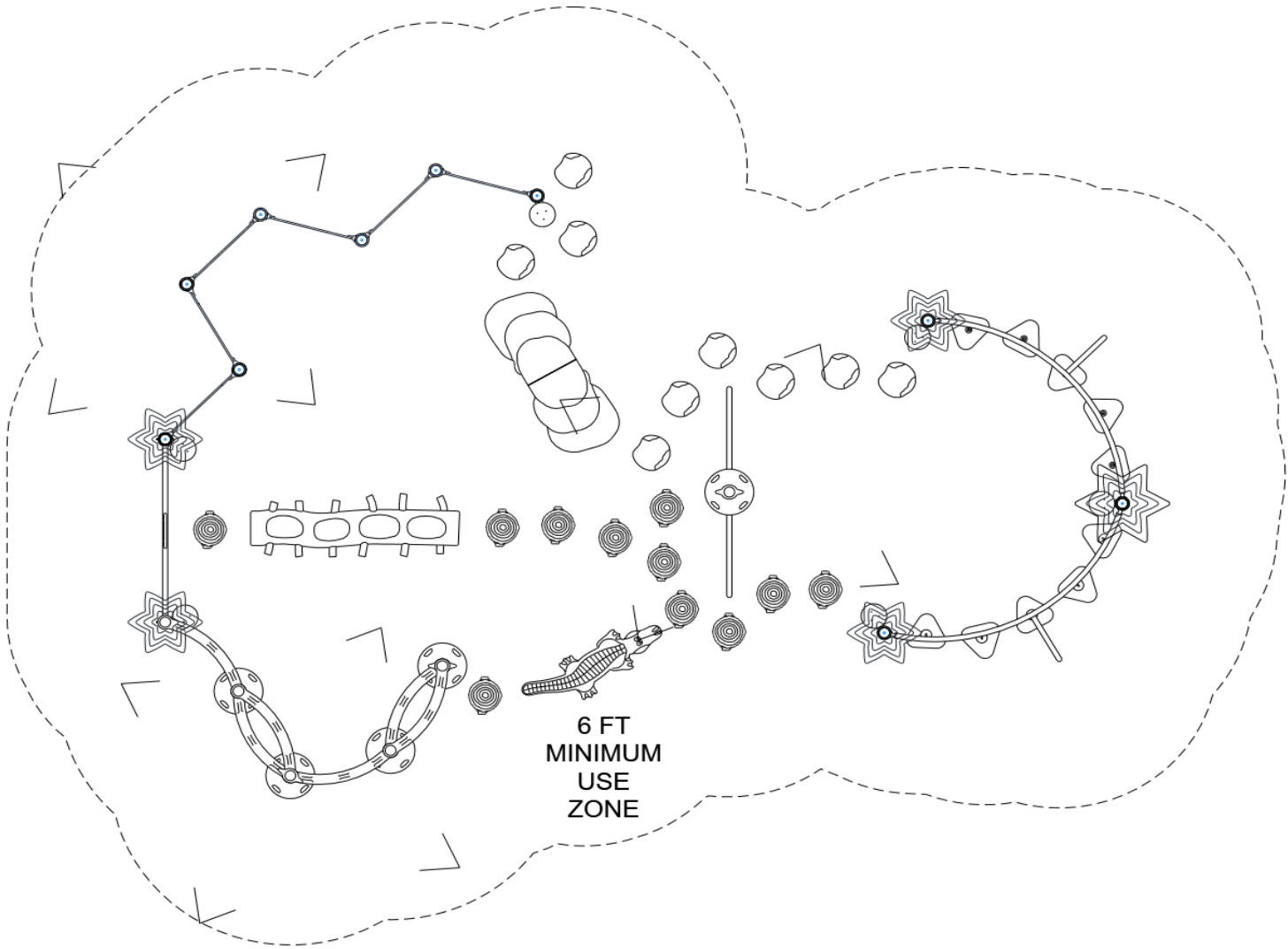

PROJECT # R501955DA  
DATE 8/13/2024

Playcraft Direct, Inc.  
MIN. USE ZONE 50' x 39' (15.011m x 11.735m)



R501955DA  
SW VIEW

R5

FOR KIDS  
AGES  
5-12



STRUCTURE # R501955DA  
PROJECT # R501955DA  
DATE 8/13/2024

R501955DA  
NE VIEW

R5

FOR KIDS  
AGES  
5-12



STRUCTURE # R501955DA  
PROJECT # R501955DA  
DATE 8/13/2024

**R501955DA**
**Project #** R501955DA

**Date** 8/13/2024

Item / Part Number	Description	Qty
<b>[R501955DA]</b>		
HS-1004-R	Collars	52
A2-2272-20	Boulder Stack Climber 20in	1
A2-2425	Horizontal Log	1
A2-2426	Balance Beam (Alligator)	1
GF-7002	Dome Cap, R5	11
S-1010-R5-10ft	Post, 10ft R5	3
S-1011-R5-11ft	Post, 11ft R5	5
S-1016-R5-16ft	Post, 16ft R5	2
S-1018-R5-18ft	Post, 18ft R5	2
S-1019-R5-19ft	Post, 19ft R5	1
S-1020-R5-20ft	Post, 20ft R5	1
S-1021-R5-21ft	Post, 21ft R5	2
S-1283-R5	Climber, Matrix Rope Net Wall	1
S-1286-R5	Climber, Arched Wall	2
S-1295-R5	Craze Handle R5	3
S-1296-R5	Craze Link R5 (Left)	4
S-1296-R5	Craze Link R5 (Right)	2
S-1417-4R5	Traverse, Wall (Four Section)	1
S-1417-R5	Traverse, Wall (Single Section)	2
S-1437-R5	Traverse, Jungle Tri-Step	1
S-1440-R5	Traverse, Sway-Step Grip	1
S-18029-R5	Shade Sail, Single Post 10ft	3
S-1847-LR5	Evergreen Topper (Large)	1
S-1847-S-R5	Evergreen Topper (Small)	4
S-1961	Stump Step 12-18in	11
S-1961-R	Rock Step	9
S-1963-R5	Seat on Post	6
S-21263-R5	Launch Pad R5	5