

NF59221CA
TOP VIEW

ADA ACCESSIBILITY GUIDELINES - ADAAG CONFORMANCE

ELEVATED	ACCESSIBLE	RAMP ACCESSIBLE	GROUND	TYPES
19	19/10	0/0	9/6	3/3
CHILD CAPACITY	210	MAX FALL HEIGHT	108	

R5

FOR KIDS
AGES
5-12

GENERAL NOTES

This conceptual plan is based on information provided prior to construction. Detailed site information, including the following, should be obtained, evaluated, and utilized in the final project design. Exact site dimensions, topography, existing utilities, soil conditions and drainage solutions.

WARNING: Accessible safety surfacing material is required beneath and around this equipment that has a critical height value (Fall Height) appropriate for the highest accessible part of this equipment. Refer to the CPSC'S Handbook For Public Playground Safety, Section 4: Surfacing.

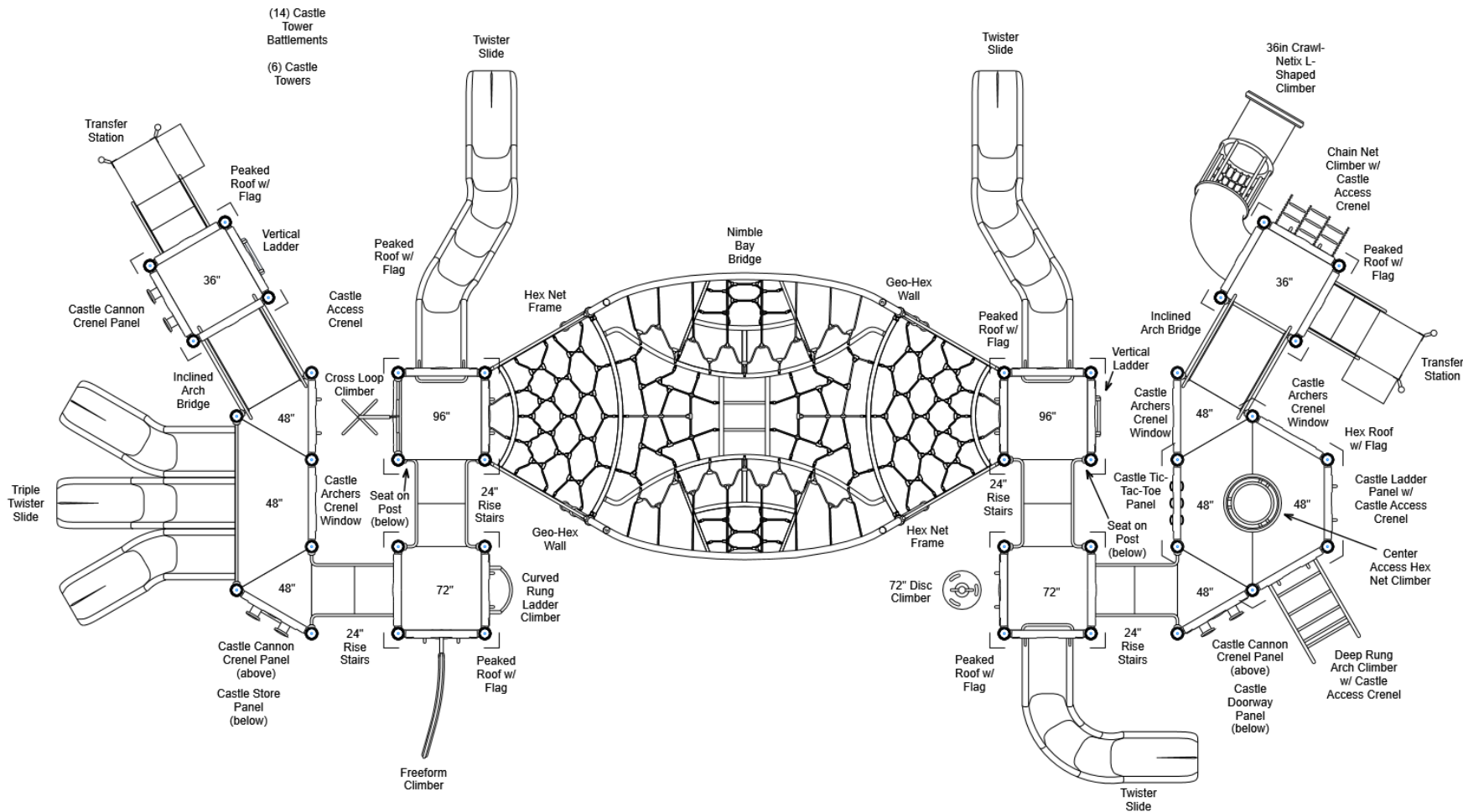

STRUCTURE # NF59221CA
PROJECT # NF59221CA
DATE 7/3/2023

Playcraft Direct, Inc.
MIN. USE ZONE 72' x 45' (21.874m x 13.642m)



NF59221CA
SITE PLAN

ADA ACCESSIBILITY GUIDELINES - ADAAG CONFORMANCE

ELEVATED	ACCESSIBLE	RAMP ACCESSIBLE	GROUND	TYPES
19	19/10	0/0	9/6	3/3

R5

FOR KIDS
AGES
5-12

GENERAL NOTES

This Preliminary Site Plan is based on measurements that were provided in the initial planning phase. All dimensions must be verified prior to the submission of a purchase order. Playcraft Systems will not be held responsible for any discrepancies between actual dimensions and dimensions submitted in the planning phase.

The Minimum Use Zone for a play structure is based on the product design at the time of proposal. Components and structure designs may be subject to change which may affect dimensions. Therefore, before preparing the site, we strongly recommend obtaining final drawings from the factory (available after the order is placed and included in the Assembly Manual).

WARNING: Accessible safety surfacing material is required beneath and around this equipment that has a critical height value (Fall Height) appropriate for the highest accessible part of this equipment. Refer to the CPSC'S Handbook For Public Playground Safety, Section 4: Surfacing.

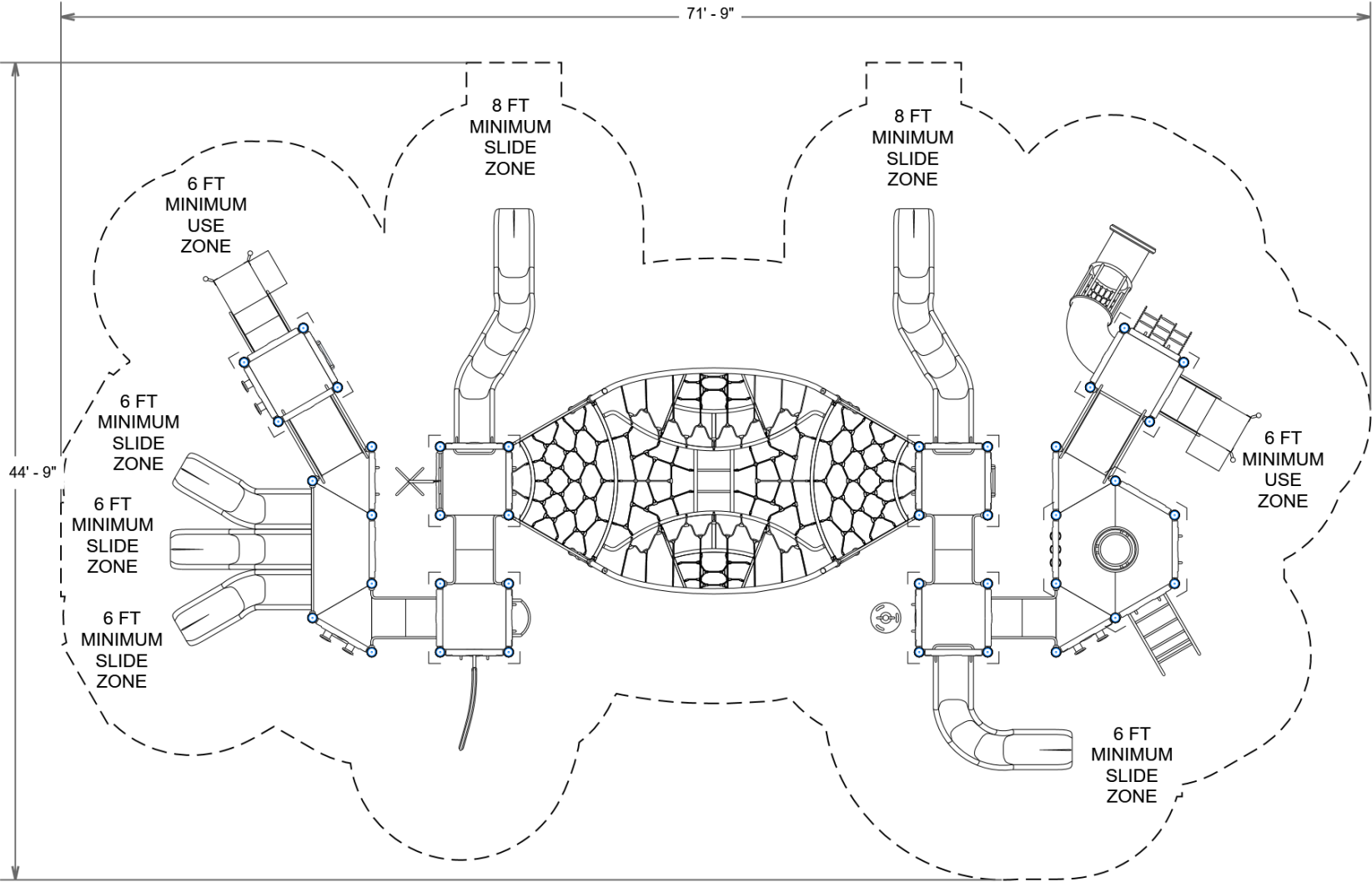

PROJECT # NF59221CA
DATE 7/3/2023

Playcraft Direct, Inc.
MIN. USE ZONE 72' x 45' (21.874m x 13.642m)



NF59221CA
SW VIEW

R5

FOR KIDS
AGES
5-12



STRUCTURE # NF59221CA
PROJECT # NF59221CA
DATE 7/3/2023

NF59221CA
NE VIEW

R5

FOR KIDS
AGES
5-12



STRUCTURE # NF59221CA
PROJECT # NF59221CA
DATE 7/3/2023

NF59221CA

Project # NF59221CA

Date 7/3/2023

Item / Part Number	Description	Qty
[NF59221CA]		
HS-1004-R	Collars	239
HS-1004-R35	Collars R35	24
GF-7002	Dome Cap, R5	8
S-1011-R5-11ft	Post, 11ft R5	1
S-1012-R5-12ft	Post, 12ft R5	7
S-1014-R5-14ft	Post, 14ft R5	6
S-1019-R5-19ft	Post, 19ft R5	4
S-1020-R5-20ft	Post, 20ft R5	4
S-1021-R5-21ft	Post, 21ft R5	8
S-1023-R5-23ft	Post, 23ft R5	8
S-1101-R5	Square Deck	6
S-1102-R5	Tri-Deck	4
S-1106-R5	Hex Deck, Half (4 Post)	1
S-1206-24R45	ADA Stairs, 24in Rise w/ Walls	4
S-1209-24-R5	Transfer Station, 36in-L	2
S-1210-36	Climber, Vertical Ladder 30-36in	1
S-1210-96	Climber, Vertical Ladder 90-96in	1
S-1219-4	Climber, Deep Rung Arch 42-48in	1
S-1221-3	Climber, Chain Net 30-36in	1
S-1229-8R	Climber, Cross Loop 90-96in	1
S-1233-6-HW	Climber, Disc 66-72in (w/ HW)	1
S-1238-6	Climber, Freeform 66-72in	1
S-1282-6	Climber, Curved Rung Ladder 66-72in	1
S-1310-R5	Transition Wall	1
S-1514-45R5	Bridge, Inclined Arch (45in)	2
S-1535-DTG-LL36	Climber, Crawl-Netix 36in (L-Shaped, DTG, L)	1
S-16211-4GD	Castle Ladder Panel	1
S-16211-60ACC-R5	Castle Access Crenel (Tall)	10
S-16211-60ARCC	Castle Archers Crenel Window	3
S-16211-60CANC	Castle Cannon Crenel (Tall)	3
S-16211-60TEC-R5	Castle Twister Slide Entry Panel	3
S-16211-60TTTC	Castle Tic-Tac-Toe Panel	1
S-16211-ACC-R5	Castle Access Crenel	1
S-16211-DOR	Castle Doorway Panel	1
S-16211-STR	Castle Store Panel	1
S-16211-TWR	Castle Tower	6

Item / Part Number	Description	Qty
S-16211-TWRB	Castle Tower Battlement	14
S-1710-3-4R5-LSR	Slide, Triple Twister 48in (L-S-R)	1
S-1710-6-LLL	Slide, Twister 72in (L3)	1
S-1710-8-LSSRS	Slide, Twister 96in (L-S-S-R-S)	1
S-1710-8-RSSLS	Slide, Twister 96in (R-S-S-L-S)	1
S-18018-R5-F	Roof, Peaked w/ Flag (HDPE/Steel)	6
S-1803-1821-R5	Roof, Hex w/ Flag	1
S-1926-SR5	Center Access Hex Net Deck (48in)	1
S-1963-R5	Seat on Post	2
S-5103	Geo-Hex Wall	2
S-5104	Hex Net Frame	2
S-5501-DD	Nimble Bay Bridge (Deck to Deck)	1