

R50AB6B5A  
TOP VIEW

ADA ACCESSIBILITY GUIDELINES - ADAAG CONFORMANCE

ELEVATED	ACCESSIBLE	RAMP ACCESSIBLE	GROUND	TYPES
9	9/5	0/0	3/3	3/3
CHILD CAPACITY		70	MAX FALL HEIGHT	
			60	

R5

FOR KIDS  
AGES  
2-5

GENERAL NOTES

This conceptual plan is based on information provided prior to construction. Detailed site information, including the following, should be obtained, evaluated, and utilized in the final project design. Exact site dimensions, topography, existing utilities, soil conditions and drainage solutions.

WARNING: Accessible safety surfacing material is required beneath and around this equipment that has a critical height value (Fall Height) appropriate for the highest accessible part of this equipment. Refer to the CPSC'S Handbook For Public Playground Safety, Section 4: Surfacing.

(4) Single  
Post  
LeafScape  
Roofs

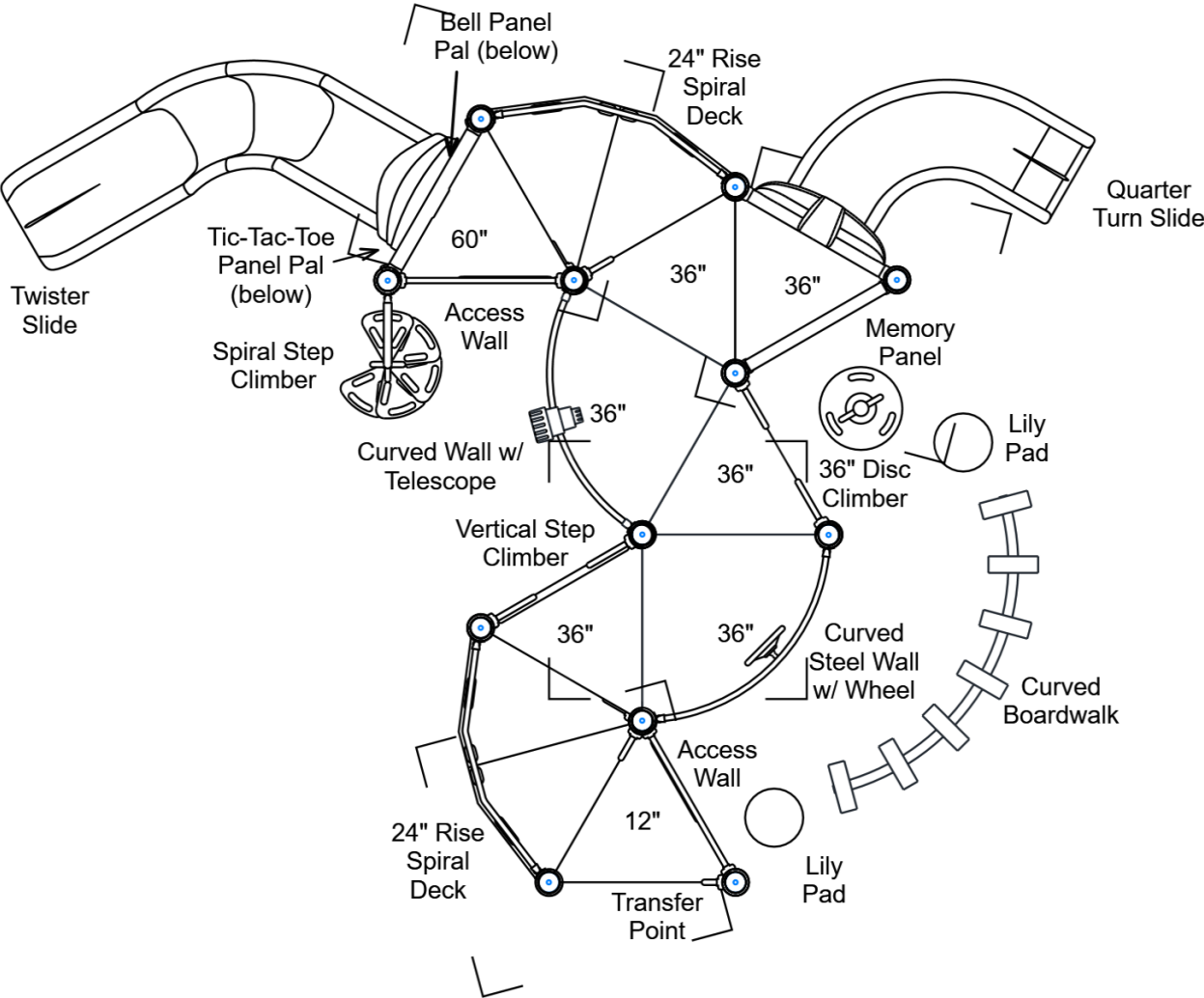

STRUCTURE # R50AB6B5A  
PROJECT # R50AB6B5A  
DATE 8/5/2025

Playcraft Direct, Inc.  
MIN. USE ZONE 34' x 29' (10.36m x 8.753m)



R50AB6B5A  
SITE PLAN

ADA ACCESSIBILITY GUIDELINES - ADAAG CONFORMANCE

ELEVATED	ACCESSIBLE	RAMP ACCESSIBLE	GROUND	TYPES
9	9/5	0/0	3/3	3/3

R5

FOR KIDS  
AGES  
2-5

GENERAL NOTES

This Preliminary Site Plan is based on measurements that were provided in the initial planning phase. All dimensions must be verified prior to the submission of a purchase order. Playcraft Systems will not be held responsible for any discrepancies between actual dimensions and dimensions submitted in the planning phase.

The Minimum Use Zone for a play structure is based on the product design at the time of proposal. Components and structure designs may be subject to change which may affect dimensions. Therefore, before preparing the site, we strongly recommend obtaining final drawings from the factory (available after the order is placed and included in the Assembly Manual).

WARNING: Accessible safety surfacing material is required beneath and around this equipment that has a critical height value (Fall Height) appropriate for the highest accessible part of this equipment. Refer to the CPSC'S Handbook For Public Playground Safety, Section 4: Surfacing.

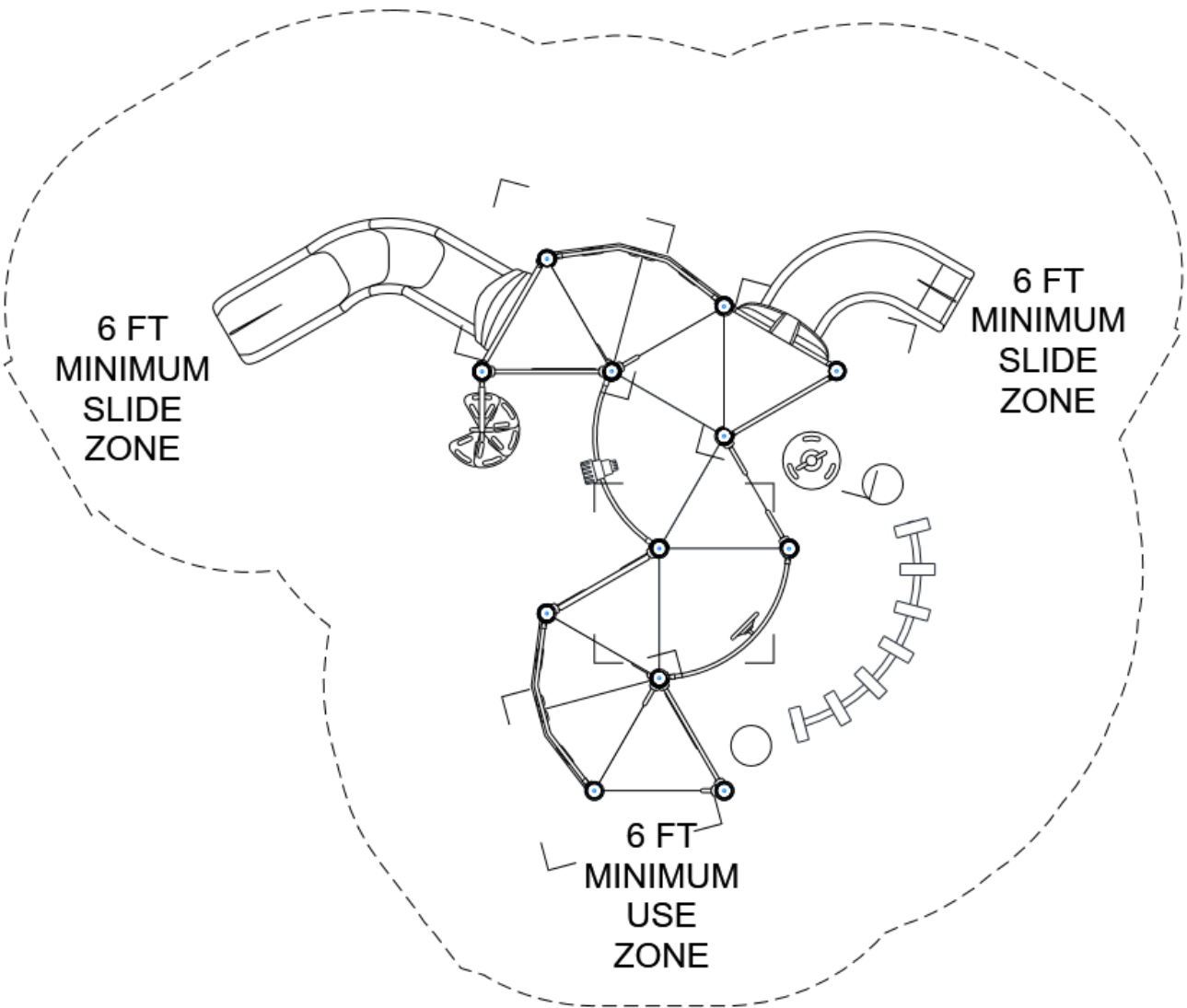

**R50AB6B5A**  
**SW VIEW**

**R5**

FOR KIDS  
AGES  
2-5

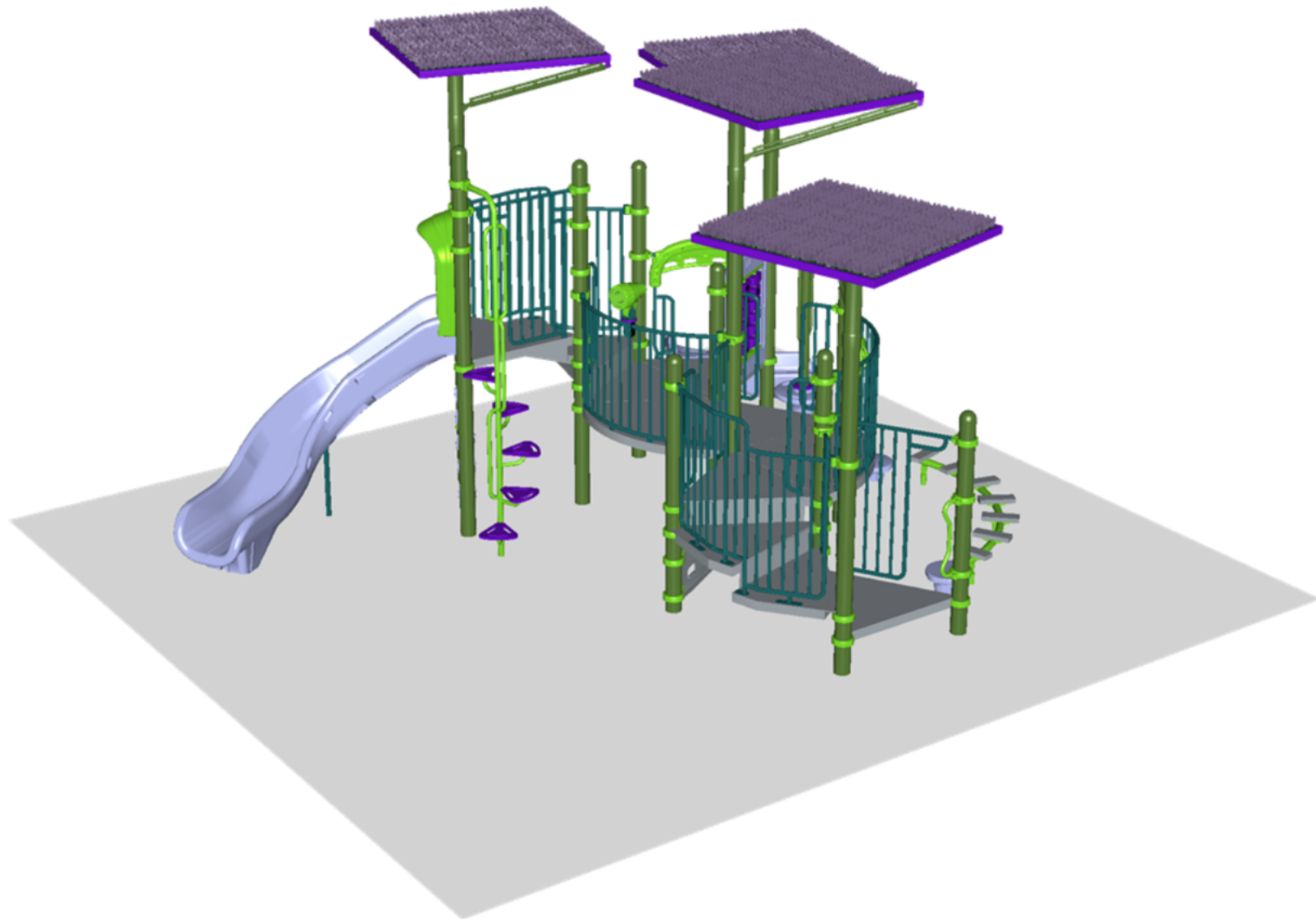

**STRUCTURE #** R50AB6B5A  
**PROJECT #** R50AB6B5A  
**DATE** 8/5/2025

**R50AB6B5A**  
**NE VIEW**

**R5**

FOR KIDS  
AGES  
2-5



**STRUCTURE #** R50AB6B5A  
**PROJECT #** R50AB6B5A  
**DATE** 8/5/2025

**R50AB6B5A**
**Project #** R50AB6B5A

**Date** 8/5/2025

Item / Part Number	Description	Qty
<b>[R50AB6B5A]</b>		
HS-1004-R	Collars	50
A2-2430	Boardwalk, Curved (90 Degree)	1
GF-7002	Dome Cap, R5	8
S-1009-R5-09ft	Post, 09ft R5	1
S-1010-R5-10ft	Post, 10ft R5	4
S-1012-R5-12ft	Post, 12ft R5	2
S-1013-R5-13ft	Post, 13ft R5	2
S-1014-R5-14ft	Post, 14ft R5	3
S-11021-L	Spiral Deck, (Left, 24in)	1
S-11021-R	Spiral Deck, (Right, 24in)	1
S-1102-R5	Tri-Deck	6
S-1107-R5	Curved Deck	2
S-1212-3R5	Climber, Vertical Step 30-36in	1
S-1233-3-HW	Climber, Disc 30-36in (w/ HW)	1
S-1234-DSC-5R5	Climber, Spiral Step 60in	1
S-1303-R5	Single Slide SitDown Hood	1
S-1309-2-R5	Half Walls (Pair) R5	2
S-1313-R5	Handle	1
S-1314-R5L	Access Wall (Left)	2
S-1316-RE-R5	Roto Twister Entry Panel	1
S-1328-1830-R5	Steel Wall (Curved w/ Telescope)	1
S-1328-RMT	Steel Wall (Curved w/ Wheel)	1
S-1414	Lily Pad Step 12-18in	1
S-1414-6	Lily Pad Step 06in	1
S-1608-R5	Memory Panel	1
S-1661-R5	Panel Pal, Bell	1
S-1664-R5	Panel Pal, Tic-Tac-Toe	1
S-1705-3	Slide, Quarter Turn 36in	1
S-1710-5-LL	Slide, Twister 60in (L2)	1
S-1813-1P	Metal Roof, LeafScape	4