

R50853D8A

TOP VIEW

ADA ACCESSIBILITY GUIDELINES - ADAAG CONFORMANCE

ELEVATED	ACCESSIBLE	RAMP ACCESSIBLE	GROUND	TYPES
11	11/6	0/0	5/4	3/3
CHILD CAPACITY	75	MAX FALL HEIGHT	60	

R5

FOR KIDS
AGES
5-12

GENERAL NOTES

This conceptual plan is based on information provided prior to construction. Detailed site information, including the following, should be obtained, evaluated, and utilized in the final project design. Exact site dimensions, topography, existing utilities, soil conditions and drainage solutions.

WARNING: Accessible safety surfacing material is required beneath and around this equipment that has a critical height value (Fall Height) appropriate for the highest accessible part of this equipment. Refer to the CPSC'S Handbook For Public Playground Safety, Section 4: Surfacing.

(4) Single Post Angled LeafScape Roof

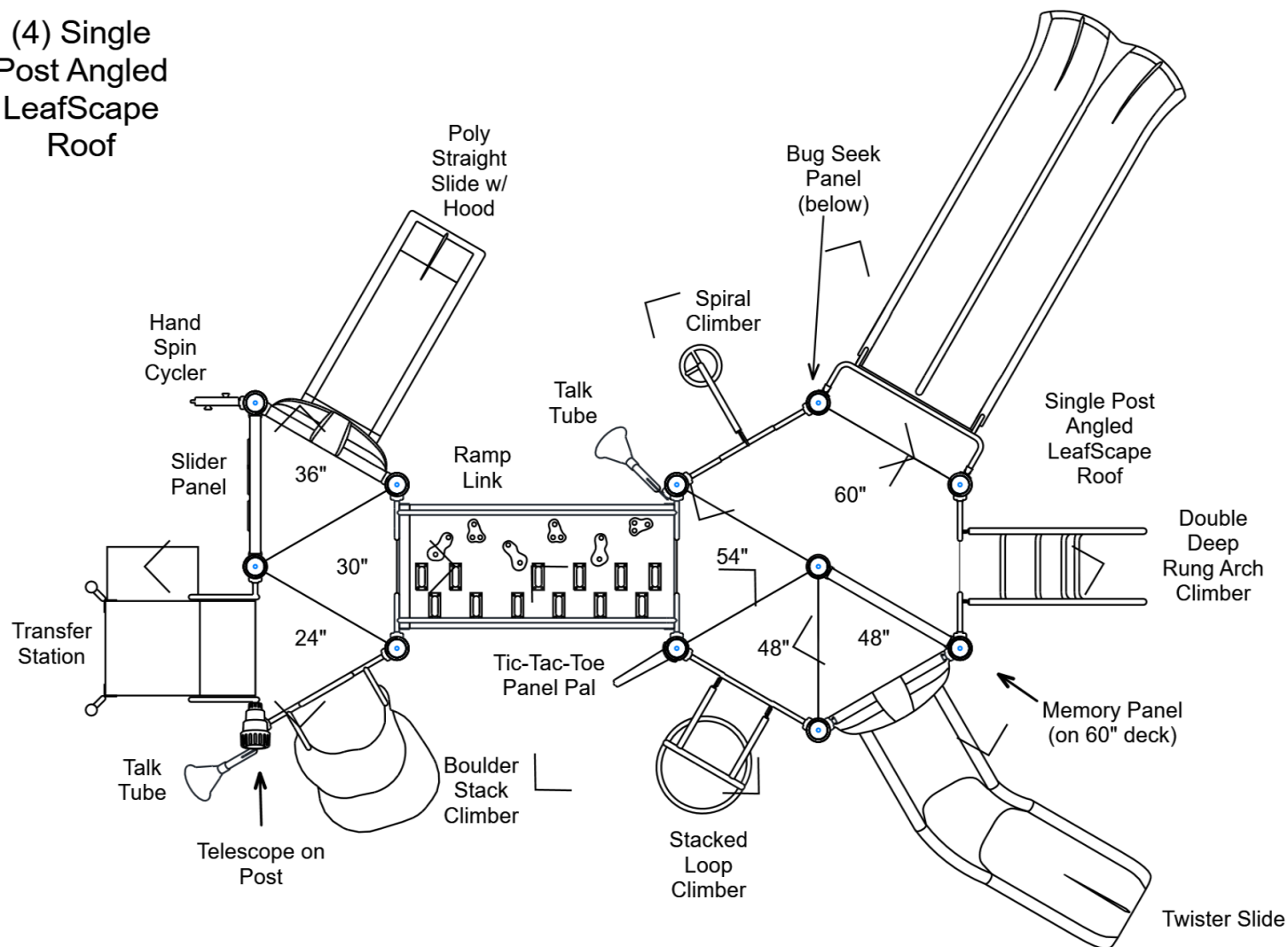

STRUCTURE # R50853D8A
PROJECT # R50853D8A
DATE 8/5/2025

Playcraft Direct, Inc.

MIN. USE ZONE 38' x 34' (11.343m x 10.299m)

R50853D8A SITE PLAN

ADA ACCESSIBILITY GUIDELINES - ADAAG CONFORMANCE

ELEVATED	ACCESSIBLE	RAMP ACCESSIBLE	GROUND	TYPES
11	11/6	0/0	5/4	3/3

R5**FOR KIDS
AGES
5-12**

GENERAL NOTES

This Preliminary Site Plan is based on measurements that were provided in the initial planning phase. All dimensions must be verified prior to the submission of a purchase order. Playcraft Systems will not be held responsible for any discrepancies between actual dimensions and dimensions submitted in the planning phase.

The Minimum Use Zone for a play structure is based on the product design at the time of proposal. Components and structure designs may be subject to change which may affect dimensions. Therefore, before preparing the site, we strongly recommend obtaining final drawings from the factory (available after the order is placed and included in the Assembly Manual).

WARNING: Accessible safety surfacing material is required beneath and around this equipment that has a critical height value (Fall Height) appropriate for the highest accessible part of this equipment. Refer to the CPSC'S Handbook For Public Playground Safety, Section 4: Surfacing.

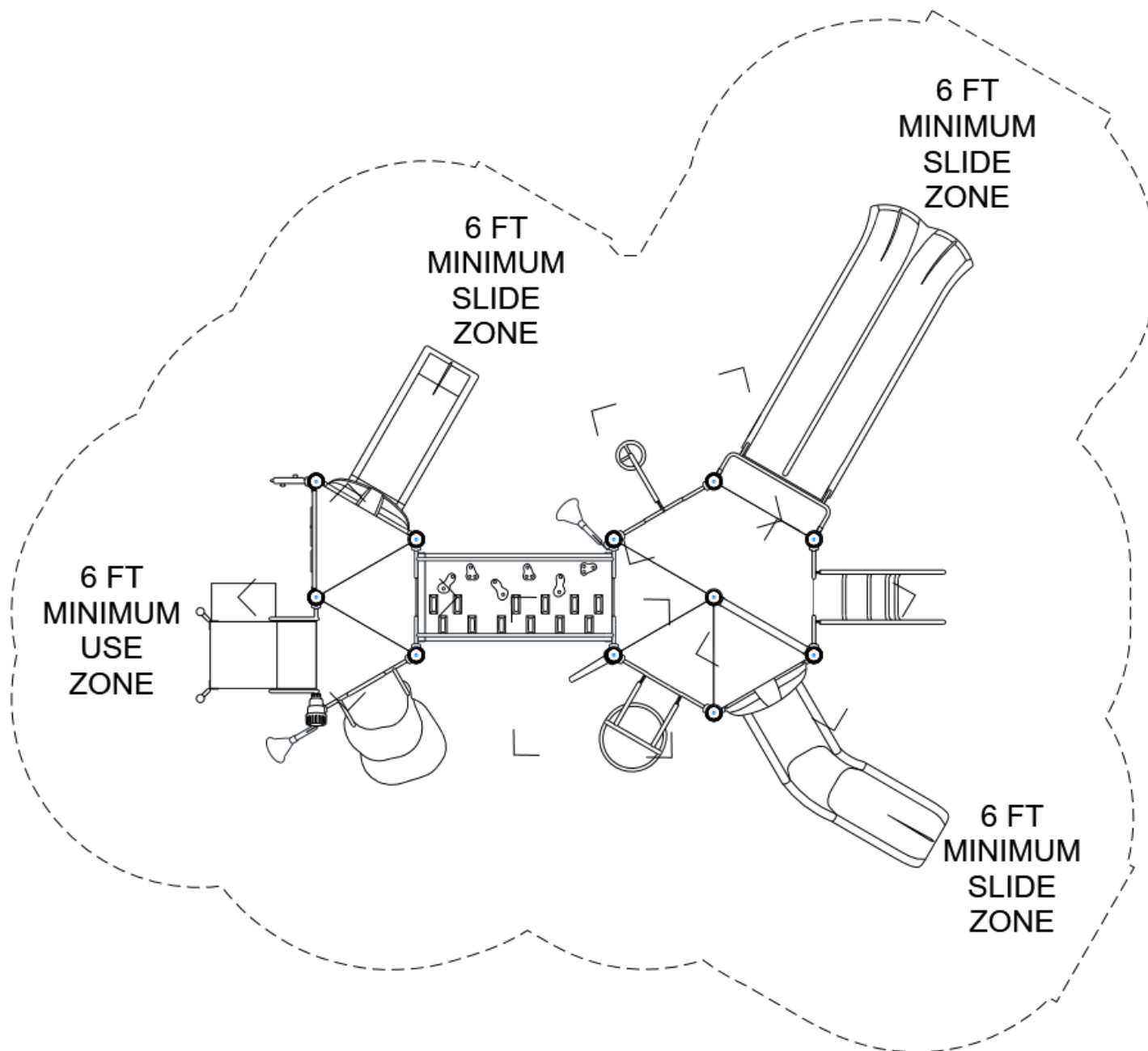

PROJECT #
DATE

R50853D8A
8/5/2025

Playcraft Direct, Inc.

MIN. USE ZONE 38' x 34' (11.342m x 10.298m)

R50853D8A
SW VIEW

R5

FOR KIDS
AGES
5-12



STRUCTURE # R50853D8A
PROJECT # R50853D8A
DATE 8/5/2025

R50853D8A
NE VIEW

R5

FOR KIDS
AGES
5-12



STRUCTURE # R50853D8A
PROJECT # R50853D8A
DATE 8/5/2025

R50853D8A

Project # R50853D8A

Date 8/5/2025

Item / Part Number	Description	Qty
[R50853D8A]		
HS-1004-R	Collars	54
GF-7002	Dome Cap, R5	7
S-1009-R5-09ft	Post, 09ft R5	1
S-1010-R5-10ft	Post, 10ft R5	3
S-1011-R5-11ft	Post, 11ft R5	1
S-1012-R5-12ft	Post, 12ft R5	3
S-1013-R5-13ft	Post, 13ft R5	1
S-1014-R5-14ft	Post, 14ft R5	1
S-1015-R5-15ft	Post, 15ft R5	2
S-1102-R5	Tri-Deck	6
S-1103-R5	Hex Deck, Half (5 Post)	1
S-1110-R	Filler, 12in	1
S-1209-12-R5	Transfer Station, 24in-L	1
S-1223-5R	Climber, Spiral 54-60in	1
S-1224-4R	Climber, Stacked Loop 42-48in	1
S-1275-5R5	Climber, Double Deep Rung Arch 54-60in	1
S-1290-D3-R5	Climber, Boulder Stack 18-24in	1
S-1303-R5	Single Slide SitDown Hood	1
S-1303-TW-R5	Twister Entry Panel w/ Hood	1
S-1310-R5	Transition Wall	1
S-1525-R5	Link, Ramp (Inclined 24in)	1
S-1608-R5	Memory Panel	1
S-1614-R5	Slider Panel	1
S-1618-Bug-R5G	Seek Panel (Bug)	1
S-1664-R5	Panel Pal, Tic-Tac-Toe	1
S-1701-3	Slide, Single 36in (Straight)	1
S-1702-1122-5	Slide, Double 60in (w/ Extn)	1
S-1710-4-L	Slide, Twister 48in (L)	1
S-1813-1PA	Metal Roof, LeafScape Angled	4
S-1831-R5	Telescope (Post Mounted)	1
S-1910-R5	Talk Tube (Post Mounted, Left)	2
S-1932-R5	Hand Spin Cyler (Post Mounted)	1