

REVCEE56C

TOP VIEW

ADA ACCESSIBILITY GUIDELINE - ADAAG CONFORMANCE

ELEVATED	ACCESSIBLE	RAMP ACCESSIBLE	GROUND	TYPES
2	2/1	0	18/1	3/1



GENERAL NOTES:

This conceptual plan is based on information provided prior to construction. Detailed site information, including the following, should be obtained, evaluated, and utilized in the final project design. Exact site dimensions, topography, existing utilities, soil conditions and drainage solutions.

WARNING: Accessible safety surfacing material is required beneath and around this equipment that has a critical height value (Fall Height) appropriate for the highest accessible part of this equipment. Refer to the CPSC's Handbook For Public Playground Safety, Section 4: Surfacing.

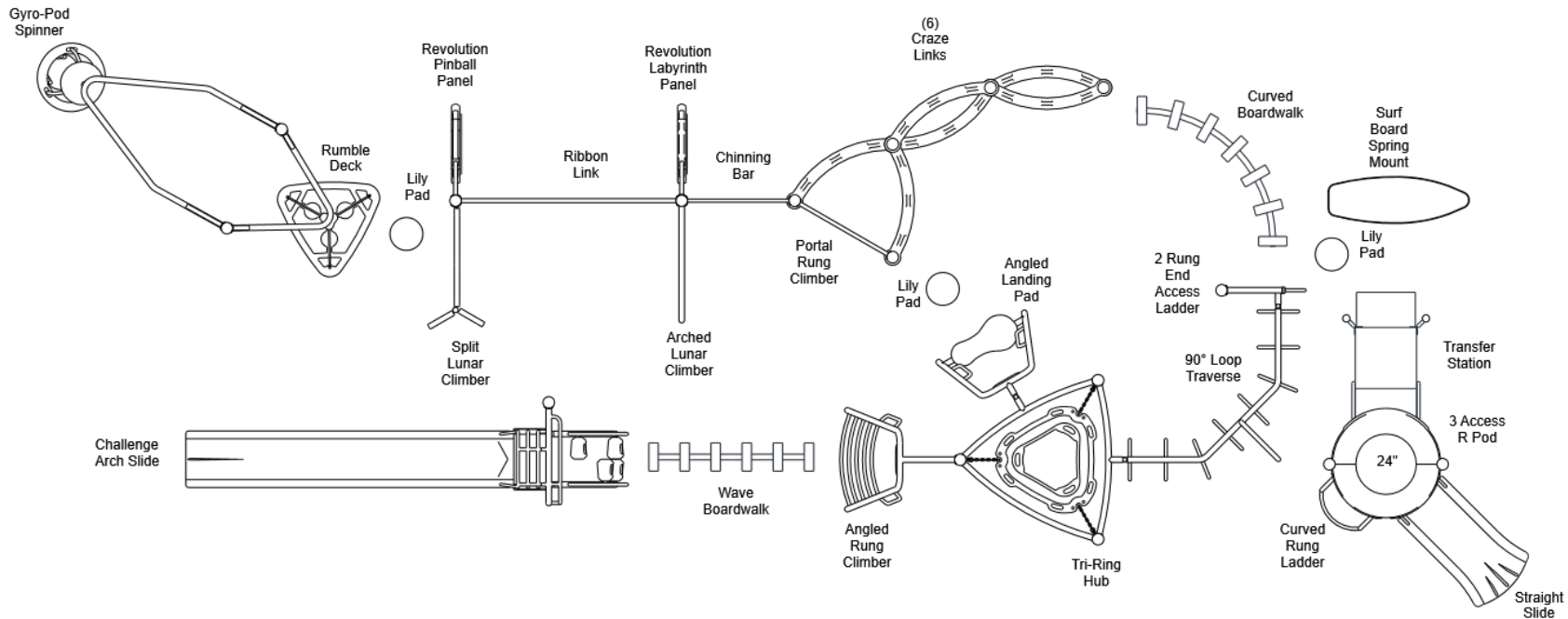

STRUCTURE#: REVCEE56C

PROJECT#: REVCEE56C

DATE: 5/5/2020 | DRAWN BY:

MIN. USE ZONE: 65' x 32'

PLAYCRAFT REP:

Playcraft Direct, Inc.



REVCEE56C
SITE PLAN

ADA ACCESSIBILITY GUIDELINE - ADAAG CONFORMANCE

ELEVATED	ACCESSIBLE	RAMP ACCESSIBLE	GROUND	TYPES
2	2/1	0	18/1	3/1



FOR KIDS
AGES
5-12

GENERAL NOTES:

This Preliminary Site Plan is based on measurements that were provided in the initial planning phase. All dimensions must be verified prior to the submission of a purchase order. Playcraft Systems will not be held responsible for any discrepancies between actual dimensions and dimensions submitted in the planning phase.

The Minimum Use Zone for a play structure is based on the product design at the time of proposal. Components and structure designs may be subject to change which may affect dimensions. Therefore, before preparing the site, we strongly recommend obtaining final drawings from the factory (available after the order is placed and included in the Assembly Manual).

WARNING: Accessible safety surfacing material is required beneath and around this equipment that has a critical height value (Fall Height) appropriate for the highest accessible part of this equipment. Refer to the CPSC's Handbook For Public Playground Safety, Section 4: Surfacing.

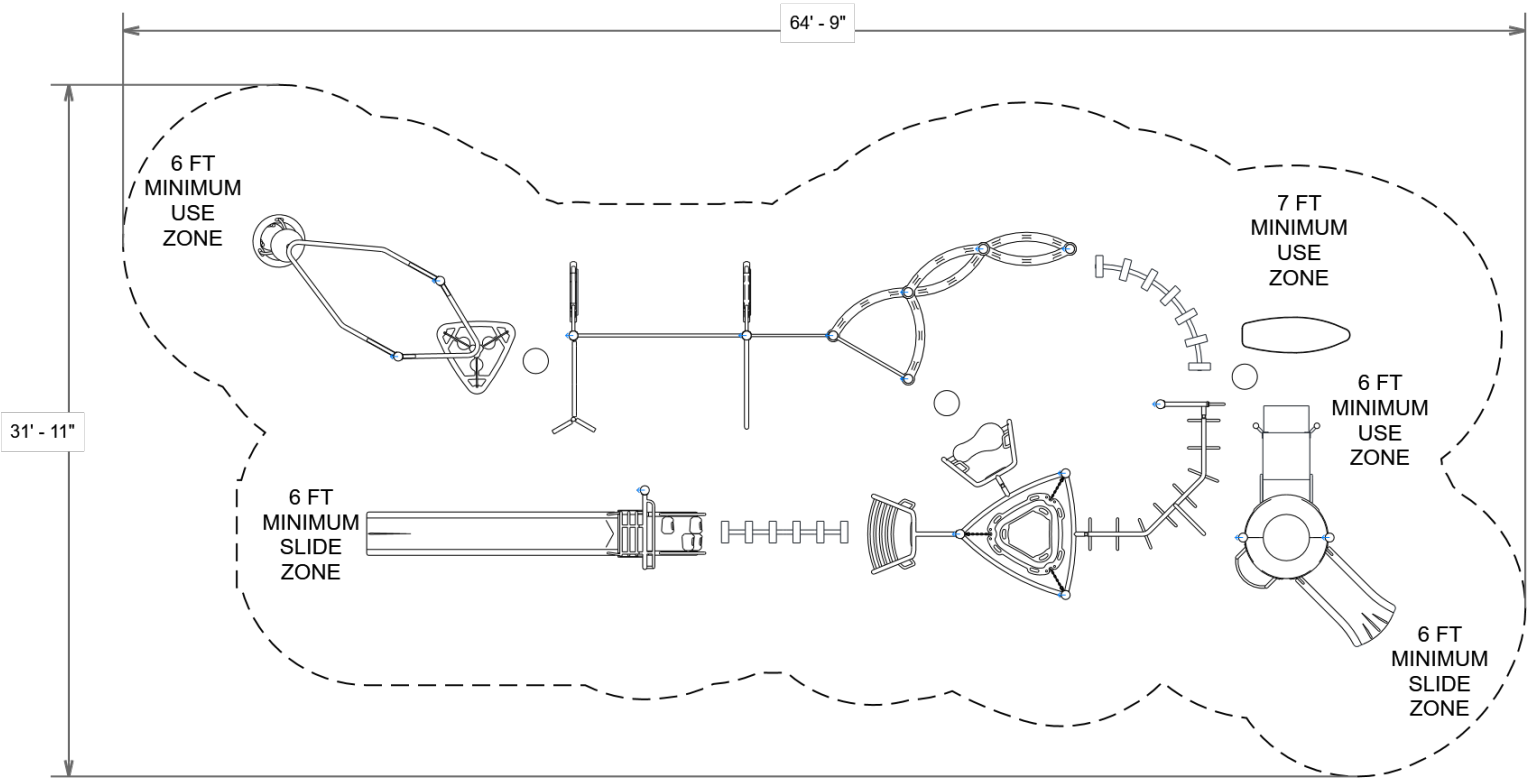

PROJECT#: REVCEE56C

DATE: 5/5/2020 | DRAWN BY:

MIN. USE ZONE: 65' x 32'

PLAYCRAFT REP:

Playcraft Direct, Inc.



REVCEE56C
SW VIEW

RV5

FOR KIDS
AGES
5-12



STRUCTURE#: REVCEE56C

PROJECT#: REVCEE56C

DATE: 5/5/2020 | DRAWN BY:



REVCEE56C
NE VIEW

RV5

FOR KIDS
AGES
5-12



STRUCTURE#: REVCEE56C

PROJECT#: REVCEE56C

DATE: 5/5/2020 | DRAWN BY:

PLAYCRAFT
SYSTEMS



Bill of Materials

REVCEE56C

Project# REVCEE56C

5/5/2020

Item	Description	Quantity
REVCEE56C		
A2-2430	Boardwalk, Curved (90 Degree)	1
A2-2435-W	Boardwalk, Wave	1
A2-2437-S	Surf Board (Spring)	1
S-10090-RV5	Post (090in) RV5	1
S-10108-RV5	Post (108in) RV5	3
S-10120-RV5	Post (120in) RV5	4
S-10126-RV5	Post (126in) RV5	1
S-10132-RV5	Post (132in) RV5	5
S-10138-RV5	Post (138in) RV5	1
S-10162-RV5	Post (162in) RV5	1
S-12014-6RV-R	Slide, 72in (Challenge Arch, Right)	1
S-1209-12RV	Contour Transfer Station 24in (C)	1
S-1257-RV5	Climber, Portal Rung	1
S-12592-RV	Climber, Split Lunar (Post Mounted)	1
S-1268-RV5	Climber, Ribbon Link	1
S-1278-RV5	Climber, Angled Rung	1
S-1282-2RV	Climber, Curved Rung Ladder 24in	1
S-1286-RV5	Climber, Arched Lunar	1
S-1296-RV	Craze Link RV	6
S-1404-RV2	End Access Ladder (2 Rung)	1
S-1411-2RV90	Loop Traverse (90 Degree w/ Two Housings)	1
S-1414	Lily Pad Step 12-18in	3
S-1533-RV	3 Access R Pod RV	1
S-1631-RV	Pinball Panel	1
S-1634-RV	Labyrinth Panel	1



PLAYCRAFT[®]
S Y S T E M S

**Bill of Materials
(continued)**

Item	Description	Quantity
S-1701-2RV	Contour Straight Slide 24in	1
S-1930-RV	Chinning Bar RV	1
S-1959-3RV-2	Tri-Ring Hub (3 Section, 2 Mount)	1
S-1971-RV	Rumble Deck	1
S-1974-RV	Gyro-Pod Spinner	1
S-21004-RTRV	Hanger (Right Turn)	1
S-21264-MNT-RV5	Climber, Angled Landing Pad (Housing)	1
HS-1007-RV	Extra Hardware	2