

REV952CEA
TOP VIEW

ADA ACCESSIBILITY GUIDELINES - ADAAG CONFORMANCE

ELEVATED	ACCESSIBLE	RAMP ACCESSIBLE	GROUND	TYPES
0	0/0	0/0	7/0	3/0
CHILD CAPACITY	34	MAX FALL HEIGHT	48	

RV5

FOR KIDS
AGES
5-12

GENERAL NOTES

This conceptual plan is based on information provided prior to construction. Detailed site information, including the following, should be obtained, evaluated, and utilized in the final project design. Exact site dimensions, topography, existing utilities, soil conditions and drainage solutions.

WARNING: Accessible safety surfacing material is required beneath and around this equipment that has a critical height value (Fall Height) appropriate for the highest accessible part of this equipment. Refer to the CPSC'S Handbook For Public Playground Safety, Section 4: Surfacing.

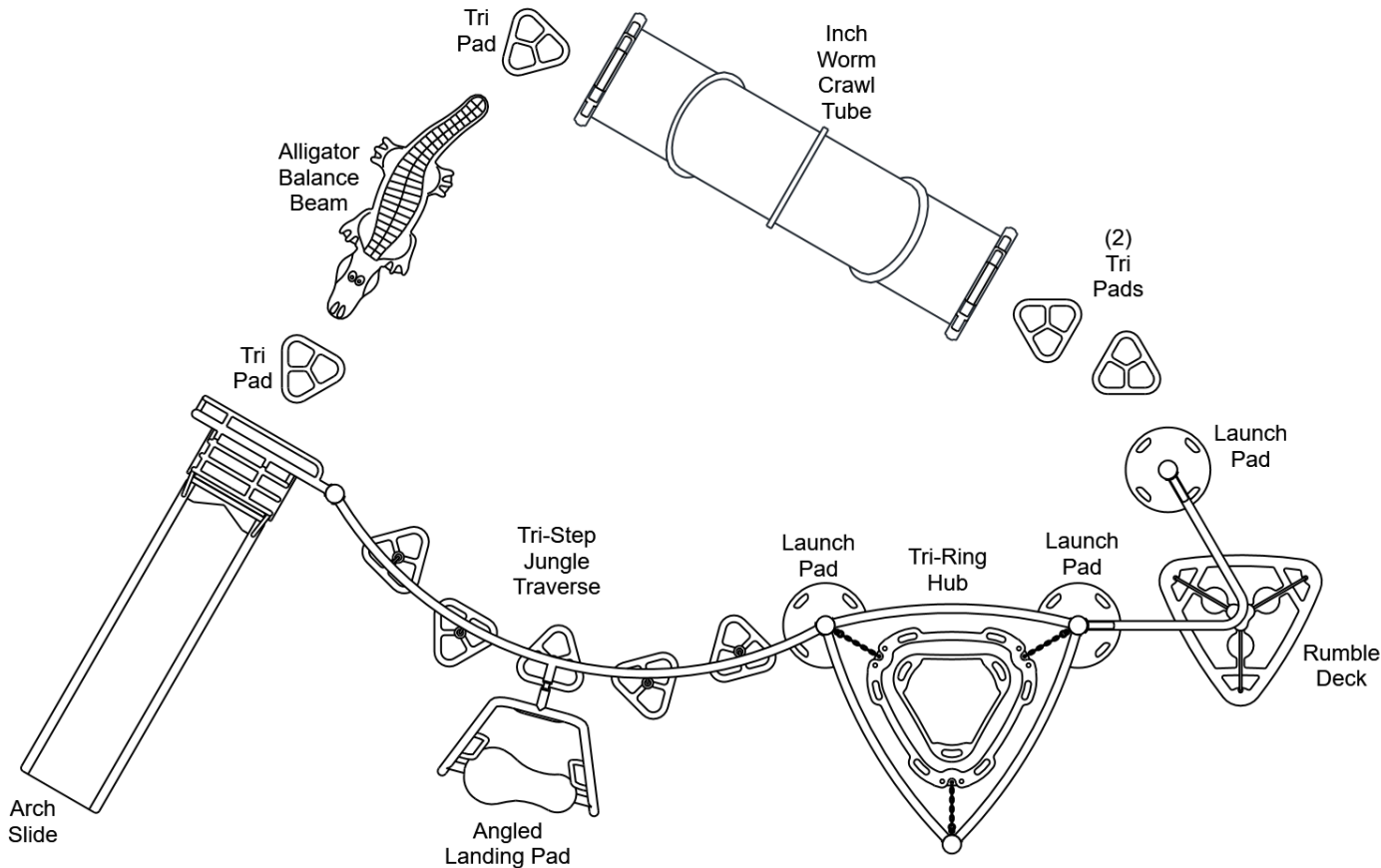

STRUCTURE # REV952CEA
PROJECT # REV952CEA
DATE 10/5/2023

Playcraft Direct, Inc.
MIN. USE ZONE 41' x 31' (12.486m x 9.308m)



ELEVATED	ACCESSIBLE	RAMP ACCESSIBLE	GROUND	TYPES
0	0/0	0/0	7/0	3/0

RV5

FOR KIDS
AGES
5-12

GENERAL NOTES

This Preliminary Site Plan is based on measurements that were provided in the initial planning phase. All dimensions must be verified prior to the submission of a purchase order. Playcraft Systems will not be held responsible for any discrepancies between actual dimensions and dimensions submitted in the planning phase.

The Minimum Use Zone for a play structure is based on the product design at the time of proposal. Components and structure designs may be subject to change which may affect dimensions. Therefore, before preparing the site, we strongly recommend obtaining final drawings from the factory (available after the order is placed and included in the Assembly Manual).

WARNING: Accessible safety surfacing material is required beneath and around this equipment that has a critical height value (Fall Height) appropriate for the highest accessible part of this equipment. Refer to the CPSC'S Handbook For Public Playground Safety, Section 4: Surfacing.

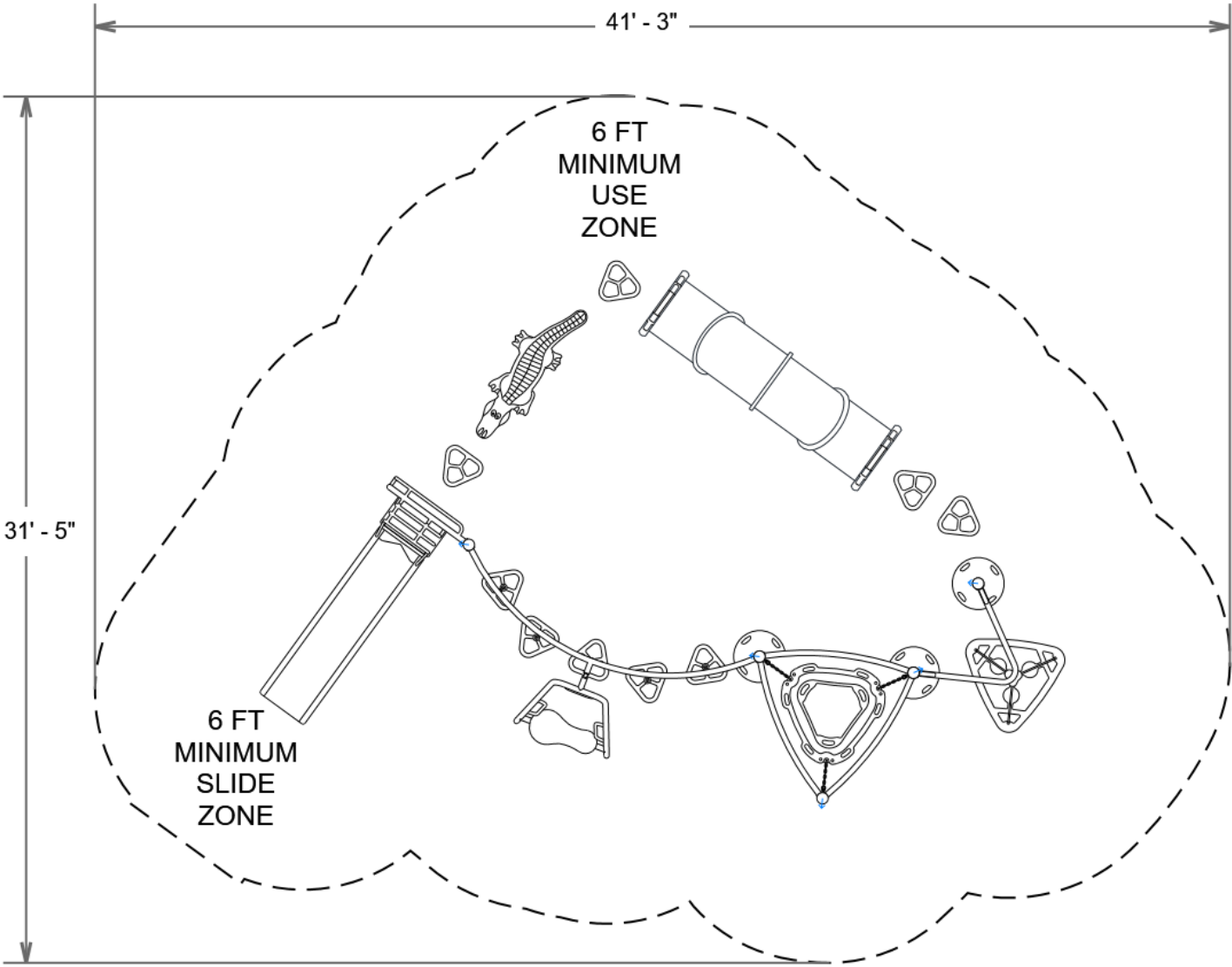

REV952CEA
SW VIEW

RV5

FOR KIDS
AGES
5-12

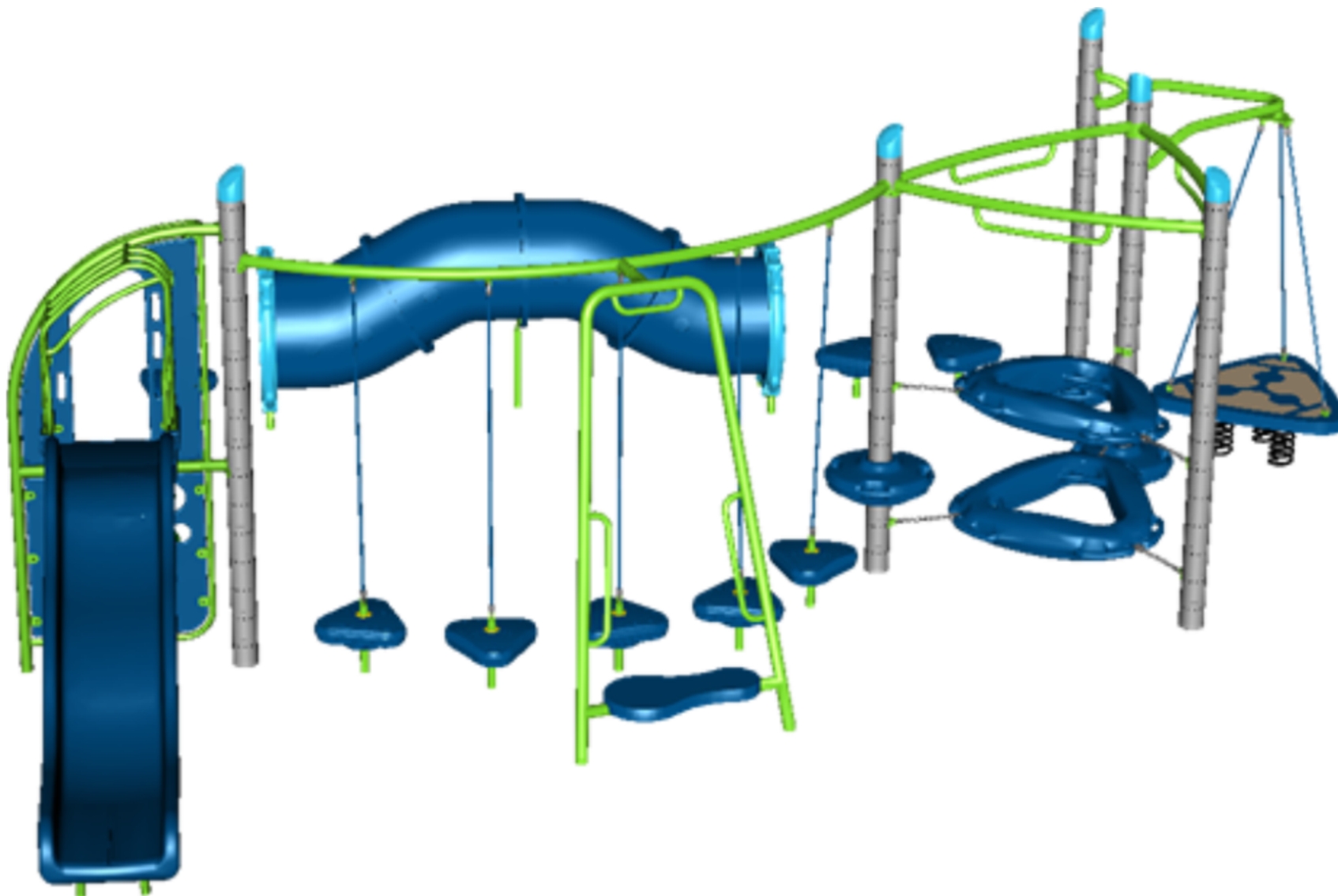

STRUCTURE # REV952CEA
PROJECT # REV952CEA
DATE 10/5/2023

REV952CEA
NE VIEW

RV5

FOR KIDS
AGES
5-12

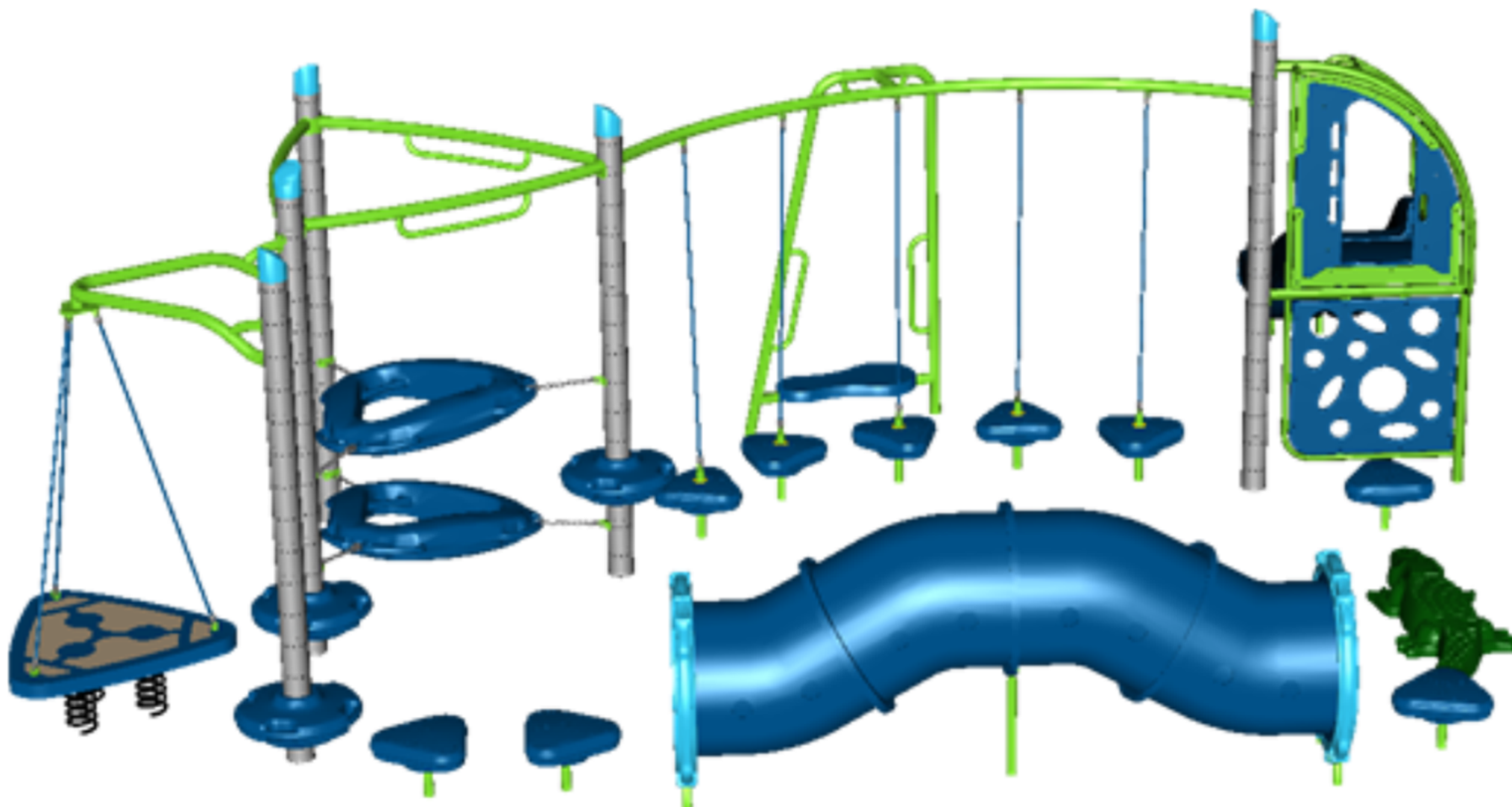

STRUCTURE # REV952CEA
PROJECT # REV952CEA
DATE 10/5/2023

REV952CEA

Project # REV952CEA

Date 10/5/2023

Item / Part Number	Description	Qty
[REV952CEA]		
A2-2341	Crawl Tube, Inch Worm	1
A2-2426	Balance Beam (Alligator)	1
S-10132-RV5	Post (132in) RV5	4
S-10138-RV5	Post (138in) RV5	1
S-12013-4-RV-L	Slide, 48in (Arch, Left)	1
S-1437-RV	Tri-Step Jungle	1
S-1959-2RV	Tri-Ring Hub (2 Section)	1
S-1961-RV	Tri Pad	4
S-1971-RV	Rumble Deck	1
S-21263-RV	Launch Pad RV	3
S-21264-MNT-RV5	Climber, Angled Landing Pad (HSE)	1
HS-1007-RV	Extra Hardware	2