

R50DFA07A TOP VIEW

ADA ACCESSIBILITY GUIDELINE - ADAAG CONFORMANCE

ELEVATED	ACCESSIBLE	RAMP ACCESSIBLE	GROUND	TYPES
13	13/7	13	7/0	3/0

R5

FOR KIDS
AGES
2-12

GENERAL NOTES:

This conceptual plan is based on information provided prior to construction. Detailed site information, including the following, should be obtained, evaluated, and utilized in the final project design. Exact site dimensions, topography, existing utilities, soil conditions and drainage solutions.

WARNING: Accessible safety surfacing material is required beneath and around this equipment that has a critical height value (Fall Height) appropriate for the highest accessible part of this equipment. Refer to the CPSC's Handbook For Public Playground Safety, Section 4: Surfacing.

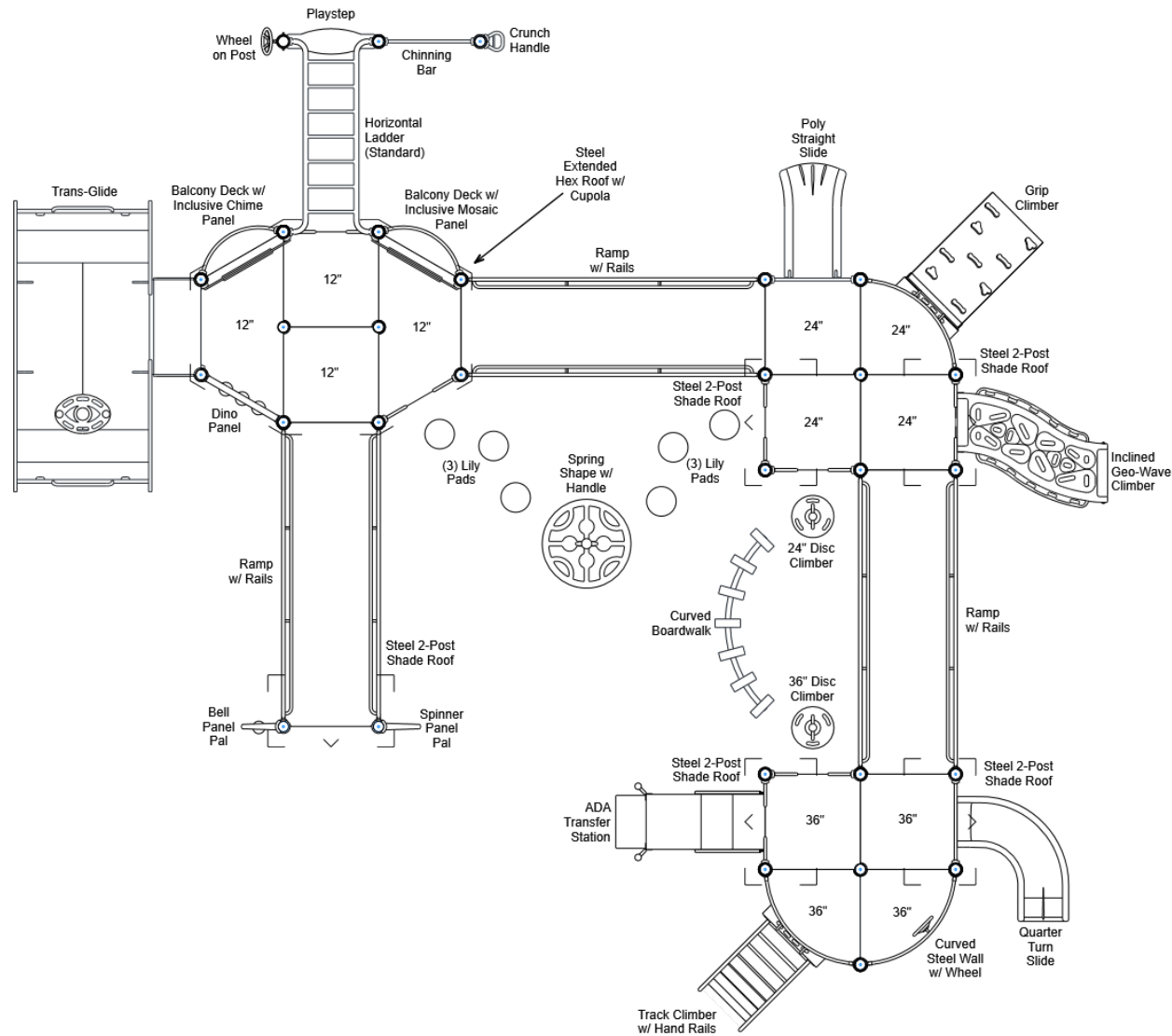

STRUCTURE#: R50DFA07A

PROJECT#: R50DFA07A

DATE: 1/8/2020 | DRAWN BY: Jefferson

MIN. USE ZONE: 56' x 52'

PLAYCRAFT REP:

Playcraft Direct, Inc.



R50DFA07A SITE PLAN

ADA ACCESSIBILITY GUIDELINE - ADAAG CONFORMANCE

ELEVATED	ACCESSIBLE	RAMP ACCESSIBLE	GROUND	TYPES
13	13/7	13	7/0	3/0



GENERAL NOTES:

This Preliminary Site Plan is based on measurements that were provided in the initial planning phase. All dimensions must be verified prior to the submission of a purchase order. Playcraft Systems will not be held responsible for any discrepancies between actual dimensions and dimensions submitted in the planning phase.

The Minimum Use Zone for a play structure is based on the product design at the time of proposal. Components and structure designs may be subject to change which may affect dimensions. Therefore, before preparing the site, we strongly recommend obtaining final drawings from the factory (available after the order is placed and included in the Assembly Manual).

WARNING: Accessible safety surfacing material is required beneath and around this equipment that has a critical height value (Fall Height) appropriate for the highest accessible part of this equipment. Refer to the CPSC'S Handbook For Public Playground Safety, Section 4: Surfacing.

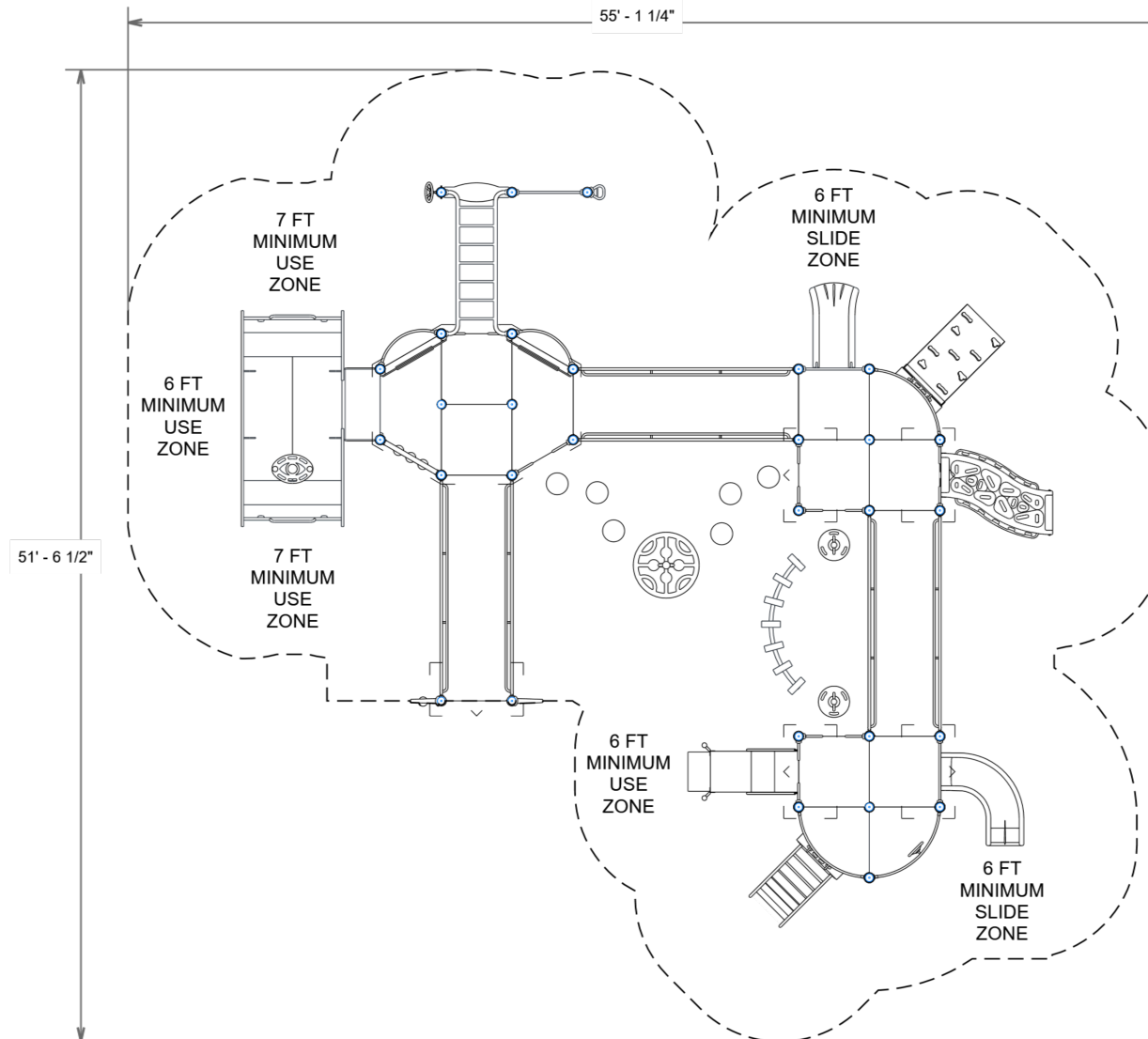

PROJECT#: R50DFA07A

DATE: 1/8/2020 | DRAWN BY: Jefferson

MIN. USE ZONE: 56' x 52'

PLAYCRAFT REP:

Playcraft Direct, Inc.



R50DFA07A
SW VIEW

R5

FOR KIDS
AGES
2-12



STRUCTURE#: R50DFA07A

PROJECT#: R50DFA07A

DATE: 1/8/2020 | DRAWN BY: Jefferson

R50DFA07A
NE VIEW

R5

FOR KIDS
AGES
2-12

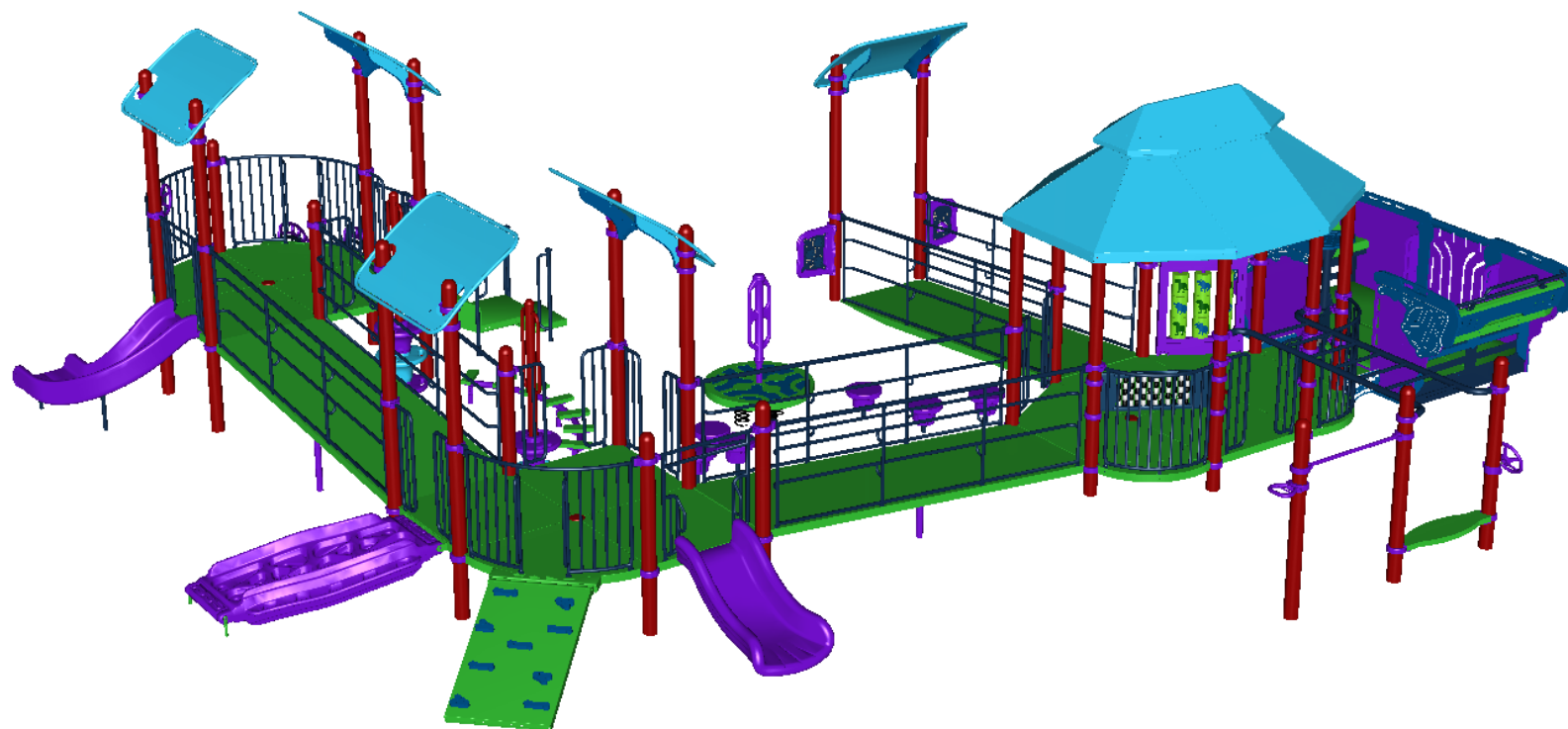

STRUCTURE#: R50DFA07A

PROJECT#: R50DFA07A

DATE: 1/8/2020 | DRAWN BY: Jefferson





Bill of Materials

R50DFA07A
Jefferson Evans

Project# R50DFA07A
1/8/2020

Item	Description	Quantity
R50DFA07A		
HS-1004-R	Collars	89
A2-2430	Boardwalk, Curved (90 Degree)	1
A2-2444	Spring Shape w/ Handles (Round)	1
GF-7001	Flat Cap, R5	4
GF-7002	Dome Cap, R5	18
S-1005-R5F-9-012-051	Post, 5ft, 12in (51in)	2
S-1006-R5F-9-024-063	Post, 6ft, 24in (63in)	1
S-1007-R5F-9-036-075	Post, 7ft, 36in (75in)	1
S-1009-R5-09ft	Post, 09ft R5	6
S-1010-R5-10ft	Post, 10ft R5	2
S-1011-R5-11ft	Post, 11ft R5	8
S-1012-R5-12ft	Post, 12ft R5	2
S-1013-R5-13ft	Post, 13ft R5	4
S-1014-R5-14ft	Post, 14ft R5	4
S-1101-R5	Square Deck	7
S-1103-R5	Hex Deck, Half (5 Post)	2
S-1107-R5	Curved Deck	3
S-1109-R5	Balcony Deck	2
S-1208-R-RAIL12	Ramp 144in (Ground w/ Rails, Inclined)	1
S-1208-R-RAIL24	Ramp 144in (06-12in High w/ Rails, Inclined)	1
S-1208-R-RAIL36	Ramp 144in (18-24in High w/ Rails, Inclined)	1
S-1209-24RHW	Transfer Station, 36in-C (RHW)	1
S-1216-2CR5	Climber, Grip 18-24in	1
S-1232-3-CRVHR	Climber, Track 30-36in (Curved w/ Hand Rails)	1
S-1233-2-HW	Climber, Disc 18-24in (w/ HW)	1



Bill of Materials (continued)

Item	Description	Quantity
S-1233-3-HW	Climber, Disc 30-36in (w/ HW)	1
S-1249-DGH	Climber, Incl. Geo-Wave 18-24in (Horiz, DTG Right)	1
S-1304-R5	Single Slide SitDown Wall	1
S-1309-2-R5	Half Walls (Pair) R5	6
S-1328-RMT	Steel Wall (Curved w/ Wheel)	1
S-1406-90R5	Traverse, Horizontal Ladder (7-Rung)	1
S-1414	Lily Pad Step 12-18in	5
S-1414-30	Lily Pad Step 24in	1
S-1606-R5	Dino Panel	1
S-1661-R5	Panel Pal, Bell	1
S-1666-R5	Panel Pal, Spinner	1
S-1686-R5	Inclusive Panel, Mosaic	1
S-1687-R5	Inclusive Panel, Chime	1
S-1701-2R5V2	Slide, Single 24-30in (Straight)	1
S-1705-3	Slide, Quarter Turn 36in	1
S-18012-R5	Metal Roof, 2-Post Shade	5
S-1806-R5STLCUP	Metal Roof, Hex (Extended w/ Cupola)	1
S-1812-R5	Driver Wheel (Post Mounted)	1
S-1930-R5	Chinning Bar	1
S-1937-R5	Crunch Handle	1
S-1962-R5	Playseat	1
S-1975-R5	Trans-Glide	1
HS-1100-2	Deck to Deck Hardware	14