

R50DDF20A  
TOP VIEW

ADA ACCESSIBILITY GUIDELINE - ADAAG CONFORMANCE

ELEVATED	ACCESSIBLE	RAMP ACCESSIBLE	GROUND	TYPES
12	12/6	0	7/4	3/3

R5

FOR KIDS  
AGES  
5-12

GENERAL NOTES:

This conceptual plan is based on information provided prior to construction. Detailed site information, including the following, should be obtained, evaluated, and utilized in the final project design. Exact site dimensions, topography, existing utilities, soil conditions and drainage solutions.

WARNING: Accessible safety surfacing material is required beneath and around this equipment that has a critical height value (Fall Height) appropriate for the highest accessible part of this equipment. Refer to the CPSC'S Handbook For Public Playground Safety, Section 4: Surfacing.

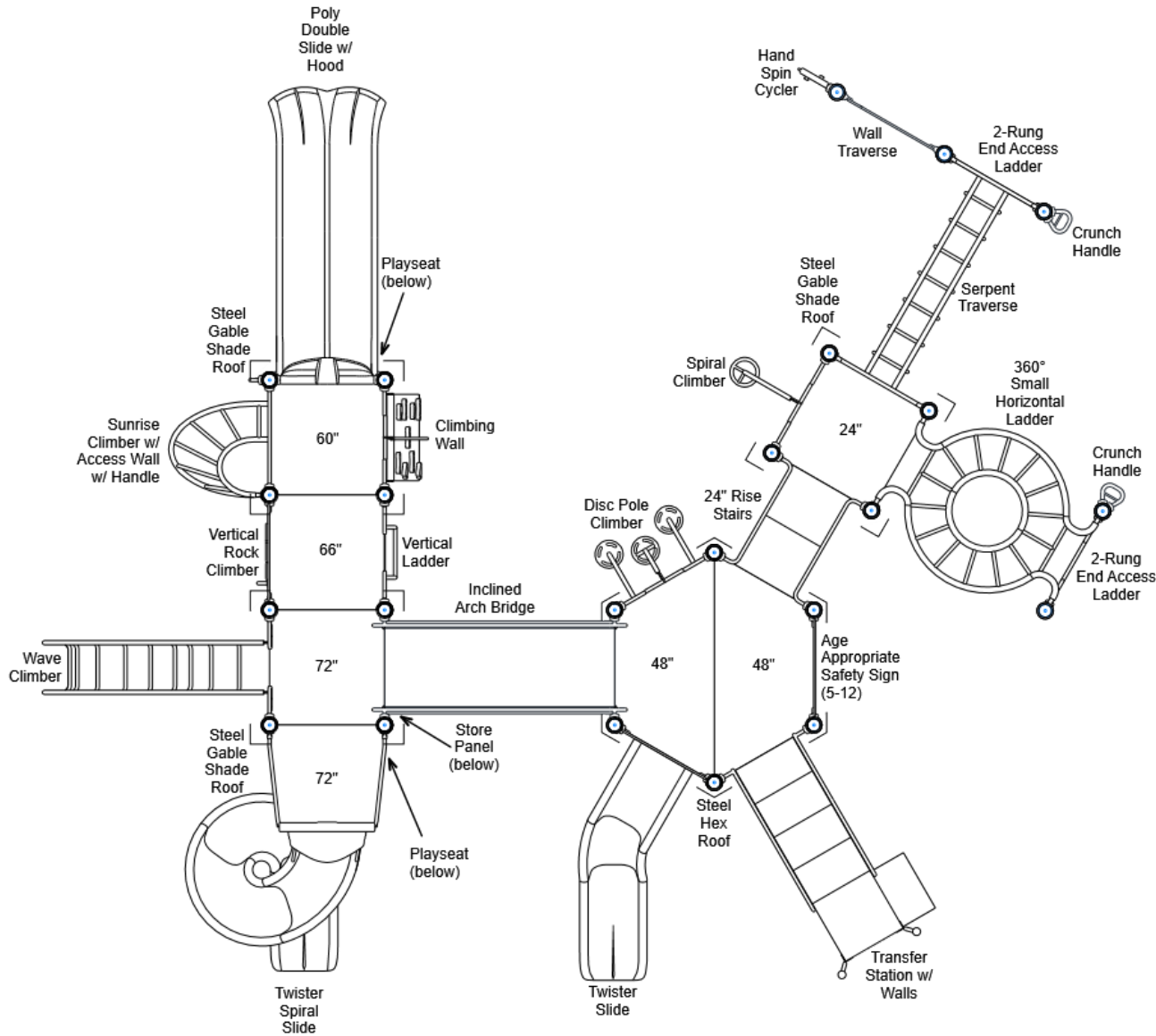

STRUCTURE#: R50DDF20A

PROJECT#: R50DDF20A

DATE: 6/2/2021 | DRAWN BY: Nathaniel

MIN. USE ZONE: 48' x 42'

PLAYCRAFT REP:

Playcraft Direct, Inc.



# R50DDF20A SITE PLAN

ADA ACCESSIBILITY GUIDELINE - ADAAG CONFORMANCE

ELEVATED	ACCESSIBLE	RAMP ACCESSIBLE	GROUND	TYPES
12	12/6	0	7/4	3/3

R5

FOR KIDS  
AGES  
5-12

## GENERAL NOTES:

This Preliminary Site Plan is based on measurements that were provided in the initial planning phase. All dimensions must be verified prior to the submission of a purchase order. Playcraft Systems will not be held responsible for any discrepancies between actual dimensions and dimensions submitted in the planning phase.

The Minimum Use Zone for a play structure is based on the product design at the time of proposal. Components and structure designs may be subject to change which may affect dimensions. Therefore, before preparing the site, we strongly recommend obtaining final drawings from the factory (available after the order is placed and included in the Assembly Manual).

**WARNING:** Accessible safety surfacing material is required beneath and around this equipment that has a critical height value (Fall Height) appropriate for the highest accessible part of this equipment. Refer to the CPSC's Handbook For Public Playground Safety, Section 4: Surfacing.

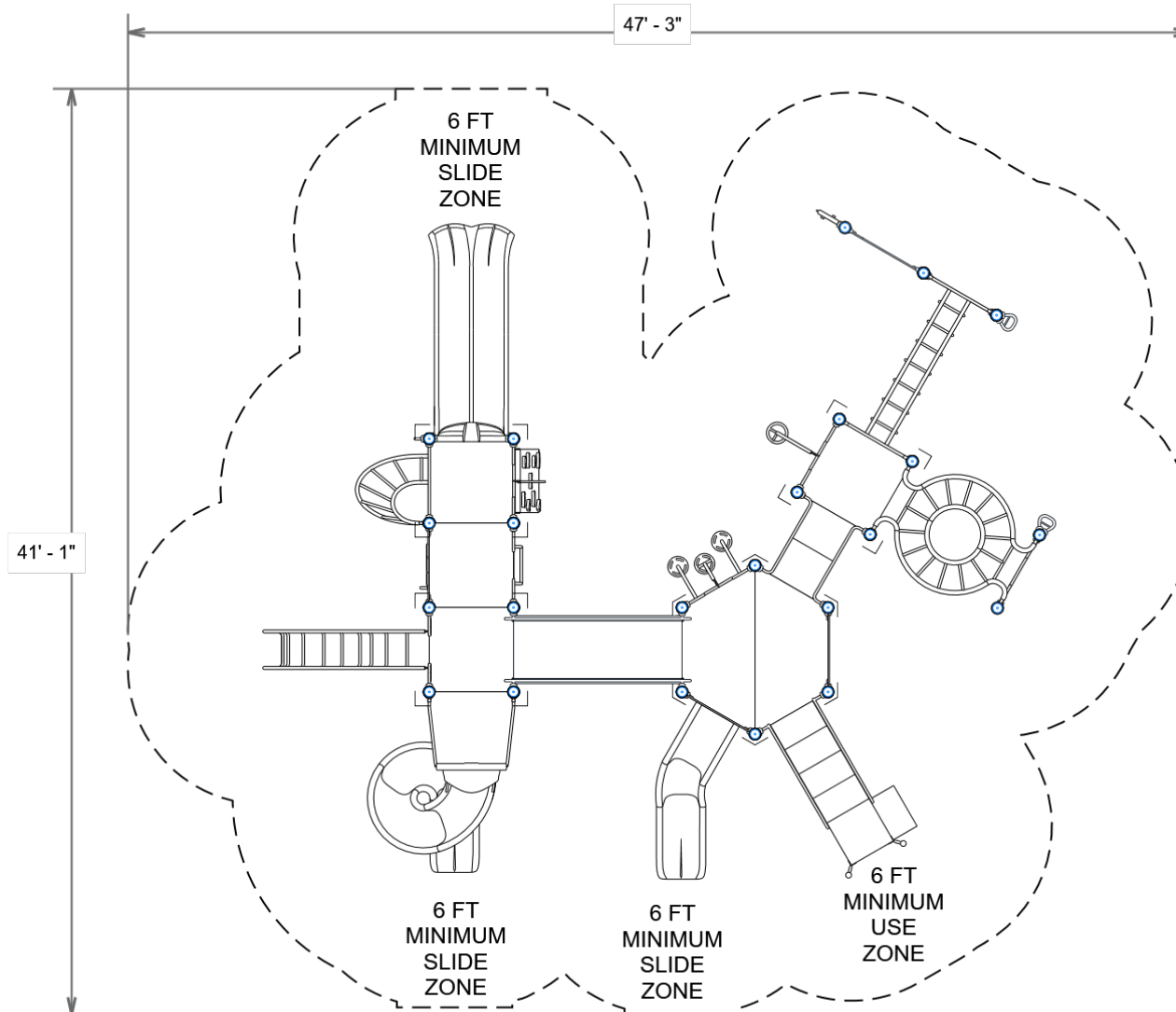

PROJECT#: R50DDF20A

DATE: 6/2/2021 | DRAWN BY: Nathaniel

MIN. USE ZONE: 48' x 42'

PLAYCRAFT REP:

**Playcraft Direct, Inc.**



**R50DDF20A**  
**SW VIEW**

**R5**

FOR KIDS  
AGES  
5-12



STRUCTURE#: R50DDF20A

PROJECT#: R50DDF20A

DATE: 6/2/2021 | DRAWN BY: Nathaniel



**R50DDF20A**  
**NE VIEW**

**R5**

FOR KIDS  
AGES  
5-12



STRUCTURE#: R50DDF20A

PROJECT#: R50DDF20A

DATE: 6/2/2021 | DRAWN BY: Nathaniel



## Bill of Materials

R50DDF20A

Project# R50DDF20A

6/2/2021

Item	Description	Quantity
R50DDF20A		
HS-1004-R	Collars	102
GF-7002	Dome Cap, R5	17
S-1011-R5-11ft	Post, 11ft R5	3
S-1012-R5-12ft	Post, 12ft R5	2
S-1016-R5-16ft	Post, 16ft R5	10
S-1017-R5-17ft	Post, 17ft R5	4
S-1018-R5-18ft	Post, 18ft R5	4
S-1101-R5	Square Deck	4
S-1106-R5	Hex Deck, Half (4 Post)	2
S-1206-24R45	ADA Stairs, 24in Rise w/ Walls	1
S-1209-36W-R5	Transfer Station, 48in-R (W)	1
S-1210-72	Climber, Vertical Ladder 66-72in	1
S-1214-5R5	Climber, Wall 54-60in	1
S-1223-2R	Climber, Spiral 18-24in	1
S-1225-6R	Climber, Wave 66-72in	1
S-1237-6R5	Climber, Vertical Rock 66-72in	1
S-1243-4	Climber, Disc Pole 42-48in	1
S-12801-R-R5	Climber, Sunrise 54-60in (Right)	1
S-1306-R5	Double Slide SitDown Hood	1
S-1309-2-R5	Half Walls (Pair) R5	1
S-1310-R5	Transition Wall	3
S-1314-1948-B-R5L	Access Wall w/ Handle (Left)	1
S-1316-R5	Twister Entry Panel	1
S-1402-R5	End Access Ladder (2-Rung)	2
S-1417-R5	Traverse, Wall (Single Section)	1



Item	Description	Quantity
S-1418-R5	Traverse, Serpent	1
S-1420-R5	Traverse, Horizontal Ladder (Small, 360 Deg)	1
S-1514-90R5	Bridge, Inclined Arch (90in)	1
S-1645-R5G	Store Panel (Open)	1
S-1682-R5	Age Appropriate Safety Panel (5-12)	1
S-1702-5R5	Slide, Double 60in	1
S-1706-S6R-R5	Slide, Twister Spiral 72in (R)	1
S-1710-4-L	Slide, Twister 48in (L)	1
S-18016-R5	Metal Roof, Gable Shade	3
S-1803-R5STL	Metal Roof, Hex	1
S-1932-R5	Hand Spin Cycler (Post Mounted)	1
S-1937-R5	Crunch Handle	2
S-1962-R5	Playseat	2
HS-1100-3	Deck to Deck Hardware	2