

TOP VIEW

ELEVATED	ACCESSIBLE	RAMP ACCESSIBLE	GROUND	TYPES
10	10/5	0/0	10/3	4/3
CHILD CAPACITY	94	MAX FALL HEIGHT	48	

FOR KIDS
AGES
2-12

This conceptual plan is based on information provided prior to construction. Detailed site information, including the following, should be obtained, evaluated, and utilized in the final project design. Exact site dimensions, topography, existing utilities, soil conditions and drainage solutions.

WARNING: Accessible safety surfacing material is required beneath and around this equipment that has a critical height value (Fall Height) appropriate for the highest accessible part of this equipment. Refer to the CPSC'S Handbook For Public Playground Safety, Section 4: Surfacing.

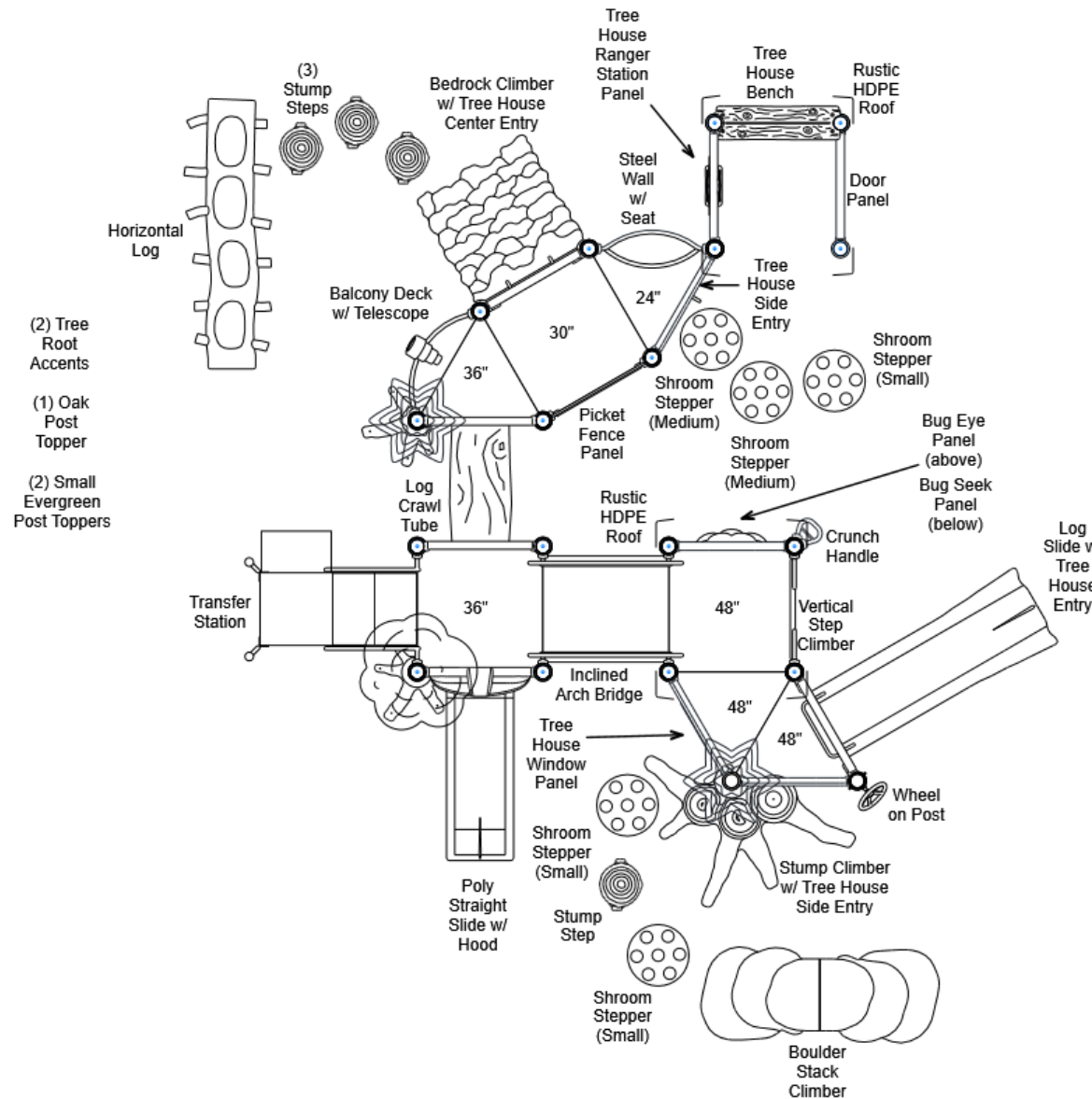
**Playcraft Direct, Inc.**

MIN. USE ZONE 39' x 41' (11.596m x 12.255m)



R50C9B19A
SITE PLAN

ADA ACCESSIBILITY GUIDELINES - ADAAG CONFORMANCE

ELEVATED	ACCESSIBLE	RAMP ACCESSIBLE	GROUND	TYPES
10	10/5	0/0	10/3	4/3

R5

FOR KIDS
AGES
2-12

GENERAL NOTES

This Preliminary Site Plan is based on measurements that were provided in the initial planning phase. All dimensions must be verified prior to the submission of a purchase order. Playcraft Systems will not be held responsible for any discrepancies between actual dimensions and dimensions submitted in the planning phase.

The Minimum Use Zone for a play structure is based on the product design at the time of proposal. Components and structure designs may be subject to change which may affect dimensions. Therefore, before preparing the site, we strongly recommend obtaining final drawings from the factory (available after the order is placed and included in the Assembly Manual).

WARNING: Accessible safety surfacing material is required beneath and around this equipment that has a critical height value (Fall Height) appropriate for the highest accessible part of this equipment. Refer to the CPSC'S Handbook For Public Playground Safety, Section 4: Surfacing.

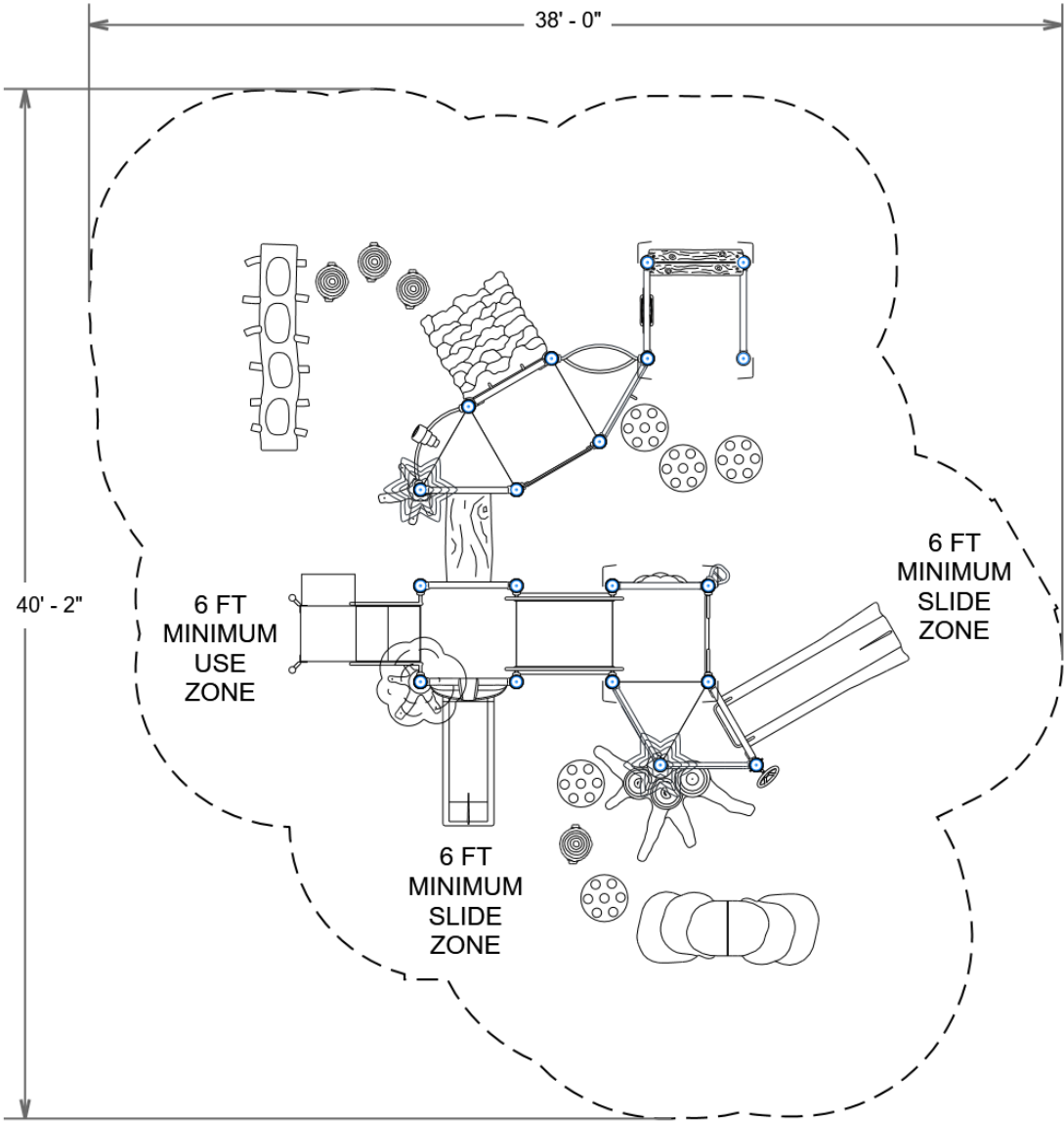

R50C9B19A
SW VIEW

R5

FOR KIDS
AGES
2-12



STRUCTURE # R50C9B19A
PROJECT # R50C9B19A
DATE 7/25/2023

R50C9B19A
NE VIEW

R5

FOR KIDS
AGES
2-12



STRUCTURE # R50C9B19A
PROJECT # R50C9B19A
DATE 7/25/2023

R50C9B19A

Project # R50C9B19A

Date 7/25/2023

Item / Part Number	Description	Qty
[R50C9B19A]		
HS-1004-R	Collars	63
A2-2272-20	Boulder Stack Climber 20in	1
A2-2425	Horizontal Log	1
A2-2432	Shroom Stepper (Small)	3
A2-2433	Shroom Stepper (Medium)	2
GF-7002	Dome Cap, R5	8
S-1010-R5-10ft	Post, 10ft R5	7
S-1011-R5-11ft	Post, 11ft R5	1
S-1012-R5-12ft	Post, 12ft R5	4
S-1014-R5-14ft	Post, 14ft R5	4
S-1015-R5-15ft	Post, 15ft R5	1
S-1016-R5-16ft	Post, 16ft R5	2
S-1101-R5	Square Deck	3
S-1102-R5	Tri-Deck	4
S-11048-48R5	Log Slide 48in	1
S-1109-R5-T	Balcony Deck w/ Telescope	1
S-1209-24-R5	Transfer Station, 36in-L	1
S-1212-4R5	Climber, Vertical Step 42-48in	1
S-1228-1677-3R5	Climber, Bedrock w/ Tree House Entry 30-36in	1
S-1292-48R5SE	Climber, Stump (T.H. Side Entry) 48in	1
S-1303-R5	Single Slide SitDown Hood	1
S-1309-2-R5	Half Walls (Pair) R5	1
S-1312-R5	Steel Wall (w/ HDPE Seat)	1
S-1514-45R5	Bridge, Inclined Arch (45in)	1
S-1618-Bug-R5G	Seek Panel (Bug)	1
S-1632-R5	Bug Eye Panel	1
S-1638-FP-R5	Picket Fence Panel	1
S-1654-R5	Door Panel	1
S-1677-R5LT	Log Crawl Tube	1
S-1677-RNG-GM-R5	Tree House Ranger Station Panel (I)	1
S-1677-SEP-DM-R5	Tree House Side Entry	1
S-1677-WND-DM_R5	Tree House Window	1
S-1701-3	Slide, Single 36in (Straight)	1
S-1809-R5	Roof, Rustic HDPE	2
S-1812-R5	Driver Wheel (Post Mounted)	1
S-1847-S-R5	Evergreen Topper (Small)	2

Item / Part Number	Description	Qty
S-1848-R5	Oak Topper	1
S-1849-R5	Tree Root Accent	2
S-1937-R5	Crunch Handle	1
S-1960-TH-R5	Tree House Bench	1
S-1961	Stump Step 12-18in	4