

R50B8EAFA

TOP VIEW

ADA ACCESSIBILITY GUIDELINE - ADAAG CONFORMANCE

ELEVATED	ACCESSIBLE	RAMP ACCESSIBLE	GROUND	TYPES
17	17/9	12	6/0	2/0

R5

FOR KIDS
AGES
2-5

GENERAL NOTES:

This conceptual plan is based on information provided prior to construction. Detailed site information, including the following, should be obtained, evaluated, and utilized in the final project design. Exact site dimensions, topography, existing utilities, soil conditions and drainage solutions.

WARNING: Accessible safety surfacing material is required beneath and around this equipment that has a critical height value (Fall Height) appropriate for the highest accessible part of this equipment. Refer to the CPSC'S Handbook For Public Playground Safety, Section 4: Surfacing.

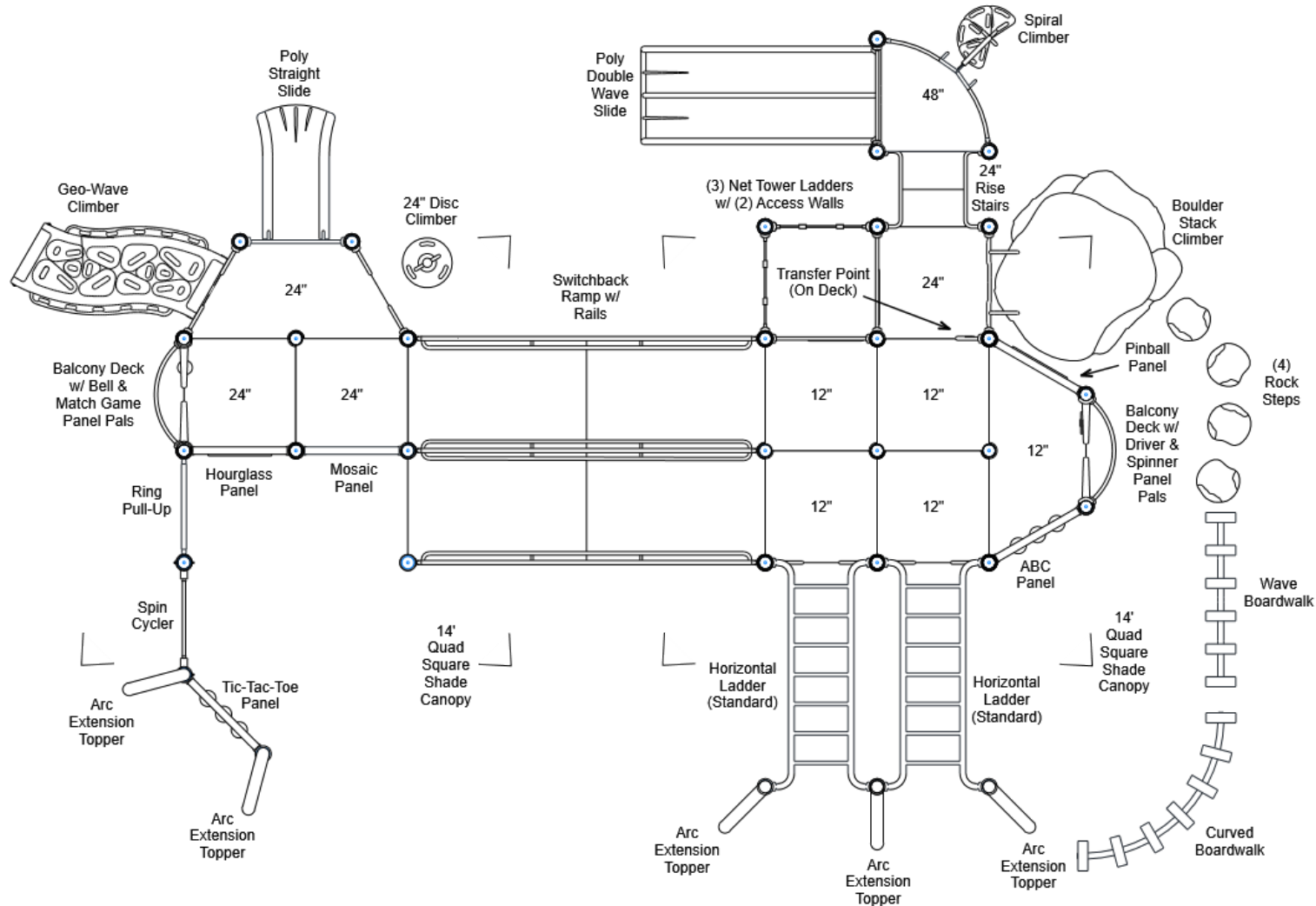

STRUCTURE#: R50B8EAFA
PROJECT#: R50B8EAFA
DATE: 7/29/2022

MIN. USE ZONE: 54' x 41'

PLAYCRAFT REP:
Playcraft Direct, Inc.

R50B8EAFA
SITE PLAN

ADA ACCESSIBILITY GUIDELINE - ADAAG CONFORMANCE

ELEVATED	ACCESSIBLE	RAMP ACCESSIBLE	GROUND	TYPES
17	17/9	12	6/0	2/0

R5

FOR KIDS
AGES
2-5

GENERAL NOTES:

This Preliminary Site Plan is based on measurements that were provided in the initial planning phase. All dimensions must be verified prior to the submission of a purchase order. Playcraft Systems will not be held responsible for any discrepancies between actual dimensions and dimensions submitted in the planning phase.

The Minimum Use Zone for a play structure is based on the product design at the time of proposal. Components and structure designs may be subject to change which may affect dimensions. Therefore, before preparing the site, we strongly recommend obtaining final drawings from the factory (available after the order is placed and included in the Assembly Manual).

WARNING: Accessible safety surfacing material is required beneath and around this equipment that has a critical height value (Fall Height) appropriate for the highest accessible part of this equipment. Refer to the CPSC'S Handbook For Public Playground Safety, Section 4: Surfacing.

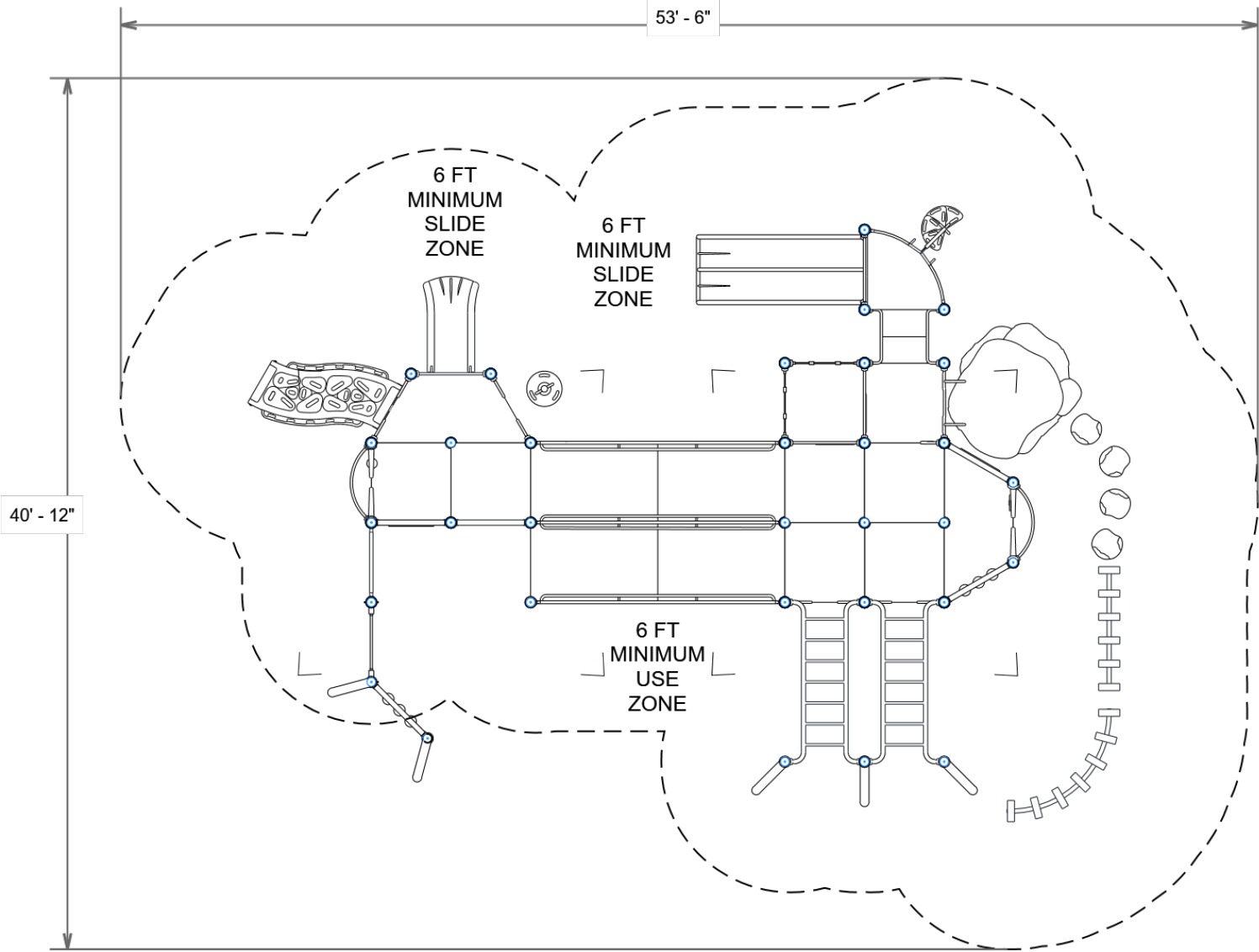

PROJECT#: R50B8EAFA
DATE: 7/29/2022

MIN. USE ZONE: 54' x 41'

PLAYCRAFT REP:
Playcraft Direct, Inc.

R50B8EAFA
SW VIEW

R5

FOR KIDS
AGES
2-5

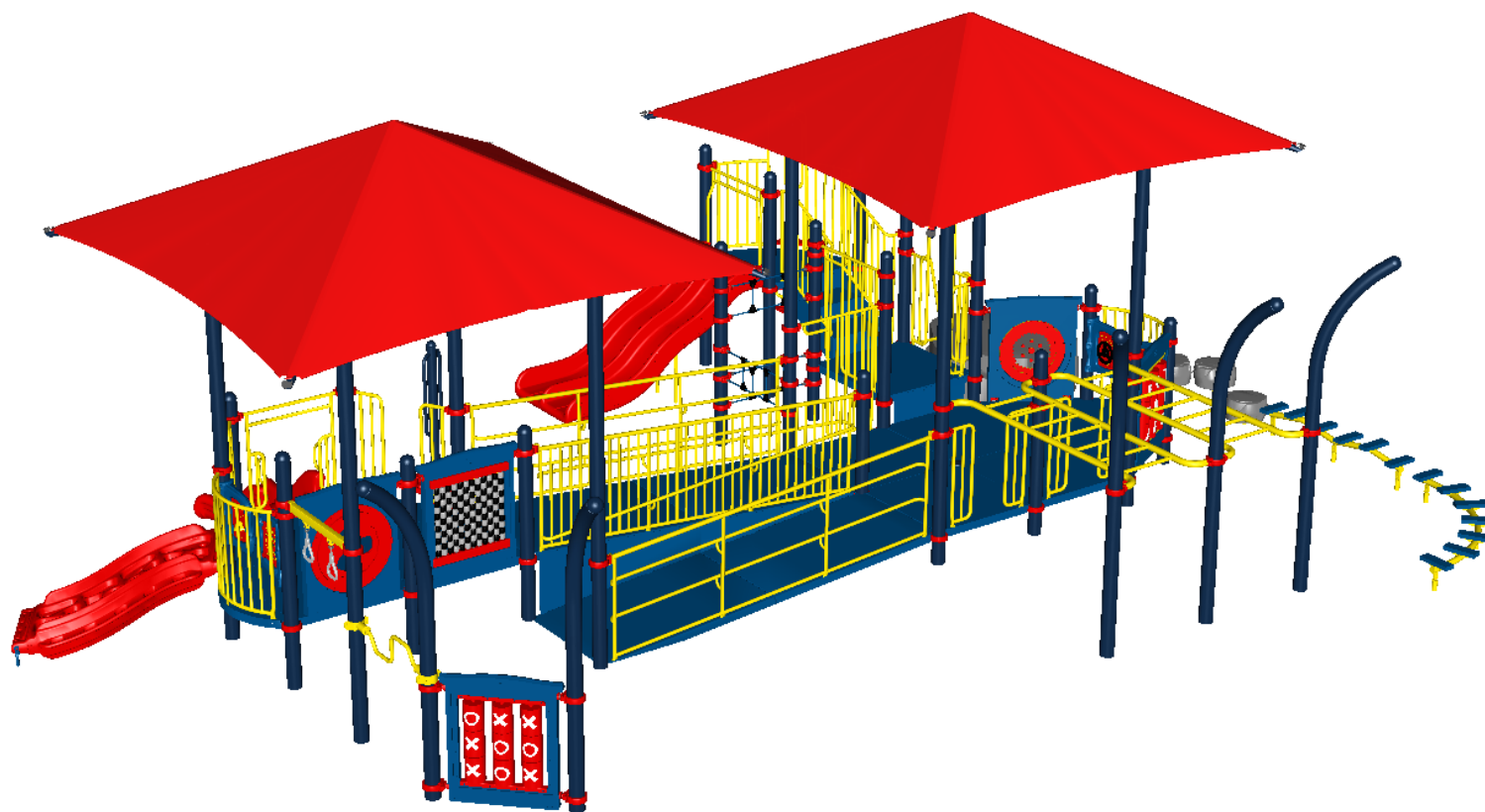

STRUCTURE#: R50B8EAFA
PROJECT#: R50B8EAFA
DATE: 8/2/2022

R50B8EAFA
NE VIEW

R5

FOR KIDS
AGES
2-5

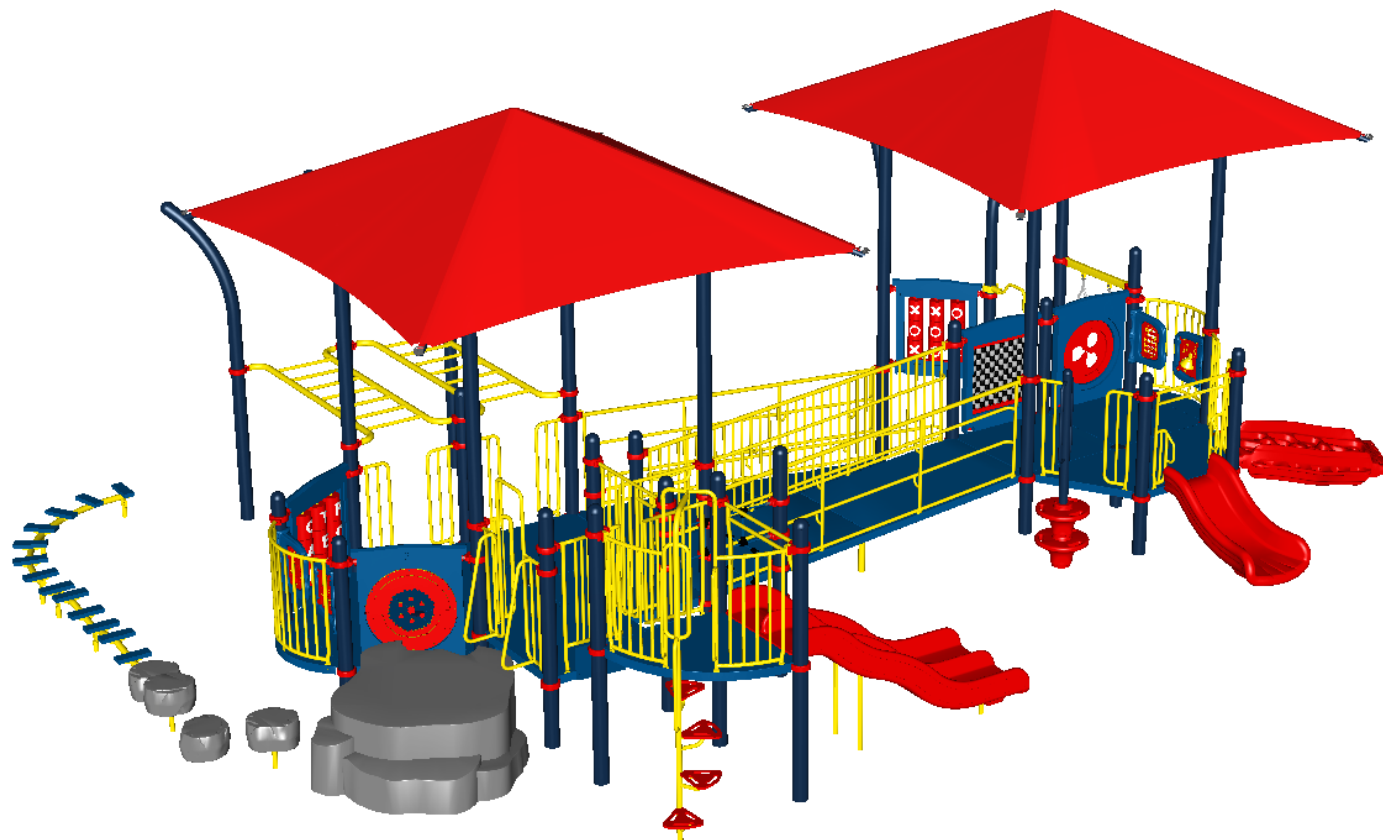

STRUCTURE#: R50B8EAFA
PROJECT#: R50B8EAFA
DATE: 8/2/2022



Bill of Materials

R50B8EAFA

Project# R50B8EAFA

7/29/2022

Item	Description	Quantity
R50B8EAFA		
HS-1004-R	Collars	80
A2-2430	Boardwalk, Curved (90 Degree)	1
A2-2435-W	Boardwalk, Wave	1
GF-7001	Flat Cap, R5	2
GF-7002	Dome Cap, R5	17
S-1005-R5F-9-012-051	Post, 5ft, 12in (51in)	1
S-1006-R5F-9-024-063	Post, 6ft, 24in (63in)	1
S-1008-R5-08ft	Post, 08ft R5	6
S-1009-R5-09ft	Post, 09ft R5	8
S-1010-R5-10ft	Post, 10ft R5	5
S-1011-R5-11ft	Post, 11ft R5	3
S-1015-R5-15ft	Post, 15ft R5	8
S-1101-R5	Square Deck	7
S-1103-R5	Hex Deck, Half (5 Post)	2
S-1107-R5	Curved Deck	1
S-1109-R5	Balcony Deck	2
S-1110-R	Filler, 12in	2
S-1206-24R5	ADA Stairs, 24in Rise w/ Walls (Short)	1
S-1208-SBRL24G	Ramp Switchback (Ground w/ Rails, Inc.)	1
S-1233-2-HW	Climber, Disc 18-24in (w/ HW)	1
S-1234-4CR5	Climber, Spiral Step 42-48in	1
S-1249-DGH	Climber, Inc. Geo-Wave 18-24in (H, DTG, L)	1
S-1290-D1-R5	Climber, Boulder Stack 24in (Base Rock)	1
S-1293-R5	Net Tower Ladder	3
S-1305-R5	Double Slide SitDown Wall	1



Bill of Materials (continued)

Item	Description	Quantity
S-1309-2-R5	Half Walls (Pair) R5	4
S-1309-ADA-R-R5	Half Walls ADA (Single, Right)	1
S-1314-R5L	Access Wall (Left)	1
S-1314-R5R	Access Wall (Right)	1
S-1406-90R5	Traverse, Horizontal Ladder (7-Rung)	2
S-1616-R5G	Tic-Tac-Toe Panel	1
S-1619-R5	ABC Panel	1
S-1630-R5	Hourglass Panel	1
S-1631-R5	Pinball Panel	1
S-1661-R5	Panel Pal, Bell	1
S-1666-R5	Panel Pal, Spinner	1
S-1667-R5	Panel Pal, Driver	1
S-1668-R5	Panel Pal, Match Game	1
S-1685-R5	Mosaic Panel	1
S-1701-2R5V2	Slide, Single 24-30in (Straight)	1
S-1702-4R5	Slide, Wave 48in (Double)	1
S-18021-R5QD14	Shade Canopy, 14ft Quad Square	2
S-1850-R5	Arc Extension Topper	5
S-1933-R5	Spin Cyclor	1
S-1936-R5	Ring Pull-Up	1
S-1961-R	Rock Step	4