

R5066599A
TOP VIEW

ADA ACCESSIBILITY GUIDELINES - ADAAG CONFORMANCE

ELEVATED	ACCESSIBLE	RAMP ACCESSIBLE	GROUND	TYPES
19	13/10	0/0	7/6	4/3
CHILD CAPACITY	211	MAX FALL HEIGHT	108	

R5

FOR KIDS
AGES
5-12

GENERAL NOTES

This conceptual plan is based on information provided prior to construction. Detailed site information, including the following, should be obtained, evaluated, and utilized in the final project design. Exact site dimensions, topography, existing utilities, soil conditions and drainage solutions.

WARNING: Accessible safety surfacing material is required beneath and around this equipment that has a critical height value (Fall Height) appropriate for the highest accessible part of this equipment. Refer to the CPSC'S Handbook For Public Playground Safety, Section 4: Surfacing.

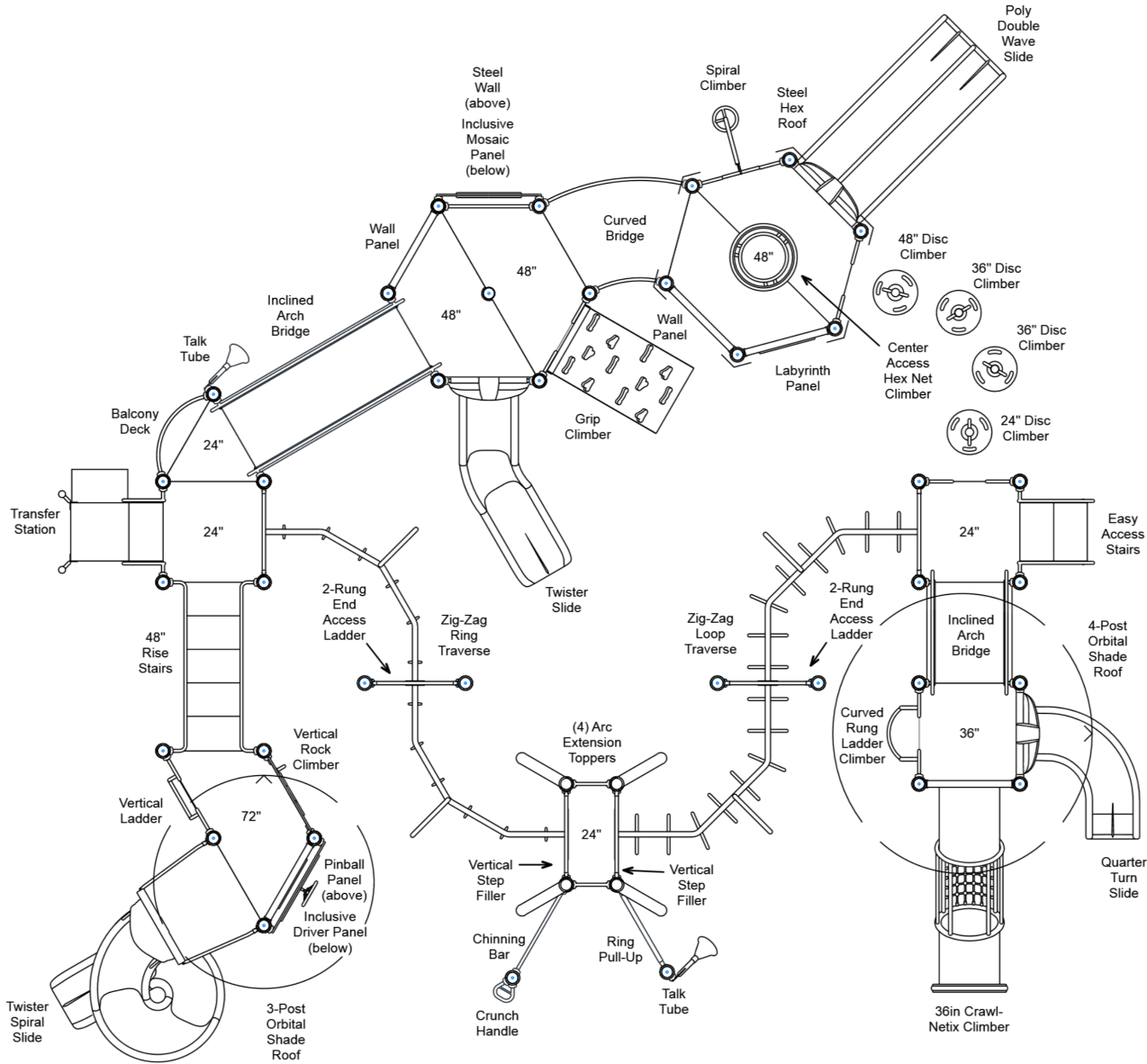

STRUCTURE # R5066599A
PROJECT # R5066599A
DATE 12/5/2024

Playcraft Direct, Inc.
MIN. USE ZONE 53' x 51' (16.025m x 15.532m)



R5066599A
TOP VIEW

ADA ACCESSIBILITY GUIDELINES - ADAAG CONFORMANCE

ELEVATED	ACCESSIBLE	RAMP ACCESSIBLE	GROUND	TYPES
19	13/10	0/0	7/6	4/3
CHILD CAPACITY	211	MAX FALL HEIGHT	108	

R5

FOR KIDS
AGES
5-12

GENERAL NOTES

This conceptual plan is based on information provided prior to construction. Detailed site information, including the following, should be obtained, evaluated, and utilized in the final project design. Exact site dimensions, topography, existing utilities, soil conditions and drainage solutions.

WARNING: Accessible safety surfacing material is required beneath and around this equipment that has a critical height value (Fall Height) appropriate for the highest accessible part of this equipment. Refer to the CPSC'S Handbook For Public Playground Safety, Section 4: Surfacing.

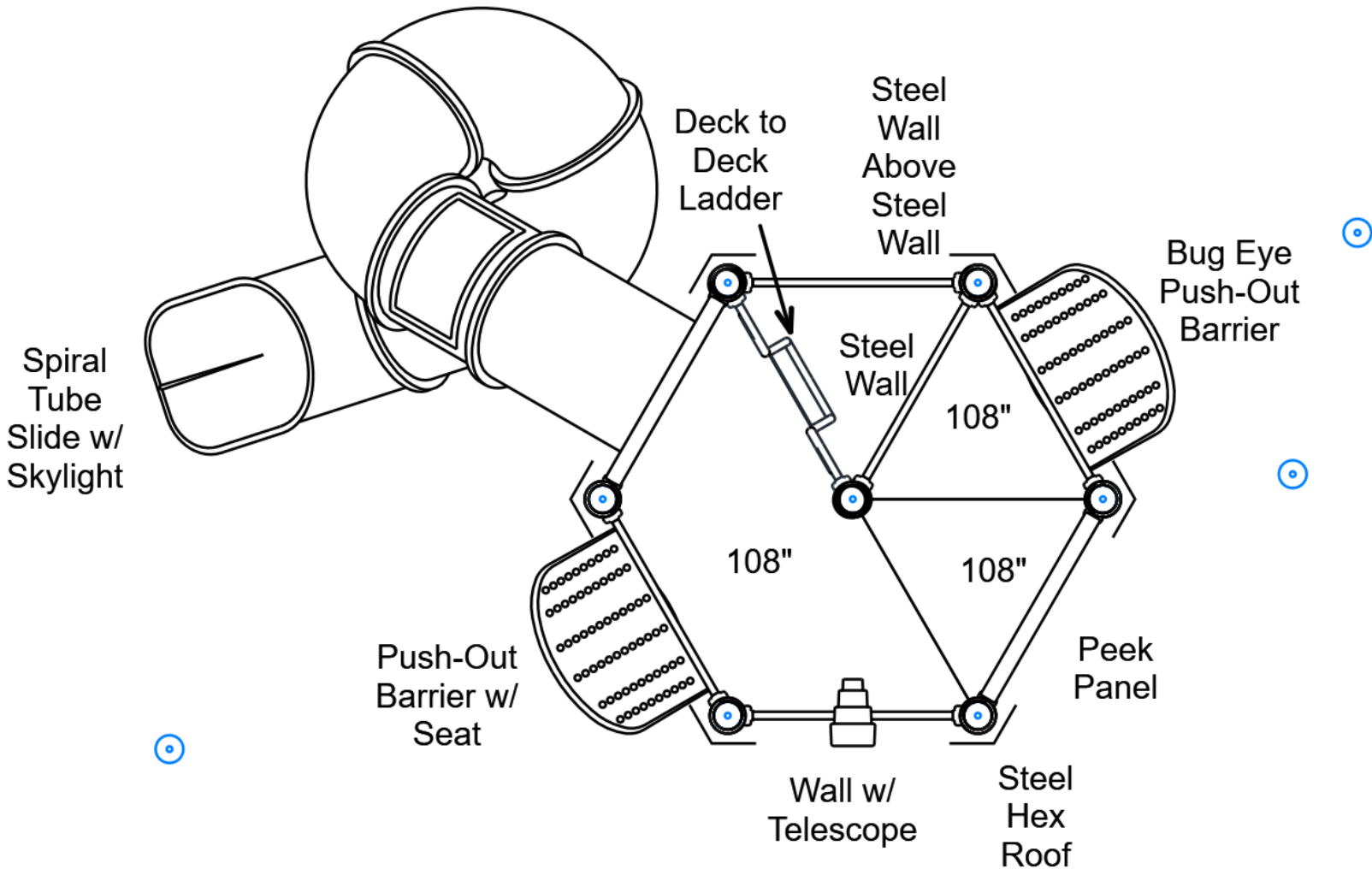

STRUCTURE # R5066599A
PROJECT # R5066599A
DATE 12/5/2024

Playcraft Direct, Inc.
MIN. USE ZONE 53' x 51' (16.025m x 15.532m)



R5066599A
SITE PLAN

ADA ACCESSIBILITY GUIDELINES - ADAAG CONFORMANCE

ELEVATED	ACCESSIBLE	RAMP ACCESSIBLE	GROUND	TYPES
19	13/10	0/0	7/6	4/3

R5

FOR KIDS
AGES
5-12

GENERAL NOTES

This Preliminary Site Plan is based on measurements that were provided in the initial planning phase. All dimensions must be verified prior to the submission of a purchase order. Playcraft Systems will not be held responsible for any discrepancies between actual dimensions and dimensions submitted in the planning phase.

The Minimum Use Zone for a play structure is based on the product design at the time of proposal. Components and structure designs may be subject to change which may affect dimensions. Therefore, before preparing the site, we strongly recommend obtaining final drawings from the factory (available after the order is placed and included in the Assembly Manual).

WARNING: Accessible safety surfacing material is required beneath and around this equipment that has a critical height value (Fall Height) appropriate for the highest accessible part of this equipment. Refer to the CPSC'S Handbook For Public Playground Safety, Section 4: Surfacing.

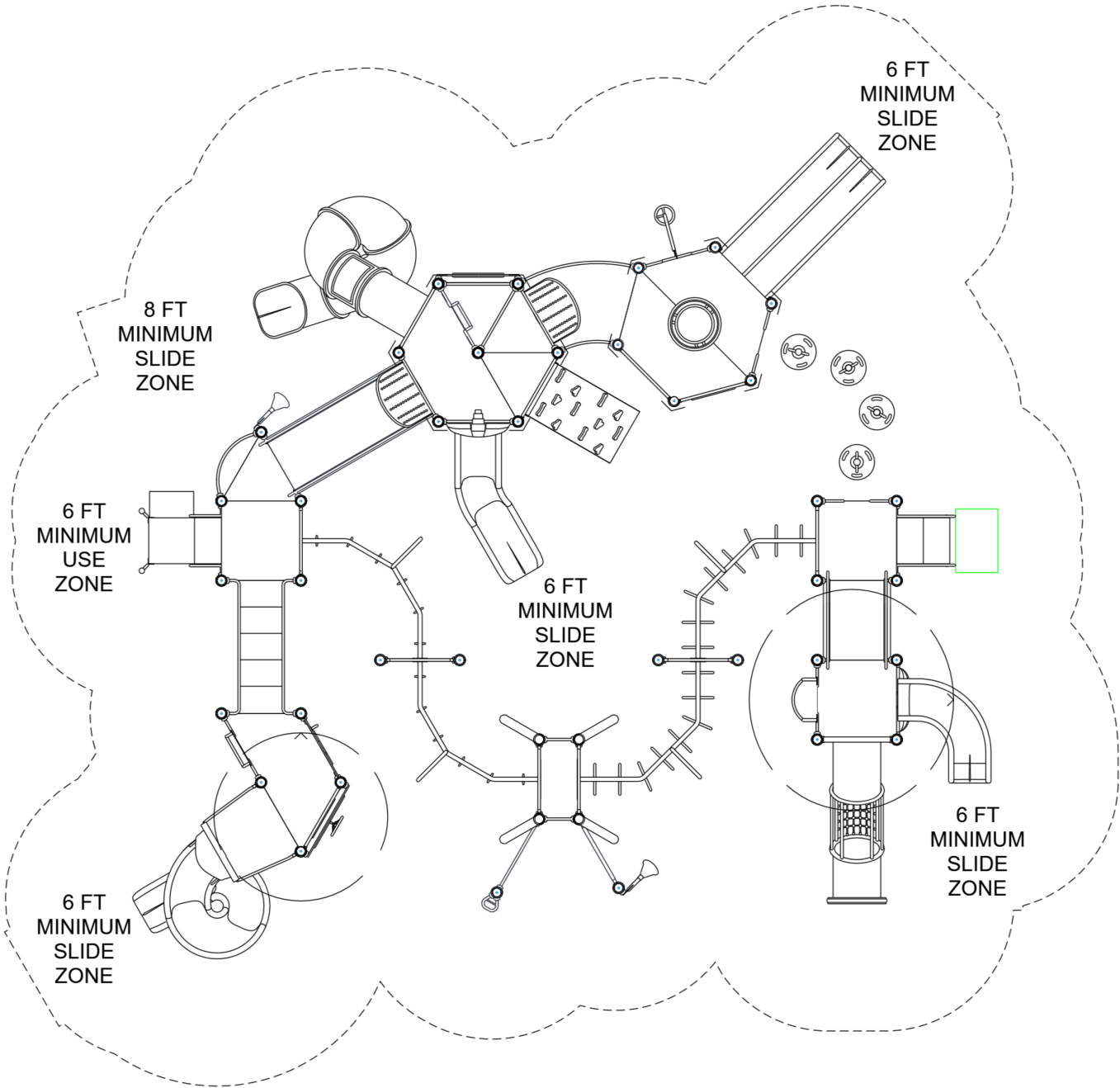

PROJECT # R5066599A
DATE 12/5/2024

Playcraft Direct, Inc.
MIN. USE ZONE 53' x 51' (16.002m x 15.545m)



R5066599A
SW VIEW

R5

FOR KIDS
AGES
5-12

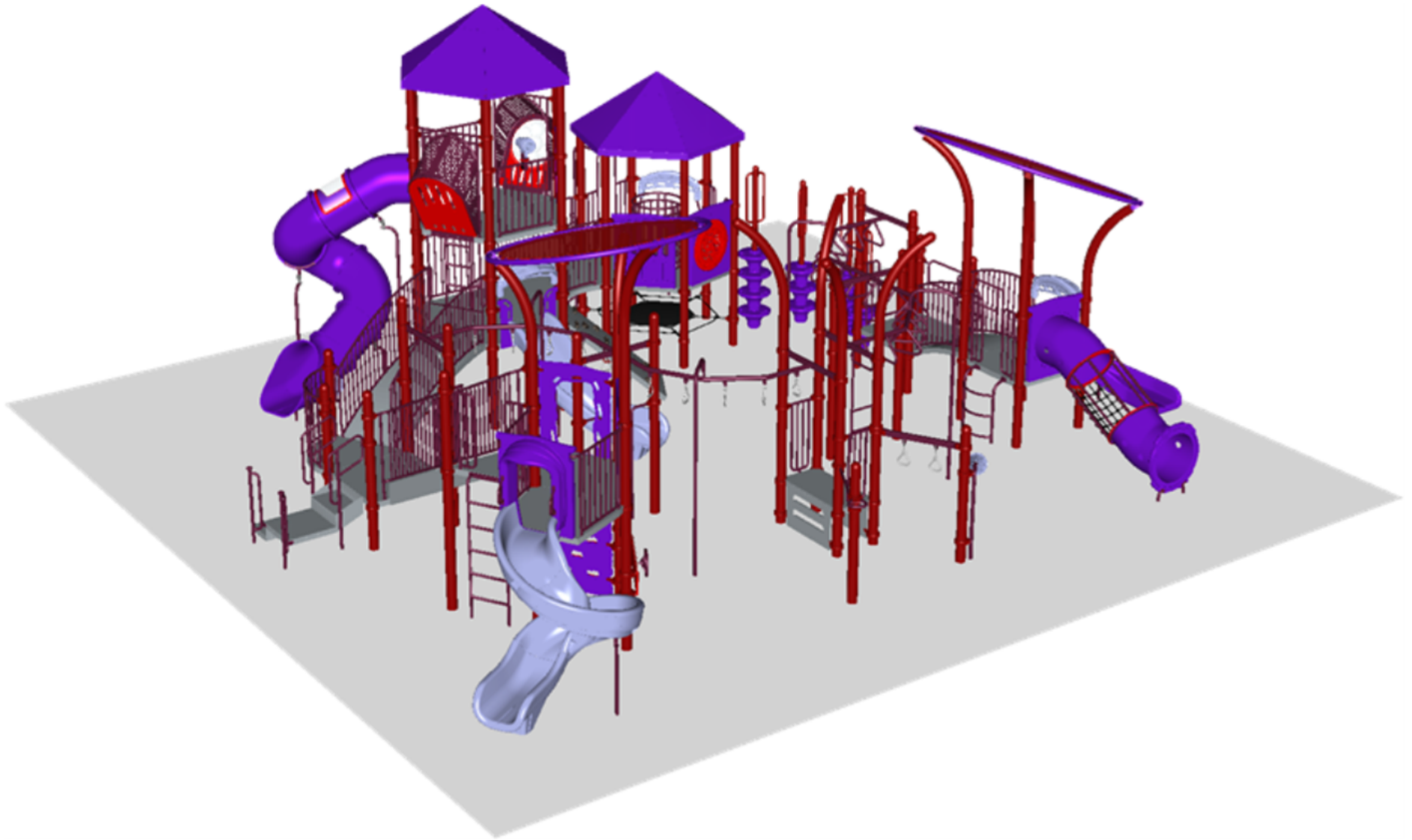

STRUCTURE # R5066599A
PROJECT # R5066599A
DATE 12/5/2024

R5066599A
NE VIEW

R5

FOR KIDS
AGES
5-12



STRUCTURE # R5066599A
PROJECT # R5066599A
DATE 12/5/2024

R5066599A
Project # R5066599A
Date 12/5/2024

Item / Part Number	Description	Qty
[R5066599A]		
HS-1004-R	Collars	144
GF-7002	Dome Cap, R5	18
S-1009-R5-09ft	Post, 09ft R5	10
S-1010-R5-10ft	Post, 10ft R5	1
S-1012-R5-12ft	Post, 12ft R5	15
S-1013-R5-13ft	Post, 13ft R5	2
S-1014-R5-14ft	Post, 14ft R5	6
S-1016-R5-16ft	Post, 16ft R5	1
S-1019-R5-19ft	Post, 19ft R5	6
S-11011-13011-R5	Half Square Deck w Walls R5	1
S-1101-R5	Square Deck	3
S-1102-R5	Tri-Deck	3
S-1103-R5	Hex Deck, Half (5 Post)	4
S-1109-R5	Balcony Deck	1
S-1201-2R5	Easy Access Stairs, 24in	1
S-1206-48R5	ADA Stairs, 48in Rise w/ Walls	1
S-1209-12-R5	Transfer Station, 24in-L	1
S-1210-72	Climber, Vertical Ladder 66-72in	1
S-1211-24R5G	Climber, Vertical Step Filler 24in	2
S-1216-4	Climber, Grip 42-48in	1
S-1223-4R	Climber, Spiral 42-48in	1
S-1233-2-HW	Climber, Disc 18-24in (w/ HW)	1
S-1233-3-MC	Climber, Disc 30-36in	2
S-1233-4-HW	Climber, Disc 42-48in (w/ HW)	1
S-1237-6R5	Climber, Vertical Rock 66-72in	1
S-1242-R5	Deck to Deck Ladder (60in Rise)	1
S-1282-3	Climber, Curved Rung Ladder 30-36in	1
S-1301-1830-S-R5	Wall w/ Telescope	1
S-1301-56R5	Steel Wall (Above Wall) 56in	1
S-1301-R5	Wall, Steel 36in (Standard)	2
S-1303-R5	Single Slide SitDown Hood	1
S-1303-TW-R5	Twister Entry Panel w/ Hood	1
S-1306-R5	Double Slide SitDown Hood	1
S-1309-2-R5	Half Walls (Pair) R5	5
S-1310-R5	Transition Wall	1
S-1331-R5	Wall Panel (Elevated)	2

Item / Part Number	Description	Qty
S-1362-13112-R5	Push-Out Barrier (w/ Seat)	1
S-1362-16132-R5	Push-Out Barrier (Bug Eye)	1
S-1402-R5	End Access Ladder (2-Rung)	2
S-1409-RX2-R	Traverse, Ring (Zig-Zag, Right)	1
S-1411-L-R5X2	Traverse, Loop (Zig-Zag, Left)	1
S-1511-R5	Bridge, Curved	1
S-1514-45R5	Bridge, Inclined Arch (45in)	1
S-1514-90R5	Bridge, Inclined Arch (90in)	1
S-1535-3DTG-R5	Climber, Crawl-Netix 36in (DTG, 36)	1
S-1610-R5	Peek Panel	1
S-1628-R5	Inclusive Driver Panel (Ground)	1
S-1631-R5	Pinball Panel	1
S-1634-R5	Labyrinth Panel	1
S-1686-R5	Inclusive Panel, Mosaic (Ground)	1
S-1702-4R5	Slide, Wave 48in (Double)	1
S-1705-3	Slide, Quarter Turn 36in	1
S-1706-S6L-R5	Slide, Twister Spiral 72in (L)	1
S-1707-9SKY-SPR5	Slide, Tube 108in (Spiral, Right, SKY)	1
S-1710-4-L	Slide, Twister 48in (L)	1
S-18030-3	Shade Canopy, 3-Post Orbital	1
S-18030-4R5	Shade Canopy, 4-Post Orbital	1
S-1803-R5STL	Metal Roof, Hex	2
S-1850-R5	Arc Extension Topper	4
S-1910-R5	Talk Tube (Post Mounted, Right)	1
S-1910-R5	Talk Tube (Post Mounted, Left)	1
S-1926-SR5	Center Access Hex Net Deck (48in)	1
S-1930-R5	Chinning Bar	1
S-1936-R5	Ring Pull-Up	1
S-1937-R5	Crunch Handle	1