

# R505F2FEA TOP VIEW

ADA ACCESSIBILITY GUIDELINE - ADAAG CONFORMANCE

ELEVATED	ACCESSIBLE	RAMP ACCESSIBLE	GROUND	TYPES
7	7/4	0	5/2	3/2

R5

FOR KIDS  
AGES  
2-5

## GENERAL NOTES:

This conceptual plan is based on information provided prior to construction. Detailed site information, including the following, should be obtained, evaluated, and utilized in the final project design. Exact site dimensions, topography, existing utilities, soil conditions and drainage solutions.

WARNING: Accessible safety surfacing material is required beneath and around this equipment that has a critical height value (Fall Height) appropriate for the highest accessible part of this equipment. Refer to the CPSC'S Handbook For Public Playground Safety, Section 4: Surfacing.

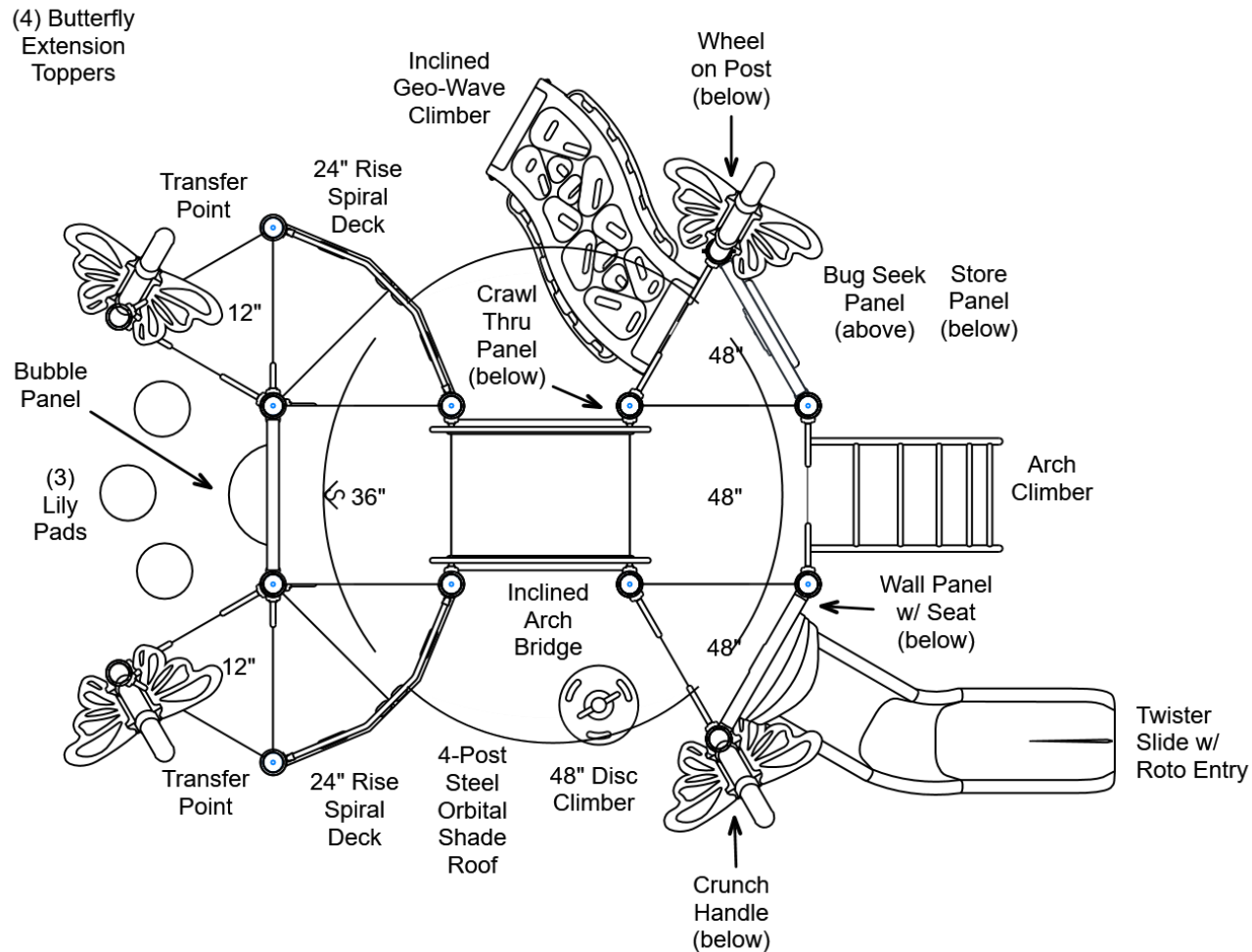

STRUCTURE#: R505F2FEA  
PROJECT#: R505F2FEA  
DATE: 7/5/2022

MIN. USE ZONE: 34' x 28'

PLAYCRAFT REP:  
**Playcraft Direct, Inc.**

# R505F2FEA SITE PLAN

ADA ACCESSIBILITY GUIDELINE - ADAAG CONFORMANCE

ELEVATED	ACCESSIBLE	RAMP ACCESSIBLE	GROUND	TYPES
7	7/4	0	5/2	3/2

R5

FOR KIDS  
AGES  
2-5

## GENERAL NOTES:

This Preliminary Site Plan is based on measurements that were provided in the initial planning phase. All dimensions must be verified prior to the submission of a purchase order. Playcraft Systems will not be held responsible for any discrepancies between actual dimensions and dimensions submitted in the planning phase.

The Minimum Use Zone for a play structure is based on the product design at the time of proposal. Components and structure designs may be subject to change which may affect dimensions. Therefore, before preparing the site, we strongly recommend obtaining final drawings from the factory (available after the order is placed and included in the Assembly Manual).

**WARNING:** Accessible safety surfacing material is required beneath and around this equipment that has a critical height value (Fall Height) appropriate for the highest accessible part of this equipment. Refer to the CPSC'S Handbook For Public Playground Safety, Section 4: Surfacing.

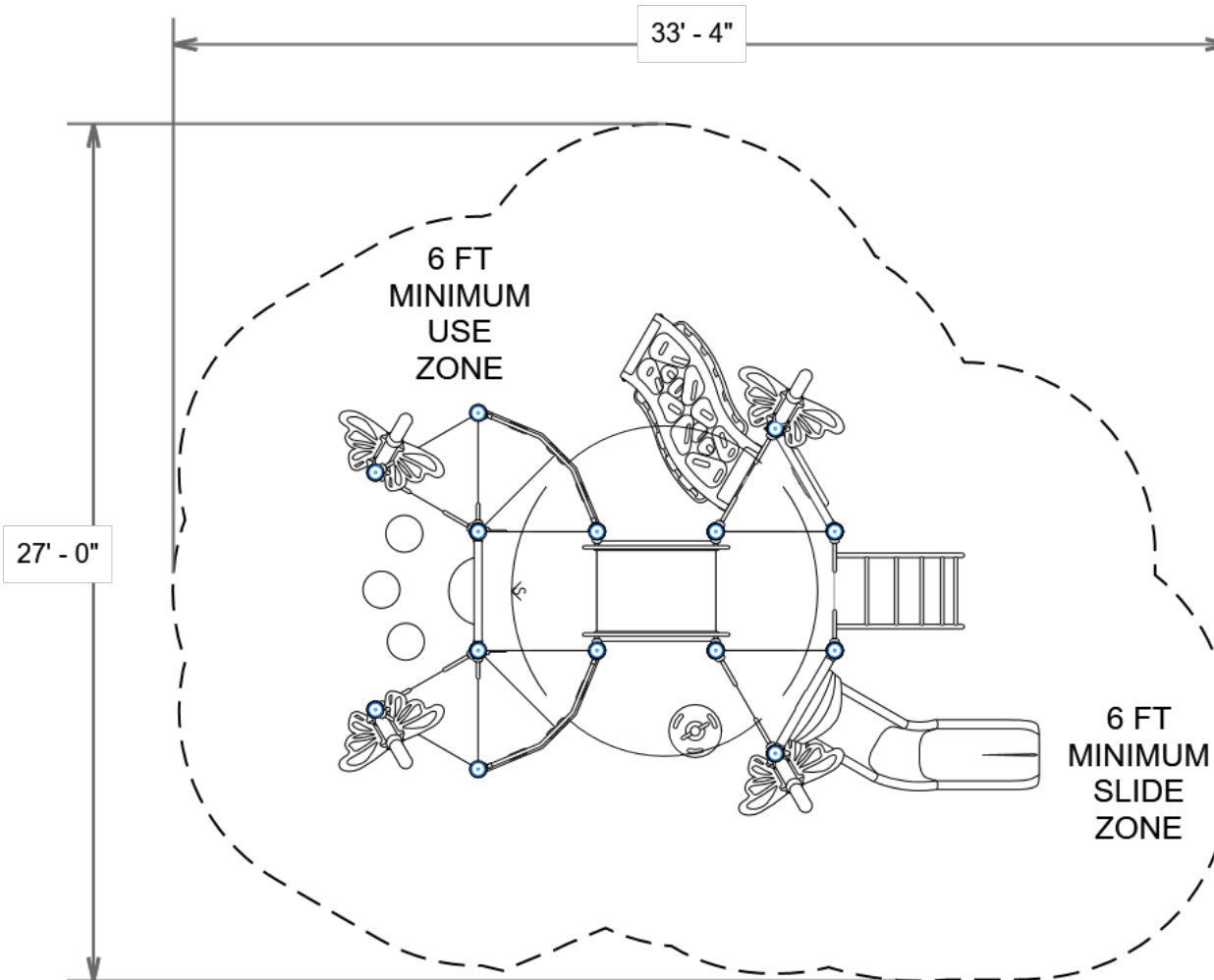

PROJECT#: R505F2FEA  
DATE: 7/5/2022

MIN. USE ZONE: 34' x 27'

PLAYCRAFT REP:  
**Playcraft Direct, Inc.**

**R505F2FEA**  
**SW VIEW**

**R5**

FOR KIDS  
AGES  
2-5



STRUCTURE#: R505F2FEA  
PROJECT#: R505F2FEA  
DATE: 7/5/2022

**R505F2FEA**  
**NE VIEW**

R5

FOR KIDS  
AGES  
2-5



STRUCTURE#: R505F2FEA  
PROJECT#: R505F2FEA  
DATE: 7/5/2022



## Bill of Materials

R505F2FEA

Project# R505F2FEA

7/5/2022

Item	Description	Quantity
R505F2FEA		
HS-1004-R	Collars	61
GF-7002	Dome Cap, R5	6
S-1009-R5-09ft	Post, 09ft R5	2
S-1010-R5-10ft	Post, 10ft R5	4
S-1011-R5-11ft	Post, 11ft R5	8
S-1101-R5	Square Deck	2
S-11021-L	Spiral Deck, (Left, 24in)	1
S-11021-R	Spiral Deck, (Right, 24in)	1
S-1102-R5	Tri-Deck	4
S-1218-4	Climber, Arch 42-48in	1
S-1233-4-HW	Climber, Disc 42-48in (w/ HW)	1
S-1249-DGH	Climber, Inc. Geo-Wave 42-48in (H, DTG, R)	1
S-1309-2-R5	Half Walls (Pair) R5	5
S-1313-R5	Handle	2
S-1316-RE-R5	Roto Twister Entry Panel	1
S-1333-R5G	Wall Seat Panel	1
S-1414	Lily Pad Step 12-18in	3
S-1514-45R5	Bridge, Inclined Arch (45in)	1
S-1600-R5G	Crawl Thru Panel	1
S-1602-R5	Bubble Panel	1
S-1615-R5	Store Panel	1
S-1618-Bug-R5	Seek Panel (Bug)	1
S-1710-4-L	Slide, Twister 48in (L)	1
S-18030-STL	Metal Roof, Orbital Shade (4-Post)	1
S-1812-R5	Driver Wheel (Post Mounted)	1



## Bill of Materials (continued)

Item	Description	Quantity
S-1851-R5CRV	Butterfly Extension Topper	4
S-1937-R5	Crunch Handle	1